

# User's Manual

## BaseT HDBaseT 2.0 4K2K HDMI + USB 2.0 Extender over CATx with Bi-directional IR Extension & Independent Audio Extraction



**EVBMU-M2010**  
EVBMU-2010L + EVBMU-2010R

### Related Products

Type	100M	Function
Tx + Rx	<b>EVBMUN-M2010</b>	HDBaseT2.0 HDMI Extender (1-in / 1-out) with IR, Ethernet, USB 2.0 & Serial Extending



- The final specification is the actual product based.
- Features and functions may be added or changed after the manual was written. Please visit our website to download the latest version of manual for reference.

PP5-HE2002Z-200 **CE FC RoHS**

### Package Contents

- Transmitter Unit x 1
- Receiver Unit x 1
- Power supplies x 2 set / pc
  - Power Adapter Set
  - Power Adapter with necessary AC Cord
  - or
  - Plug-in Power Adapter
- mini-USB to USB-A Cable x 1
- User's Manual x 1
- Foot Pad Set x 2
- Optional
  - IR Extension Kit
  - RJ12 Cable + RJ12 to DB9 Adapter

### Features

- Send HDMI and 4 USB signal to multimedia display up to 100 meter
- Transmit full uncompressed HD video and independent audio (analog stereo and Toslink (S/PDIF)) over CAT5e/6/7 cable
- Bi-directional IR extension
- USB Port is compatible for most of popular USB devices (USB KM, USB printers, USB Scanner, external hard disk drives ...)
- Support resolutions up to 4Kx2K @60 (4:2:0) and HD Audio Formats
- Compatible with most of the popular screen resolution to XGA, SXGA, UXGA, WSXGA ... Full HD, WUXGA, UHD system
- Low cost standard CAT5e/6/7 LAN cable
- HDTV, 3D HDTV compatible
- HDCP compliant and Blu-ray ready
- Compact size; easy to set up; simple to instal
- Ideal for hospitality (hotels, conference rooms), digital signage (airports, shopping malls), surveillance cameras, whole-home networking and point-to-point consumer applications

### NOTE:

Video resolution and extension distance are based on a single CATx 24AWG solid cable without cascade. STP cabling is recommended for environments with high EMI or RFI. For the best performance results, using stranded cabling or other thinner cables, and coiling of excess cable lengths should be avoided.

## 1 Connection Pattern

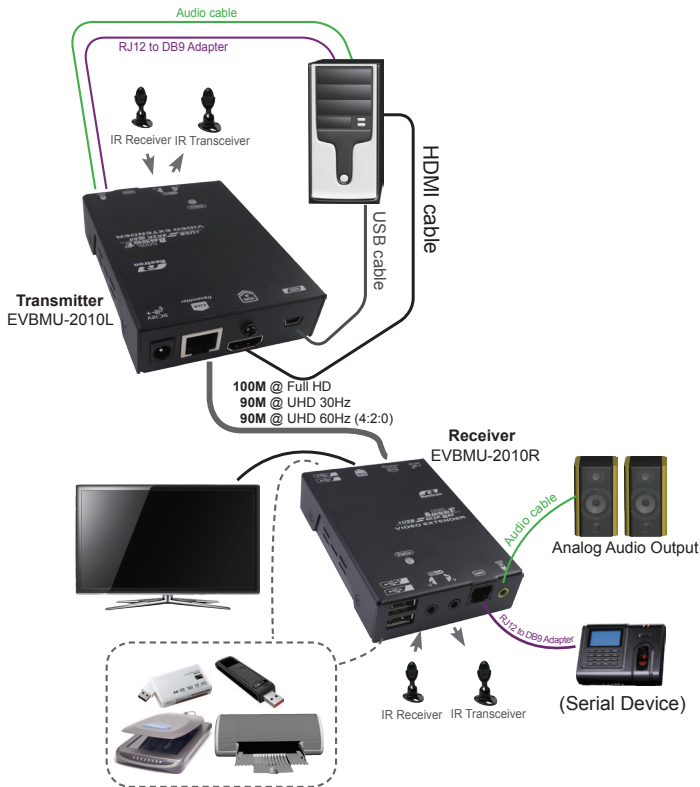

## 3 Product Description

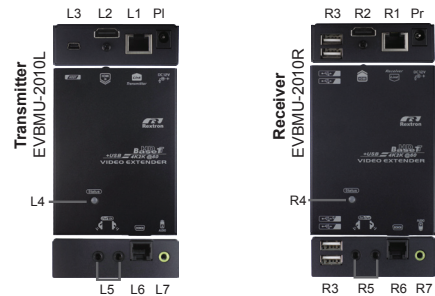

L1	R1	Function	Description
L1	R1	RJ-45 Jack	Use a CATx cable for connection between two units
L2	R2	Input / Output Connector	[L3] connects to PC [R3] connects to Monitor
L3	R3	USB connector	[L3] connects to PC [R3] connects to USB devices
L4	R4	LED Indicator	[L2] Green: Power on [R2] Green: Power on / Blue: Link OK
L5	R5	IR Extension	[In] connects to IR Receiver [Out] connects to IR Transmitter
L6	R6	RJ12 Connector	[L6] connect to PC [R6] connect to Serial device
L7	R7	Audio Connector	[L7] connect to PC [R7] connect to the speaker
PI		Power Supply	(optional) Apply power from power supplier to the unit
Pr			Apply power from power supplier to the unit

## 2 LED Indicator

Unit	LED	Status
Transmitter Unit	Power ON: Green / Link OK: Blue / HDCP content: Purple	
Receiver Unit	Power ON: Red / Link OK: Blue / HDCP content: Purple	

## 4 Specifications

Model	Transmitter Unit	Receiver Unit
EVBMU-M2010	EVBMU-2010L	EVBMU-2010R
Interface	HDMI x 1 Analog Stereo x 1 RJ-12 x 1 IR Transceiver x 1 IR Receiver x 1 USB Host x 1	HDMI x 1 Analog Stereo x 1 RJ-12 x 1 IR Transceiver x 1 IR Receiver x 1 USB Device x 4
Interconnection	RJ-45 x 1	RJ-45 x 1
LED (Link / Video status)	(Multi-Color) x 1	(Multi-Color) x 1
Video Resolution (max.)	100M Full HD (1920 x 1080) 90M UHD (3840 x 2160 @30Hz) 90M UHD (3840 x 2160 @60Hz YCbCr 4:2:0)	
Extension Distance	100M	
Power Supply	DC 12V	
Enclosure	Metal	
H x W x D (mm)	24 x 75 x 102	
Weight (g)	311~340	