

# User manual

## ***ZITZI GUPPY***



*Check the checkbox if the product is  
CUSTOMIZED. The CE Mark is no  
longer valid and should be removed.*



*The product is only intended for use as an under frame together with seating  
systems produced by Anatomic SITT AB. If other uses are desired, please contact  
Anatomic SITT AB.*

# Safety precautions

## Introduction

For you to use all advantages of the Zitzi Guppy, it is important that you read through this manual thoroughly. This applies to all persons who are in the vicinity of the user. Adjustment of the Zitzi Guppy should always be performed by medically qualified person. If you need additional information, please contact Anatomic SITT AB.

## Correspondence

Zitzi Guppy and its accessories are CE marked products. A unique serial number is located on a label placed on the lower part of the frame. This serial number should be quoted in any correspondence regarding the product.

## Crashtested and approved

Zitzi Guppy is crashtested and approved according to 7176-19 for 70 kg in vehicle.



### **Obs!**

*The prescriber or person with equivalent qualifications and knowledge of the user and the tool will always carry out a risk assessment before use. If this analysis shows that there may be a risk of serious injury, the user must never be left unattended when using the Guppy.*

## **This product is manufactured by Anatomic SITT AB**

**Postal address** Anatomic SITT AB, Box 6137, SE-600 06 Norrköping

**Street address** Anatomic SITT AB, Terminalgatan 1, SE-603 61 Norrköping

**Telephone** +4611-161800

**Fax** +4611-162005

**Email** [info@anatomicsitt.com](mailto:info@anatomicsitt.com)

**Web** [anatomicsitt.com](http://anatomicsitt.com), [youtube.com/anatomicsitt](https://youtube.com/anatomicsitt)

# Table of contents

<b>Safety precautions</b> .....	<b>3</b>	Setting the brakes .....	17
Introduction .....	3	Releasing the brakes.....	17
<b>Seat part</b> .....	<b>6</b>	Troubleshooting of the brakes .....	17
Mounting of the seatplate.....	6	Installation of drum brake.....	19
<b>Tilt</b> .....	<b>7</b>	<b>Parking brake</b> .....	<b>20</b>
Tilt of the seat .....	7	Installation of parking brake .....	20
<b>Armrest</b> .....	<b>9</b>	Using the parking brake .....	20
Installation on chassis.....	9	<b>Footrest</b> .....	<b>21</b>
Height adjustment.....	9	Mounting of footrest.....	21
Width adjustment .....	9	Safety stop .....	21
Angle adjustment upwards and downwards...	9	Adjusting the angle on the knee-joint.....	21
Depth adjustment .....	9	Adjustment the height of the footrest .....	21
<b>Driving-handle</b> .....	<b>11</b>	<b>Calf support</b> .....	<b>22</b>
Installation of driving-handle.....	11	Mounting of calf support .....	22
Depth adjustment of the driving-handle.....	11	Height adjustment of the calf support.....	22
Angle adjustment of the driving-handle .....	11	Width adjustment of the calf support .....	22
Angle adjustment of driving-handle.....	11	<b>Anti-tip device</b> .....	<b>23</b>
Fold the driving-handle .....	11	Installation of anti-tip device.....	23
<b>Wheels with Quick-release</b> .....	<b>12</b>	Using the anti-tip device .....	23
Mounting of wheels with quick-release .....	12	<b>Step bar</b> .....	<b>24</b>
Release the wheel.....	12	Installation of the step-bar .....	24
<b>Driving wheels</b> .....	<b>13</b>	Using the step-bar.....	24
Wheel position .....	13	<b>Transportation kit</b> .....	<b>26</b>
<b>Caster</b> .....	<b>14</b>	Installation of front bracket.....	26
Installation of caster .....	14	Installation of rear bracket.....	26
Mounting of the caster on the caster house fork.	14	Installation of safety-loop.....	26
Caster positioning .....	14	Using the transportation kit .....	26
Caster fork position.....	15	<b>Direction lock</b> .....	<b>28</b>
Angle adjustment of caster fork.....	15	Install the direction lock.....	28
<b>Brake</b> .....	<b>17</b>	Activate direction lock .....	28
Drum brake .....	17	Releasing the direction lock.....	28

<b>Mudguards</b>	<b>29</b>
Installation of mudguards	29
Adjusting the mudguard	29
<b>Transportation in a vehicle</b>	<b>31</b>
Guidelines for transportation in a car	31
Crash tested and approved	31
<b>Maintenance instructions</b>	<b>32</b>
Service intervals	32
Cleaning and washing instructions	32
Gas piston	32
Warranty	33
Combinations	33
Spare parts	33
Marking	33
Recycling	33
<b>Reconditioning</b>	<b>34</b>
Service	34
Cleaning	34
Finishing	34
Marking	34
Wheels	34

Paint	34
Stability	35
Tubular frame and details	35
Forks	35
Driving bow and push-handle	35
Brakes	35
Folding mechanism and tilt	35
Function control	35

<b>Adaptation and customization</b>	<b>36</b>
Recommendations	36
Risk assessment	36

<b>Terms of sale</b>	<b>37</b>
Warranty	37
Warranty claims	37
Returning products	37

<b>Customer service</b>	<b>38</b>
-------------------------	-----------

<b>Technical data</b>	<b>39</b>
-----------------------	-----------

# Seat part

## Installation of the mounting plate

The seating system mounting plate is easily mounted on the chassis by four (4) screws, washers and nuts in selected tracks (A) on the chassis seatplate.

Place the seating systems mounting plate (B) on the chassis seatplate (C) and stick through the supplied screw (D). Then meet up with nut and washer (F) on the underside of its chassis seatplate. Tighten the screws (D) firmly.



### **Note!**

*The picture shows only one type of mounting plate assembly instructions. For more information about mounting plates, see the instruction manuals for selected seating system.*

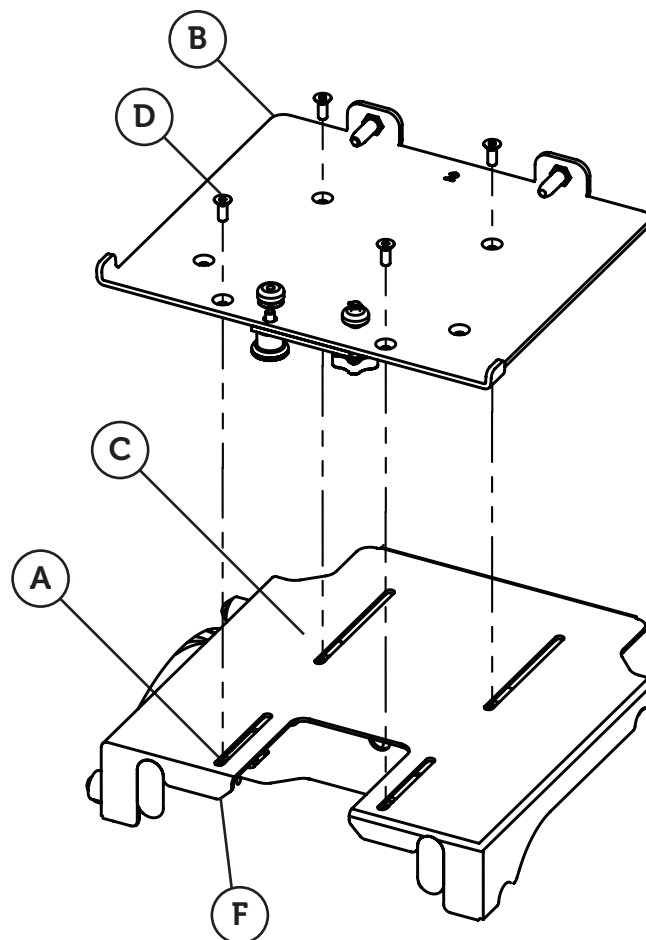

# Tilt

## Tilt the seat

The seatplate is adjustable at an angle between 0–32°. Press the tilt handle (A) while holding the handle and pushing it upwards or downwards. Let go of the tilt handle (A) when the seat is in the required position.

To restore the angle to its neutral position, press the tilt handle (A) and push the handle upwards and backwards.



### **Obs!**

*Be careful to avoid risk of pinching while tilting the seat.*



### **Obs!**

*Be aware of the possible increased risk of overturn during tilt.*

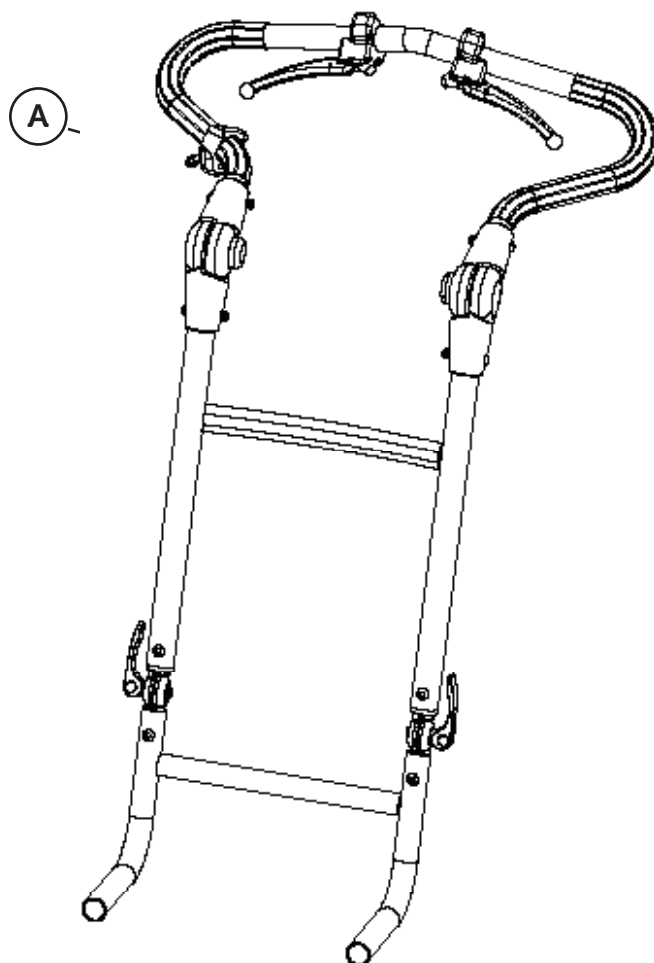

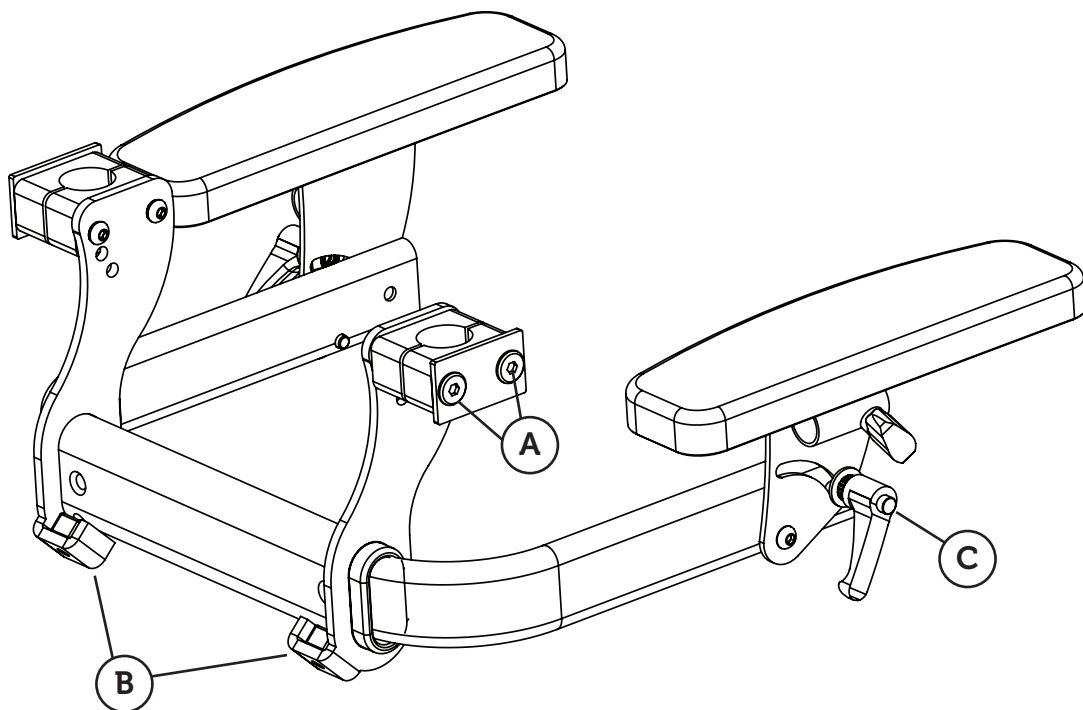
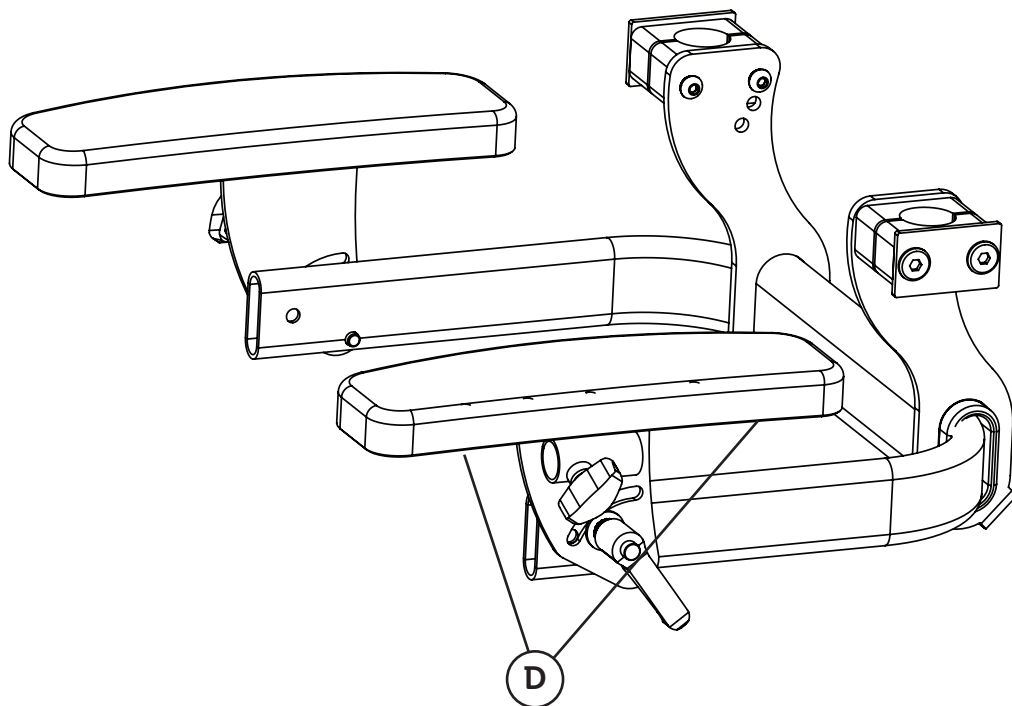



# Armrest

## **Mounting on the frame**

Loosen the screws (A) completely on each side. Mount the mounting bracket around the driving bow. Put back the screws (A) and tighten.

## **Height adjustment**

Loosen the screws (A) and adjust to required height. Tighten the screws.

## **Width adjustment**

Loosen the screws (B) and adjust to required width. Tighten the screws.

## **Angle adjustment upwards and downwards**

To adjust the angle of the armrest loosen the adjuster (C) and adjust it to the required angle. To compensate you can also adjust the angle in the armrests attachment. Loosen the screws (A) and adjust the angle using the three holes (E) in the attachment.

## **Depth adjustment**

Loosen the screws (D) underneath the armrest plate and adjust to required position using holes underneath.

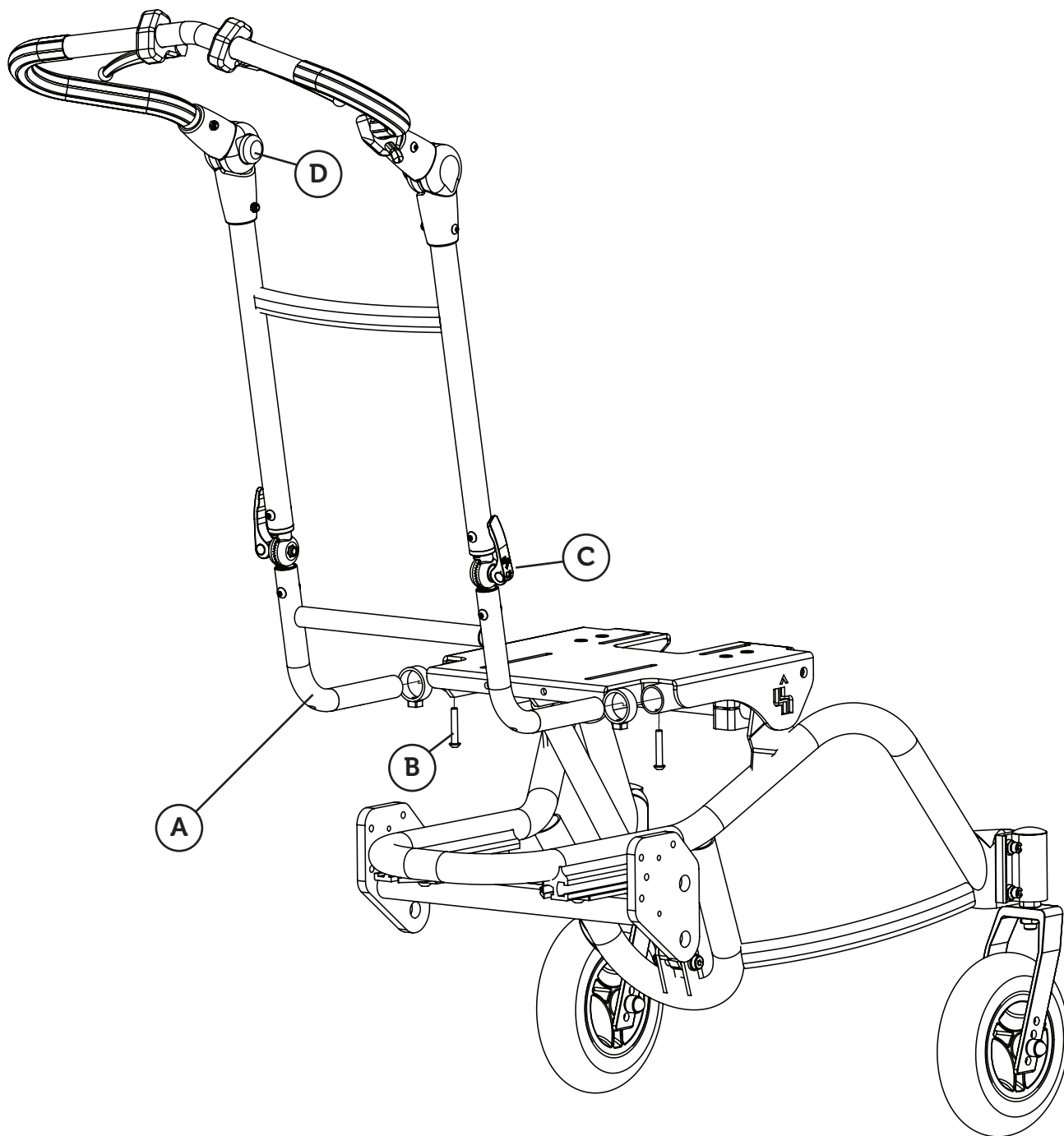

# Driving-handle

## Installation of the driving-handle

Insert the attachment of the push-frame (A) in the provided holes underneath the seatplate on the rear of the chassis and then tighten the screws (B). Choose between the four fixed positions.

## Depth adjustment of the driving-handle

To adjust the push-frame (extend the depth of the seat) loosen the screws (B) underneath the seatplate on the rear of the chassis and adjust to the desired depth. Tighten the screws (B).



### **Notice!**

*The screw must fit into one of the four fixed positions that is available on the driving-handle.*

## Angle adjustment of the driving-handle

You can adjust the angle according to the seating system you are provided with. Release the the adjusters (C) on both sides. Adjust the push-frame to required angle and then tighten the adjusters (C).



### **Notice!**

*The driving-handle shall always be in contact with the back of the seating system during transportation in a vehicle.*

## Angle adjustment of driving-handle

Press the buttons (D) on the inside of the driving-handle and adjust.

## Fold the push-frame

Release the adjusters (C) and fold the push-frame forwards. Tighten the adjusters (C).

# Wheels with Quick-release

## Mounting of wheels with quick-release

The wheels can easily be removed from the chassis which can be useful during transport purposes.

Press and hold the button (B) in the wheel center. Push the wheel (A) until it stops. Release the press button (B). Secure that the wheel is installed properly by trying to pull it outwards without pressing the quick-release button (B).



### ***Notice!***

*Secure that the wheel is installed properly by trying to pull it outwards.*

## Release the wheel

Press and hold the button (B) in the wheel center as you pull off the wheel from the chassis.

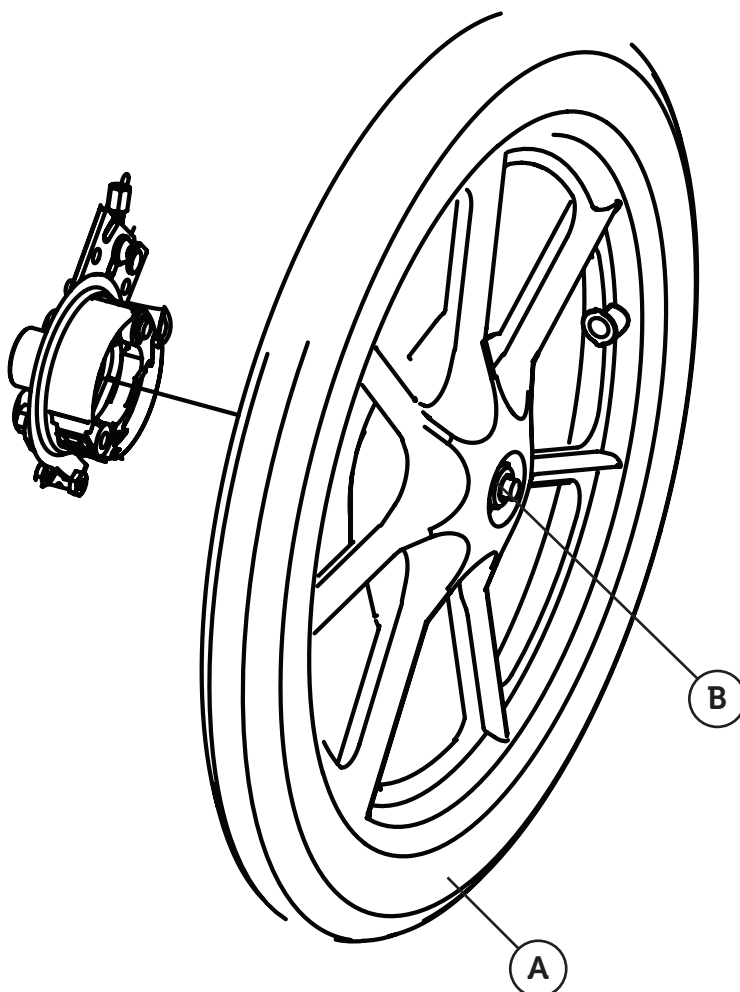

# Driving wheels

## Wheel position

Depending on the seating systems position on the chassis seatplate you can adjust the wheel horizontally to maintain a correct centre of gravity and better balance.

To adjust the wheel in the right position, release the four screws (A) underneath the wheel axle and adjust to the required depth. Secure and measure that the wheel axle is on the same depth on both sides.

16" wheels are mounted in the provided holes B + C.

20", 22" and 24" are mounted in the provided holes D + E.

For advice and help balancing the wheelchair, please contact your dealer.



### **Notice!**

*NOTE that changing the wheel position might increase the risk of tipping.*



### **Notice!**

*The screws should not be taken out completely. Just loosen them a little.*

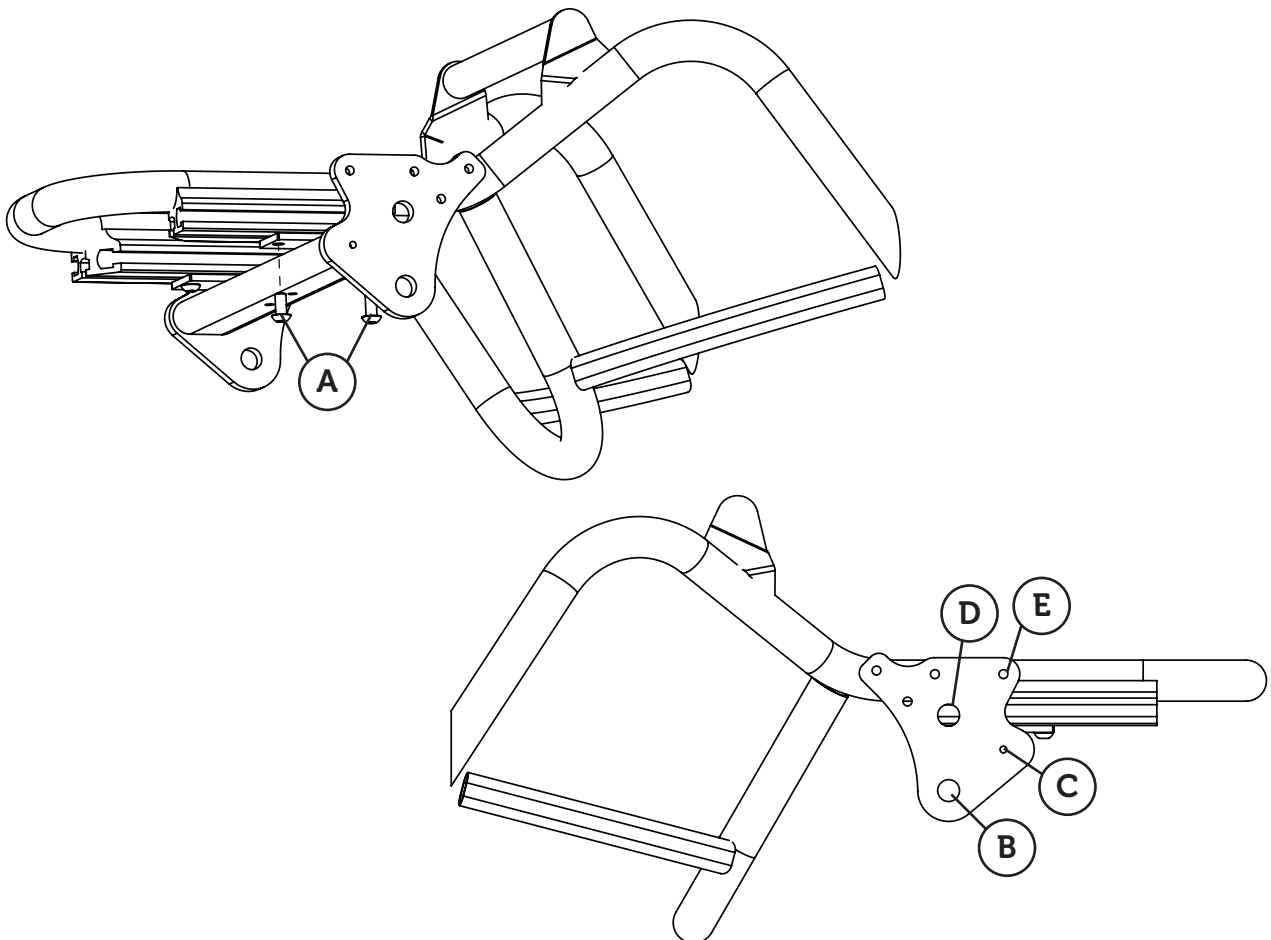

# Caster

## Installation of caster

Insert the pin (A) underneath the chassis as illustrated. Then mount the front wheel house (K) using screw (B), washer (C) and the eccentric nut (D) and tighten.

## Mounting of the caster on the caster house fork

Mount the caster (F) into one of five different positions by using the caster fork (K), the supplied axle (G), washer (H) and lock nut (I).

Place the caster (F) in the caster fork (K). Provide the axle (G) with a washer (H) and lead the axle into one of the five provided holes and the caster. Mount a washer (H), lock nut (I) on the other side and tighten. Finish by placing a nut cover (J) over the lock nut. See the picture below.

## Caster positioning

You can adjust the castors in five different height positions. This allows you to adjust the castor height after positioning the driving wheels.



### **Obs!**

*OBS! Secure that the screws is properly tighten after the adjustment.*

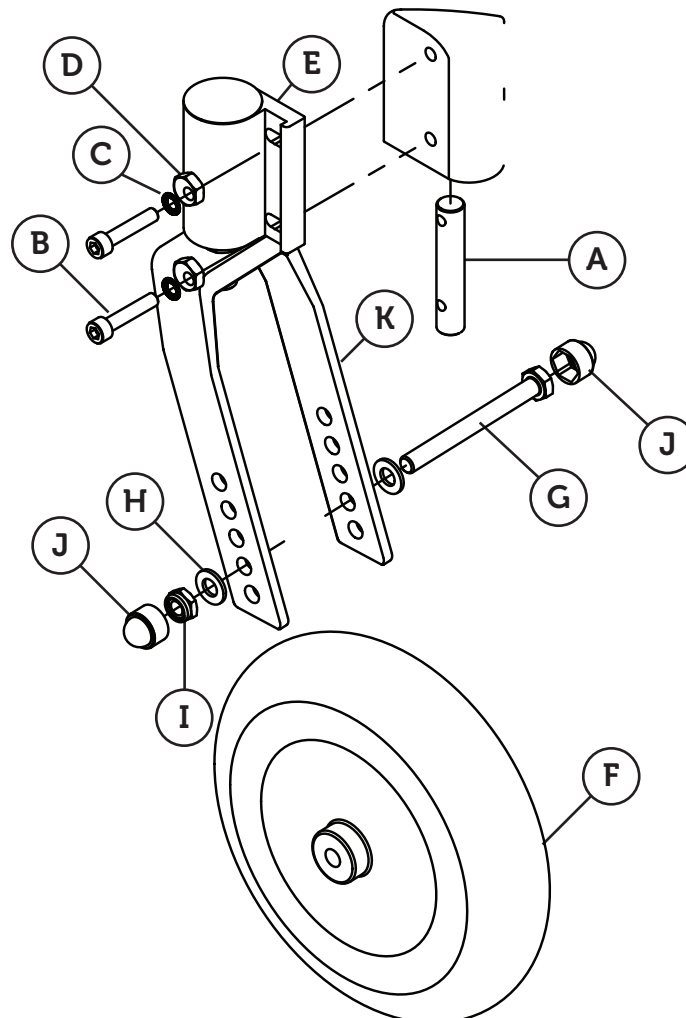

# Caster

## Caster fork position

You may need to adjust the caster fork (A) if the wheelchair doesn't roll properly. This can occur when adjusting the caster position without adjusting the caster fork (A).

Make sure that the position of the caster attachment (B) is 90° in proportion to the ground as illustrated.

## Angle adjustment of caster fork

Loosen and rotate the eccentric nuts (C) on the caster attachment (B) until the correct angle is obtained.

Tighten the screws properly after adjusting the caster fork.



### **Obs!**

*Make sure the screws are properly tightened after the adjustment.*

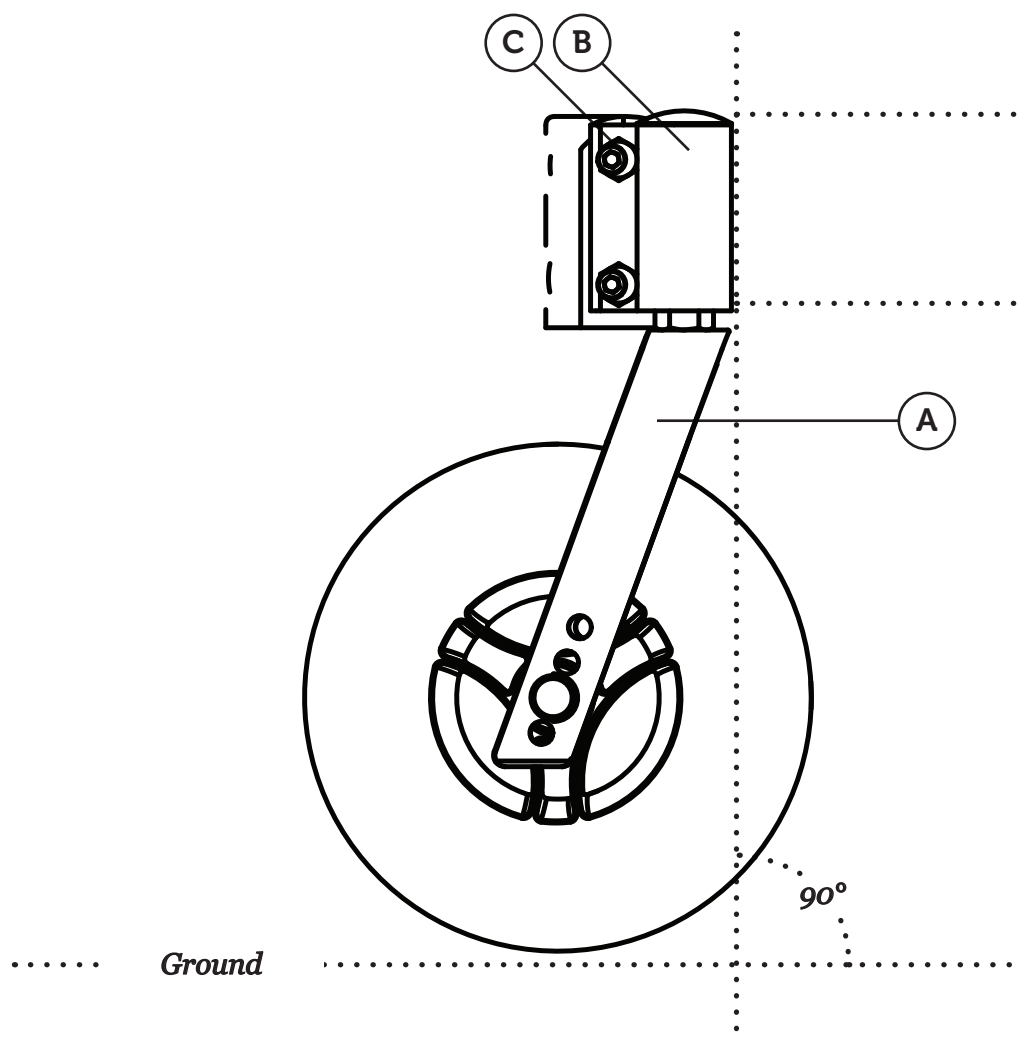

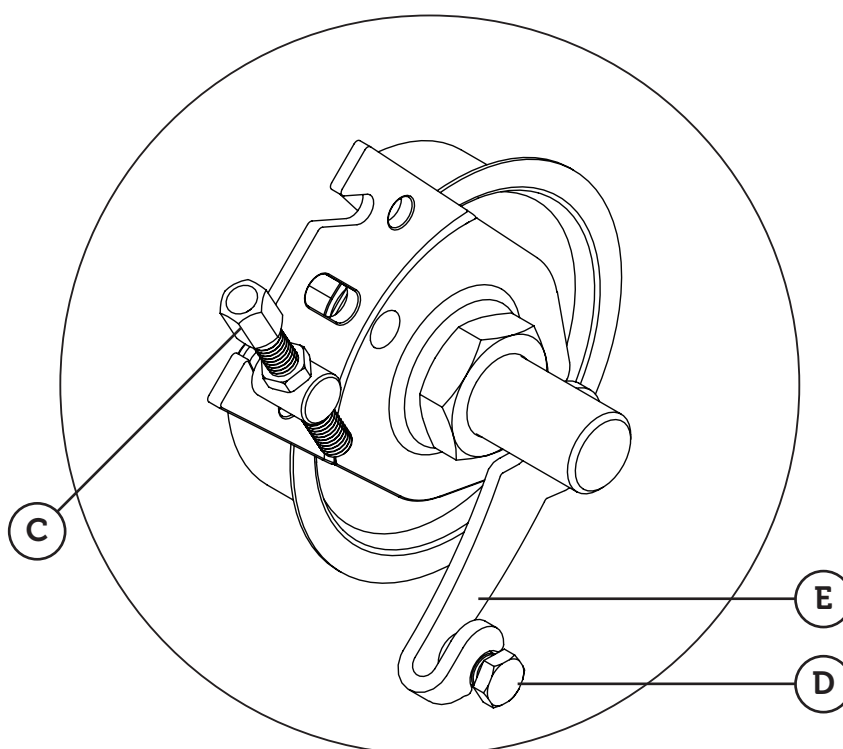
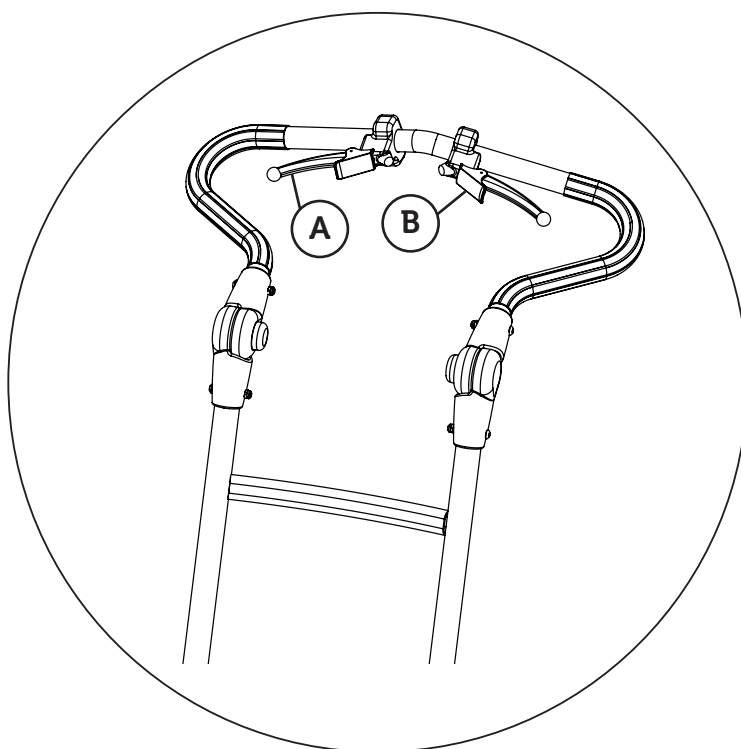

***Detailed drum brake***



# Brake

## **Drum brake**

The wheels are equipped with drum brakes that can be activated by the caretaker. Always check that the brakes are working properly before use.

Press the right brakehandle (A) while pushing the wheelchair forward. The brakehandle (A) should not be possible to press all the way to the driving handle. About 5–10 mm's should remain when brakes are set.

Repeat the procedure with the left brakehandle.

## **Setting the brakes**

Press the brakehandle (A) and push the red locking device (B) forward.

## **Releasing the brakes**

Press the brakehandle (A) and the locking device will release automatically. Then let go of the brakehandle.

## **If the brakes does not work**

Check the tension of both brakewires. If a wire has low tension, try to tens it by loosen the screw (C) and then tighten again. If the adjustment is not enough try the following quick-setup guide to re-tighten the brake cables.

- 1)**     *Tighten the screw (C) to its bottom position*
- 2)**     *Loosen the nut (D)*
- 3)**     *Squeeze the brake by lifting the drum brake arm (E) and move the nut (D) further up the wire.*
- 4)**     *Tighten the nut (D) and adjust the tension with the screw (C)*

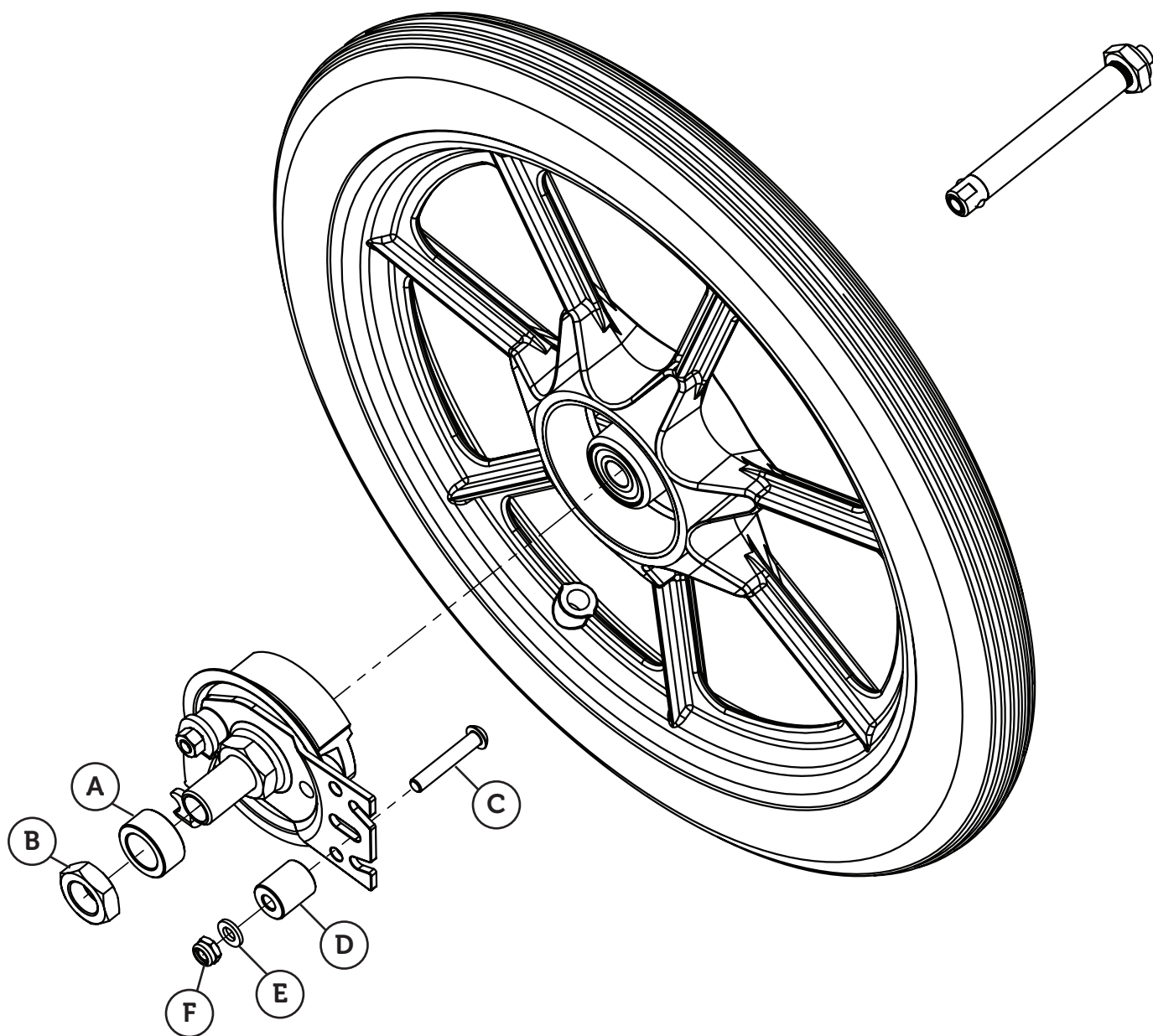

# Brake

## Installation of drum brake

You need to remove the wheel from the wheelchair to mount the drum brake. Press the button on the quick-release axle and pull the wheel and axle out from the drum brake. See page 12.

Mount the drum brakes on the chassis by threading the large distance (A) to the drum brake attachment as illustrated. Secure the large distance (A) with the large nut (B) as illustrated. It is important to not tighten too hard.

Then take the screw (C) and put it in the elliptical hole and thread the small distance (D) over the screw (C).

Fasten the screw (C) using a washer (E), nut (F) as illustrated. Tighten the both nuts (B) and (F). Make sure the drum brake is properly positioned.

Put the wheel back on the wheelchair (page 12) when the installation of the drum brake is done.



### **Obs!**

*Nut (B) (and screw C when selecting 16" wheels) has to be secured with a thread lock, such as Loctite 243 or similar.*



### **Note!**

*When selecting the 16" wheels, the screw (C) is threaded directly in the plate.*



### **Note!**

*For more information on how to use the quick-release, see page 12.*



### **Note!**

*The installation of the drum brake is the same for all wheel sizes.*

# Parking brake

## Installation of handbrake

The installation of the parking brake attachment should be installed as illustrated in the intended hole-pattern on the chassis side with the supplied screws (A), washers (B) and nuts (C).

Adjust the handbrake (D) if necessary by loosen the screws (E) and then move the handbrake forward and backwards in the track. Tighten the screws (E) when required position is reached.

## Using the handbrake

Set the handbrake (D) by pressing the handbrake arm forward. Pull the arm back to release the handbrake.

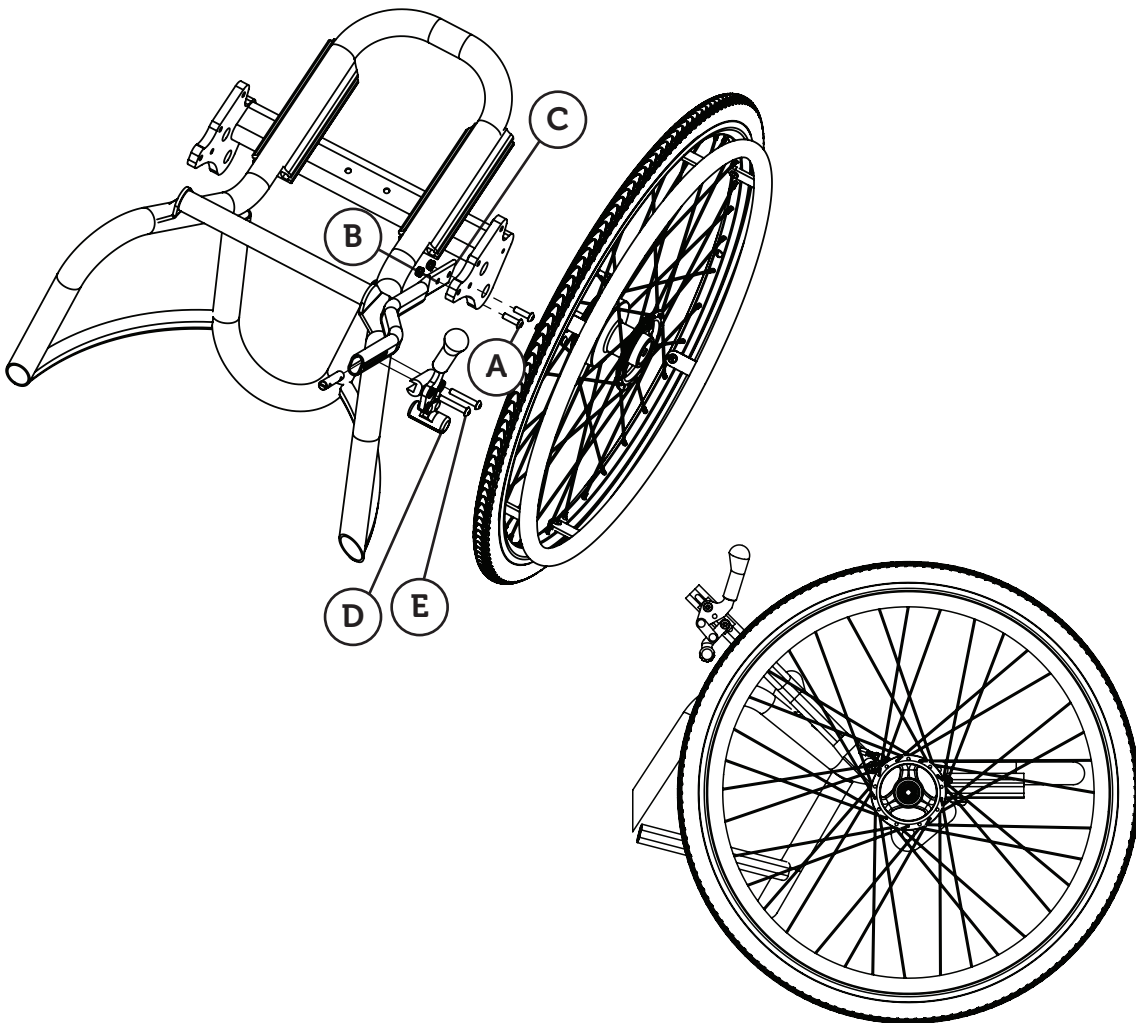

# Footrest

## Mounting of footrest

Insert the footrest attachment (A) in the front holes underneath the seatplate. There is two positions for depht adjustment. Tighten the screws (B) on both sides with washer and nuts (C).



### **Note!**

*Before installation you have to remove the seal from the seatplates. Then you can easily insert the footrest attachment.*

## Safety stop

A pin (D) is installed in the bottom of the footrest attachment. The pin can also be used to find back to a pre-set height position.

### **Tips!**

*Install an additional pin above the footrest in the footrest attachment to easily find your way back to an alternative height position (eg with or without shoes).*

## Adjusting the angle on the knee-joint

When the footrest attachment is installed to the chassis you can adjust the footrest angle at the knee-joint. Loosen the screw (E) slightly and adjust to the desired angle. Tighten the screw.

## Adjustment the height of the footrest

When the footrest attachment is installed to the chassis you can adjust the height of the footrest. Loosen the adjuster (F) and adjust to required height. Tighten the adjuster.

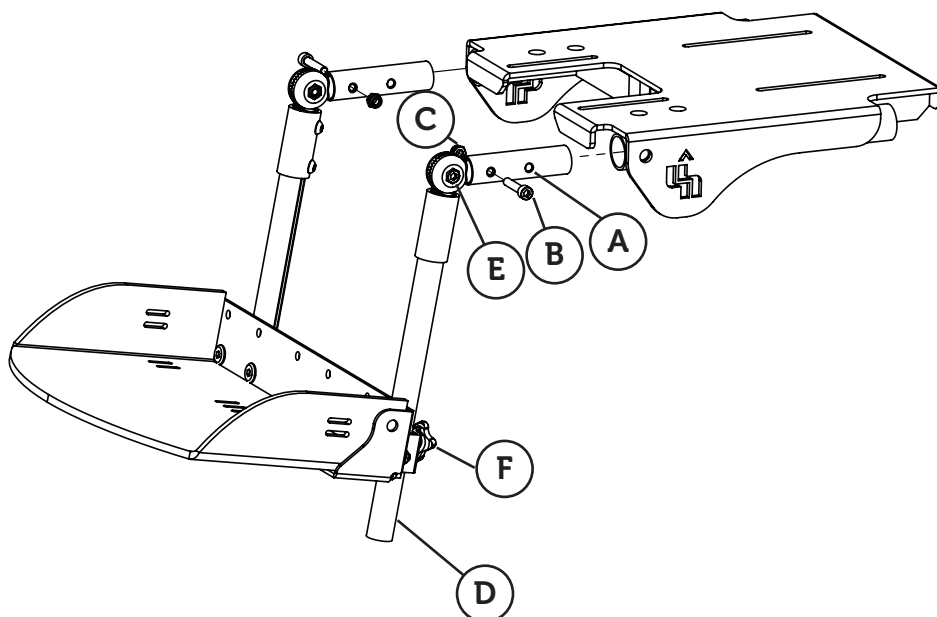

# Calf support

## Mounting of calf support

Install the calf support with the supplied screws and pins as illustrated into the footrest attachment.

## Height adjustment of the calf support

Loosen the screws (A) slightly and then adjust to the required height. Tighten the screws (A)

## Width adjustment of the calf support

Loosen the screws (B) slightly and then adjust to the required width. Tighten the screws (B)

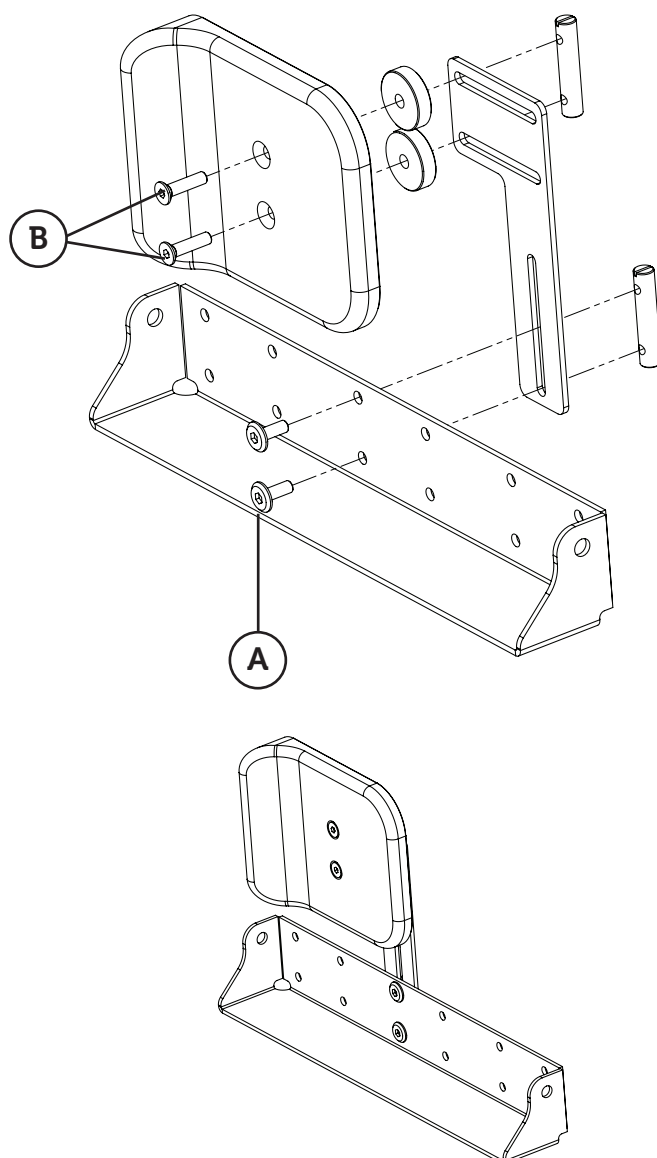

# Anti-tip device

## Installation of anti-tip device

Install the anti-tip device on the wheel axle as illustrated using the supplied screws (A), washer (B), nuts (C) and nut cover (D).

Insert the screw (A) into the holes on the anti-tip attachment and through the chassis and put a washer (B) and nut (C) on the opposite side. Tighten the screws.

Finish by placing nut covers (D) as illustrated.



### **Note!**

*Zitzi Guppy should always be equipped with anti-tip device because of its many adjustment possibilities.*

## Using the anti-tip device

The anti-tip should be used for a safer and secure usage of the chassis. It can easily be folded when not in use by carefully stepping down the anti-tip and turn it aside. When deactivating, try to step on the anti-tip so close the anti-tip attachment as possible.

Make sure to turn the anti-tip advice until you hear a click, wich indicates that the anti-tip is in its right position.

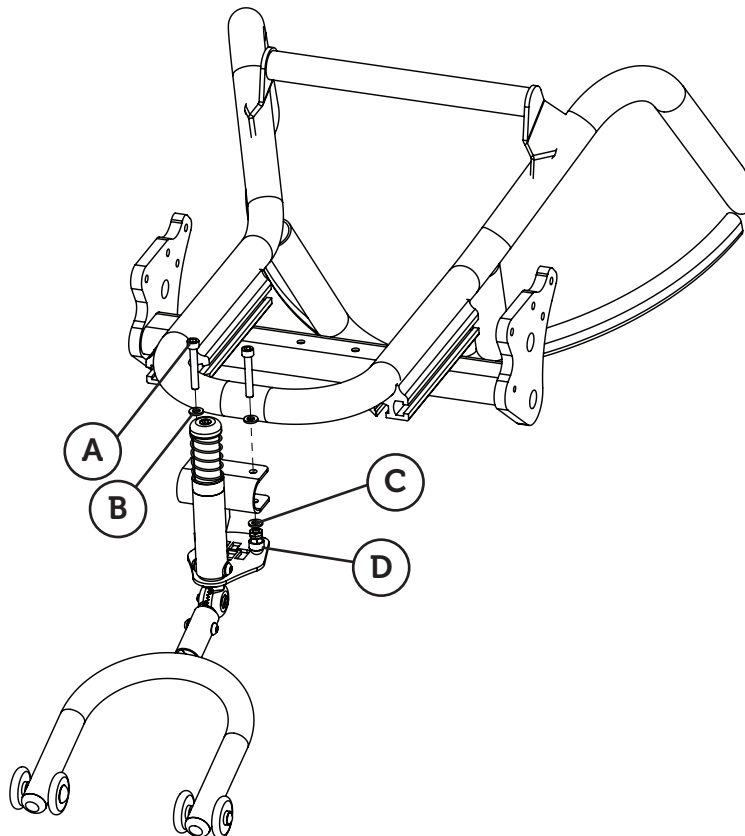

# Step bar

## Installation of the step bar

Install the step bar (A) on the inside of the chassis as illustrated. Thread the nuts in the track and lock its position with the screws (B) from the outside.



### **Note!**

*The step bar is assembled on the right side as standard.*

## Using the step bar

The step bar facilitates the raising of the chassis when it is necessary (eg. at pavements). Push the step bar with your foot while holding the driving handle and gently pull the chassis backwards to free up some space under the castors.



### **Obs!**

*It is important to hold the driving handle firmly while using the step bar.*

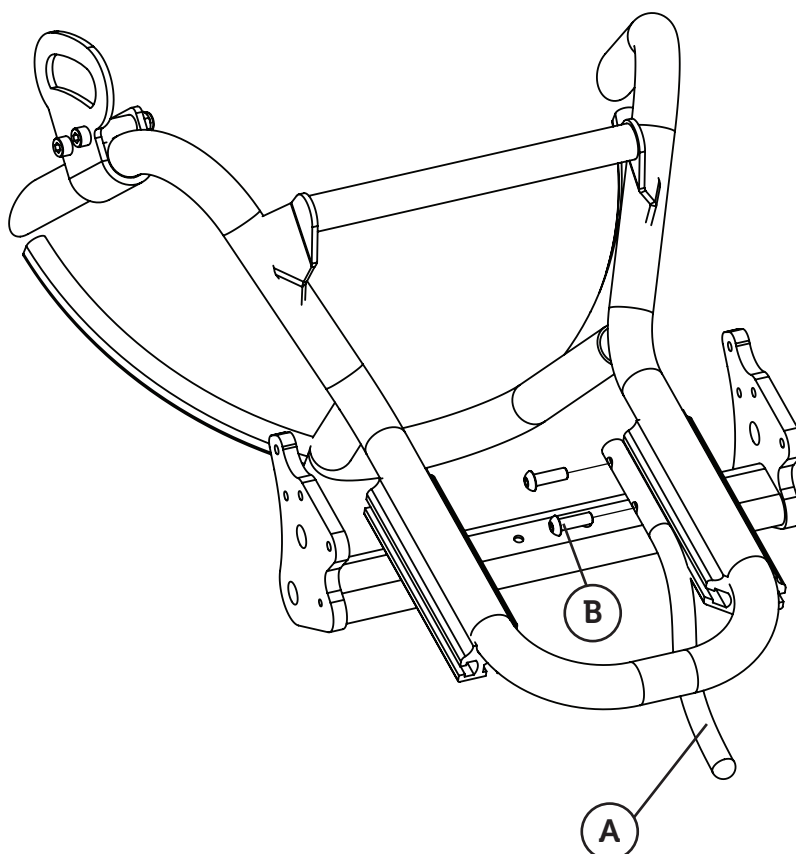



# Transportation kit

## **Installation of front bracket**

Mount the bracket with screw (A) and washer (B) to the chassis as illustrated. Do not forget to mount the distance (C) as well.

## **Installation of rear bracket**

The rear bracket shall be mounted on the outside of the profile at the rear of the chassis using the supplied screws (D), washers (E) and nuts (F) as illustrated.

## **Installation of safety-loop**

Install the safety-loop on the inside of the profile with screws (G), washer (H) and tube (I). The upper bracket is mounted at the rear of the seatplate with screws (J) and nut (K).

## **Using the transportation kit**

See "Transport in vehicle" for more information and recommendations on how to use the transportation kit safely.



### ***Check up!***

*The lock on the safety-loop should automatically lock when you fold the loop towards the upper bracket.*



### ***Obs!***

*The push-frame shall always be in contact with the seating systems back during transportation in a vehicle.*



### ***Crashtested and approved***

*Crashtested and approved according to 7176-19 for 70 kg.*



### ***Note!***

*When using the transportation kit, the angle of the chassis has to be 0°.*

## Transportation kit

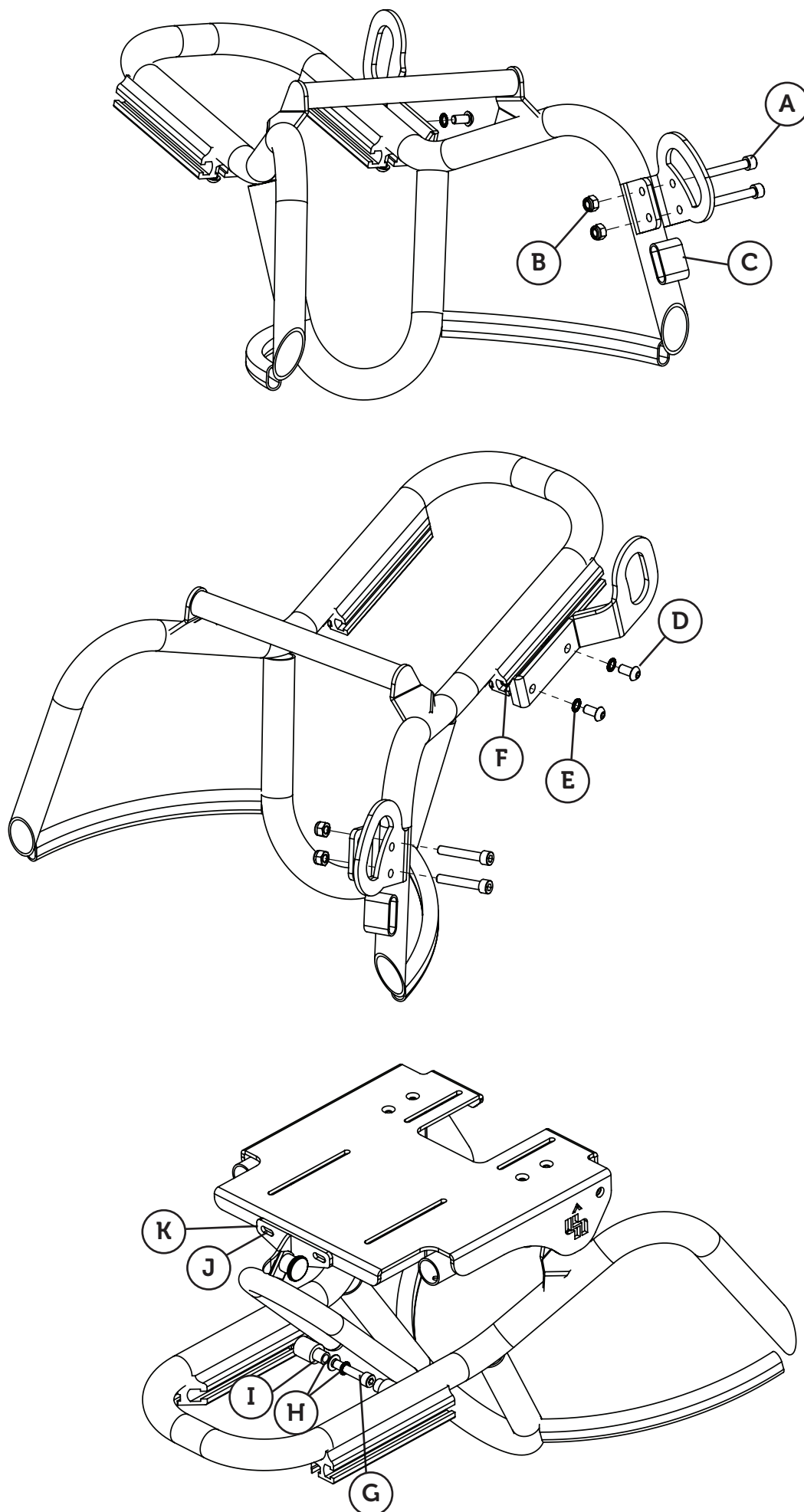

# Direction lock

## **Install the direction lock**

Mount the direction lock to the castors using the supplied details.

Start by removing the castor attachment (A) from the chassis attachment (B) by removing the screws (C). Then lift the end seal (D) from caster attachment (A) top and remove the center bolt (E).

Then mount the directional lock details (F) between the caster attachment (A) and chassis attachment (B) and between the caster attachment (A) and the caster fork (G) with the supplied details as illustrated.

When the direction lock is installed, mount the caster on the chassis again. You can adjust the direction lock by slightly adjusting screw (J).

## ***Tips!***

*For more information about installing the castors, see page 18-21.*

## **Activate direction lock**

Pull the locking pin (H) straight up and then rotate 90° and release the pin (I) into the hole in the moving part. Ensure that the direction is locked.

## **Releasing the direction lock**

Pull the locking pin (H) straight up and then rotate 90° and release the pin into the hole in the moving part. Ensure that the direction is locked.



## ***Note!***

*Direction lock fits only by choosing the 7" castors.*

## Direction lock

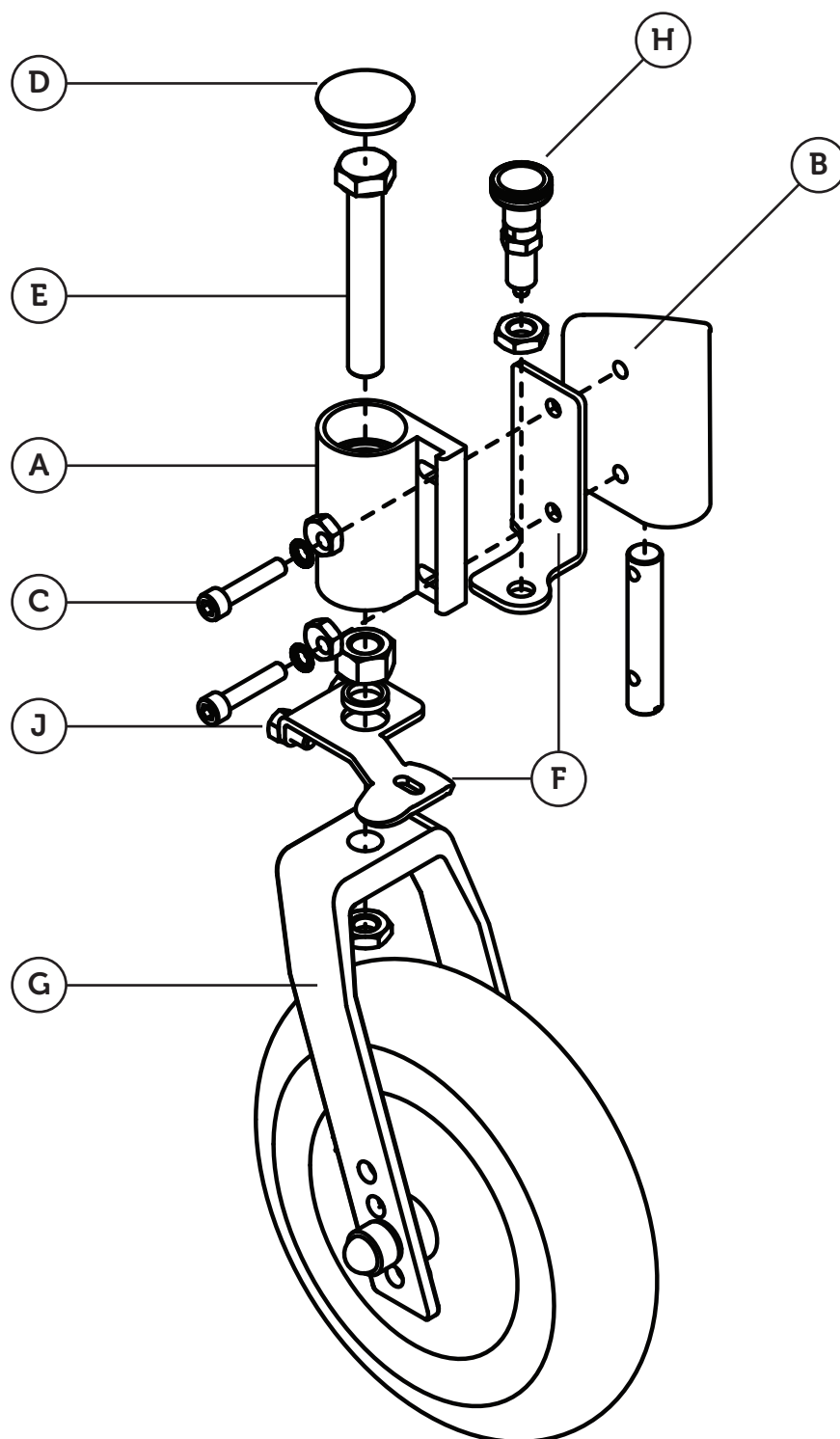

# Mudguards

## Installation of mudguards

Mount the mudguards with the supplied screws (A), the spacer (B) and nuts (C).

Loosen the wheel with the quick-release function (see page 12). Loosen the screw that holds the rotationlocker on the brake (see page 20) and then remove the spacer.

Mount the mudguards and replace the removed spacer with the supplied, shorter spacer (B).

## Adjusting the mudguard

You can adjust the mudguards in height by loosen the screws (D). Adjust to required height and then tighten the screws (D).

### ***Tips!***

*You just need to loosen the screws (D) slightly.*

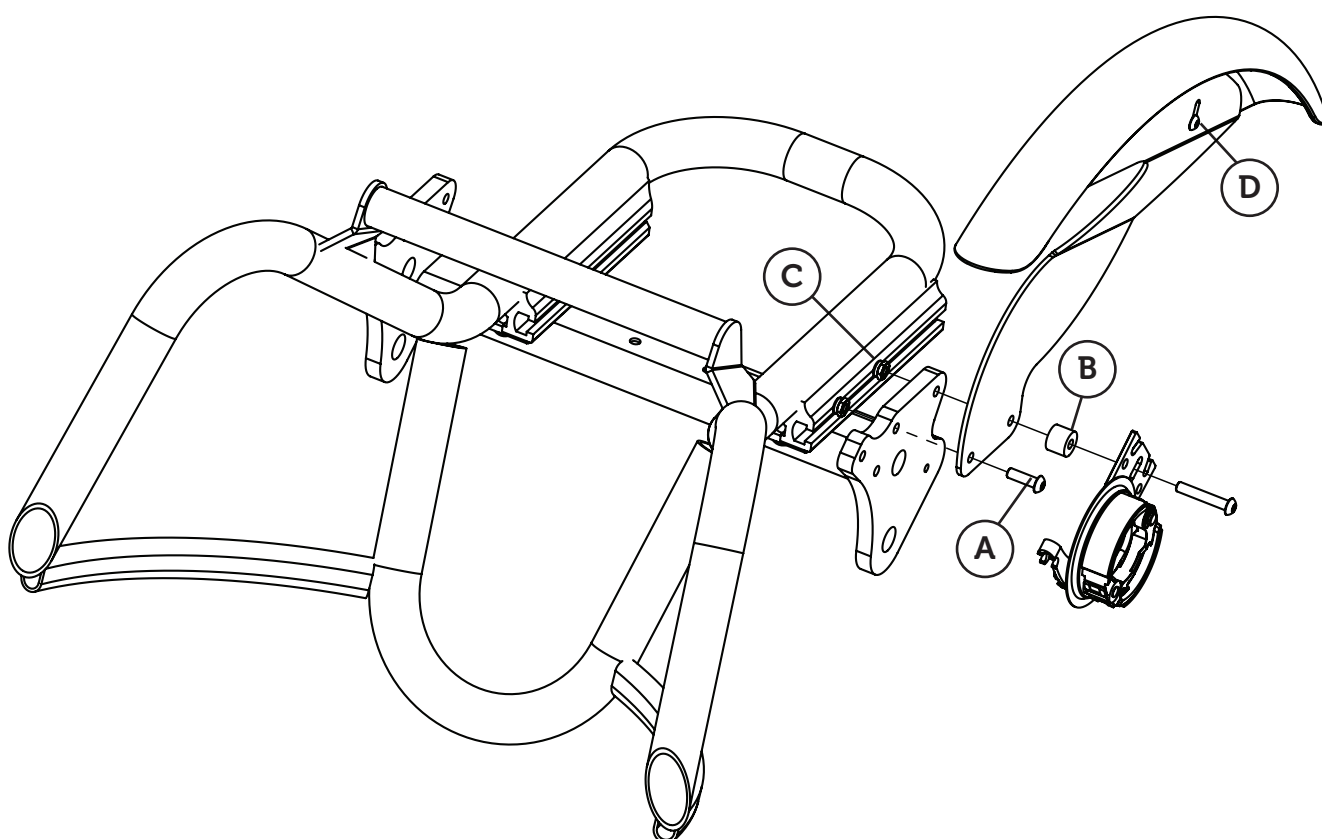

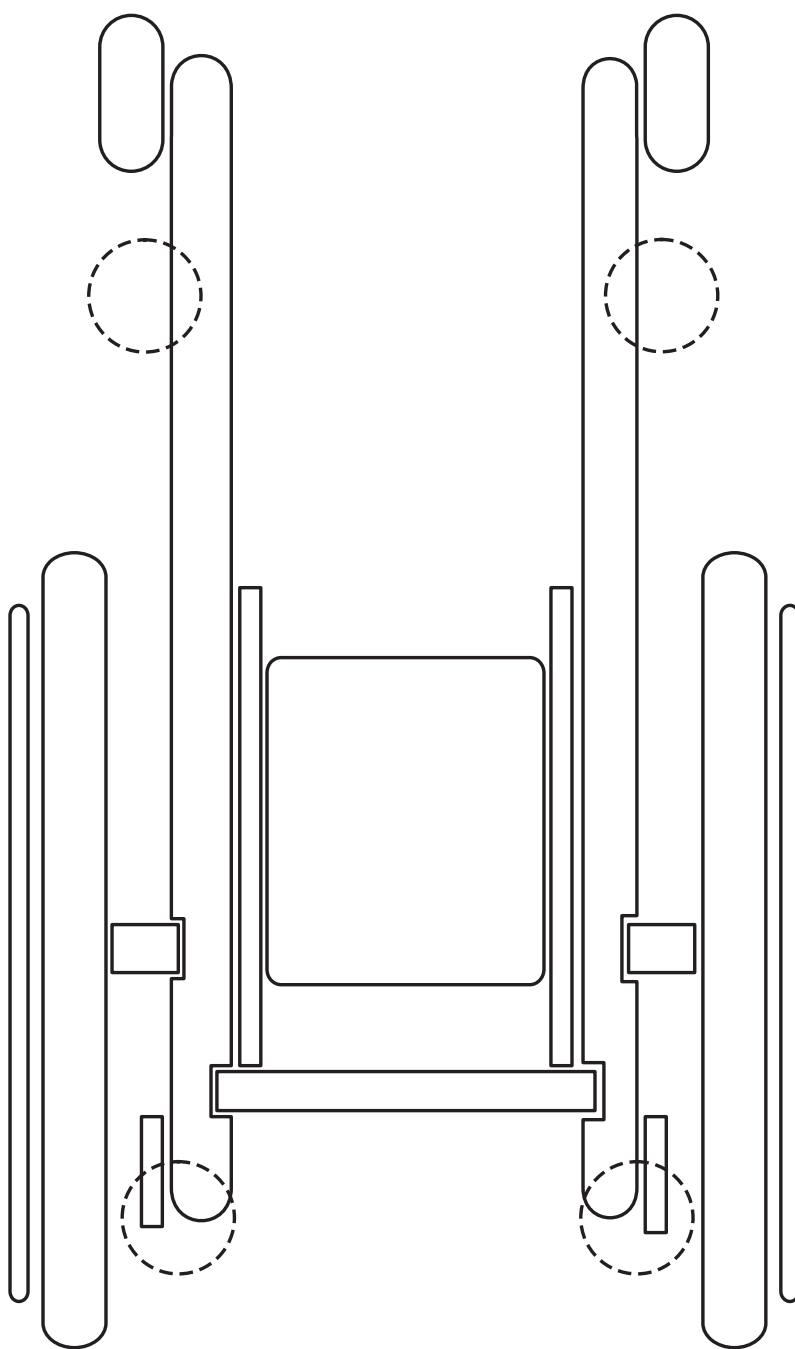

***Indication for transportation brackets***

*Guppy from above with the drive  
wheels closest to the footer*

# Transportation in a vehicle

## Guidelines for transportation in a car

Fixing shall be done with straps, approved to ISO 10542, the intended transport brackets as marked on the image description.



### ***Note!***

*It is important that you only stretch the strap to low tension.  
Over-tensing of the straps can cause the frame to become warped.*



## Crash tested and approved

is crash tested and approved according to ISO 7176-19 up to 70 kg.

### ***Note!***

*Crash test is approval valid for weights up to 70 kg.*

# Maintenance instructions

## **Service intervals**

In order for the device to work properly, regular service and inspection must be performed. The need for service depends on frequency of use and wear. Check all moving parts and fasteners for wear. Service should always be performed by professional and qualified personnel. If you are unsure, please feel free to contact Anatomic SITT AB.

## **Cleaning and washing instructions**

Plastic and metal parts can be wiped off with a damp cloth, or washed with antibacterial liquid or similar. Think green, think about the environment! Use biodegradable detergents.

***Check the condition regularly and perform maintenance when necessary.***

## **Gas piston**

Gas piston should be used regularly to maintain its function. If the product is not used, the gas piston should be activated at least once every 6 months. Further, they should be stored so that the piston rod is placed facing downward. Otherwise, the gas spring seal might break and the gas piston fail.



### ***Note!***

*Gas piston must be activated regularly*



### **Warranty**

1 year against manufacturing defects. For more detailed information about the warranty we provide, see page 49 of this manual.

### **Combinations**

Zitzi Guppy and its accessories are CE marked products that can be combined with all the accessories described in this manual. Zitzi Guppy is suitable for use together with seating systems like Zitzi Delfi Pro and Anatomic Sits. For other combinations please contact Anatomic SITT AB.

### **Spare parts**

For the CE marking of the Zitzi Guppy to be valid, the frame may only be fitted with spare parts delivered by Anatomic SITT AB.

### **Marking**

Zitzi Guppy and its accessories are CE marked products. A unique serial number is located on a label placed under the activation housing. This serial number should be quoted in any correspondence regarding the product.

### **Recycling**

A used part or product should be dismantled and discarded. The parts should be separated by material type, metal, plastic and combustibles (textiles). Gas piston is sorted as hazardous material.



### ***Notice!***

*Always check that the device is not customized when reconditioning, before it is sent to new users.*

# Reconditioning

## **Service**

Regular maintenance is important for the Guppy to function safe and properly. The need for service changes is depending on use and wear. Check all moving parts and fasteners regularly. Use original parts from Anatomic SITT AB when reconditioning the Guppy.

Work should always be done by professional and qualified staff.  
If you need support, you are always welcome to contact Anatomic SITT AB.

The need of reconditioning varies and must be judged case by case.  
Go through all checkpoints at least once per year or as needed.  
Functional control should be performed each time the Guppy is used.

## **Cleaning**

Painted surfaces, wheels, front castors and handles is cleaned with cleaning solvent. Never use paint thinner, gasoline or other solvent.

## **Finishing**

After washing, all leads, confined space and drainage holes should be blown dry and spray lubricated with thin oil.

## **Marking**

Check that the CE-marking is intact and readable. The marking is located on the tubular frame.

## **Wheels**

Make sure both castors and rear wheels are not worn and that they spin easily without noise. See page 14–21 of this manual for further information regarding wheel and caster adjustment.

## **Paint**

To prevent corrosion and touch up scratches, check for damages in the paint. If needed, touch-up paint is available from Anatomic SITT AB.

### **Stability**

Check that all the wheels are firmly on the ground and that there is no skewness in the chassis. See page 14–21 of this manual for further information about wheel and castor adjustment.

### **Tubular frame and details**

Welded and bolted joints. Grind bushings and hinges to operate without noise. Lubricate as required. Also check the knobs, screws and other mounting parts. Replace them if necessary.

### **Forks**

Ensure that the fixings and bearings no play and they turn easily. Lubricate the front forks when needed.

### **Driving bow and push-handle**

Make sure the padding and handles are secure and that the push-handle is ‘adjustable in height. Also check the condition of the knob and screw.

### **Brakes**

Check that the drum brake and parking brake are working properly. Additional information about the brakes, see page 22–27 of this manual.

### **Folding mechanism and tilt**

Make sure that you can easily fold back tube and push bar and that it's easily to tilt the unit. See page 8–9 for more information about the tilt.

### **Function control**

Function control means that you go through wheels, stability, brakes, push handle and push bar.



### ***Notice!***

*Always check that the device is not customized when reconditioning, before it is sent to new users.*

# Adaptation and customization

## **Guidelines and recommendations**

Every time the Zitzi Guppy is altered in some way, an assessment has to be made to determine if it is an adaptation or a customization.

An adaptation is any change made in comprehension of the CE mark. All other changes are customizations. Adaptations must only be made by a person deemed to be qualified for the task and should always be made in a professional manner. The CE mark means that the product fulfils all of the essential European safety requirements.

## **Risk assessment**

Note that a risk assessment always should be done for an adaptation as well as for a customization of a medical aid. The product must never become dangerous to use after adaptation.

The product should be fitted with a note that it is adapted to a specific user, so that it cannot be mistaken for a standard model product.



### ***Note!***

*The CE-mark is no longer valid if the product is customized.*

# Terms of sale

## **Warranty**

Warranty against manufacturing errors is valid for one (1) year from delivery date. Warranty is void if the product has been subjected to external factors or rough handling. It's required that the faulty product is returned for us to process a warranty claim. Always attach the packing slip of the original delivery.

## **Warranty claims**

Describe the error and the possible cause for this as thoroughly as possible. Claim repairs or possible replacement under warranty. Always attach a copy of the invoice and state that the product should be returned to you after repairs. Provide a shipping address, a contact person and a phone number.

Make sure that you pack the product well to protect it from shocks during the transportation. Note the shipping number in your documentation. This is so that you can track the shipment should anything occur during transport.

## **Returning products**

In the event of faulty orders or deliveries, the products should be returned within 20 days from delivery. Always attach a copy of both the packing slip and the invoice. Provide your reason for returning the products.

Make sure that you pack the product well to protect it from shocks during the transportation. Note the shipping number in your documentation. This is so that you can track the shipment should anything occur during transport.

## **For products returned more than 20 days from delivery**

*a refund is made of 80% of the invoice value*

## **For products returned more than 60 days from delivery**

*a refund is made of 60% of the invoice value*

## **For products returned more than 150 days from delivery**

*a refund is made of 40% of the invoice value*

## **For products returned more than 360 days from delivery**

*no refund is made for the products*

## **⚠ Customized products cannot be returned**

# Customer service

## Scandinavia

### Anatomic SITT AB

Box 6137, SE-600 06 Norrköping  
Stohagsgatan 26, SE-602 29 Norrköping  
Tel. +46 11 161800, Fax +46 11 162005  
Email [info@anatomicsitt.com](mailto:info@anatomicsitt.com)

SE

### Anatomic SITT A/S

Viengevej 4, DK-8240 Risskov  
Tel. +45 861 701 74, Fax +45 861 701 75  
Email [a-sitt@anatomic-sitt.dk](mailto:a-sitt@anatomic-sitt.dk)

DK

### Bardum A/S

Håndverksvein 8, N-1405 Langus  
Tel. +47 64 91 80 60, Fax +47 64 91 80 66

NO

### Handico Finland OY

Asemanaukio 7, FIN-04200 Kerava  
Tel. +358 331 222 700, Fax +358 331 222 710  
Email [handico@handico.fi](mailto:handico@handico.fi)

FI

## Europe

### Anatomic SITT Nederland BV

Sir Rowland Hillstraat 1C, NL-4004 JT Tiel  
Tel. +31 344 63 45 40, Fax +31 344 62 33 61  
Email [informatie@anatomicsitt.com](mailto:informatie@anatomicsitt.com)

NL

### Be Independent Ltd

St Luke's Road G'Mangia PTA MLT-1027  
Tel. +356 214 662 66, Fax +356 214 656 70

MLT

### Consolor Ltd Unit A3

The Forelle Centre, Black Moor Road, Ebblake  
Industrial Estate, Verwood, Dorset, BH31 6BB  
Tel. +44 120 282 76 50, Fax +44 133 273 02 33

GBR

### HandiTech Scandinavian Reha Aids Center

11 G Seferi Str. GR-542 50 Thessaloniki  
Tel. +302 310 324 114, Fax +302 310 324 054  
Email [info@handitech.gr](mailto:info@handitech.gr)

GR

### Invaru Ltd

Peterburi tee 14A, EST-114 11 Tallin  
Tel. +372 621 25 82, Fax +372 638 08 78

EST

### MMS Medical Ltd

51 Eastgate Drive, Little Island, Cork  
Tel. +353 021 461 8000, Fax +353 021 461 8099

IRL

### Mobilitec

Rua dos Verdes 123, PRT-4470-658 Pedras  
Tel. +351 229 436 130, Fax +351 229 436 139

PRT

FR

### OX Orthopédix

27 rue François Gillet, FR-42400 St. Chamond  
Tel. +33 477 195 994, Fax +33 426 303 789

IT

### Ortopedia Castagna Centro Tecnico

Via Ghislanzoni 18/B, IT-23900 Lecco  
Tel. +39 341 362 671, Fax +39 341 360 931

CH

### Rehatec AG

Ringstrasse 15, CH-4123 Allschwill  
Tel. +41 614 879 911, Fax +41 614 879 910

IS

### Stod Hf Stoaekjadmíðin

Tronuhræn 8, IS-220 Hafnarfjörður  
Tel. +354 565 2885, Fax +354 565 1423

GR

### Scan Ideal

28, Tzavela Str. GR-542 49 Thessaloniki  
Tel. +302 310 320 150, Fax +302 310 350 151

SVN

### Team Nova Reha

Grecja vas 33, SVN-2288 Hajdina  
Tel. +386 278 201 06, Fax +386 278 201 06

ES

### Via Libre Fundosa Accesibilidad

Don Ramon de la Cruz 38, ES-28001 MADRID  
Tel. +34 911 213 031, Fax +34 911 213 025

## Asia Pacific and Middle East

UAE

### Al Safwa Mobility LLC (ASM)

Al Falah Street Harley Davidson, 2001, Abu Dhabi  
Tel. +971 264 242 62, Fax +971 264 242 63  
Email [info@alsafwamobility.ae](mailto:info@alsafwamobility.ae)

AUS

### Paediatric Mobility Equipment

Po Box 1118, Young, AUS-NSW259  
Tel. +61 1300 131 884, Fax +61 1300 884 010  
Email [sales@paedmobility.com.au](mailto:sales@paedmobility.com.au)

NZL

### Cubro Rehab

PO Box NZL-9144, Tauranga  
Tel. +64 757 78 816, Fax +64 757 78 827

ISR

### Special needs for Special children

48 Mordey Hagetaot St. Beer Sheva, ISR-84840  
Tel. +972 8 62 875 85, Fax +972 862 819 61

MYS

### The Gym & Care

1F-23 & 24, IOI Business Park, MYS-47100 Puchong  
Tel. +603 8070 9166, Fax +603 8073 9166  
Email [info@gymncare.com](mailto:info@gymncare.com)

# Technical data

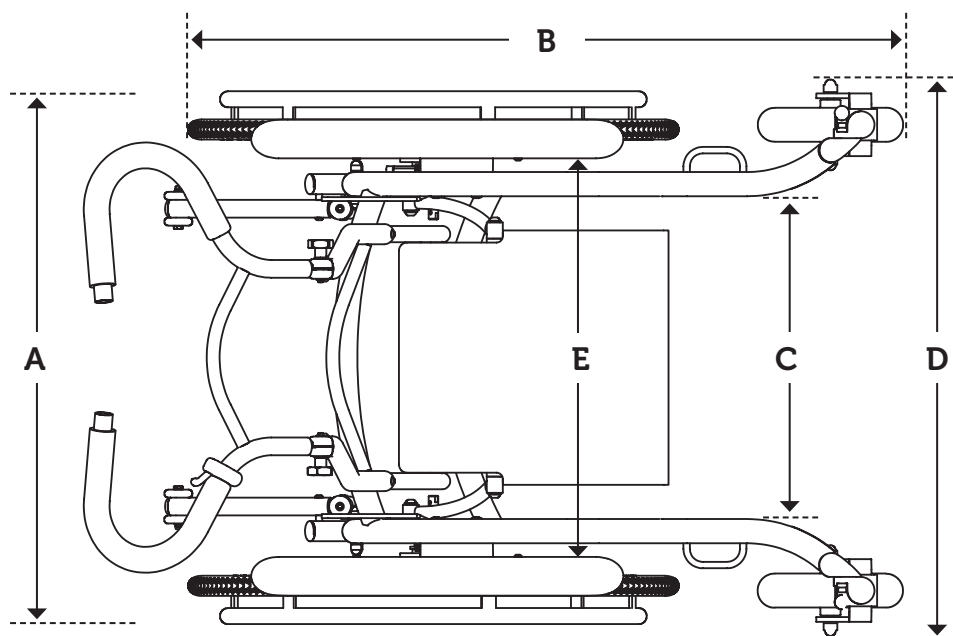

with 16" wheels (6" casters)

Size	Tilt	Seat height	Weight	A	B	C	D	E
Size 1	0-32°	46 cm	14 kg	51 cm	67-73 cm	41 cm	57 cm	41 cm
Size 2	0-32°	46 cm	14 kg	56 cm	67-73 cm	41 cm	57 cm	46 cm

with 20" / 22" / 24" wheels (6" casters)

Size	Tilt	Seat height	Weight	A	B	C	D	E	E with mud flaps
Size 1	0-32°	46 cm (20")	15 kg	57 cm	71-82 cm	41 cm	57 cm	43,5 cm	39,5 cm
Size 2	0-32°	46 cm (20")	15 kg	62 cm	71-82 cm	41 cm	57 cm	48,5cm	44,5 cm

The total length of the chassis change depending on location and wheels.  
C measurement is taken at the height of castor house.

**SE**

**Anatomic SITT AB (manufacturer)**

Box 6137, SE-600 06 Norrköping

Tel +46 11-16 18 00

Fax +46 11-16 20 05

Support +46 11-16 18 05

**Visiting adress**

Terminalgatan 1, SE-603 61 Norrköping

**DK**

**Anatomic SITT A/S**

Viengevej 4, 8240 Risskov, Denmark

Tel +45 86 17 01 74

Fax +45 86 17 01 75

**NL**

**Anatomic SITT Nederland B.V.**

Postbus 6027 / 4000 HA Tiel, The Netherlands

Tel +31 344 63 45 40

Fax +31 344 62 33 61

*World wide*

[anatomicsitt.com](http://anatomicsitt.com)

[info@anatomicsitt.com](mailto:info@anatomicsitt.com)

[facebook.com/anatomicsitt](https://facebook.com/anatomicsitt)

[youtube.com/anatomicsitt](https://youtube.com/anatomicsitt)

