

CHD602P card reader with keypad

User Manual

1. Introduction

CHD602P keypad EM card reader is nice appearance, stable performance, and is with keypad and wiegand output, The communication agreement of it is compatible with HID5355K high-performance card reader. The reader is also used as accessorial device of the access controller which is outside connected with a HID5355K card reader.

CHD602P/PM card reader is with powerful functions, it supports to open doors by password, reading card, card+password, ID+password etc, in addition, it is featured with easy wire-installation, quick reaction, flexible keypad, simple operation, etc.

1.1.1 Appearance

Picture as below



Size (H×W×T): 106mm×120mm×24mm Weight: about 170g

1.1.2 Wiegand output interface

Connect the outside controller to send card number by wiegand output interface, the wire definition as below:

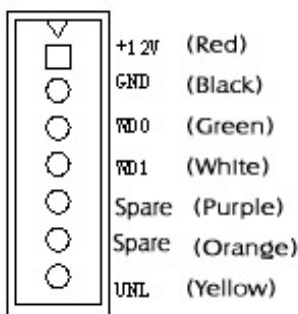

Chart 1 (7 pin socket signal definition)

1 (Red)	2 (Black)	3 (Green)	4 (White)	5 (Purple)	6 (Orange)	7 (Yellow)
+12V	GND	WD0	WD1	Spare	Spare	UNL

UNL:signal for door-opening, connect the N.O port of door-opening relay

Chart 2 (RJ45 socket signal definition)

1 (White)	2 (Orange)	3 (White green)	4 (Blue)	5 (White Blue)	6 (Green)	7 (White Palm)	8 (Palm)
WD0	WD1		GND	+12V			

1.1.3 LED indicator

When power on, green light is on until 2seconds later, green light is on when swipe card., when illegally card-swiping, red light is on.

1.1.4 Speaker

Speaker is dings one time when swipe card.

1.2 Technical Parameter

Working Voltage: 9Vdc~12Vdc; Work Current: ≤100mA

Distance: 50~100mm (depending on the card quality)

Transmitting distance: less than 30m;

Working frequency: 125KHZ

Supporting card kind: different kinds of EM cards (like: thickness card, thin card etc)

1.3 Operation Illustration

1.3.1 Swipe card

When read on EM card reader, it can be saw the green light of keypad is shining, speaker shouts one time, send wiegand signal samely

1.3.1 Keypad(keypad is output at 4BIT)

Keypad Number: 0, 1, 2, 3, 4, 5, 6, 7, 8, 9, *, #

Output Value: 0, 1, 2, 3, 4, 5, 6, 7, 8, 9, 0xA, 0xB

When swipe card on card reader, input password+# to confirm within 5seconds,it will give open door signal when confirmed the password is correct.

2 Installation

2.1 Environmental Requirement

1. No electric conduction dust, no corrosion mental and no destructive insulated gas
2. Avoid to use on the condition of water and foggy
3. Work environment: -10~50 °C20~90%
Storage environment: -20~60 °C20~90%

2.2 Check out

Open the package, if there is any damage,please inform the manufacturer immediately, please check the shipping list if everything is full.

2.3 Installation

Picture as below

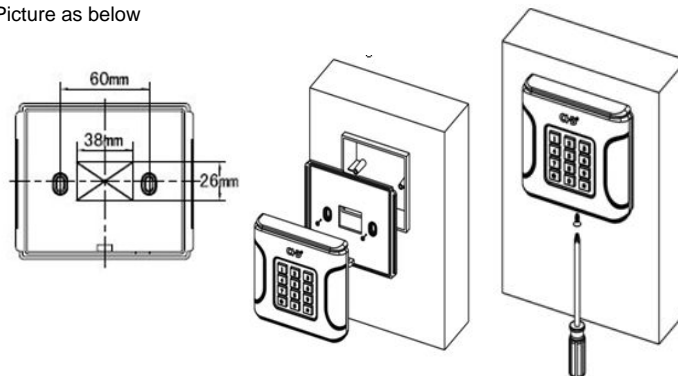

- Step 1:select the installation place according to the elevation
- Step 2.open the outlet hole of installation place, also open 2pcs 6mm fixed stuff.
- Step 3.have bottom cap fix ed on wall
- Step 4.make RJ45 est, tighten the body, fix screws, finish installation.

2.4 Wire Connection

1. connect the 7pin socket to wiegand output interfact,RJ45 interface on the other side. please refer to the controller wire connection manual when connect access controller

3 Maintenance

1. Do not detach the card reader by yourself, which avoid to damage the internal components

Appendix toxic and harmful substance or element characteristic chart

Name	toxic and harmful substance or element					
	Pb	Hg	Cd	Cr ⁶⁺	PBB	PBDE
Component	×	○	○	○	○	○
○ it shows the content of toxic and harmful substance is under SJ/T-11363—2006 rule, X it shows the content of toxic and harmful substance is over SJ/T-11363—2006 rule,						
Emerson is always committing himself to design and manufacture friendly-environment products, we are trying lastingly ongoing study to reduce and eliminating toxic and harmful substance of products, the following components which contain toxic and harmful is because we couldnt slove subject to the current technic limit.						

Emerson Network Power Com., Lit

Post code: 518057 Website: www.emersonnetworkpower.com.cn

Service Line: 4008876510 E-mail: service@emersonnetwork.com.cn