

Thank you for choosing this product.

Before using the system, be sure to read this manual carefully. In particular, be sure to read the "Important Safety Instructions".

After reading this manual, store it in a convenient place.

Important Safety Instructions

Before using the system, be sure to read these "Important Safety Instructions".

This document contains illustrations in order to ensure the safe use of this product as well as to prevent harm to the user and damage to personal property.

The illustrations and their meanings are as described below.

Warning This refers to a hazard or unsafe procedure or practice which can result in severe personal injury or death.

Caution This refers to a hazard or unsafe procedure or practice which can result in personal injury or product or property damage.

Warning

- Do not use when wet. Inserting this product into the PC card slot when there is water or other such fluids on it could result in malfunction, electric shock or fire outbreak.
- Do not disassemble or modify the product. Doing so may cause electric shock or fire.

Caution

- When touching the PC card during operations such as insertion or removal, first discharge any accumulated static electricity to ground (through an earthed metallic device etc.) before touching the unit.
- Do not place the product in places prone to static electricity.
- Do not shake or cause shock to the device, nor remove from the card slot while it is still reading or writing data. Doing so could cause data corruption or loss.
- Do not use or store in places prone to vibration or shock, in direct sunlight, in places with high levels of dust, humidity or drastic temperature variations, or near strong magnetic fields such as speakers etc.
- Do not place the card in trouser pockets etc. Doing so places pressure on the device when one is sitting down etc., and may lead to damage.

Precautions for Use

- Do not drop the card or subject it to strong shocks.
- On transferring the device from low temperature to a higher temperature, allow some time for it to reach the temperature of the new surroundings before starting use. Abrupt changes in temperature or humidity may cause internal condensation and lead to malfunctioning.
- We do not undertake data recovery operations for this product. Take regular backups of vital data to other media, such as MO disks, hard disk etc.
- Please be informed that we shall not be responsible for any loss arising from damage or loss of data pertaining to this product.
- Since this uses flash memory, it has a limited life. Data recording and reading becomes difficult over a period of time of usage. In that case, please procure a new device.
- Due to modifications, specifications for this product, design and user manual contents are subject to change without notice.

1

Product Functionalities

This product can be set into Intelligent Controller to save cut-off data as a backup file.

Since the backup files are output in CSV format, the user can read the PC card from a personal computer, thereby enabling one to process or print the cut-off data using commercially available spreadsheet software etc.

2

Setting the PC Card

Open the storage outlet on the front surface of the Intelligent Controller, and firmly insert the card fully into the card socket in the direction displayed in the illustration on the right.

Memo

- The card does not get set properly if it is not facing correctly or if it is inserted at an angle. Insert the PC card so that **the front of the card is on the left side**.
- When set correctly, a quick sound is emanated.

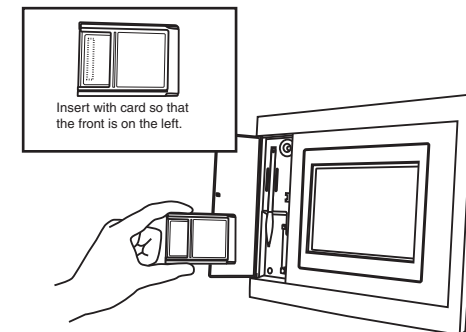

3

Removing the PC Card

To remove the card from the Intelligent Controller's PC card socket, press the Remove button as shown in the illustration on the right.

Memo

A quick sound is emanated when a set card is removed.

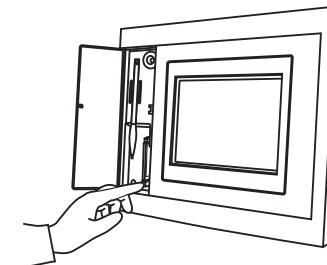

4

Data Backup Method

The [Backup] and [Restore] buttons of the [Cut-off/Data backup] menu (Main 2/Sub 4) become enabled when a PC card is inserted in the Intelligent Controller.

For the actual procedure, please refer to the Intelligent Controller Operation Manual.

5

CSV File Format

CSV files are output in the following file-name format:

YYYYMMDD-YYYYMMDDn.CSV

Accounting initiation year/month/date

Accounting closure year/month/date

File No.
In case multiple files with identical accounting period initiation/closure dates exist, numbers 1, 2, 3...9 are allotted.

Header portion

- 1) Distribution ratio calculation method
Character string "Simple normal distribution mode" or "Simple thermostat ON distribution mode"
- 2) Period
Accounting period initiation month/date and time, closure month/date and time
(Format: 199Months99Days99Hrs)
- 3) Adaptor-wise pulse counts and distribution group number (Main unit and adaptors 1-7)
Power 1 (Regular hours, Out of hours, and Special days), Power 2 (Regular hours, Out of hours, and Special days), Gas (Regular hours, Out of hours, and Special days), Distribution group number of Power 1, Distribution group number of Power 2, Distribution group number of gas

Data portion

As regards the indoor units data, the data in the table below is constantly output in comma-separated format for the maximum number of indoor units (256 units).
For the system that does not have indoor units, the adaptor number=0 and only a comma is generated as output.
In lines 1 and 2, an item-wise heading (Main item, Sub item in the table below) is generated as output.

No	Main item	Sub item	Range	Comments
1	Adaptor No.	-	0 to 7	0 signifies the Intelligent Controller main unit.
2	Link No.	-	1 to 2	1: LINK 1, 2: LINK 2
3	Unit key	-	(Optional)	(for internal system processing)
4	Central control address	-	1 to 32, undetermined	
5	System address	-	1 to 32	31 and 32 to be used only in case of local adaptors
6	Unit address	-	1 to 64	
7	Product type	-	PAC, GHP, HOT	HOT is set by the Intelligent Controller.
8	Model	-		Indoor unit model
9	Indoor unit function [kW]	-	0.0 to 999.9	Values if modified by the Intelligent Controller
10	Electric heater Yes/No	-	0/1	Presence of electric heater Yes (1)/No (0)
11	Unit name	-	maximum 12 characters	
12	Tenant No.	-	1 to 128	
13	Tenant name	-	maximum 20 characters	
14	Distribution group	-	1 to 8	
15	Blast thermostat ON (minutes)	Regular hours	0 to 3932159	
16		Out of hours	"	
17		Special days	"	
18	Strong blower thermostat ON (minutes)	Regular hours	"	
19		Out of hours	"	
20		Special days	"	
21	Light blower thermostat ON (minutes)	Regular hours	"	
22		Out of hours	"	
23		Special days	"	
24	Blast thermostat OFF (minutes)	Regular hours	"	
25		Out of hours	"	
26		Special days	"	
27	Strong blower thermostat OFF (minutes)	Regular hours	"	
28		Out of hours	"	
29		Special days	"	
30	Light blower thermostat OFF (minutes)	Regular hours	"	
31		Out of hours	"	
32		Special days	"	
33	Heater ON (minutes)	Regular hours	"	
34		Out of hours	"	
35		Special days	"	
36	Adaptor usage Yes/No	Main unit	0/1	Distribution group allocation Yes (1)/No (0)
37		Adaptor 1	"	"
38		Adaptor 2	"	"
39		Adaptor 3	"	"
40		Adaptor 4	"	"
41		Adaptor 5	"	"
42		Adaptor 6	"	"
43	Adaptor 7	"	"	
44	Intra-group power distribution ratio [%]	Regular hours	0.00 to 100.00	
45		Out of hours	"	
46		Special days	"	
47	Power consumption [kWh]	Total time	"	
48		Regular hours	0	
49		Out of hours	"	
50	Intra-group gas distribution ratio [%]	Special days	"	
51		Total time	"	
52		Regular hours	0.00 to 100.00	
53	Gas consumption [m3]	Out of hours	"	
54		Special days	"	
55		Total time	"	
56	Gas consumption [m3]	Regular hours	0	
57		Out of hours	"	
58		Special days	"	
59	Gas consumption [m3]	Total time	"	

Memo

- Standard commercially available CF cards cannot be used on the Intelligent Controller. The [Backup] and [Restore] buttons of the [Cut-off/Data backup] menu (Main 2/Sub 4) do not become enabled if such a card is inserted.
- When processing with commercially available spreadsheet software, ensure that the data has first been copied to a separate folder in the computer before conducting operations. Avoid directly processing the original data inside the PC card.

6 Specifications

• Operating temperature range
5 to 40°C

• External dimensions

CF card dimensions diagram

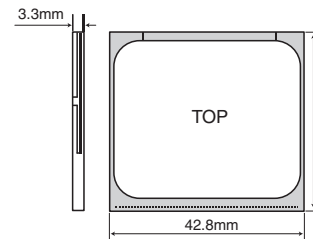

Dimensions diagram when CF card is mounted on the PC card adaptor

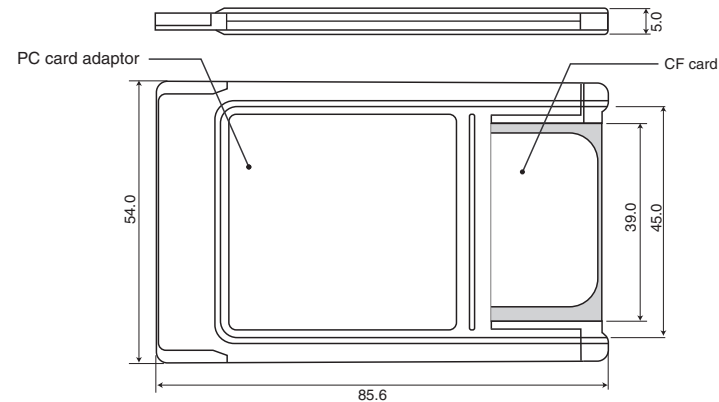

Authorized representative in EU
Panasonic Testing Centre
Panasonic Marketing Europe GmbH
Winsbergring 15, 22525 Hamburg, Germany

Printed in Japan
85464609075011