

Wireless Audio Adapter

User's Manual

ABOUT THIS MANUAL

This manual is designed for use with the Wireless Audio Adapter. Information in this document has been carefully checked for accuracy; however, no guarantee is given to the correctness of the contents. The information in this document is subject to change without notice. The manufacturer does not make any representations or warranties (implied or otherwise) regarding the accuracy and completeness of this document and shall in no event be liable for any loss of profit or any commercial damage, including but not limited to special, incidental, consequential, or other damage.

SAFETY INSTRUCTIONS

Always read the safety instructions carefully:

- ◆ Keep this User's Manual for future reference
- ◆ Keep this equipment away from humidity
- ◆ If any of the following situation arises, get the equipment checked by a service technician:
 - The equipment has been exposed to moisture.
 - The equipment has been dropped and damaged.
 - The equipment has obvious sign of breakage.
 - The equipment has not been working well or you cannot get it to work according to the User's Manual.

COPYRIGHT

This document contains proprietary information protected by copyright. All right are reserved. No part of this manual may be reproduced by any mechanical, electronic or other means, in any form, without prior written permission of the manufacturer.

Table of Contents

1. Introduction.....	1
Features	2
Package Contents	2
System Requirements	2
2. Using the Adapter	3
Hardware Connection.....	3
How to Use Your Wireless Audio Adapter.....	4
3. Specifications.....	5
4. Regulatory Compliance.....	6
FCC Conditions	6
CE	6
WEEE Information	6

1. Introduction

The Wireless Audio and Microphone Adapter seamlessly allows you to wirelessly transmit audio from your PC or Notebook and then vice versa transmit your voice back from the other side to your computer throughout different rooms. Simply connect the wireless audio dongle (Transmitter) to your computer's USB port and connect the wireless audio box (Receiver) to a stereo speaker or headphone (uses a 3.5mm stereo audio jack) and start enjoying audio coming from your computer throughout your house (a mobile strap is also included for the audio box to hang around your neck if you choose to use it). A microphone jack is also included to plug in a microphone. The wireless audio adapter can transmit distances of up 10 meters (33 feet) and supports Windows 2000/XP/Vista/7 and Mac OSX operating systems. Eliminate messy wires and start enjoying your audio content everywhere freely.



Features

- ◆ Eliminate wires
- ◆ Proprietary 2.4GHz wireless solution
- ◆ Easy system expansion with stereo sound support
- ◆ Hands-free communication
- ◆ Plug and play, quick and convenient use, no driver / software installation
- ◆ Low power consumption / Low audio noise
- ◆ Supports 1-1 Broadcasting
- ◆ Volume controlled through your computer or manually on the adapter

Package Contents

- | | |
|----------------------------|----|
| ◆ Wireless Audio Dongle | x1 |
| ◆ Wireless Audio Box | x1 |
| ◆ User's Manual | x1 |
| ◆ AAA Battery | x1 |
| ◆ Mobile Strap | x1 |
| ◆ Power Adapter (Optional) | x1 |

System Requirements

The minimum requirements for the PC are:

- ◆ Intel Pentium III or AMD K6 500 CPU above
- ◆ At least 128MB RAM
- ◆ At least 50 MB hard disk space
- ◆ PC or Mac with one USB port
- ◆ With one of the following operating systems :
 - Windows® 2000, XP and Vista™, 7
 - Mac OS X v10.x or later

2. Using the Adapter

Hardware Connection

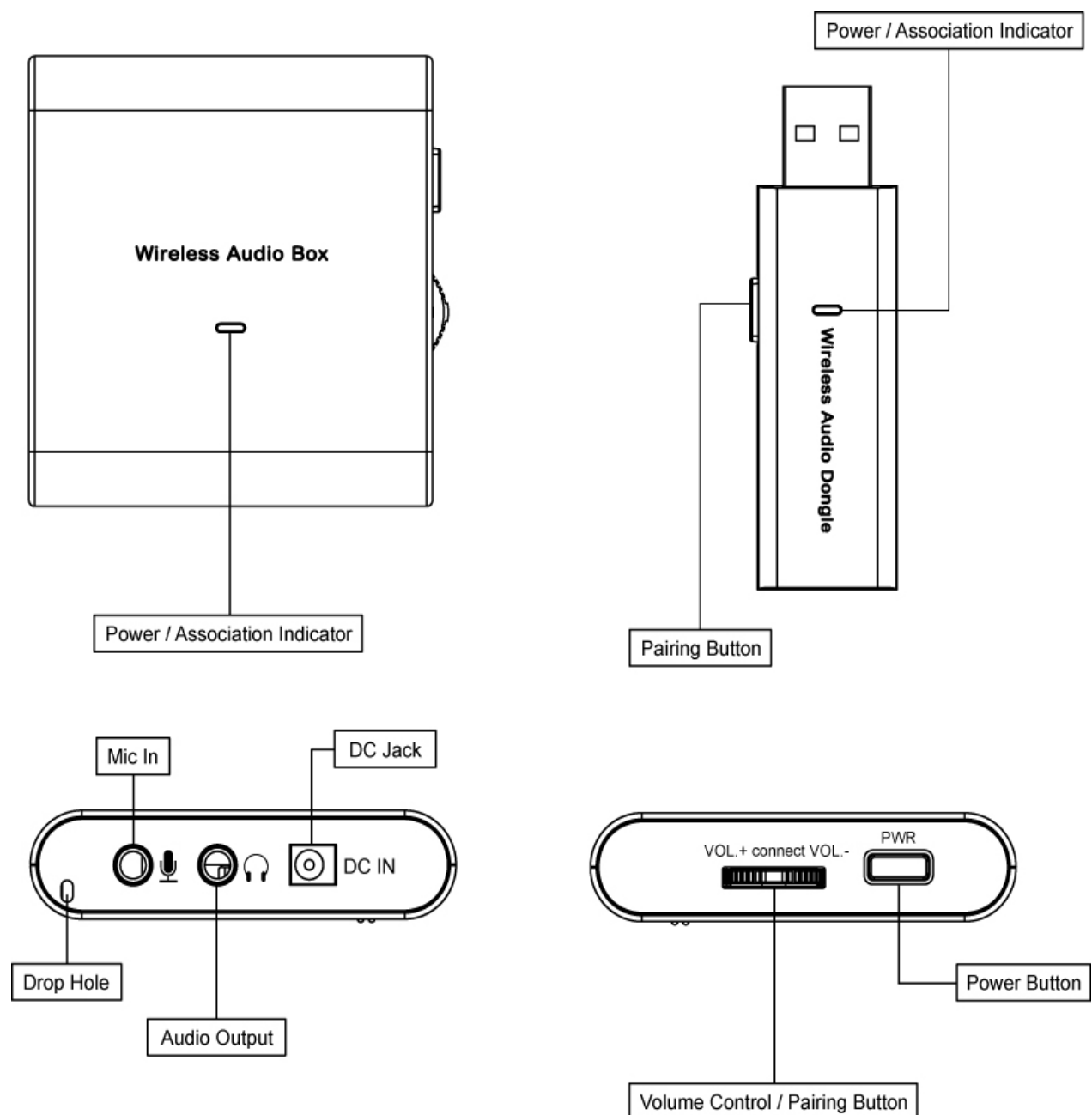

How to Use Your Wireless Audio Adapter

Caution: DO NOT power on the wireless audio box alone with battery inserted and power adapter connected at the same time to avoid unnecessary risk.

No drivers or software needed for installation. Please follow the steps below and complete the pairing process between the Wireless Audio Dongle and Wireless Audio Box.

1. **Plug** the Wireless Audio Dongle into the USB port of the PC or Mac.
LED will start blinking for powered on indicator.
2. **Power on** the Wireless Audio Box with **battery inserted** or **power adapter** connected first, and then press the Wireless Audio Box **PWR button** for over 1 second until the Wireless Audio Box LED starts blinking for powered on indicator.
3. Press the Wireless Audio Dongle **pairing button** for over 3 seconds first and then press the Wireless Audio Box **Volume bottom** for over 3 seconds until you hear the **beep sound** from the Wireless Audio Box to indicate the pairing is successful.
4. Once the pairing is successful, you may start to use your audio adapter wirelessly.

Note :

The Wireless Audio Box will be automatically enter power saving mode when no audio signal has been received after five minutes, please re-push the PWR button to power on and continue to use the Wireless Audio Adapter.

3. Specifications

Item	Description		
Interface	USB RF Dongle	USB Type A Male	
	Audio Output	3.5mm Stereo Audio Jack Female	
	Audio Input	3.5mm Stereo Audio Jack Female	
	Power	DC Power Jack	
RF Band	2.4 GHz		
RF data rate	Up to 2 Mbps , GFSK modulation		
Audio Output	2 channel Line Out		
Microphone Input	1 channel Line In		
Audio Sample rate	32KHz with 16-bit downstream; 16KHz with 16-bit upstream		
Audio Compliance	USB 1.1 full speed specification as transfer rate to 1.5 / 12 Mbps		
	Supports LPCM and Compressed format 16-bit 2-channels		
Power Mode	Wireless Audio Dongle	Bus-powered	
	Wireless Audio Box	Power Adapter	Input : AC 100-240V ; Output : DC 5V /1A
		Battery	AAA 1.5V battery x 1
Power consumption	Wireless Audio Dongle	40mA	
	Wireless Audio Box	Power Adapter	0.225 W
		Battery	0.15 W
LED	Green LED	Blinking when powered on, lights up when data transfer between wireless audio dongle and wireless audio box.	
	Orange LED	Lights up when Mic function is been used.	
Operational Range	Up to 10 meters		
Operation System Support	Windows® 2000, XP SP2 and Vista™ 32/64-bit		
	Mac OS X v10.x or later		
Working Environment	Operating Temperature	10~40 degrees (Celsius)	
	Storage Temperature	0~70 degrees (Celsius)	
	Humidity	0~80%	
Dimension	Wireless Audio Dongle	65 (L) x 20 (W) x 10 (H) (mm)	
	Wireless Audio Box	58 (L) x 55 (W) x 14.4 (H) (mm)	
Housing	Plastic ABS		

* Specifications are subject to change without notice.

4. Regulatory Compliance

FCC Conditions

This equipment has been tested and found to comply with Part 15 of the FCC Rules. Operation is subject to the following two conditions:

- (1) This device may not cause harmful interference
- (2) This device must accept any interference received. Including interference that may cause undesired operation.

Important! Changes or modifications not expressly approved by the manufacturer responsible for compliance could void the user's authority to operate the equipment. Use an approved phone set.

CE

This equipment is in compliance with the requirements of the following regulations:
EN 55 022: CLASS B

WEEE Information

For EU (European Union) member users:

According to the WEEE (Waste electrical and electronic equipment) Directive, do not dispose of this product as household waste or commercial waste. Waste electrical and electronic equipment should be appropriately collected and recycled as required by practices established for your country. For information on recycling of this product, please contact your local authorities, your household waste disposal service or the shop where you purchased the product.

