

CHARGING

Low battery indication:

When the battery is low the screen will display LOW, flash 5 times then turn off.

Charging:

Connect the unit to the charger, LED indicator will display '%' in red. The Display will show '100%' when fully charged

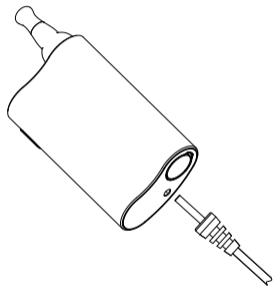

USER MANUAL

ATTENTION

Please read this manual regularly before use.
This product works best when cleaned using the stick and brush provided in this kit. Please keep this manual for future reference.

SPECS

Size: 50.5*26*114mm

Input: DC.5V,1A

Battery Capacity: 1600mAh

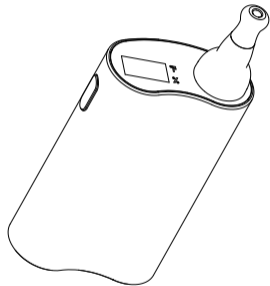

WARNING

OUR PRODUCTS ARE INTENDED FOR USE BY CONSUMERS 18 OR OLDER, AND NOT BY CHILDREN.

- Charge fully before first use.
- Allow approximately 3 hours for a full charge. Do not charge for more than 24 hours.
- Must use original battery.

APPEARANCE

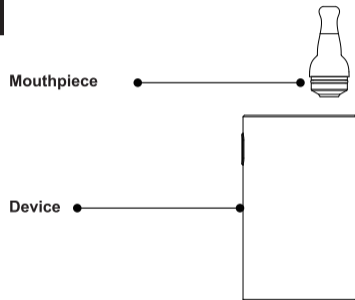

Accessories:

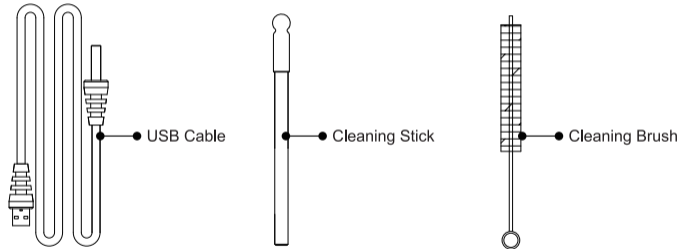

INTRODUCTION

LED Indicator lights

Display screen

ON/OFF
Button

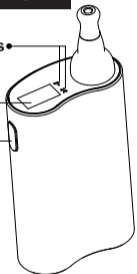

Unit Function

- Press 5 times to turn ON/OFF
- 3 temperature settings, 370-410-450 °F press for 2 seconds to adjust temperature, release the button once desired temperature is chosen. Screen will blink twice then display defined °F, later instant °F displayed.



Temperature indication



Battery power indication



Error indication



Low battery level indication

HOW TO USE

1. Unscrew the mouthpiece

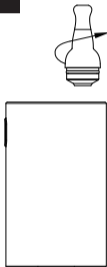

2. Place loose leaves or tobacco cigarette without filter into the tube

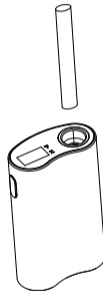

3. Place the mouthpiece



4. ● Press button 5 times to turn on
● Set temperature
● Enjoy Vaping



HOW TO CLEAN

1. Unscrew the mouthpiece

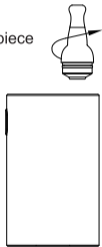

2. Open the tail cover

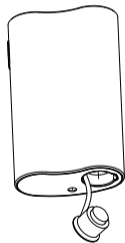

3. Use the cleaning stick to remove tobacco or cigarette residue from the E-tube

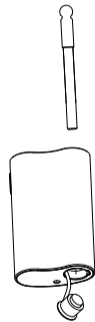

4. Use the cleaning brush to remove the remaining residue from the E-tube

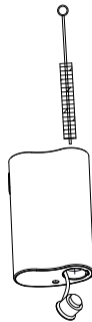

5. Place the mouthpiece onto the device

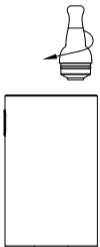

6. Device ready



HOW TO REPLACE SCREEN

1. Screw off the mouthpiece



2. Unscrew the plug



3. Screw off the screen piece



4. Put new screen onto plug

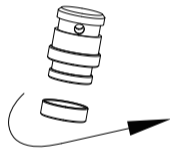

5. Screw on the plug



6. Put mouthpiece back

