

BELKIN®

Smart TV Link 4 Port

User Manual

F7D4550 8820nt00867uk Rev. A00

ENGLISH

TABLE OF CONTENTS

Getting Started	1
What's in the Box	1
How to Set It Up	2
Where to Place Your Smart TV Link 4 Port	3
Getting to Know Your Smart TV Link 4 Port	4
Front Panel	4
Back Panel	4
Technical Details	5
Technical Features	5
System Requirements	5
Using Your Smart TV Link 4 Port	6
Updating the Firmware via the Web Interface	6
Resetting the Smart TV Link 4 Port	6
Restoring your Smart TV Link to Factory Defaults	7
Troubleshooting, Support, and Warranty	8
Troubleshooting	8
Technical Support	9
Belkin International, Inc., Limited 2-Year Product Warranty	10
Regulatory Information	12
FCC Statement	13
CE compliance statement	14

GETTING STARTED

What's in the Box

Smart TV Link 4 Port

Ethernet Cable

Power Supply

Quick Installation Guide

Belkin CD with User Manual

How to Set It Up

To get started, you will need:



Wireless router,
with its network name
and password



Web browser



Personal computer

1. Connect your Smart TV Link's Ethernet cable to your PC's Ethernet port. Plug the Smart TV Link's power supply into a wall outlet.

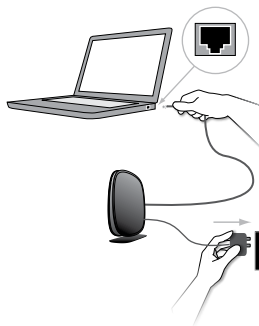

2. Open an Internet browser and type: <http://Belkin.smarttv> into the address bar. A "Welcome screen" will appear to guide you through the setup.

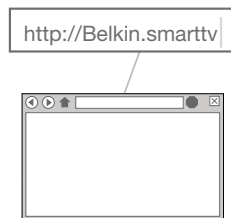

Browsers supported: Firefox® 3.5 and above, Internet Explorer® 6 and above, Google Chrome™ 7 and above, Safari® 4 and above.

Note: Default language is English. You may change languages by clicking on the language icon and choosing from the available options.



- Click the "Get Started" button to begin the setup process.
- Follow the directions on your browser to set up your device.

3. Once the Smart TV Link has successfully joined the wireless network, disconnect it from the PC, and unplug the power supply.

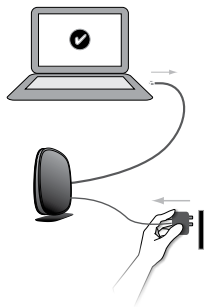

4. Connect your Smart TV Link's Ethernet cable to your TV's Ethernet port*. Plug the Smart TV Link's power supply into a wall outlet.

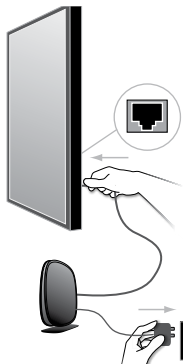

*You can connect up to 4 Ethernet-enabled devices.

Where to Place Your Smart TV Link 4 Port

For the best results, place the Smart TV Link 4 Port next to your TV or AV equipment in an open location away from large metal objects and magnets such as those found in speakers. Raising the Smart TV Link above floor level can improve the strength of your wireless signal.

Note: Once set up, the device needs to be restored to factory defaults (either via firmware GUI or via holding the reset button for 10 seconds, and then repeating the setup process).

GETTING TO KNOW YOUR SMART TV LINK 4 PORT

Front Panel

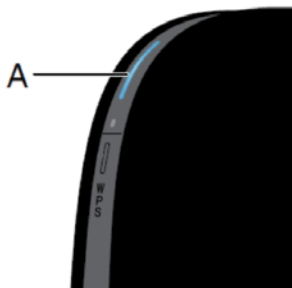

A) Smart TV Link 4 Port Status Light

Your Smart TV Link's status is shown by the light on the front.

Off: The Smart TV Link is not plugged into a power source.

Blinking Blue: The Smart TV Link is starting up.

Blinking Blue/Amber: Indicates the Smart TV Link needs to be set up.

Solid Blue: The Smart TV Link is connected to the Wi-Fi® network.

Solid Amber: The Smart TV Link is connected to the Wi-Fi network, but the signal is weak. You may experience performance problems. Consider moving the Smart TV Link closer to the wireless router.

Blinking Amber: The Smart TV Link is not connected to the Wi-Fi network. Check to make sure that your wireless router is functioning properly, and/or move the Smart TV Link closer to the wireless router.

Back Panel

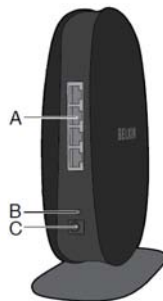

A) Wired (LAN) Connectors

Connect up to four AV devices such as Internet-Enabled TVs, Blu-ray™ players, gaming consoles, or other Ethernet-enabled devices to these ports using Ethernet cables.

B) Reset Button

This button is used to restart your Smart TV Link in rare cases when it functions incorrectly. Resetting the Smart TV Link will preserve your settings. This button may also be used to restore the factory default settings. Please see the "Troubleshooting" section for more information.

C) Power Connector

Connect the included power supply to this jack.

TECHNICAL DETAILS

Technical Features

Integrated 802.11n Wireless Bridge

Utilizes Dual-Band network technology (2.4GHz and 5GHz), allowing interference-free bandwidth to all your connected AV devices.

Integrated 4-Port 10/100 Switch

Your Smart TV Link has a built-in, 4-port network switch to connect your wired AV devices to the Internet.

System Requirements

Smart TV Link 4 Port

Wireless router

At least one computer with an installed network interface Smart TV Link

RJ45 Ethernet networking cable

Internet browser

USING YOUR SMART TV LINK 4 PORT

Updating the Smart TV Link's Firmware via the Web Interface

Note: Your PC needs to be wired to the Smart TV Link in order to access the web interface. Open an Internet browser and type: <http://Belkin.smarttv> into the address bar.

The following steps show you how to update your Smart TV Link's firmware using its web interface.

Resetting the Smart TV Link 4 Port

Restart your Smart TV Link.



USING YOUR SMART TV LINK 4 PORT

Reset Button

The “Reset” button is used in rare cases when the Smart TV Link may function improperly. Resetting the Smart TV Link will restore the Smart TV Link’s normal operation while maintaining the programmed settings. You can also restore the factory default settings by using the “Reset” button.

Resetting the Smart TV Link 4 Port

Push and release the “Reset” button. The light on the Smart TV Link will momentarily flash and then become solid again, indicating the reset is complete.

Restoring Your Smart TV Link to Factory Defaults

Press and hold the “Reset” button for at least 10 seconds, and then release it. The light on the Smart TV Link will become blue/amber in an alternating flash pattern indicating that the Smart TV Link is ready to be set up again.

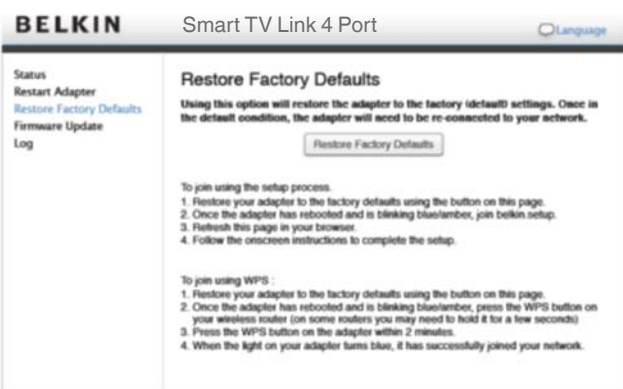

The screenshot shows the web interface for the BELKIN Smart TV Link 4 Port. The top navigation bar includes the BELKIN logo, the product name 'Smart TV Link 4 Port', and a language selection dropdown. On the left, a sidebar menu contains 'Status', 'Restart Adapter', 'Restore Factory Defaults', 'Firmware Update', and 'Log'. The main content area is titled 'Restore Factory Defaults' and contains the following text: 'Using this option will restore the adapter to the factory (default) settings. Once in the default condition, the adapter will need to be re-connected to your network.' Below this is a 'Restore Factory Defaults' button. Two sections of instructions are provided: 'To join using the setup process' and 'To join using WPS', each with a four-step numbered list.

BELKIN Smart TV Link 4 Port Language

Status
Restart Adapter
Restore Factory Defaults
Firmware Update
Log

Restore Factory Defaults

Using this option will restore the adapter to the factory (default) settings. Once in the default condition, the adapter will need to be re-connected to your network.

[Restore Factory Defaults](#)

To join using the setup process:

1. Restore your adapter to the factory defaults using the button on this page.
2. Once the adapter has rebooted and is blinking blue/amber, join belkin setup.
3. Refresh this page in your browser.
4. Follow the onscreen instructions to complete the setup.

To join using WPS:

1. Restore your adapter to the factory defaults using the button on this page.
2. Once the adapter has rebooted and is blinking blue/amber, press the WPS button on your wireless router (on some routers you may need to hold it for a few seconds).
3. Press the WPS button on the adapter within 2 minutes.
4. When the light on your adapter turns blue, it has successfully joined your network.

Troubleshooting

Belkin Setup cannot find my Smart TV Link.

If Belkin Setup is not able to communicate with your Smart TV Link during the installation process, please make sure that the wireless router is turned on and has Internet connectivity.

The Smart TV Link is having trouble connecting to my wireless network.

BELKIN Smart TV Link 4 Port

English



**Please contact Belkin Support for help.
You'll need the following information:**

Product Name: [Universal Wireless AV Adapter](#)

Product Number: [12345](#)

Issue: [SSID cannot be found.](#)

Save a copy of this page

Belkin Support Numbers

Argentina	800 222 0147
Australia	1 800 235 546
Belgium	0707 00073
Brazil	0800 888 8018 / 4003 8018
Canada	800 223 5546
Chile	123 00208354
China	800 819 0159

Blinking Amber LED

This indicates that the Smart TV Link is not connected to your wireless network. Please move the Smart TV Link closer to your router.

Solid Amber LED

This indicates that the Smart TV Link is connected to your wireless network, but the signal is weak. You might experience slower performance. Please move the Smart TV Link closer to your router.

My wireless network performance is slow, inconsistent, suffers from weak signal, or I'm having difficulty maintaining a connection with my wireless network.

Wireless technology is radio-based, which means connectivity and the throughput performance between devices decreases when the distance between devices increases. Other factors that will cause signal degradation (metal is generally the worst culprit) are obstructions such as walls and metal appliances. Note also that connection speed may decrease as you move your Smart TV Link farther away from the router.

Technical Support

US

<http://www.belkin.com/support>

UK

<http://www.belkin.com/uk/support>

Australia

<http://www.belkin.com/au/support>

New Zealand

<http://www.belkin.com/au/support>

Singapore

1800 622 1130

Europe

<http://www.belkin.com/uk/support>

COUNTRY	NUMBER	INTERNET ADDRESS
AUSTRIA	0820 200766	www.belkin.com/de/networking/
BELGIUM	07 07 00 073	www.belkin.com/nl/networking/ www.belkin.com/fr/networking/
CZECH REPUBLIC	239 000 406	www.belkin.com/uk/networking/
DENMARK	701 22 403	www.belkin.com/uk/networking/
FINLAND	0972519123	www.belkin.com/uk/networking/
FRANCE	08 - 25 54 00 26	www.belkin.com/fr/networking/
GERMANY	0180 - 500 57 09	www.belkin.com/de/networking/
GREECE	00800 - 44 14 23 90	www.belkin.com/uk/networking/
HUNGARY	06 - 17 77 49 06	www.belkin.com/uk/networking/
ICELAND	800 8534	www.belkin.com/uk/networking/
IRELAND	0818 55 50 06	www.belkin.com/uk/networking/
ITALY	02 - 69 43 02 51	www.belkin.com/it/networking/
LUXEMBOURG	34 20 80 85 60	www.belkin.com/uk/networking/
NETHERLANDS	0900 - 040 07 90 €0.10 per minute	www.belkin.com/nl/networking/
NORWAY	81 50 0287	www.belkin.com/uk/networking/
POLAND	00800 - 441 17 37	www.belkin.com/uk/networking/
PORTUGAL	707 200 676	www.belkin.com/uk/networking/
RUSSIA	495 580 9541	www.belkin.com/networking/
SLOVAKIA	08000 04614	www.belkin.com/networking/
SLOVENIA	0800 80510	www.belkin.com/networking/
SOUTH AFRICA	0800 - 99 15 21	www.belkin.com/uk/networking/
SPAIN	902 - 02 43 66	www.belkin.com/es/networking/
SWEDEN	07 - 71 40 04 53	www.belkin.com/uk/networking/
SWITZERLAND	08 - 48 00 02 19	www.belkin.com/de/networking/ www.belkin.com/fr/networking/
UNITED KINGDOM	0845 - 607 77 87	www.belkin.com/uk/networking/
OTHER COUNTRIES	+44 - 1933 35 20 00	

Belkin International, Inc., Limited 2-Year Product Warranty

What this warranty covers.

Belkin International, Inc. ("Belkin") warrants to the original purchaser of this Belkin product that the product shall be free of defects in design, assembly, material, or workmanship.

What the period of coverage is.

Belkin warrants the Belkin product for two years.

What will we do to correct problems?

Product Warranty.

Belkin will repair or replace, at its option, any defective product free of charge (except for shipping charges for the product). Belkin reserves the right to discontinue any of its products without notice, and disclaims any limited warranty to repair or replace any such discontinued products. In the event that Belkin is unable to repair or replace the product (for example, because it has been discontinued), Belkin will offer either a refund or a credit toward the purchase of another product from Belkin.com in an amount equal to the purchase price of the product as evidenced on the original purchase receipt as discounted by its natural use.

What is not covered by this warranty?

All above warranties are null and void if the Belkin product is not provided to Belkin for inspection upon Belkin's request at the sole expense of the purchaser, or if Belkin determines that the Belkin product has been improperly installed, altered in any way, or tampered with. The Belkin Product Warranty does not protect against acts of God such as flood, lightning, earthquake, war, vandalism, theft, normal-use wear and tear, erosion, depletion, obsolescence, abuse, damage due to low voltage disturbances (i.e. brownouts or sags), non-authorized program, or system equipment modification or alteration.

How to get service

To get service for your Belkin product you must take the following steps:

1. Contact Belkin International, Inc., at the phone number listed on page 10, within 15 days of the Occurrence.
Be prepared to provide the following information:
 - a. The part number of the Belkin product.
 - b. Where you purchased the product.
 - c. When you purchased the product.
 - d. Copy of original receipt.
2. Your Belkin Customer Service Representative will then instruct you on how to forward your receipt and Belkin product and how to proceed with your claim.

Belkin reserves the right to review the damaged Belkin product. All costs of shipping the Belkin product to Belkin for inspection shall be borne solely by the purchaser. If Belkin determines, in its sole discretion, that it is impractical to ship the damaged equipment to Belkin, Belkin may designate, in its sole discretion, an equipment repair facility to inspect and estimate the cost to repair such equipment. The cost, if any, of shipping the equipment to and from such repair facility and of such estimate shall be borne solely by the purchaser. Damaged equipment must remain available for inspection until the claim is finalized. Whenever claims are settled, Belkin reserves the right to be subrogated under any existing insurance policies the purchaser may have.

How state law relates to the warranty

THIS WARRANTY CONTAINS THE SOLE WARRANTY OF BELKIN. THERE ARE NO OTHER WARRANTIES, EXPRESSED OR, EXCEPT AS REQUIRED BY LAW, IMPLIED, INCLUDING THE IMPLIED WARRANTY OR CONDITION OF QUALITY, MERCHANTABILITY OR FITNESS FOR A PARTICULAR PURPOSE, AND SUCH IMPLIED WARRANTIES, IF ANY, ARE LIMITED IN DURATION TO THE TERM OF THIS WARRANTY.

Some states do not allow limitations on how long an implied warranty lasts, so the above limitations may not apply to you.

IN NO EVENT SHALL BELKIN BE LIABLE FOR INCIDENTAL, SPECIAL, DIRECT, INDIRECT, CONSEQUENTIAL OR MULTIPLE DAMAGES SUCH AS, BUT NOT LIMITED TO, LOST BUSINESS OR PROFITS ARISING OUT OF THE SALE OR USE OF ANY BELKIN PRODUCT, EVEN IF ADVISED OF THE POSSIBILITY OF SUCH DAMAGES.

This warranty gives you specific legal rights, and you may also have other rights, which may vary from state to state. Some states do not allow the exclusion or limitation of incidental, consequential, or other damages, so the above limitations may not apply to you.

REGULATORY INFORMATION

FCC Statement

DECLARATION OF CONFORMITY WITH FCC RULES FOR ELECTROMAGNETIC COMPATIBILITY

We, Belkin International, Inc., of 12045 E. Waterfront Drive, Playa Vista, CA 90094, declare under our sole responsibility that the device, **F7D4550v1**, complies with Part 15 of the FCC Rules. Operation is subject to the following two conditions: (1) this device may not cause harmful interference, and (2) this device must accept any interference received, including interference that may cause undesired operation.

Caution: Exposure to Radio Frequency Radiation.

The device shall be used in such a manner that the potential for human contact normal operation is minimized.

This equipment complies with FCC radiation exposure limits set forth for an uncontrolled environment. This equipment should be installed and operated with a minimum distance of 20cm between the radiator and your body.

Federal Communications Commission Notice

This equipment has been tested and found to comply with the limits for a Class B digital device, pursuant to Part 15 of the FCC Rules. These limits are designed to provide reasonable protection against harmful interference in a residential installation.

This equipment generates, uses, and can radiate radio frequency energy, and if not installed and used in accordance with the instructions, may cause harmful interference to radio communications. However, there is no guarantee that interference will not occur in a particular installation. If this equipment does cause harmful interference to radio or television reception, which can be determined by turning the equipment off and on, the user is encouraged to try and correct the interference by one or more of the following measures:

- Reorient or relocate the receiving antenna.
- Increase the distance between the equipment and the receiver.
- Connect the equipment to an outlet on a circuit different from that to which the receiver is connected.
- Consult the dealer or an experienced radio/TV technician for help.

FCC Caution: Any changes or modifications not expressly approved by the party responsible for compliance could void the user's authority to operate this equipment.

This device and its antenna(s) must not be co-located or operating in conjunction with any other antenna or transmitter..

European Compliance Statement:

Belkin International hereby declares that this F7D4550 Smart TV Link 4 Port is in compliance with the essential requirements and other relevant provisions of the RTT&E Directive 1999/5/EC, the EMC Directive 2004/108/EC, and the Low Voltage Directive 2006/5/EC. Conformity was assessed using a Technical Construction File.

A copy of the European Union CE marking "Declaration of Conformity" may be obtained at the website: www.belkin.com/doc



For information on product disposal please refer to <http://environmental.belkin.com>

belkin.com

© 2011 Belkin International, Inc. All rights reserved. All trade names are registered trademarks of respective manufacturers listed. Mac and Mac OS are trademarks of Apple Inc., registered in the U.S. and other countries. Windows, Windows Vista, and Internet Explorer are either registered trademarks or trademarks of Microsoft Corporation in the United States and/or other countries.

F7D4550_8820nt00867uk

Belkin Ltd.
Express Business Park
Shipton Way, Rushden
NN10 6GL, United Kingdom

Belkin SAS
130 rue de Sully
92100 Boulogne-Billancourt,
France

Belkin GmbH
Otto-Hahn-Straße 20
85609 Aschheim
Germany

Belkin Iberia
Avda de Barajas, 24, Edificio Gamma,
4ªpta, 28108 Alcobendas
Madrid - Spain

Belkin Italy & Greece
Via Nino Bonnet, 4/6
Milan 20154
Italy

Belkin B.V.
Boeing Avenue 333
1119 PH Schiphol-Rijk,
Netherlands