

Cableveyor® PAT.

TKC34H25 · TKC47H36 · TKC64H50 · TKC85H68
 (formerly TKC0340), (formerly TKC0470), (formerly TKC0640), (formerly TKC0850)

Thank you for your purchase of the Tsubaki Cableveyor.
 These instructions cover everything from delivery to installation. Please read them thoroughly before starting.

1 Construction/Part Name

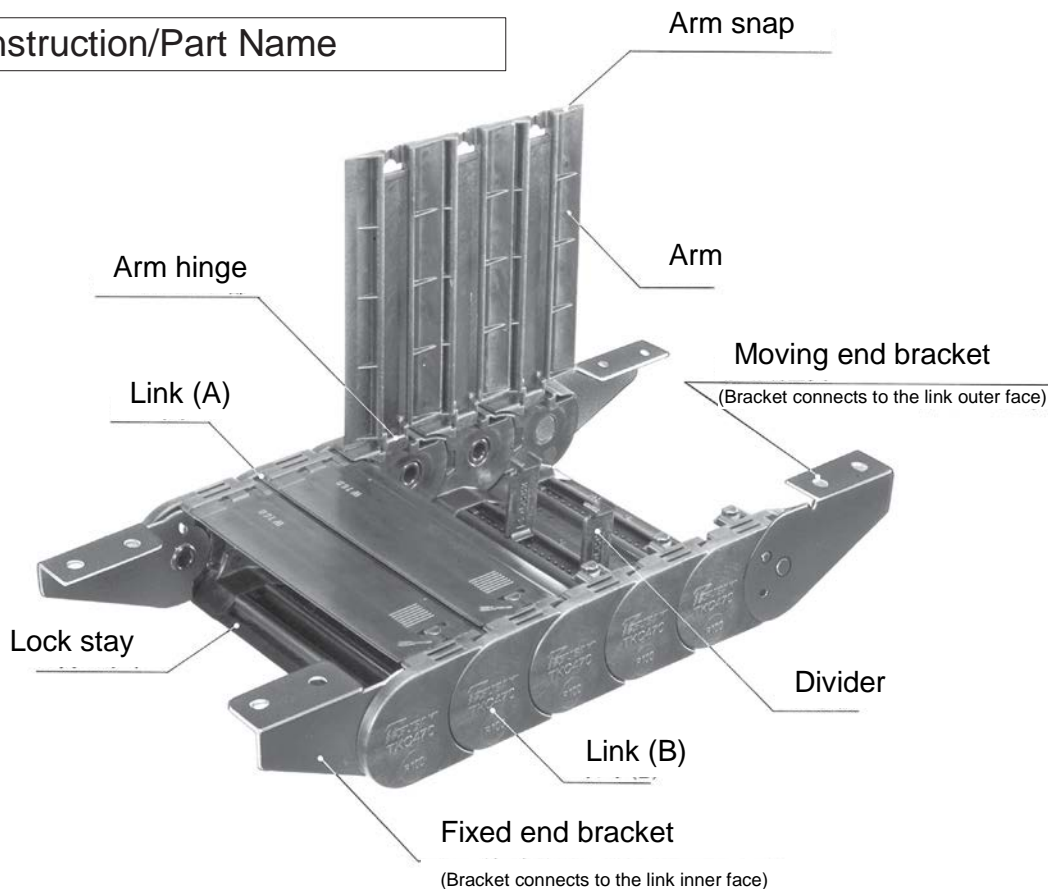

2 Delivery

- 1)
 - A. For TKC34H25
 The moving end bracket is delivered assembled into the Cableveyor unit, while the fixed end bracket and dividers are shipped as unassembled parts.
 - B. For TKC47H36, TKC64H50, and TKC85H68
 Both the moving and fixed end brackets are delivered assembled into the Cableveyor unit, while the dividers are shipped as unassembled parts.

2) Long length Cableveyors (usually over 4m) are generally shipped in sections.

Sectioned Cableveyor

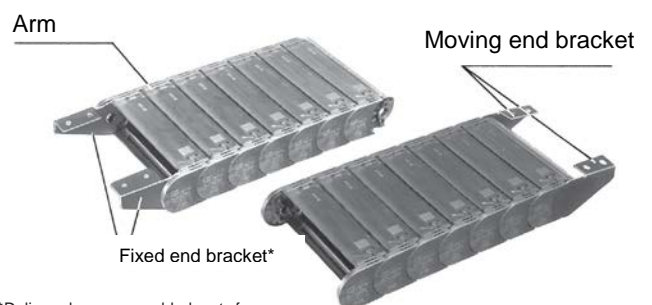

*Delivered as unassembled parts for TKC34H25.

3 Connecting

3-1 Open the arms.

Open the arms one by one starting from the Cableveyor travel end (Dia. 1 below).

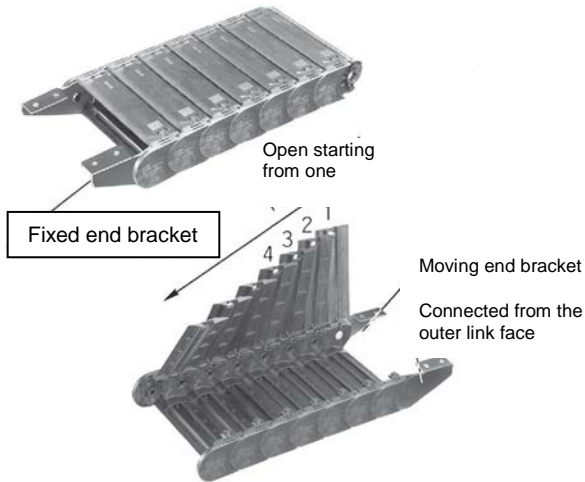

There is a screwdriver mark on the arm snaps. Insert the tip of a flat-head screwdriver to open the arms.

Open sequentially from the travel end

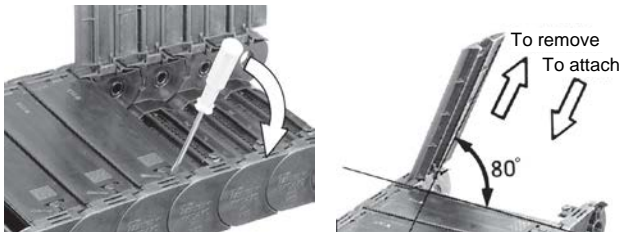

*1. Screwdriver tip size
TKC34H25=4.5mm
TKC47H36=6.0mm
TKC64H50=8.0mm
TKC85H68=8.0mm

*2. Arms can be removed by lifting 80 degrees and pulling out.

3-2 Remove the lock stays.

Remove 3 or 4 lock stays from the area to be connected on the travel end side.

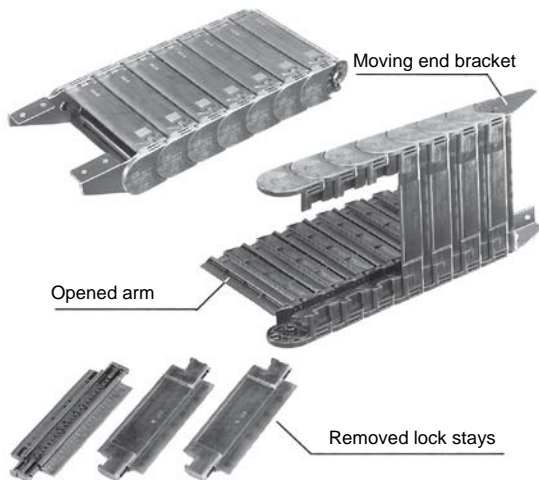

Insert a flat-head screwdriver into the grooves of lock stays with a screwdriver mark and pry open in the direction of the arrow.

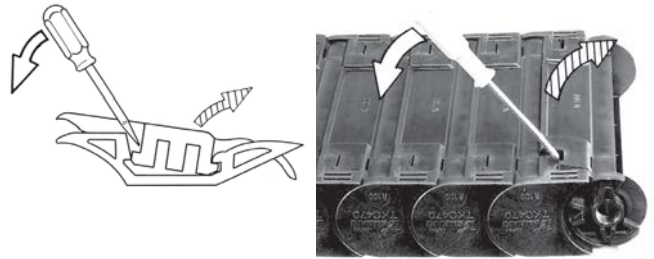

*Guide mark for removing locking stays (screwdriver mark)

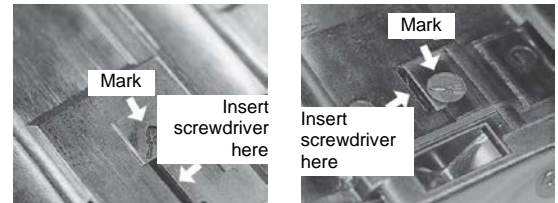

For TKC34H25

For TKC47H36, TKC64H50, and TKC85H68

3-3 Connect the links.

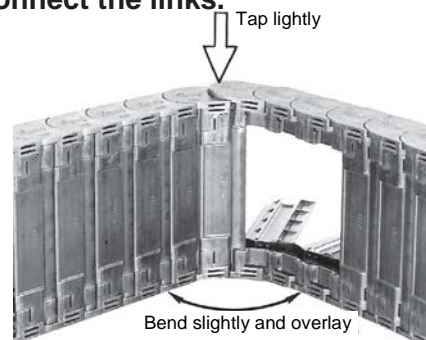

- 1) Align the pin hole and stopper projection and forcefully press in the link by hand. A light tap with a plastic hammer will also suffice.
- 2) Slightly bend the stopper knobs on the links about 5 degrees toward bending radius side to align.

3-4 Attach the lock stays.

Insert the lock stay into links (A) and (B) simultaneously as shown in the cross-sectional diagram below and press down in the direction of the arrow to fix.

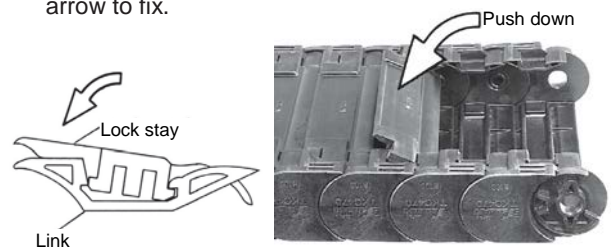

Note: Align the lock stay in links (A) and (B) at the same time.

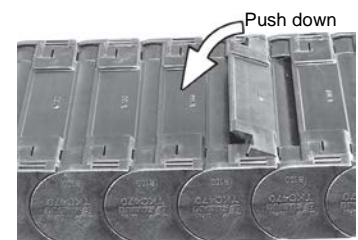

*Lock stay attachment guide mark (to align with links)



For TKC34H25



For TKC47H36, TKC64H50, and TKC85H68

4 Inserting Cables/Hoses (set)

4-1 Open the arms.

Refer to 3-1.

4-2 Attach the dividers.

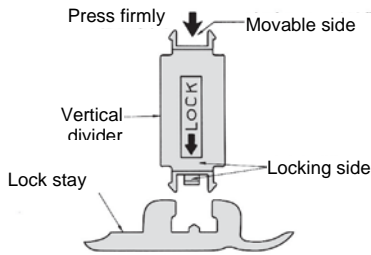

- 1) There are two ways to attach the vertical divider to the lock stay.
 - A. For fixed dividers
Position the vertical divider with the LOCK arrow facing down and connect to the lock stay to fix in place. Dividers can be fixed along the stay in 5mm increments.
 - B. For movable dividers
Position the vertical divider with the LOCK arrow facing up. Dividers can slide freely along the lock stay groove.
- 2) Align the vertical divider with the lock stay recess and press firmly by hand to attach.
- 3) Attaching the dividers
Dividers should generally be attached every other link.
- 4) To remove the vertical divider from the lock stay, push the divider down laterally.

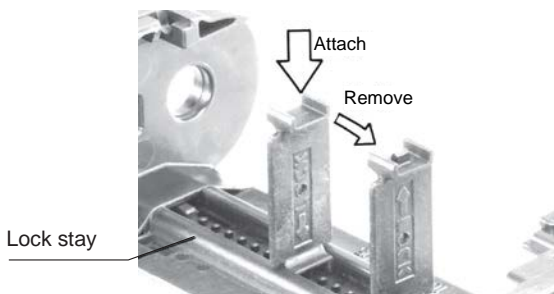

4-3 Insert the cables/hoses.

Insert the cables/hoses into their designated position.

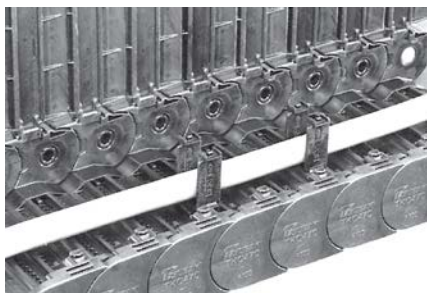

4-4 Close the arms.

Close the arms from the Cableveyor fixed end side. Press down firmly on the mark on the arm surface by hand, or lightly tap with a plastic hammer, to connect the arm to the link (B). (Note: Tapping the highlighted area below with a hammer may cause cracking.)

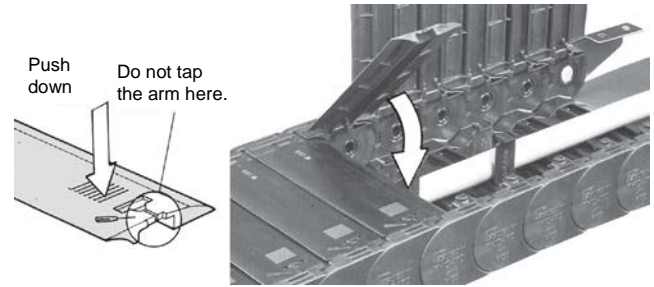

Note: Close the arms sequentially from the fixed end.



With cables/hoses inserted (set)

5 Lengthening Your Cableveyor

5-1 Remove the travel end bracket.

Insert a flat head screwdriver between the link and bracket and remove the bracket, or remove the first link. (See 6.)

5-2 Connect the additional link(s).

First, lightly tap links (A) & (B) with a plastic hammer to connect.

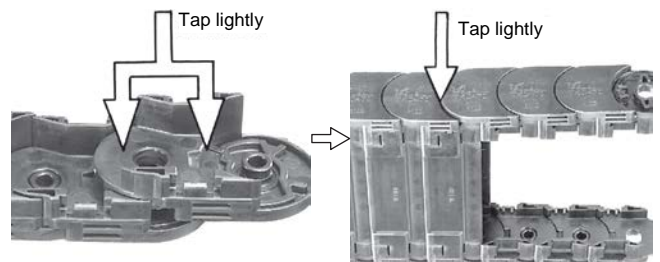

5-3 Attach lock stays to the additional link(s).

See 3-4.

5-4 Attach any dividers and arms.

See 4-2.

5-5 Attach the travel end bracket.



6 Shortening Your Cableveyor

6-1 Remove arms from the travel end side.

See 3-1.

6-2 Remove the lock stays.

See 3-2.

6-3 Remove the link(s).

1. For TKC34H25 and TKC85H68

Insert a flat-head screwdriver between the links to separate. Perform the same on the brackets.



2. For TKC47H36 and TKC64H50

Insert a flat-head screwdriver between the links to separate.

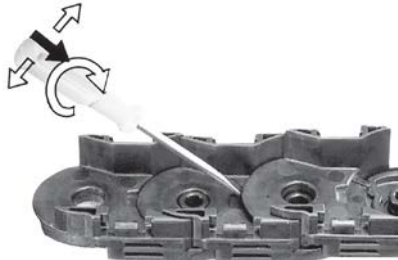

3. Or, instead of using a screwdriver place a jig on the link pins and lightly tap with a hammer.

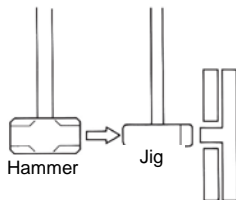

6-4 Remove the travel end bracket.

Insert a flat-head screwdriver between the link and bracket to remove the bracket.

6-5 Attach the travel end bracket.

See 5-5.

7 Caution when Handling

Depending on the application, there may be sag or pretension in the self support length. Select your Cableveyor using Tsubaki's Performance Graph to avoid any issues.

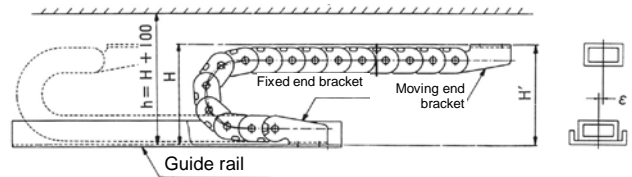

1. The travel end installation height (H') to the equipment should be the Cableveyor's height $H + (10-30)$.
2. The Cableveyor mounting height (h) should be $H + 100$.
3. Install a guide rail.
4. The error (ϵ) in travel end and fixed end installation faces should be less than 6mm.
5. Use cables/hoses designed for movement with excellent bending and wear resistance properties.
6. Do not use cables/hoses with wire braid casings, as they can be easily damaged.
7. Stacking cables/hoses can easily cause wear. Cables/hoses should be laid horizontally or separated by horizontal dividers.
8. Ensure the cables/hoses have leeway in their length when installing. After adjusting them to the proper length, secure both ends with clamps.
9. Foreign matter in the guide rail may cause damage. Please keep clean.
10. The following parts are delivered unassembled.
 - Dividers
 - (For TKC34H25 only): Fixed end bracket