



# S-Series

---

## SM-54

### Instruction Manual

---

---

**MANUFACTURER:**

SCHUSTER Transferpressen GmbH  
Fritz-Reichle-Ring 20  
78315 Radolfzell  
GERMANY

FON: +49-7732-30279-10  
FAX: +49-7732-30279-13  
E-MAIL: [kontakt@schuster-transferpressen.de](mailto:kontakt@schuster-transferpressen.de)  
WEB: [www.schuster-transferpressen.de](http://www.schuster-transferpressen.de)

**DISTRIBUTER:**



Tel 1300 196 156  
Email [mail@colourcomponents.com.au](mailto:mail@colourcomponents.com.au)  
Street 24/25 Ingleston Road, Tingalpa QLD. 4173 Australia  
Web [www.colourcomponents.com.au](http://www.colourcomponents.com.au)

## SM-54

### Instruction Manual

---

1	Safety Advice .....	12
1.1	Manual Convention .....	12
1.2	Important Security Advices .....	12
1.3	Working with the Transfer Press .....	12
2	Check Shipment .....	13
3	Assembling and Bringing into Service .....	13
4	Settings .....	13
4.1	Height Adjustment for Work Plate .....	13
4.2	Set Pressure .....	14
4.3	Time and Temperatur Controller .....	14
4.3.1	Set Temperatur .....	14
4.3.2	Set Printing Time .....	14
5	Printing Operation .....	15
6	Exchange Heat Element and Work Plate .....	15
6.1	Build in and Extend a Heat Element .....	15
6.2	Build in and Extend a Work Plate .....	15
7	Maintenance .....	16
8	Problem Solving .....	16
9	Technical Data .....	17

The SCHUSTER Transferpressen GmbH takes no responsibility for damages arising from misuse, reparations, and modifications which were carried out by third, not authorized parties, as well as for damages arising from non observance of the instruction manual. This handbook was constructed with great care, a liability for small negligent mistakes, for example printing error, however are excluded.

The SCHUSTER Transferpressen GmbH takes no responsibility for damages or errors which arise from the use of accessory or spare parts which are not original pdeviceucts of SCHUSTER Transferpressen GmbH.

Below SCHUSTER Transferpressen GmbH is identified as the manufacturer.

Copyright © 2010 SCHUSTER Transferpressen GmbH. All rights reserved

Abb. 1: Vorderansicht SM-54

Abb. 2: Rückansicht SM-54



Abb. 3: Zusammenbau der SM-54



Abb. 4: Instrumentengehäuse

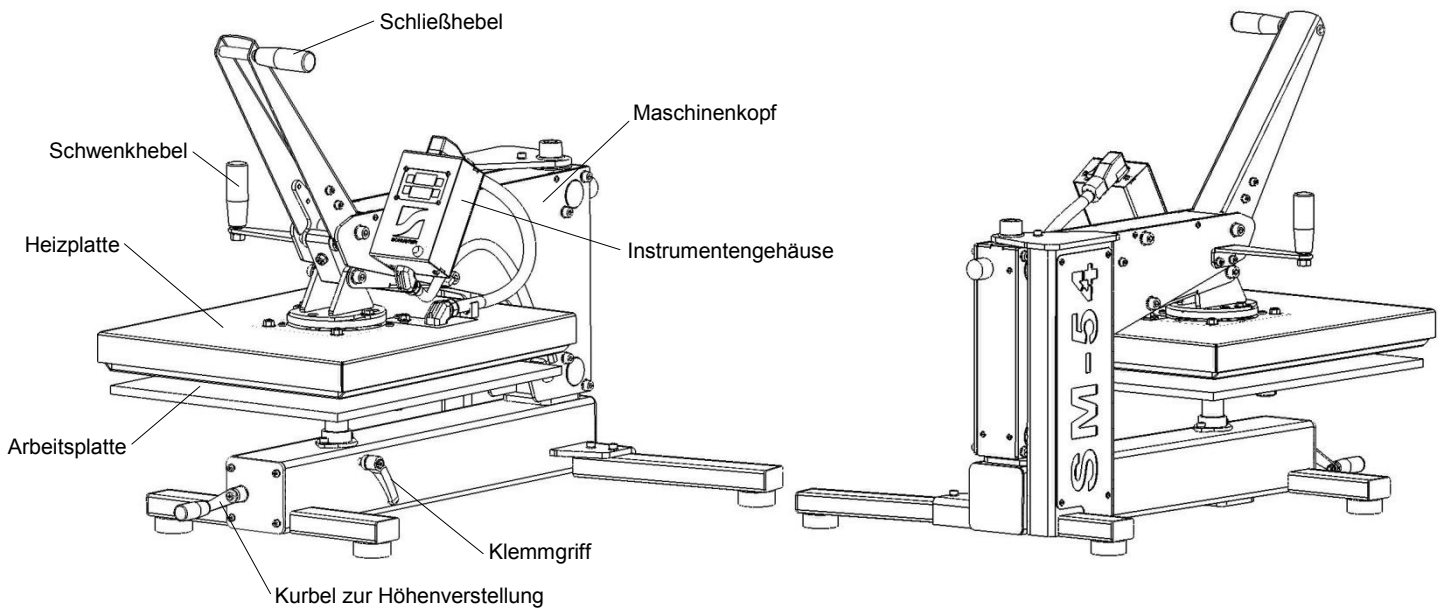

# 1 Safety Advice

Read through following advices before bringing the transfer press into service. It is necessary to consider all warnings and advices indicated on the transfer press.

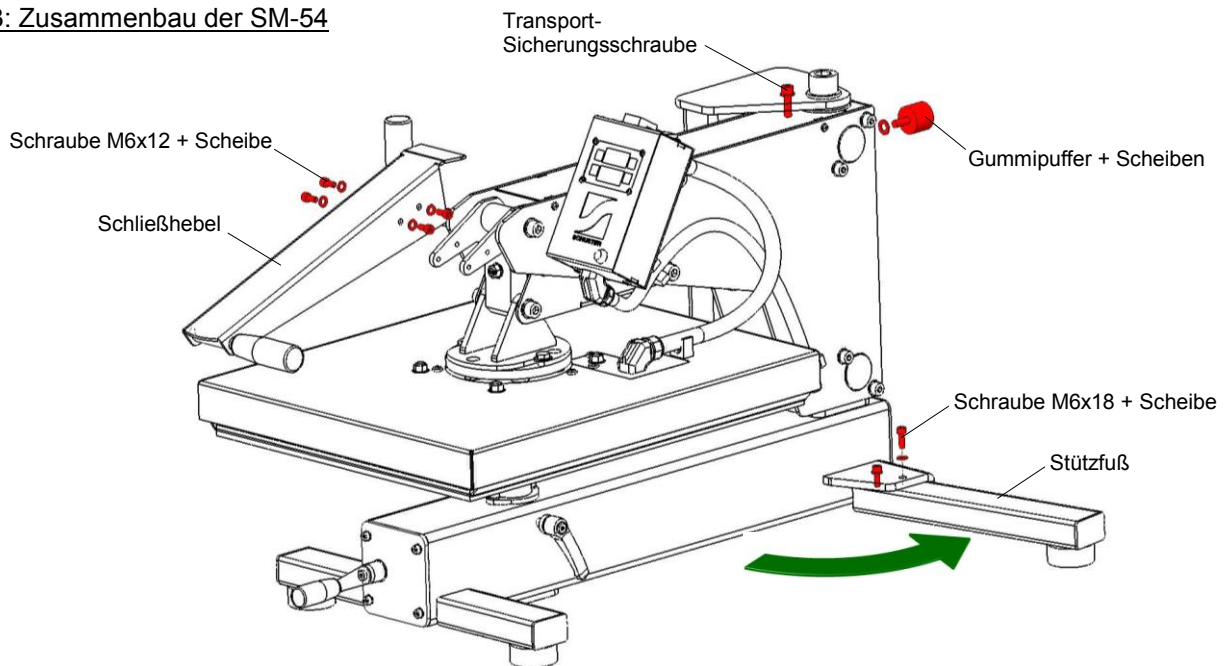
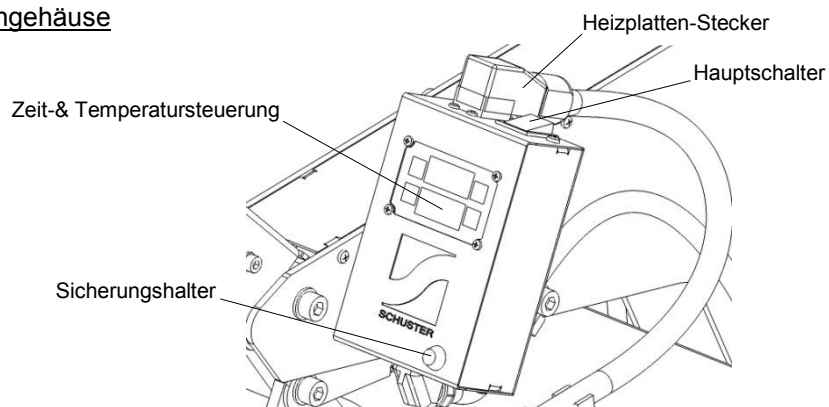
## 1.1 Manual Convention



You can find this symbol in particular on important safety advices in this instruction manual, in which you will be advised about the right handling of the transfer press. It is necessary to pay attention to these advices. Non-observance can lead to injuries of the user.



Security advices which are marked with this symbol, it's necessary to pay attention to. In case of non observance, burns of the user may occur. You also can find this symbol marked on some parts on the transfer press.



A symbol like this advices you, that through crushing danger of injuries exists. You also can find this symbol marked on parts of the transfer press.

## 1.2 Important Security Advices

This transfer press presents dangers if used inappropriately, or when used for a non intended use. For this reason, read carefully all of the following advices:

- The transfer press may only be used for printings on pressure- and heat resistant materials. Every exceeding use is seen as not intended. If still used for non intended service, the manufacturers will not be liable for the resulting damages. Unauthorized reconstructions and modifications are not permitted, because they will interfere with the security and the service of the machine.
- Don't insert any objects through the case notch. Also make sure that no fluid will reach the transfer press and the heat element.
- The used mains voltage has to be the same as the stated mains voltage on the type plate of the transfer press.
- Watch out not to damage the power plug.
- If you connect the transfer press over an extension cable, please make sure that the overall nominal current (of all connected equipment) does not exceed the allowed current load. Further make sure that the overall nominal

current of all connected equipment does not exceed the allowed power supply of the connected electrical outlet.

- Never try to maintenance the device on your own.
- To ensure safe operations of the transfer press, the operator has to make sure that non-authorized people neither work on the machine, nor set the machine into operation, or perform any other operations on the machine.
- All operations on the transfer press can only be accomplished by specialised staff who gained an appropriate instruction or training.
- General legal and other binding regulations for accident prevention and environmental protection are to be considered in addition to this instruction manual.

## 1.3 Working with the Transfer Press

- Look out not to touch the lower part of the heat element while the press is in service, otherwise burns may occur. Please also note that there is still a danger to suffer burns even after turning off the transfer press for a longer time.
- The case of the heat element will also be heating up; so be careful.
- During the service of the press, and especially during the start of the transfer press, never put your hand between the work plate and the heat element, or the transfer press. Furthermore, make sure that no other person can reach the transfer press.

## 2 Check Shipment

SM-54 with a single sliding table	with a double sliding table
1 x silicone foam pad	2 x silicone foam pads
1 x protective cover	2 x protective cover
1 x hexagon wrench button	1 x hexagon wrench button
1 x instruction manual	1 x instruction manual

### 3 Assembling and Bringing Into Service

1. Unpack the transfer press.
  2. Bring the transfer press to its location of service. **Only use the assembled transport device to move the press.** Make sure that no flammable or heat-sensitive materials or equipment are in immediate vicinity of the transfer press.
- 
3. Remove the transport device. It is very important to keep them, because the transfer press can ONLY be moved through these transport devices. In particular; faults which will appear when trying to lift the transfer press up on other parts than the transfer devices, will be exempted from this warranty. It is especially unacceptable, to lift the transfer press at the sliding table or at the heat element. When you assemble the transport devices, make sure you plumb in the fixing screws tightly.
  4. Remove the corrugated-head screws on the sliding table. Keep these as well for a further transport to secure the sliding table against slipping.

5. Connect the power plug with an electrical outlet and connect the compressed air pipe to the compressed air filter (see page 11, Fig. 2 and 4).
6. Switch on the power switch to start the transfer press.
7. The transfer press will be ready for operations now.

### 4 Settings

#### 4.1 Height Adjustment for Work Plate

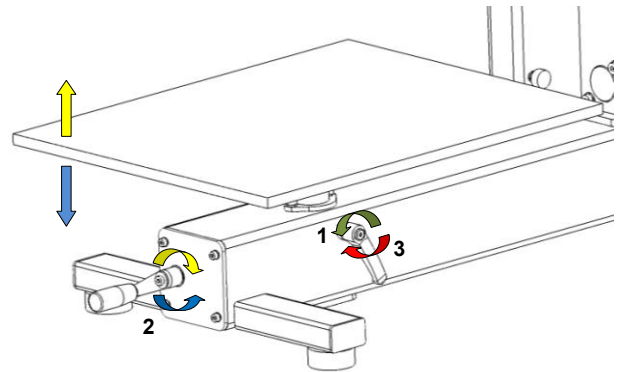

1. The first step will be to loose the locking of the height adjustments. To do so, turn the clip handle to the left.
2. Now turn the work plate in clockwise direction to lower it, or in anticlockwise direction to raise it.
3. When you reached your desired height, turn the clip handle to the right to lock the height adjustment.



The gap between the undersurface of the heat element and the upper surface of the article to be printed on, should be 15 – 25 mm. Is the gap bigger/higher than 25 mm; the transfer press will automatically cancel the printing process for technical reasons, and the heat element will go back into its original position.

#### 4.2 Set Pressure

You can adjust the pressure with the pressure regulator; the manometer in the control panel serves as a control for your changes.

The first step to change the pressure will be to pull out the pressure regulator, then turn the pressure regulator to the right, to increase the pressure, to the left to reduce it. After you adjusted the desired pressure, push the pressure regulator back in to set the pressure.

Usual values for sublimation prints: 3 – 5 bar.



Maximum allowed pressure: 6 bar.

### 4.3 Time and Temperature Controller

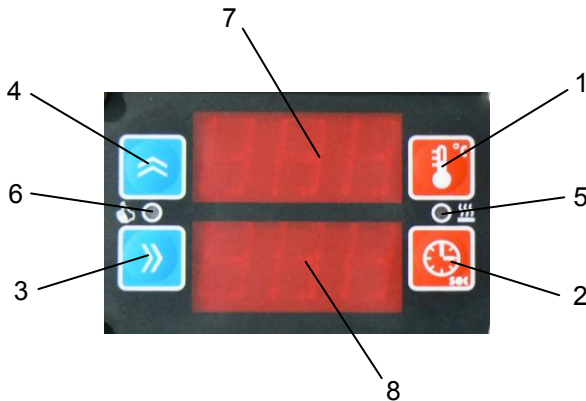

Pos.	Definition
1.	button „temperature“
2.	button „time“
3.	button „to the right“
4.	button „upwards“
5.	Light-emitting diode „heating“
6.	Light-emitting diode „O.K.“
7.	Display „temperature“
8.	Display „time“

#### 4.3.1 Set Temperature

1. To set the temperature; push the button „temperature“ once; the first cypher will start flashing.
2. Adjust the desired value with the „upwards“ button.
3. To change the value of the second cypher, push the button „to the right“; and the second cypher will start flashing. Use the same procedure to adjust the value.
4. To change the third cypher; use the same process like for the second cypher.
5. Push the button „temperature“ to save the settings, as well as to leave the adjustment mode.

The light-emitting diode will flash „heating“, as long as the temperature set point is not reached yet. After heating up, the light-emitting diode will flash „O.K.“ after the transfer press reached the desired temperature.

Recommended temperature values: 180 – 200 °C

#### 4.3.2 Set Printing Time

Two different printing times can be adjusted:

1. Push the button „time“, and hold it. In the display „time“ (lower display) „t1“ (1. time set point) and „t2“ (2. time set point) will flash for about one second each.
2. To adjust the desired time set point: Release the button „time“, when your desired time set point (t1. or t2.) is flashing up in the display. Now only the first cypher should be flashing.
3. Set the desired value with the button „upwards“.
4. To change the second and third cypher, push the button „to the right“. It will flash up. Set the value like you did with the first cypher.

If you push the button „time“, settings will be saved and you will leave the adjustment mode.

Acceptable values: 1. time set point: 0-399 sec.  
2. time set point: 0-60 sec.

Usual printing time: 45 – 70 sec.

## 5 Printing Operation

After you adjusted your settings and the temperature was reached (the light-emitting diode "O.K." will flash) - you can begin with your printing operations.

1. If you have an SM-54, pull the sliding table out.
2. If you have a , pull the double sliding table to the left or right until it blocks.
3. Arrange the item and the corresponding artwork on the work plate.
4. If you have an SM-54, push the sliding table back into the transfer press until it blocks.
5. If you have a , pull the double sliding table towards the opposite side until it blocks.
6. Confirm both starter buttons and the same time.
7. The heat element will lower and start the operation. After the printing time is over, the heat element will rise automatically and you will hear a beep.



## 6 Exchange Heat Element and Work Plate

### 6.1 Build In and Extend a Heat Element

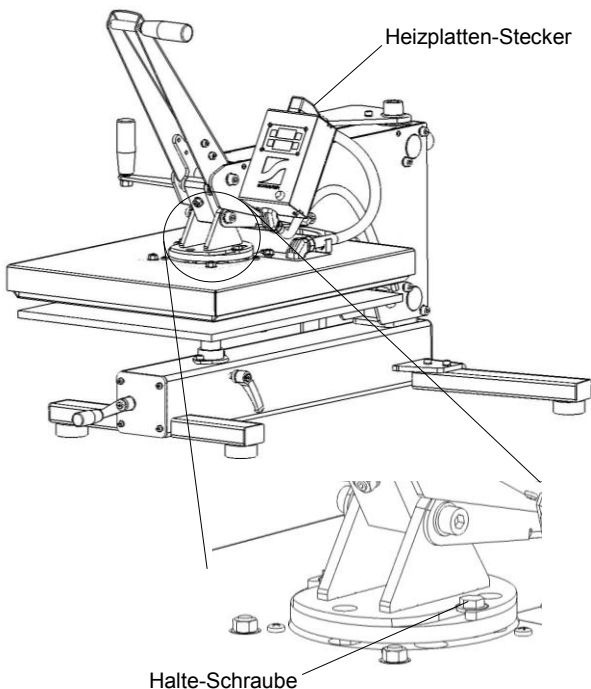

Before you start to extend the heat element, assure yourself that the heat element is cooled down to room temperature.

1. At first remove the heat element plug. To do so; you first of all have to loosen the corrugated-head screw of the heat element plug with a phillips screwdriver. Remove the heat element plug from the outlet.
2. Now you have to loosen both retaining screws of the heat element with a 13-way spanner, and screw it out for approximately 3-4 mm.
3. Lift the heat element up, and pull it towards you.
4. To build in a heat element, do the same process in reversed order.

### 6.2 Build In and Extend a Work Plate

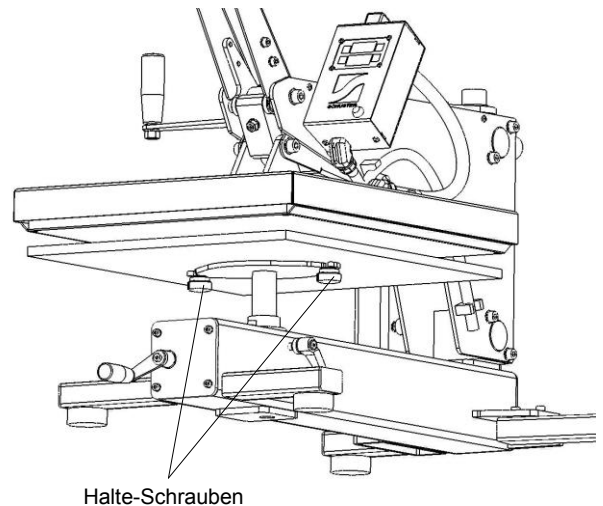

Loose both retaining screws on the underside of the work plate, then just pull the plate out towards you.

## 8 Problem Solving

Problem	Reason	Removal
Transfer press does not work after pushing the start button	1. Compressed air pipe is not connected.	Connect the compressed air pipe with the compressed air filter (Ch. 3)
	2. Compressor is turned off	Turn on the compressor
	3. Pressure regulator is closed	Turn the pressure regulator to the left (Ch. 4.2)
	4. Sliding table is not in end position	Push the sliding table until it blocks (Ch.5)
	5. Start buttons didn't get pushed at the same time	Push the start buttons both at the same time (Ch. 5)
	6. Pushed emergency stop	Open the emergency stop
After the printing process started, the heat element lowers but returns immediately into its original position.	Work plate was set up to low/ the gap between heat element and work plate is too big.	Raise the work plate, clearance max. 25 mm (Ch. 4.1)
Work plate is twisting	Height is not adjusted or insufficient locked in place.	Arrange the work plate and lock the right height adjustment through turning the clip handle to the right - until the work plate is not twistable anymore. (Ch. 4.1)



## 9 Technical Data

	SM-54	
External Dimensions L x W x H	920 x 478 x 528 mm	880 x 1150 x 528 mm
Weight	80 kg	
Voltage	230 V	
Max. current consumption	9 A	
Max. heating power	2000 W	
Temperature	Up to 210°C	
Time of pressure	1. time domain: 0 - 399 sec. 2. time domain: 0 - 60 sec	
Max. pressure	6 bar	
Max. pressure at 6 bar	17 kN $\pm$ 1,7 t	
Max. surface pressure at 6 bar on a pressure surface of 40 x 50 cm	8,7 N/cm <sup>2</sup>	
Max. height of the article to be printed on	ca. 50 mm	