

Test Equipment Depot
1-800-517-8431

99 Washington Street
Melrose, MA 02176
Phone 781-665-1400
Toll Free 1-800-517-8431





FR-803 SMD REWORK STATION

SMD Rework Station with Vacuum Pickup

Instruction Manual

Thank you for purchasing the HAKKO FR-803 SMD Rework Station.
This unit features:

- Digital control and display of time and temperature
- Display of air-flow rate
- Manual and automatic modes
- Built-in vacuum pickup

Please read this manual before operating the HAKKO FR-803.
Keep this manual readily accessible for reference.

TABLE OF CONTENTS

1. PACKING LIST	1
2. SPECIFICATIONS	1
3. WARNINGS, CAUTIONS, AND NOTES	2
4. PART NAMES.....	3
5. PREPARATION: ASSEMBLY AND ELECTRICAL CONNECTION.....	5
6. OPERATION	8
7. PARAMETERS	17
8. OFFSET SETTING METHOD	18
9. MAINTENANCE / INSPECTION	19
10. ERRO MESSAGE	20
11. TROUBLESHOOTING	20
12. OPTINAL PARTS	21
13. PARTS LIST / STATION	23
13. PARTS LIST / HANDPIECE	25
14. WIRING DIAGRAM	26

HAKKO CORPORATION
HEAD OFFICE
TEL:+81-6-6561-3225 FAX:+81-6-6561-8466
http://www.hakko.com E-mail:sales@hakko.com
OVERSEAS AFFILIATES
U.S.A.: AMERICAN HAKKO PRODUCTS, INC.
TEL: (661) 294-0090 FAX: (661) 294-0096
Toll Free (800)88-HAKKO
http://www.hakkousa.com
HONG KONG: HAKKO DEVELOPMENT CO., LTD.
TEL: 2811-5588 FAX: 2590-0217
http://www.hakko.com.hk
E-mail:info@hakko.com.hk
SINGAPORE: HAKKO PRODUCTS PTE., LTD.
TEL: 6748-2277 FAX: 6744-0033
http://www.hakko.com.sg
E-mail:sales@hakko.com.sg

Please access to the following address for the other Sales affiliates.
<http://www.hakko.com>

1. PACKING LIST

HAKKO FR-803 station	1
Power cord	1
Handpiece holder	1
Pads (ø3 mm (0.12 in.), ø5 mm (0.20 in.), ø7.6 mm (0.3 in.)).....	2 each
Vacuum pipe control knob (L).....	1
Control card	1

Check the contents of the Hakko 852 package and confirm that all the items listed below are included.

Instruction manual	1
* This product does not include a nozzle. A large selection of nozzles are available for the HAKKO FR-803. Select the nozzle or nozzles suitable for the work to be performed.	

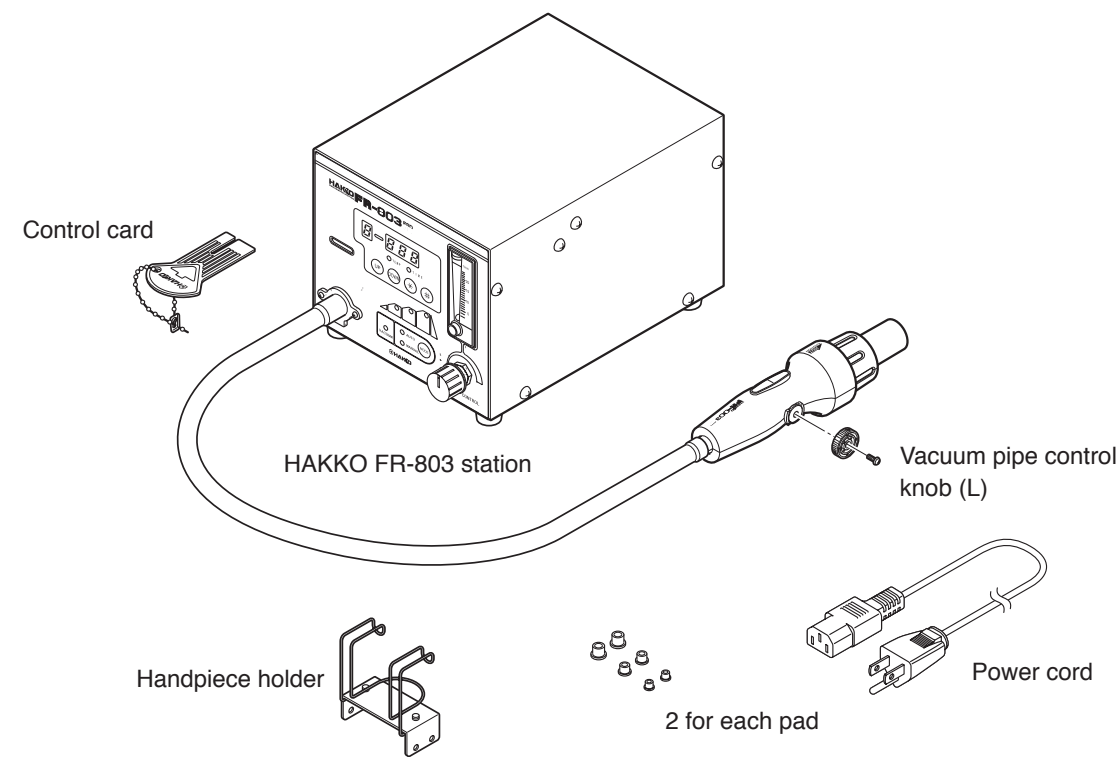

2. SPECIFICATIONS

Name	HAKKO FR-803
Power consumption	100V-310W 110V-370W 120V-440W 220V-590W 230V-650W 240V-700W

● Station	
Power consumption	100V 30 W 110-120V 40W 220-240V 50W (Standby, 100-120V 4W, 220-240V 4W)
Capacity	5 μ /min to more than 20 μ /min
Control temperature	100 ~ 450°C/200 ~ 840°F (sensor)
Modes	Manual/Auto
Timer	3 file/step
External dimensions	160 (W) × 145 (H) × 230 (D) mm/ 6.3 × 5.7 × 9.1 in.
Weight	5 kg (11.02 lb.)

● Handpiece	
Power consumption	100V-280W 110V-330W 120V-400W 220V-540W 230V-600W 240V-650W
Total length (w/o cord)	200mm/7.9 in.
Weight (w/o cord)	200 g/0.44 lb.

* This product is protected against electrostatic discharge.
* Specifications and design are subject to change without notice.

14. WIRING DIAGRAM

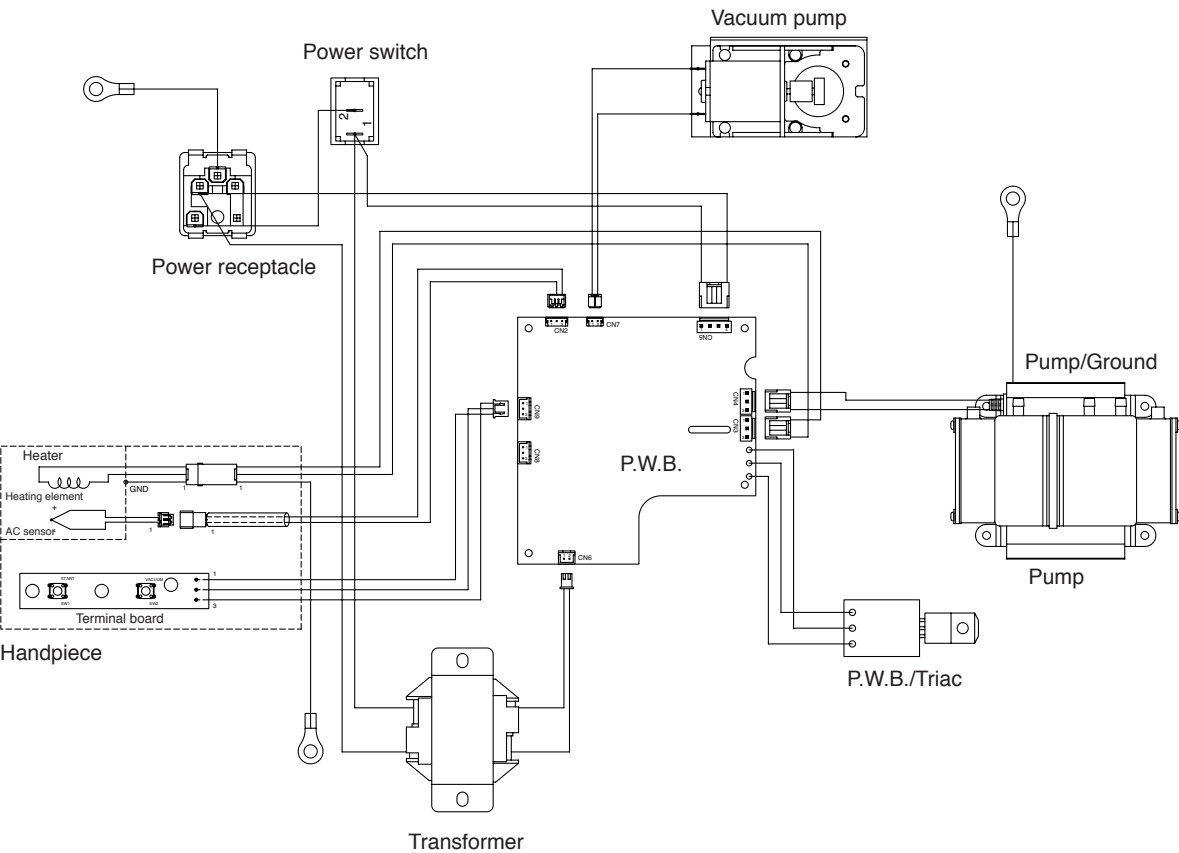

13. PARTS LIST / HANDPIECE

NOTE:
Spare or repair parts do not include mounting screws, if they are not listed on the specifications. Screws must be ordered separately.

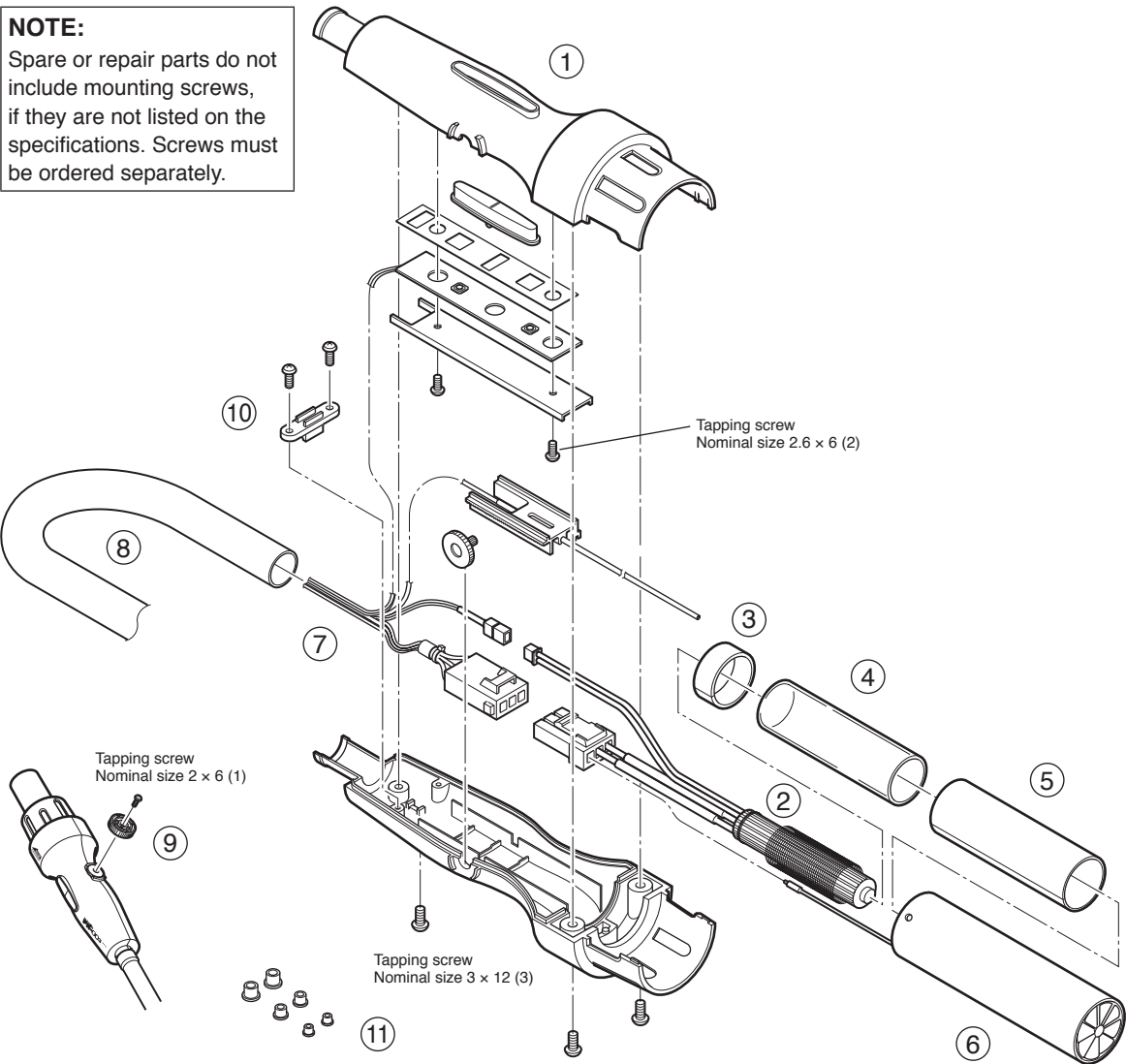

Item No.	Part No.	Part Name	Specifications
①	B3015	Handle	With screws
②	A1523	Heating element	100~120V
	A1524	Heating element	220~240V
③	B3009	Mica B	
④	B2995	Quartz glass pipe	For support heating element
⑤	B3008	Mica A	
⑥	B3095	Pipe assembly	
⑦	B3018	Cord assembly	With silicone tube
⑧	B1188	Silicone hose	

Item No.	Part No.	Part Name	Specifications
⑨	B3023	Vacuum pipe adjustment knob (L)	With screw
⑩	B1354	Cord stopper/for handle	
⑪	A1520	Pad ø3 mm (0.12 in.)	Set of 5
	A1439	Pad ø5 mm (0.20 in.)	Set of 5
	A1438	Pad ø7.6 mm (0.30 in.)	Set of 5

3. WARNINGS, CAUTIONS, AND NOTES

⚠ WARNING

Warnings and cautions are placed at critical points in this manual to direct the operator's attention to significant items. They are defined as follows:

- ⚠ **WARNING** : Failure to comply with a WARNING may result in serious injury or death.
- ⚠ **CAUTION** : Failure to comply with a CAUTION may result in injury to the operator, or damage to the items involved.
- NOTE** : A NOTE indicates a procedure or point that is important to the process being described.
- EXAMPLE** : An EXAMPLE is given to demonstrate a particular procedure point or process.

⚠ WARNING

To avoid damage to the unit, do not turn the power switch OFF until the pump stops automatically by cooling down (until  appears on the display) after use.

⚠ CAUTION

When the power is ON, the temperature of the hot air and the nozzle ranges from 100 to 450°C. (200 to 840°F.). To avoid injury to personnel or damage to items in the work area, observe the following:

- Do not direct the hot air toward personnel or touch the metal parts near the nozzle.
- Do not use the product near combustible gases or flammable materials.
- Advise those in the work area that the unit can reach very high temperatures and should be considered potentially dangerous.
- Turn the power OFF when no longer using the HAKKO FR-803 or when leaving it unattended.
- Before replacing parts or storing the unit, allow the unit to cool and then turn the power OFF.

Observe the following precautions to prevent accidents or damage to the unit.

- Do not strike the handpiece against hard surface or otherwise subject it to physical shock.
- Be sure the unit is grounded. Always connect power to a grounded receptacle.
- Do not disassemble the pump or the vacuum pump.
- Do not modify the unit.
- Use only genuine HAKKO replacement parts.
- Do not wet the unit or use the unit with wet hands.
- Remove power cord by holding the plug – not the wires.
- Do not leave the vacuum pump on for long periods of time.
- Make sure the work area is well ventilated.
- While using the HAKKO FR-803, don't do anything which may cause bodily harm or physical damage.

4. PART NAMES

Station

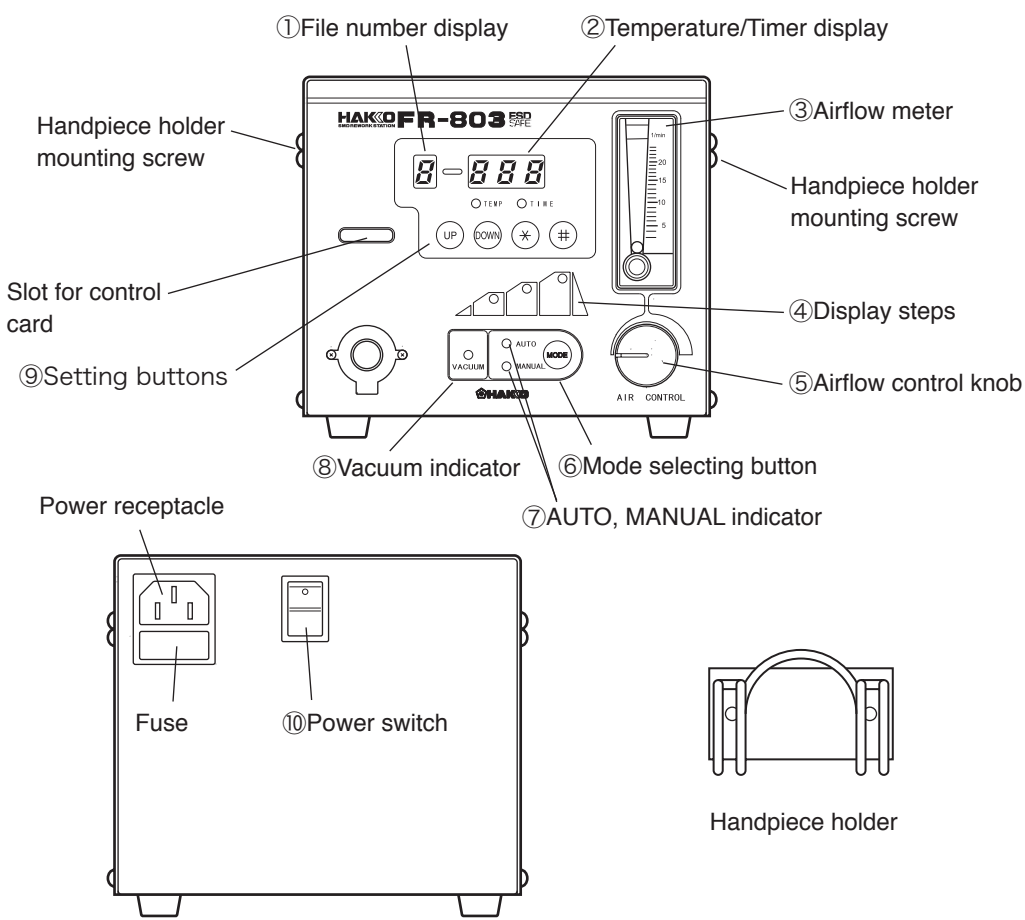

Handpiece

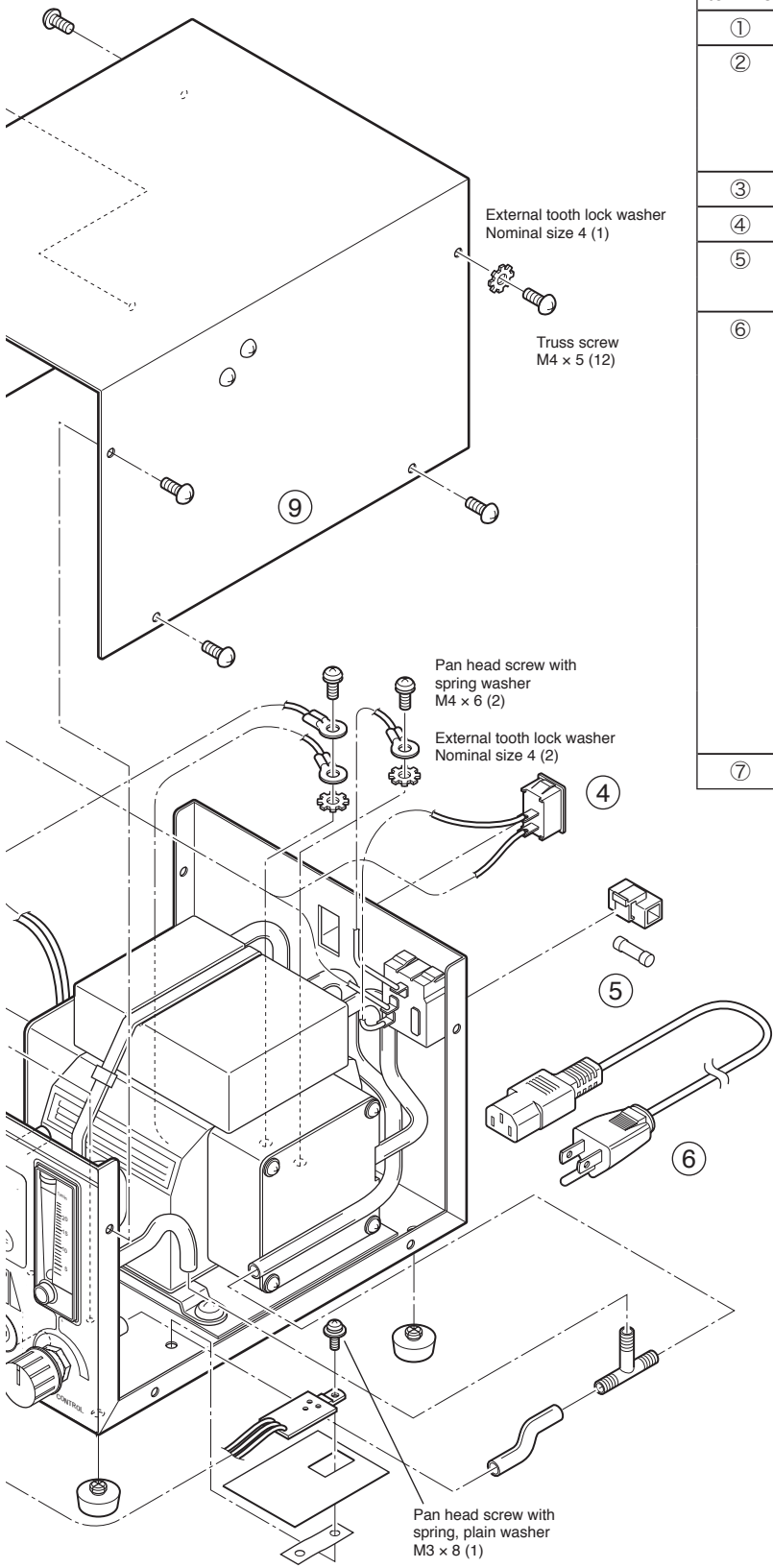
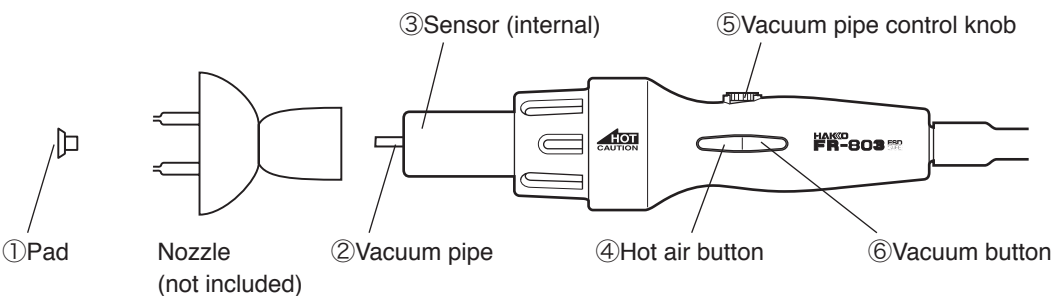

Item No.	Part No.	Part Name	Specifications
①	B3006	Handpiece holder	
②	B3016	P.W.B./for temperature control	100~120V, with triac
	B3017	P.W.B./for temperature control	220~240V, with triac
③	B1028	Knob	With screw
④	B1084	Power switch	
⑤	B2468	Fuse/125V-5A	100~120V
	B1258	Fuse/250V-3.15A (S)	220~240V
⑥	B2419	Power cord, 3 wired cord & American plug	100~120V
	B2421	Power cord, 3 wired cord but no plug	220~240V
	B2422	Power cord, 3 wired cord & BS plug	India
	B2424	Power cord, 3 wired cord& European plug	220V KTL, 230V CE
	B2425	Power cord, 3 wired cord & BS plug	230V CE, U.K.
	B2426	Power cord, 3 wired cord & Australian plug	
	B2436	Power cord, 3 wired cord & Chinese plug	China
⑦	B2972	Control card	

13. PARTS LIST / STATION

NOTE:
Spare or repair parts do not include mounting screws, if they are not listed on the specifications. Screws must be ordered separately.

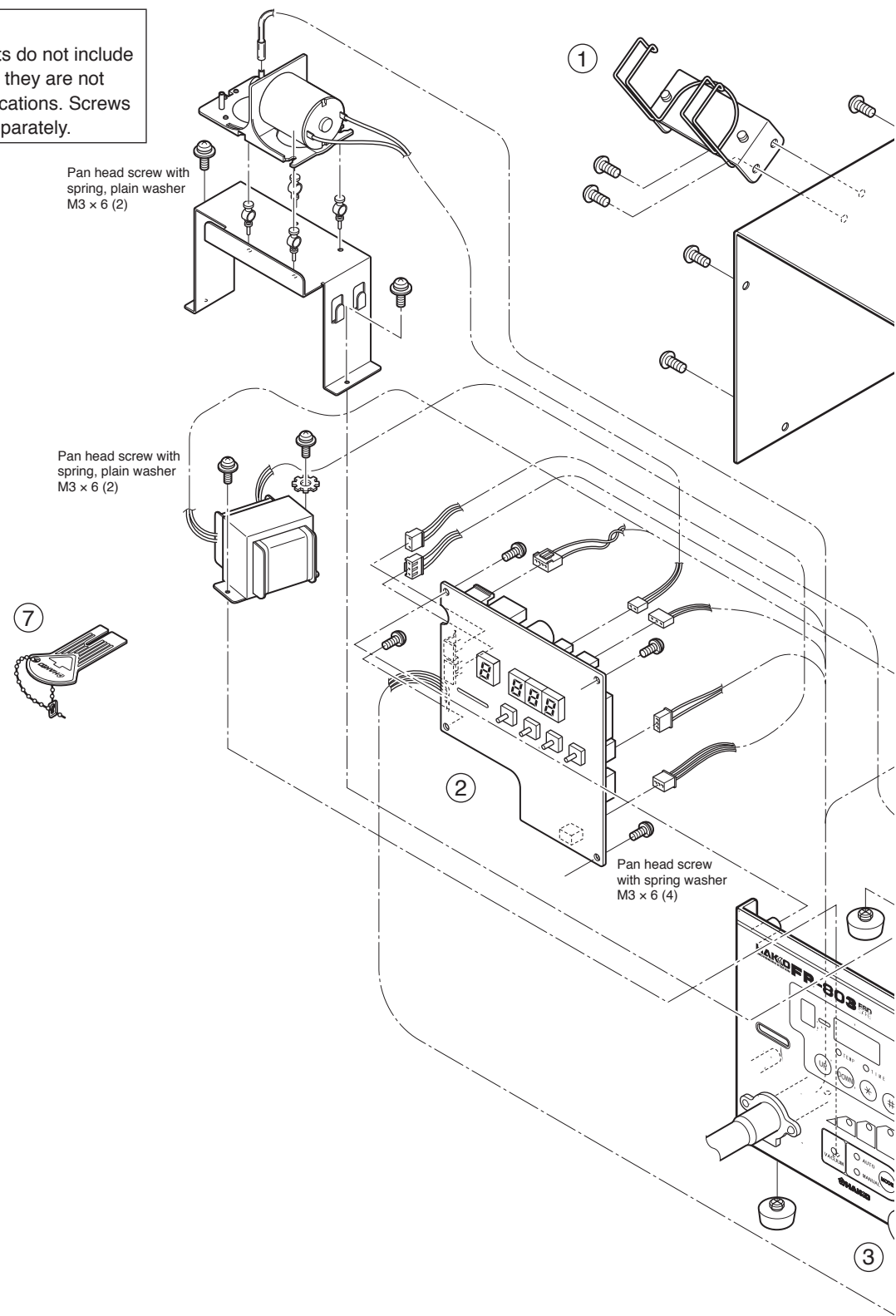

Station

- ① File number display
- ② Temperature/timer display
- ③ Airflow meter
- ④ Display steps
- ⑤ Airflow control knob
- ⑥ Mode selection button
- ⑦ AUTO/MANUAL indicator
- ⑧ Vacuum indicator
- ⑨ Setting button
- ⑩ Power switch

This section displays files 1 to 3 in Auto mode.

This section displays a temperature and timer setting time for each step in AUTO mode.

CAUTION

The displayed and set temperature indicates the temperatures at the sensor.

This meter indicates the airflow rate.

This section will be lit during every step in AUTO mode.

This knob controls the airflow. The airflow can be set in the range of 5 to 20 l/min.

This button displays and selects the MANUAL and AUTO modes.

This indicator lights the selected mode.

This indicator lights when the vacuum pump is in operation.

Use this button for setting, determining and checking the file number, temperature, timer, etc.

This switch turns the power ON and OFF.

Handpiece

- ① Pad
- ② Vacuum pipe
- ③ Sensor (internal)
- ④ Hot air button
- ⑤ Vacuum pipe control knob
- ⑥ Vacuum button

The pad absorbs parts.

The pad is mounted on the tip of the vacuum pipe.

This sensor detects the temperature of the hot air.

- MANUAL Mode
When the Start button is pressed, the unit begins blowing hot air. When the Start button is pressed again, the unit begins cooling and stops blowing hot air after reaching 100°C (200°F).
- AUTO Mode
When the Start button is pressed again, the selected AUTO program begins.

This knob controls the length of the vacuum pipe.

This button turns the vacuum pump ON and OFF.

5. PREPARATION: ASSEMBLY AND ELECTRICAL CONNECTION

A. Station Assembly

- **Attach the handpiece holder.**
Remove the handpiece holder mounting screw from the side of the station. Attach the handpiece holder to the station. (Figure 1)
(The handpiece holder can be installed on either the left or right side.)

B. Handpiece Assembly

NOTE:
The handpiece can be used with the provided vacuum pipe control knob (L). (See figure 2.)

- **Using vacuum function operative nozzle (see page 21.)**

- 1. Attach the nozzle.**
 - a. Extend the vacuum pipe using the vacuum pipe control knob. (Figure 3)
 - b. Remove the inside screw (M3 × 5) of the nozzle. (Figure 4)
 - c. Loosen the nozzle mounting screw. Pass the vacuum pipe through the nozzle hole and attach the nozzle. (Figure 5)
 - d. Tighten the nozzle mounting screw.
- 2. Attach the pad.**
 - a. Attach the pad. (Figure 7)
 - b. Adjust the pad to an appropriate position. Adjust the vacuum pipe so that the pipe and pad protrude as little as possible.

CAUTION
The nozzle and pad will be heated at high temperature. Cool them before replacement.

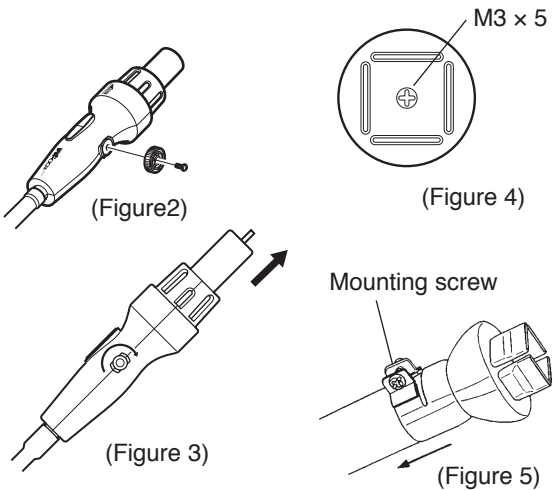
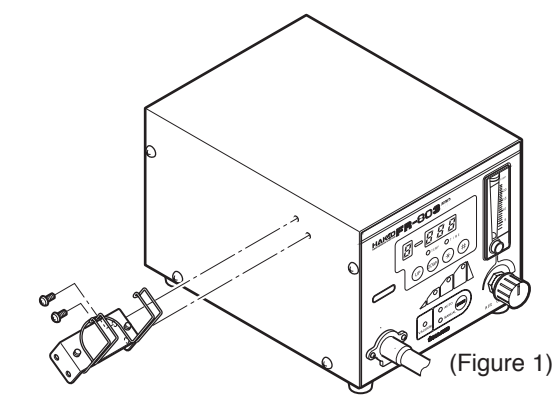

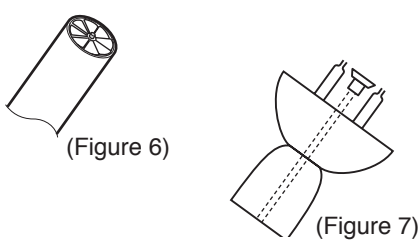

CAUTION
● **Vacuum pipe**
Do not use excessive force.
When not using a nozzle, retract the vacuum pipe to the shortest length. (Figure 6)



CAUTION
● **Pad**
The pad does not last indefinitely. When it becomes deteriorated, replace it. Since exposure to high temperatures causes it to deteriorate faster, Hakko recommends it be cooled after use.

● Vacuum function inoperative nozzles.

Unit: mm (inch)

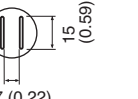
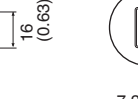
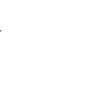
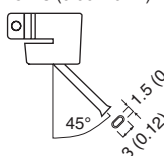
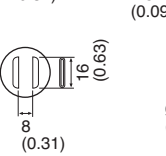
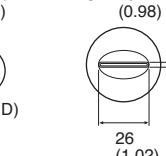
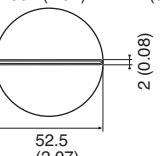
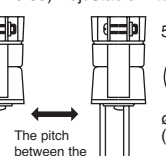
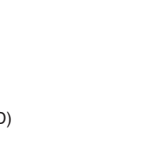
A1124B Single Ø2.5 (0.09)	A1130 Single Ø4.4 (0.17)	A1131 SOP 4.4 × 10 (0.17 × 0.39)	A1132 SOP 5.6 × 13 (0.22 × 0.51)	A1133 SOP 7.5 × 15 (0.3 × 0.59)	A1134 SOP 7.5 × 18 (0.3 × 0.7)
					
Ø2.5 (I.D.) (0.09)	Ø4.4 (I.D.) (0.17)	4.8 (0.19)	5.7 (0.22)	7.2 (0.28)	7.2 (0.28)
A1142B Bent Single 1.5 × 3 (0.06 × 0.12)	A1183 SOJ 15 × 8 (0.59 × 0.31)	A1190 Dual Single 2.5 × 9.5 Pitch (0.09 × 0.37)	A1191 SIP 25L (0.98)	A1192 SIP 50L (1.97)	A1325 Dual Single Ø1.5 × 5-10 (0.06 × 0.2-0.39) Adjustable Pitch
					
45° 1.5 (0.06) 3 (0.12)	8 (0.31)	Ø2.5 (I.D.) (0.09)	26 (1.02)	52.5 (2.07)	The pitch between the two nozzles is adjustable. 5 (0.2) 10 (0.39) Ø1.5 (I.D.) (0.06)

CAUTION
Do not use No. **A1124B** Single ø2.5 (0.09) and No. **A1142B** Bent Single 1.5 × 3 (0.06 × 0.12) nozzle with the HAKKO FR-803. These nozzles do not have space to blow hot air, using them with the HAKKO FR-803 may result in danger.

12. OPTINAL PARTS

CAUTION
The size in Name/Specification indicates the size of IC package.

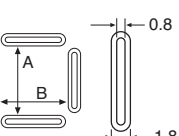
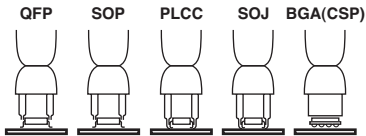

Air nozzle (common to all nozzles)

	C0.8 D1.8	C1.0 D2.0	C0.8 D2.0
No.	A1125B~A1129B A1131~A1141B A1180B~A1189B A1203B~A1266B	A1191	A1192

● Vacuum function operative nozzles.

*HAKKO FR-801 and FR-802 are not equipped with the vacuum function.

Unit: mm (inch)

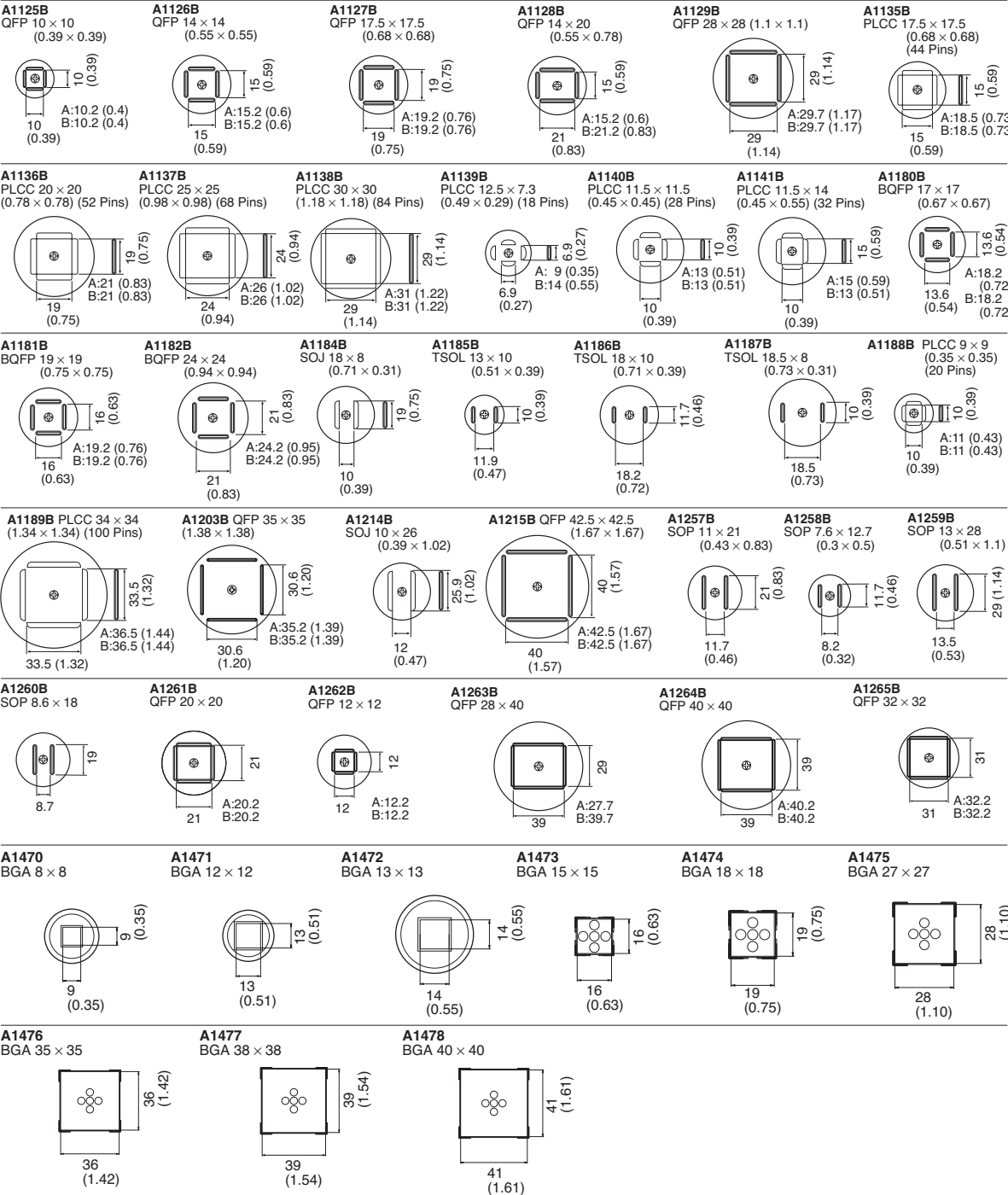

● Using vacuum function inoperative nozzle (see page 22.)

- **Attach the nozzle.**
 - Retract the vacuum pipe to the shortest length using the vacuum pipe control knob. (See page 5, Figure 6)
 - Loosen the nozzle mounting screw. Attach the nozzle. (See page 5, Figure 5)
 - Tighten the nozzle mounting screw.

CAUTION
The pad cannot be used with this type of nozzle.

C. Electrical Connection and Power ON

- Connect the power cord to the power receptacle on the back panel of the station. (Figure 8)
- Place the handpiece on the holder. (Figure 9)
- Plug the power cord into a grounded wall socket.
- Turn the power switch ON.

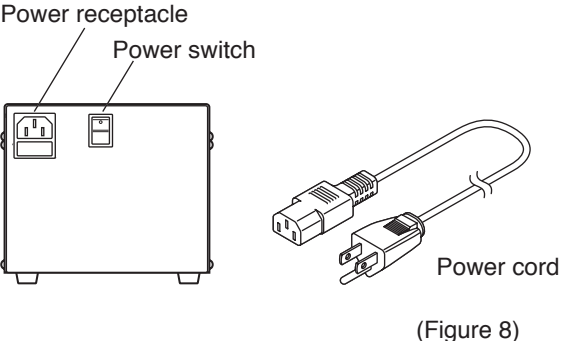

CAUTION
This product is ESD-protected. Be sure to use a grounded wall socket.

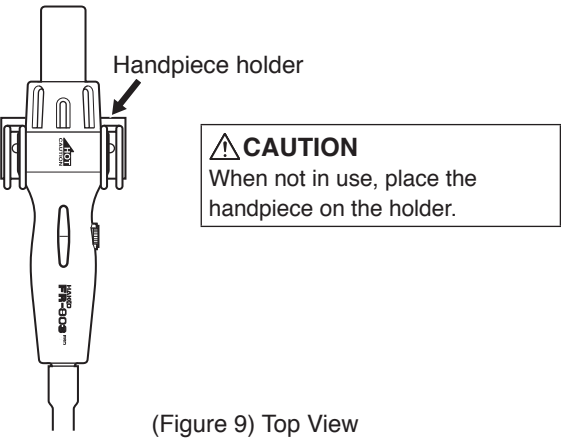

CAUTION
When not in use, place the handpiece on the holder.

6. OPERATION

A. Mode Selection

Insert the control card into the card slot and select your desired mode using the mode selection button. (Figure 10)

The HAKKO FR-803 provides the following two modes. The AUTO mode consists of the INSTALL and REMOVE modes.

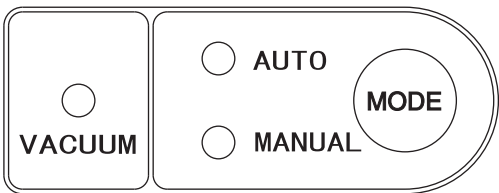

(Figure 10)

Manual Mode

In this mode, air and vacuum pump operation are controlled entirely by manual operation.

NOTE:
The timer cannot be set when using MANUAL mode.

AUTO mode

Install Mode (AUTO) (See page 14.)

This mode is used when installing parts. The vacuum pump will be automatically turned OFF.

In INSTALL mode, turn ON the vacuum function manually and align the component on the PWB. Vacuum function automatically will turn OFF 5 seconds after starting selected the profile.

Remove Mode (AUTO) (See page 13.)

This mode is used when removing parts. The vacuum pump will be automatically turned ON.

In REMOVE mode, the vacuum function automatically turns ON during the last 10 seconds of the selected profile. Set the temperature profile shown in the following figure in advance.

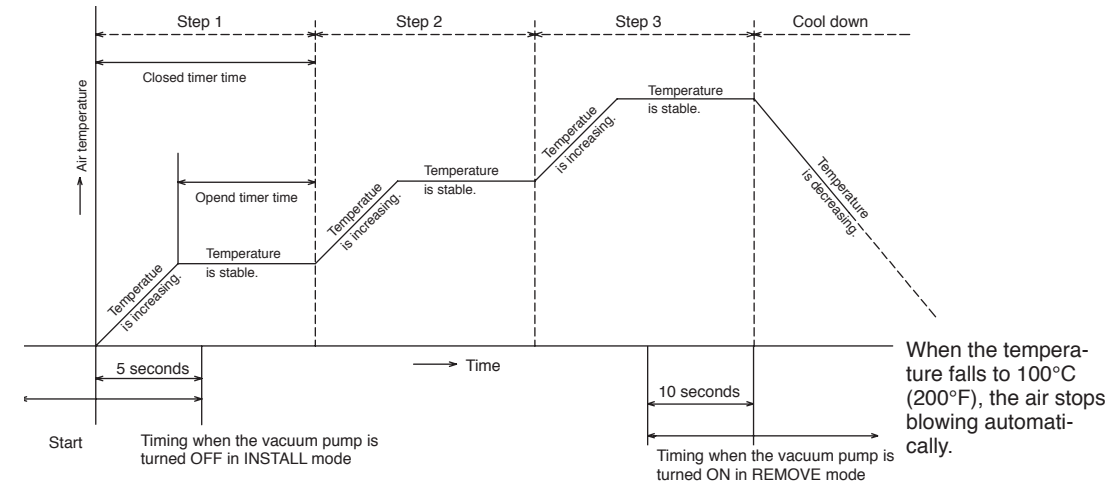

* In REMOVE mode, turn OFF the vacuum pump manually.

10. ERROR MESSAGE

When the error detection software in the HAKKO FR-803 detects an error, a message is displayed to alert the operator. See “Troubleshooting” for procedures to correct the error.

Sensor Error



This error occurs when there is the possibility of a sensor failure (or a failure in the sensor circuit). **S-E** flashes and the power is shut down.

Heater Error



This error occurs when the temperature of the hot air is falling even though the heater is on. The **H-E** flashes to indicate the possibility of a heater failure.

11. TROUBLESHOOTING

WARNING

Before checking the inside of the HAKKO FR-803 or replacing parts, be sure to disconnect the power plug. Failure to do so may result in electric shock.

The unit does not operate when the power switch is turned ON.

CHECK : Is the power cord or connection plug disconnected?
ACTION : Connect it.
CHECK : Is the fuse blown?
ACTION : Investigate why the fuse blew and then replace the fuse.

S-E flashes, indicating a sensor error.

CHECK : Is the sensor broken?
ACTION : Measure the resistance value of the sensor. The normal value is 0 Ω. If the resistance value is abnormal, replace the parts with new parts.

H-E flashes, indicating a heater error.

CHECK : Is the heater broken?
ACTION : Measure the resistance value of the sensor. The normal value is 33 Ω (±10%) (100-120V), 85Ω (±10%) (220-240V) at room temperature. If the resistance value is abnormal, replace the parts with new parts.

The profile cannot be set.

CHECK : Is the station in Auto mode?
ACTION : Put the station into Auto mode.
CHECK : Is the value outside the setting range?
ACTION : Enter a value that is within the setting range.

The vacuum pump does not stop when the vacuum button is pressed.

CHECK : Is the VACUUM button being pressed?
ACTION : Press the VACUUM button.

9. MAINTENANCE / INSPECTION

● Broken Heater or Sensor

① Open the handpiece.

- 1. Retract the vacuum pipe to its shortest length.
- 2. Move the tube downward.
- 3. Remove the three screws holding the handpiece together.
- 4. Remove the pipe from the protruding portion of the handle.

CAUTION
Quartz glass and heat insulation are inside the pipe. Be careful not to drop or lose these items.

- 5. Disconnect the heater sensor connector and remove the heater.

CAUTION
Do not apply excessive force to the vacuum pipe.

② Measure the resistance value.

- 1. Measure the resistance value (a) of the sensor. The normal value is 0Ω.
- 2. Measure the resistance value (b) of the heater. The normal values are approximately 33Ω (±10%) (100-120V), 85Ω (±10%) (220-240V) at room temperature. If the resistance value is abnormal, replace the part.
(Refer to the instructions included with the replacement part.)

● Replacing the Fuse

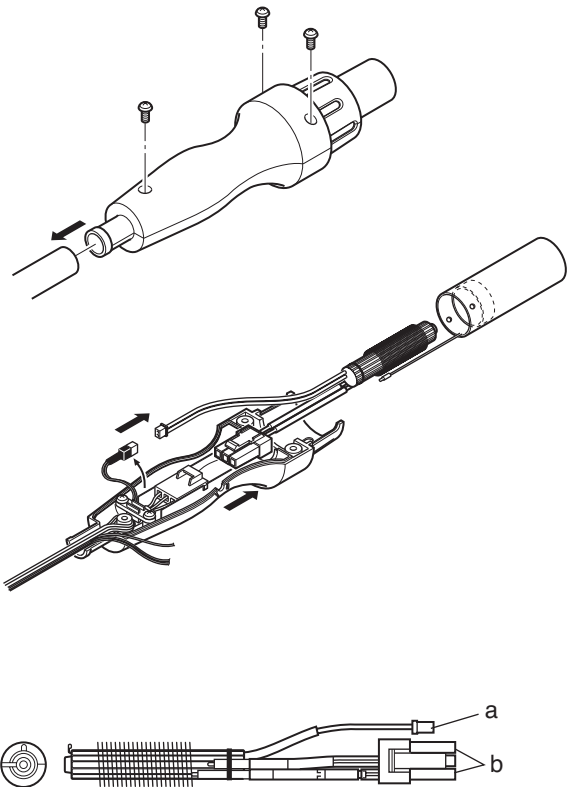
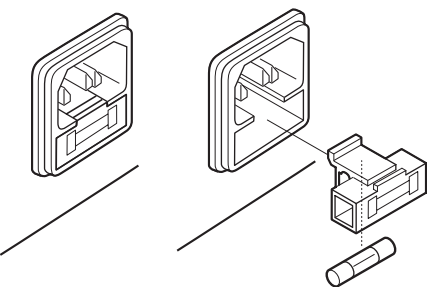

CAUTION
Since there are various hazards with replacing the heating element, be sure to turn off the power and replace them according to the above procedure.

- 1. Unplug the power cord from the power receptacle.
- 2. Remove the fuse holder.
- 3. Replace the fuse with new one.
- 4. Put the fuse holder back in place.

6. OPERATION

B. Selecting Manual Mode

The temperature/timer is displayed by . The HAKKO FR-803 is preset at 300°C at the factory, see page 9.

● Air Blow

- 1. Start**
Press the HOT AIR button on the hand-piece to start the flow of air. The hot air blows from the tip of the nozzle, and the temperature is controlled according to the temperature setting.
- 2. Stop**
Press the HOT AIR button again. Power to the heater is shut off and cooling begins. When the temperature falls to 100 °C. (200°F.), the air stops blowing and the temperature display reads .

● Vacuum Function

- This function is used to hold the component securely to the pads.
- 1. Start**
Press the Vacuum button on the hand-piece. The vacuum pump turns ON and the part is held by suction.
- 2. Stop**
Press and hold the Vacuum button. The vacuum pump turns OFF.

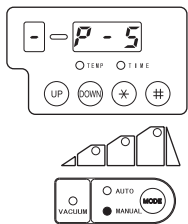

To check the set temperature, press the button.

CAUTION
To avoid damage to the equipment, do not turn the power switch OFF until appears on the display.

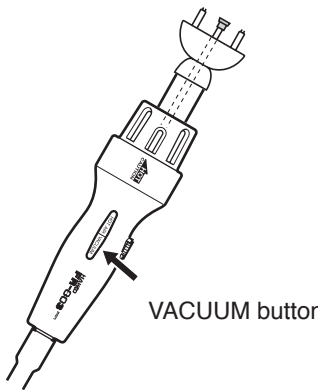
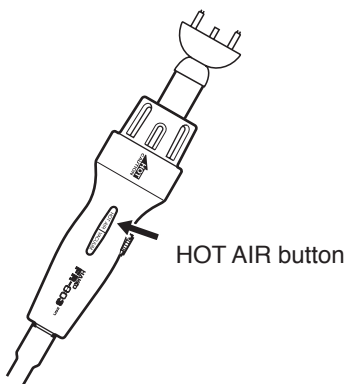

CAUTION
Parts held by the pads are very hot. Be careful when removing them from the pads.

6. OPERATION

C.Temperature change method in MANUAL mode

CAUTION
Be sure to insert the control card into the card slot and set the mode to MANUAL before changing.

Setting change in temperature

CAUTION
The temperature setting range is 100 to 450°C (200 to 840°F).

Example: Change the temperature setting from 300 to 450°C.

- 1. Press the **✱** button on the temperature setting section for 1 sec. or more.
 - The HUNDREDS digit flashes on the display, indicating that the HUNDREDS digit can be entered.
- 2. Enter the HUNDREDS digit.
 - Use the **UP** or **DOWN** buttons to select your desired value for the HUNDREDS digit. When your desired value is displayed, press the **✱** button. The TENS digit begins to flash.
- 3. Enter TENS digit.
 - Use the **UP** or **DOWN** buttons to select your desired value for the TENS digit. When your desired value is displayed, press the **✱** button. The UNITS digit begins to flash.
- 4. Enter the UNITS digit.
 - Select your desired value for the UNITS digit in the same manner as for the TENS digit. When your desired value is displayed, press the **✱** button. **SET** displays and indicates that the temperature setting procedure is completed.

CAUTION
If the power is turned OFF before the temperature setting procedure is completed (**SET** is not displayed), the new setting value will not be stored in memory.

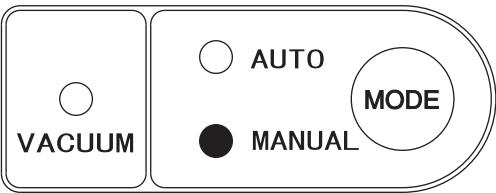

- Attempting to enter a value outside the setting range will cause the display to begin flashing the HUNDREDS digit again. Reenter a correct value.
- Both the display temperature and the temperature setting are the temperature at the sensor. (Even with the same temperature setting, the temperature of the hot air differs depending on the nozzle size.)

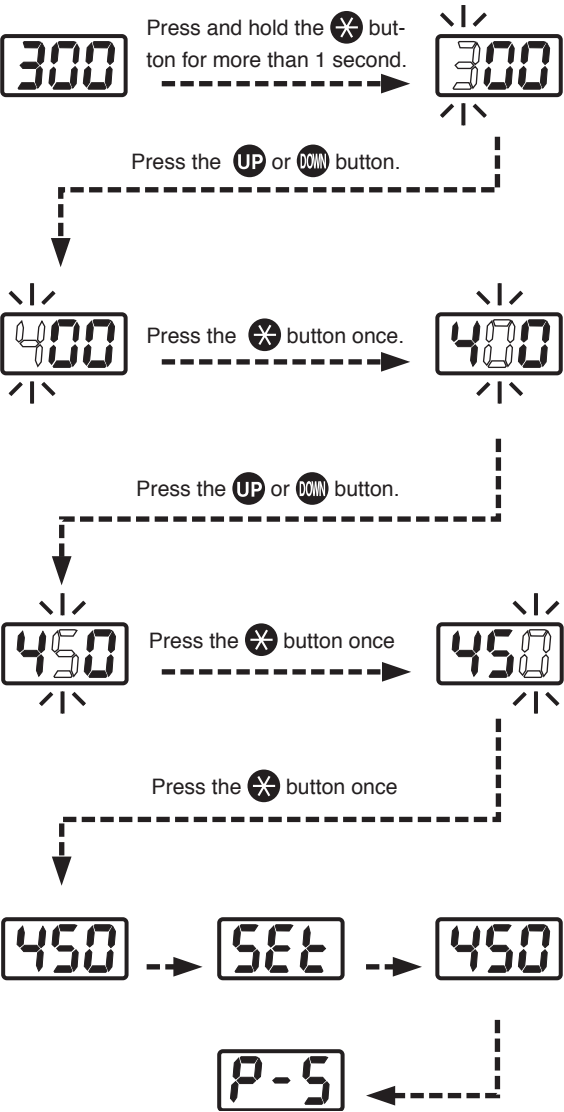

● Factory setting

CAUTION
Be sure to insert the control card into the card slot before initial resetting.

Turn the power switch ON while simultaneously pressing the **UP**, **DOWN** and **✱** buttons to reset the initial set values upon shipment from the factory. The mode is displayed in MANUAL.
Upon shipment from the factory, the data are set to the values as shown in the right tables.

<In MANUAL mode>

Temperature	300°C
Offset value	0

<In AUTO mode>

		File 1	File 2	File 3
Mode		INSTALL	INSTALL	INSTALL
Step 1	Setting temp.	200°C	200°C	200°C
	Timer time	30	30	30
Step 2	Setting temp.	250°C	250°C	250°C
	Timer time	30	30	30
Step 3	Setting temp.	300°C	300°C	300°C
	Timer time	30	30	30

8. OFFSET SETTING METHOD

NOTE:
The temperature at the blowout port varies depends on the nozzle size. The offset temperature can be selected.

CAUTION
Change the mode to MANUAL before setting. The operations cannot be performed in AUTO mode.

Be sure to insert the control card.

- 1. Press the **#** button for 1 second or more.
The mode will be shifted to the offset inputting mode.
- 2. Input the offset value.
The input range is -50 to + 50°C (In °F mode, from -90 to + 90°F)
Enter the HUNDREDS digit.
 - a. Use the **UP** or **DOWN** buttons to select your desired value for the HUNDREDS digit. Only 0 (in case of positive) and – (in case of negative) can be input (the same as in °F mode). Select 0 or – and press the **✱** button. The TENS digit begins to flash.**Enter the TENS digit.**
 - b. Use the **UP** or **DOWN** buttons to select your desired value for the TENS digit. When your desired value is displayed, press the **✱** button. The UNITS digit begins to flash.**Enter the UNITS digit.**
 - c. Select your desired value for the UNITS digit in the same manner as for the TENS digit. When your desired value is displayed, press the **✱** button. **SET** displays and indicates that the temperature setting procedure is completed.

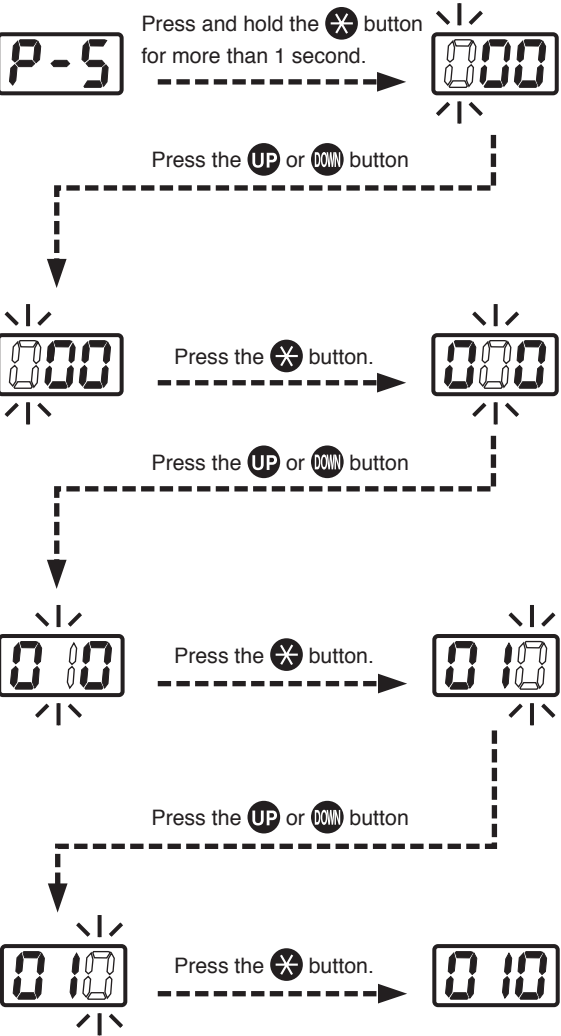

6. OPERATION

D-1 Setting method in AUTO/INSTALL mode

● Operations in INSTALL mode

This mode has the following sequence:

- ① Vacuum ON (Manual)
- ② Start/hot air blow (Manual)(Step/start)
- ③ Vacuum OFF after 5 seconds
- ④ Step 1 operation
- ⑤ Step 2 operation
- ⑥ Step 3 operation
- ⑦ Cool down operation

NOTE:
The operation can be set from 1 to 3.

● Installation

• Advance preparation of P.W.B.
Apply an appropriate amount of solder paste to the P.W.B.)

① Part suction and positioning

Press the VACUUM button on the handpiece. Have the part sucked by the pads and position the part on the P.W.B. (Figure 1)

② Start (heating)

Press the HOT button on the handpiece. Hot air blows from the nozzle to melt the solder. The station operates based on the preprogrammed temperature profile. (Figure 2)

CAUTION
To stop the program, press the HOT AIR button. Cooling begins.

③ Vacuum stop

After 5 seconds, the vacuum turns OFF and the part is released from suction. (Figure 3)

④ Stop

When the step operation is completed, cooling begins. Make sure the solder has hardened before lifting the handpiece. (Figure 4)

In INSTALL mode, press the HOT AIR button after turning the vacuum function ON manually and aligning the component on the PWB. Vacuum function automatically will turn OFF 5 seconds after starting selected the profile.

To check the temperature setting, press the button. To change the temperature setting, see “Setting method in AUTO mode” on page 13.

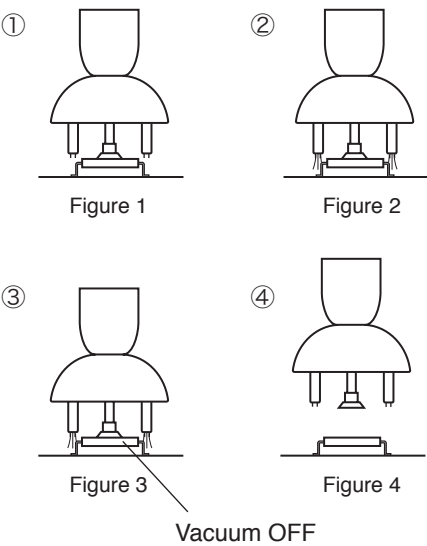

9. File writing

Press the button for 1 second or more to shift into the file writing mode. Use the or buttons to display and press the button. The file writing will be completed.

NOTE:
If is selected, the data will be returned to the data before change and the mode will be shifted to the file number selection mode.

* In AUTO mode, files are not selected. Select the file to be used and start it.

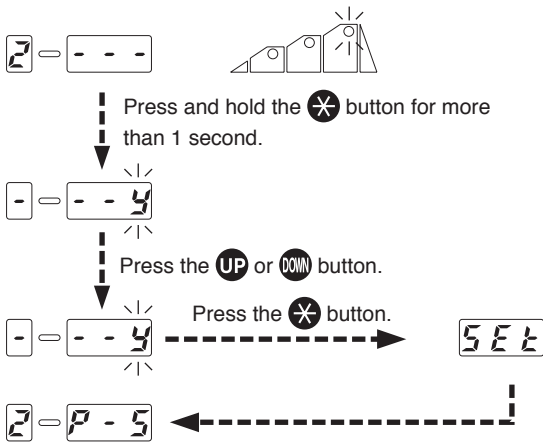

F. Airflow adjustment

Adjust the flow rate of the hot air while watching the airflow meter. The adjustment range is 5 ℓ/min to 20 ℓ/min.

CAUTION
Do not apply excessive force when turning the airflow control knob.

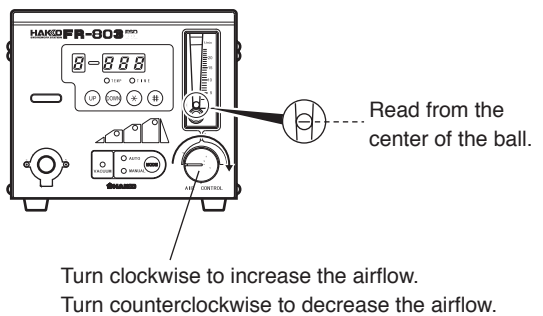

G. Set data checking method

Setting in Auto mode

Select your desired file No. in advance.

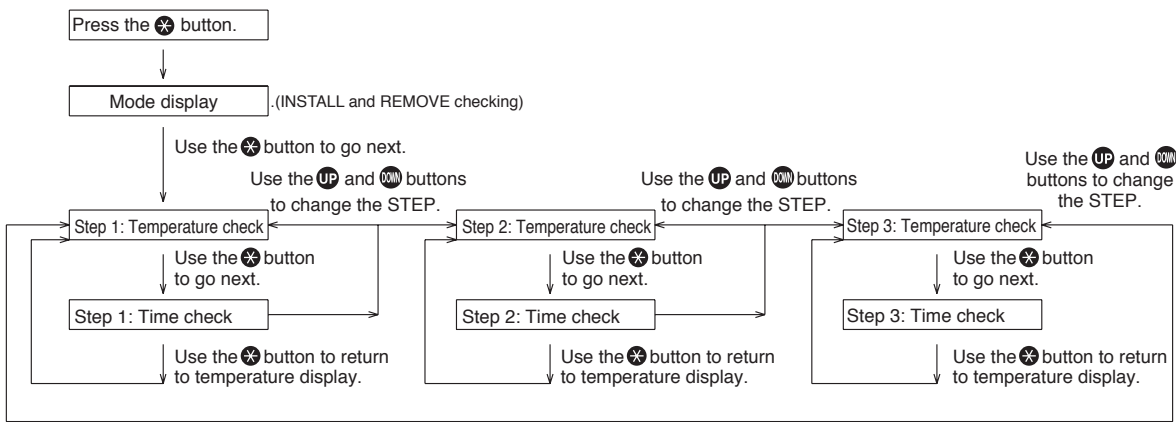

* If no button is input for 2 seconds or more in any condition, the unit will be returned to normal conditions.

6. OPERATION

7.

a.

The HUNDREDS digit on the temperature/ timer display section flashes. Press the button to select. The TENS digit begins to flash.

b.

Enter the TENS digit.
Use the or button to select your desired value for the TENS digit. If your desired value is displayed, press the button. The UNITS digit begins to flash.

c.

Enter UNITS digit.
Use the or button to select your desired value for the UNITS digit. When your desired value is displayed, press the button. The mode will be shifted to **the timer time setting mode in step 3.**
8.

a.

The HUNDREDS digit on the temperature/ timer display section flashes. Press the button to select. The TENS digit begins to flash.

b.

Enter the TENS digit.
Use the or button to select your desired value for the TENS digit. If your desired value is displayed, press the button. The UNITS digit begins to flash.

c.

Enter UNITS digit.
Use the or button to select your desired value for the UNITS digit. If your desired value is displayed, press the button. The temperature and timer setting in step 3 will be completed and shifted to **the step selection mode.**

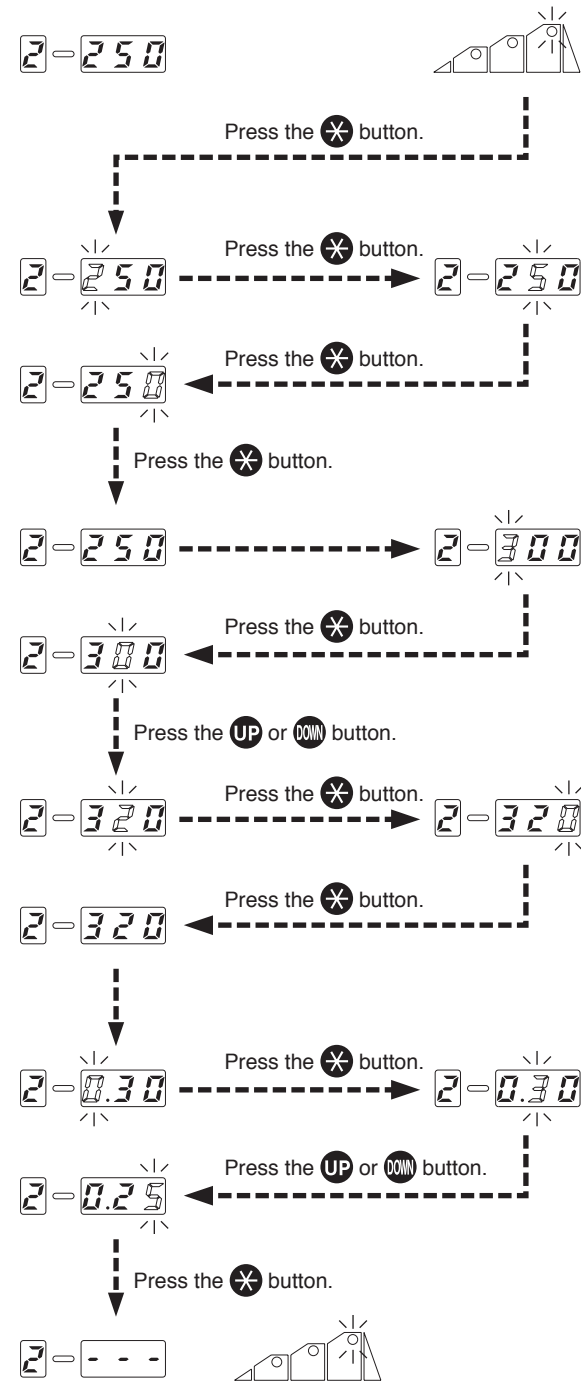

D-2 Setting method in AUTO/REMOVE mode

● Operations in REMOVE mode

This mode has the following sequence:

- ①

Start/hot air blow (manual)
- ②

Step 1 operation
- ③

Step 2 operation
- ④

Step 3 operation
- ⑤

Ten seconds before the last step is completed, the vacuum automatically turns ON and then a single sound lasting 1 second is generated. Two seconds before completion, a continuous sound is generated.
- ⑥

Vacuum OFF (manual)
- ⑦

Cool down

NOTE:

The operation can be set from 1 to 3.

● Removal

• Parts mounting

Mount the nozzle and pads on the part to be removed. (Figure 1)

① Start (heating)

Press the HOT AIR button on the handpiece. Hot air blows from the nozzle and melts the solder. The station operates based on the preprogrammed temperature profile. (Figure 2)

⚠ CAUTION

To stop the program, press the HOT AIR button. Cooling begins.

② Part suction

When the timer runs down to 10 sec., the vacuum automatically turns ON and the part is sucked. Lift the handpiece and remove the part from the P.W.B. (Figure 3)

③ Releasing the sucked part

To release the sucked part, press the VACUUM button. (Figure 3)

④ Stop

After that, when the step operation is completed, cooling begins and the airflow stops as soon as the temperature reaches 100°C (200°F). (Figure 4)

In REMOVE mode, the vacuum function automatically turns ON during the last 10 seconds of the selected profile.

To check the set temperature, press the button.
To change the set temperature, see “Setting mode in AUTO mode” on page 13.

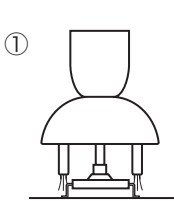

Figure 1

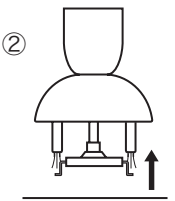

Figure 2

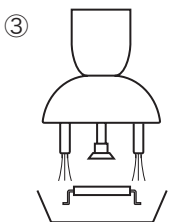

Figure 3

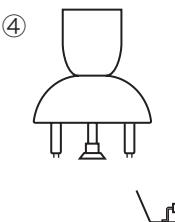

Figure 4

⚠ CAUTION

If the vacuum button is pressed before the timer runs down to 10 seconds, the vacuum pump turns ON. Press the vacuum button again to stop the air blowing.

6. OPERATION

E. File changing method in AUTO mode

⚠CAUTION

Be sure to insert the control card into the card slot before changing.

File initial setting

		File 1	File 2	File 3
Mode		INSTALL	INSTALL	INSTALL
Step 1	Setting temperature	200	200	200
	timer time	30	30	30
Step 2	Setting temperature	250	250	250
	timer time	30	30	30
Step 3	Setting temperature	300	300	300
	timer time	30	30	30

Example: When file 2 is changed as follows:

		File 2
Mode		REMOVE
Step 1	Setting temperature	250
	timer time	25
Step 2	Setting temperature	250
	timer time	30
Step 3	Setting temperature	320
	timer time	25

1. If the button is pressed for 1 second or more, the file number display section flashes. Select the file number using the or button. If your desired file number is displayed, press the button. The mode will be shifted to **the INSTALL or REMOVE selection mode**.
2. Use the or button to display . Then, press the button to select and shift to **the step selection mode**.
3. Select your desired step using the or button. Display your desired step and press the button to select. After that, the mode will be shifted to **temperature setting mode in step 1**.

NOTE:

The temperature setting range:
100°C - 450°C (200°F - 840°F).

The time setting range:
0 sec. - 300 sec. (0 min. - 5 min.)

- Attempt to enter a value outside the setting range will cause the display to begin flashing the HUNDREDS digit again. Reenter a correct value.
- Both the display temperature and the temperature setting are the temperature at the sensor. (Even with the same temperature setting, the temperature of the hot air differs depending on the nozzle size.)
- If the time setting is set to 0 sec., the step can be cancelled.

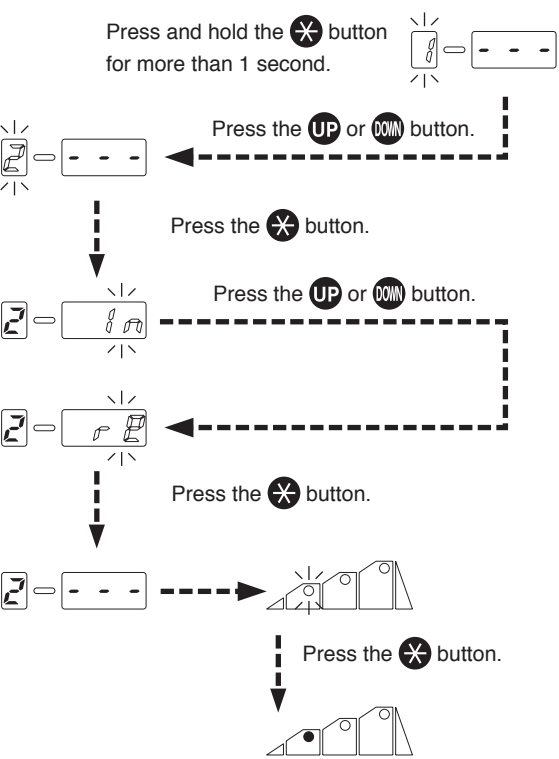

4. a. The HUNDREDS digit on the temperature/timer display section flashes. Press the button to select. The TENS digit begins to flash.
- b. Enter the TENS digit.
Use the or button to select your desired value for the TENS digit. If your desired value is displayed, press the button. The UNITS digit begins to flash.
- c. Enter UNITS digit.
Use the or button to select your desired value for the UNITS digit. If your desired value is displayed, press the button. The mode will be shifted to **the timer time setting mode in step 1**.
5. a. The HUNDREDS digit on the temperature/timer display section flashes. Press the button to set the HUNDREDS digit to 0. The TENS digit begins to flash.
- b. Enter the HUNDREDS digit.
Use the or buttons to select your desired value for the TENS digit. When your desired value is displayed, press the button. The UNITS digit begins to flash.
- c. Enter the UNITS digit.
Use the or buttons to select your desired value for the TENS digit. When your desired value is displayed, press the button. The mode will be shifted into **the step selection mode**.
6. Use the or buttons to select your desired step. Since it is not changed in step 2, select step 3. When your desired value is displayed, press the button to select. The mode will be shifted to **the temperature setting mode**.

