



WMY 71283 MLCW

You can rely on Defy. To simplify.

Front Loader Washing Machine

Users Manual

Record in the space below the listed information for future reference. The serial number is on the serial label located on the inside of the door of the washing machine.

SERIAL NUMBER.....

DATE OF PURCHASE.....

PURCHASED FROM.....

.....

The manufacturer strives for continuous improvement. For this reason, the text and illustrations in this manual are subject to change without notice.





Please read this user manual first!

Dear Customer,

Thank you for choosing a Defy washing machine. We hope that you get the best results from your machine which has been manufactured with high quality and state-of-the-art technology. Please read this entire user manual and all other accompanying documents carefully before using the machine and keep it as a reference for future use. If the machine is handed over to a new owner please ensure that the user manual accompanies the machine.

Explanation of symbols

Throughout this user manual the following symbols are used:

	Important information or useful hints about usage.
	Warning for hazardous situations with regard to life and property.
	Warning for electric shock.
	Recyclable materials.

Do not dispose of the packaging materials together with the domestic or other wastes. Take them to the packaging material collection points designated by the local authorities.

PLEASE REGISTER YOUR Machine AT
www.defy.co.za

DEFY APPLIANCES (PTY) LTD P.O.BOX 12004
JACOBS DURBAN
4026
SOUTH AFRICA

1 Important instructions for safety and environment

This section contains safety instructions that will help protect you from risk of personal injury or property damage. Failure to follow these instructions shall void any warranty

1.1 General safety

- This washing machine is not intended for use by persons (including children) with reduced physical, sensory or mental capabilities or lack of experience and knowledge unless they have been given supervision or instruction concerning the use of the washing machine by a person responsible for their safety.
- Children must be supervised to ensure that they do not play with the washing machine.
- Cleaning and maintenance works must not be performed by children unless they are supervised by a person responsible for their safety.
- Never place the machine on a carpet covered floor. Lack of airflow beneath the machine will cause electrical parts to overheat. This will result in problems with the machine.
- If the machine has a failure, it must not be operated unless it is repaired by an authorized Service Agent. There is the risk of an electric shock!
- This machine is designed to resume operating in the event of powering on after a power interruption. If you wish to cancel the programme, see “Cancelling the programme” section.
- Connect the machine to a grounded outlet protected by a 16 A fuse. Do not neglect to have the grounding installation made by a qualified electrician. Our company shall not be liable for any damages that may arise if the machine is used without grounding in accordance with the local regulations.
- To avoid the risk of water leakage, the water supply and draining hoses must be securely fastened and remain undamaged.
- To avoid the risk of flooding and injury from hot water, never open the loading door or remove the filter while there is still water in the drum.
- Do not force open the locked loading door. The loading door will be ready to open just a few minutes after the washing cycle comes to an end. In case of forcing the loading door to open, the door and the lock mechanism may get damaged.
- Unplug the machine when not in use.
- Never wash the machine by spreading or pouring water onto it! There is the risk of electric shock!
- Never touch the plug with wet hands! Never unplug by pulling on the cable, always pull out by grabbing the plug.
- Use detergents, softeners and supplements suitable for automatic washing machines only.
- Follow the instructions on the textile tags and on the detergent package.
- The machine must be unplugged during installation, maintenance, cleaning and repairing procedures.
- Always have installation and repairing procedures carried out by an authorized Service agent.
- The manufacturer shall not be held liable for damages that may arise from procedures carried out by unauthorized persons.

- If the power cable is damaged, it must be replaced by the manufacturer, after sales service or a similarly qualified person (preferably an electrician) or someone designated by the importer in order to avoid possible risks.
- Place the machine on a rigid, flat and level surface.
- Do not place it on a long-pile rug or similar surfaces.
- Do not place the machine on a high platform or near the edge on a cascaded surface.
- Do not place the machine on the power cable.
- Never use sponge or scrub materials. These will damage the painted, chrome plated and plastic surfaces.

1.2 Intended use

- This machine has been designed for domestic use. It is not for commercial purposes and must not be used outside of its intended use.
- The machine must only be used for washing and rinsing of laundry marked accordingly.
- The manufacturer waives any responsibility that may arise from incorrect usage or transportation.

1.3 Children's safety

- Packaging materials are dangerous for children. Keep packaging materials in a safe place out of reach of children.
- Electrical appliances are dangerous for children. Keep children away from the washing machine when it is in use. Do not allow children to play with the machine. Use child lock to prevent children from tampering with the machine controls.
- Do not forget to close the loading door when leaving the room where the machine is located.
- Store all detergents and additives in a safe place away from the reach of children. Close the cover of detergent containers or seal the detergent package.



While washing laundry at high temperatures, the loading door glass becomes hot. Ensure that children are kept away from the loading door of the machine while the washing operation is in progress.

1.4 Package information

- Ensure that the packaging material is disposed of in a responsible manner. Cut up plastic bags to prevent children playing with them and accidentally suffocating.

1.5 Disposing of the waste machine

- This machine has been manufactured with high quality parts and materials which can be reused and are suitable for recycling. Do not dispose of the machine with normal domestic waste at the end of its service life. Consult your local authorities. Help protect the environment and natural resources by recycling used machines. For child safety, cut the power cord and break the loading door locking mechanism so that it will be non-functional before disposing of the machine.

2 Important instructions for environment

2.1 Compliance with WEEE Directive



This product complies with EU WEEE Directive (2012/19/EU). This product bears a classification symbol for waste electrical and electronic equipment (WEEE).

This product has been manufactured with high quality parts and materials which can be reused and are suitable for recycling. Do not dispose of the waste product with normal domestic and other wastes at the end of its service life. Take it to the collection center for the recycling of electrical and electronic equipment. Please consult your local authorities to learn about these collection centers.

Compliance with RoHS Directive:

The product you have purchased complies with EU RoHS Directive (2011/65/EU). It does not contain harmful and prohibited materials specified in the Directive.

2.2 Package information

Packaging materials of the product are manufactured from recyclable materials in accordance with our National Environment Regulations. Do not dispose of the packaging materials together with the domestic or other wastes. Take them to the packaging material collection points designated by the local authorities.

3 Intended use

- This product has been designed for domestic use. It is not for commercial purposes or it should not be used out of its intended use.
- The product must only be used for washing and rinsing of laundry that are marked accordingly.
- The manufacturer waives any responsibility arisen from incorrect usage or transportation.
- The service life of your product is 10 years. During this period, original spare parts will be available to operate the appliance properly.

4 Technical specifications

Complying Commission Delegated Regulation (EU) No 1061/2010

Supplier name or trademark	DEFY
Model name	WMY 71283 MLCW
Rated capacity (kg)	7
Energy efficiency class / Scale from A+++ (Highest Efficiency) to D (Lowest Efficiency)	A+++
Annual Energy Consumption (kWh) ⁽¹⁾	169
Energy consumption of the standard 60°C cotton programme at full load (kWh)	0.968
Energy consumption of the standard 60°C cotton programme at partial load (kWh)	0.590
Energy consumption of the standard 40°C cotton programme at partial load (kWh)	0.590
Power consumption in 'off-mode' (W)	0.500
Power consumption in 'left-on mode' (W)	0.500
Annual Water Consumption (l) ⁽²⁾	9020
Spin-drying efficiency class / Scale from A (Highest Efficiency) to G (Lowest Efficiency)	B
Maximum spin speed (rpm)	1200
Remaining moisture Content (%)	53
Standard cotton programme ⁽³⁾	Cotton Eco 60°C and 40°C
Programme time of the standard 60°C cotton programme at full load (min)	208
Programme time of the standard 60°C cotton programme at partial load (min)	183
Programme time of the standard 40°C cotton programme at partial load (min)	183
Duration of the left-on mode (min)	N/A
Airborne acoustical noise emissions washing/spinning (dB)	53/75
Built-in	No
Height (cm)	84
Width (cm)	60
Depth (cm)	50
Net weight (±4 kg.)	64
Single Water inlet / Double Water inlet	• / -
• Available	
Electrical input (V/Hz)	220 V / 50Hz
Total current (A)	10
Total power (W)	2000
Main model code	1010

⁽¹⁾ Energy Consumption based on 220 standard washing cycles for cotton programmes at 60°C and 40°C at full and partial load, and the consumption of the low-power modes. Actual energy consumption will depend on how the appliance is used.

⁽²⁾ Water consumption based on 220 standard washing cycles for cotton programmes at 60°C and 40°C at full and partial load. Actual water consumption will depend on how the appliance is used.

⁽³⁾ "Standard 60°C cotton programme" and the "standard 40°C cotton programme" are the standard washing programmes to which the information in the label and the fiche relates and these programmes are suitable to clean normally soiled cotton laundry and that they are the most efficient programmes in terms of combined energy and water consumption.

Technical specifications may be changed without prior notice to improve the quality of the product.

4.1 Installation

- Contact your nearest authorised service agent for the installation of your product.
- Preparation of location, electrical, tap water and waste water installations at the place of installation is the customer's responsibility.
- Make sure that the water inlet and discharge hoses as well as the power cable are not folded, pinched or crushed while pushing the product into its place after installation or cleaning procedures.
- Make sure that the installation and electrical connections of the product are performed by an authorised service agent. The manufacturer shall not be held liable for damages that may arise from procedures carried out by unauthorized persons.
- Prior to installation, visually check if the product has any defects on it. If so, do not have it installed. Damaged products are a safety risk.

4.1.1 Appropriate installation location

- Place the product on a hard and level floor. Do not place it on a carpet with a high pile or other similar surfaces.
- When the washing machine and drier are placed on top of each other, their total weight —when loaded— amounts to 180 kilograms. Place the product on a solid and flat floor that has sufficient load carrying capacity!
- Do not place the product on the power cable.
- Do not install the product in environments where the temperature falls below 0 °C.
- Leave a minimum space of 1 cm between the machine and the furniture.
- If the floor is graduated, do not place the product next to the edge or on a platform.

4.1.2 Removing packaging reinforcement



Tilt the machine backwards to remove the packaging reinforcement. Remove the packaging reinforcement by pulling the ribbon. Do not make this operation alone by yourself.

4.1.3 Removing the transportation locks

- 1 Loosen all bolts with an appropriate wrench until they turn freely (**C**).
- 2 Remove the transport safety bolts by turning them slightly.
- 3 Insert the plastic covers, found in the bag containing the user manual, into the openings on the rear panel. (**P**)

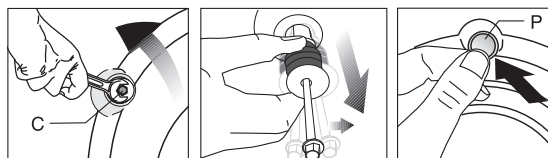

CAUTION: Remove the transportation safety bolts before operating the washing machine! Otherwise, the product will be damaged.



Keep the transportation safety bolts in a safe place to reuse should the washing machine need to be moved again in the future.

Install the transport safety bolts in reverse order of the disassembly procedure.

Never move the product without the transportation safety bolts properly fixed in place!

4.1.4 Connecting water supply



The water supply pressure required to run the product is between 1 to 10 bars (0.1 – 1 MPa). It is necessary to have 10 – 80 liters of water flowing from the fully open tap in one minute to have your machine run smoothly. Attach a pressure reducing valve if the water pressure is higher.

If you are going to use the double water-inlet product as a single (cold) water-inlet unit, you must install the supplied stopper to the hot water valve before operating the product. (Applies for the products supplied with a blind stopper group.)



CAUTION: Models with a single water inlet should not be connected to the hot water tap. In such a case the laundry will get damaged or the product will switch to protection mode and will not operate.

CAUTION: Do not use old or used water inlet hoses on the new product. It may cause stains on your laundry.

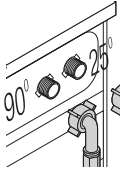

Connect the special water supply hoses supplied with the product to the water inlets on the product. Red hose (left) (max. 90 °C) is for hot water inlet, blue hose (right) (max. 25 °C) is for cold water inlet.

Make sure that the hot and cold water taps are connected correctly when the product is being installed. Otherwise, your laundry will come out hot at the end of the washing process and wear out.

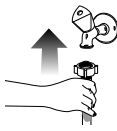
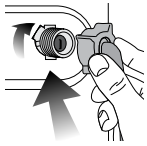

- 1 Tighten the nuts of the hose by hand. Never use a tool when tightening the nuts.
- 2 When the hose connection is completed, check whether there is leak a problem at the connection points by opening the taps fully. If there is a leak, turn off the tap and remove the nut. Retighten the nut carefully after checking the seal. In order to prevent water leaks and resultant damages, keep the taps closed when the product is not in use.

4.1.5 Connecting the drain hose to the drain

- Attach the end of the drain hose directly to the waste water drain, lavatory or bathtub.



CAUTION: Your house will be flooded if the hose comes out of its housing during water discharge. Moreover, there is the risk of scalding due to high washing temperatures! In order to prevent this from occurring, ensure that the machine performs the water intake and discharge processes without any problem. Fix the drain hose securely.

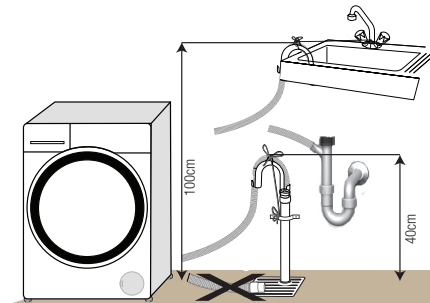

- Connect the drain hose to a minimum height of 40 cm and a maximum height of 100 cm.
- In case the drain hose is elevated after laying it on the floor level or close to the ground (less than 40 cm above the ground), water discharge becomes more difficult and the laundry may come out excessively wet. Therefore, follow the heights described in the figure.

- To prevent the waste water from going back into the machine again and to ensure easy drainage, do not immerse the end of the hose into the waste water or do not insert it into the drain for more than a distance than 15 cm. If it is too long, cut it shorter.
- The end of the hose should not be bent, it should not be stepped on and the hose must not be pinched between the drain and the machine.
- If the length of the hose is too short, then add an original extension hose. The length of the hose may not be longer than 3.2 m. To avoid water leak failures, the connection between the extension hose and the drain hose of the product must be fitted well with an appropriate clamp so as not to come off and leak.

4.1.6 Adjusting the feet



CAUTION: In order to ensure that the product operates more silently and vibration-free, it must stand level and balanced on its feet. Balance the machine by adjusting the feet. Otherwise, the product may move from its place and cause crushing and vibration problems.

CAUTION: Do not use any tools to loosen the lock nuts. Doing so may cause them to become damaged.

- 1 Loosen the lock nuts on the feet by hand.
- 2 Adjust the feet until the product stands stable and balanced.
3. Tighten all lock nuts by hand again.

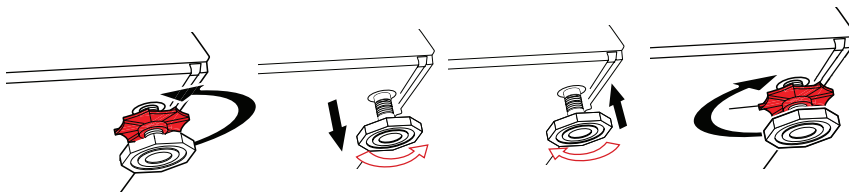

4.1.7 Electrical connection

Connect the product to a grounded outlet protected by a 16 A fuse. Our company shall not be liable for any damages that arise should the product be used without grounding in accordance with local regulations.

- Connection must comply with national regulations.
- Power cable plug must be within easy reach after installation.
- If the current value of the fuse or breaker in the house is less than 16 Amps, have a qualified electrician install a 16 Amp fuse.
- The voltage specified in the "Technical specifications" section must be equal to your mains voltage.
- Do not make connections via extension cables or multi-plugs.



CAUTION: Damaged power cables must be replaced by the Authorized Service Agents.

4.1.8 Initial use

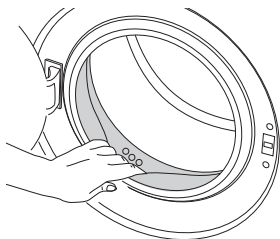

Before first use of the product make sure that preparations are made which are in line with the "Important Safety and Environment Instructions" and the instructions in the "Installation" section.

To prepare the product for washing laundry, first operate the Drum Cleaning programme. If this programme is not built into your machine then apply the method which is described in section 4.4.2.



Use an anti-limescale suitable for washing machines.

Some water might have remained in the product due to the quality control processes in the production. It is not harmful for the product.

4.2 Preparation

4.2.1 Sorting the laundry

- * Sort laundry according to type of fabric, color, and degree of soiling and allowable water temperature.
- * Always obey the instructions given on the garment tags.

4.2.2 Preparing laundry for washing

- Laundry items with metal attachments such as, underwired bras, belt buckles or metal buttons will damage the machine. Remove the metal pieces or wash the clothes by putting them in a laundry bag or pillow case.
- Remove all objects in pockets such as coins, pens and paper clips. Turn pockets inside out and brush. Such objects may damage the product or cause a noise problem if left in pockets.
- Place small size clothes such as infant's socks and nylon stockings in a laundry bag or pillow case.
- Place curtains in without compressing them. Remove curtain attachment items.
- Fasten zippers, sew loose buttons and mend rips and tears.
- Wash "machine washable" or "hand washable" labeled products only with an appropriate programme.
- Do not wash colours and whites together. New, dark coloured cottons release a lot of dye. Wash them separately.
- Tough stains must be treated properly before washing. If unsure, check with a dry cleaner.
- Only use dyes / color changers and descaling agents which are appropriate for machine washing. Always follow the instructions on the package.
- Wash trousers and delicate laundry turned inside out.
- Keep laundry items made of Angora wool in the freezer for a few hours before washing. This will reduce pilling.
- Laundry that has come into contact with substances such as flour, lime dust, milk powder, etc. must be shaken off before placing into the machine. Powders and dust on the laundry may build up on the inner parts of the machine over time and can cause damage.

4.2.3 Things to be done for energy saving

The following information will help you use the product in an ecological and energy-efficient manner.

- Operate the product in the highest capacity allowed by the programme you have selected, but do not overload; see, "Programme and consumption table".
- Always follow the instructions on the detergent packaging.
- Wash slightly soiled laundry at low temperatures.
- Use faster programmes for small quantities of lightly soiled laundry.
- Do not use prewash and high temperatures for laundry that is not heavily soiled or stained.
- If you plan to dry your laundry in a dryer, select the highest spin speed recommended during the washing process.
- Do not use more detergent than the recommended amount specified on its package.

4.2.4 Loading the laundry

1. Open the laundry cover.
2. Place the laundry items into the machine in a loose manner.
3. Push and close the loading cover until you hear the locking sound. Ensure that no items are caught in the door. The loading door is locked while a programme is running. The door can only be opened a while after the programme comes to an end.

4.2.5 Correct load capacity

The maximum load capacity depends on the type of laundry, the degree of soiling and the washing programme desired.

The machine automatically adjusts the water amount according to the weight of the laundry placed inside it.



WARNING: Follow the information in the "Programme and consumption table". When overloaded, the machine's washing performance will drop and noise and vibration problems may also occur.

4.2.6 Using detergent and softener



When using detergent, softener, starch, fabric dye, bleach, decolorant or descaling agents; read the manufacturer's instructions written on the package and follow the dosages specified. Use a measuring cup if available.

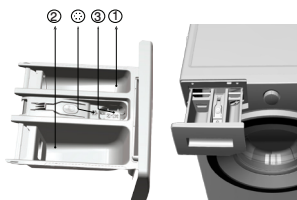

The detergent drawer is composed of three compartments:

- (1) for prewash
- (2) for main wash
- (3) for softener
- (☹) in addition, there is a siphon piece in the softener compartment.

Detergent, softener and other cleaning agents

- Add detergent and softener before starting the washing programme.
- While the washing cycle is in progress, do not leave the detergent dispenser open!
- When using a programme without prewash, do not put any detergent into the prewash compartment (compartment nr. "1").
- In a programme with prewash, do not put liquid detergent into the prewash compartment (compartment nr. "1").
- Do not select a programme with prewash if you are using a detergent bag or dispensing ball. Place the detergent bag or the dispensing ball directly amongst the laundry in the machine.

If you are using liquid detergent, do not forget to place the liquid detergent container into the main wash compartment (compartment number "2").

Choosing the detergent type

Detergent type to be used depends on the fabric type and color.

- Use different detergents for coloured and white laundry.
- Wash your delicate clothes with special detergents only (liquid detergent, wool shampoo, etc.) used solely for delicate clothes.
- When washing dark coloured clothes and quilts, it is recommended to use liquid detergent.
- Wash woolsens with special detergent made specifically for woolsens.



CAUTION: Use only detergents manufactured specifically for washing machines.

CAUTION: Do not use soap powder.

Adjusting detergent amount

The amount of washing detergent to be used depends on the amount of laundry, the degree of soiling and water hardness.

- Do not use amounts exceeding the dosage quantities recommended on the detergent package to avoid problems of excessive foam and poor rinsing. Using the correct amount of detergent results in financial savings helps protect the environment.
- Use a lesser amount of detergent for small laundry amounts or lightly soiled clothes.

Using softeners

Pour the softener into the softener compartment of the detergent drawer.

- Do not exceed the (>max<) level sign indicated in the softener compartment.
- If the softener has lost its fluidity, dilute it with water before putting it in the detergent drawer.

Using liquid detergents

If the product contains a liquid detergent cup:

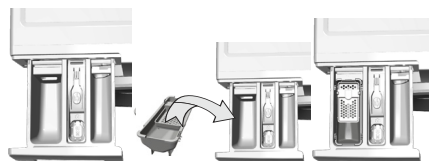

- Put the liquid detergent container into compartment no "2".
- If the liquid detergent has lost its fluidity, dilute it with water before putting it into the detergent container.

If the product does not contain a liquid detergent cup:

- Do not use liquid detergent for the prewash in a programme with prewash.
- Liquid detergent stains your clothes when used with the Delayed Start function. If you are going to use the Delayed Start function, do not use liquid detergent.

Using gel and tablet detergent

- If the gel detergent thickness is fluidal and your machine does not contain a special liquid detergent cup, put the gel detergent into the main wash detergent compartment during the first water intake. If your machine contains a liquid detergent cup, fill the detergent into this cup before starting the programme.
- If the gel detergent thickness is not fluidal or in the shape of a capsule liquid tablet, put it directly into the drum before washing.
- Place tablet detergents into the main wash compartment (compartment nr. "2") or directly into the drum before washing.

Using starch

- Put liquid soda, powder soda or fabric dye into the softener compartment.
Do not use softener and starch together in a washing cycle.
Wipe the inside of the machine with a damp and clean cloth after using starch.

Using limescale remover

- When required, use limescale removers manufactured specifically for washing machines only.

Using bleaches

Add bleach at the beginning of the washing cycle by selecting a prewash program. Do not put detergent in the prewash compartment. As an alternative application, select a programme with extra rinse and add the bleaching agent while the machine is taking water from the detergent compartment during the first rinsing step.

- Do not use bleaching agent and detergent together by mixing them.
- Use only a little amount (approx. 50 ml) of bleaching agent and rinse the clothes very well as it causes skin irritation. Do not pour the bleach onto the laundry and do not use it with the colored items.
- When using oxygen-based decolorant, select a programme which washes the laundry at a low temperature.
- Oxygen-based decolorant can be used with the detergent; however, if it is not at the same consistency, first put detergent into compartment number "2" in the detergent dispenser and wait for the machine to flush the detergent while taking in water. Whilst the machine continues taking in water, add decolorant in the same compartment.

4.2.7 Tips for efficient washing

		Clothes			
		Light Colours and Whites	Colours	Black/Dark Colours	Delicates/Woolens/Silks
		(Recommended temperature range based on soiling level: 40-90 °C)	(Recommended temperature range based on soiling level: cold -40 °C)	(Recommended temperature range based on soiling level: cold -40 °C)	(Recommended temperature range based on soiling level: cold -30 °C)
Soiling Level	Heavily Soiled	It may be necessary to pre-treat the stains or perform a prewash. Powder and liquid detergents recommended for whites can be used at dosages recommended for heavily soiled clothes. It is recommended to use powder detergents to clean clay and soil stains and stains that are sensitive to bleaches.	Powder and liquid detergents recommended for colors can be used at dosages recommended for heavily soiled clothes. It is recommended to use powder detergents to clean clay and soil stains and stains that are sensitive to bleaches. Use detergents without bleach.	Liquid detergents suitable for colors and dark colors can be used at dosages recommended for heavily soiled clothes.	Preferably use liquid detergents produced for delicate clothes. Woolen and silk clothes must be washed with special woolen detergents.
	Normally Soiled	Powder and liquid detergents recommended for whites can be used at dosages recommended for normally soiled clothes.	Powder and liquid detergents recommended for colors can be used at dosages recommended for normally soiled clothes. Detergents which do not contain bleach should be used.	Liquid detergents suitable for colors and dark colors can be used at dosages recommended for normally soiled clothes.	Preferably use liquid detergents produced for delicate clothes. Woolen and silk clothes must be washed with special woolen detergents.
	Lightly Soiled	Powder and liquid detergents recommended for whites can be used at dosages recommended for lightly soiled clothes.	Powder and liquid detergents recommended for colors can be used at dosages recommended for lightly soiled clothes. Detergents which do not contain bleach should be used.	Liquid detergents suitable for colors and dark colors can be used at dosages recommended for lightly soiled clothes.	Preferably use liquid detergents produced for delicate clothes. Woolen and silk clothes must be washed with special woolen detergents.

4.3 Operating the product

4.3.1 Control panel

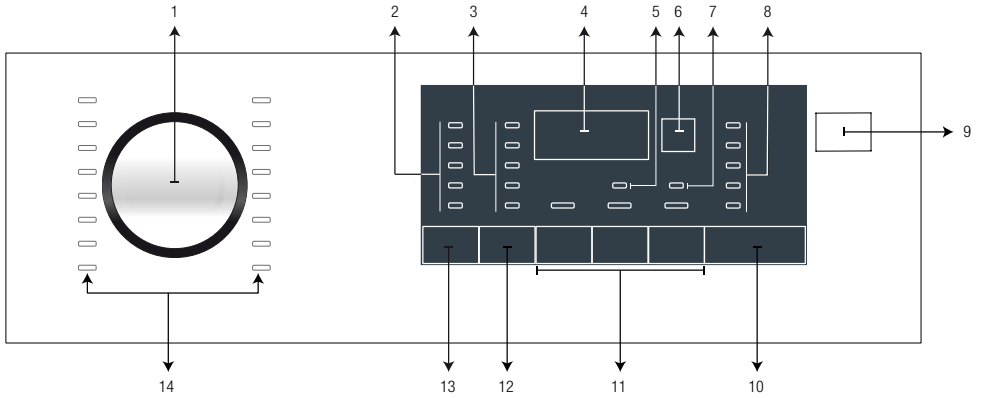

- 1 - Programme selection knob
- 2 - Temperature selection LEDs
- 3 - Spin speed selection LEDs
- 4 - Duration information display
- 5 - Child lock enabled LED
- 6 - End Time Setting button
- 7 - Door lock enabled LED

- 8 - Programme follow-up indicator LEDs
- 9 - On / Off button
- 10 - Start / Pause button
- 11 - Auxiliary function buttons
- 12 - Spin speed adjustment button
- 13 - Temperature adjustment button
- 14 - Programme Selection LEDs

4.3.2 Programme selection

- 1 Determine the programme suitable for the type, quantity and soiling level of the laundry in accordance with the "Programme and consumption table".
- 1 Select the desired programme with the "Programme Selection" knob.



Programmes are limited with the highest spin speed appropriate for that particular type of fabric.

When selecting the programme to be used, always take fabric type, color, soil degree and permitted water temperature into consideration.

Always select the lowest temperature value which is best suited to your laundry type. Higher temperature means higher power consumption.

4.3.3 Programmes

• Cottons

Use for your cotton laundry (such as bed sheets, duvet and pillowcase sets, towels, bathrobes, underwear, etc.). Your laundry will be washed with a vigorous washing action and also for a longer washing cycle.

• Synthetics

Use to wash your synthetic clothes (shirts, blouses, synthetic/cotton blends, etc.). It washes with a gentle action and has a shorter washing cycle in comparison to the Cottons programme.

For curtains and tulle, use the Synthetic 40°C programme with prewash and anti-creasing functions selected. As their meshed texture causes excessive foaming, wash veils/tulle by putting a small amount of detergent into the main wash compartment. Do not put detergent into the prewash compartment.

• Woollens

Use to wash woolen clothes. Select the appropriate temperature complying with the tags of your clothes. Use appropriate detergents for woollens.



"The wool wash cycle of this machine has been approved by The Woolmark Company for the washing of machine washable wool products provided that the products are washed according to the instructions on the garment label and those issued by the manufacturer of this washing machine. M14063."

"In UK, Eire, Hong Kong and India the Woolmark trade mark is a Certification trade mark."

• Cotton Economic

Use to wash your normally soiled, durable cotton and linen laundry. Although it washes longer than all other programmes, it provides high energy and water savings. Actual water temperature may be different from the stated wash temperature. When you load the machine with less laundry (e.g. ½ capacity or less), programme time may automatically get shorter. In this case, energy and water consumption will decrease more, providing a more economic wash. This programme is available in the models with the remaining time indicator.

• BabyProtect+

Use this programme for your laundry for which you require an anti-allergic and hygienic washing at a high temperature with an intensive and long washing cycle.

• Gentle Care 20°

Use it to wash your delicate laundry. It washes with a gentler action without any interim spins compared to the Synthetics program. It should be used for which a sensitive wash is recommended.

• Hand wash

Use to wash your woolen/delicate clothes that bear "not machine-washable" tags and for which hand wash is recommended. It washes laundry with a very gentle washing action so as not to damage clothes.

• Daily express

Use this programme to wash your lightly soiled cotton clothes in a short time.

• Super short express

Use to wash your lightly soiled and unstained cotton laundry in a short time.

• Darkcare

Use this programme to wash your dark colored laundry or colored laundry that you do not want to become faded. Washing is performed with little mechanical action and at low temperatures. It is recommended to use liquid detergent or woolen shampoo for dark coloured laundry.

• Mixed 40 (Mix 40)

Use to wash shirts together that are made of cotton, synthetic and synthetic blended fabrics.

• Shirts

Use to wash the shirts made of cotton, synthetic and synthetic blended fabrics together.

- **40° / 40'**

Use this programme to wash your lightly soiled and unstained cotton laundry in a short time.

- **Sports**

Use this programme to wash your garments that are worn for a short time such as sportswear. It is suitable to wash a small amount / synthetic blended garments.

- **Hygiene 20°**

Use this programme to remove the odour on the laundry that have only been worn once and do not contain any stains or dirt.

- **Rinse**

Use when you want to rinse or starch separately.

- **Spin + Drain**

Use to drain the water in the machine.

4.3.4 Temperature selection

Whenever a new programme is selected, the recommended temperature for the selected programme appears on the temperature indicator.

To decrease the temperature, press the Temperature Adjustment button. Temperature will decrease gradually.



If the programme has not reached the heating step, you can change the temperature without switching the machine to Pause mode.

4.3.5 Spin speed selection

Whenever a new programme is selected, the recommended spin speed of the selected programme is displayed on the spin speed indicator.

To decrease the spin speed, press the Spin Speed Adjustment button. Spin speed decreases gradually.

Then, depending on the model of the product, "Rinse Hold" and "No Spin" options appear on the display. See "Auxiliary function selection" section for explanations of these options.



If the programme has not reached the spinning step, you can change the speed without switching the machine to Pause mode.

Indicative values for Synthetics programmes (EN)						
	Load (kg)	Water Consumption (l)	Energy Consumption (kWh)	Programme Duration (min) *	Remaining Moisture Content (%) ** ≤ 1000 rpm	Remaining Moisture Content (%) ** > 1000 rpm
Synthetics 60	3	52	1.10	01:57	45	40
Synthetics 40	3	49	0.60	01:57	45	40





* You can see the washing time of the programme you have selected on the display of the machine. It is normal that small differences may occur between the time shown on the display and the real washing time.

** Remaining moisture content values may differ according to the selected spin speed.

4.3.6 Programme and consumption table

EN						Auxiliary functions						
Programme (°C)		Max. Load (kg)	Water Consumption (l)	Energy Consumption (kWh)	Max. Speed***	Prewash	Quick Wash	Anti-Creasing	Rinse Plus	Rinse Hold	Pet hair removal	Selectable temperature range °C
Cottons Eco	60**	7	44	0.97	1600							Cold-60
	60**	3.5	38	0.59	1600							Cold-60
	40**	3.5	38	0.59	1600							Cold-60
Cottons	90	7	70	2.20	1600	•	•	•	•	•	•	Cold-90
	60	7	70	1.55	1600	•	•	•	•	•	•	Cold-90
	40	7	67	0.90	1600	•	•	•	•	•	•	Cold-90
Synthetics	60	3	52	1.10	1200	•	•	•	•	•	•	Cold-60
	40	3	49	0.60	1200	•	•	•	•	•	•	Cold-60
Woolens	40	1.5	49	0.25	1200				•	•		Cold-40
Hand Wash	30	1	40	0.25	1200							Cold-30
BabyProtect	60	7	85	1.90	1600				*			30 - 90
Dark Care	40	3	60	0.60	1000	•	•	•	*	•	•	Cold-40
Shirts	60	3.5	57	1.00	800	•	•	*	•	•	•	Cold-60
Mix 40	40	3.5	60	0.70	1000	•	•	•		•	•	Cold-40
Aqua 40°/40°	40	7	45	0.60	1400					•		Cold-40
Gentle Care 20°	20	3.5	45	0.15	1200			•	•	•		20
Hygiene 20°	20	2	95	0.40	1600				*			20
Xpress Super Short	30	2	35	0.15	1400					•	•	Cold-30
Daily Xpress	90	7	67	2.00	1400					•	•	Cold-90
	60	7	67	1.10	1400					•	•	Cold-90
	30	7	67	0.25	1400					•	•	Cold-90

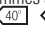
- : Selectable.
- * : Automatically selected, no canceling.
- ** : Energy Label programme (EN 60456 Ed.3)
- *** : If the maximum spin speed of the machine is lower then this value, you can only select up to the maximum spin speed.
- **** : Programme will detect the type and amount of the laundry which you put into the machine and adjust the water consumption, energy consumption and programme duration automatically.
- : See the programme description for maximum load.

	** "Cotton eco 40°C and Cotton eco 60°C are standard programmes." These programmes are known as '40°C cotton standard programme' and '60°C cotton standard programme' and indicated with the  <40°>  <60°> symbols on the panel.
	The auxiliary functions in the table may vary according to the model of your machine.
	Water and power consumption may vary subject to the changes in water pressure, water hardness and temperature, ambient temperature, type and amount of laundry, selection of auxiliary functions and spin speed, and changes in electric voltage.
	The washing time of the programme you have selected can be seen on the display of the machine. It is normal that small differences may occur between the time shown on the display and the real washing time.
	"Selection patterns for auxiliary functions can be changed by the manufacturer. New selection patterns can be added or removed."
	"The spin speed of your machine may vary according to the programme; this spin speed cannot exceed the max. spin speed of your machine."
	"The manufacturer reserves the right to make modifications to the programmes and auxiliary functions given in the table. Whilst these modifications will not affect the machine performance, programme steps and durations and durations may be affected."

4.3.7 Auxiliary function selection

Select the desired auxiliary functions before starting the programme.

Whenever a programme is selected, if a relevant auxiliary function is selected its related indicator light will illuminate.



Indicator lights of the auxiliary functions that are not allowed to be selected with the current programme will flash and an audio warning is given.

Furthermore, you may also select or cancel auxiliary functions that are suitable to the running programme after the washing cycle starts. If the wash cycle has reached a point where no auxiliary function can be selected, an audio warning will be given and the related auxiliary function's light will flash.



Some functions cannot be selected together. If a second auxiliary function conflicting with the first one is selected before starting the machine, the function selected first will be cancelled and the second auxiliary function selection will remain active. For example, if you want to select Quick Wash after you have selected the Additional Water, Additional Water will be cancelled and Quick Wash will remain active.

An auxiliary function that is not compatible with the programme cannot be selected. (See, "Programme and consumption table")

Some programmes have auxiliary functions that must be operated simultaneously. Those functions cannot be cancelled. The frame of the auxiliary function will not be illuminated, only inner area will be illuminated.

• Prewash

A Prewash is only worthwhile for heavily soiled laundry. Not using the Prewash will save energy, water, detergent and time.

• Quick Wash

This function can be used in Cottons and Synthetics programmes. It decreases the washing times and also the number of rinsing steps for lightly soiled laundry.



When you select this function, load your machine with half of the maximum laundry specified in the programme table.

• Rinse Plus

This function enables the machine to make an additional rinsing over and above the one already made after the main wash. Thus, the risk for sensitive skins (babies, allergic skins, etc.) is reduced due to there being less detergent remnants on the laundry.

• Anti-Creasing

This function minimizes the creasing effect on clothes being washed. Drum movement is reduced and spin speed is limited to prevent creasing. In addition, washing is done with a higher water level.

• Rinse Hold

If you are not going to unload the laundry immediately after the programme completes, then use the rinse hold function to keep laundry in the final rinsing water in order to prevent wrinkling when there is no water in the machine. Press the Start / Pause button after this process to drain the water without spinning the laundry. The programme will resume and complete after draining the water.

If you want to spin the laundry held in the water, adjust the Spin Speed and press the Start / Pause button. The programme resumes. Water is drained, laundry is spun and the programme is completed.

• Pet hair removal

This function helps with the removal of remaining pet hair from your garments more effectively.

When you select this function, Prewash and Extra Rinse steps are added to the normal programme. Thus, washing is performed with more water (30%) and the pet hair is removed more effectively.



WARNING: Never wash your pets in the washing machine.

4.3.8 End Time

With the End Time function, the startup of the programme may be delayed by up to 24 hours. After pressing the End Time button, the programme's estimated ending time is displayed. If the End Time is adjusted, the End Time indicator is illuminated.

In order for the End Time function to be activated and the programme to be completed at the end of the specified time, you must press the Start / Pause button after adjusting the time.

In order to cancel the End Time function, press the On / Off button to switch the machine on or off.



Do not use liquid detergents when you activate the End Time function! There is a risk of staining of the clothes.

- 1 Open the loading door, place the laundry and put detergent, etc.
- 2 Select the washing programme, temperature, spin speed and, if required, the auxiliary functions.
- 3 Set the end time of your choice by pressing the End Time button. The End Time indicator illuminates.
- 4 Press the Start / Pause button. Time countdown starts. ":" sign in the middle of the end time on the display starts flashing.



Additional laundry may be loaded during the End Time countdown period. At the end of the countdown, the End Time indicator turns off, the washing cycle starts and the time of the selected programme appears on the display.

When the End Time selection is completed, the time that appears on the screen consists of end time plus the duration of the selected programme.

4.3.9 Starting the programme

1. Press the Start / Pause button to start the programme.
2. The Programme follow-up light showing the startup of the programme will turn on.



If no programme is started or no key is pressed within 1-10 minutes during the programme selection process, the machine will switch to OFF mode. The Display and all indicators are turned off.

The selected programme data will be displayed if you press the On / Off button.

4.3.10 Loading door lock

There is a locking system on the loading door of the machine that prevents opening of the door in cases when the water level is unsuitable.

"Door Locked" LED in the panel turns on when the loading door is locked.

4.3.11 Changing the selections after the programme has started

After the programme has started you can make the following changes:

4.3.11.1 Switching the machine to pause mode:

Press the Start/Pause button to switch the machine to pause mode while a programme is running. The light indicating the Start/Pause status and programme step starts flashing on the Programme Follow-up indicator to show that the machine has been switched to the pause mode. The loading door light will also flash until the door is ready to be opened. When the loading door is ready to be opened, the loading door light will switch off and the programme step indicator and Start / Stop LED continue to flash.

When the loading door is ready to be opened, the Loading Door light will also switch off in addition to the programme step light.

4.3.11.2 Changing the auxiliary function, speed and temperature

Depending on the step the programme has reached, you can cancel or select the auxiliary functions. See, "Auxiliary function selection".

You can also change the speed and temperature settings. See, "Spin speed selection" and "Temperature selection".



If no change is allowed, the relevant light will flash 3 times.

4.3.11.3 Adding or taking out laundry

1. Press the Start / Pause button to switch the machine to pause mode. The programme follow-up light of the relevant step, which the machine was switched into during the pause mode, will flash.
2. Wait until the Loading Door can be opened.
3. Open the Loading Door and add or take out the laundry.
5. Close the Loading Door.
6. Make changes in auxiliary functions, temperature and speed settings if necessary.
7. Press the Start/Pause button to start the machine.

4.3.12 Child Lock

Use the Child Lock function to prevent children from tampering with the machine. Thus you can avoid any changes in a running programme.



You can switch the machine on and off with the **On / Off** button when the Child Lock is active. When you switch the machine on again, the programme will resume from where it stopped.

4.3.12.1 To activate the child lock:

Press and hold the **Auxiliary Function** button 2 for 3 seconds. In the programme selection display on the panel, the "Child lock enabled" light will switch on. You can release **Auxiliary Function button 2** when this warning is displayed.

4.3.12.2 To deactivate the child lock:

Press and hold Auxiliary Function button 2 for 3 seconds. In the programme selection display on the panel, the "Child lock enabled" light will switch off.

4.3.13 Cancelling the programme

The programme is cancelled when the machine is switched off and on again. Press and hold the **On / Off** button for 3 seconds.



If you press the **On / Off** button when the Child Lock is enabled, the programme will not be cancelled. You must cancel the Child Lock first.

If you want to open the loading door after you have cancelled the programme but it is not possible to open the loading door since the water level in the machine is above the loading door opening, then turn the **Programme Selection** knob to the **Pump+Spin** programme and discharge the water in the machine.

4.3.14 End of programme

The End LED appears on the display when the programme is completed.

If you do not press any button for 10 minutes, the machine will switch to OFF mode. The Display and all indicators are turned off.

Completed programme steps will be displayed if you press the On / Off button.

4.3.15 Your machine features "Standby Mode".

After you switch on your machine with On-Off button, if no programme is started or no other procedure is performed at the selection step or no action is taken within approx. 10 minutes after the selected programme ends, your machine will switch to OFF mode automatically. The Display and all indicators are turned off.

Selected programme data will be displayed if you press the On / Off button. Before you start the program, check the accuracy of your selections. If necessary, repeat them. This is not an error.

4.4 Maintenance and cleaning

The service life of the product extends and frequently experienced problems will be reduced if it is cleaned at regular intervals.

4.4.1 Cleaning the detergent drawer

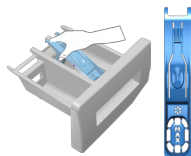

Clean the detergent drawer at regular intervals (every 4-5 washing cycles) as shown below in order to prevent accumulation of powder detergent over time. Lift the rear part of the siphon to remove it as illustrated.

If more than the normal amount of water and softener mixture starts to gather in the softener compartment, the siphon must be cleaned.

- 1 Press the dotted point on the siphon in the softener compartment and pull towards you until the compartment is removed from the machine.
2. Wash the detergent drawer and the siphon with plenty of lukewarm water in a washbasin. In order to prevent the residues from coming into contact with your skin, wear a pair of gloves and clean the drawer and siphon with a suitable brush.
- 3 After cleaning, refit the drawer and ensure that it is seated well.

4.4.2 Cleaning the loading door and the drum

For products with drum cleaning programme, please see Operating the product - Programmes.

For products without drum cleaning, follow the below steps **to clean the drum**:

Select the **Additional Water** or the **Extra Rinse** auxiliary functions. Use the **Cottons programme** without pre-wash. Set the **temperature to the level recommended on the drum cleaning agent which can be provided from authorized services**. Apply this procedure **without any laundry in the product**. Before starting the programme, put 1 pouch of special drum cleaning agent (if the special agent could not be supplied, put max. 100g of anti-limescale powder) into the main wash detergent compartment (compartment no. „2“). If the anti-limescale is in tablet form, put only one tablet into the main wash compartment no. „2“. Dry the inside of the bellow with a clean piece of cloth after the programme has come to an end.



Repeat Drum Cleaning process every 2 months.

Use an anti-limescale suitable for washing machines.

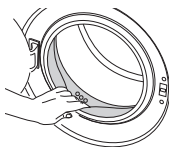

After washing make sure that no foreign substance is left in the drum.

If the holes on the bellow shown in the figure is blocked, open the holes using a toothpick.

Foreign metal substances will cause rust stains in the drum. Clean the stains on the drum surface by using cleaning agents for stainless steel.

Never use steel wool or wire wool. These will damage the painted, chromated and plastic surfaces.

4.4.3 Cleaning the body and control panel

Wipe the body of the machine with soapy water or non-corrosive mild gel detergents as necessary, and dry with a soft cloth.

Use only a soft and damp cloth to clean the control panel.

4.4.4 Cleaning the water intake filters

There is a filter at the end of each water intake valve at the rear of the machine and also at the end of each water intake hose where they are connected to the tap. These filters prevent foreign substances and dirt in the water from entering the washing machine. Filters must be cleaned as they do get dirty.

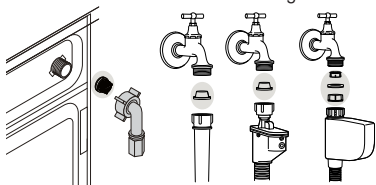

1. Close the taps.
2. Remove the nuts of the water intake hoses to access the filters on the water intake valves. Clean them with an appropriate brush. If the filters are too dirty, remove them with a pair of pliers and then clean them.
3. Take out the filters on the flat ends of the water intake hoses together with the gaskets and clean thoroughly under running water.
4. Carefully replace the seals and filters and tighten their nuts by hand.

4.4.5 Draining remaining water and cleaning the pump filter

The filter system in your machine prevents solid items such as buttons, coins and fabric fibers clogging the pump impeller during discharge of washing water. Thus, the water will be discharged without any problem and the service life of the pump will be extended.

If the machine fails to drain water, the pump filter is clogged. The filter must be cleaned whenever it is clogged or once in every 3 months. Water must be drained off first to clean the pump filter.

In addition, prior to transporting the machine (e.g., when moving to another house) and in case of freezing of the water, water may have to be drained completely.



CAUTION: Foreign substances left in the pump filter may damage your machine or may cause noise problems.

CAUTION: If the product is not being used, turn off the tap, remove the mains pipe and drain the water inside the machine to prevent any freezing from occurring.

CAUTION: After each use, turn off the water tap which is connected to the mains hose.

In order to clean the dirty filter and discharge the water:

- 1 Unplug the machine to cut off the supply power.



CAUTION: Temperature of the water inside the machine may rise up to 90 °C. To avoid a burning risk, clean the filter after the water inside the machine has cooled down.

2. Open the filter cover.



- 3 Follow the below procedures in order to drain in water.

If the product has an emergency water drainage hose: To drain the water do the following:

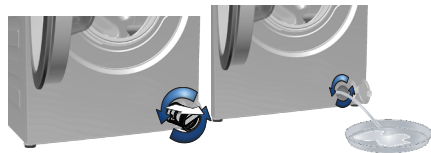

- a Pull the emergency draining hose out from its seat
- b Place a large container at the end of the hose. Drain the water into the container by pulling out the plug at the end of the hose. When the container is full, block the inlet of the hose by replacing the plug. After the container is emptied, repeat the above procedure to drain the water in the machine completely.
- c When the drainage of water has completed, close the end by the plug again and fix the hose in its place.
- d Turn and remove the pump filter.

If the product does not have an emergency water drainage hose: To drain the water do the following:

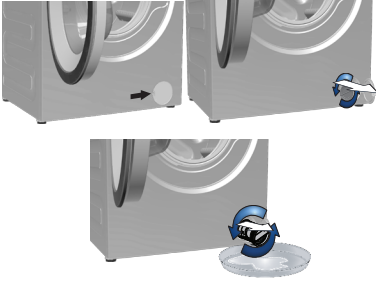

- a. In order to collect the water to flow out of the filter, place a large vessel in front of the filter.
 - b. Turn and loosen the pump filter (counterclockwise) until water starts to flow. Fill the flowing water into the container you have placed in front of the filter. Always keep a piece of cloth handy to absorb any spilled water.
 - c. When the water inside the machine is finished, take out the filter completely by turning it.
4. Clean any residues inside the filter as well as fibers, if any, around the pump impeller region.
 5. Replace the filter.
 6. If the filter cap is composed of two pieces, close the filter cap by pressing on the tab. If it is one piece, seat the tabs in the lower part into position first, and then press the upper part to close.

5 Troubleshooting

Problem	Reason	Solution
Program does not start after closing the door.	Start / Pause / Cancel button was not pressed.	<ul style="list-style-type: none"> ◆ Press the Start / Pause / Cancel button.
Programme cannot be started or selected.	Washing machine has switched to self protection mode due to a supply problem (line voltage, water pressure, etc.).	<ul style="list-style-type: none"> ◆ Press and hold the On / Off button for 3 seconds. (see. "Cancellation of programme")
Water in the machine.	Some water might have remained in the product due to the quality control processes in production.	<ul style="list-style-type: none"> ◆ This is not a failure; water is not harmful to the machine.
Machine does not fill with water.	Tap is turned off.	<ul style="list-style-type: none"> ◆ Turn on the taps.
	Water inlet hose is bent.	<ul style="list-style-type: none"> ◆ Flatten the hose.
Machine does not fill with water.	Water inlet filter is clogged.	<ul style="list-style-type: none"> ◆ Clean the filter.
	Loading door may be open.	<ul style="list-style-type: none"> ◆ Close the door.
Machine does not drain water.	Water drain hose might be clogged or twisted.	<ul style="list-style-type: none"> ◆ Clean or flatten the hose.
	Pump filter is clogged.	<ul style="list-style-type: none"> ◆ Clean the pump filter.
Machine vibrates or makes noise.	Machine might be standing unbalanced.	<ul style="list-style-type: none"> ◆ Adjust the feet to level the machine.
	A hard substance might have entered into the pump filter.	<ul style="list-style-type: none"> ◆ Clean the pump filter.
	Transportation safety bolts are not removed.	<ul style="list-style-type: none"> ◆ Remove the transportation safety bolts.
	Amount of laundry in the machine may be too little.	<ul style="list-style-type: none"> ◆ Add more laundry to the machine.
	Machine might be overloaded with laundry.	<ul style="list-style-type: none"> ◆ Take out some of the laundry from the machine or distribute the load by hand to balance it homogeneously in the machine.
There is water leaking from the bottom of the washing machine.	Machine might be leaning on a rigid item.	<ul style="list-style-type: none"> ◆ Make sure that the machine is not leaning on anything.
	Water drain hose might be clogged or twisted.	<ul style="list-style-type: none"> ◆ Clean or flatten the hose.
Machine stopped shortly after the programme started.	Pump filter is clogged.	<ul style="list-style-type: none"> ◆ Clean the pump filter.
	Machine might have stopped temporarily due to low voltage.	<ul style="list-style-type: none"> ◆ It will resume running when the voltage is restored to the normal level.
Machine directly discharges the water it takes in.	Drainage hose might not be at adequate height.	<ul style="list-style-type: none"> ◆ Connect the water drainage hose as described in the instruction manual.
No water can be seen in the machine during washing.	The water level is not visible from outside of the washing machine.	<ul style="list-style-type: none"> ◆ This is not a failure.
Loading door cannot be opened.	Door lock is activated because of the water level in the machine.	<ul style="list-style-type: none"> ◆ Drain the water by running the Pump or Spin programme.
	Machine is heating up the water or it is in the spinning cycle.	<ul style="list-style-type: none"> ◆ Wait until the programme completes.
	The child lock is engaged. The door lock will be deactivated a couple of minutes after the programme has come to an end.	<ul style="list-style-type: none"> ◆ Wait for a couple of minutes for deactivation of the door lock.
Washing takes longer time than specified in the manual.(*)	Water pressure is low.	<ul style="list-style-type: none"> ◆ Machine waits until taking in adequate amount of water to prevent poor washing quality due to the decreased amount of water. Therefore, the washing time extends.
	Voltage might be low.	<ul style="list-style-type: none"> ◆ Washing time is prolonged to avoid poor washing results when the supply voltage is low.
	Input temperature of water might be low.	<ul style="list-style-type: none"> ◆ The required time to heat up the water extends in cold seasons. Also, washing time can be lengthened to prevent poor washing results.
	Number of rinses and/or amount of rinse water might have increased.	<ul style="list-style-type: none"> ◆ Machine increases the amount of rinse water when more rinsing is needed and adds an extra rinsing step if necessary.
	Excessive foam might have occurred and the automatic foam absorption system might have been activated due to too much detergent usage.	<ul style="list-style-type: none"> ◆ Use recommended amount of detergent.

Problem	Reason	Solution
Programme time does not countdown. (On models with display) (*)	Timer may stop during water intake.	♦ The timer indicator will not countdown until the machine takes in adequate amount of water. The machine will wait until there is a sufficient amount of water to avoid poor washing results due to lack of water. The timer indicator will resume countdown after this.
	Timer may stop during the heating step.	♦ The timer indicator will not countdown until the machine reaches the selected temperature.
	Timer may stop during the spinning step.	♦ The automatic unbalanced load detection system might be activated due to the unbalanced distribution of the laundry in the drum.
Programme time does not countdown. (*)	There might be an unbalanced load in the machine.	♦ The automatic unbalanced load detection system might be activated due to the unbalanced distribution of the laundry in the drum.
Machine does not switch to spinning step. (*)	There might be an unbalanced load in the machine.	♦ The automatic unbalanced load detection system might be activated due to the unbalanced distribution of the laundry in the drum.
	The machine will not spin if water is not drained completely.	♦ Check the filter and the drainage hose.
	Excessive foam might have occurred and the automatic foam absorption system might have been activated due to too much detergent usage.	♦ Use the recommended amount of detergent.
Washing performance is poor: Laundry turns gray. (**)	Insufficient amount of detergent has been used over a long period of time.	♦ Use the recommended amount of detergent appropriate for water hardness and the laundry.
	Washing was done at low temperatures over a long period of time.	♦ Select the proper temperature for the laundry to be washed.
	Insufficient amount of detergent is used with hard water.	♦ Using an insufficient amount of detergent with hard water causes the soil to stick on the cloth and this turns the cloth into gray over time. It is difficult to eliminate graying once it happens. Use the recommended amount of detergent appropriate for water hardness and the laundry.
	Too much detergent is used.	♦ Use the recommended amount of detergent appropriate for water hardness and the laundry.
Washing performance is poor: Stains persist or the laundry is not whitened. (**)	Insufficient amount of detergent is used.	♦ Use the recommended amount of detergent appropriate for water hardness and the laundry.
	Excessive laundry was loaded in.	♦ Do not overload the machine. Load with amounts recommended in the "Programme and consumption table".
	Wrong programme and temperature were selected.	♦ Select the proper programme and temperature for the laundry to be washed.
	Wrong type of detergent is used.	♦ Use original detergent appropriate for the machine.
	Too much detergent is used.	♦ Put the detergent in the correct compartment. Do not mix the bleaching agent and the detergent with each other.
Washing performance is poor: Oily stains appeared on the laundry. (**)	Regular drum cleaning is not applied.	♦ Clean the drum regularly. For this, please see 4.4.2.
Washing performance is poor: Clothes smell unpleasantly. (**)	Odours and bacteria layers are formed on the drum as a result of continuous washing at lower temperatures and/or in short programmes.	♦ Leave the detergent drawer as well as the loading door of the machine ajar after each washing. This will help prevent a humid environment favorable to bacteria from occurring in the machine.

Problem	Reason	Solution
Colour of the clothes faded. (**)	Excessive laundry was loaded in.	♦ Do not overload the machine.
	Detergent in use is damp.	♦ Keep detergents closed in an environment free of humidity and do not expose them to excessive temperatures.
	A higher temperature is selected.	♦ Select the proper programme and temperature according to the type and soiling degree of the laundry.
Not rinsing well.	The amount, brand and storage conditions of the detergent used are inappropriate.	♦ Use a detergent appropriate for the washing machine and your laundry. Keep detergents closed in an environment free of humidity and do not expose them to excessive temperatures.
	Detergent is put in the wrong compartment.	♦ If detergent is put in the prewash compartment although the prewash cycle is not selected, the machine may take this detergent during the rinsing or softener step. Put the detergent in the correct compartment.
	Pump filter is clogged. Drain hose is folded.	♦ Check the filter. ♦ Check the drain hose.
Laundry became stiff after washing. (**)	Insufficient amount of detergent is used.	♦ Using an insufficient amount of detergent for the water hardness can cause the laundry to become stiff in time. Use an appropriate amount of detergent according to the water hardness.
	Detergent is put in the wrong compartment.	♦ If detergent is put in the prewash compartment although the prewash cycle is not selected, the machine may take this detergent during the rinsing or softener step. Put the detergent in the correct compartment.
	Detergent might be mixed with the softener.	♦ Do not mix the softener with detergent. Wash and clean the dispenser with hot water.
Laundry does not smell like the softener. (**)	Detergent is put in the wrong compartment.	♦ If detergent is put in the prewash compartment although the prewash cycle is not selected, the machine may take this detergent during the rinsing or softener step. Wash and clean the dispenser with hot water. Put the detergent in the correct compartment.
	Detergent might be mixed with the softener.	♦ Do not mix the softener with detergent. Wash and clean the dispenser with hot water.
Detergent residue in the detergent drawer. (**)	Detergent is put in wet drawer.	♦ Dry the detergent drawer before putting in detergent.
	Detergent has gotten damp.	♦ Keep detergents closed in an environment free of humidity and do not expose them to excessive temperatures.
	Water pressure is low.	♦ Check the water pressure.
	The detergent in the main wash compartment got wet while taking in the prewash water. Holes of the detergent compartment are blocked.	♦ Check the holes and clean if they are clogged.
	There is a problem with the detergent drawer valves.	♦ Call the Authorized Service Agent.
	Detergent might be mixed with the softener.	♦ Do not mix the softener with detergent. Wash and clean the dispenser with hot water.
	Regular drum cleaning is not applied.	♦ Clean the drum regularly. For this, please see 4.4.2.

Problem	Reason	Solution
Too much foam forms in the machine. (**)	Improper detergents for the washing machine are being used.	♦ Use detergents appropriate for the washing machine.
	Excessive amount of detergent is used.	♦ Use only sufficient amount of detergent.
	Detergent was stored under improper conditions.	♦ Store detergent in a closed and dry location. Do not store in excessively hot places.
	Some meshed laundry such as tulle may foam too much because of their texture.	♦ Use smaller amounts of detergent for this type of item.
	Detergent is put into the wrong compartment. Softener is being taken early.	♦ Put the detergent into the correct compartment. ♦ There may be problem in the valves or in the detergent dispenser. Call the Authorized Service Agent.
Foam is overflowing from the detergent drawer.	Too much detergent is used.	♦ Mix 1 tablespoonful softener and ½ l water and pour into the main wash compartment of the detergent drawer.
		♦ Put detergent into the machine suitable for the programmes and maximum loads indicated in the "Programme and consumption table". When you use additional chemicals (stain removers, bleaches and etc), reduce the amount of detergent.
Laundry remains wet at the end of the programme. (*)	Excessive foam might have occurred and automatic foam absorption system might have been activated due to too much detergent usage.	♦ Use recommended amount of detergent.
(*) Machine does not switch to spinning step when the laundry is not evenly distributed in the drum to prevent any damage to the machine and to its surrounding environment. Laundry should be rearranged and re-spun.		
(**) Regular drum cleaning is not applied. Clean the drum regularly. See 4.4.2		
	CAUTION: If you cannot eliminate the problem although you follow the instructions in this section, consult your dealer or the Authorized Service Agent. Never try to repair a nonfunctional product yourself.	

Since the following are not factory faults, they are the owners responsibility:

- Damage to the exterior finish, breakage of components, damage through improper use or installation of the washing machine or damage caused by moving the washing machine.

Before calling a Service technician or your dealer, please check the following:

- Is the machine plugged into the wallsocket? Is the house circuit breaker on?
- Is the machine switched on? Has the machine door been closed properly?
- Is the detergent dose correct? Is the filter clean? Is the tap open?
- Is there a water supply to the home? Have any of the hoses been twisted or kinked?

South African Service Agents:

BLOEMFONTEIN
160 Long Street, Hilton, Bloemfontein 9301
Tel: 051 400 3900
Bloemfontein.Service@defy.co.za

CAPE TOWN
5A Marconi Rd. Montague Gardens, 7441
Tel: 021 526 3000
CapeTown.Service@defy.co.za

DURBAN
35 Intersite Avenue, Umgeni Business Park,
Durban, 4051
Tel: 031 268 3300
Durban.Service@defy.co.za

EAST LONDON
16 Bowls Rd. Arcadia, East London, 5201
Tel: 043 743 7100
EastLondon.Service@defy.co.za

JOHANNESBURG
Cnr. Mimetes & Kruger Sts. Denver ext.12
Johannesburg, 2094
Tel: 011 621 0200 or 011 621 0300
Gauteng.Service@defy.co.za

POLOKWANE
87 Nelson Mandela Drive, Superbia 0699
Tel: 0152 92 1166 | 71819
Polokwane.Service@defy.co.za

PORT ELIZABETH
112 Patterson Road, North End, Port Elizabeth
6001
Tel: 041 401 6400
PortElizabeth.Service@defy.co.za

PRETORIA
Block A1 Old Mutual Industrial Park,
Cnr. D.F.Malan Drive & Moot Str. Hermanstad,
0082
Tel: 012 377 8300
Pretoria.Service@defy.co.za

Sub-Saharan Africa Service Agents:

ZAMBIA: SOUTHGATE INVESTMENTS LTD
Plot 1606, Sheki Sheki Road
P.O. Box 33681
Lusaka, 10101, Zambia
Tel: +260 0211 24233213
Fax: +260 0211 242933 sgiservicecentre@
microlink.zm

NAMIBIA: ATLANTIC DISTRIBUTORS (PTY) LTD
10 Tienie Louw Street, Northern Industrial Area
P.O. Box 21158, Windhoek, Namibia
Tel: (061) 216162
Fax: (061) 216134 atlantic@mweb.com.na

ZIMBABWE: TRADECOMAFRICA
Trade Com Africa, 183 Loreley Crescent
Msasa, Harare, Zimbabwe
Tel: +263 4 4861656
Cell: +263 772 469010
Cell: +263 772 469011

BOTSWANA: RAY MORGAN AGENCIES RMA
Service Centre, Plot 48, East Gate Gaborone
International Commerce Park Kgale View,
Gaborone
Botswana
Tel: +267 390 3996 | 390 3912
Fax: +267 318 7376
Cell: +267 7134 6539 service@rma.co.bw;
raja@rma.co.bw

SWAZILAND: LYNDS DISTRIBUTORS
P.O Box 716, Mbabane, Swaziland, H100
Tel: (00268) 2515 431018
Fax: (00268) 2518 4318

MOZAMBIQUE: COOL WORLD. LDA
Rua da Resistencia No. 97B RIC Cell: +258 84 44
61 234 coolworldlda@hotmail.com Nosso Show
Room
Av: da Industrias, Parcela No.735 * 735A
Machava, Maputo

This certificate is issued by DEFY APPLIANCES (PTY) LIMITED manufacturers of Defy and Ocean products, hereinafter the Company, to the original purchaser only, of the appliance described on the certificate and shall constitute the only warranty given in respect of this appliance.

The Company warrants to the original purchaser that for a period of TWO YEARS from date of purchase the appliance is free from defect under normal domestic use, both in workmanship and material, subject to the following conditions.

1. Repair or replacement of any part of this appliance, found by the Company to be defective, shall be at the election of the Company. The Company reserves the right to effect such service through any of its Service Divisions or Authorised Service Dealers. The cost of such service shall be borne by the Company in full, provided that the appliance is located no further than 50km from a Company Service Centre or an Authorised Service Dealer. Where the appliance is located beyond the 50km radius, the purchaser shall be liable for the standard travelling charges, as determined by the Company.
2. Vitreous enamelware, fuses and lamps are specifically excluded from these warranties. It is an express condition of these warranties that the purchaser takes due care and attention in the use and maintenance of the appliance. Abuse, misuse in conflict with operating instructions, connection to incorrect voltages and subjection to commercial use shall release the Company from its obligations.
3. This warranty shall become void and cease to operate if the appliance is dismantled by, or any repairs to the appliance are effected by any persons not duly authorised by the Company, or if substitute parts not approved by the Company are used in the appliance, or if the serial number of the appliance is removed.
4. The Company shall not be responsible for damages resulting from fire, flood, civil disturbances or any Act of God. The Company shall not, in terms of these warranties be responsible nor held liable for any consequential loss or damage of any kind caused by or due to the failure or malfunction of the appliance.
5. The Company shall not be responsible for transportation or other costs other than those incurred within the provisions of Point 1 of this Certificate.
6. **For warranties in the Republic of South Africa and Sub-Saharan Africa, please contact your nearest Defy office. Please refer to the previous page for respective South African service agents and Sub-Saharan Africa service agents.**
7. Where service is requested under warranty and no fault or defect can be found by the Company, all costs incurred will be for the purchaser's account.
8. This Certificate as well as your invoice will serve as proof of purchase. For the purpose of warranty, it will be essential to produce this Certificate and invoice. Failure to do so, will render the purchaser liable for service costs.

**KEEP THIS CERTIFICATE AND SALES INVOICE AS PROOF OF
PURCHASE FOR WARRANTY PURPOSES.**