

RPS *EXTREME* RECORD-PLAY-SHOOT

Field Game Call Recording and Call Management



Table of Contents:

Chapter I - Intro

Chapter II - Connecting to Computer with SD Card or USB Cable

Chapter III - In the field: Playback and Recording

Chapter IV - QR Guides

Chapter V - Other Features and Functions

Chapter VI - Maintenance/Troubleshooting/Specifications

Warranty

Page 1

Page 4

Page 5

Page 7

Page 7

Page 7

Page 9

Chapter I - Intro

Package Contents:

Base Unit

Remote Control

USB Cable

SD Memory Card

Documentation/User Manual



What You'll Need

Small Phillips screwdriver, 4 AA batteries, 3 AAA batteries.

Optional

Computer device with Internet service and USB or SD port.

Earphones for private call preview.

Audio cable to external speaker or audio driven decoy.

1. Set-Up and Connection: Base Unit and Remote

Install Batteries: Open the battery compartment on the bottom of the base unit with a small Philips head screw driver and insert 4 AA batteries.

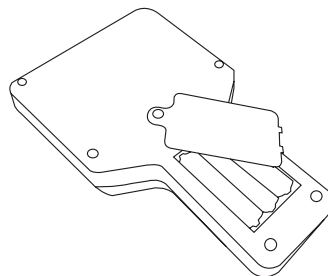
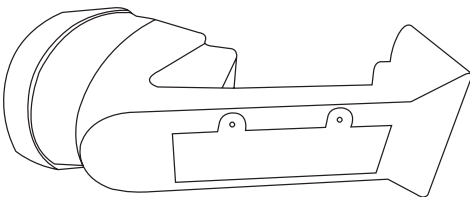

Open the battery door on the back of the remote control unit/transmitter (also Phillips) and insert 3 AAA batteries.

2. Insert SD Card

Open the Connection Port door by pushing down on the release tab.

Lift and fold the door down for access.

Insert SD card label side up into the slot and push it gently in until it clicks.

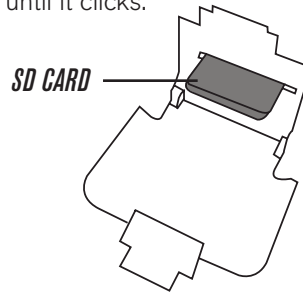

To remove SD card - Press in again and the card will pop out.

3. Turn On/Sync Up

Before you use your Record-Play-Shoot for the first time, you need to sync up the two units.

First dock the Remote into the Base Unit. Press down on latch at the rear of base unit for dock and release.

Turn both units on using the switches on the right hand side of each.

The LED status light will go on.*

Normal ON = Solid Red

Requires Syncing = Flashing Green

Base Battery Weak = Slow Red Flashing

**For all codes see Quick Reference in Chapter IV*

The Home screen will appear and cycle through status reports for battery strength, memory, number of files used/available and indicates whether SD card is installed or not – until a key is pressed.

Syncing happens automatically and screen indicates when completed - by telling you it is OK to remove the SD card.

REMOTE CONTROL SCREEN

RECORD-A-CALL
SYNC CONNECTION

<----->

OK TO REMOVE

Note: This happens very quickly with small amounts of data and more slowly for transferring larger amounts of data.

All operations can work with remote seated in base unit or separately except for synchronization.

4. Select a Sound

Press SOUND key on the remote

Screen will show 4 ways to locate files

Move cursor with Up/Down arrows

Press SELECT to choose Sound Files

>SOUND FILE
FOLDER
PLAYLIST

RECENT

The ten sound files that come pre-loaded with your RPS will appear in alphabetical order.

They are in a folder called PREDATOR1.

Arrow in lower corner means more choices below.

Arrow in upper corner means more choices above.

>FEMALE_COYOTE_HOWL
COYOTE_FOOD_FIGHT
BETA_MALE_COYOTE
HOUSE_CAT

v

Move UP/DOWN arrows to choose file.

>FEMALE_COYOTE_HOWL
COYOTE_FOOD_FIGHT
BETA_MALE_COYOTE
HOUSE_CAT

v

FEMALE_COYOTE_HOWL
>COYOTE_FOOD_FIGHT
BETA_MALE_COYOTE
HOUSE_CAT

v

FEMALE_COYOTE_HOWL
COYOTE_FOOD_FIGHT
>BETA_MALE_COYOTE
HOUSE_CAT

v

HOUSE_CAT
COTTONTAIL_DIST
BABY_CROWS

^

>HARE



5. To PLAY a Sound

Press PLAY to play once, or SELECT for Repeat Option. (Note: for private listening you can use the earphone jack located in the connection port) *see Chapter II.*

Use UP/DOWN arrows to change number of times you want to play (Up to 99 TIMES).

READY TO PLAY

YELP
>PLAY 2 TIME

Press PLAY.

READY TO PLAY
YELP

The Sound file name will flash and the repeat number counts down (2 seconds of silence in between).

NOW PLAYING

Press PAUSE to stop, PAUSE again to keep playing.
Press PLAY to restart from beginning.

At the end of the repeat playback the screen will revert to READY TO PLAY with the last file played selected. You can also cue up the next sound while one is playing.

**Instructions for using Folders, Playlists and Favorites can be found in Chapter III.*

Chapter II: Connecting to Computer with SD Card or USB cable

Open the Connection Port by pushing down on the release tab.

Lift and fold the door down for access.

The Connection Port includes connections for the SD Card, USB and the audio output jack.



If Your Computer has a Slot for an SD Card

Remove SD card by pressing gently in. Card will pop out. Insert SD card into computer device.

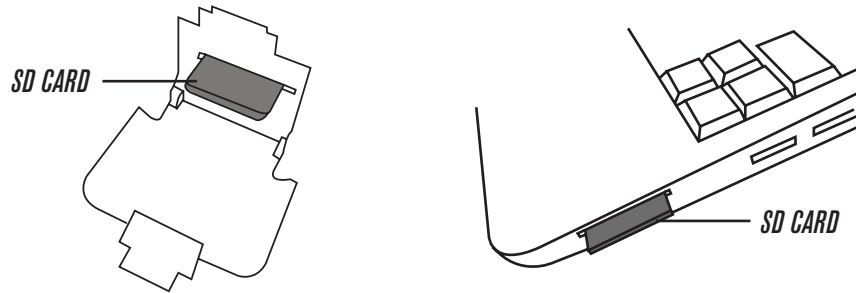

On most computers the SD card will appear on the screen as a removable disk and can be accessed in the same way. Just drag and drop folders or individual sound files to the SD memory card.

Tip: Since it is easier to label files on a computer, now is a good time to think about how you might use playlists in the field and organize accordingly.

When you have completed downloading to the SD card, replace it in the SD port in the base unit.

Attach the Remote to the Base Unit and sync up again.

Your RPS is now fully operational.

OR via USB

Attach small end of USB cable to the USB connection in the RPS Connection Port.

Attach large end of USB cable to your computer.

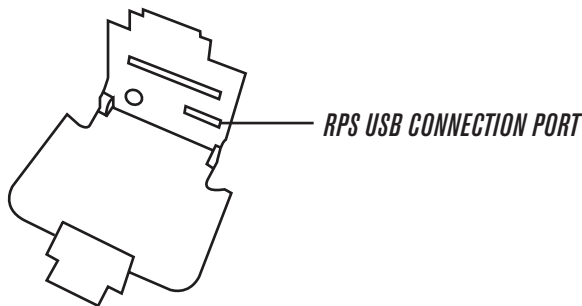

On your Remote screen you will get confirmation when a USB connection is made (PC or MAC). All other functions are disabled while this connection is live. The RPS will appear on most computers as a removable disk or other storage device.

USB CONNECTION flashes during data transfer:

Moves back and forth during data transfer – Warning DO NOT REMOVE.

When the data transfer is complete the screen will say OK TO REMOVE.

Remove the USB according to the instructions of your computer. When you remove the USB the RPS screen goes blank and the unit turns off.

Free Credits for Game Call Swap

In addition to the calls provided with your RPS and your own recorded calls, you can also buy/sell/swap a wide variety of calls at www.gamecallswap.com

Contact Customer Service at 1.800.891.3660 and request your owner code by providing the serial number of your RPS. (Press MENU select INFORMATION and ABOUT to see Serial Number)

Now go online to www.gamecallswap.com and Register as a Buyer/Swapper. Preview as many calls as you like then move selections to the shopping cart. At checkout type in your owner code and your Free credits will be applied.

Expand your call library - and even sell your own recorded calls.

Chapter III. In the field: Playback and Recording



Playback

Basic Playback – In Section I we showed you how to play a call from the RPS pre-programmed sounds. Playing back from the calls on the SD card works the same way. Just use the SOUNDS, SCROLL (UP/DOWN arrows), SELECT and PLAY buttons as before.

Playback a FOLDER

Press SOUNDS to see the options.

>SOUND FILES
FOLDERS
PLAYLISTS
RECENT

Indicate Folder with the Up/Down arrows – Press SELECT.

Indicate Folder desired with the Up/Down arrows – Press SELECT to choose to go back a screen press UNDO.

Press PLAY and the entire folder of sounds will play back in alphabetical order.

To PLAY a Sound from RECENT

Your RPS stores the last 10 sounds that you have used in a RECENT folder.

Use the cursor to select this option just as you would the others, then press PLAY to play the whole folder or select sounds within the RECENT folder. This list is saved in scratchpad memory in the remote and will disappear when you change anything on the SD card or connect to a computer.

PLAYLIST

Creating the PLAYLIST

When you get to your hunting location you may want to select just a few calls in a specific order for use during the day rather than going through all your stored sounds each time. For this you can use the PLAYLIST function.

The PLAYLIST can include up to 36 file names, which will be stored in scratchpad memory in your remote. The playlist is saved during your hunting session even if you stop for lunch, put the remote back in the base or turn it off.

The list will be erased after you create a new playlist or the first time you sync up after making a change on the SD card with your computer. The sounds still exist in their original form on the SD card.

Access CREATE PLAYLIST via the MENU key on remote.

Press SELECT and you will enter the NEW PLAYLIST menu.

Options are:

ADDFILE TO LIST

EXIT W/O SAVE*

**This will take you back to the MENU screen without creating a new PLAYLIST and will protect you from erasing an existing list.*

Add/Repeat Files to PLAYLIST

Select ADDFILE and you will be taken to the SOUNDS menu.

Use UP/DOWN to choose a sound for the playlist.
This time when you press SELECT the sound will be added to the end of the PLAYLIST and you will be bounced back to the PLAYLIST menu.

Here you can review the list with the UP/DOWN arrows or select REPEAT to schedule a repeat of the new file (up to 99x) or ADDFILE to add another sound.



SILENCE Option

For pacing your calls you may want to add silence – Silence is included in the Predator 1 folder (silence5sec). It can be repeated just like any other sound.

When you are done creating your playlist SELECT - SAVE LIST & EXIT.

Screen will confirm that list is saved.

When you play the PLAYLIST it will playback all the sounds in the order that you selected them. You can manually stop the playlist by pressing pause/play.

RECORDING

The RPS is designed for recording your own sounds in the field.
There is a built-in microphone in the Base Unit.

To prepare for recording make sure that the SD card is in place.
The Remote screen will flash a warning if there is no SD card.
You can record with or without the Remote attached to the Base Unit, and with the Base Unit in either an upright or vertical position.
Pick a clear unobstructed location to get the cleanest recording.
Do a couple of test recordings to check for ambient noises that might interfere.
On Remote - Press RECORD to activate record capability
Press SELECT to start recording
The word RECORDING flashes (LED on side of unit also flashes)
and shows you the recording time in seconds
Press SELECT again to stop recording.

*Note: There is a slight delay from pressing RECORD on the Remote until the Base Unit begins actual recording.
You can record up to 36 files of up to 15 seconds each.*

PLAY/RE-RECORD or SAVE

When you press PLAY the filename RECFILE## (01, 02 and so on up to 36) appears, the sound plays and shows the time counting down. You may want to use your earphones for silent previewing.

At this point you will be given the option to SAVE the new recording; PLAY it again or RE-RECORD.

>SAVE
PLAY
RE-RECORD

If you don't like the recording you just made, press RE-RECORD and record again over the previous recording. If you are happy with the sound, select SAVE (UP/DOWN; SELECT).

Once you have saved a sound it cannot be deleted in the field. It can only be deleted when connected to a computer.
The next screen will give you the option of RECORD ANOTHER or EXIT to return to SOUNDS menu.

Newly recorded sounds can be used right away but not moved to PLAYLIST until you have gone to a computer and assigned them names/folders.

Saving a Field Recording

Take the SD card to your computer and drag and drop the files to your desktop.
This is the place to review and assign file names to reflect content.
You may also want to decide which files to share or swap.



Chapter IV. QR Guides

Quick Reference - Navigating the Remote Control Keypad

Up/Down Arrows – Moves the cursor on the screen up and down Increments numbers for Repeat function.
Select – Used for choosing functions, and moving to next function.
Sound – Calls up the Sound Files.
Play – Plays a selected sound file.
Pause – Pauses a selected sound file and when pushed a second time continues the sound from where you left off.
Record – Activates record function.
Menu– Calls up backlight, memory, battery status and Add to Playlist as well as short form Instruction reminders.
Undo – Cancels latest selection and takes you back a step.
Vol +/- Vol – Increases/Decreases volume and displays volume level on screen.
Default volume level at start up is 5.
After 3 seconds of without volume activity, screen returns to previous action.
Flashlight – Activates/Deactivates the Red Flashlight.

Quick Reference – LED Indicator

Normal ON	Solid red
Requires sync	Flashing green
Computer connected	Alternating red and green flashing
Base battery weak	Slow red flashing
Recording	Long solid red with short pause
SD card full	Fast flashing red with short pause
No SD card	Flash red twice and long pause

Quick Reference – MENU Options

The MENU button gives you quick access to a number of functions. Use the Up/Down cursor keys and SELECT to choose the option you want.

1. Backlight ON/OFF – press SELECT to cycle ON/OFF to make the Remote screen easy to read.
2. STATUS – Gives you the opportunity to check status of your SD Card memory used and available as well as battery charge levels.
3. LED Color Codes – On board listing of the color codes listed above.
4. ADD To PLAYLIST – Shows last files of playlist.
5. INFORMATION – On board instruction mini-reference.

Chapter V - Other features and functions

Antenna – Point up in the air for maximum distance, adjust appropriately depending on position of base unit
Placement – The Base Unit Options has a plastic eye on front suitable for attaching a lanyard or other cord for suspending the unit from a tree or blind.

Chapter VI – Maintenance/Troubleshooting/Specifications

Though the product has been ruggedized for outdoor use, please use the same care you typically would use for any portable consumer product. The unit is water resistant but avoid heavy rain, submersion in water, etc.
Don't store or use in extreme temperature of less than -22 degree F (-30 ° C) or more than 175 ° F (80 ° C).

Cleaning

Keep contacts clean and free from direct heat and moisture.
Wipe the outside with moist, clean cloth.
Use ordinary household cleaner if needed.

Batteries/Power

When not in use power down and store in a dry place.
Remove the batteries from both units when not used for an extended time (more than 30 days).

It is a good idea to clean the contacts between base unit and remote before you go into the field and more often if you are in dirty or damp conditions.

Base Unit automatically shuts off after 2 hours of no use/turn off-turn on to restart.

Remote Control shuts off after 15 minutes of no use.



If the Base Unit/Remote Unit or flashlight won't power up, check batteries.

New batteries will be the most reliable and are preferred for going in the field whenever weather conditions might be an issue.

Audio File Formats

The RPS accepts WAV and mp3 files. Field recordings are WAV files.

It is recommended to use one file format per folder but if you do mix WAV/and mp3 in a folder they will be sorted in alphabetical order by format.

Your RPS comes with 10 sounds (WAV files) built into internal memory. These are in a folder called Predator1.

SD Card

The capacity of the SD slot is up to 32 GB. You may want to have more than one SD cards for back up or sorting your sounds. As with any computer memory device, store in a dry, cool place.

Antenna range

Up to 100 yards or more depending on strength of batteries, weather and other interference.

Call Customer Support 1.800.891.3660

or go to the website www.casscreek.com for latest information and updates.

Thank you for supporting our products. We welcome your input and suggestions.

Cass Creek RPS – One Year LIMITED WARRANTY

The Cass Creek RPS carries a one (1) year Limited Warranty on materials and workmanship from the date of purchase. To be valid, Register online at www.casscreek.com/registration or contact Cass Creek Customer Service, either via email or telephone and provide the unit serial number within thirty (30) days of purchase. Should you forget to register your RPS, you will be required to show proof of purchase prior to any warranty repair. We recommend that you do this now while you have your receipt.

For the first three (3) months from date of purchase, Cass Creek will repair or replace the unit or defective part at no charge. For the remaining warranty period you will be required to return the item with \$ 10.00 check or money order for handling, processing, packaging, shipping & labor. There may be additional charges for non-warranted items. If you have not completed the Warranty Registration process within 30 days of purchase, please include a copy of your dated sales receipt showing the dealer's name, product and purchase price. We will either repair or replace the item in accordance with the Cass Creek Repairs Terms and Conditions and will then return postpaid. This Warranty is limited to the original purchaser only. The warranty does not cover damage caused by dropping, water, normal wear, intentional or unintentional damage, loss or breakage caused by abuse, misuse or accident. The warranty is void if your unit has been altered or unauthorized service work has been attempted.

For service under this Warranty, you must first call for an RMA (Return Merchandise Authorization) number. Explain to the Customer Service Representative the defect. We may be able to correct the problem over the phone without a return.

If it is necessary, return the defective unit postpaid, with the RMA number on the outside of the box. In most cases, the product will be repaired or replaced and shipped back to you within thirty (30) days. Please provide as much detail as possible regarding the problem you are experiencing. Also provide return shipping and contact information. Warranty repairs will be returned to you via ground transportation. The entire unit must be returned for proper evaluation. Do not return only the non-functioning part.

REPAIR OR REPLACEMENT AS PROVIDED UNDER THIS WARRANTY IS THE EXCLUSIVE REMEDY OF THE CONSUMER. CASS CREEK SHALL NOT BE LIABLE FOR ANY INCIDENTAL, SPECIAL OR CONSEQUENTIAL DAMAGES FOR BREACH OF ANY EXPRESS OR IMPLIED WARRANTY ON THIS PRODUCT OR RESULTING FROM THE USE OR UNAVAILABILITY OF THIS PRODUCT, EXCEPT TO THE EXTENT PROHIBITED BY APPLICABLE LAW, ANY IMPLIED WARRANTY OF MERCHANTABILITY OR FITNESS FOR A PARTICULAR PURPOSE ON THIS PRODUCT IS HEREBY DISCLAIMED. THIS WARRANTY SUPERCEDES ALL OTHER WARRANTIES ASSOCIATED OR INCLUDED WITH THIS PRODUCT.

Some states do not allow the exclusion or limitation of incidental or consequential damages, or allow limitations on how long an implied warranty lasts, so the above limitation may not apply to you. This warranty gives you specific legal rights, and you may have other rights which vary from state to state.