



www.arctic.ac

# P253 BT

User Manual



[support.arctic.ac/p253bt](https://support.arctic.ac/p253bt)

Dear,

Thank you for choosing the ARCTIC P253 BT.

This entry level compact headset is designed for the everyday music lover that enjoys the freedom of Bluetooth® technology. I hope you enjoy the P253 BT and we at ARCTIC look forward to further enriching your life with our products. If you would like to share how you use ARCTIC's products please do so at <https://www.facebook.com/ARCTIC.en>

ARCTIC is a fully carbon neutral company and your support helps us to compensate every kilogram of CO<sub>2</sub> we produce. Thank You.

Sincerely,

A handwritten signature in black ink, appearing to read "M. Huber".

Magnus Huber  
ARCTIC CEO

## Packaging Contents

Headphones x 1, Mini USB Charging Cable x 1,  
User Manual x 1

## Music Stutters

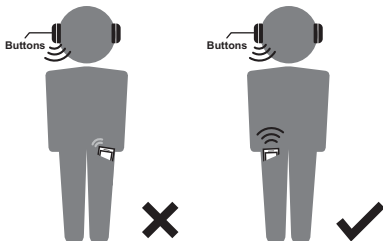

## Function Diagram

- ① Multifunction button
- ② LED indicator
- ③ Volume +
- ④ Volume -
- ⑤ Mini USB charging port
- ⑥ Forward
- ⑦ Backward
- ⑧ Microphone

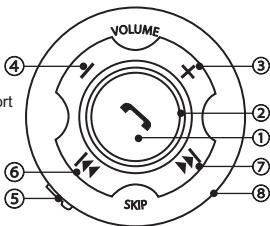

## Switch the Headset On or Off

### Switch on

Press the multifunction button for 3 seconds until the blue LED lights up

### Switch off

Press the multifunction button for 3 seconds until the red LED lights up

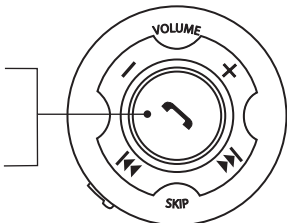

## Pair with Your Smartphone / Tablet

1. Switch on the P253 BT by press the multifunction button for 3 seconds.
2. The P253 BT automatically enters pairing mode shown by the red and blue LED flash alternately.
3. Turn on Bluetooth on your phone and pair it with the headphone.

### Example: iOS

Press Settings > General > Bluetooth and switch Bluetooth on > ARCTIC P253 BT > Pair

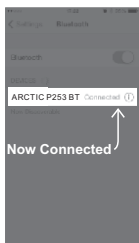
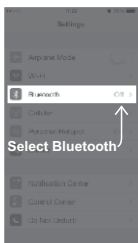

## Example: Android 4.0

Press Menu > Settings > Switch on Bluetooth > Bluetooth > Search for devices > ARCTIC P253 BT > Pair

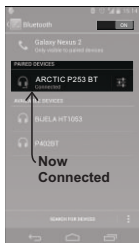
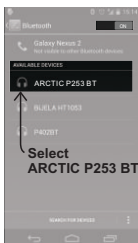

### Notes:



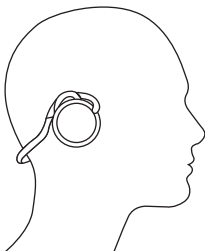

- Pairing mode will last up to ten minutes or until a device is found, two tones will sound to let you know when pairing has stopped.
- If you exceed the effective range of approx. 10M (33ft) the headphone will disconnect and will automatically reconnect if the speaker re-enters the effective range within ten minutes.

## How to Wear the Headset



## Phone Operations

If the mobile device that is paired (via Bluetooth) with the P253 BT headphone is a cellular phone you can:

<b>Answer Call</b>	Press  once.
<b>End Call</b>	Press  once.
<b>Refuse Call</b>	Press and hold  for 2 seconds.
<b>Redial the last dialed number</b>	Press and hold  for 2 seconds.
<b>Switch Call</b>	Press and hold  for 2 seconds while in a call.

## Headset Controls

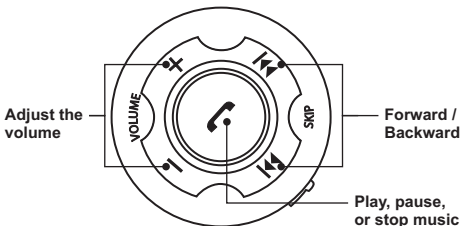

## LED Indicators

Status	Indication
Charging	Red LED on
Battery full	Red LED off
On	Blue LED flashes
Pairing mode	Red and blue LED will flash alternately
Low battery	Red LED flashes

## Reconnection

1. Turn on Bluetooth on phone.
2. Switch on the P253 BT by press the multifunction button for 3 seconds.
3. If your device was the latest one to be paired with the P253 BT it will connect automatically otherwise please repeat pairing section.

## Charging the Headset

The P253 BT can be charged while switched on or off.

1. Insert the micro USB cable into the P253 BT and the USB side into a power source. (We recommend the Home Charger 4500).
2. When the Blue light on constantly the P253 BT is fully charged.

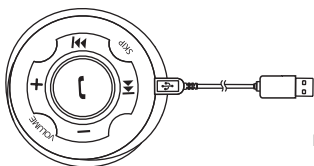

Home Charger 4500

It is recommended to fully charge before initial use for better battery life.

## Cautions

- Wireless connections are affected by obstructions such as walls, human body and other devices.
- Keep P253 BT dry, moisture may damage electronic components.
- Exposure to high temperature will shorten the life and damage electronic components.
- Opening / altering the P253 BT voids all product warranty.
- Rough handling may damage inside electronic components.

## Specifications

Wearing Style	Supra-aural, On-ear, Neckband
Frequency Response	18 Hz – 22 kHz, THD 0.1%
Bluetooth Version	V3.0 +EDR Class 2
Rechargeable Battery	400mAh Lithium Polymer battery
Standby Time	Up to 400 hours
Weight	71 g



**© 2013 CSR plc and its group companies.**

The Bluetooth® word mark and logos are registered trademarks owned by Bluetooth SIG, Inc., and any use of such marks by ARCTIC (HK) Ltd. is under license. Other trademarks and trade names are those of their respective owners.

**FCC ID UFDBSH10**

This device complies with Part 15 of the FCC Rules. Operation is subject to the following two conditions: (1) this device may not cause harmful interference, and (2) this device must accept any interference received, including interference that may cause undesired operation.

**© 2014 ARCTIC Switzerland AG. All Rights Reserved.**

No part of this manual including the products described in it, may be reproduced, transmitted, stored in a retrieval system, or translated into any language in any form or by any means, except documentation kept by the purchaser for backup purpose, without the express written permission of ARCTIC Switzerland AG. In no event shall ARCTIC its directors or employees be liable for any indirect damages, incidental or consequential damages arising from any defect or error in this manual or product.