



USER'S MANUAL



THANK YOU FOR YOUR TRUST



Skywalk GmbH & Co. KG congratulates you on the purchase of your X-Gloo, the modular lightweight tent system without compressors and poles.

In order to guarantee the perfect operation, optimal function, long product life and your personal safety and the safety of your guests, please note the following:

Before you use your X-Gloo for the first time, read these operating instructions carefully and follow the safety indications.

All functions, maintenance and repairs should only be carried out to the degree described in these operating instructions.

Please contact your X-GL00 Team for repairs exceeding these instructions!

If you loan your X-Gloo Event Tent to another person, please pass on these instructions and make sure that the person is fully advised regarding the technical aspects of the X-Gloo Event Tent, in order to avoid faulty operation.

If you have any further questions, we are always happy to assist you:

Service Hotline
+49 (0)8641-6948-60

TABLE OF CONTENTS

TECHNICAL DATA	4	ANCHORING	10	TAKEDOWN	20
STANDARD DELIVERY	5	Anchoring Tube Ballasts	10	CLEANING	20
SPECIAL INSTRUCTIONS	6	Anchoring with Water Ballast Barrels	11	REPAIR	21
SETUP	8	Anchoring with the Anchoring Set	12	Bladder Repair	21
1. Lay out the Matrix	8	Securing Walls with Wall Ballasts..	13	Replacement of the Protection Strip	21
2. Test the Valves	8	BLOCK-BUILDING SYSTEM	14	Bladder Replacement	22
3. Inflate.....	8-9	Side Walls	14		
Inflation with the Hand Pump.....	8	Tunnel Part	16	X-RELAX	25
Inflation with the Electric Pump		Canopy and Canopy Banner	16		
Bravo 0V10/Bravo 2000	8	Roof Banner	16		
Inflation with the Bravo		LED Lighting Kit	17		
Turbo Max 12 V for car battery	8	Removing the Roof	18		
Setup using the Protection Foil	9	Seperating the Tubes.....	18		

TECHNICAL DATA

4x4



Exterior side lengthca. 4 m
Entrance height.....ca. 2,0 m
Total heightca. 2,3 m

Covered area
without Side Walls..... 7,23 m²
with 4 Canopies.....ca. 23 m²

Tube diameter.....ca. 25 cm
Weight without Wallsca. 13,3 kg

Setup
Hand Pump 15 min
Electric Pump3-5 min
Operating pressure* 0,2 bar/3 PSI

5x5

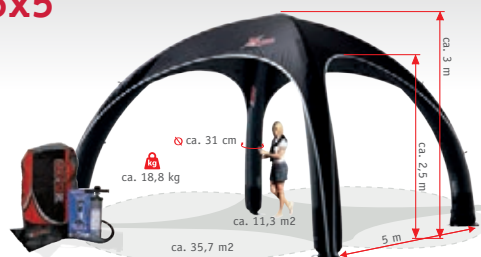

Exterior side lengthca. 5 m
Entrance height.....ca. 2,5 m
Total heightca. 3 m

Covered area
without Side Walls..... ca. 11,3 m²
with 4 Canopies..... ca. 35,7 m²

Tube diameterca. 31 cm
Weight without Walls ca. 18,8 kg

Setup
Hand Pump 23 min
Electric Pump 7-10 min
Operating pressure* 0,2 bar/3 PSI

6x6



Exterior side lengthca. 6 m
Entrance height.....ca. 3,0 m
Total heightca. 3,57 m

Covered area
without Side Walls..... 16,27 m²
with 4 Canopies..... ca. 51,34 m²

Tube diameter.....ca. 37 cm
Weight without Walls. ca. 22,5 kg

Setup
Hand Pump 30 min
Electric Pump 10-15 min
Operating pressure 0,18 bar/2,6 PSI

8x8



Exterior side length .. ca. 7,85 m
Entrance height.....ca. 3,94 m
Total heightca. 4,8 m

Covered area ca. 30,3 m²
Tube diameter.....ca. 43 cm

Weight without Walls.. ca. 42 kg
Setup with Electric Pump.. 25 min
Operating pressure* 0,35 bar/5 PSI

**This data serves primarily as information, since the operation of the Overpressure Valves is automatic.*

STANDARD DELIVERY

X-GLOO MATRIX WITH ACCESSORIES

4x4, 5x5 AND 6x6 MODELS

- 1x - X-Gloo Multifunction Transport Bag (1)
- 1x - Hand Pump (2)
- 1x - Side Wall Bag (3)
- 1x - Anchoring Line Set (4)
- 1x - Manual and Quick User Guide (5)
- 1x - Closing Rod for X-Gloo 5x5/6x6 (6)
- 1x - X-Gloo Repair Kit (contents below)



X-GLOO MATRIX WITH ACCESSORIES

8x8 MODEL

- 1x - Quick Pack Sack (7)
- 1x - Hand Pump (2)
- 3x - Side Wall Bag (3)
- 1x - Anchoring Webbing Set (8)
- 1x - Manual and Quick User Guide (5)
- 1x - Closing Rod (6)
- 1x - Setup Support Bar (9)
- 1x - X-GLOO Repair Kit (contents below)



X-GLOO REPAIR KIT

- 1x - Replacement Bladder (10)
- 1x - Replacement Protection Strip (11)
- 1x - Replacement Overpressure Valve (12)
- 1x - Adhesive Repair Patches (13)
- 1x - Fixing Element Tool (14)
- 1x - Allen Wrench (15)



SPECIAL INSTRUCTIONS

GRAPHICS/DESIGN

- A transparent effect can occur (especially with background light) with different tent color combinations (e.g. light Roof color and dark Tubes). This should be taken into consideration by customers when designing the X-Gloo. If in doubt, please consult your X-GLOO professional.

SET-UP

- Do not exceed the specified maximum air pressure.
- The X-Gloo is not intended for long-term outdoor use and should be inspected for wear or damage after every event.
- If small folds form inside the Tubes when inflating, it is helpful with the larger tents to gently shake the Tube during the inflation process. This will help keep the inner Bladder in the correct position assuring proper inflation.
- The X-Gloo should be deflated in winds exceeding 60 km/h (The first sign of overload is when the Roof begins to compress). When high wind force is expected (gusts of more than 50-60 km/h for the 4x4, 5x5, or 6x6; and more than 40 km/h for the 8x8) the tent must be secured and anchored.

⚠ PLEASE NOTE: *If Side Walls are completely zipped in to a 6x6 tent, a force of almost 500 kg is the result. For this reason, please pay special attention to the following points:*

- According to the ground surface, you may require longer or additional stabilisation materials.
- Additionally, you must attach Anchoring Lines/Webbing to all Shoulder Loops (found on the outside of each Tube)!
- Our smaller Tube Ballasts (ideal for use on hard ground surfaces) may not be sufficient for securing your tent against strong wind gusts. Refer to our Wind Resistance Certificate to determine whether Water Ballast Barrels are required.
- Winds stronger than 60 km/h can lead to structural damage of the tent and this damage is no longer covered by the warranty.

- If weather conditions deteriorate dramatically, all Overpressure Valves should be opened immediately and the tent deflated. Additionally, the deflated tent should be weighted down.
- In general, the Protective Strips on the bottom of the Tubes are exposed to more wear and tear on rough surfaces due to the movement of the tent from wind.

OPERATION

Keep open fires and heat sources away from the X-Gloo.

FIRE PROTECTION CLASSIFICATION:

• Description of Norms:

- DIN 4102-B1 (Abb.: B1) Controls testing and requirements on the reaction to fire of building materials. German norm, used in most European countries.
- CPAI 84-95, Section 6 Specification of the American Association of Sailcloth Materials for the assessment of flame-retardant materials used in (event-) tents. Due to the fact that the X-Gloo is in use worldwide at tradeshow as an innovative event tent, we reserve the right not to certify the tent according to the national norms of each country. The certification according to CPAI 84 fulfills the international requirements for flame resistance in tent products and includes similar test criteria like DIN 4102-B1 or NFP 92501-7M2.
- When the tent is used in sandy terrain, avoid getting sand grains in the Tubes or in the Pump
- Keep the valves free of sand and dirt particles and clean them if necessary, since this can cause faulty operation and pressure loss.
- The tent can be damaged by the penetration of sharp objects (e.g. knives, tools) in the Tubes causing leakage and loss of pressure. Handle the X-Gloo with appropriate care.
- Avoid extreme variations in temperature (day and night) or long-term use. This can lead to loss of air pressure, requiring reinflation of the tent.

Procedure in the case of pressure loss:

- FIRST close all valves TIGHTLY!
- If pressure loss continues, blow out the Overpressure Valves to remove all dust or dirt particles.
- If pressure loss still continues, the quickest solution is to remove the Bladder and replace it, as a damaged Bladder is likely the cause.
 - If the damage is visible on the Bladder and the damaged area is smaller than 1 cm -> Apply the Adhesive Repair Patch included in the Repair Kit.
 - If the damaged area cannot be found, spray some soapy water onto the inflated Bladder surface so that the escaping air bubbles are visible and the damage can be located. Then apply the Adhesive Repair Patch to repair the Bladder.

STORAGE

- Avoid pressure spots (e.g. do not lean on the tent with your knees while folding the tent up).
- Store the X-Gloo in a dry location and at temperatures not exceeding 40° celsius.
- Do not pack or store the X-Gloo when damp or wet, since this can cause the formation of mold spots and discoloration.
- At temperatures lower than 0° celsius, folding can lead to damage of the components. Take special care with the Window Walls in low temperatures and pack them carefully.
- Never store the X-Gloo in an automobile in direct sunlight. The intense heat can cause the Window Walls to stick together irreversibly, or may cause permanent damage to the cloth.

⚠ Important information for digitally-printed parts!
Digital printed elements must be stored in dry condition!
CAUTION: *If the elements are stored while still damp, the ink from the printed material can bleed and the printing can become permanently damaged! We are unable to accept liability.*

MAINTENANCE, CLEANING, REPAIR

All kinds of repairs can be done in our workshop in Marquartstein or in the Service Center in Las Vegas, Nevada. We can also take care of special requests (additional straps, velcro strips, etc.) at our facility.

- Maintenance and repair should be carried out only by X-GLOO or by an authorized Service Center.
- The X-Gloo should be periodically inspected for chafe marks and damage and promptly repaired.
- In order to avoid damage of the material coating, first attempt to remove dirt and stains using a soft, dry brush or microfiber cloth. Only if necessary use a small amount of mild alkaline solution mixed with water. Avoid the use of solvents, washing machines or steam cleaning.
- Re-waterproofing is not possible.

MATERIALS

- Bleaching of the material is possible with extended UV exposure (e.g. at high altitude or extended setup time). White wall material tends to yellow from UV exposure, and is easily stained when contacted with dust and dirt. All of the materials currently implemented in the X-Gloo have been subjected to extensive material testing. It is practically impossible to state when exactly a color change could become visible, since the influencing factors vary strongly. However: All cloths change in color with extensive UV exposure! According to expert knowledge, with proper care the X-Gloo will show only minimal color change after many years of use. The range of use will not be limited.
- The materials used (and therefore, the entire tent) are waterproof.

SETUP

1. LAY OUT THE MATRIX

Spread the X-Gloo Matrix out in the area intended for setup. Try to make sure that the tube endings of the X-Gloo are positioned approximately where you want them once the tent is inflated. This way you can avoid having to reposition or handle the tent again.

8x8 ONLY: Zip in the Middle Wall

Since the entrance height of an assembled X-Gloo 8x8 is very high, we recommend zipping in the Middle Wall before inflating the tent.

⚠ PLEASE NOTE: Only the outer side of the Middle Walls are equipped with a Zipper Rain Protector. If you should choose to attach the Middle Wall with the outer side facing inwards (so that a logo printed on the outside is visible from the inside of the tent for example), the waterproof quality of the tent in the area of the zipper can not be guaranteed.

2. TEST THE VALVES

The Valve consists of the socket ring (1) attached to the Bladder and a screw-on housing (2) with attached protective cap (3). The housing must be tightened securely to the socket ring before



inflation (4). The Backstroke Valve in the housing prevents air from escaping. In order to prevent dirt from entering, the protective cap is screwed onto the housing after inflation is complete. To deflate, simply unscrew the housing from the socket ring.

⚠ PLEASE NOTE: There is one red Overpressure Valve (5) on each Tube located beside the Valve. The Overpressure Valve opens automatically as soon as the Tubes reach the maximal pressure.



The function of each Overpressure Valve should be tested before inflation. To do this, unscrew the housing and make sure that the spring can be pushed in.

⚠ PLEASE NOTE: Sand and dirt can clog the spring and Overpressure Valve so that the function is negatively influenced.

Inflation with the Hand Pump

The Hand Pump included in the standard delivery is equipped with different valve sockets and an air hose. Do not kink or press down on the air hose to avoid air leakage or damage!

⚠ PLEASE NOTE: See the notation on the hose connection:

Inflate | Deflate

Inflation with the Electric Pump Bravo OV10* and Bravo 2000*

Screw the hose (included in delivery) to the correct opening on the pump.

⚠ PLEASE NOTE: See the notation on the hose connection:

IN = Inflate | OUT = Deflate

Stick the plug into the outlet. Please note that the Bravo 2000 has a booster which can be turned on with the switch. Please read and follow the operating instructions included with the Bravo OV10 and Bravo 2000.

**120V and 230V models available.*

Inflation with the Bravo Turbo Max for 12V automobile battery

The Bravo Turbo Max can be connected to a 12V automobile battery. To avoid draining your battery, make sure that it is fully charged or that the vehicle is running while operating the pump. Please read and follow the operating instructions included with the Bravo Turbo Max.

Connect the cable clamps to the respective connections of the battery (red = +, black = -) and adjust the pressure control to 3 PSI.

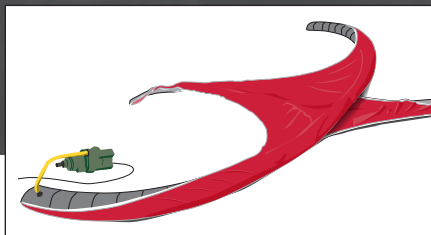

Step 4: Inflate two Tubes opposite one another.

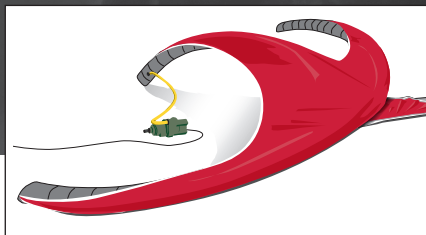

Step 5: Inflate the third Tube so the tent will begin to rise.

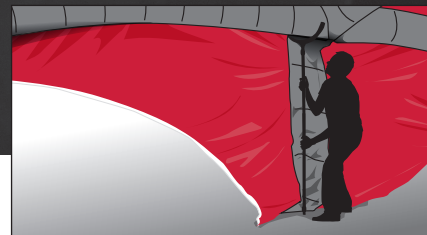

Step 6: Using the Setup Support Bar to raise an 8x8 X-Gloo.

3. INFLATE

Step 1: Make sure that the pump hose is equipped with the correct adapter for the Valve.

Step 2: Connect the hose to the pump and then connect the hose end with the adapter to the Valve on the X-Gloo Tube.

Step 3: Now start the pump by turning the switch to ON.

Step 4: First inflate two Tubes opposite one another to form a 180° semicircle.

Step 5: Next inflate the Tube between those inflated in Step 4. The tent will begin to rise off of the ground.

Step 6: Now you can inflate the final Tube. With the 8x8 it is recommended to work with two people. One person lifts

the Tube intersection at the middle of the Roof and sets the fork of the Setup Support Bar directly under one of the Tubes in the area of the Tube intersection. The second person operates the pump, moving it as necessary with the Tubes as they are inflated.

Step 7: Close the Valves after inflating the Tubes.

Step 8: If the Tubes have been inflated correctly, the X-Gloo will stand in a stable and wrinkle-free position. All four Tubes can now moved by hand to the final position.

For more information, watch our how-to video at:
www.x-gloo.com/en/experience/videos/



SETUP USING THE PROTECTION FOIL

Follow these setup instructions if using our optional Protection Foil to help prevent soiling or damaging your X-Gloo during setup.

Step 1: Lay out the Protection Foil where you want to set up the tent and roll the Matrix out on top of it (1).

Step 2: Position two Tubes opposite one another in a half-circle and then inflate with air (2). Inflate the remaining two Tubes as described in the regular setup process.

Step 3: Position the Tube ends at the edges of the Foil so that grommets on the

inside of the Tube ends rest exactly over the grommets of the Protection Foil (3).

Step 4: Remove the Protection Foil and anchor the tent using one or more of the methods described on pages 10-13.



ANCHORING

ANCHORING WITH TUBE BALLASTS (WATER OR SAND)

Each Tube Ballast Set includes four ballasts. The ballasts can be filled with water or sand/gravel, and then connected to the inside or the outside of the tent Tubes by using the two clips on each ballast.

⚠ PLEASE NOTE: Inside of each ballast is a Water Bladder (1) for use when filling the ballasts with water. If you choose to fill the ballasts with sand or gravel (2), you must first remove the Water Bladder from the ballast so it does not become damaged.

If filling with water

- Step 1:** Included in the Tube Ballast Set are a hose and various faucet adapters. Attach the hose to the faucet using the correct adapter (3).
- Step 2:** Open the velcro on the ballast cover and pull out the inner Water Bladder until the Fill Valve is visible (1).
- Step 3:** Open the Fill Valve, insert the other end of the hose and fill with water (4).
- Step 4:** Once full, remove the hose from the Water Bladder and close the Fill Valve and the velcro on the ballast cover.
- Step 5:** Connect the Tube Ballasts to the clips on the Tube endings (5). When doing so, be sure that the rubber-coated side of each ballast is facing down. To secure your tent during stronger wind conditions, multiple ballasts can be attached to each tube by connecting them to each other using the four toggle buttons on each ballast. Ballasts can be connected side-by-side or on top of one another.
- Step 6:** Tighten the straps on the clips so that the ballasts prevent the tent from rising—this provides the best stability.



ANCHORING WITH WATER BALLAST BARRELS

The **Water Ballast Barrels** can be used as anchors for your X-Gloo, as seating, or as both.

- Step 1:** Open the two valve covers on the Ballast Barrel. Make sure that the check valve at the bottom of the barrel is closed so that no water or air can escape when filling **(1)**. Push open the check valve at the top of the barrel so that air can escape.
- Step 2:** Connect the included hose to the valve at the base of the barrel and fill with the desired amount of water (up to 80L). To give the barrel a cleaner appearance, the remaining space can be then filled with air using one of our Electric Pumps. The hose provided with the Ballast Barrels is connected to the Pump in place of the Pump's yellow hose.
- Step 3:** Disconnect the hose from the barrel and make sure that both valves are tightly closed.
- Step 4:** With the help of an assistant, carry the Ballast Barrel to your tent location by lifting it by the handles. Or, if you are on your own, tip the barrel onto its edge and roll it.

Connecting to your X-Gloo

Ballast Barrels are connected to the X-Gloo by use of an included shackle. When connecting one or two Ballast Barrels to each Tube, use the shackle to attach the eyelet at the base of each Ballast Barrel directly to the large grommet at the base of the Tube **(2)**.

When using three Ballast Barrels on each Tube, the No-Rub Mat should be used. Connect the center eyelet on the No-Rub Mat to the Tube grommet. Then set the three barrels on the mat and connect each barrel to one of the three eyelets on the mat.

Digitally-Printed Cover (3)

The Ballast Barrels can be uniquely branded through the use of the Digitally-Printed Cover. Simply slip the cover over the barrel and close the zipper.

To Empty

To empty the Ballast Barrel, simply unscrew the lower valve cover and push open the check valve.

For more information, watch our how-to video at:
www.x-gloo.com/en/experience/videos/



ANCHORING

ANCHORING WITH THE ANCHORING SET

The **Anchoring Set** consists of: Anchoring Lines (Anchoring Webbing for the 8x8 X-Gloo), Line Tensioner, Tent Peg Puller for removing tent pegs stuck in hard or frozen ground (8x8 X-Gloo only), and assorted tent pegs packed in a Peg Bag.

ANCHORING SET 1: FOR 4X4 X-GLOO² TENTS

TENT PEG	QUANTITY	USE
300 mm Long	24 pcs.	inner Tubes + Anchoring Lines + Walls
500 mm Long	4 pcs.	outer Tube

ANCHORING SET 2: FOR 5X5 AND 6X6 X-GLOO² TENTS

TENT PEG	QUANTITY	USE
300 mm Long	20 pcs.	Walls + inner Tube or Anchoring Lines
500 mm Long	8 pcs.	outer Tube + inner Tube or Anchoring Lines

ANCHORING SET 3: FOR 8X8 X-GLOO² TENTS

TENT PEG	QUANTITY	USE
300 mm Long	16 pcs.	Walls
500 mm Long; 14 mm Ø	4 pcs.	Anchoring Webbing or Walls
500 mm Long; 19 mm Ø	8 pcs.	inner Tube + Anchoring Webbing
800 mm Long	4 pcs.	outer Tube

Using the Shoulder Loops

Step 1: Push the loop end of one Anchoring Line/Webbing through one of the Shoulder Loops on the tent **(1)**.

Step 2: Push the straight end of the Anchor Line through the loop end and pull it through until the anchor line is tight around the Shoulder Loop of the tent **(2)**.

Step 3: Using a Line Tensioner, secure the tent by connecting the Anchor Line to a tent peg positioned approximately 2 meters from the base of the Tube **(3)**. Tighten the line using the Line Tensioner.

Step 4: Repeat on the other three Tubes.

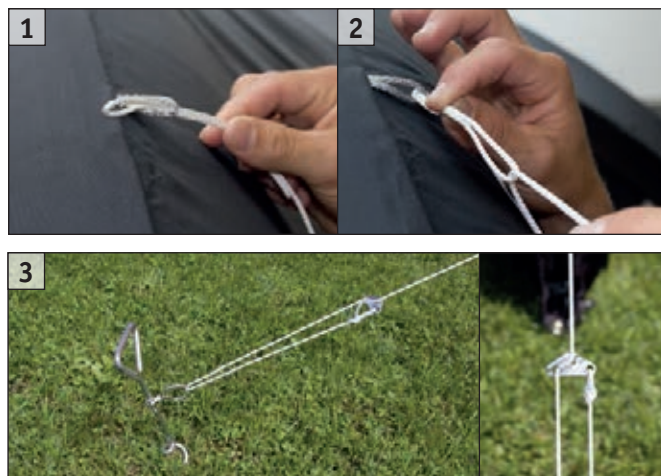
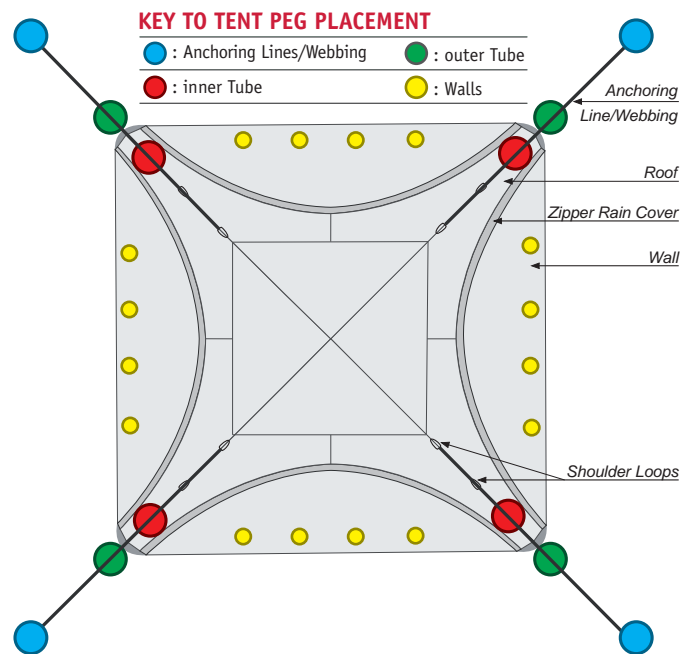



SECURING WALLS WITH WALL BALLASTS (WATER OR SAND)

Each Wall Ballast can be filled with water or sand/gravel, and then connected to the Wall using the provided toggle buttons (4).

⚠ PLEASE NOTE: Inside of each ballast is a Water Bladder for use when filling the ballasts with water. If you choose to fill the ballasts with sand or gravel, you must first remove the Water Bladder from the ballast so it does not become damaged (1).

If filling with water

Step 1: Included with each Wall Ballast are a hose and various faucet adapters. Attach the hose to the faucet using the correct adapter (2).

Step 2: Open the velcro on the ballast cover and pull out the inner Water Bladder until the Fill Valve is visible.

Step 3: Open the Fill Valve, insert the other end of the hose and fill with water (3).

Step 4: Once full, remove the hose from the Water Bladder and close the Fill Valve and the velcro on the ballast cover.

Step 5: Using the four toggle buttons, connect the Wall Ballast to the large grommets at the base of the Wall (4). When doing so, be sure that the rubber-coated side of the ballast is facing down. Multiple Wall Ballasts are recommended for securing Walls on 5x5, 6x6, and 8x8 model tents.

⚠ PLEASE NOTE: The function of the Wall Ballasts is to reduce the risk of damage to the tent walls and zippers through exposure to high winds. They are not intended to replace the Tube Ballasts, Water Ballast Barrels, or Anchoring Sets as a means to anchor the tent.

ELEMENTS

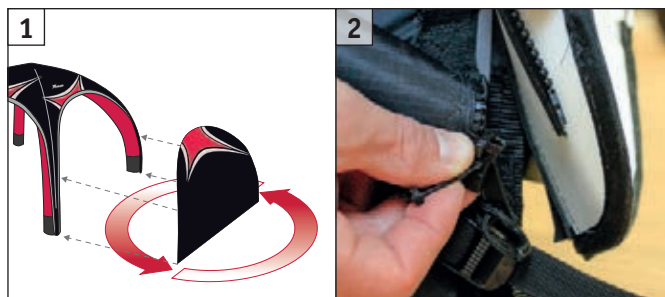

SIDE WALLS

The Side Walls are available in four variations: as Standard Walls (completely closed), Window Walls, Mesh Walls, and Entrance Walls. The zippers attach on the right and left of the Matrix and meet together at the top.

NOTE: Side Walls can be installed with the side of your choice facing outward. In this way, it is possible to have the printed side of the wall facing the outside or inside of the tent **(1)**.

Attaching the Side Walls

On the tube endings of the X-Gloo you will find access to zippers to attach the Side Walls. Connect the Side Wall to the X-Gloo Matrix and close both zippers to the top of the wall **(2)**.

Closing the Side Walls with the Closing Rod

For easier opening and closing of the Side Walls, a Closing Rod is included in the delivery of the 5x5, 6x6 and 8x8 X-Gloo. The hook at the end of the Closing Rod is connected to the Slider Puller and the Side Walls can be opened or closed **(3)**.

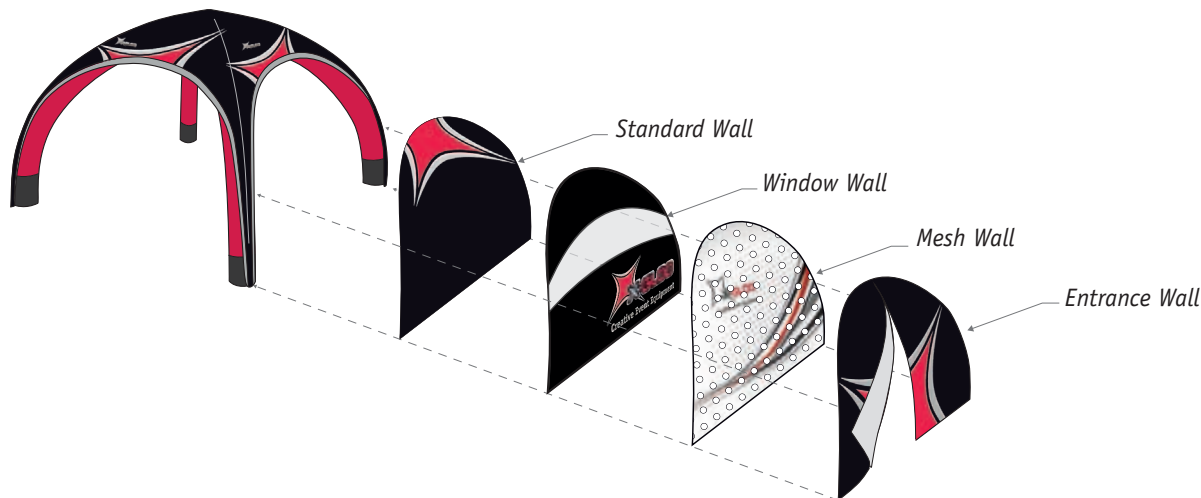



Opening and securing the Entrance Wall

The Entrance Wall is zipped on as described above in *Attaching the Side Walls*. To hold the Entrance Wall open, open the zipper in the middle of the Wall and gather each side together. On each side of the Entrance Wall you will find a toggle button on a length of cord. Fasten each side by inserting the toggle button through the loop of cord across from it (4).

Folding over the Side Walls to make Half Walls (5)

In order to secure the Side Wall in a horizontal half-open / folded position and prevent it from completely opening, the zipper puller on each side of the wall should be fixed to the small velcro strips on the inside of the tent roof (6 & 7).

Preventing strain/damage to the Side Wall zippers

If the Side Walls are exposed to high pressure (if the tent is set up in an area with high winds for example), the zipper will bear the strain. This is especially true for where the zippers are attached to the tube ends. To relieve strain to the zippers and to avoid damage to the X-Gloo or the Side Walls, you will find straps and buckles located at the base of each Side Wall. Connect these to the webbing loops provided on the tube ends (8). Tighten each strap until the tension on the zipper is relieved (9).

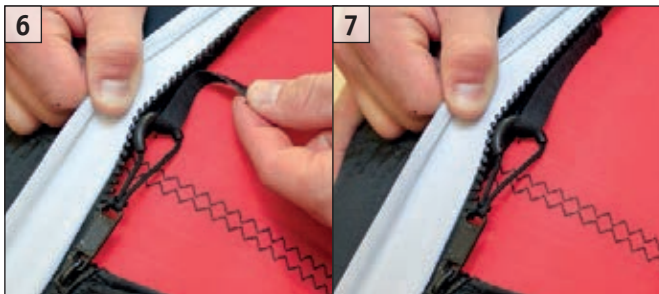

ELEMENTS

TUNNEL PART

The Tunnel Part makes it possible to connect one or more X-Gloos. It can be used to connect one size tent to a different size tent, or to connect multiple tents of the same size. The Tunnel Part is zipped on between the X-Gloos instead of using a Side Wall (1).

CANOPY AND CANOPY BANNER

The Canopy can expanded the covered area of the X-Gloo. To attach it, first prepare the two upper battens by connecting the two ends together (2). Insert the upper battens into the two sleeves built into the Canopy (3) by first opening the Velcro found on one end of the sleeve. Close the Velcro tab after each batten is installed.

After the upper battens are inserted, attach the Canopy to the X-Gloo, making sure that the battens are facing downward.

Finally, make sure the cover for the Overpressure Valve is firmly closed and then inflate the front tube. While inflating, lift the front tube to allow air to enter the full length of the tube.

⚠ PLEASE NOTE: The Overpressure Valve opens automatically as soon as maximal pressure is achieved.

The Canopy Banner (4) can now be attached (if using) using the zippers at the upper part of the Front Tube (5x5 and 6x6 models only).

ROOF BANNER

The Roof Banner (5) also increases the covered area of the tent, and it serves as a prominent branding surface. To attach the Roof Banner simply connect it to the tent Matrix using the zippers.

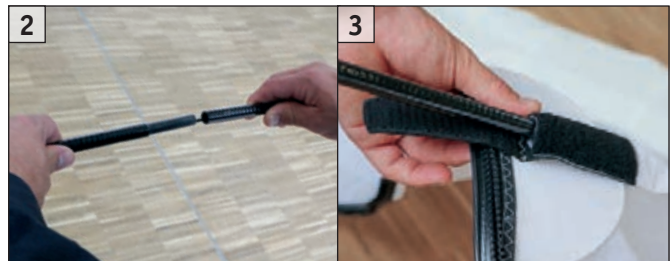

LED LIGHTING KIT

Hanging the LED Lighting Kit in your X-Gloo

Step 1: It is easiest to install the LED Lighting Kit during the setup of your X-Gloo, just after inflating three of the four tubes. Take the long end of webbing connected to the LED light and loop it above the Tube intersection **(6)**. Connect it to the buckle on the other side of the light. Tighten the strap so the LED light is held snugly against the Tubes.

Step 2: Next, extend the four toggles on the LED lighting mount and connect them to the loops on the inside of the X-Gloo Tubes **(7)**.

Step 3: Tuck the cable underneath the roof so that it follows one Tube all the way to the ground **(8)**. The fourth Tube can now be inflated.

Step 4: The transformer and dimmer controller can be safely stored on the ground.

Remove the LED Lighting Kit from your X-Gloo using the steps above in reverse order. Ensure that the LED light does not hit the ground when deflating your X-Gloo!

For more information, watch our how-to video at:
www.x-gloo.com/en/experience/videos/



ELEMENTS

The X-Gloo Matrix can be easily disassembled into individual parts (Roof and Tubes). Thanks to this feature, the individual parts can be removed for repaired or replacement. Re-attaching the new or repaired part is just as easy.

REMOVING THE ROOF

- Step 1:** Beneath the Roof at each Tube end, you will find two velcro straps fixing the tent Roof to the Tube. Open both straps and disconnect them from the plastic buckles **(1)**.
- Step 2:** Remove the plastic toggle button from the loop which is located at the end of the zipper connecting the Roof to the Tube end **(2)**, and then unzip the Roof from the Tube **(3)**. Repeat Steps 1 and 2 on the remaining three Tubes. The Roof can now be removed **(4)**.

SEPERATING THE TUBES

- Step 1:** Remove the Roof as described above.
- Step 2:** Use an 8mm Allen key (included in the Repair Kit) to unscrew the bolt in the aluminum Tube Connector and then remove the bolt and cap **(5)**. The Tubes can then be easily removed by sliding them out of the channels in the Tube Connector **(6)**.

For more information, watch our how-to video at:
www.x-gloo.com/en/experience/videos/



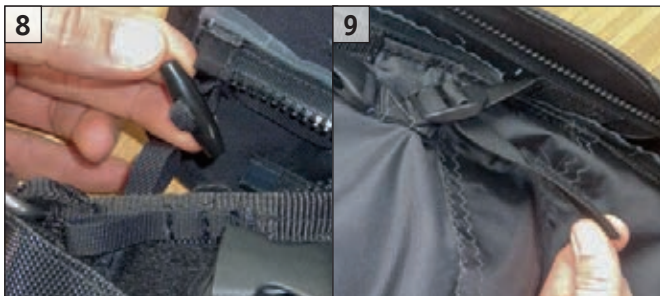

ASSEMBLY

To reassemble the X-Gloo Matrix, simply reverse the disassembly process. Starting near the Tube Connector, attach each zipper on the roof to one of the four tubes (7). Next, connect each toggle button on the roof to the corresponding loop on the tube ends (8), and then reconnect the velcro straps on the roof by first threading them through the buckles on the tube ends (9).



For more information, watch our how-to video at:
www.x-gloo.com/en/experience/videos/



TAKEDOWN / CLEANING

TAKEDOWN

Make sure that all of the Tent Pegs are removed and all Anchoring Lines are released before deflating the Tubes on your X-Gloo.

Step 1: Remove all elements (e.g. Side Walls, Canopy, etc) which are attached to the X-Gloo.

Step 2: Next, open the Overpressure Valve on each Tube (1). The air will completely escape within minutes.

Step 3: Then turn the X-Gloo inside-out so that the tube intersection loop is facing outwards (2).

Step 4: Lay the Tubes on top of one another with the Valves facing upwards. The Roof should be drawn outwards in large folds (3).

Step 5: After the last of the air has escaped, roll up the X-Gloo from the Roof to the Tube endings (4).

Step 6: Now the X-Gloo can be packed in the X-GL00 Multifunction Transport Bag or Trolley. Side Walls can be stored separately in the protective Side Wall Bag included in delivery.

For more information, watch our how-to video at:

www.x-gloo.com/en/experience/videos/



CLEANING

Dirt and stains should be removed *without* the use of soap or water whenever possible. We recommend using a soft, dry brush or microfiber cloth. If the stain cannot be brushed away, then use a small amount of conventional soap mixed with lots of water.

⚠ Important information for digitally-printed parts!
Digitally-printed elements should NEVER be cleaned with soap and water. Wetting these elements to clean them could result in the printing becoming permanently damaged. In these cases, X-GL00 will not accept liability.

⚠ CAUTION: *Never use solvents, detergent, steam cleaning or gasoline! This destroys the cloth.*

The X-Gloo should be inspected visually and for functionality at least once a year by an expert. This inspection includes inflating the X-Gloo Tubes in order to check all pressure-bearing parts for tears, punctures, debonding, heat- or chemical damage.

⚠ All functions, maintenance, and eventual repairs should only be carried out to the degree described in these operating instructions. Please contact your X-GL00 Team for repairs exceeding these instructions!

REPAIR

⚠ All functions, maintenance, and eventual repairs should only be carried out to the degree described in these operating instructions. Please contact your X-GLOO Team for repairs exceeding these instructions!

BLADDER REPAIR

Our **Adhesive Repair Patch** (70 x 50 mm) resists perforation, is stretch-durable, and has been developed especially for repair of tears and holes in the Bladder.

- High adhesion guarantees impermeability
- Resistant to UV exposure
- Easy to trim
- Resistant to moisture, sand, salt, wind and high temperatures

Step 1: Clean the dirt or oil from the area to be repaired using the Cleaning Cloth included (5).

Step 2: Trim the Adhesive Repair Patch to the desired size and carefully remove the protective layer. Try to avoid touching the sticky surface (6).

Step 3: Press the Repair Patch onto the repair area and make sure that there is sufficient overlap of the repair area. An overlap of at least 50 mm is recommended for larger tears or holes.

⚠ **PLEASE NOTE:** Press the Repair Patch uniformly and forcefully (more pressure means that the tape will adhere more quickly).

Step 4: Allow the area to dry for several minutes (7) – done.

REPLACEMENT OF THE PROTECTION STRIP

Protection Strips are fitted with velcro to all four Tube endings of the X-Gloo, (8) as well as to the Tube endings of the optional Canopy. To replace, simply remove and attach the new one (9).



Adhesive Repair Patch

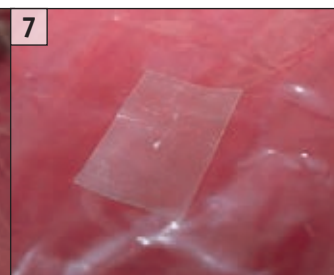
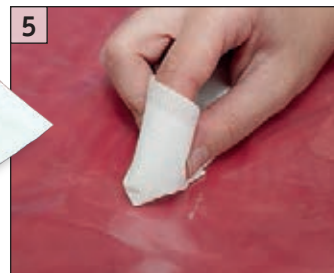

REPAIR

⚠ All functions, maintenance, and eventual repairs should only be carried out to the degree described in these operating instructions. Please contact your X-GLOO Team for repairs exceeding these instructions!

BLADDER REPLACEMENT

- Step 1:** Lay out the tent neatly so that the damaged Tube is on top and the service zipper is facing upwards.
- Step 2:** Open the two velcro straps on the Tube end (**Img. 1**).
- Step 3:** Open the service zipper on the Tube end (**Img. 2**).
- Step 4:** Pull the Bladder Sack out of the Tube (**Img. 3**).
- Step 5:** Open the 3 velcro straps which keep the Bladder Sack folded in half and pull them out of the plastic buckles (**Img. 4**).

- Step 6:** Unfold the Bladder Sack by pulling open a final velcro strip (**Img. 5**).
- Step 7:** Pull the loose ends of the three velcro straps out of the holes in the Bladder and Bladder Sack (**Img. 6**).
- Step 8:** Open the Bladder Sack at the opposite Tube end using the same method as described in Steps 2-6.
- Step 9:** Push/pull both valves (**Img. 7**) and all of the small black fixing elements to the inside of the Tube (**Img. 8**) (Both valves are secured inside the Tube with velcro).





Step 10: Pull the Bladder out of the Tube (Img. 9).

Step 11: Lay the replacement Bladder parallel to the Tube (valves should align with the corresponding holes in the Tube) (Img. 10).

Step 12: Gather the replacement Bladder in loose folds positioned above the opening in the upper Bladder Sack (Img. 11).

Step 13: Now, starting from the Bladder Sack at the opposite end, thread the Tube completely onto your arm. Grasp the end of the replacement Bladder through the upper Tube opening (Img. 12).

Step 14: Pull the replacement Bladder carefully into the Tube (Img. 13).

⚠ CAUTION: Make sure that the replacement Bladder does not get twisted when pulling it in. Try to enlist the help of a second person to help with the procedure.

Step 15: Feed the replacement Bladder completely through both Tube ends, making sure that the Bladder extends beyond the opening in each Bladder Sack (Img. 14).

Step 16: Push both valves through the corresponding holes in the Tube and press firmly to secure the velcro. Make sure that no Tube material gets caught or pinched in the velcro (Img. 15).

Step 17: Using the Fixing Element Tool included with in your repair kit (or a loop of thin rope or cord), pull each of the fixing elements through the corresponding holes in the Tube (Img. 16).

For more information, watch our how-to video at:
www.x-gloo.com/en/experience/videos/



REPAIR

⚠ All functions, maintenance, and eventual repairs should only be carried out to the degree described in these operating instructions. Please contact your X-GLOO Team for repairs exceeding these instructions!

Step 18: To close the Tube ends, fold over the corners of the exposed Bladder so the outer-most elongated holes in the Bladder line up on top of those just beside them. The result should look like a row of three visible holes instead of five (**Img. 17**).

Step 19: Thread the 3 long velcro straps through the corresponding holes in the Bladder and Bladder Sack (**Img. 18 & 19**).

Step 20: Fold the Bladder Sack in half, pressing it firmly to close the long velcro strap in the middle (**Img. 20 & 21**).

Step 21: Loop the three velcro straps through the corresponding plastic buckles on the Bladder Sack, and then press each one firmly to close it (**Img. 22 & 23**).

Step 22: Push the Bladder Sack back into the Tube, and then thread the two velcro straps for connecting the Bladder Sack to the Tube end out through the provided holes. Close them by pressing firmly (**Img. 24 & 25**).

Step 23: Make sure the entire Bladder Sack is back inside the Tube and close the service zipper (**Img. 26**).

Step 24: Close the Bladder Sack on the remaining Tube end using the same method.

For more information, watch our how-to video at:
www.x-gloo.com/en/experience/videos/



X-RELAX



INFLATION

The core of the X-Relax is a cylindrical Bladder, similar to the Bladder construction of the X-Gloo event tent. To inflate:

Step 1: Remove the X-Relax from the included bag.

Step 2: Locate and open the valve cover **(1)** to expose the valve **(2)**.

Step 3: Inflate using a Hand Pump – done.

EXCHANGEABLE OUTER SHELL

The X-Relax design enables an inexpensive replacement of the outer shell, and therefore the option to change the design of the X-Relax while retaining the existing Bladder.

Height.....ca. 60 cm
Diameterca. 42 cm
Weight..... 2.5 kg

Setup with Hand Pump..... 1 min
Operating pressure .. 0.2 bar/3 PSI

