

Wireless Charger User Manual

User Manual

Thanks for choosing us!
This is a smart phone wireless charger that allows you enjoy the fun of digital products easily.

Please kindly read the user manual before using and keep it for future reference.

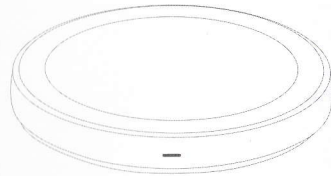

Specification:

Input : DC5V,1500mA	Charging distance : 4~10mm
Frequency : 100-200KHz	Conversion : $\geq 72\%$
Diameter: 69mm	Thickness: 9mm
NW.: 50g	

Connect to Power Adapter

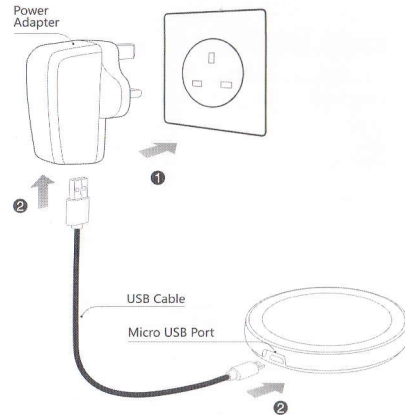

- ① Connect the power adapter to socket.
- ② Connect adapter to the USB 2.0 interface, the other Micro USB to pad.
- ③ Standby LED light turn on green.

Note: Charging pad controled by smart chips, long-term standby can be assured.

Connect to Laptop for Charging

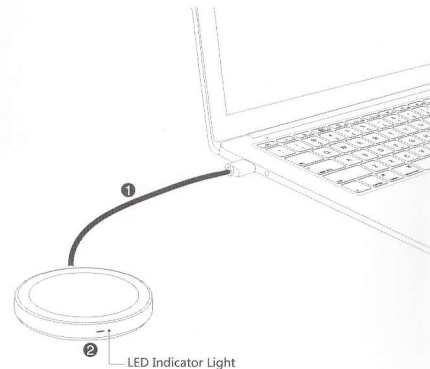

- ① Connect the USB 2.0 interface into laptop USB port, the other Micro USB to pad.
- ② Standby LED light turn on green.

Connect to Desktop for Charging

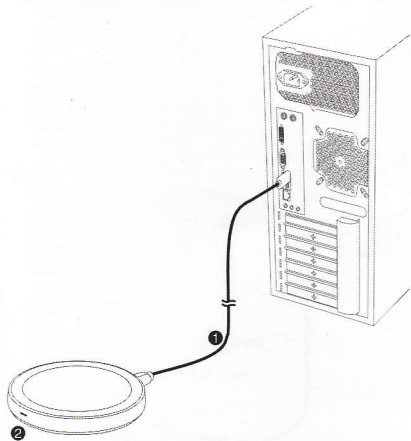

① Connect the USB 2.0 interface into desktop motherboard USB port, the other Micro USB to pad.

② Standby LED light turn on green.

Charging mode

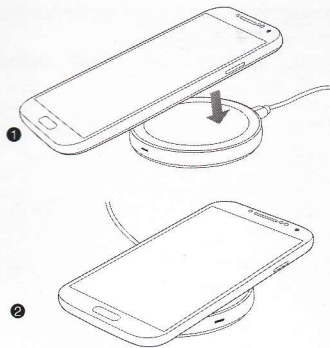

① Make sure the charging pad indicator light turn on green, under standby status.

② Put wireless charging mobile phone on the pad, it will start charging after a sound "dii". The charging pad will sound continuous tone with blue and green LED light flashing when placed on the incorrect position. Please move your phone a little until the tune stop and LED light turn to blue. It shows that the phone is already found the right charging position and start charging.

Notes:

- 1、 Do not squeeze or collisions.
- 2、 Do not disassemble or throw into fire or water, to avoid causing a short circuit leakage.
- 3、 Do not use wireless charger in severely hot, humid or corrosive environments, to avoid circuit damage and occurs leakage phenomenon.
- 4、 Do not place too close with magnetic stripe or chip card (ID card, bank cards, etc.) to avoid magnetic failure.
- 5、 Please keep the distance at least 20cm between implantable medical devices (pacemakers, implantable cochlear, etc.) and the wireless charger, to avoid potential interference with the medical device.
- 6、 To take care of the children, to ensure that they won't play the wireless charger as a toy, to avoid unnecessary accidents.

The involved images are sketch maps, the final product as per the material subjects.

Includes: T-200 wireless charger, 30cm power cable, 150cm power cable, user's manual, warranty card.
* No power adapter, if you need, please purchase separately.