



# JUICEPRO

COLD PRESS JUICER

INSTALLATION & OPERATING  
INSTRUCTIONS

ALI-VJP-S3 / ALI-VJP-P3  
[WWW.PROAPPLIANCES.COM.AU](http://WWW.PROAPPLIANCES.COM.AU)



## **Congratulations on your purchase of a JuicePro Cold Press Juicer**

---

**Note: Please read through the instructions carefully before using or installing the product and ensure that the manual is kept in a safe place for future reference.**

**The system must be properly installed and located in accordance with the installation instructions before it is used.**

---

### **CUSTOMER CARE: 1300 764 325**

Alibaba Imports Pty Ltd  
c/- Perks & Associates  
180 Greenhill Road  
Parkside SA 5063 Australia  
Phone: (08) 8354 0711  
[www.proappliances.com.au](http://www.proappliances.com.au)

 /proappliances  
 @proappliancesau



Electrical Requirements:  
Australia / New Zealand 240V / 230V 50Hz  
Due to manufacturing alterations product may  
vary slightly from that is pictured.

## OPERATION CONDITIONS & SAFETY PRECAUTIONS

- All components need to be installed in accordance with the user manual instructions for correct performance of unit.
- This appliance is not intended for use by persons (including children) with reduced physical, sensory or mental capabilities, or lack of experience and knowledge, unless they have been given supervision or instruction concerning use of the appliance by a person responsible for their safety.
- Children should be supervised to ensure that they do not play with the appliance.
- Do not operate any appliance with a damaged cord or plug or after the appliance malfunctions.
- If the supply cord is damaged, it must be replaced by the manufacturer, its service agent or similarly qualified persons in order to avoid a hazard.
- To protect against risk of electrical shock, do not put the main body (motor) in water or any other liquid.
- Unplug from outlet when not in use, before assembling or taking off parts and before cleaning.
- Avoid contact of moving parts.
- Do not use attachments not recommended or sold by the manufacturer as it may lead to fire, electric shock or injury.
- Always ensure you switch the juicer to the off position and the motor has stopped completely before disassembling.
- Do not put your fingers or foreign objects into the juicer while it is in operation. If food becomes lodged in the inlet use the plunger to push it down, or use the reverse button on the machine to dislodge. If this is not possible turn juicer off and wait for motor to completely stop before disassembling juicer to remove food.
- Do not use outdoors.
- Do not use appliance for other than intended purpose.
- Lift appliance from the base only.
- Do not put any parts into the dishwasher, NOT dishwasher safe.
- Do not use appliance continuously for more than 15 minutes as overheating will automatically shut down the unit. This unit is for household use only and warranty is not extended to units used for commercial purposes.
- Do not use the appliance to juice hard materials, including pips, ice, frozen fruit, large seeds.

## INSTALLATION & OPERATING INSTRUCTIONS

### A. Component identification & content check list:

#### ALI-VJP-S3 / ALI-VJP-P3 - JuicePro Cold Press Juicer

Ref	Description	Qty
Main	Components	
A	Hopper	1
B	Squeezing Screw	1
C	Strainer	1
D	Spinning Brush	1
E	Bowl	1
F	Base	1
G	Cleaning Brush	1
H	Pusher	1
I	Container	2

**Note:** Do not pre-operate before inputting materials or do not operate with an empty bowl.

**Important:** The Base, Bowl and Hopper must be correctly aligned for the machine to operate correctly. (See Fig 1).



## B. Assembly Instructions:

**Important:** Prior to Assembling the Juicer please check this point: At the base of the bowl there is a rubber stopper. When in place the stopper ensures all of the juice only exits via the juice outlet. Before juicing always ensure that the rubber stopper is firmly in place. (See Fig 2).

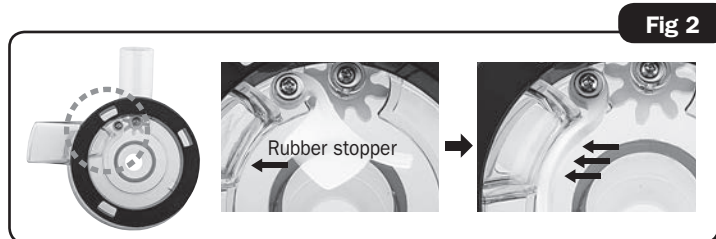

1. Assemble the bowl on the base (See Fig 3).

A. Make sure the bowl is sitting securely on the base.



2. Insert the strainer into the spinning brush.

A. Align the dot on the strainer with the dot on the bowl and insert strainer + spinning brush into the bowl. When the dots are correctly aligned the strainer + spinning brush will lock in place. (See Fig 4).

3. Insert the squeezing screw into the strainer and turn until it drops into position. (See Fig 5).



4. Assemble the hopper onto the bowl. (See Fig 6).

A. Align the small arrow on the hopper with the dot on the bowl.

B. Twist the hopper clockwise so that the plastic tab on the hopper is in line with the on/off switch. (See Fig 7).

**Note:** The small arrow from part 4.A will no longer be aligned with the dot once the hopper is locked to the close position. (See Fig 7).

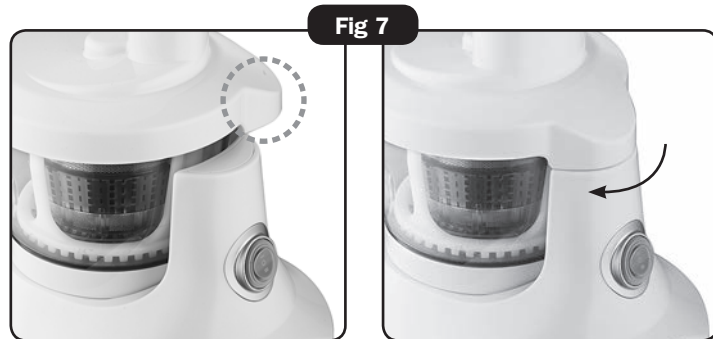

## C. Operating Instructions:

### Warning:

- Do not operate the juicer with wet hands as it may cause an electric shock.
- Do not operate the juicer prior to inputting juicing materials.
- Do not operate for more than 15 minutes at one time.

### Important:

To protect the motor and provide you with a long lasting machine the Juice Pro has an auto shut down feature. If the components are not aligned or installed correctly, the motor overheats due to extended juicing or the strainer becomes clogged the machine will automatically shut down. This is normal and prevents damage to your Juice Pro.

If this happens switch the machine off. Check components are correctly installed and that there is no food caught in the strainer. Wait 5 minutes for the motor to cool then recommence normal operation.

1. Plug in the juicer.
2. Place a container below the juice outlet and a container below the pulp outlet.
3. The juicer power button has 3 positions.
  - A. ON - This starts the motor and juicing process.
  - B. OFF - Is the central position of the button. It switches off the appliance.
  - C. REV - Is reverse. Only use this function when something is stuck in the juicer and it needs to be unclogged.

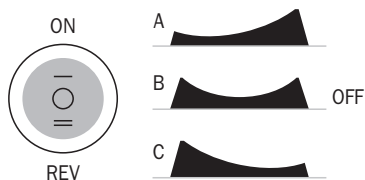

4. Prepare the material you wish to juice. The Juice Pro is designed to juice many different materials. The preparation for each material will differ, the below points are a guide. Please read page 8 and 9. Getting started with your Juice Pro for further tips on Juicing.
  - Ensure juice material is cut into small portions for optimal juice extraction. Each portion should easily fall down the hopper chute without the need for force.

- Remove any large pips or seeds. This includes stones from stone fruits and peel from citrus fruits.
  - Always pre-wash food before juicing.
5. Switch the power button to 'ON'. Insert the food into the hopper.
    - Insert food slowly one piece at a time and allow juicer time to work.
    - Do not overstuff the hopper or force food in. The pusher is only to be used if food becomes stuck. (See Fig 8).
  6. When you are finished switch the power button to 'OFF'.

**Note:** If you are making multiple juices in one session to avoid cross over of flavours, pour water into the hopper between drinks to clean the unit. Capture rinsing water in a separate bowl so as not to dilute your juice. Depending on the material being juiced you may need to clear some pulp from the strainer.



## D. If the machine becomes clogged and inoperable:

1. Turn the machine off and press the reverse button for a few seconds then try operating again. Note: The reverse button works with a 'pulse' motion.
2. If the reverse button does not work turn off the machine and switch off at the power point. Disassemble the unit to dislodge any material then reassemble as per the instructions and try again.

## E. How to disassemble and clean the unit:

1. Switch off the unit.
2. Twist the hopper anti clockwise then lift off.  
(See Fig 9). Lift the bowl straight up to remove from the base.

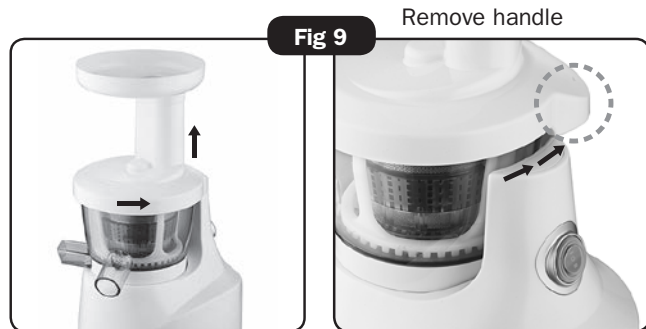

Fig 9

Remove handle

3. Disassemble the parts from the bowl in the order show by the diagram. (See Fig 10).

4. Use the brush to clean all of these parts thoroughly in warm soapy water then dry thoroughly. Ensure the pulp outlet on the bowl is clear (the end of the cleaning brush is designed to clear trapped material from the pulp outlet). Unplug the rubber stopper for easier access to the pulp outlet.

**Caution:** Before juicing ensure the rubber stopper is firmly in place. (See Fig 2, Page 3).

5. Use a damp cloth to wipe down the base of the unit.

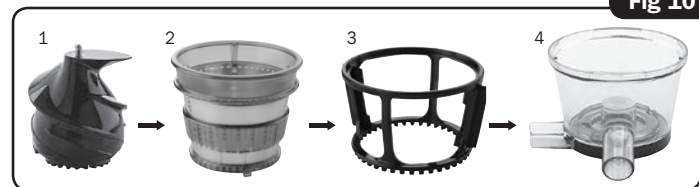

Fig 10

## Cleaning Tips:

- Periodically remove the silicone brushes from the spinning brush and clean thoroughly before reassembling.
- Thoroughly clean immediately after each use to minimize staining.
- Pull out the rubber stopper on the base of the bowl to clean bowl effectively. Always ensure the rubber stopper is re-inserted prior to juicing otherwise it may cause a leak.
- Do not use harsh abrasives or chemicals to clean the juicer.
- Do not clean in the dishwasher.



## TROUBLE SHOOTING

**BEFORE YOU CALL FOR SERVICE PLEASE REVIEW THE TROUBLE SHOOTING TIPS FIRST.**

Problem	Possible Causes	What To Do
No power to juicer.	Juicer not plugged in.	Check the juicer is plugged in.
	Incorrect assembly.	Reassemble the juicer according to the instructions.
Motor has stopped.	Bowl has been overfilled with material.	Press the reverse power button to try and clear the clog. May need to be try this a few times.
	Overuse has caused the motor to shut down as a precaution to overheating.	Switch off and let the motor cool before using again.
Leaking from beneath the bowl.	Rubber plug on base of bowl not correctly inserted.	Rubber plug on base of bowl not correctly inserted.
	A small amount of residual juice is normal.	It is normal to find a small amount of juice, clean from the appliance with damp cloth.
Stain on the bowl, strainer, spinning brush.	Natural colour from juicing materials.	This is perfectly normal. To reduce discolouration ensure you rinse and clean the appliance immediately after use.
Squeaking noise during operation.	Juicing noise from squeezing screw.	This is perfectly normal. Ensure you do not overload the juicer.
Damage to the strainer.	Frozen foods, ice, pips, seeds, unknown substance or too much material in the bowl.	Ensure you read the instructions carefully on the correct use of the juicer. Do not overfill the juicer.

**Spare parts available, call 1300 764 325**

## Getting started with your Juice Pro

Juicing is a fun and easy way to enjoy fruit and vegetables.

The different taste combinations are endless and only limited by your imagination!

The Juice Pro Cold Press Juicer is not a conventional juicer and therefore cannot be used in the same way. Take the time to get to know the mechanics of your juicer and how it works best, to do this we suggest you start with easy to juice items and work up to experimenting with different flavour combinations.

### Material Size and Juicing Speed

The size of the material and the speed at which you feed it into your juicer is very important in achieving good results. To familiarise yourself with the process we recommend you start with easy to juice materials such as citrus fruits. (Remember to always remove the peel first!).

Cut the material into small portions that will easily fall down the hopper chute without being forced. The harder the fruit or vegetable type the smaller the portion should be, for example carrot and beetroot should be cut into 2cm segments.

Feed the material into the hopper, generally a segment at a time. Allow the juicer time to work and process the material before adding more. Gradually increase the feeding rate, through trial and error you will soon familiarise yourself with the right material size and feeding speed.

You will find that harder materials like beetroot may need longer to process than softer materials like citrus fruit.

### Time to Experiment

Once you are confident in using your juicer get creative and experiment, who knows you may just invent a new flavour! Here are a few ideas to get you started:

- You can try all sorts of fruit / vegetable combinations - don't forget to try adding beetroot, cucumber, broccoli, berries or tomatoes to name a few.
- Juice leafy greens such as spinach or wheat grass. (See page 9 for juicing for leafy greens.)
- Try adding fennel for an aniseed flavour.
- To get a nice kick add a small amount of Ginger or Garlic.
- Make an almond or soy milk. (See page 9 for Soy & Nut milks.)

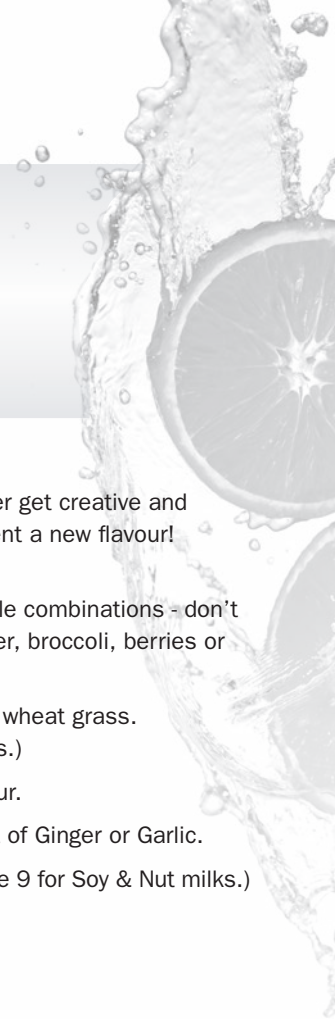

### Quick Tips

- Refrigerate produce before juicing to maximise taste and juice yield.
- Banana's won't juice! Just make your juice minus the banana then pop juice and banana in a blender to make a tasty smoothy.
- Clean the juicer immediately after juicing to minimise staining.
- If you are making multiple juices in one session avoid flavour cross over by pouring water into the hopper between juices to rinse the unit. Ensure that rinsing water is captured in a separate bowl so as not to dilute your juice.

### Juicing Leafy Greens

Leaves are more difficult to juice and may take some practice to get used to. The best way to feed them into the hopper is to roll them into small tight parcels before feeding into the hopper. Wet leaves will not process as well as dry leaves so after you have washed them pat dry with paper towel.

For the best results we suggest you juice leaves with other fruits or vegetables and alternate between feeding leaves and the other material into the hopper. It's best not to finish the juicing with leaves as some may remain in the machine.

### Making Soy and Nut Milks

Soy beans need to be boiled before being juiced. Slowly feed equal parts of soy beans and water (you can utilise the water used to boil the soy beans if you wish) into the hopper. The soy milk can be run through the Juice Pro a second time to further refine it.

To make nut milk only use raw nuts that have been soaked in water overnight and rinsed thoroughly. Simultaneously feed nuts with some water into the hopper, the nut to water ratio will determine how creamy the milk is. Try juicing raw almonds, walnuts, brazil nuts alone or in combination.



**Alibaba Imports Pty Ltd offers a 12 month repair or Replacement Warranty on this product with a 24 month Repair or Replacement Warranty on the Motor only.**

Alibaba Imports warrants this appliance to the first purchaser and subject to the stated conditions:

Warranty covers any defects in material or workmanship in the manufactured product within the first twelve months from the date of purchase. Warranty on the motor only covers any defects in materials or workmanship of the motor within the first twenty four months from date of purchase.

To make a warranty claim you must call Alibaba Imports on Toll Free number 1300 764 325 for instructions.

Product will be repaired or replaced at our discretion. Repair or replacement costs of the product will be covered under warranty by Alibaba Imports.

Goods presented for repair may be replaced by refurbished goods of the same type rather than being repaired. Refurbished parts may be used to repair the goods.

Our goods come with guarantees that cannot be excluded under the Australian Consumer Law. You are entitled to a replacement or refund for a major failure and compensation for any other reasonably foreseeable loss or damage. You are also entitled to have the goods repaired or replaced if goods fail to be acceptable quality and the failure does not amount to a major failure.

**Conditions Of This Warranty:**

1. This product has been fully installed in accordance with the user manual installation instructions.
2. The warranty extends only to repairing or replacing any component that proves to be defective in material or workmanship.
3. The warranty does not cover defects occasioned by misuse, alterations, accidents, or used for other than the intended purpose.
4. The warranty does not cover damage to the product caused by accident, fire, or floods.
5. Proof of purchase is required for warranty claims.
6. This unit is for household use only and warranty is not extended to units used for commercial purposes.

**Please keep purchase receipt in a safe place.**

Alibaba Imports Pty Ltd  
c/- Perks & Associates  
180 Greenhill Road Parkside,  
South Australia 5063

Phone: (08) 8354 0711  
Customer Care 1300 764 325

This image shows a single sheet of white paper with horizontal ruling lines. The lines are evenly spaced and run across the width of the page. There are no margins, text, or other markings on the paper.



This image shows a single sheet of white paper with horizontal ruling lines. The lines are evenly spaced and run across the width of the page. There are no margins, text, or other markings on the paper.



**For Customer Care  
visit [www.proappliances.com.au](http://www.proappliances.com.au)**

1300 764 325

Alibaba Imports Pty Ltd  
c/- Perks & Associates  
180 Greenhill Road Parkside  
SA 5063 Australia