

修订					
版本	标记	处数	内容	日期	变更者
V0			N/A		

• Function Specifications

Sign	Function
	ON/OFF: turn on or off the light.
	Color Temperature Shortcut Key: obtain the warm white or cold white quickly.
	Color Temperature Adjusting Key: obtain the color temperature between the warm white and cold white.
	Brightness+/-: increase or reduce the brightness under certain color temperature.

Attentions

- The input voltage of this controller should follow the working voltage of specification.
- Please connect the wires of the controller and LED fittings as the connecting diagram.
- The standard warranty is two years in our company. We won't be responsible for any damages of the controller due to any wrong operations.

Malfunction&Solutions Table

Malfunction & Solutions Table		
Malfunctions	Possible Causes	Solutions
Strips do not light	1. There is no primary power.	Remove any short or open circuits and other malfunctions, and energize the fixture.
	2. The power supply is auto protected since the short or open circuit occurs at the output of the power supply.	
	3. The input wires of the strips are connected reversely.	
Some LED strips don't light	1. Some power supplies don't get primary power.	Check the power supply and remove malfunctions.
	2. Some strips are wrongly connected to the power supply.	
	3.Individual strips' polarities are connected reversely.	Connect the wires correctly.
Brightness of the LEDs is dim or not even	1. Power Supply is overloaded.	Change a power supply with high power according to the actual load.
	2.The wire loss of power supply is too much.	Ensure the working voltage of strips is ±5% of the rated voltage, or shorten the power supply wire or use thicker wires.
	3. Too many LED strips are connected.	Adjust the strip length of each branch to meet the maximum operable length.
LEDs are blinking	1.Bad connections exist.	Find the bad connections and remove any malfunctions.
	2. Power supply doesn't work.	Replace the power supply.
Remote controller can't control the LED strips	1.The remote control fails.	Check the battery of the remote control.

NOTE

1. Installation notes:
- 1)Make sure that the mounting surface is clean before installing strips.
 - 2)The polarities of connection made at LED strips and power supply should be correct, or the strips will not light.
 - 3)Connect wires to the power supply firmly, It will be fine if the wires can not be pulled out by hand.
- 2.Notes for Optional Supplies:
- 1)Forbid using any acid and alkali adhesive to fix the strips.
 - 2)During installing the strips, forbid sticking adhesive on LED surfaces to avoid damaging the LEDs.
 - 3)Standard operable length is 20m(787.4in). It is recommended to choose safety-certified power supply with DC24V output voltage(with short-circuit, overvoltage and overcurrent protections). The tolerance range for the output voltage of power supply is ±5%. If more products needed, the power supply should have more than 20% load allowance.

⚠ WARNING

- This product is non-waterproof, forbid being exposed to outdoor or semi-outdoor environment directly.
- Forbid disassembling or modifying the strips or touching LED surface with sharp stuff.
- Don't install the products with power on.
- When the neutral glass glue is used to fix the products, the light box or channel letter should not be sealed until the glass glue gets solidified in open environment.
- The products should be installed or maintained ONLY by the professional persons.
- Please check the supply voltage and wire connections before energizing the fixture.
- Standard operable length is 20m(787.4in). Forbid exceeding!
- If the extension of the wires between strips and power supply is needed, it is recommended to choose 16AWG or much thicker wire to avoid the hazard caused by overcurrent or overheat.
- When the standard operable length is 20m(787.4in), the wires between the strip and power supply should be no longer than 2m(78.74in), or the wire loss will increase, which will lead to higher total power.

Declaration

- Warranty: 3 years or 13,000 hours, whichever comes first.
- If the external flexible cord of this luminaire is damaged, it shall be exclusively replaced by the manufacturer or his service agent or a similar qualified person in order to avoid a hazard.
- All the data and pictures in this manual are subject to actual products.
- Information provided is subject to change without notice.

Crylux Series Flexible LED Strip
Manual
R0BC0BD



Read this manual carefully before using this product and keep it!

V1.0

备注：
1. 尺寸：297*210mm；
2. 材质：80g书纸；
3. 公差：±1mm；
4. 灰度双面印刷；
5. 虚线不印刷，来料必须从虚线处折好。

说明书正面

		深圳市日上光电有限公司					
RISHANG 日上光电		SHENZHEN RISHANG OPTO-ELECTRONICS CO., LTD.				材质	
零件名称	晶辉系列20米可调色温灯带说明书(英文 无LOGO)	设计	方艳平	日期	2012.07.23	表面处理	
零件编码	308-01-081	审核		日期		重量	
图纸编号	RD-R0BC0BD-BZ002	标准化		日期		比例	N/A
页数	共 2 张 第 1 张	批准		日期		单位	

修订					
版本	标记	处数	内容	日期	变更者
V0			N/A		

Model and Specification

Series		Crylux Series		
Model		R0BC0BD		
Color Temperature(K)		3000	4500	6000
Power(W)	1m(39.37in)	5.1	10.2	5.1
	20m(787.4in)	102	204	102

IP Grade : IP33

Working Voltage (V DC) : 24

Operating Temperature (°C[°F]) : -20~60[-4~140]

Storage Temperature(°C[°F]) : -40~70[-40~158]

Applications : It is suitable for cove and contour lighting , general lighting in hotel, shopping mall, home etc.

- Note: Due to the specialty of the products, the general power of 20m long product may be different from the power which is based on "Power per meter "Length" calculation method, please choose it according to the actual application.

Profile Drawings

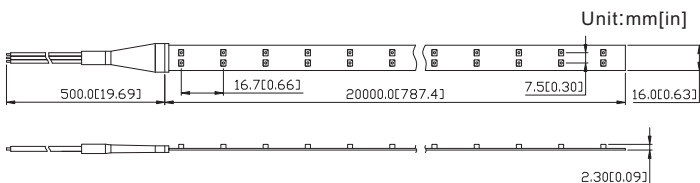

Installation and Use

1.Wire Connection:

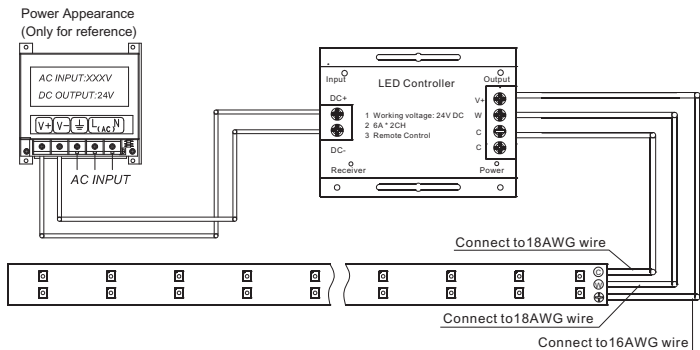

2. Product Components and Tools Required:

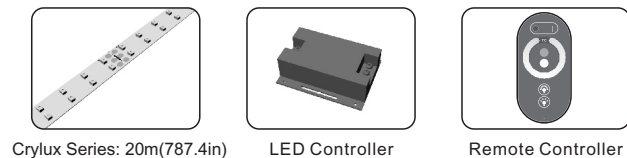

Crylux Series: 20m(787.4in)

LED Controller

Remote Controller



Fasteners(60pcs)



Self-tapping Screws (60pcs)

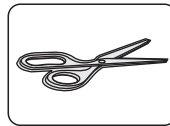

Tools Required: Scissors

3.Installation Procedures:

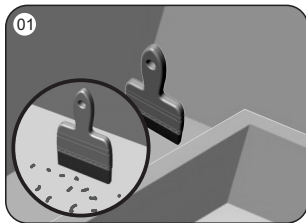

- Clean the mounting surface and keep it clean.

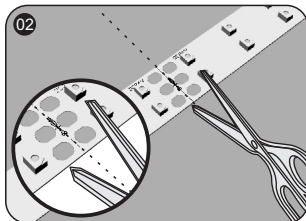

- Cut the strips to achieve the desired length.
- ⚠ Note: Please cut the strips at the printed marks!

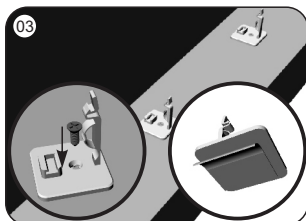

- Firstly, install the fasteners as straight line with double-adhesive tape or screws, and it shall install 3pcs fasteners per meter.

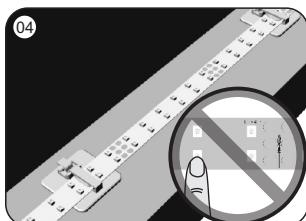

- Determine the mounting positions and stick the strips into the mounting surface.
- ⚠ Note: Do not press on the LEDs during installing !

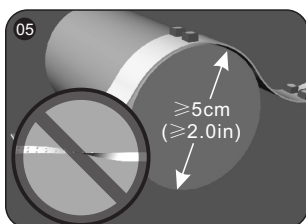

- When installing, the bending diameter of the strips should be no less than 5cm(2.0in).
- ⚠ Note: Do not twist the strips!

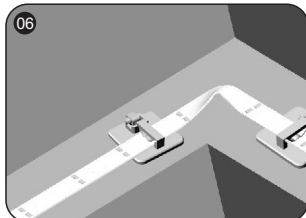

- When the strips need to make a turn, please install two fasteners to secure the strips.
- ⚠ Note: Do not bend the strips to right angle!

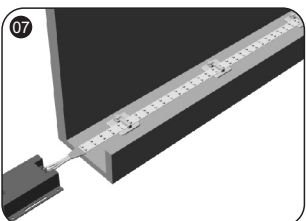

- After installing the strips, strip wires shall be connected to the the controller and insulated
- ⚠ Note: The wire connection made at strips and controller must follow the wire connection illustration!

Manual for Remote Controller

Technical parameters

- Controller
 - Operating Voltage: DC24V
 - Working Temperature: -20-60°C(-4~140°F)
 - Maximum output current: 6A /CH
 - Output: 2 channels
 - Maximum output power: 288W (24V)
 - Connecting mode: common anode
- Touch remote controller
 - Power supply: Three AAA batteries
 - Standby power consumption: 0.08mW
 - Work power consumption: 6mW
 - Transmission power consumption: 40mW
 - Remote control distance: ≥15m(≥590.55in)

Key Functions

- Touch-key Function Instructions

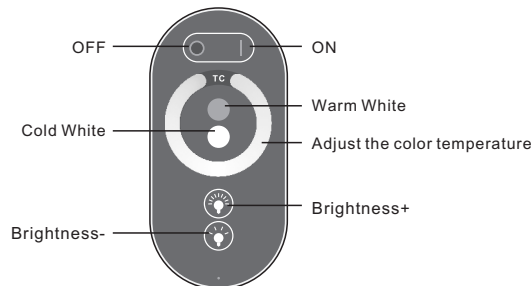

备注:
1.尺寸: 297*210mm;
2.材质: 80g书纸;
3.公差: ±1mm;
4.灰度双面印刷;
5.虚线不印刷, 来料必须从虚线处折好。

说明书背面

深圳市日上光电有限公司						材质	
SHENZHEN RISHANG OPTO-ELECTRONICS CO., LTD.							
零件名称	晶辉系列20米可调色温灯带说明书(英文 无LOGO)	设计	方艳平	日期	2012.07.23	表面处理	
零件编码	308-01-081	审核		日期		重量	
图纸编号	RD-R0BC0BD-BZ002	标准化		日期		比例	N/A
页数	共 2 张 第 2 张	批准		日期		单位	