



pure acoustics®

User Guide

MCP-70BT Portable Bluetooth Entertainment System



In order to achieve the best performance with your product please read this instruction manual carefully before using, and keep it in a safe place for future reference.

	<p>CAUTION</p> <p>RISK OF ELECTRIC SHOCK DO NOT OPEN or DISMANTLE</p>	
<p>Caution: To reduce the risk of electric shock do not open this device, there are no serviceable parts for customers. Please refer any maintenance or repair to qualified authorised repair personnel.</p>		
	<p>Warning Risk of Electric Shock: DO NOT open or dismantle speaker yourself. Doing so may cause damage to you, the speaker and other property and will void the warranty.</p>	

NOTE

This unit may be subject to changes in specifications, characteristics and/or operation without prior notice to the end-user, in order to continue improving and developing its technology.

CONTROL PANEL INSTRUCTION

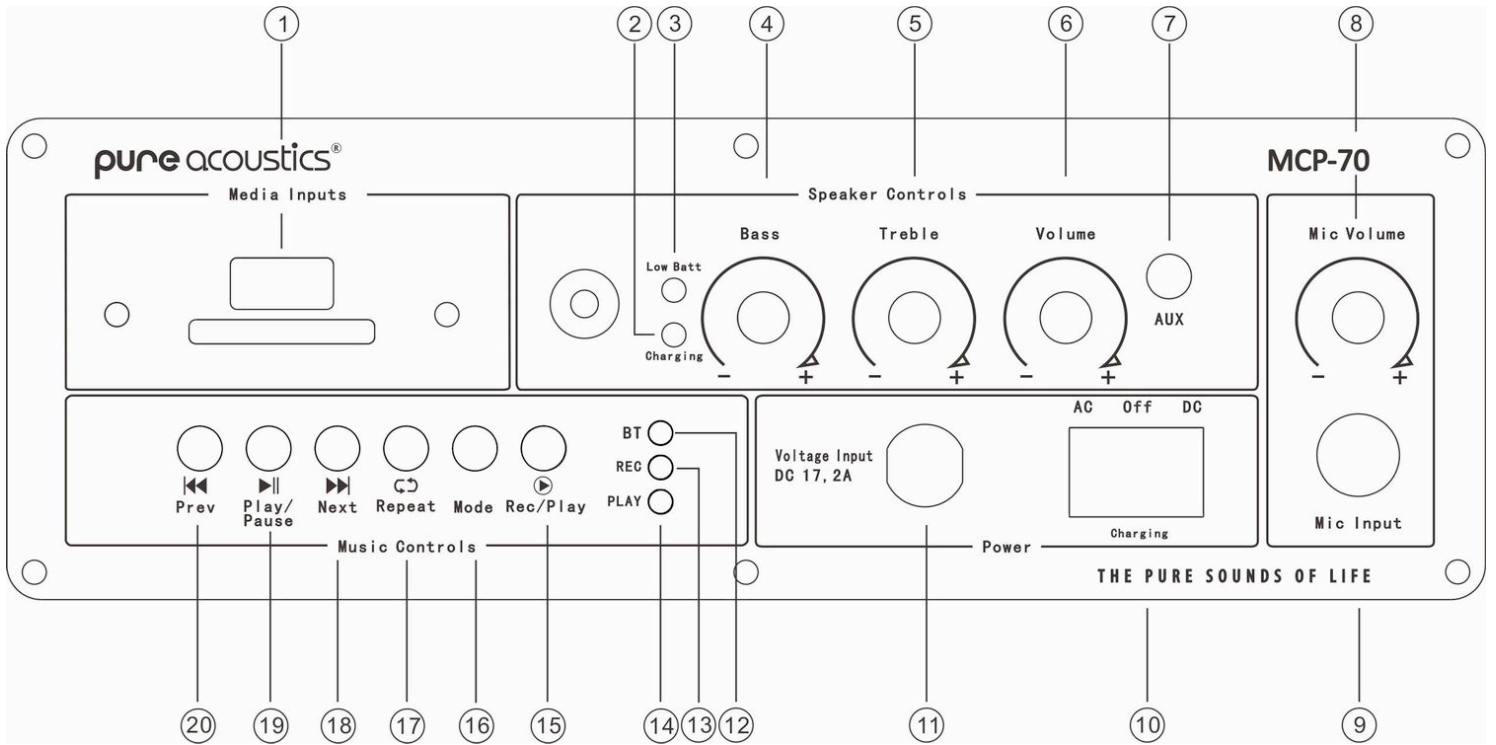

- 1: USB /SD Port
- 2: Battery charge indicator
- 3: Battery low indicator
- 4: Bass volume knob
- 5: Treble volume knob
- 6: Master volume knob
- 7: AUX input
- 8: MIC Volume
- 9: MIC input
- 10: Power mode and charging switch: AC/DC/Charging/Off
- 11: External adapter jack
- 12: Bluetooth working indication light
- 13: Indicator of recording
- 14: Indicator of play
- 15: Record /Play key
- 16: mode Knob: AUX/Bluetooth/ USB/SD
- 17: Repeat key
- 18: Next track
- 19: Play /Pause
- 20: Previous track

REMARK: Number 15: Pressing for 3 second is for recording, Pressing for 1 second to play the recording contents (when the USB/SD and the microphone is ready)

Operating Instructions:

1. **Connect with Sound Source:** To play music, connect the MCP-70 with sound source first, via a RCA audio cable, insert the terminal of the audio cable into AUX jacks, the other terminal connected with sound source device. While playing by U-disk or SD card, just insert U-disk into the USB slot or SD card into the SD slot. Press SELECT INPUT button, unit will switch between AUX and USB.
2. **PLAY:** While playing with AC 220V, place the POWER button in the AC position, make sure the power is connected properly; While playing with DC12V built-in, place the POWER switch in the DC position, and make sure AC power is disconnected. Adjust the volume knobs according to your preference.
3. **KARAOKE MODE:** Plug the MIC into the MIC input port first, move the switch on the MIC to the on position, the unit is ready to be used in karaoke mode. The best distance between the device and the wireless microphone is 10 meters. To avoid feedback keep the microphone at least 3 meters away from the device.
4. **CHARGE:** To charge you're MCP-70, connect the supplied power cable into the unit and outlet then place the power button in the OFF position.
5. **RECORDING:** When you wish to record an audio or voice application, be sure to insert the USB or SD card properly. Next, connect your sound source into the MIC input port or AUX port and then press & hold the REC/Play button for 3 seconds. The REC indicator light illuminates red indicating the MCP-70 is recording. Press the REC/Play button for 1 second to play back the recorded content.

GUIDELINES FOR BUILT-IN BATTERY

1. Before using your MCP-70 the first time, please charge the device for at least 4-6 hours.
2. If battery power level is low during music play, Low battery indicator light will illuminate, indicating that the unit should be charged immediately. While unit is being charged, green indicator light will blink, once the indicator light stays on, charging is complete and device may be used in battery mode.
3. When battery level is low it is recommended that you charge the device within 24 hours, doing so will prolong the life of the built-in rechargeable battery and prevent the device from requiring a longer charge period before the next use.
4. Any tampering, changes, adjustments or unauthorized repairs will void the warranty of the speaker. All necessary repairs must be made by a trained & authorized person only. If not a well-trained person, it is forbidden to dismount the device; doing so may cause electric-shock injury or death as well as property damage.

GUIDELINES FOR WIRELESS MICROPHONE

1. Before using the wireless microphone, please be sure included battery are installed. Confirm the batteries have sufficient power prior to each use. Using the wireless MIC's without sufficient power will lead to a shorter receiving distance, unwanted feedback and/or distortion, If any of the for mentioned issues occur please replace the batteries in the microphones.
2. Although the wireless microphones included will work in most situations, for the best results use the microphones in an open space within the proper proximity with the speaker.

GUIDELINES FOR BLUETOOTH

1. The Bluetooth pair name of the device is "PURE MCP-70".
2. Before using the Bluetooth function. Please be sure the speaker is in Bluetooth mode.
3. Scan for nearby devices using your Smartphone or other bluetooth enabled music player. Choose "Pure MCP-70" from the list of nearby devices and select it devices. The "PURE MCP-70" will connect with your device.

CAUTION

- A · The equipment only works with AC 220V power supply or DC12V built-in battery, DO NOT use any other power supply to power the device. Doing so may cause damage to the speaker and will void the warranty.
- B · Do not expose this equipment to rain, moisture, strong sunlight or a high temperature environment.
- C · To prevent damage, do not place the objects on equipment, like vases or other objects containing liquid etc.
- D · To prevent damage to the sound system, do not connect the equipment to an exterior amplifier.
- E · To avoid hurting your hearing or prevent damage to the equipment, please play the equipment at an adequate enough sound volume level.
- F · To prevent overheating, please use the equipment in a well-ventilated environment.

SAFETY

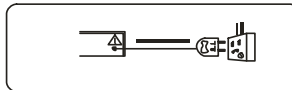

POWER: This equipment should only be powered use one of the above mentioned power sources.

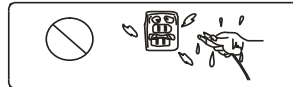

ELECTRIC SHOCK: In case of electric shock, do not use the speaker. Remove from the power outlet and consult a professional authorized repair man.



HEAVY PREASURE/HEAT: The equipment should not be pressed or placed in areas that can cause overheating.

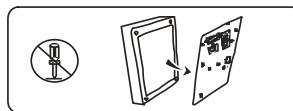

DISMOUNTING: Do not dismount the equipment yourself, if needed, please refer to well-trained and authorized person. Doing so may cause damage and void the warranty.

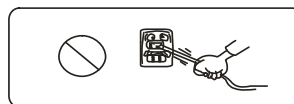

POWER CABLE PROTECTION: Please be assured power cable cannot be stepped on or pressed by heavy object; do not drag power cable forcefully

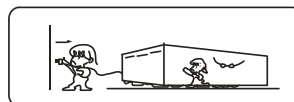

USAGE: Please remove power cable from outlet and Power off while not in use for extended periods of time.

Troubleshooting

The speaker does not produce sound:

- A · Check to see that power plug is properly inserted into outlet and confirm the power switch is in the On position.
- B · Check to make sure the audio cable is properly connected.
- C · Check to make sure the speaker volume is at an adequate sound level.
- D · If attempting to use the speaker in battery mode, try plugging in to a wall using the power cable to confirm the battery does not need to be charged.

Karaoke with sharp noise, what to do?

- A. Please adjust the distance between the MCP-70 and the wireless microphone
- B. If attempting to use both wireless microphones simultaneously try increasing the distance between the two microphones.

EQUIPMENT NOISE

The MCP-70 is equipped with a distortion prevention feature. However, in the event that unwanted noise distortion occurs, remove any connected audio cables and reinsert them one at a time. Make sure to keep adequate distance from each cable 2 -3 feet.

ANTIMAGNETIC

Keep the speaker at a safe distance from other magnetic devices to prevent unwanted distortion such as CRT Monitors; TV's, mobile phones etc... keeping these and other similar devices at a distance of 2-3 feet will prevent such distortion from occurring.

Technical Specifications:

Specifications

Power Output: 45 Watts

Frequency Response: 40Hz-22 KHz +/- 3dB

Wireless MIC A Frequency: 202.2

Wireless MIC B Frequency: 185.15

S/N Ratio: > 70dB +/- 3dB

Driver: 8" Woofer / 4 ohms x 1

Tweeter: 3" horn

Power Source 1: DC 12V 2.6mAh

Power Source 2: AC 100-230V / 50-60Hz 35W

Product Dimensions: 17.5 X 27 X 40 Cm

In the Box:

1. 2 Wireless Microphones with Independent Frequencies
2. 1 Power Adapter
3. 1 IR Remote Control
4. 2 User manual