



FIELDMANN[®]
Home & Garden Performance



FZR 4010-B

English 5 - 20
Čeština..... 21 - 36
Slovenčina..... 37 - 52
Magyarul..... 53 - 68
Polski 69 - 84

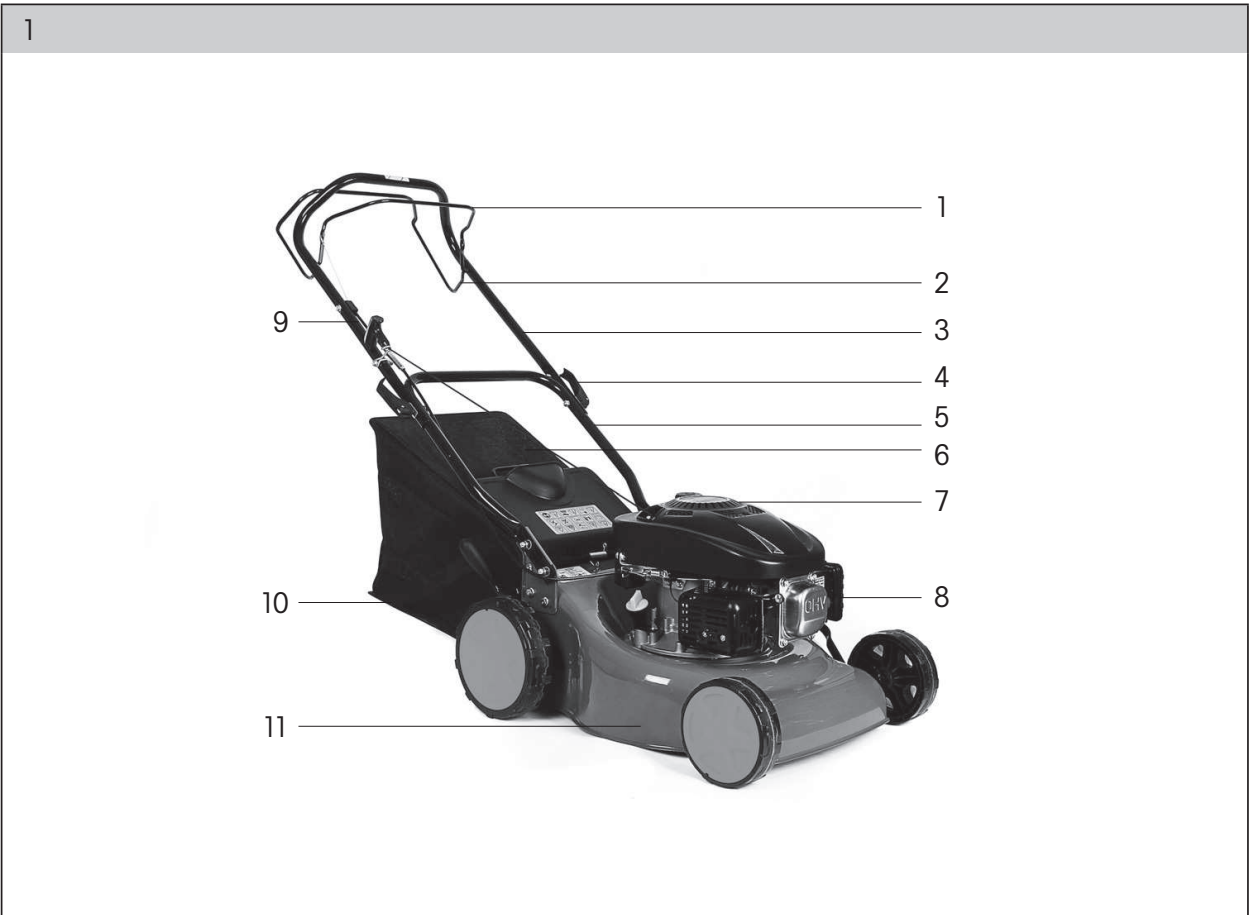

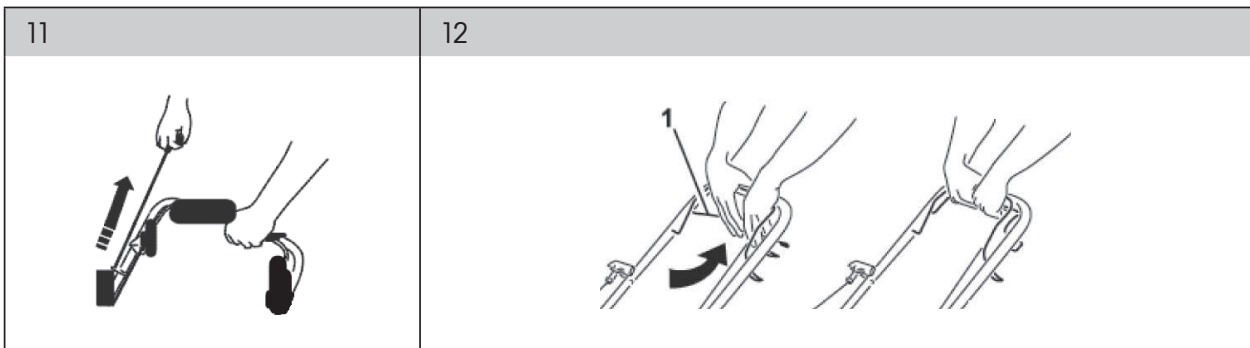
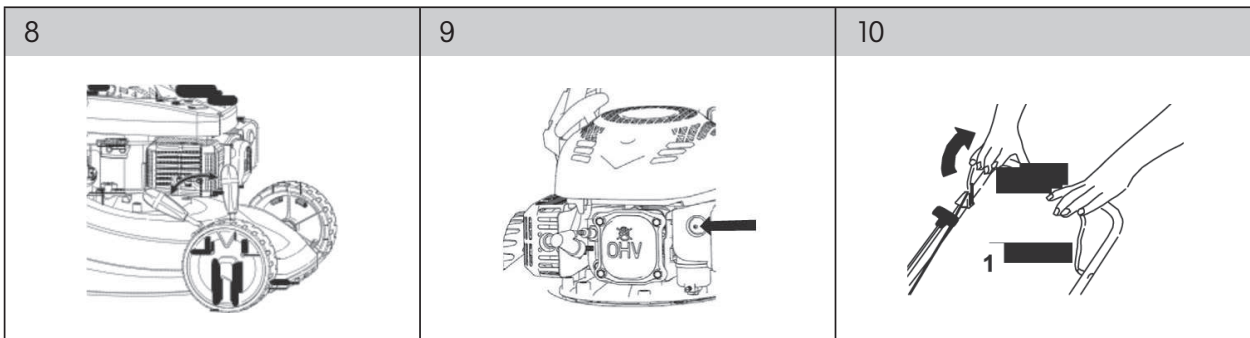
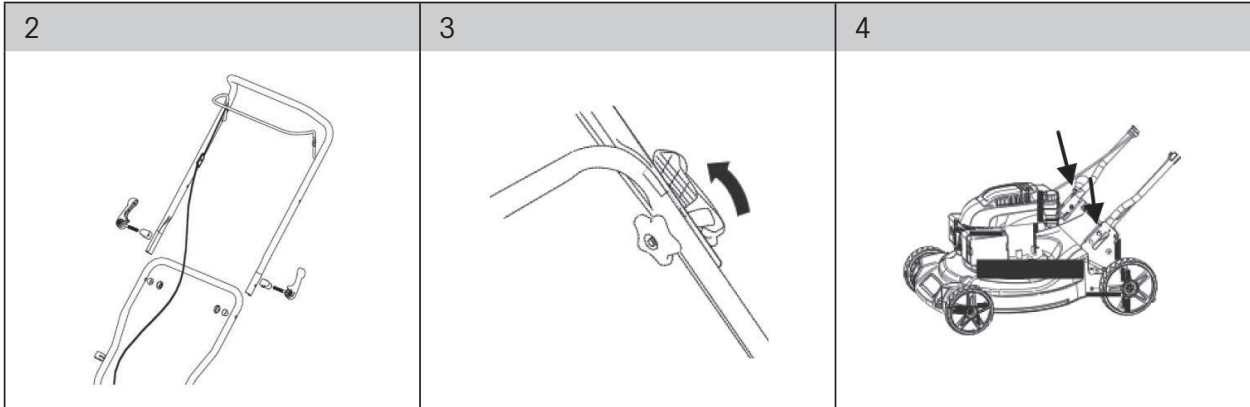

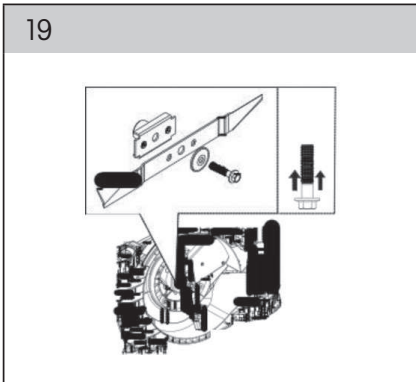
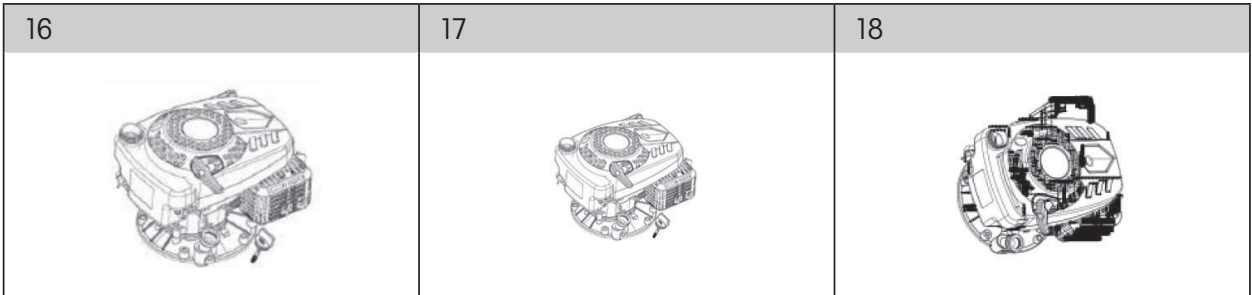
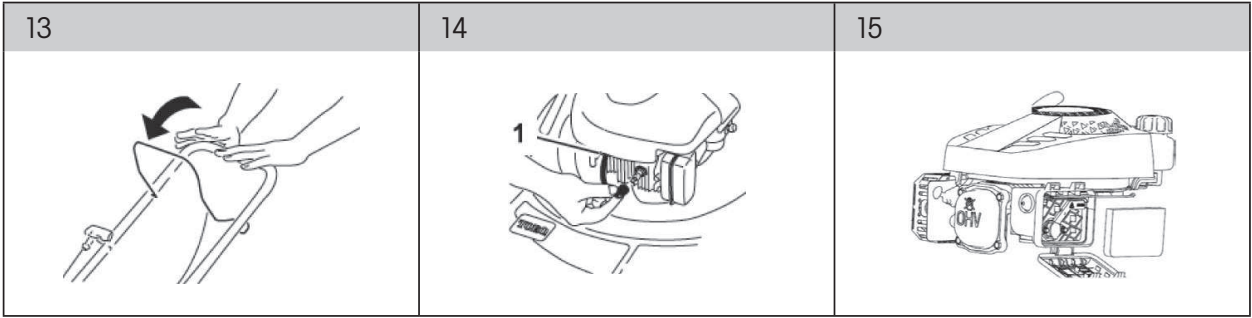

Petrol Lawnmower

USER'S MANUAL

Thank you for purchasing this rotary petrol lawnmower. Before you start using it, please, carefully read this user's manual and save it for possible future use.

CONTENTS

ILLUSTRATED ATTACHMENT.....	1
1. GENERAL SAFETY INSTRUCTIONS.....	6
Important safety notice	
Packaging	
Operating instructions	
2. EXPLANATION OF INSTRUCTION LABELS ON THE MACHINE.....	7
3. DESCRIPTION OF THE MACHINE.....	9
4. ASSEMBLY INSTRUCTIONS.....	9
5. OPERATION.....	9
General mowing tips	
Recommended maintenance plan	
Preparing for maintenance	
Replacing the air filter	
Changing the motor oil	
Replacing the mowing blade	
6. SAFETY INSTRUCTIONS.....	14
General safety instructions	
Instructions for use	
7. MAINTENANCE.....	15
Lawn care	
Maintenance	
Service	
Warranty does not cover	
Storage	
8. TECHNICAL SPECIFICATIONS.....	17
9. DECLARATION OF CONFORMITY.....	18
10. DISPOSAL.....	19

1. GENERAL SAFETY INSTRUCTIONS

Important safety notice

- ✿ Carefully unpack the product and take care not to throw away any part of the packaging before you find all the parts of the product.
- ✿ Store the machine in a dry place out of reach of children.
- ✿ Read all warnings and instructions. Not following warnings or instructions may lead to injury by electrical shock, a fire and/or serious injuries.

Packaging

The product is packed in a package that prevents damage during transport. This package is a resource and so can be handed over for recycling.

Operating instructions

Before you start working with the machine, read the following safety and usage instructions.

Acquaint yourself with the operating elements and the correct use of the machine. Keep the user's manual in a safe place where it can be easily retrieved for future use. Save the original packaging, including the internal packing material, warranty card and proof of purchase receipt at least for the duration of the warranty.

If you need to ship this machine, pack it in the original cardboard box to ensure maximum protection during shipping or transport (e.g. when moving or when you need to send this product for repair).

 **Note:** If you hand over the machine to somebody else, do so together with the user's manual. Following the instructions in the included user's manual is a prerequisite for the proper use of the machine. The user's manual also contains operating, maintenance and repair instructions.

The manufacturer takes no responsibility for accidents or damages resulting from not following the instructions in this manual.

2. EXPLANATION OF INSTRUCTION LABELS ON THE MACHINE



Before putting into operation, please carefully read the user's manual.



Keep other persons away from the work area.



Attention, rotating blades! Protect yourself against the danger of injury to limbs.



Emission of toxic gasses. Do not use the petrol lawnmower in enclosed or unventilated areas.



Hot surfaces, risk of burns!

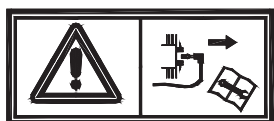

Before carrying out maintenance, turn off the engine and disconnect the spark plug.



Never add fuel while the engine is running.



Indicates that there is a risk of injury to persons, death or damage to the machine if instructions are not followed



Use hearing protection.
Use eye protection.
Use breathing organ protection.



Always maintain a distance from moving parts.



Travel along the slope on contours, not up and down.



Conforms to all relevant European directives.



Petrol is extremely flammable and therefore allow the engine to cool down for 2 minutes before adding more fuel.

3. DESCRIPTION OF THE MACHINE

1. Switch / brake lever
2. Travel lever
3. Top part of the handle
4. Quick coupling screw
5. Bottom part of the handle
6. Grass catcher
7. Engine
8. Fuel primer bulb
9. Pull cord
10. Central mowing height adjustment lever
11. Lawnmower chassis

4. ASSEMBLY INSTRUCTIONS

⚠ WARNING! There exists a risk of damage to cables and subsequent operation of the lawnmower under dangerous conditions if the handle is incorrectly folded or unfolded.

- 🌀 Do not damage the cables when folding or unfolding the lawnmower handle.
- 🌀 If a cable is damaged, contact an authorised service centre.

1. Take the top and bottom part of the handle out of the packaging, screw out the quick coupling screws on both sides of the handle and connect both parts of the handle together (figure 2).
2. Press the buttons on the handle (figure 3).
3. Place 4 nuts on the bottom part of the handle (figure 4).
4. Lift up the back cover of the lawnmower and hold it in the top position (figure 5).
5. Insert the grass catcher into the groove in the rear part of the cover (figure 6).
6. Release the rear cover.

5. OPERATION

1. Adding motor oil

- 1.1 Take out the oil dipstick (figure 7).
- 1.2 Slowly pour oil into the filling tube until the oil level reaches the "Full" (full) mark on the oil dipstick. Do not overfill the tank.
- 1.3 Then screw the oil dipstick back into place.

⚠ Caution! Perform the first oil change after the first 2 hours of operation, then regularly change the oil once a year. See chapter Changing the motor oil.

2. Filling up fuel

- ⚠ **Caution!** Petrol is an extremely flammable and combustible substance. In the event of a fire or explosion, you and other persons may suffer burns.
- 🌀 Prior to pouring in petrol, place the canister and/or the lawnmower directly on the ground, do not place it in a vehicle or on an object, this will prevent the risk of a static discharge and the combustion of the petrol while it is being poured.
- 🌀 Always add the fuel in an outdoor environment, when the engine is cold. Carefully wipe away any stains or drops.
- 🌀 Do not smoke when adding petrol. Do not pour fuel into the lawnmower in the vicinity of an open fire or sparks.
- 🌀 Only store petrol in an approved type of canister, out of reach of children.

3. Checking the oil level

- 3.1 Take out the oil dipstick, clean it using a cloth and reinsert it into the hole (figure 7).
- 3.2 Then take the dipstick out again and read off the oil level. If the oil level is below the "Add" (add) mark, slowly pour oil into the filling tube until the oil level reaches the "Full" (full) mark on the oil dipstick. Do not overfill the tank.
- 3.3 Put the oil dipstick back into place.

4. Setting the mowing height

- ⚠ **Caution!** When setting the mowing height, there is a risk of contact with the moving blades and subsequent serious injury.
- 🌀 Turn off the engine and wait until the moving parts come to a complete stop.
- 🌀 When setting the mowing height, never place your fingers into the area under the lawnmower deck.
- ⚠ **Caution!** If the engine was running, the exhaust muffler is very hot and there is risk of burning oneself on it. Keep a safe distance from the hot exhaust muffler.

- 4.1 Set the mowing height as required using the central height adjustment lever (figure 8).

5. Starting the engine

- 5.1 Before first use of the lawnmower, press 3. - 5 times the fuel primer bulb on the suction filter. Then before every start of the lawnmower, press the fuel primer bulb only once (figure 9).
- 5.2 Pull the throttle control lever to the handle (figure 10).
- 5.3 Start the lawnmower using the manual starter (figure 11).
- 5.4 If the engine does not start up after 1 - 2 pulls of the cord, press the fuel primer bulb once or twice and attempt to start it again.

📖 **Note:** If you are unsuccessful starting the engine, contact an authorised service centre.

Turn off the engine. Release the brake control lever.

6. Mowing with travel (applies only to lawnmowers equipped with travel)

If you wish to take advantage of the independent travel feature when mowing, press the travel control lever 1 (bottom lever) against the handle and hold it (figure 12).

If you do not wish to use the travel feature, simply release the travel control lever.

 **Note:** The travel runs at a constant maximum speed when mowing.

- ✿ Remove sticks, branches, rocks, wires and other items from the area being mowed, which the mowing blades could impact.
- ✿ Prevent the mowing blades from coming into contact with solid foreign objects. Never intentionally travel over items with the lawnmower.
- ✿ If the lawnmower has travelled over an object or it has started vibrating abnormally, immediately turn off the engine, disconnect the spark plug cable and check the lawnmower for damage.
- ✿ You will achieve the best lawnmower performance by always replacing or sharpening and balancing the mowing blade at the start of the season.

7. Stopping the engine

If you wish to stop the engine, release the cutting blade control lever (figure 13).

8. Tips for operating the petrol lawnmower

General mowing tips

- ✿ Never mow more than one third of the length of the blade of grass at once. Do not mow grass to a height of less than 4 cm
- ✿ If you intend to mow grass higher than 1 cm, first set a higher mowing height and proceed very slowly when mowing. Then reduce the mowing height and mow the entire area once more. If the grass is too tall, the lawnmower may clog up and the engine may be overloaded.

 **WARNING!** When mowing wet grass or wet leaves there is a risk of slipping, falling down and subsequent serious injury resulting from contact with the mowing blades of the lawnmower. Mow grass only when it is dry.

- ✿ If the mowing results look unsatisfactory, try the following steps:
 - Replace the mowing blade or have it sharpened.
 - Walk slower when mowing.
 - Increase the mowing height on the lawnmower.
 - Mow the lawn more often.

 **Caution!** The right and left side of the lawnmower are described from the viewing position of the operator of the lawnmower when mowing.

Recommended maintenance plan

Maintenance interval	Task
After first 2 hours of operation	Change the motor oil.
Before each use or daily	Check the oil level in the tank. Check that the engine turns off 3 seconds after the mowing blade control lever is released. Clean grass clippings and other dirt from the bottom part of the lawnmower.
Before storage	Before repairs or storage for the winter season, drain the petrol from the tank (see the respective chapter in the manual).
Yearly	Replace the air filter (in dusty conditions, replace the filter more frequently). Change the motor oil. Lubricate the wheel mechanism. Replace the mowing blade or have it sharpened (if the blade is blunted faster, have it sharpened more frequently). You can find further information in the user's manual of the lawnmower's engine.

⚠ Important: You can find further information in the user's manual of the lawnmower's engine.

Preparing for maintenance

1. Turn off the engine and wait until the moving parts come to a complete stop.
2. Before starting maintenance, disconnect the end of the spark plug and hook it on to the holding pin (figure 14).
3. After finishing maintenance, reconnect the end to the spark plug.

⚠ Important: In order to tilt the lawnmower to change oil or replace the blades, first use up all the fuel in the tank. If it is necessary to tilt the lawnmower before fuel is used up, pump out the fuel using a manual fuel pump. Always tilt the lawnmower to the side so that the air filter is pointing upwards.

⚠ Caution! Fuel may leak out when the lawnmower is tilted. Fuel is flammable and combustible and may cause injury. Use up the fuel during operation or pump it out using a manual pump, never using a siphon tube.

Replacing the air filter

Replace the air filter once per year. If you operate the lawnmower in dusty conditions, replace the filter more frequently.

1. See chapter Preparing for maintenance.
2. Take off the air filter cover.
3. Replace the air filter.
4. Reattach the lawnmower cover.

Changing the motor oil

Before changing the oil, allow the engine to run for a while to heat up the oil. Warm oil is easier to drain and also binds more impurities to itself.

1. See chapter Preparing for maintenance.
2. Take out the oil dipstick (figure 16).
3. Tilt the lawnmower to the right side and drain the used oil through the filling tube (figure 17).
4. Slowly pour oil into the filling tube until the oil level reaches the "Full" (full) mark on the oil dipstick (figure 18).
Do not overfill the tank.
5. Put the oil dipstick back into place.
6. Take the used oil to your local waste collection facility.

Replacing the mowing blade

⚠ Important: You will need a torque wrench to correctly install the mowing blade. If you do not have a torque wrench or you are not sure about the installation, please contact an authorised service centre.

After using up a tank of fuel, always check the mowing blade. If the mowing blade is damaged or cracked, replace it immediately. If the blade is blunt or damaged, have it sharpened or replace it.

⚠ Caution! The mowing blade is sharp, contact with the blade may result in serious injury. Use protective gloves when working with the mowing blade.

1. Before starting maintenance, disconnect the end of the spark plug and hook it on to the holding pin. See chapter Preparing for maintenance.
2. Tilt the lawnmower to the side so that the air filter is pointing upwards.
3. Lock the mowing blade in position using a wooden block (figure 19).
4. Take off the mowing blade and keep all the fastening parts (figure 19).
5. Install a new mowing blade and all the fastening parts.

⚠ Important: The bent ends of the mowing blade must point towards the lawnmower deck.

6. Using the torque wrench, tighten the mowing blade fastening bolt to 4 Nm.

⚠ Important: A bolt tightened to 4 Nm is very strong. Lock the mowing blade in position using a wooden block and firmly tighten the bolt using an impact or torque wrench. It is very difficult to overtighten the bolt.

6. SAFETY INSTRUCTIONS

General safety instructions

- ✿ This product is used exclusively for mowing grass. Do not use it for any other purposes than those intended. Otherwise there is a risk of damaging it or an injury.
- ✿ Never allow children or persons who are not acquainted with the contents of this user's manual to work with the machine.
- ✿ The person operating the lawnmower is responsible for the safety of persons in the work area. Never operate the lawnmower in the near vicinity of other people, children or freely roaming animals.
- ✿ Before starting mowing, check the terrain where the lawnmower will be used and remove stones, wires, sticks, splinters, bones and other foreign objects, which could become caught in it or deflected or cause injuries.

Instructions for use

- ✿ All nuts, pins and bolts must be properly tightened so that the machine is in a safe and operational condition.
- ✿ Never use the lawnmower without the grass catcher or protective cover.
- ✿ Never use the lawnmower with loose mowing blades. Always check in advance that all respective bolts are securely tightened. Blunt blades must be sharpened evenly. Damaged blades must be replaced.
- ✿ When working with the lawnmower, wear long pants and solid footwear.
- ✿ Never start the lawnmower in enclosed or poorly ventilated areas where fumes could accumulate. Emissions from the engine contain carbon monoxide, which is life threatening.
- ✿ Work only during sufficient light conditions (in daylight or sufficient artificial lighting).
- ✿ Do not use the lawnmower when it is raining or if the grass is wet.
- ✿ Proceed especially carefully when mowing in elevated terrain (on a slope). Always mow perpendicular to the slope, parallel to the contour, and not directly up/down.
- ✿ Under no condition leave the lawnmower running without supervision; if you leave the lawnmower, turn off the engine.
- ✿ Never lift the rear part of the lawnmower when starting it and always keep your limbs away from the cutting deck or the rear grass ejection chute while the engine is running.
- ✿ Never modify the engine's speed setting.
- ✿ On lawnmowers with travel, release the travel lever before starting the engine.
- ✿ Never transport the lawnmower while its engine is running.
- ✿ Stop the engine and disconnect the spark plug in the following cases:
 - when performing any task whatsoever under the mowing deck or in the rear grass ejection chute.
 - when performing maintenance, repairs or inspecting the machine.
 - before carrying, lifting or transporting the lawnmower.
 - when you leave the lawnmower without supervision or you are getting ready to adjust the mowing height.
 - before removing and emptying the grass catcher.
 - when an impact with a foreign object occurs, stop the engine and carefully inspect to ensure that there is no damage. In the event of damage, take the lawnmower to a specialised service centre for repairs.

⚠ ATTENTION: The mowing blade continues to rotate for several seconds after the engine is turned off.

- if the lawnmower is vibrating abnormally (immediately identify and remedy the cause of the vibration).
- For the purpose of ensuring safe operation, regularly check that the pins, bolts and nuts on the lawnmower are securely tightened.

⚠ ATTENTION: FUEL IS A VERY FLAMMABLE LIQUID.

- ✿ Store fuel in a suitable container.
- ✿ Only add fuel in an open and well ventilated location. When handling fuel, do not smoke or use a mobile phone.
- ✿ Only add fuel when the engine is turned off. Never open the fuel tank or add fuel if the engine is hot or if it is running.
- ✿ If fuel is spilled, do not start the engine. Take the lawnmower away from the location where the fuel was spilled and take care to avoid possible ignition. Continue with work only after the spilled fuel has evaporated and the fuel fumes have dissipated;
- ✿ After adding fuel, securely tighten the fuel tank cap and the cap on the fuel canister.

⚠ ATTENTION: Before carrying out maintenance or repairs, stop the engine and disconnect the spark plug.

7. MAINTENANCE

Lawn care

- ✿ Various forms of care are required depending on the type of grass area.
- ✿ Therefore, always read the instructions included on seed packages with respect to the mowing height for the growing conditions in the given locality.
- ✿ It is necessary to always keep in mind that the larger part of grass consists of a stem and one or more leaves. When the leaves are cut off completely, the lawn is damaged and the renewal of growth will be much more difficult.
- ✿ The following instructions generally apply:
 - excessively low mowing causes disruption to the roots and subsequently "spotty" appearance;
 - in summer, mowing must be higher to prevent the soil from drying out;
 - mowing wet grass may result in a lower efficiency of the blade due to grass catching on the blade and grass being ripped out of the ground;
 - in the event of exceptionally tall grass it is appropriate to perform the first mow at the maximum permitted mowing height of the machine and then mow again only after two or three days.
- ✿ The lawn will have a better appearance when it is mowed regularly over its entire area at the same height with alternating mowing directions.

Maintenance

- ✿ All nuts, pins and bolts must be properly tightened so that the machine is in a safe and operational condition. Regular maintenance is the basic prerequisite for ensuring safety of the user, maintain the lawnmower's operating condition and high performance.
- ✿ Never store a machine with petrol in the fuel tank inside a building where the fumes could come within range of an open fire, sparks or sources of high temperature
- ✿ Before storing in any enclosed area, allow the engine to cool down.

- ✿ To reduce the risk of a fire, ensure that the lawnmower and in particular the engine, exhaust muffler, battery and also the location of spare fuel storage are free of grass, leaves or excessive amounts of lubricant.
- ✿ Regularly inspect the condition of the deflector and the grass catcher; replace if damaged.
- ✿ Drain the fuel in a well ventilated area when the engine has cooled down.
- ✿ When removing or installing the mowing blade, use thick work gloves.
- ✿ It is necessary to check the balance of the mowing blade every time that it is sharpened.

⚠ ATTENTION: Before carrying out maintenance or repairs, stop the engine and disconnect the spark plug.

- ✿ Before using the four-stroke engine, please carefully read the user's manual of the engine. Regularly check the oil level and if necessary add oil or change it.
- ✿ Regularly inspect the lawnmower and ensure that all grass deposits are removed from the underside of the chassis.
- ✿ Regularly lubricate the axle of the chassis and the bearings using a suitable lubricant.
- ✿ Regularly inspect the condition of the blades because they have a significant effect on the performance of the lawnmower. Blades should always be sharp and balanced.
- ✿ In regular intervals, check that all nuts and bolts are tightened. Nuts and bolts that are worn out or incorrectly tightened may cause serious damage to the engine or the frame.
- ✿ If the blade strongly impacts an obstacle, stop the lawnmower and take it to an authorised service centre.
- ✿ **BLADE:** the blade is made from pressed steel. To achieve the best possible mowing results, regularly sharpen the blades, approximately after every 25 hours of operation. Check that the blade is always correctly balanced. To do this, insert a steel axle (with a diameter of 2-3 mm) into the middle hole. If it is correctly levelled, the axis will remain in the horizontal position.
- ✿ If the blade does not remain in the horizontal position, replace it.
- ✿ When removing the blade, screw out the bolt, check the load bearing part of the blade. If the parts are worn out or damaged, replace them.
- ✿ When installing the blades, check that the cutting edges are pointing in the rotating direction of the engine. The blade fastening bolt must be tightened using a torque wrench to a torque of 3.7 K gm (37 Nm). (fig. 14)

⚠ ATTENTION: Always use only original spare parts. Poor quality spare parts may cause serious damage to the lawnmower and create a safety hazard.

Service

- ✿ In the event that after purchasing the product you find any kind of defect, contact the service department. When using the product, follow the instructions contained in the included user's manual.
- ✿ A complaint will not be accepted if you modified the product or if you did not follow the instructions in the user's manual.

Warranty does not cover

- ✿ Normal wear and tear of operating parts of the machine as a result of its use
- ✿ Servicing tasks related to standard maintenance of the machine (e.g. cleaning, lubrication, tuning, etc.). Defects caused by external effects (e.g. climatic conditions, dustiness, inappropriate use, etc.)
- ✿ Mechanical damage resulting from the machine being dropped, impact, etc.
- ✿ Damages resulting from unprofessional handling, overloading, use of incorrect parts, inappropriate tools, etc.
- ✿ On returned products that were not properly protected against mechanical damage during transport, the risk of potential damage is borne exclusively by the owner.

Storage

- ✿ If you will not be using the machine for an extended period of time, store it according to the following instructions. This will extend the lifetime of the machine.
- ✿ Fully drain fuel from the fuel tank and the carburettor. Close the choke and 3 to 5 times pull on the cord.
- ✿ Screw out the spark plug and pour a small amount of motor oil into the socket. Gently pull the pull cord 2 to 3 times.
- ✿ Use a clean cloth to clean the exterior surfaces. Store the machine in a clean dry location.

8. TECHNICAL SPECIFICATIONS

Engine type	OHV, air cooled, 4-stroke
Rated power	1.75 kW
Engine rpm	3000 rpm
Displacement	99 cm ³
Starting	Pull cord
Fuel tank capacity (lead-free 95 or higher)	0.8 litres
Adjustable mowing height	25-75 mm with 10 positions
Height adjustment	Central height adjustment
Mowing width	400 mm
Wheel span	155 mm (front wheel) 200 mm (rear wheel)
Capacity of grass catcher:	45 l
Chassis	steel
Declared noise level	96 dB (A)
Weight	26.5 kg

Amendments to text and technical parameters are reserved.

Changes in the text, design and technical specifications may be made without prior notice and we reserve the right to make these changes.

9. DECLARATION OF CONFORMITY

ES Declaration of Conformity

We Fast ČR, a.s., Černokostelecká 251 01 Říčany u Prahy, tel.:323204111, hereby declare, that the Fieldmann FZR 4010 B Petrol Lawnmower (year of manufacture is indicated on the rating label and is followed by the serial number of the machine, meets the directives COUNCIL DIRECTIVE:

2006/42/EC – 2004/108/EC – 2000/14/EC – 97/68/EC – 2002/88/EC

and was tested in compliance with the norms below:

EN 55012

EN 836 – EN 836/A1 – EN 836/A2 – EN 836/A3

EN ISO 5395-1:2013

EN ISO 14982:2009

EN ISO 3744:2010

ISO 11094:1991

FAST ČR, a.s. is authorised to act on behalf of the manufacturer.

CE label: 14

In Říčany, on 27. 8. 2014

Name, stamp, signature

FAST FAST ČR, a.s. 
Černokostelecká 1621
251 01 Říčany u Prahy
ICO: 26726548 tel.: +420/ 323 204 111
DIČ: CZ26726548 fax: +420/ 323 204 110

Petr Uher
Quality Manager



10. DISPOSAL

INSTRUCTIONS AND INFORMATION REGARDING THE DISPOSAL OF USED PACKAGING MATERIALS

Take the packaging material to a designated municipal waste facility.



The machine and its accessories are manufactured from various materials, e.g. metal and plastic.

Take damaged parts to a recycling centre. Inquire at the relevant government department.



This product meets all the basic requirements of EU directives that apply to it.

Changes in the text, design and technical specifications may be made without prior notice and we reserve the right to make such changes.

User's manual in the original language.

