

Holmes

Oscillating Table Fan

HAOF933
HAOF1233
HAOF1633



Owner's Guide

PLEASE READ AND SAVE THESE IMPORTANT INSTRUCTIONS

PLEASE READ AND SAVE THESE IMPORTANT SAFETY INSTRUCTIONS

When using electrical appliances, basic safety precautions should always be followed to reduce the risk of fire, electric shock, and injury to persons, including the following:

- 1) Read all instructions before using the appliance.
- 2) To avoid fire or shock hazard, plug the appliance directly into a 120V AC electrical outlet.
- 3) Keep the cord out of heavy traffic areas. DO NOT let the cord hang over the edge of a table or counter. To avoid fire hazard, NEVER put the cord under rugs, near heat registers, radiator, stoves, or heaters.
- 4) To protect against electrical hazards, DO NOT immerse in water or other liquids. Do not use near water.
- 5) Close supervision is necessary when any appliance is used by or near children, or by disabled people.
- 6) Always unplug the fan before moving it, putting on or taking off parts, cleaning, or whenever the fan is not in use. Be sure to pull by the plug and not the cord.
- 7) Avoid contact with moving parts. DO NOT operate without fan grills properly in place.
- 8) DO NOT operate any appliance with a damaged cord or plug, if motor fan fails to rotate, after the appliance malfunctions, or if it has been dropped or damaged in any manner. Return appliance to manufacturer for examination, electrical or mechanical adjustment, or repair.
- 9) DO NOT operate in the presence of explosive and/or flammable fumes.
- 10) Use appliance only for intended household use as described in this manual. Any other use not recommended by the manufacturer may cause fire, electric shock, or injury to persons. The use of attachments not recommended or sold by The Holmes Group (or Bionaire) may cause hazards.
- 11) DO NOT use outdoors.
- 12) Always use on a dry, level surface.
- 13) Keep unit away from heated surfaces and open flames.

- 14) WARNING: To reduce the risk of fire or electric shock, DO NOT use this fan with any solid-state speed control device.
- 15) DO NOT attempt to repair or adjust any electrical or mechanical functions on this unit. Doing so will void your warranty. The inside of the unit contains no user serviceable parts. All servicing should be performed by qualified personnel only.

PLEASE READ AND SAVE THESE IMPORTANT SAFETY INSTRUCTIONS

ASSEMBLY INSTRUCTIONS

Base / Pole Assembly

Step 1: Insert the pole into the base aligning the keyway on the bottom of the pole with the key in the base.

Step 2: Tighten the base nut onto the bottom of the pole.

Fan Head Assembly

Step 1: Position the rear grill over the motor shaft, making sure the circular opening in the center of the rear grill fits over the prongs on the rear housing. Please make sure the rear grill fits securely against the motor housing.

Step 2: Secure the rear grill in its place using the rear grill mounting-nut. Turn this nut clockwise and tighten firmly.

Step 3: Slide the fan blade, with the hollowed interior of the blade facing towards the rear of the grill firmly onto the motor shaft, until the shaft protrudes from the front of the blade.

Step 4: Secure the fan blade onto the motor shaft by firmly tightening the fan blade nut.

NOTE: TURN THE BLADE NUT COUNTER-CLOCKWISE

Step 5: Center the front grill by aligning the Holmes logo on the grill hub so it is horizontal and parallel with the floor. Then, holding the front grill against the rear grill, push the translucent grill ring into place at the top and bottom of the fan. (Push directly on the translucent grill ring, not on the grills themselves.) Finish securing the grill ring in the same manner until both grills are joined underneath the translucent grill ring.

Step 6: Align the metal plate with the indentation on the bottom of the grill ring. Pass the screw with the washer through the opening on the bottom of the grill ring and fasten to the metal plate.



THIS PRODUCT IS EQUIPPED WITH A POLARIZED AC (Alternating Current) PLUG (a plug having one blade wider than the other). This plug will fit into the power outlet only one way. If the plug does not fit fully into the outlet, reverse the plug. If it still does not fit, contact qualified personnel to install the proper outlet.

DO NOT DEFEAT THE SAFETY PURPOSE OF THIS POLARIZED PLUG IN ANY WAY

ILLUSTRATION

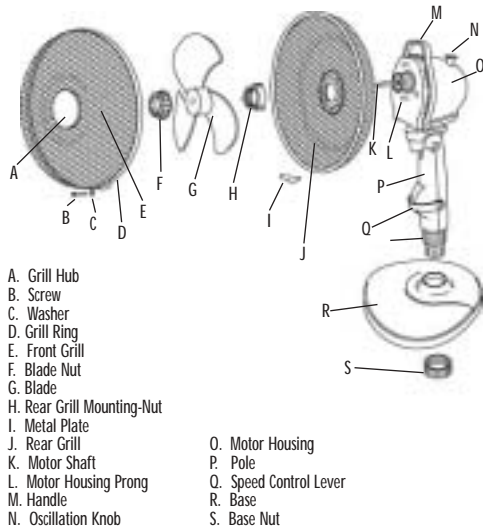

CLEANING/MAINTENANCE

Follow these instructions to correctly and safely care for your Holmes table fan. Please remember:

- Always unplug the fan before cleaning or disassembling.
- Do not allow water to drip on or into the fan motor housing.
- Do not use any of the following as a cleaner: gasoline, thinner, benzene

(See instructions for fan head assembly)

Step 1: To access the fan blade, remove the front grill and the fan blade nut.

Step 2: Clean the fan blade, both front and rear grills with a soft cloth moistened with a mild soap solution.

Step 3: Replace blade, tighten the fan blade nut, and securely fasten the front grill.

Fan Head and Base Cleaning

Using a soft, moist cloth, with or without a mild soap solution, carefully clean the fan base and head. Please use caution around the motor housing area. Do not allow the motor or other electrical components to be exposed to water.

OPERATING INSTRUCTIONS

Step 1: Set the fan base on a dry, level surface.

Step 2: Please make sure the On/Speed lever is in the "Off" position. Plug the cord into any standard 120-volt A/C outlet.

Step 3: The SPEED is adjusted by moving the lever up or down to the desired setting.

Step 4: The OSCILLATION control knob is located on the top of the fan motor housing. To start oscillation, push control knob down. To stop oscillation, pull control knob up.

FAN STORAGE

Your fan can be stored in the off-season either partially disassembled or assembled. It is important to keep it in a safe, dry location.

- If stored disassembled, we recommend using the original (or appropriately sized) box.
- If stored assembled or partially assembled, remember to protect the fan head from dust.

ADJUSTMENT INSTRUCTIONS

Tilt Adjustment

To change the tilting angle of the fan head, move the fan head to the desired angle.

SERVICE INSTRUCTIONS

1. Do NOT attempt to repair or adjust any electrical or mechanical functions on this unit. Doing so will void the warranty.
2. If you have any questions regarding this unit's operation or believe any repair is necessary, please write to our consumer service department.
3. If you need to exchange the unit, please return it in its original carton, with a sales receipt, to the store where you purchased it. If you are returning the unit more than 30 days after the date of purchase, please see the enclosed warranty.
4. If you have any other questions or comments, please write:

The Holmes Group, Inc.
CONSUMER SERVICE DEPARTMENT
P.O. Box 769,
Milford, MA 01757-0769

or visit our website at www.holmesproducts.com

For your own records, staple or attach your sales receipt to this manual. Also, please take a moment to write the store name/location and date purchase below.

STORE NAME:

LOCATION:

DATE PURCHASED:

(STAPLE RECEIPT HERE)

ONE (1) YEAR LIMITED WARRANTY

SAVE THIS WARRANTY INFORMATION

- A. The quality controls used in the manufacture of this Holmes product are to ensure your satisfaction.
- B. This Warranty applies only to the original purchaser of this product.
- C. This Warranty applies ONLY to repair or replacement of any supplied or manufactured parts of this product that, upon inspection by Holmes authorized personnel, proves to have failed in normal use due to defects in material or workmanship. Holmes will determine whether to repair or replace the unit. This Warranty does not apply to installation expenses.
- D. Operating this unit under conditions other than those recommended or at voltages other than the voltage indicated on the unit, or attempting to service or modify the unit, will render this WARRANTY VOID.
- E. **Unless otherwise proscribed by law, Holmes shall not be liable for any personal injury, property or any incidental or consequential damages of any kind (including water damage) resulting from malfunctions, defects, misuse, improper installation or alteration of this product.**
- F. All parts of this Holmes product are guaranteed for a period of 1 year as follows:
 1. Within the first 30 days from date of purchase, the store from which you purchased your Holmes product should replace this product if it is defective in material or workmanship (provided the store has in-stock replacement.)
 2. Within the first twelve months from date of purchase, subject to the conditions in paragraph H, Holmes will repair or replace the product if it is defective in material or workmanship providing it is returned to Holmes, freight prepaid, with PROOF OF PURCHASE date, together with \$5.00 for handling and return packing/shipping charges.
- G. If you have any problem with this product, please write to our Consumer Service Dept.
- H. **IMPORTANT** Return INSTRUCTIONS Your warranty depends on your following these instructions if you are returning the unit more than 30 days after the date of purchase:
 1. Carefully pack the item in its original carton or other suitable box to avoid damage in shipping.
 2. Before packing your unit for return; be sure to enclose:
 - a) your name, full address with zip code and telephone number,
 - b) a dated sales receipt or PROOF OF PURCHASE,
 - c) your \$5.00 check for return packaging, and
 - d) The model number of the unit and the problem you are having.(Enclose in an envelope and tape directly to the unit before the box is sealed.)
 3. Holmes recommends you insure the package (as damage in shipment is not covered by your warranty).
 4. All shipping charges must be prepaid by you (as noted in paragraph F).
 5. Mark the outside of your package:

HOLMES
THE HOLMES GROUP, INC.
CONSUMER RETURNS
32 B SPUR DRIVE
EL PASO, TX 79906

SHIPPING AND HANDLING CHARGES: \$5.00

This warranty gives you specific legal rights, and you may have other rights which vary from state to state. The provisions of this warranty are in addition to, and not a modification of, or subtraction from, the statutory warranties and other rights and remedies contained in any applicable legislation. To the extent that any provision of this warranty is inconsistent with any applicable law, such provision shall be deemed voided or amended, as necessary, to comply with such law.