

## Manuel de programmation User manual





With its compact dimensions and modern elegant design, Mini pony dmX is ideal for theatrical, live shows and architectural applications. The new high power COB LED technology allows a bright and uniform illumination, reduces considerably the consumption and removes maintenance and lamp changing.

**IMPORTANT!**

READ CAREFULLY THE INSTRUCTION LEAFLET IN ALL ITS PARAGRAPHS. THE KNOWLEDGE OF THE INFORMATION AND OF THE LIMITATION HELD IN IT, IS BASIC AND FUNDAMENTAL FOR A CORRECT AND SAFE USAGE OF THIS PRODUCT.

**IMPORTANT!**

BEFORE ANY (MAINTENANCE, CLEANING ETC.) ACTION, SWITCH OFF THE POWER SUPPLY.

**IMPORTANT!**

- This device is suitable for indoor use (room temperature cannot be higher than 35°C).
- This device is suitable for direct assembling on normally flammable surfaces.

**Technical specifications:**

- Body made of die-cast aluminium + steel sheets
- Black epoxy powder coating
- Power supply: 100/240V 50/60Hz
- Current: 0,22 A (230v)
- Power: 50 Watts
- Source: 1 COB LED
- Colour temperature: 3200°K or 5400°K
- Functioning: DMX Signal and automatic mode
- Channels: ½ DMX 512, 8/16 bit
- Weight: 1,7Kg

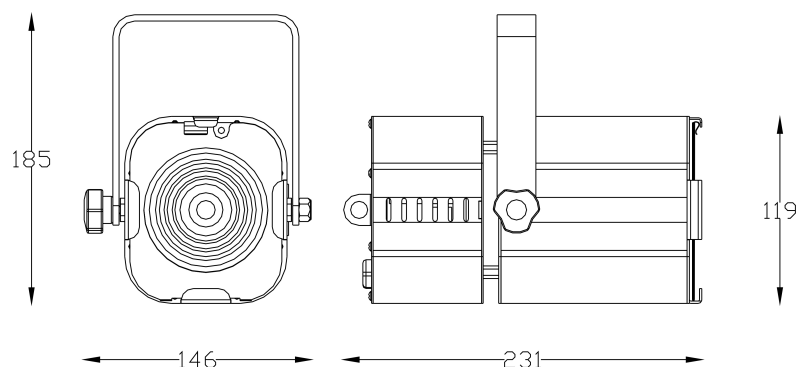
**Dimensions:****Installation:**

The projector can be fixed in any position. For suspending use, it is needed to install an appropriate clamp. It must be located in a well ventilated position, using an M8 screw, a nut and a washer. Make sure the structure You are fixing the product to can stand the product load.

**Connection**

The projector is fitted with a power supply cable and two XLR 5 Poles connectors for DMX IN and OUT signal (Fig.1)

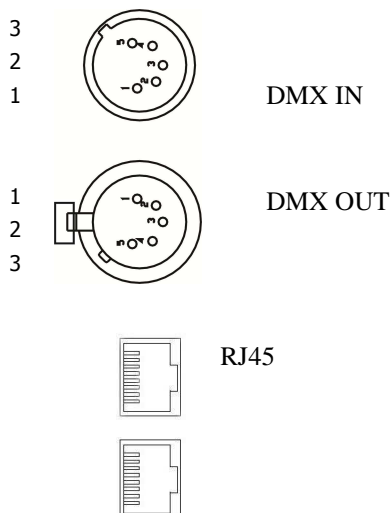
**Power supply connection:**

Power supply: 100/240V 50/60Hz

**DMX connectors:**

- 1: GND (shield)
- 2: data -
- 3: data +
- 4: NC
- 5: NC

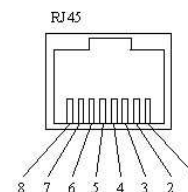
**RJ45 connectors:**

- 1: DALI / Cont1
- 2: DALI / Cont2
- 3: Common
- 4: CAN H
- 5: CAN L
- 6: Analogue 0 +10V
- 7: DMX -
- 8: DMX+

Any modification to this product is forbidden.

This lantern must be powered according to the voltage and frequency showed on its label (100/240V 50/60Hz). Connect the power cable to the socket. We suggest to connect each projector to its own switch so that they can be individually switched on with a remote control.



To remote control the projectors is required the use of a DMX512 control desk.

For the connection of signal use cable EIA rs-485 type: two core screened, 120Ω characteristic impedance, 22-24 AWG, low capacity, 1 XLR 5 poles MALE connector and 1 XLR 5 poles FEMALE connector.

To form a DMX chain, connect the DMX control desk to the first projector's DMX IN, then from its DMX OUT to the DMX IN of the second projector and so on.

For a correct functioning of the DMX signal, it is necessari to put a terminal into the DMX OUT of the last projector. This terminal is made of 1 XLR MALE connector with a 120Ω resistance welded between PIN 2 and PIN 3.

## Digital display and functioning options

Using the digital display, it is possible to change the functioning options, drive the projector in manual mode with possibility to regulate the light output intensity, display projector information and reset settings to default.

After 10 seconds without working, the display will turn off (if set on menu).

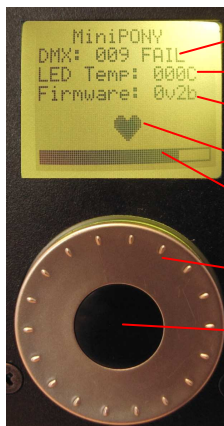

DMX address and state

LED temperature

Firmware version

Icon for regular functioning

Intensity of projector

Encoder wheel for navigation

Enter push button

The Led indicate the presence of DMX signal.

**Led on:** presenza del segnale

**Led off:** assenza del segnale

**Led red:** overheating of LED source. Fan will turn on at maximum speed.



## Addressing of the projector

To control many Mini pony DMX individually, it is necessary to assign to each one a different DMX address , setting the starting channel taking into consideration that one Mini pony DMX books 1 or 2 channels depending on the functioning mode set.

For example, if we have 6 projectors and need to use the 16 bit resolution, it will be necessary to set them on the channels 1, 3, 5, 7, 9, 11...

**To set DMX address** it is needed to **press 'Enter'** and follow this path **Mode>Setup>Mux setup>DMX setup>Set address>** on the display. Change DMX address using the encoder and press 'Enter' to confirm.



## Description of the main menu

To scroll the items of this menu use the encoder wheel.

### Manual

It is used to regulate the light output manually.

Press 'Enter'. To regulate the intensity set a value between 0 and 255 using the encoder wheel.

Press 'Enter' again to esc from regulation.

### Remote

Here you can set the controlling mode f the fixture. Some modes are optional in this version.

Press 'Enter', to choose the desired mode and press 'Enter' again to confirm.

Press 'Enter' again to esc.

### Setup

From this menù it is possible to setup every parameter of the fixture. Press 'Enter' to go in.



## MUX Setup

Access to the digital control configuration menù.

### DMX Setup

Access to the DMX configuration menù.

#### Set Address

Set the DMX address.

Press 'Enter', change DMX canne with the encoder wheel and press 'Enter' again to confirm.

#### Set Resolution (Courbes)

Set the dimming resolution of the fixture.

**8-bit** Basic resolution. Books 1 DMX chanel.

**8-bit extra** Medium resolution, software simulation of 11 bit. Books 1 DMX channel.

**16-bit HL** High resolution, the first channel is High, the second is Low. Books 2 channels.

**16-bit LH** High resolution, the first channel is Low, the second is High. Books 2 channels.

#### Set Hold

Set the DMX fail function.

If selected, when DMX signal fail, intensity hold at last received value.

If de-selected, when DMX signal fail, intensity snap to 0.

**DALI Setup** Not installed in this version.

**CAN Setup** Not installed in this version.

## Analogue Setup

It is used to setup the analogical part of the fixture.

**Encoder Setup** Configures the encoder wheel functioning.

**Enable** Enable or disable the use of the encoder wheel.

**Keep on exit** If set, the fixture keep the value set with the encoder wheel after leaving the regulation page.

**0-10V Setup** Not installed in this version.

**Contacts Setup** Not installed in this version.

**Wireless Setup** Not installed in this version.

**System Setup** Used to configure the system.

**LED Setup** It is used to setup the functioning of LED source.

**PWM frequency** Not installed in this version.

**Current scale** Set the quantity of current to drive the LED source.

**LCD Setup** Setup the illumination of LCD display

**Autodim** If set, the display illumination fade down after 10 seconds of inactivity.

If not set, display is always illuminated.

**Cooling Setup** Configure the cooling system

**Full speed** If set, fan always work at full speed.

If not set, fan works automatically only when needed.

**LumenRadio** Not installed in this version.

## Description of the DMX channels:

### Resolution 8-bit

#### Ch1

Dimming intensity 1-100%

### Resolution 8-bit Extra

#### Ch1

Dimming intensity 1-100%

### Resolution 16-bit HL

#### Ch1

Dimming intensity 1-100%

#### Ch2

Low 16 bit value 1-100%

### Resolution 16-bit LH

#### Ch1

Low 16 bit value 1-100%

#### Ch2

Dimming intensity 1-100%