

SMÅKRIK

GB

EM



Design and Quality
IKEA of Sweden

Contents

Safety information	4	Cleaning and maintenance	12
Product description	6	What to do if ...	14
Control panel	6	Technical data	16
First use	7	Environmental concerns	17
Daily use	8	IKEA GUARANTEE	18

Safety Information

Before first use

This appliance is designed for domestic use only!

- Use hot pads or oven mitts to prevent burns, when touching hot parts.
- This appliance is designed to make coffee or heat drinks. Be careful to avoid being scalded by sprays of water or steam or due to improper use of the appliance.

Important safety instructions

Read carefully and keep for future reference

- Do not heat, or use flammable liquids in or near the appliance. Fumes can create a fire hazard or explosion.
- Do not leave the appliance unattended
- Do not use corrosive chemicals or vapors in this appliance. This type of appliance is specifically designed to heat water.

It is not designed for industrial or laboratory use.

- Only allow children to use the appliance under adult supervision and after adequate instructions have been given, so that the child is able to use the appliance in a safe way and understands the hazards of improper use.

This appliance is not intended for use by persons (including children) with reduced physical, sensory or mental capabilities, unless used under the supervision of a person responsible for their safety.

Accessible parts may become hot during use, young children should be kept away.

Precautions and general recommendations

Installation and connection

Prior to connecting

- Check that the voltage on the rating plate corresponds to the voltage in your home.
- Ensure that the appliance is not damaged.
- Do not operate this appliance if it has a damaged mains cord or plug, if it is not working properly, or if it has been damaged or dropped. Do not immerse the mains cord or plug in water. Keep the cord away from hot surfaces. Electrical shock, fire or other hazards may result.

After connecting

- The earthing of this appliance is compulsory. The manufacturer will accept no responsibility for injury to persons, animals or damage to objects arising from the non-observance of this requirement.

The manufacturers are not liable for any problems caused by the user's failure to observe these instructions.

Safety

- After removing the packaging, make sure the appliance is complete and undamaged. If in doubt, do not use the appliance and contact a qualified professional.
- The electrical installation and the electrical connection must be carried out by a qualified technician according to the manufacturer's instructions and in compliance with the local safety regulations.
- Packing elements (plastic bags, polystyrene etc) must not be left within reach of children as they may represent a hazard.
- Never install the appliance in environments where the temperature may reach 0°C or lower (the appliance may be damaged if the water freezes).
- Make sure the mains voltage corresponds to the voltage indicated on the appliance rating plate. Connect the appliance to an efficiently earthed socket with a minimum current rating of 10A only. The manufacturer may not be considered liable for possible incidents caused by the failure to adequately earth the mains.
- If the power socket does not match the plug on the appliance, have the socket replaced with a suitable type by a qualified professional.
- Observance of safety directives requires that a multi pole switch with a minimum contact gap of 3 mm be used for the installation.
- Do not use multiple plug adapters or extension leads.
- The power cable on this appliance must not be replaced by the user as this operation requires the use of special tools. If the cable is damaged or requires replacing, contact an authorised service centre only to avoid all risks. To learn how to operate the appliance correctly, when you use it for the first time, follow the step-by-step instructions given in the following chapters.

Product description

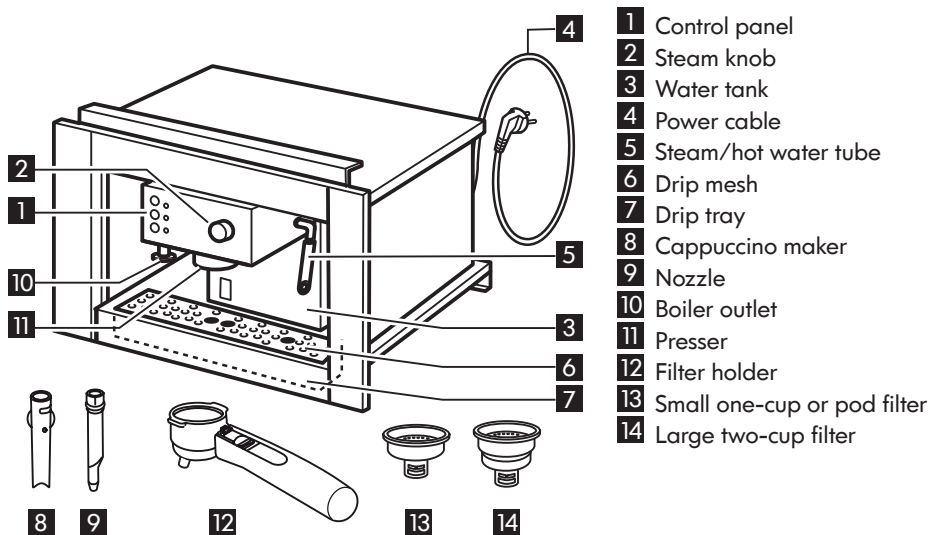

Control panel

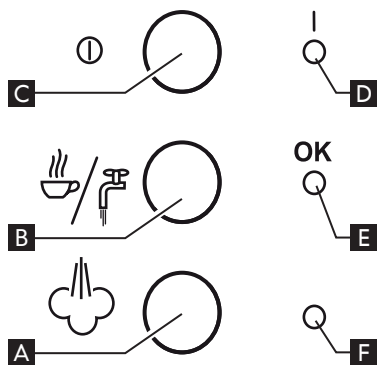

- A** Steam selector button
- B** Coffee/hot water button
- C** On/off button
- D** On light
- E** Temperature ok light (coffee or hot water)
- F** Steam indicator light

First use

Filling the water tank

Remove the watertank by pulling it out (towards the front).

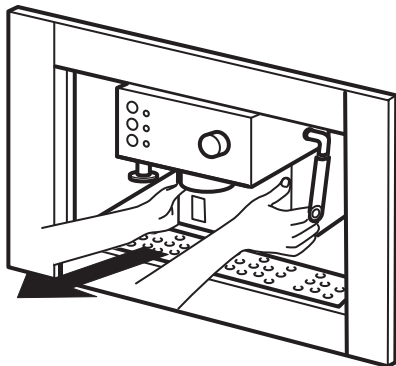

Fill the tank with fresh clean water taking care not to exceed the MAX level. Refit the tank.

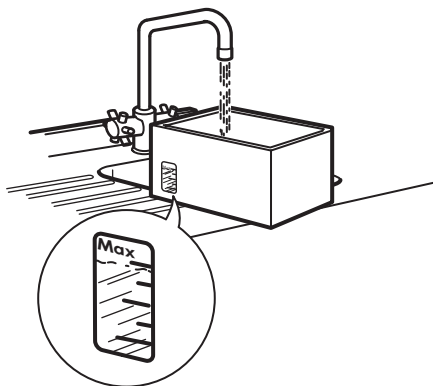

Never use the appliance without water in the tank and always remember to fill up when the level drops to a couple of centimetres from the bottom.

Preheating the coffee unit

To obtain espresso coffee at the right temperature, the coffee machine must be preheated. Press the ON/Off button at least 30 minutes before making the coffee, making sure the filter holder is attached to

the appliance without adding ground coffee (check that the steam knob is closed).

To attach the filter holder, position it under the boiler outlet with the handle towards the left, push it upwards and at the same time rotate the handle firmly towards the right.



Wait for half an hour, then make the coffee as described in the following section.

Alternatively, you can preheat more rapidly by proceeding as follows:

Turn the appliance on by pressing the ON/OFF button and attach the filter holder to the appliance without adding ground coffee.

Place a cup under the filter holder. Use the same cup as will be used to prepare the coffee in order to preheat it.

Wait for the ok indicator light to come on, then immediately press the coffee knob. Run the water off until the OK indicator light goes out, then interrupt delivery by pressing the coffee button again.

Empty the cup. Wait until the OK indicator light comes on again then repeat the same operation. (It is normal for a small and harmless puff of steam to be given off when removing the filter holder).

Daily use

How to prepare espresso coffee using the filter holder for ground coffee

After preheating the appliance as described above, place the ground coffee filter in the filter holder, making sure the projection is correctly inserted in the slot. Use the smaller filter to make one coffee or the larger filter to make two coffees.

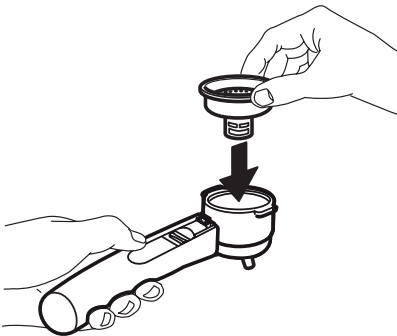

To make a single coffee only, place one level measure (about 7 g) of ground coffee in the filter. To prepare two coffees, place two loosely filled measures (about 6+6 g) of ground coffee in the filter.

Fill the filter a little at a time to prevent the ground coffee from overflowing.

IMPORTANT: for correct operation, before adding the ground coffee to the filter holder, clean the filter from residues of ground coffee from the previous infusion.

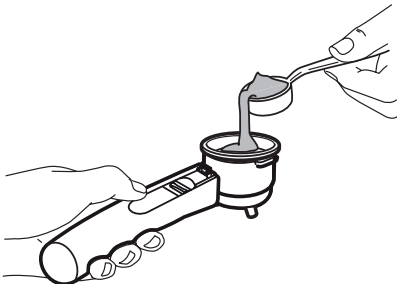

Distribute the ground coffee evenly and press lightly with the presser.

N.B.: Correct pressing of the ground coffee is essential to obtain a good espresso. If pressing is excessive, coffee delivery will be slow and the froth will be dark. If pressing is too light, coffee delivery will be too rapid and the froth will be skimpy and light coloured.

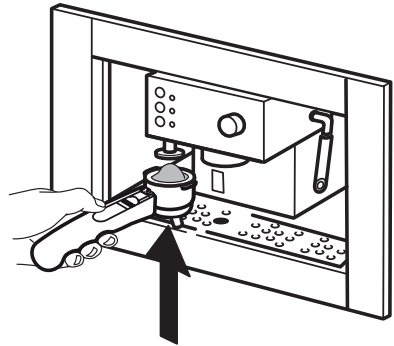

Remove any excess coffee from the rim of the filter holder and attach the filter holder to the appliance.

Rotate firmly to avoid leaks of water. Place the cup or cups under the filter holder spouts.

You are recommended to heat the cups before making the coffee by rinsing them with a little hot water.

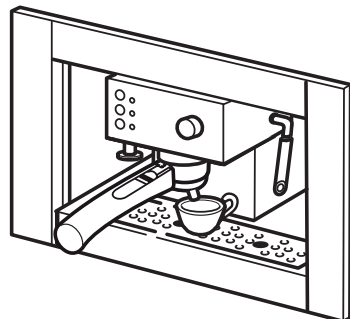

Make sure the ok light is on (if off, wait until it comes on), then press the coffee button. When the required quantity of coffee has been run off, press the same button again you should not run off coffee for more than 45 seconds at a time.

To remove the filter holder, rotate the handle from right to left.

IMPORTANT: to avoid splashes, never remove the filter holder while the appliance is delivering coffee.

To eliminate the used coffee grounds, block the filter in place using the lever incorporated in the handle and empty the coffee by turning the filter holder upside down and tapping.

To turn the coffee machine off, press the ON/OFF button.

IMPORTANT: the first time the appliance is used, all accessories and the internal circuits must be washed through by making at least five coffees without using ground coffee.

How to prepare espresso coffee using pods

Preheat the appliance as described in the section "Preheating the coffee unit", making sure the filter holder is attached. This obtains a hotter coffee.

N.B.: Use pods conforming to the ESE standard indicated on the pack with the following logo:



The ESE standard is a system accepted by leading pod producers and enables espresso coffee to be prepared simply and cleanly.

Place the small filter (1 cup or pods) in the filter holder, making sure the projection is correctly inserted in the slot.

Insert a pod, centring it as far as possible on

the filter. Always follow the instructions on the pod pack to position the pod on the filter correctly.

Attach the filter holder to the appliance.

Always rotate as far as it will go.

How to make cappuccino coffee

Prepare the espresso coffees as described in the previous paragraphs, using sufficiently large cups.

Press the steam button and wait for the OK light to come on. This indicates that the boiler has reached the ideal temperature for steam production.

In the meantime, fill a recipient with about 100 grams of milk for each cappuccino to be prepared. The milk must be at refrigerator temperature (not hot!). In choosing the size of the recipient, bear in mind that the milk doubles or triples in volume.

N.B.: you are recommended to use semiskimmed milk at refrigerator temperature.

Place the recipient containing the milk under the cappuccino maker.

Dip the cappuccino maker into the milk for about 5 mm and turn the steam knob anticlockwise, taking care not to immerse the raised line on the cappuccino maker (indicated by the arrow).

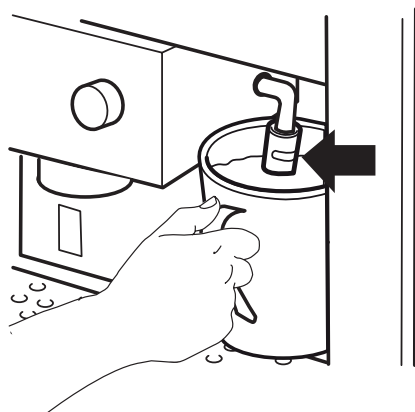

Turn the steam knob at least a half turn anticlockwise.

Steam is discharged from the cappuccino maker, giving the milk a creamy frothy appearance. To obtain a creamier froth, dip the cappuccino maker into the milk and rotate the container with slow movements from the bottom upwards.

When the required temperature is reached (60°C is ideal), interrupt steam delivery by rotating the steam knob clockwise and at the same time pressing the steam button.

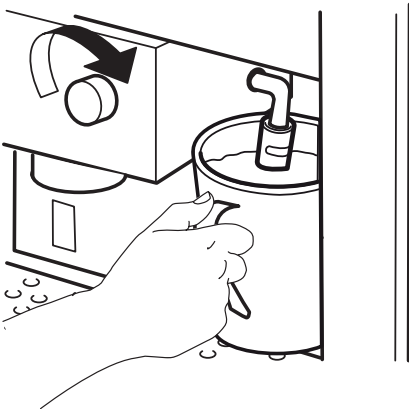

Pour the frothed milk into the cups containing the espresso coffee prepared previously. The cappuccino is ready. Sweeten to taste and, if desired, sprinkle the froth with a little cocoa powder.

N.B.: To prepare more than one cappuccino, first make all the coffees then at the end prepare the frothed milk for all the cappuccinos.

N.B.: to make coffee again after the milk has been frothed, cool down the boiler first or the coffee will be burnt. To cool it, place a container under the boiler outlet, press the steam button and run off water until the OK light goes out. Make the coffee as described in the previous paragraphs.

IMPORTANT: always clean the cappuccino maker after use. Proceed as follows:

Discharge a little steam for a few seconds by rotating the steam knob.

This empties any milk left inside the steam spout.

IMPORTANT: To ensure hygiene, you are recommended to follow this procedure each time you make cappuccino to avoid milk stagnating in the milk circuit.

With one hand, hold the cappuccino tube firmly and with the other unscrew the cappuccino maker itself by rotating clockwise and extracting downwards.

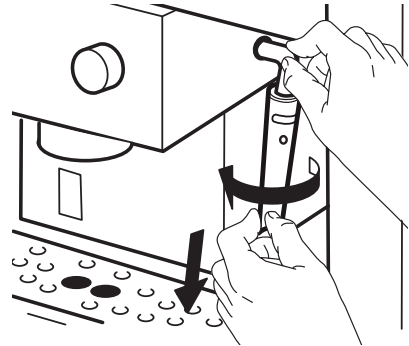

Remove the nozzle from the steam tube by pulling it downwards.

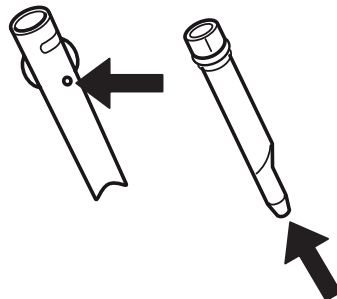

Wash the cappuccino maker and steam nozzle thoroughly with warm water.

Make sure the two holes shown in are not blocked. If necessary, clean with a pin.

Replace the steam nozzle by inserting it onto the steam tube and rotating firmly towards the top of the tube.

Replace the cappuccino maker by inserting it and rotating anticlockwise.

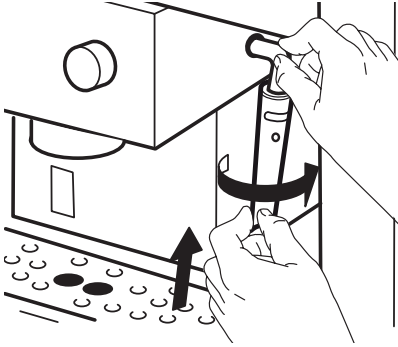

Hot water production

Turn the appliance on by pressing the ON/OFF button. Wait until the OK indicator light comes on.

Place a recipient under the cappuccino maker.

Press the coffee button and at the same time turn the steam knob anticlockwise.

Water comes out of the cappuccino maker.

To interrupt delivery of hot water, close the steam knob by rotating clockwise and press the coffee button again you should not run off hot water for more than 45 seconds at a time.

Cleaning and maintenance

Before performing any cleaning operations, leave the appliance to cool down.

Do not use solvents or abrasive cleaning products to clean the appliance. A soft, damp cloth is sufficient.

Empty and wash the drip tray and drip mesh frequently.

Clean the water tank regularly.

IMPORTANT: Never immerse the appliance in water. It is an electrical appliance.

Cleaning the filter holder

About every 200 coffees, clean the filter holder for ground coffee as follows:

- Remove the filter with frother.
- Clean the inside of the filter holder. Never wash in a dishwasher.
- Unscrew the cap of the frother by turning anticlockwise.
- Remove the frother from the container by pushing it from the cap end.
- Remove the gasket.

Rinse all components and clean the metal filter thoroughly in hot water using a brush.



Make sure the holes in the metal filter are not blocked. If necessary, clean with a pin.

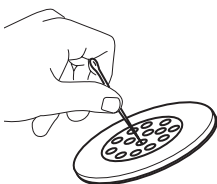

- Replace the filter and gasket on the plastic disk. Make sure to insert the pin on the plastic disk into the hole in the gasket indicated by the arrow.
- Replace the assembly in the steel filter container, making sure the pin is inserted in the hole in the support.

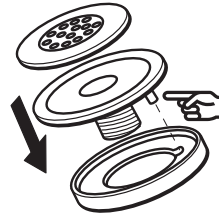

- Finally, screw on the cap by turning clockwise. Failure to clean as described above invalidates the guarantee.

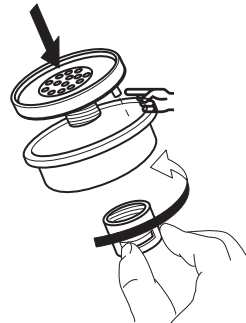

Cleaning the boiler outlet

About every 300 coffees, the espresso boiler outlet must be cleaned as follows.

Make sure the appliance is not hot and that it is unplugged from the mains.

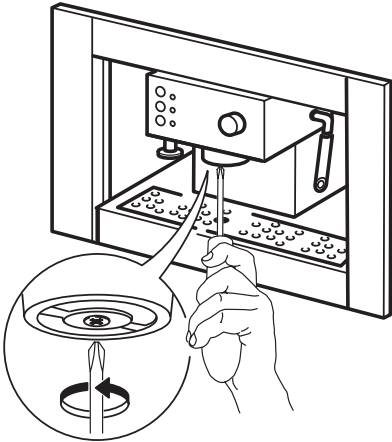

Using a screwdriver, unscrew the screw fixing the espresso boiler outlet filter
 Clean the boiler with a damp cloth
 Clean the outlet thoroughly in hot water using a brush. Make sure the holes are not blocked. If necessary, clean with a pin.
 Rinse under running water, rubbing all the time.
 Screw the boiler outlet back on. Failure to clean as described above invalidates the guarantee.

Descaling

You are recommended to descale the coffee machine about every 200 coffees or a maximum of every two months.
 You should use a commercially available product specifically for descaling espresso

coffee machines. If such a product is not available, proceed as follows.
 Fill the tank with half a litre of water.
 Dissolve 2 spoonfuls (about 30 grams) of citric acid (obtainable from chemist's or drug stores)
 Press the on/off button and wait for the OK indicator light to come on.
 Make sure the filter holder is not attached and position a recipient under the boiler outlet.
 Press the coffee button, half empty the tank by turning the steam knob every now and then to run off a little solution. Stop run-off by pressing the button again.
 Turn the appliance off.
 Leave the solution to work for 15 minutes then turn the appliance on again.
 Press the coffee button to empty the tank completely.
 To eliminate residues of solution and scale, rinse the tank well, fill with clean water (without citric acid) and replace in position.
 Press the coffee button and run the water off until the tank is completely empty, turn the steam knob every now and then to run off a little water.
 Interrupt water run-off and repeat operations 9, 10 and 11 again. Repair of damage to the coffee machine caused by scale is not covered by the guarantee unless descaling is performed regularly as described above.

What to do if ...

Problem	Possible cause	Solution
No espresso coffee is delivered	No water in the tank	Fill the tank with water
	The holes in the filter holder spouts are blocked.	Clean the spout holes.
	The espresso boiler outlet is blocked	Clean as described in the chapter "Cleaning the boiler outlet"
	The filter is blocked	Clean as described in the section "cleaning the filter holder".
	The tank is incorrectly inserted	Insert tank correctly.
The espresso coffee drips from the edges of the filter holder rather than the holes.	The filter holder is inserted incorrectly	Attach the filter holder correctly and rotate firmly as far as it will go.
	The espresso boiler gasket has lost elasticity	Have the espresso boiler gasket elasticity replaced at a service centre
	The holes in the filter holder spouts	Clean the spout holes.
The espresso coffee is cold	The espresso OK indicator light was not on when the coffee switch was pressed	Wait until the OK light comes on not on when the coffee switch was pressed.
	No preheating performed	Preheat as described in the paragraph "Preheating the appliance".
	The cups were not preheated	Preheat the cups by rinsing them in hot water or leaving them to rest for at least 20 minutes on the cup warmer tray on the lid.
The pump is excessively noisy	The water tank is empty	Fill tank
	The tank is incorrectly inserted.	Insert tank correctly.

What to do if ...

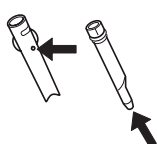
Problem	Possible cause	Solution
The coffee froth is too light (delivered from the spout too fast)	The ground coffee is not pressed down firmly enough	Press the ground coffee down more firmly.
	There is not enough ground coffee	Increase the quantity of ground coffee
	The ground coffee is too coarse	Use ground coffee for espresso coffee machines only
	Incorrect type of ground coffee.	Change the type of ground coffee.
The coffee froth is too dark (delivered from the spout too slowly)	The ground coffee is pressed down too firmly	Press the coffee down less firmly.
	There is too much ground coffee	Reduce the quantity of ground coffee
	The espresso boiler outlet is blocked	Clean as described in the chapter "Cleaning the boiler outlet"
	The filter is blocked	Clean as described in the section "cleaning the filter holder".
	The ground coffee is too fine	Use ground coffee for espresso coffee machines only
	The coffee is damp or ground too fine	Use only ground coffee for espresso coffee machines. Make sure it is not damp
	Incorrect type of ground coffee.	Change the type of ground coffee.
No milk froth is formed when making cappuccino	Milk not cold enough.	Always use semi-skimmed milk at refrigerator temperature.
	Cappuccino maker dirty.	Thoroughly clean the holes in the cappuccino maker in particular those indicated by the arrows. 

Technical data

Dimensions (mm)	Width	595
	Height	348
	Length	305
Pump pressure (bar)		15
Power (W)		1100
Water tank capacity (L)		1,5

The technical information are situated in the rating plate on the internal side of the appliance and in the energy label.

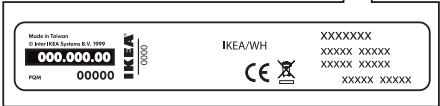
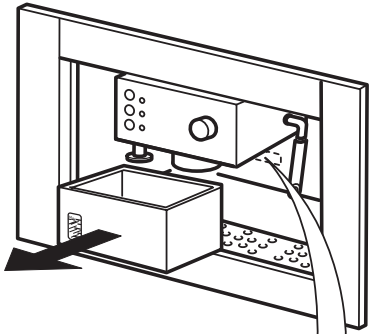

Environmental concerns

This appliance is marked according to the European directive 2002/96/EC on Waste Electrical and Electronic Equipment (WEEE). By ensuring this product is disposed of correctly, you will help prevent potential negative consequences for the environment and human health, which could otherwise be caused by inappropriate waste handling of this product.



The symbol  on the product, or on the documents accompanying the product, indicates that this appliance may not be treated as household waste. Instead it shall be handed over to the applicable collection point for the recycling of electrical and electronic equipment.

Disposal must be carried out in accordance with local environmental regulations for waste disposal.

For more detailed information about treatment, recovery and recycling of this product, please contact your local city office, your household waste disposal service or the shop where you purchased the product.

Declaration of conformity

This appliance, which is intended to come - into contact with foodstuffs, complies with European Regulation (CE) n. 1935/2004 and has been designed, manufactured and sold in conformity with the safety requirements of the “Low Voltage” directive 2006/95/ CE (which replaces 73/23/ CEE and subsequent amendments), the protection requirements of “EMC” 2004/108/CE.

Ikea guarantee

How long is the IKEA guarantee valid?

This guarantee is valid for five (5) years from the original date of purchase of your appliance at IKEA, unless the appliance is named LAGAN in which case two (2) years of guarantee apply. The original sales receipt, is required as proof of purchase. If service work is carried out under guarantee, this will not extend the guarantee period for the appliance.

Which appliances are not covered by the IKEA five (5) years guarantee?

The range of appliances named LAGAN and all appliances purchased in IKEA before 1st of August 2007.

Who will execute the service?

IKEA service provider will provide the service through its own service operations or authorized service partner network.

What does this guarantee cover?

The guarantee covers faults of the appliance, which have been caused by faulty construction or material faults from the date of purchase from IKEA. This guarantee applies to domestic use only. The exceptions are specified under the headline "What is not covered under this guarantee?" Within the guarantee period, the costs to remedy the fault e.g. repairs, parts, labour and travel will be covered, provided that the appliance is accessible for repair without special expenditure. On these conditions the EU guidelines (Nr. 99/44/EG) and the respective local regulations are applicable. Replaced parts become the property of IKEA.

What will IKEA do to correct the problem?

IKEA appointed service provider will examine the product and decide, at its sole discretion, if it is covered under this guarantee. If considered covered, IKEA Service Provider or its authorized service partner through its own service operations, will then, at its sole discretion, either repair the defective product or replace it with the same or a comparable product.

What is not covered under this guarantee?

- Normal wear and tear.
- Deliberate or negligent damage, damage caused by failure to observe operating instructions, incorrect installation or by connection to the wrong voltage, damage caused by chemical or electrochemical reaction, rust, corrosion or water damage including but not limited to damage caused by excessive lime in the water supply, damage caused by abnormal environmental conditions.
- Consumable parts including batteries and lamps.
- Non-functional and decorative parts which do not affect normal use of the appliance, including any scratches and possible color differences.
- Accidental damage caused by foreign objects or substances and cleaning or unblocking of filters, drainage systems or soap drawers.
- Damage to the following parts: ceramic glass, accessories, crockery and cutlery baskets, feed and drainage pipes, seals, lamps and lamp covers, screens, knobs, casings and parts of casings. Unless such damages can be proved to have been caused by production faults.
- Cases where no fault could be found during a technician's visit.
- Repairs not carried out by our appointed service providers and/or an authorized service contractual partner or where non-original parts have been used.
- Repairs caused by installation which is faulty or not according to specification.
- The use of the appliance in a non-domestic environment i.e. professional use.
- Transportation damages. If a customer transports the product to his home or another address, IKEA is not liable for any damage that may occur during transport. However, if IKEA delivers the product to the customer's delivery address, then damage to the product that occurs during this delivery will be covered by IKEA.

- Cost for carrying out the initial installation of the IKEA appliance.

However, if an IKEA appointed Service Provider or its authorized service partner repairs or replaces the appliance under the terms of this guarantee, the appointed Service Provider or its authorized service partner will reinstall the repaired appliance or install the replacement, if necessary. This does not apply within Ireland, customer should contact the local IKEA dedicated after sales line or the appointed Service Provider for further information.

These restrictions do not apply to fault-free work carried out by a qualified specialist using our original parts in order to adapt the appliance to the technical safety specifications of another EU country.

How country law applies

The IKEA guarantee gives you specific legal rights, which cover or exceed all the local legal demands.

However these conditions do not limit in any way consumer rights described in the local legislation.

Area of validity

For appliances which are purchased in one EU country and taken to another EU country, the services will be provided in the framework of the guarantee conditions normal in the new country.

An obligation to carry out services in the framework of the guarantee exists only if the appliance complies and is installed in accordance with:

- the technical specifications of the country in which the guarantee claim is made;
- the Assembly Instructions and User Manual Safety Information.

The dedicated AFTER SALES for IKEA appliances

Please don't hesitate to contact IKEA appointed After Sales Service Provider to:

- make a service request under this guarantee;

- ask for clarifications on installation of the IKEA appliance in the dedicated IKEA kitchen furniture;
- ask for clarification on functions of IKEA appliances.

To ensure that we provide you with the best assistance, please read carefully the Assembly Instructions and/or the User Manual before contacting us.

How to reach us if you need our service



Please refer to the last page of this manual for the full list of IKEA appointed After Sales Service Provider and relative national phone numbers.

- i** In order to provide you a quicker service, we recommend to use the specific phone numbers listed on this manual. Always refer to the numbers listed in the booklet of the specific appliance you need an assistance for. Please also always refer to the IKEA article number (8 digit code) and 12 digit service number placed on the rating plate of your appliance.

- i** **SAVE THE SALES RECEIPT!**
It is your proof of purchase and required for the guarantee to apply. The sales receipt also reports the IKEA name and article number (8 digit code) for each of the appliances you have purchased.

Do you need extra help?

For any additional questions not related to After Sales of your appliances please contact your nearest IKEA store call centre. We recommend you read the appliance documentation carefully before contacting us.



BELGIË - BELGIQUE - BELGIEN

Telefoon/Numéro de téléphone/Telefon-Nummer: 026200311
Tarief/Tarif/Tarif: Lokaal tarief/Prix d'un appel local/Ortstarif
Openingstijd: Maandag - Vrijdag 8.00 - 20.00
Heures d'ouverture: Lundi - Vendredi 8.00 - 20.00
Öffnungszeiten: Montag - Freitag 8.00 - 20.00

ČESKÁ REPUBLIKA

Telefonní číslo: 225376400
Sazba: Místní sazba
Pracovní doba: Pondělí - Pátek 8.00 - 20.00

DANMARK

Telefonnummer: 70150909
Takst: Lokal takst
Åbningstid: Mandag - fredag 9.00 - 21.00
Lørdag 9.00 - 18.00
(Åbent udvalgte søndage, se IKEA.dk)

DEUTSCHLAND

Telefon-Nummer: 06929993602
Tarif: Ortstarif
Öffnungszeiten: Montag - Freitag 8.00 - 20.00

ΕΛΛΑΔΑ

Τηλεφωνικός αριθμός: 2109696497
Χρέωση: Τοπική χρέωση
Ώρες λειτουργίας: Δευτέρα - Παρασκευή 8.00 - 20.00

ESPAÑA

Teléfono: 913754126
Tarifa: Tarifa local
Horario: Lunes - Viernes 8.00 - 20.00
(España Continental)

FRANCE

Numéro de téléphone: 0170480513
Tarif: Prix d'un appel local
Heures d'ouverture: Lundi - Vendredi 9.00 - 21.00

ÍSLAND

Símanúmer: 5852409
Kostnaður við símtal: Almennt mínútuverð
Opnunartími: Mánudaga - Föstudaga 9.00 - 17.00

ITALIA

Telefono: 0238591334
Tariffa: Tariffa locale
Orari d'apertura: Lunedì - Venerdì 8.00 - 20.00

MAGYARORSZÁG

Telefon szám: (06-1)-3285308
Tarifa: Helyi tarifa
Nyitvatartási idő: Héftőlő Péntekig 8.00 - 20.00

NEDERLAND

Telefoon: 09002354532
en/of 0900 BEL IKEA
Lokaal tarief € 0,10 p/min
Tarief:
Openingstijd: Maandag t/m - Vrijdag 9.00 - 21.00
Zaterdag 9.00 - 20.00
Zondag 9.00 - 18.00

NORGE

Telefon nummer: 23500112
Takst: Lokal takst
Åpningstider: Mandag - fredag 8.00 - 20.00
ÖSTERREICH
Telefon-Nummer: 013602771461
Tarif: Ortstarif
Öffnungszeiten: Montag - Freitag 8.00 - 20.00

POLSKA

Numer telefonu: 225844203
Stawka: Koszt połączenia według taryfy operatora
Godziny otwarcia: Poniedziałek - Piątek 8.00-20.00

PORTUGAL

Telefone: 213164011
Tarifa: Tarifa local
Horário: Segunda - Sexta 9.00 - 21.00

REPUBLIC OF IRELAND

Phone number: 016590276
Rate: Local rate
Opening hours: Monday - Friday 8.00 - 20.00

РОССИЯ

Телефонный номер: 84957059426
Стоимость звонка: Местная стоимость звонка
Время работы: Понедельник - Пятница 8.00 - 20.00
(Московское время)

SCHWEIZ - SUISSE - SVIZZERA

Telefon-Nummer/Numéro de téléphone/Telefono: 0225675345
Tarif/Tarif/Tariffa: Ortstarif/Prix d'un appel local/Tariffa locale
Öffnungszeiten: Montag - Freitag 8.00 - 20.00
Heures d'ouverture: Lundi - Vendredi 8.00 - 20.00
Orario d'apertura: Lunedì - Venerdì 8.00 - 20.00

SLOVENSKO

Telefónne číslo: (02) 50102658
Cena za hovor: Cena za miestny hovor
Pracovná doba: Pondelok až piatok 8.00 - 20.00

SUOMI

Puhelinnumero: 0981710374
Hinta: Yksikköhinta
Aukioloaika: Maanantaista perjantaihin 8.00 - 20.00

SVERIGE

Telefon nummer: 0775-700 500
Taxa: Lokal samtal
Öppet tider: Måndag - Fredag 8.30 - 20.00
Lördag - Söndag 9.30 - 18.00

UNITED KINGDOM

Phone number: 02076601517
Rate: Local rate
Opening hours: Monday - Friday 9.00 - 21.00

