

ZCM 1000



operation manual



Unit 7, Forest Row Business Park
Station Road
Forest Row
East Sussex
RH18 5DW
United Kingdom

Phone: +44 (0)1342 822655
Fax: +44 (0)1342 824155

Email: info@start-uk.co.uk

Web: www.start-uk.co.uk



CONTENTS

Read this user's manual before use to ensure proper operation. Keep the manual on hand for reference in case there is a problem.

Warranty Information	2
Safety Precautions.	3
Features	3
Description of Parts and Functions	4
Operation	5-6
Additional Functions.	6
Precautions.	7
Troubleshooting	7
Exploded Views/ Parts Breakdown.	8-13
Preventative Maintenance	14
Specifications	14

WARRANTY POLICY

Start-UK warrants all parts on ZCM series tape dispensers against defects in design, materials and workmanship for a period of 1 year. Parts excluded from this are: cutting blades, silicone rollers and cutter liners. These parts are considered "wear parts". Warranty does not cover transportation costs.

Our sole obligation under this warranty is limited to repair, replacement or credit of the purchase price, at our discretion, for the machines listed above, which do not perform properly the function for which they were designed.

Warranty repair is contingent upon our examination and determination that alleged defects have not been caused by misuse, abuse, improper installation or application, repair, alteration, accident or neglect in use, storage, transportation or handling.

The above warranty and remedy constitutes Start-UK's sole liability hereunder and are in lieu and exclusive of all other warranties and remedies expressed, implied or statutory, including but not limited to, those of merchantability and fitness for a particular purpose.

NOTES

PREVENTATIVE MAINTENANCE

- WEEKLY -** Remove cutting head and clean. Look for missing roller rings and replace as needed.
- MONTHLY -** Remove blade spring and blades to inspect cutter liners. Place one drop of silicone oil on each liner, or replace if worn. Inspect feed roller and blades for tape fragments or adhesive build-up. Clean with alcohol.

SPECIFICATIONS

Model	ZCM1000
Display	3-Digit LED
Applicable Tape Width	7 - 50mm
Core Diameter	3" (optional 1", 1.25", 1.5")
Tape Length Set Limit	20 - 999mm
Memory Settings	1
Drive	DC Motor for tape feed and cut
Power Consumption	18w
Power (AC)	117v 50/60Hz or 220v 50/60Hz
Ambient Temperature	5° - 40°C
Ambient Humidity	≤ 80% RH
Dimensions	14 W x 22 D x 15 H cm
Weight	2.4kg

SAFETY PRECAUTIONS

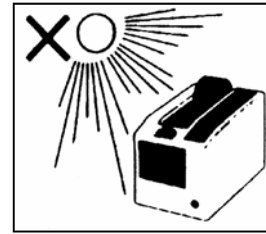

Do not leave the tape dispenser in direct sunlight.

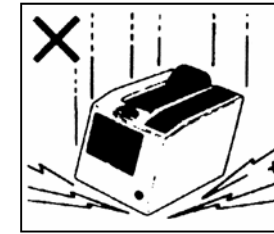

Do not drop the tape dispenser or subject it to heavy shocks.

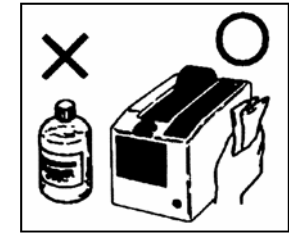

Do not use volatile liquids (thinner, benzene etc.) to clean the dispenser. Wipe with dry cloth only.

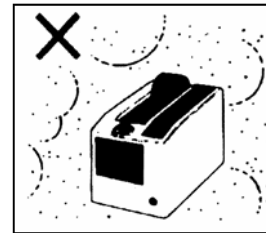

Do not use the tape dispenser in humid or dusty conditions.

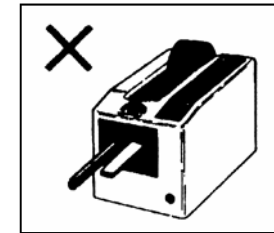

Do not insert bars or plates into the tape outlet - this will damage the blade.

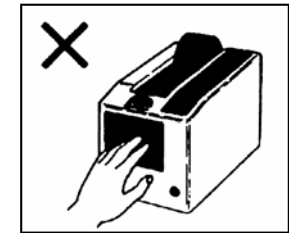

Do not insert your fingers into the tape outlet.

FEATURES

- If using automatic feed, when one piece of tape is removed, the unit will automatically feed and cut the next piece at the preset length.
- The tape length is easily seen on the LED display, and operation is simple - press the *CM* key or *MM* key to set the length.
- If a piece of long tape is needed, press *FEED* key for desired length, then press *CUT* key to cut.
- The blade unit can be removed and replaced easily.

DESCRIPTION OF PARTS AND FUNCTIONS

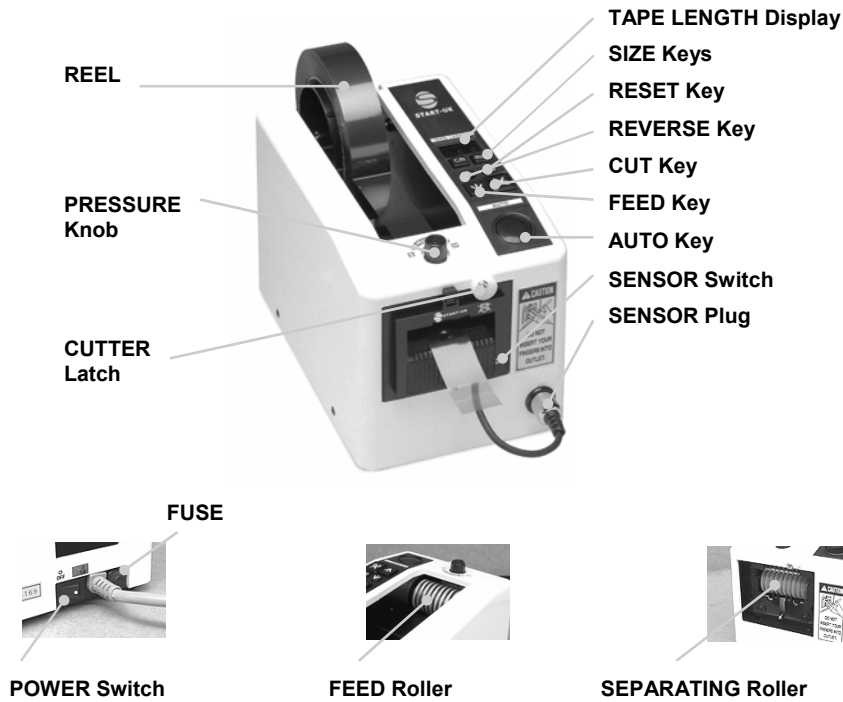

 **POWER Switch**

TAPE LENGTH **TAPE LENGTH Display**
 The last digit = mm
 The first two = cm

 **SIZE Keys**
 Press *mm* key to set length in mm. Press *cm* to set length in cm.

AUTO **AUTO Key**
 Feeds tape to the pre-set length and cuts automatically.

 **REVERSE Key**
 Feed Roller reverses.

 **RESET Key**
 Length display is reset to 20mm.

 **FEED Key**
 Tape dispenses as long as key is pressed.

 **CUT Key**
 Press to cut tape.

 **PRESSURE Knob**
 Adjusts top roller to change pressure on tape.

EXPLODED VIEWS / PARTS BREAKDOWN

BOTTOM PLATE WIRING

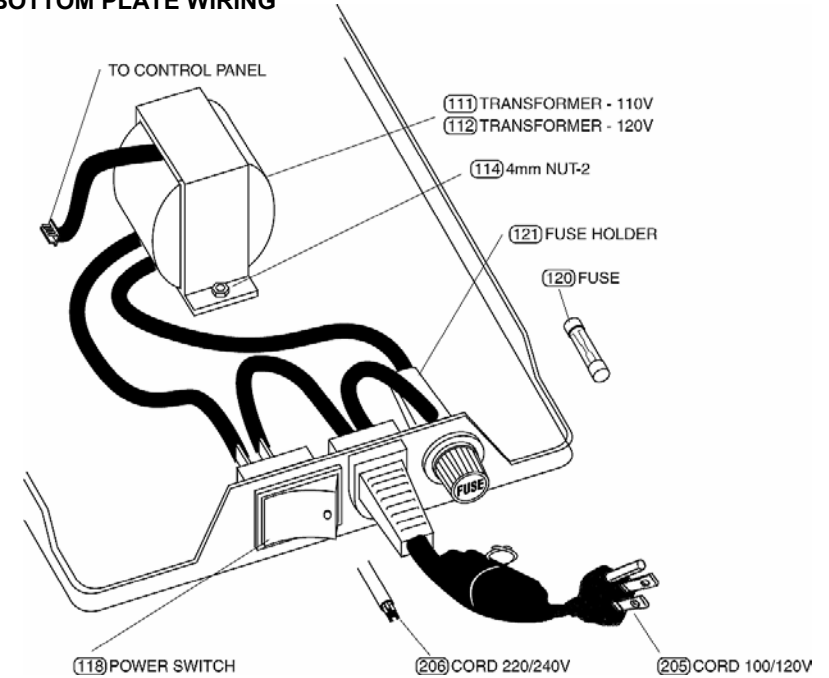

CONTROL PANEL CONNECTIONS

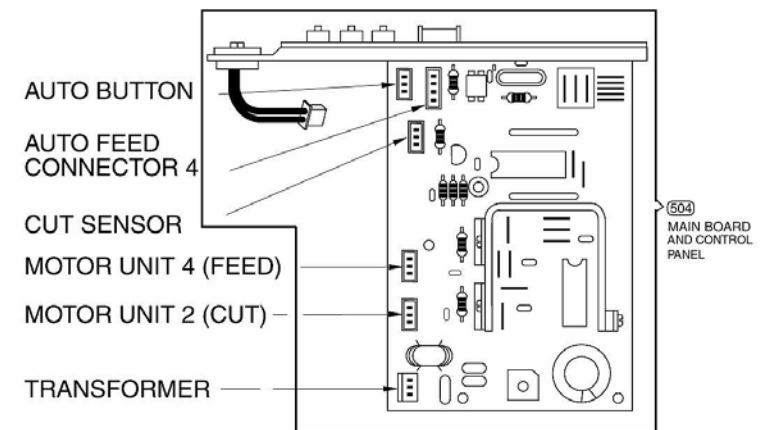

EXPLODED VIEWS / PARTS BREAKDOWN

REMOVE BODY COVER AND BOTTOM PLATE

TO REMOVE BODY COVER:

1. REMOVE AUTO FEED CUTTER UNIT (550)
2. REMOVE FOUR SCREWS (233)
3. REMOVE PRESSURE KNOB (106)
4. LIFT COVER FROM UNIT

TO REMOVE BOTTOM PLATE:

1. REMOVE GROUND SCREW FROM BASE (234)
2. REMOVE FOUR SCREWS FROM BOTTOM OF UNIT (228)
3. REMOVE TWO SCREWS FROM BOTTOM OF UNIT (113)
4. REMOVE TWO SCREWS FROM FRONT OF BASE (228)

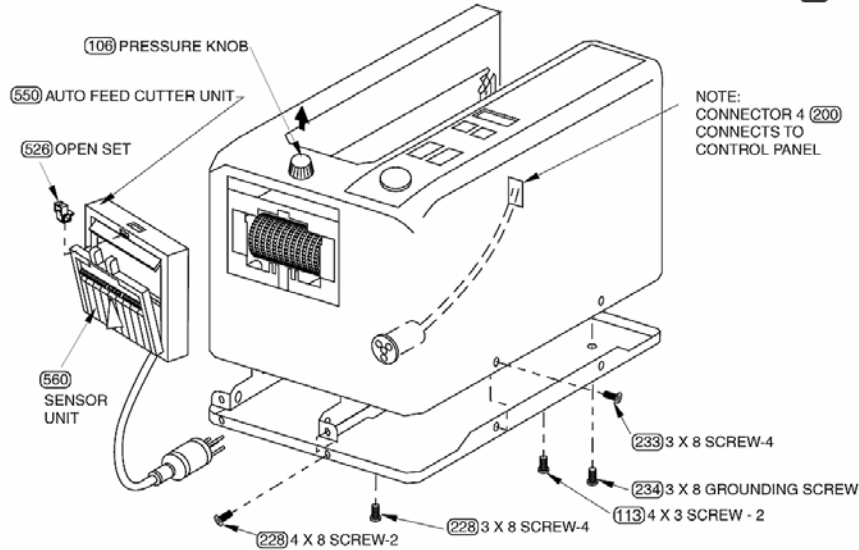

CHANGE THE SEPERATING ROLLER

1. REMOVE TWO SCREWS (233)
2. GRIP RUBBER RINGS (136)
3. LIFT ROLLER UNIT FROM TAPE UNIT

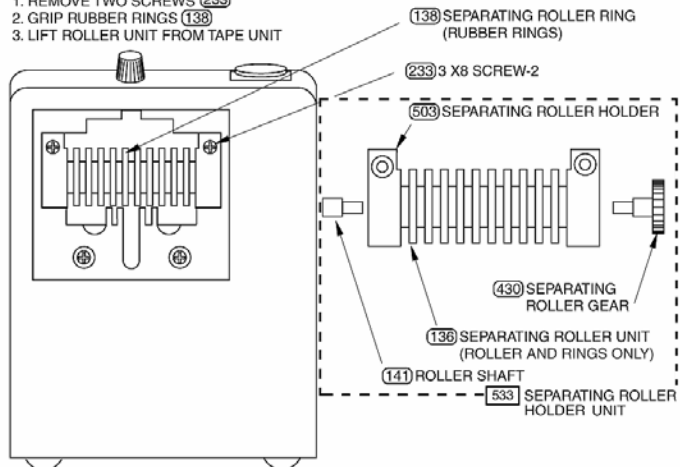

OPERATION

Using Automatic Feed:

1. Plug in and turn the dispenser on.
2. Set tape on the centre of reel and stick the end of the tape onto the metal feed roller. Press FEED key until tape feeds through cutting unit. If the tape will not feed through the cutter, fold corners of the tape to form a triangle shape and re-feed (Fig.A).
3. Press CUT key to cut the tape.
4. Set the tape length.
Press MM key to set length (0 - 9mm).
Press CM key to set length (20 - 999cm).
5. Set PRESSURE knob.
If tape curls or slips, increase pressure.
If tape creases, decrease pressure.
6. Turn sensor switch ON. Tape will be fed to set length and cut. When the piece of tape is removed from machine, another piece will be fed and cut.
(Turn sensor switch OFF when not in use.)



Fig.A

**FOLD
TAPE
BACK**

Using AUTO key

With sensor switched OFF, press AUTO key. Tape will be fed to set length and cut.

Using FEED key

Press FEED key until desired tape length has been fed. (This key overrides the preset length). Press CUT to cut the tape.

Changing tape

Press the REVERSE key. The feed roller will rewind the tape away from the cutter area. Remove the tape manually.

In case of tape jam

Press REVERSE key to remove tape from cutter area. Rewind and replace tape on roller. Also, remove cutter unit to verify that no tape is stuck on roller or cutter.

CAUTION - Do not place fingers in cutter unit whilst machine is ON.
(See section *Replace Cutter Unit* on page 6.)

OPERATION (Continued)

To replace Cutter Unit

Turn off sensor and power before removing cutter unit. Pull sensor plug out, then pull centre unit forward while pressing the knob on the top of the unit.

To replace the blades, remove the two screws inside head. Blade can then be lifted out and replaced. Before remounting the cutter unit to the frame, the lower blade must be bottomed out. If it is not completely down, use a screwdriver to lower.

Remount the cutter unit by aligning the bottom of the unit then pushing in the top.

Replacing the Separating Roller

Turn off the sensor and power before removing the separating roller. Remove the cutter unit, then remove the two screws.

To remove the roller holder, grip the rubber ring in the centre of the roller and pull. Then remove the screws on the left and right of the roller holder and pull off shaft and gear.

ADDITIONAL FUNCTIONS

Error Indication

If something is wrong in the operation of the machine, the Tape Length Display will show "ERR" (Error).

Releasing "ERR" (Error)

There are two ways of releasing the "ERR" message:

- Press the RESET key, then go back to the original minimum length of 20mm.
- Press MM key twice, then go back to the length which was shown before the "ERR" message.

Operation during the "ERR" message

Only the REVERSE key can be used when the "ERR" message is shown. If the tape is jammed, press the REVERSE key and remove the jammed tape. Then reset as above.

NEW Memory Function

There is a new length memory function on this unit.

When the power is switched ON, the last length that was used is memorized and comes up automatically. For example, you are using the machine with a setting of 100mm and then you turn OFF the power. The next day, when you turn ON the unit, you will see 100mm instead of the default 20mm, which shows on older units.

EXPLODED VIEWS / PARTS BREAKDOWN

FEED STRUCTURE

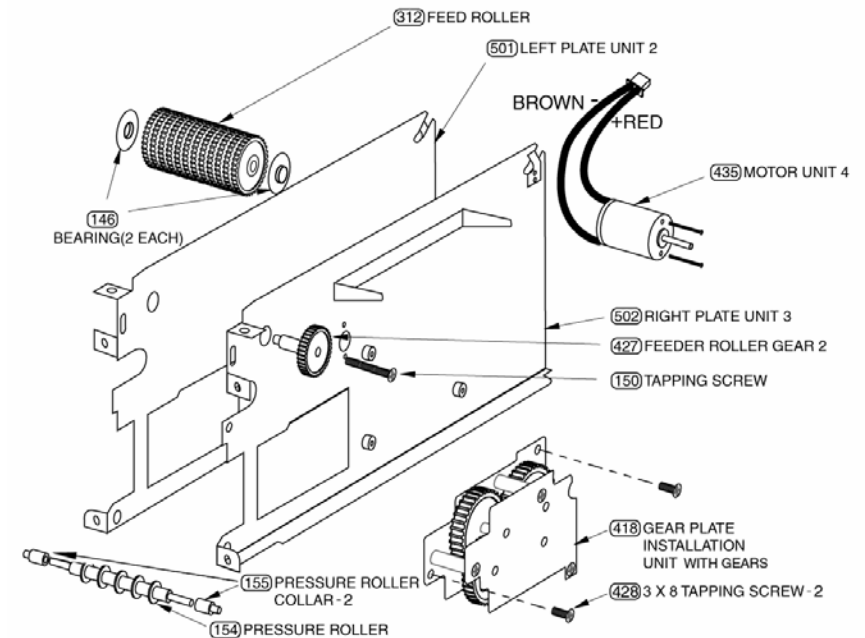

REMOVING SENSOR UNIT

1. OPEN SENSOR UNIT FROM BLADE HOLDER UNIT
2. PRESS SENSOR UNIT FORWARD (UP) TO REMOVE FROM CUTTER HOLDER UNIT

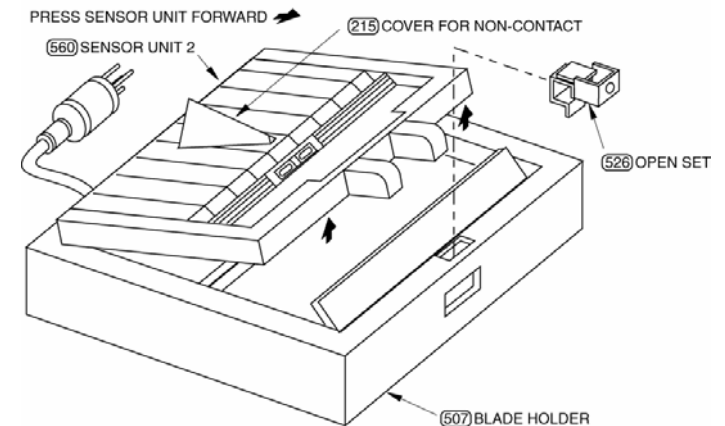

EXPLODED VIEWS / PARTS BREAKDOWN

FRONT HOLDER STRUCTURE

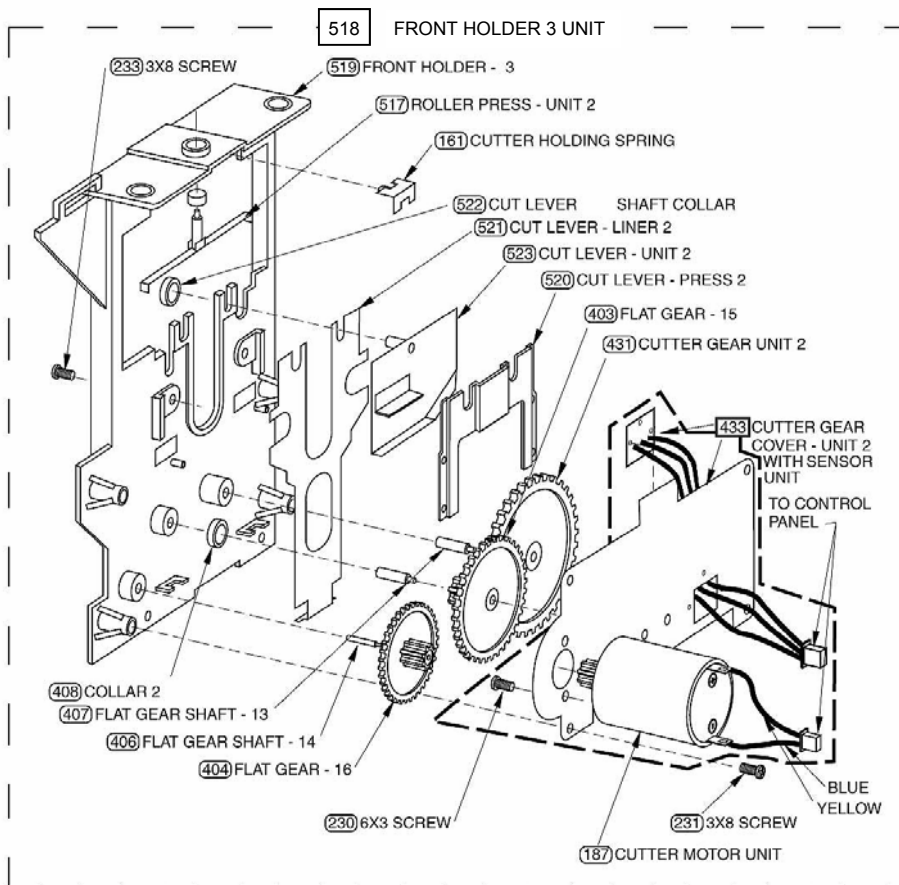

Numbers in balloons represent the last three digits for replacement part number.

When ordering, ask for ZCM1000 P_ _ _ (three digits).

PRECAUTIONS

- Set the tape properly as described in these instructions. If the end of the tape is folded when the tape is set, the tape may jam at the tape outlet.
- This machine will cut virtually any type of pressure sensitive tape (cloth, aluminium, filament etc.). If the tape is thicker than 0.05", test for compatibility.
- Because of tape differences (elasticity, tackiness etc.), some tapes may not cut at the set length. If this occurs, adjust the set length accordingly.
- If tape sticks to the blade, remove the cutter unit, clean with alcohol and apply silicone oil (supplied) to the blade.
- To reduce jamming, remove tape from machine when not in use.

TROUBLESHOOTING

When problems occur, carry out the following procedures. If the tape dispenser does not operate normally after following the troubleshooting procedures, contact your supplier.

1. If the motor does not drive:
 - a) Check that the power cord is plugged in.
 - b) Check that the power switch is turned on.
2. If the tape does not cut:

Make sure the cutter unit is set properly, and clean.
3. If the LED does not light:
 - a) Check that the power cord is plugged in.
 - b) Check that the power switch is turned on.
4. If the tape does not feed:
 - a) Check if the tape is jammed at the roller or in the cutter unit.
 - b) Check that the tape is set properly.
5. If the auto feed does not work:
 - a) Check that the sensor plug is plugged in.
 - b) Check that the sensor switch of cutter unit is on.
 - c) Check that the sensor part of the cutter unit is not stained.
6. If the tape feeding does not stop:

Check that the tape is centred. If not, set the tape at the centre of the feed roller so that the sensor will see the tape.

EXPLODED VIEWS / PARTS BREAKDOWN

NOTE: Parts grouped within broken lines can be purchased as complete assemblies

