

www.phonak.com

029-0094-02/V2.00 /2009-09/A+W Printed in Switzerland © Phonak AG All rights reserved

iSense

iSense Classic

User Guide



CE
0459

PHONAK

life is on

Contents

Welcome	4
Online resources	5
<hr/>	
iSense Classic package	6
<hr/>	
Important iSense Classic numbers	7
<hr/>	
Instrument description	8
Main parts	8
iSense Classic status indicator	10
<hr/>	
Charging iSense Classic	16
<hr/>	
Getting started	18
Fitting iSense Classic around the neck	18
Fitting the flex around the ear	19
Switching ON	21
Controlling the volume	22
<hr/>	
Replacing the ear wax filter	23
<hr/>	

Important information	25
Service and warranty	26
Declaration of conformity	27
Phonak distributors worldwide	28

Welcome

iSense Classic is a trendy MP3-like FM receiver specifically developed for people who have difficulty understanding speech in complex listening situations.

Please read this manual carefully to make sure you benefit from all of iSense Classic's features.

For detailed information on using your FM transmitter, which is part of your overall FM solution, please refer to the appropriate FM transmitter User Guide (also see www.phonak.com).

iSense is a quality product developed by the Swiss company Phonak, the world leader in FM technology, innovation and reliability. With proper care and usage, your iSense will support your hearing and communication needs for many years.

Phonak – life is on!

Further resources:

To learn more about iSense and Phonak's other FM products, we recommend visiting the following websites:

- **www.eSchoolDesk.com**

This website was designed first and foremost to support teachers, however it is also useful for parents and FM users. It includes numerous short movies that explain how various product features and functions work. There are also special sections on FM system care, maintenance and trouble shooting to help users live comfortably with their devices.

- **www.phonak.com**

This is the Phonak website. Go to the Consumer/Product section and then click FM Systems to find information on our full range of transmitters and receivers.

- **www.iSense.phonak.com**

This is the iSense homepage. Here you'll find information about iSense products, detailed user testimonials and much more.

- **www.FMeLibrary.com**

This is an online scientific library all about FM systems. Here you can find FM-related papers and reports from all over the world.

iSense Classic package

iSense Classic is delivered in a complete package that includes ear wax filters, retention pieces and a lanyard (neck cord).

iSense Classic



Replacement ear wax filters



Important iSense Classic numbers

Operating time:

- Operating time in active mode until the battery is empty and needs recharging:
 - ▷ 10 hours
- See page 16 to learn about charging the iSense Classic.

Operating range:

- Inside a building:
 - ▷ approx. 50 feet (15 meters)
- Outside
 - ▷ approx. 130–170 feet (40–50 meters)
- 🚫 High powered electronic equipment, large electronic installations and metallic structures may impair and significantly reduce the iSense's operating range.

Instrument description

Main parts

- ① Flex
- ② Wax filter
- ③ Retention

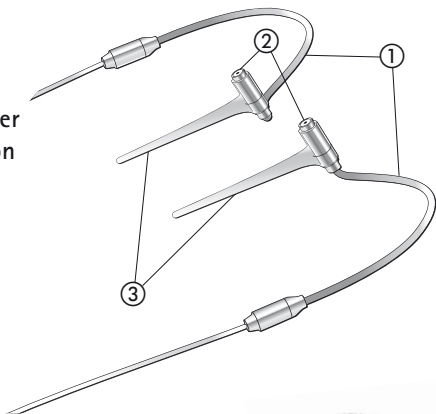

- ④ Y-cable available in 2 sizes
- ⑤ Lanyard adapter
- ⑥ Lanyard

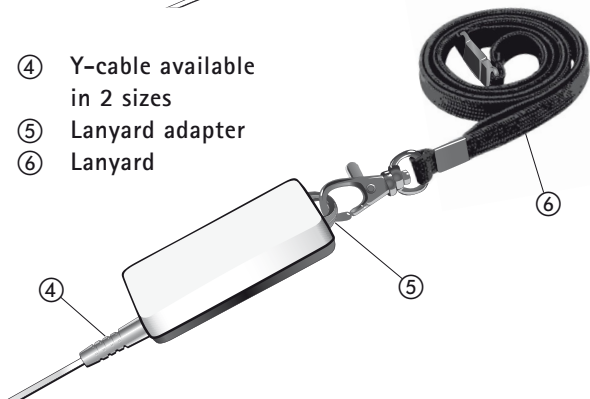

- ⑦ Status indicator
- ⑧ Volume toggle switch
- ⑨ ON/OFF switch

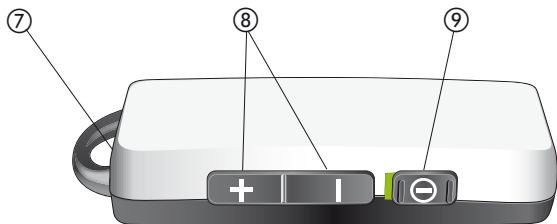

Instrument description

iSense Classic status indicator

Green indicator



Orange indicator



- ① Battery almost empty
- ② Battery completely exhausted
- ③ Charging in process
- ④ Charging completed
- ⑤ Volume control minimum/maximum position
- ⑥ Volume control middle position



Instrument description

Light flashes

General indication



Switching iSense Classic ON



The green light is visible for 3 seconds



Battery status indication

a)  60 seconds 
3 orange flashes (and 3 beeps),
repeated every 60 seconds

b) 
10 orange flashes (and 10 beeps)



Meaning	User action
iSense Classic has been switched on and is ready for use.	Switch the transmitter ON (e. g. inspiro).
Battery is almost empty and needs to be charged within one hour.	Charge iSense Classic and the transmitter (e. g. inspiro) as soon as possible. *
Battery is completely exhausted. iSense Classic can no longer be used without being charged first. iSense Classic is switched OFF automatically after ten flashes.	Charge iSense Classic and the transmitter (e.g. inspiro) immediately. *

* To simplify handling, it is recommended to always charge iSense Classic and the transmitter at the same time.

Instrument description

iSense Classic status indicator

Charging indication

- c)  Green double flashes every 5 seconds



- d)  The green light is constantly visible

Volume indication

- e)  One orange flash (and a double beep)

- f)  One green flash (and a double beep)

Meaning	User action
iSense Classic is connected to the charger and is being charged.	Charging of a completely exhausted battery takes around two hours. The battery will be about 80% charged within one hour.
The iSense Classic battery is fully charged.	Unplug the charger. The green light disappears and iSense Classic is ready for use again.

The volume control toggle is in the maximum or the minimum position.

The volume control is in the middle position.

Charging the iSense Classic

- a) Fully charge the battery of the iSense Classic and the transmitter before using the system for the first time. An empty iSense Classic battery is
- 80 % charged after one hour
 - 100 % charged after two hours

Plug the charging unit into an easily accessible power socket.

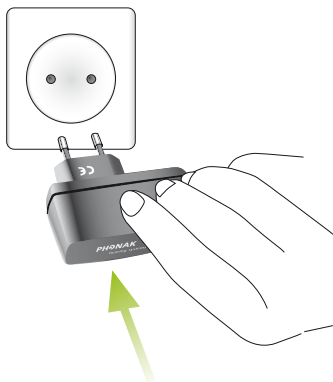

 Use original Phonak chargers only

- b) Plug the connector from the charger into the iSense Classic charging socket

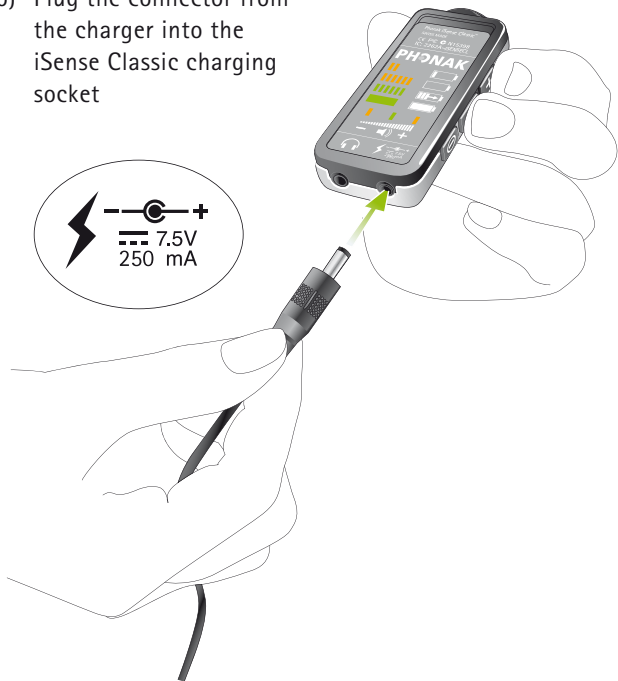

-  iSense Classic should be charged in an ambient temperature of 0°C – 40°C (32°F – 104°F) only. iSense Classic cannot be used if the charger is plugged in!

Getting started

Fitting the iSense Classic around the neck



Wear the
iSense Classic
around the
neck as shown.

Fitting the flex around the ear

Make sure that the two flexes are bent well and the retention pieces attached.

Flex for the
left ear

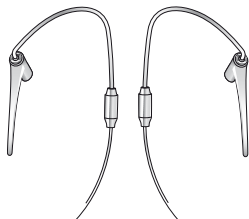

Flex for the
right ear

 **Never use iSense Classic without retention pieces!**

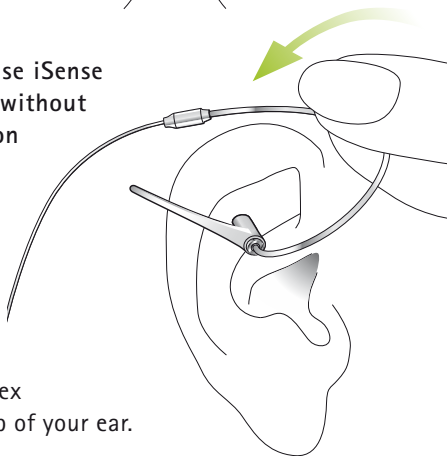

Place the flex
over the top of your ear.

Getting started

c)

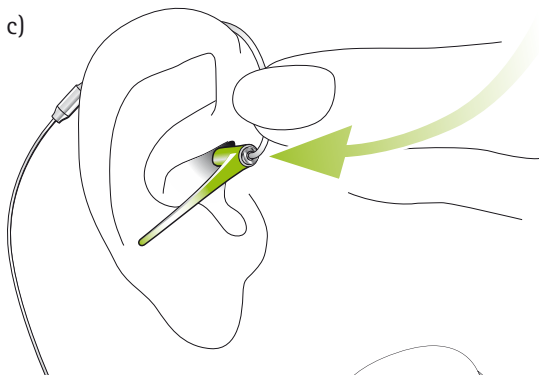

Ensure that the receiver is placed well in front of the ear canal. Use the transparent retention to fix the receiver in the concha (the inner part of the visible ear).

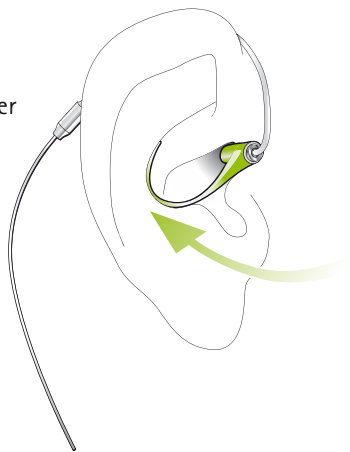

Switching ON

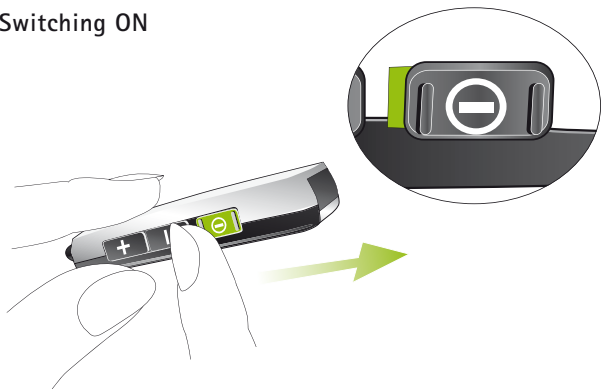

Shift the ON/OFF slider to the right.

After switching ON the iSense Classic, switch ON your FM transmitter (e. g. inspiro)

Getting started

Controlling the volume

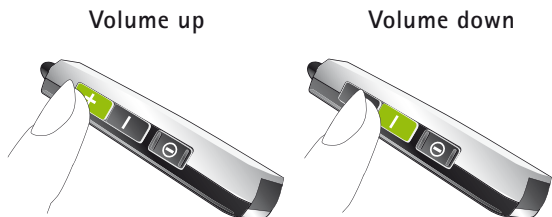

Short button press: The volume will be increased / decreased by one small step only.

Long button press: The volume will be increased / decreased continuously until you stop pressing the button.

Once the preferred volume has been chosen, iSense Classic automatically stores this setting, even after it has been switched OFF.

If the wirelessly transmitted signal is not strong enough, increase the volume setting on iSense Classic.

Replacing the ear wax filter

The iSense ear wax filter is a replaceable part that protects the receiver from the build up of wax. From time to time the wax filter should be replaced. For the best results, change the ear wax filter when recommended by your hearing care professional.

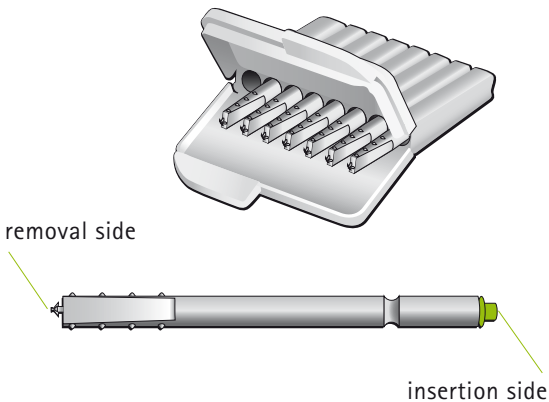

Use only the supplied handling tools when changing the ear wax filter.

These handling tools are designed for single use only; please dispose of them after use.

Replacing the ear wax filter



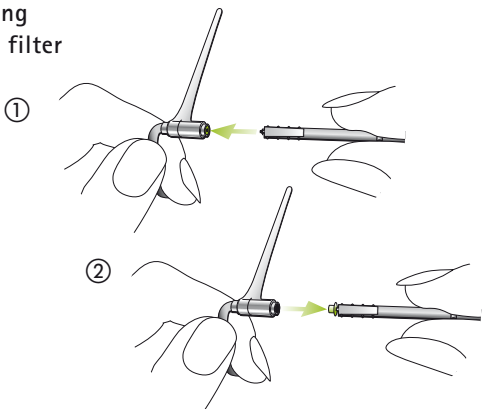

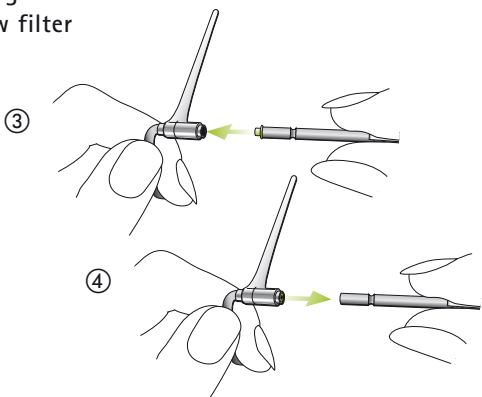

Removing the old filter



Inserting the new filter



Important information

-  Do not use your FM System in a place where it is prohibited to use electronic devices, e. g. on airplanes or in hospitals. If in doubt, please ask the person in charge.
-  Persons with pacemakers or other medical devices should ALWAYS consult their physician, the manufacturer of their pacemaker, or other medical device BEFORE using FM System. The use of FM System with a pacemaker or other medical devices should ALWAYS be in accordance with the safety recommendations of the physician responsible for your pacemaker or the pacemaker manufacturer.
-  Please note that radio signals might also be picked up and overheard by other receivers.
-  Do not use water or other liquids to clean the iSense Classic.
-  Only use original Phonak accessories.
-  Your iSense Classic may only be repaired by an authorized service center.
-  Never use iSense Classic without its retention pieces.

Service and warranty

Phonak provides a manufacturer's limited warranty for your iSense Classic. This covers all manufacturing and material defects. Problems with iSense Classic arising from improper handling or care and repairs made by an unauthorized party are not covered by the warranty. Please ask at the point of sale for full details of this warranty. The salesperson will note the serial number of your iSense Classic below. It will be needed in the event of a warranty repair.

iSense Classic serial number:

Date of purchase:

Declaration of conformity

Hereby, Phonak Communications AG, declares that the iSense Classic is in compliance with the essential requirements and other relevant provisions of Directive 1999/5/EC and Directive 93/42/EEC. To obtain a copy of the Declaration of conformity, please contact the local Phonak AG representative whose address can be taken from the list of Phonak distributors worldwide.

This device complies with part 15 and part 95 of the FCC rules and with RSS 210 of Industry Canada.

Operation is subject to the following two conditions:

(1) This device does not cause harmful interference, and (2) this device must accept any interference received, including interference that may cause undesired operation.

 **Warning:** Changes or modifications made to this equipment not expressly approved by Phonak may void the user's authority to operate the equipment.

Phonak distributors worldwide

Group companies:	(detailed information on www.phonak.com)
Australia	Phonak Australasia Pty. Ltd. Baulkham Hills N.S.W 2153
Austria	Hansaton Akustische Geräte GmbH 5020 Salzburg
Belgium	Ets Lapperre B.H.A.C. NV B-1702 Groot-Bijgaarden Phonak Belgium NV, B-1700 Dilbeek
Brazil	CAS Produtos Médicos São Paulo – SP 04363-100
Canada	Phonak Canada Limited Mississauga, Ontario L5W 0B3
China	Phonak (Shanghai) Co. Ltd. Shanghai City 200233
Denmark	Phonak Danmark A/S, Nitivej 10 2000 Frederiksberg
France	Phonak France SA, 69500 Bron
Germany	Phonak GmbH, 70736 Fellbach- Oeffingen, EC Representative
India	Phonak India Pvt. Ltd., 100 034 New Delhi
Italy	Phonak Italia S.r.l., 20159 Milano
Japan	Phonak Japan Co., Ltd., Tokyo 101-0044
Jordan	Phonak Middle East, 11181 Amman
Mexico	Phonak Mexicana, S.A. de C.V. 03920 México, D.F.MEXICO
Netherlands	Phonak B.V., 3439 ME Nieuwegein
New Zealand	Phonak New Zealand Ltd., Takapuna Auckland 9
Norway	Phonak AS, 0105 Oslo
Poland	Phonak Polska SP Z.O.O 00-567 Warszawa
Portugal	Phonak Ibérica S.A., 03008 Alicante, Spain

Russian Federation	Phonak CIS Ltd., Moscow, 115114
Spain	Phonak Ibérica S.A., 03008 Alicante
Sweden	Phonak AB, 117 43 Stockholm
Switzerland	Phonak AG, Phonak Schweiz, 8712 Stäfa
Turkey	Phonak Turkey A.S., 34357 Istanbul
United Kingdom	Phonak UK Limited Warrington, Cheshire WA1 1PP
USA	Phonak LLC, Warrenville, IL 60555-3927

Independent general distributors: A complete list of Phonak distributors is available at Phonak's Internet site: **www.phonak.com**. Please visit us or ask your hearing care professional for information.

Manufacturer: Phonak Communications AG, Länggasse 17
CH-3280 Murten, Switzerland



The CE symbol is a confirmation by Phonak AG that this Phonak product meet the requirements of directive 93/42/EEC on medical devices and the R&TTE Directive 1999/5/EC on Radio and Telecommunication Terminal Equipment. The numbers after the CE symbol are the numbers of consulted certified bodies under the above mentioned directives.



This symbol indicates that it is important that the user refers to associated warnings given in this user guide.



The symbol with the crossed out disposal bin indicates that this product shall not be treated as household waste. Please hand over your old or unused product to the applicable collection point for the recycling of electrical and electronic equipment or bring your old product to your hearing care professional for appropriate disposal. By ensuring this product is disposed of correctly, you will help prevent potential negative effects on the environment and human health.



This symbol indicates this product complies with requirements for a BF type applied part according to EN 60601-1.



This symbol indicates that this is a Class II ME equipment according to EN 60601-1.

Operating conditions

This product has been designed for trouble-free operation without restrictions when used as intended, unless otherwise stated in this user guide.

Transportation and storage conditions Temperature should not exceed limits of $-20^{\circ}/60^{\circ}$ Celsius at a relative air humidity of 65% for extended periods during transportation and storage.
Air pressure between 500 and 1100 hPa is not detrimental to this device.

