



34" OSCILLATING CERAMIC TOWER HEATER with REMOTE CONTROL
MODEL 2RA10/8566

READ AND SAVE THESE INSTRUCTIONS

READ CAREFULLY BEFORE ATTEMPTING TO ASSEMBLE, INSTALL, OPERATE OR MAINTAIN THE PRODUCT DESCRIBED. PROTECT YOURSELF AND OTHERS BY OBSERVING ALL SAFETY INFORMATION. FAILURE TO COMPLY WITH INSTRUCTIONS COULD RESULT IN PERSONAL INJURY AND/OR PROPERTY DAMAGE! RETAIN INSTRUCTIONS FOR FUTURE REFERENCE.

DESCRIPTION

The AirKing Oscillating Ceramic Heater features 2 heat settings. The heater oscillates 120° and comes with a remote control for convenience. This unit also features a built in timer to allow up to 8 hours of operation before automatic shutdown and comes with a 6ft. (1.82m) 16/3 grounded cordset.

SPECIFICATIONS

Motor.....120 V/60 Hz
Control.....Manual/Remote
Settings.....High and Low Heat
Air Flow Distribution.....120°
Approvals.....UL/CUL listed. Close mesh blower guard meets OSHA requirements.

MODEL	2RA10/8566		
SETTINGS	HIGH	LOW	FAN
BTU	5118	3070	Ø
Amps	12.5	7.0	0.288
Watts	1500	900	33.4
dB A	47	<40	47

GENERAL SAFETY INFORMATION

1. Read all instructions before using Heater.
2. Use this Heater only as described in this manual. Any other use not recommended by the manufacturer may cause fire, electrical shock, or injury to persons.
3. Make certain that the power source conforms to the electrical requirements of the Heater.
4. Extreme caution is necessary when any Heater is used by or near children or invalids and whenever the Heater is left operating unattended.
5. The power cord is equipped with a three-prong grounded plug that must be inserted into a matching receptacle. Under no circumstances should the ground prong be cut off the plug. Where a two-prong wall receptacle is encountered, it must be replaced with a properly grounded three-prong receptacle installed in accordance with the National Electrical Code (NEC) and all applicable local codes and ordinances. This work must be done by a qualified electrician, using copper wires only.

DO NOT USE A THREE-PRONG ADAPTER. IMPROPER CONNECTION MAY CAUSE THIS RISK OF ELECTROCUTION. USE OF SUCH ADAPTERS IS NOT PERMITTED IN CANADA.

6. Where possible, avoid the use of extension cords because the extension cord may overheat and cause a risk of fire. If they must be used, minimize the risk of overheating by ensuring that they are UL listed, a minimum No. 14 AWG, rated not less than 1875 watts. Never use a single extension cord to operate more than one Heater.
7. Do not operate any Heater with a damaged cord or plug or after the Heater malfunctions, has been dropped or damaged in any manner. Return Heater to authorized service facility for examination, electrical or mechanical adjustment or repair.
8. Unplug power cord before servicing or moving the Heater. Always unplug Heater when not in use.

WARNING: DO NOT DEPEND ON THE ON/OFF SWITCH AS THE SOLE MEANS OF DISCONNECTING POWER WHEN SERVICING OR MOVING THE HEATER. ALWAYS UNPLUG THE POWER CORD.

9. Do not insert or allow fingers or foreign objects to enter any ventilation or exhaust opening as it may cause an electric shock or fire, or damage the Heater. Do not block or tamper with the Heater in any manner while it is in operation.
10. To prevent a possible fire, do not block air intakes or exhaust in any man-

ner. Do not place on soft surfaces, like a bed, where openings may become blocked.

11. Always place the Heater on a stable, flat, level surface when operating, to avoid the chance of the Heater overturning. Locate the Power Cord so the Heater or other objects are not resting on it. Do not run Power Cord under carpeting. Do not cover Power Cord with throw rugs, runners, or the like. Arrange Power Cord away from room traffic and where it will not be tripped over.
12. This Heater is hot when in use. To avoid burns, do not let bare skin touch hot surfaces. Always use handle when moving this Heater. Keep combustible materials, such as furniture, pillows, bedding, papers, clothes and curtains at least 3 feet (0.9 m) from the front of the Heater and keep them at least 1 foot (0.3 m) from the sides and rear.
13. A Heater has hot and arcing or sparking parts inside. It must NOT be used in potentially dangerous locations such as flammable, explosive, chemical-laden or wet atmospheres. This Heater is intended for general use ONLY.
14. This Heater is not intended for use in wet or damp locations. Never locate a Heater where it may fall into a bathtub or other water container.
15. Do not use Heater outdoors.

WARNING: REDUCE THE RISK OF FIRE OR ELECTRIC SHOCK – DO NOT USE THIS HEATER WITH ANY SOLID STATE SPEED CONTROL DEVICES.

SAVE THESE INSTRUCTIONS

OPERATION

1. Carefully remove the Heater from the bag and the carton.
2. Place the Heater on a firm, level surface.

WARNING: Plastic or rubber tabs, like the feet on this unit, may stick to furniture surfaces and/or hardwood floors. The unit may leave a residue that could darken, stain or leave permanent blemishes on the finish of certain furniture surfaces, including wood surfaces, and/or hardwood floors.

3. Plug the cord set into a 120V~ electrical outlet. Be sure plug fits tightly in outlet.
4. When the Heater is initially plugged in, there will be a "beep" and the **Power Light** will come on indicating that there is power to the unit. The **Power Light** will remain lit until the Heater is unplugged from the electrical outlet. (Figure 1)

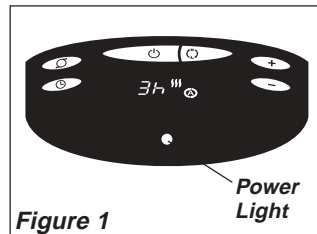

Figure 1

5. Turn the Heater ON by pressing the **Power Button** (⏻).
6. When initially turned on, the Heater will display the current room temperature in ° Fahrenheit. Press the (+) and (-) buttons at the same time to change the display to ° Celsius. Press the same two buttons together again will change the display back to ° Fahrenheit.
7. Upon turning the Heater on, the unit will be in HIGH heat (⦿) (1500 Watts) and will display the current room temperature (Figure 2)
8. Press the (⏻) button for LOW heat (⦿). (900 Watts)

9. To turn the Heater OFF, press the **Power Button** (⏻) and unplug the Heater from the electrical outlet.

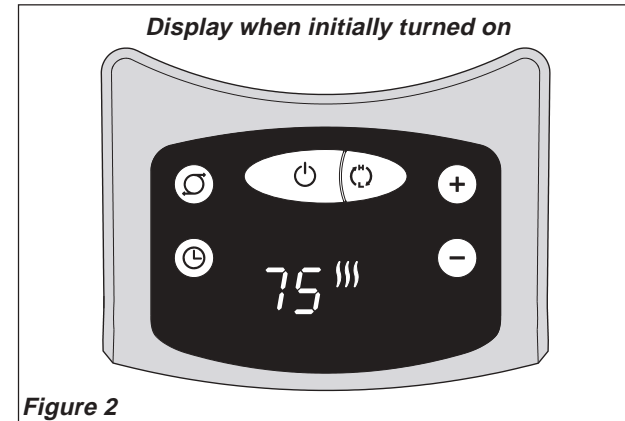

Figure 2

OSCILLATION:

Pressing the **Oscillation Button** (↻) will allow the Heater to oscillate back and forth. To stop the oscillation, press the **Oscillation Button** (↻) again.

TIMER FUNCTION (Figure 3)

The timer function may be activated when the Heater display is in any function or speed. This function allows you to set the length of time the Heater will run before turning itself off, from 1 hour to 8 hours. Pressing the **Timer Button** (⌚) will increase the length of time by 1 hour each time this button is pressed. After the display reflects 8 hours, pressing the **Timer Button** (⌚) once more will reset the Heater to run continuously. The Heater will turn off when the set time has lapsed. The unit can be turned back on by pressing the **Power Button** (⏻).

AUTOMATIC TEMPERATURE CONTROL (Figure 4)

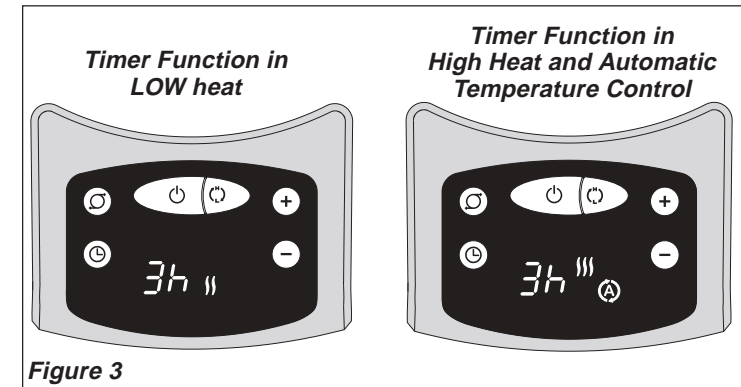

Figure 3

Pressing the (+) or (-) button allows you to set the desired temperature of the Heater.

1. When the (+) or (-) button is pressed, the displayed set temperature will begin to flash and the (⊙) symbol will appear.
2. Press the (+) to increase the desired set temperature or press the (-) to decrease the desired set temperature.
3. When the air temperature reaches 2° above the set temperature, the Heater will shut off.
4. When the air temperature reaches 1° below the set temperature,

- the Heater will turn on.
5. This function will cancel if the (⏻) button is pressed and the Heater will now be in Low heat (⦿).

NOTE: It is normal for the Heater to cycle ON and OFF as it maintains the SET temperature.

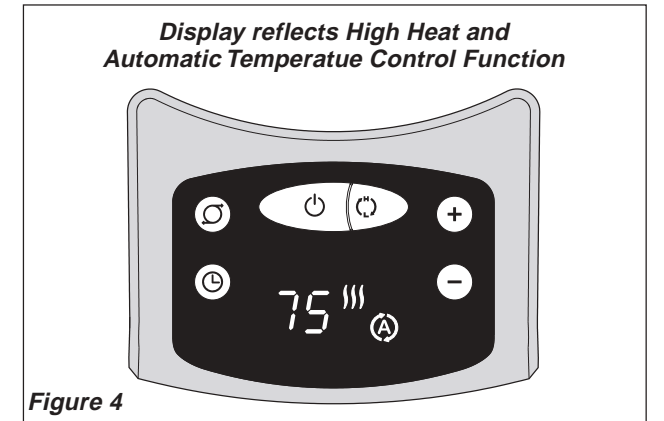

Figure 4

REMOTE CONTROL (Figure 5)

All the functions performed with the Remote Control work identically to the manual controls, except the ability to change from °F to °C.

1. Install the two "AAA" batteries supplied.
2. Do not mix old and new batteries. Do not mix alkaline, standard (carbon-zinc) or rechargeable (nickel-cadmium) batteries.

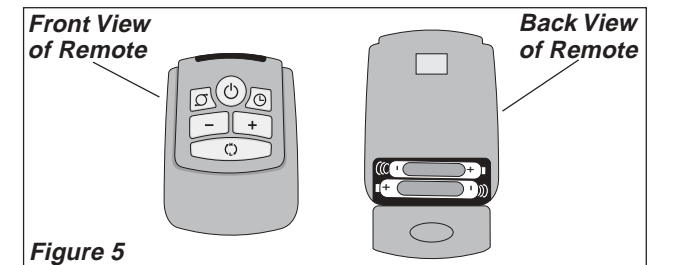

Figure 5

3. Remote control hook is located on back of Heater. (Figure 6)

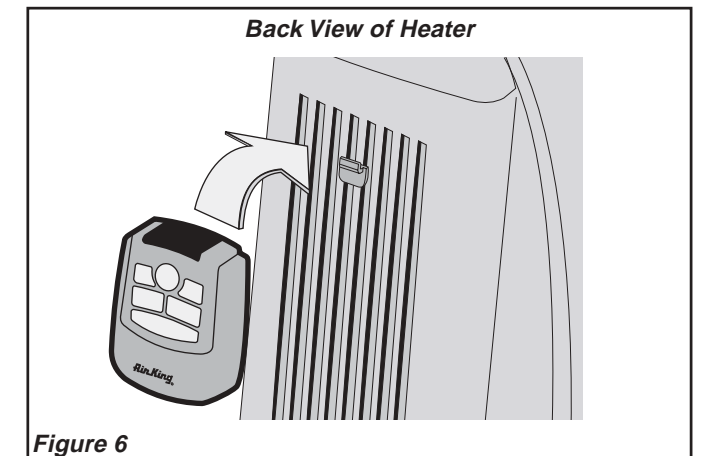

Figure 6

SAFETY FEATURE

1. A thermal overload protector is built in to prevent overheating.
2. When an overheat temperature is reached, the Heater will be automatically shut off. It can only resume operation when the user resets the unit.

To Reset Heater:

1. Unplug the Heater and wait 10 minutes for the Heater to cool down.
2. After the Heater has cooled down, plug the unit into a 120V~ electrical outlet and follow the operation instructions described in this manual.

TROUBLE SHOOTING TIPS

If your heater shuts off unexpectedly or fails to operate, one of the above-mentioned safety feature may have been activated to prevent overheating.

1. Be sure the power cord is plugged into a working electrical outlet.
2. Check your Thermostat setting. The Heater may be off because it has reached the desired temperature setting.

MAINTENANCE

WARNING: ALWAYS UNPLUG THE CORD BEFORE MOVING OR SERVICING.

WARNING: DO NOT IMMERSE HEATER IN WATER.

CLEANING: IMPORTANT! Clean the Heater grill and side intakes with the vacuum brush attachment of your vacuum cleaner. This will remove lint and dirt from the inside of the Heater. Clean the body of the Heater with a soft cloth.

DO NOT ATTEMPT TO TAKE APART THE HEATER.

CAUTION: Do not use gasoline, benzine, thinner, harsh cleaners, etc., as they will damage the Heater. NEVER use ALCOHOL OR SOLVENTS.

SERVICING: All other servicing, with the exception of general user-maintenance, should be performed by an authorized service representative.

STORAGE: Store the Heater with these instructions in the original carton in a cool, dry place.

NOTES

LIMITED WARRANTY

AIRKING THREE-YEAR LIMITED WARRANTY. Products are warranted by AirKing to the original user against defects in workmanship or materials under normal use for three years after date of purchase. Any unit which is determined by AirKing to be defective in material or workmanship and returned to an authorized service location, as AirKing designates, shipping costs prepaid, will be, as the exclusive remedy, repaired or replaced at AirKing's option. For limited warranty claim procedures, see PROMPT DISPOSITION below. This limited warranty gives purchasers specific legal rights which vary from state to state.

LIMITATION OF LIABILITY. To the extent allowable under applicable law, AirKing's liability for consequential and incidental damages is expressly disclaimed. AirKing's liability in all events is limited to, and shall not exceed, the purchase price.

WARRANTY DISCLAIMER. AirKing has made a diligent effort to illustrate and describe the products in this literature accurately; however, such illustrations and descriptions are for the sole purpose of identification, and do not express or imply a warranty the products are merchantable, or fit a particular purpose, or that the products will necessarily conform to the illustrations or descriptions.

Except as provided below, no warranty or affirmation of fact, expressed or implied, other than as stated in "LIMITED WARRANTY" above is made or authorized by AirKing.

PRODUCT SUITABILITY. Many states and locations have codes and regulations governing sales, construction, installation, and/or use of products for certain purposes, which may vary from those in neighboring areas. While AirKing attempts to assure that its products comply with such codes, it cannot guarantee compliance, and cannot be responsible for how the product is installed or used. Before purchase and use of a product, please review the product application, and national and local codes and regulations, and be sure that the product, installation, and use will comply with them.

Certain aspects of disclaimers are not applicable to consumer products; e.g., (a) some states do not allow the exclusion or limitation of incidental or consequential damages, so the above limitation or exclusion may not apply to you; (b) also, some states do not allow limitations on how long an implied warranty lasts, consequently the above limitation may not apply to you; and (c) by law, during the period of the Limited Warranty, and implied warranties of merchantability or fitness for a particular purpose applicable to consumer products purchased by consumers, may not be excluded or otherwise disclaimed.

PROMPT DISPOSITION. AirKing will make a good faith effort for prompt correction or other adjustment with respect to any product which proves to be defective within limited warranty. For any product believed to be defective within limited warranty, first write or call dealer from whom product was purchased. Dealer will give additional directions.