



# IR REMOTE CONTROL SYSTEM USER'S MANUAL



## User's Manual

Please read this instruction thoroughly before operation and retain it for future reference.

601 V1.2



# IR REMOTE CONTROL SYSTEM USER'S MANUAL



## User's Manual

Please read this instruction thoroughly before operation and retain it for future reference.

601 V1.2

## **Thank-You Note Before You Get Start**

First of all, we would like to express our gratitude to you for purchasing CPcam products. Once again, this product is designed uniquely to meet all your personal needs with our great industry-designing ability and our everlasting perseverance to the quality of all our products.

This manual will introduce you how to install this camera. Please keep it well for your future reference.

Now, we would like to invite you to personally experience this user-friendly manual and all of the powerful functions this CPcam product offers.

<http://www.cpcamcctv.com>

## **Thank-You Note Before You Get Start**

First of all, we would like to express our gratitude to you for purchasing CPcam products. Once again, this product is designed uniquely to meet all your personal needs with our great industry-designing ability and our everlasting perseverance to the quality of all our products.

This manual will introduce you how to install this camera. Please keep it well for your future reference.

Now, we would like to invite you to personally experience this user-friendly manual and all of the powerful functions this CPcam product offers.

<http://www.cpcamcctv.com>

## WARNING

All the safety and operating instructions should be read before operation. The improper operation may cause permanent damage.



- Please lift and place this equipment gently.
  - Do not expose this equipment to open sunlight.
  - Do not use this equipment near water or in contact with water.
  - Do not spill liquid of any kind on the equipment.
  - Do not attempt to have this equipment serviced by yourself.
  - Installation should be made by qualified service personnel.
- \*\* The operating humidity is between 0%~80%.



The lightning flash with arrowhead symbol, within an equilateral triangle, is intended to alert the user to the presence of uninsulated "dangerous voltage" within the product's enclosure that may be of sufficient magnitude to constitute a risk of electric shock to persons.



The exclamation point within an equilateral triangle is intended to alert the user to the presence of important operating and maintenance-(servicing) instructions in the literature accompanying the appliance.

## WARNING

All the safety and operating instructions should be read before operation. The improper operation may cause permanent damage.



- Please lift and place this equipment gently.
  - Do not expose this equipment to open sunlight.
  - Do not use this equipment near water or in contact with water.
  - Do not spill liquid of any kind on the equipment.
  - Do not attempt to have this equipment serviced by yourself.
  - Installation should be made by qualified service personnel.
- \*\* The operating humidity is between 0%~80%.



The lightning flash with arrowhead symbol, within an equilateral triangle, is intended to alert the user to the presence of uninsulated "dangerous voltage" within the product's enclosure that may be of sufficient magnitude to constitute a risk of electric shock to persons.



The exclamation point within an equilateral triangle is intended to alert the user to the presence of important operating and maintenance-(servicing) instructions in the literature accompanying the appliance.

## SPECIFICATIONS

### IR RECEIVER

#### ▣ SPECIFICATIONS

- 1.Support PTZ camera & DVR control
- 2.Connected to RS-485 by transmission line
- 3.IR Receiver
- 4.Control up to 255 PTZ & LIGHT
- 5.Control up to 255 DVR
- 6.Enabling different ID
- 7.Current Consumption: DC 12V, 25mA



### IR TRANSMITTER

#### ▣ SPECIFICATIONS

- 1.IR control for PTZ camera, DVR, LIGHT
- 2.IR emission distance:straight-line is 10m; transmit at left and right 22.5 degree is 8m
- 3.Control up to 255 PTZ camera & LIGHT
- 4.Control up to 255 DVR
- 5.Enabling different ID
- 6.Current Consumption: AAA Size battery x 2
- 7.Not support digital zoom.



### REMOTE SWITCH

#### ▣ SPECIFICATIONS

1. Home Electronics (lights, TV,etc.)
2. Connected to RS-485 by transmission line
3. DC IN x 1, DC OUT x 1
4. Output Terminal
5. Current Consumption: 50mA



## SPECIFICATIONS

### IR RECEIVER

#### ▣ SPECIFICATIONS

- 1.Support PTZ camera & DVR control
- 2.Connected to RS-485 by transmission line
- 3.IR Receiver
- 4.Control up to 255 PTZ & LIGHT
- 5.Control up to 255 DVR
- 6.Enabling different ID
- 7.Current Consumption: DC 12V, 25mA



### IR TRANSMITTER

#### ▣ SPECIFICATIONS

- 1.IR control for PTZ camera, DVR, LIGHT
- 2.IR emission distance:straight-line is 10m; transmit at left and right 22.5 degree is 8m
- 3.Control up to 255 PTZ camera & LIGHT
- 4.Control up to 255 DVR
- 5.Enabling different ID
- 6.Current Consumption: AAA Size battery x 2
- 7.Not support digital zoom.



### REMOTE SWITCH

#### ▣ SPECIFICATIONS

1. Home Electronics (lights, TV,etc.)
2. Connected to RS-485 by transmission line
3. DC IN x 1, DC OUT x 1
4. Output Terminal
5. Current Consumption: 50mA



# SITUATION SIMULATE

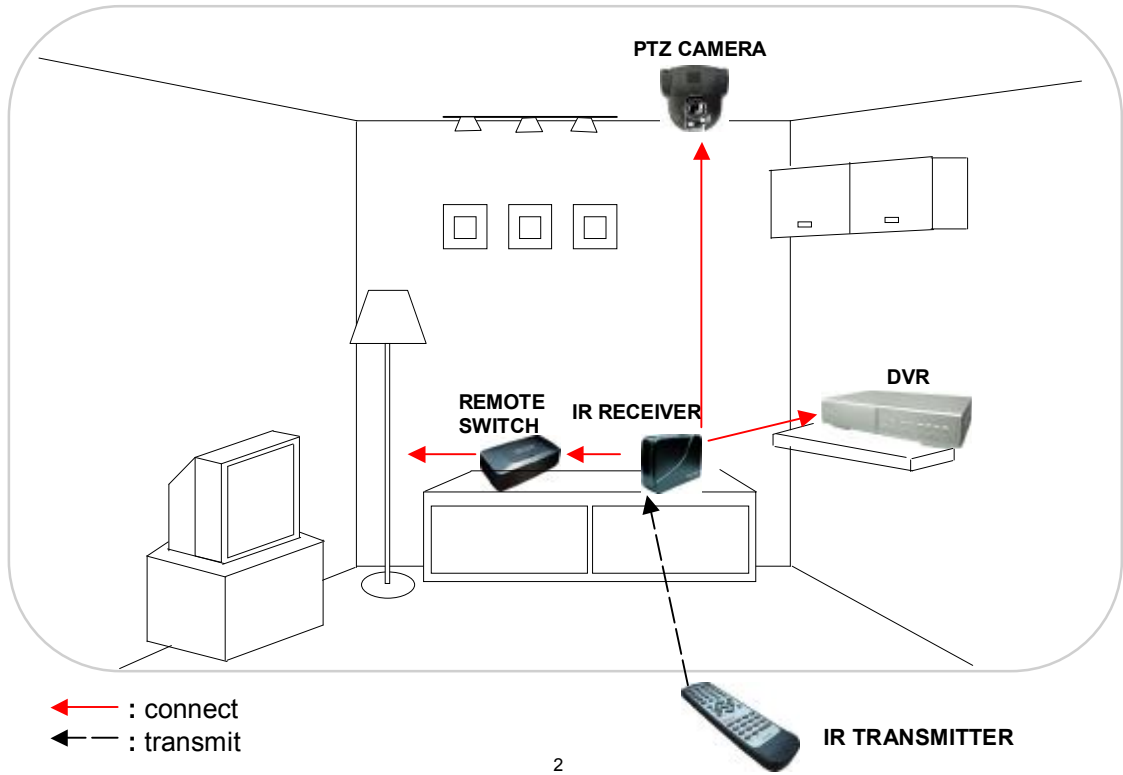

# SITUATION SIMULATE

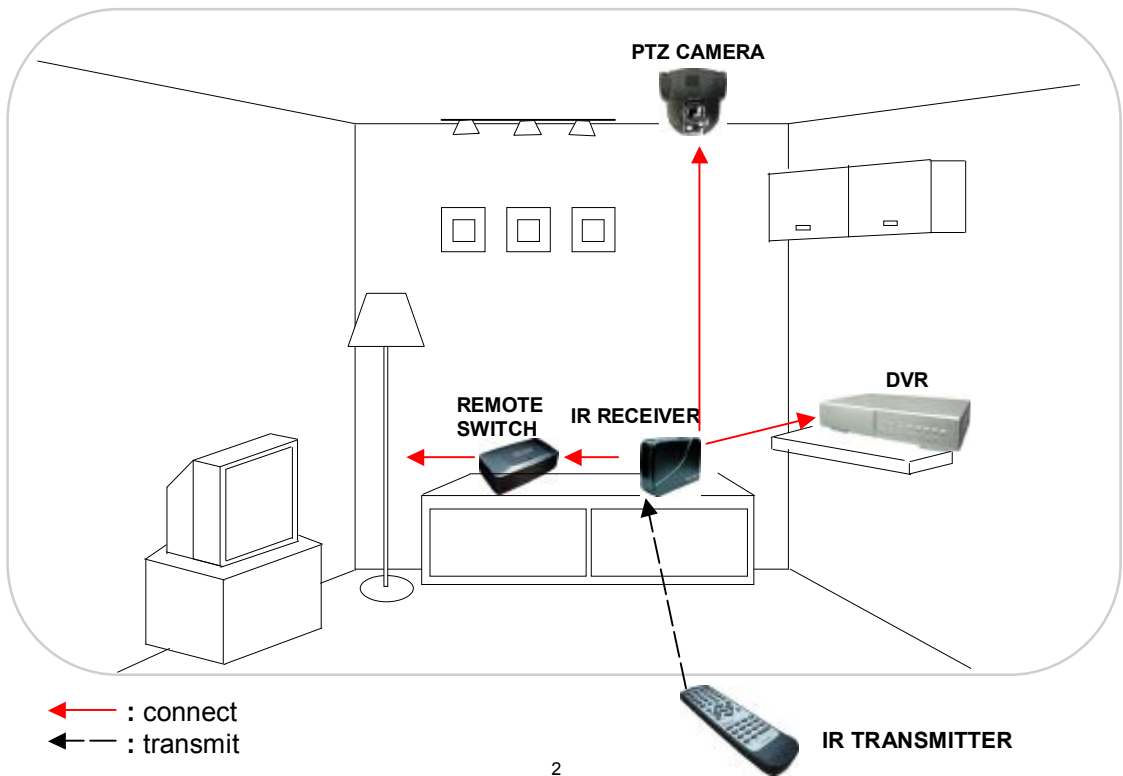

**RS 485**

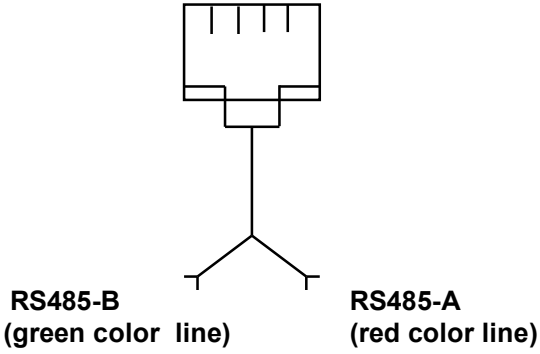

**Note:**  
Connect "RS485-A(red color line)" to 11<sup>th</sup> aperture on DVR's Sub-D Plug, PTZ or Remote Switch.  
Connect "RS485-B(green color line)" to 10<sup>th</sup> aperture on DVR's Sub-D Plug, PTZ or Remote Switch.

**RS 485**

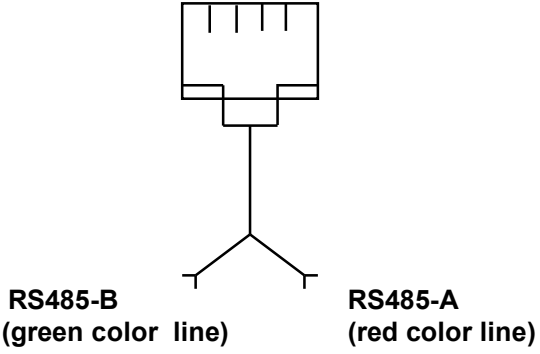

**Note:**  
Connect "RS485-A(red color line)" to 11<sup>th</sup> aperture on DVR's Sub-D Plug, PTZ or Remote Switch.  
Connect "RS485-B(green color line)" to 10<sup>th</sup> aperture on DVR's Sub-D Plug, PTZ or Remote Switch.

## PANEL DESCRIPTION

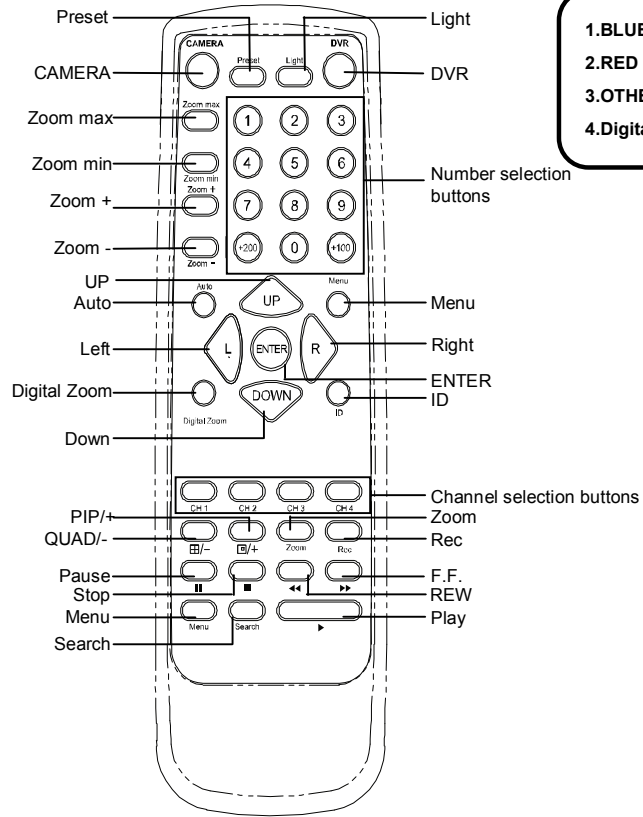

1. BLUE LINE AREA – Control CAMERA  
 2. RED LINE AREA – Control DVR  
 3. OTHERS – Support CAMERA & DVR  
 4. Digital Zoom is not supported now.

## PANEL DESCRIPTION

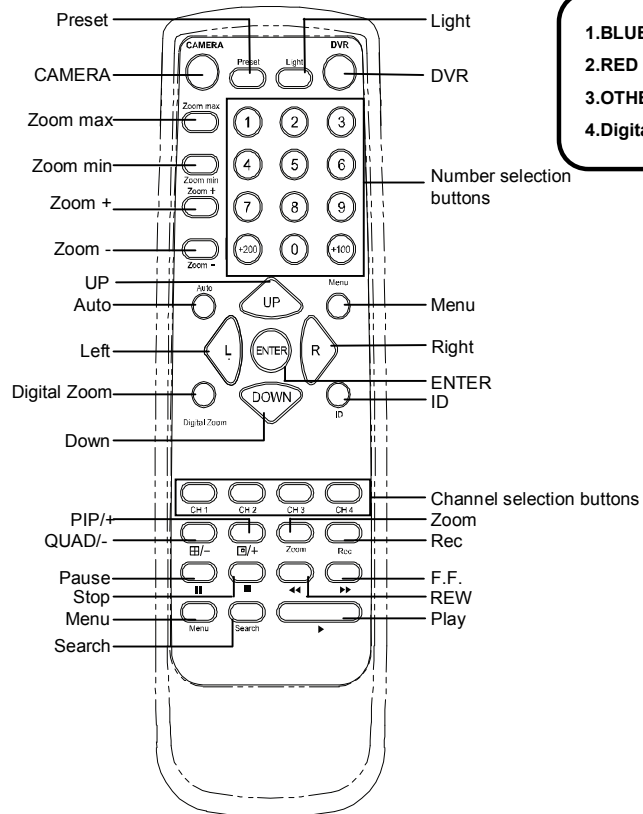

1. BLUE LINE AREA – Control CAMERA  
 2. RED LINE AREA – Control DVR  
 3. OTHERS – Support CAMERA & DVR  
 4. Digital Zoom is not supported now.

## FUNCTION DEFINITION - CAMERA

- Zoom max**

Press the **Zoom max** button, the picture will become the biggest size directly.

- Zoom min**

Press the **Zoom min** button , the picture will become the smallest size directly.

- Zoom + / -**

Press the **Zoom +** or **Zoom-** button to change the ratio.

- Auto**

Please refer to **PTZ User's Manual**.

- Menu**

Press **Menu** to enter Camera setting menu.

- Preset**

Please refer to **PTZ User's Manual**.

- Light**

Press **Light** button to control remote switch (ON/OFF).

- UP, DOWN, L, and R**

Press UP,DOWN,L and R to control PTZ camera.

If you press over 2 seconds, PTZ camera will move continuously.

## FUNCTION DEFINITION - CAMERA

- Zoom max**

Press the **Zoom max** button, the picture will become the biggest size directly.

- Zoom min**

Press the **Zoom min** button , the picture will become the smallest size directly.

- Zoom + / -**

Press the **Zoom +** or **Zoom-** button to change the ratio.

- Auto**

Please refer to **PTZ User's Manual**.

- Menu**

Press **Menu** to enter Camera setting menu.

- Preset**

Please refer to **PTZ User's Manual**.

- Light**

Press **Light** button to control remote switch (ON/OFF).

- UP, DOWN, L, and R**

Press UP,DOWN,L and R to control PTZ camera.

If you press over 2 seconds, PTZ camera will move continuously.



## FUNCTION DEFINITION - DVR

### •CH1 、 CH2 、 CH3 、 CH4

Press **Ch1- 4** to select channel.

### • / -

Under DVR play mode, it can display the 4 channels in QUAD mode. Under setup mode, it can decrease value.

### • / +

Under DVR play mode, it can display Picture in Picture screen. Under setup mode, it can increase value.

### •Zoom

Press **Zoom** button to enlarge the digital picture.

### •Rec

Press **Rec** to start recording.

### • II

Under DVR play mode, it can pause the video.

### • ■

Under DVR playback mode, it can stop the action.

### • ►►

FF: Play video fast forward.

### • ◀◀

REW: Play video fast backward.

### •Menu

Press **Menu** button to enter DVR setting menu.

### •Search

Press **Search** button to search.

### • ►

Play: Press **Play** to see previous recorded video.

6

## FUNCTION DEFINITION - DVR

### •CH1 、 CH2 、 CH3 、 CH4

Press **Ch1- 4** to select channel.

### • / -

Under DVR play mode, it can display the 4 channels in QUAD mode. Under setup mode, it can decrease value.

### • / +

Under DVR play mode, it can display Picture in Picture screen. Under setup mode, it can increase value.

### •Zoom

Press **Zoom** button to enlarge the digital picture.

### •Rec

Press **Rec** to start recording.

### • II

Under DVR play mode, it can pause the video.

### • ■

Under DVR playback mode, it can stop the action.

### • ►►

FF: Play video fast forward.

### • ◀◀

REW: Play video fast backward.

### •Menu

Press **Menu** button to enter DVR setting menu.

### •Search

Press **Search** button to search.

### • ►

Play: Press **Play** to see previous recorded video.

6

## ADJUSTMENT AND SETTINGS

### Turning On the Power of IR TRANSMITTER

- Press **DVR**, **CAMERA** and **Digital Zoom** button one by one to turn on IR Transmitter.
- IR Transmitter will turn off automatically after 8 minutes if there is no operation.  
Please restart again.
- If IR Receiver receives IR signal, the indicator of IR Receiver will flash.

#### Step 1

1. Press "**DVR**" button.

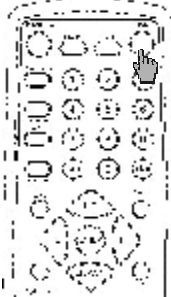

#### Step 2

2. Press "**CAMERA**" button.



#### Step 3

3. Press "**Digital Zoom**" button.



7

## ADJUSTMENT AND SETTINGS

### Turning On the Power of IR TRANSMITTER

- Press **DVR**, **CAMERA** and **Digital Zoom** button one by one to turn on IR Transmitter.
- IR Transmitter will turn off automatically after 8 minutes if there is no operation.  
Please restart again.
- If IR Receiver receives IR signal, the indicator of IR Receiver will flash.

#### Step 1

1. Press "**DVR**" button.

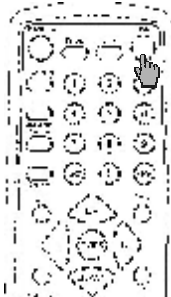

#### Step 2

2. Press "**CAMERA**" button.



#### Step 3

3. Press "**Digital Zoom**" button.



7

## ADJUSTMENT AND SETTINGS

### ❖ ID Setting – CAMERA

For example: Changing Camera ID from 001 to 003

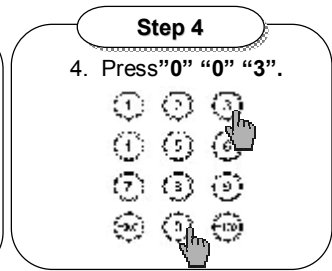
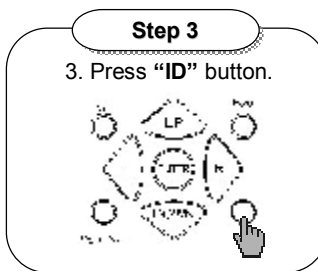
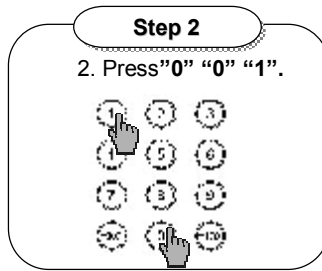
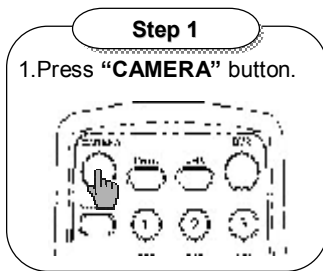

**\*Note :**

1. If CAMERA ID is 8, please press "0"、"0"、"8" and "ENTER".
2. If CAMERA ID is 68, please press "0"、"6"、"8" and "ENTER".
3. If CAMERA ID is 168, please press "1"、"6"、"8" and "ENTER".
4. If CAMERA ID is 100 ( or 200 ) , please press "+100" button(or "+200") and "ENTER".
5. The ID range is from 0 to 254.

If the setting is OK → when you press the "ID" button, the screen will show "CAMERA ID" at the same time.

**Forget the ID**

If you forget the ID(IR Receiver and Remote Switch)  
→ you can **press any three digits** instead of Step2 and set the ID as default value "000".

## ADJUSTMENT AND SETTINGS

### ❖ ID Setting – CAMERA

For example: Changing Camera ID from 001 to 003

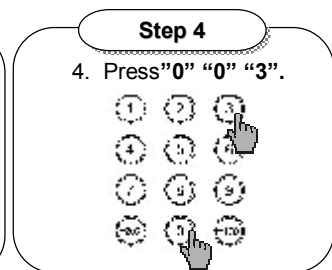
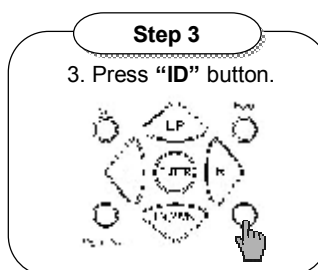
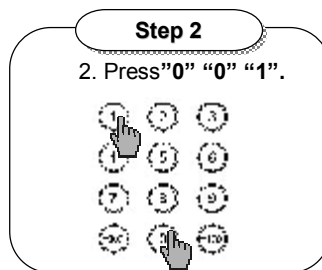
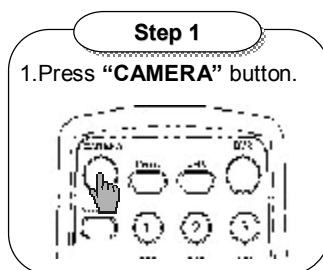

**\*Note :**

1. If CAMERA ID is 8, please press "0"、"0"、"8" and "ENTER".
2. If CAMERA ID is 68, please press "0"、"6"、"8" and "ENTER".
3. If CAMERA ID is 168, please press "1"、"6"、"8" and "ENTER".
4. If CAMERA ID is 100 ( or 200 ) , please press "+100" button(or "+200") and "ENTER".
5. The ID range is from 0 to 254.

If the setting is OK → when you press the "ID" button, the screen will show "CAMERA ID" at the same time.

**Forget the ID**

If you forget the ID(IR Receiver and Remote Switch)  
→ you can **press any three digits** instead of Step2 and set the ID as default value "000".

## ADJUSTMENT AND SETTINGS

### ❖ID Setting – DVR

Use DVR panel to set DVR ID.

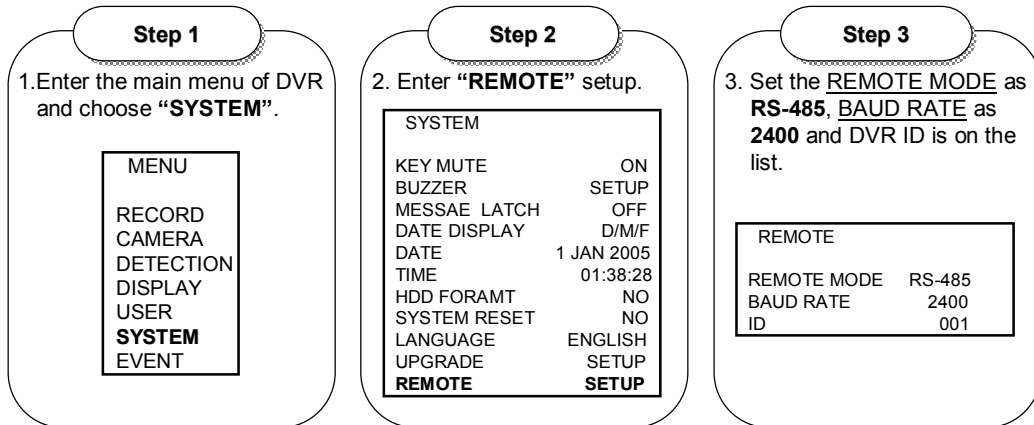

- If your command to the DVR won't be recognized by the receiver, you can set DVR's ID as default value 000.
  - If the Remote Mode is RS-485, then you can't control PTZ via DVR's panel\*.
- (\*When you connect IR Receiver, PTZ and DVR, then the RS-485 will just be recognized between IR Receiver and DVR)

9

## ADJUSTMENT AND SETTINGS

### ❖ID Setting – DVR

Use DVR panel to set DVR ID.

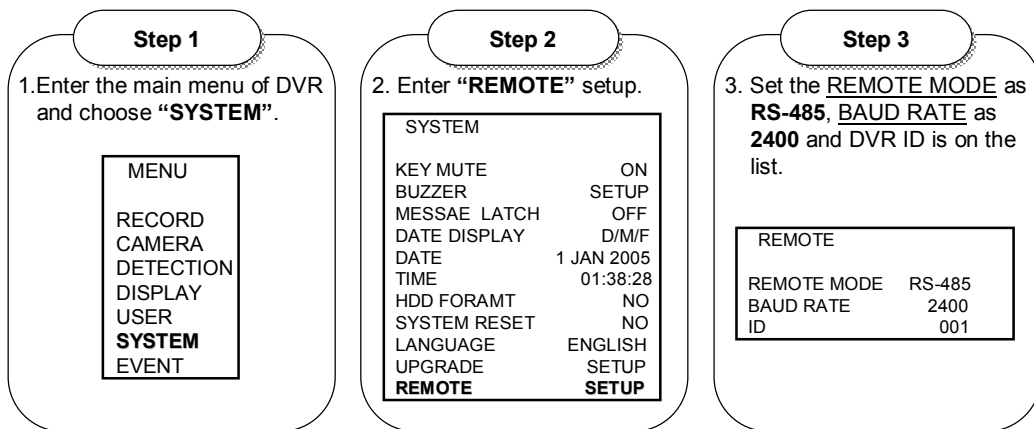

- If your command to the DVR won't be recognized by the receiver, you can set DVR's ID as default value 000.
  - If the Remote Mode is RS-485, then you can't control PTZ via DVR's panel\*.
- (\*When you connect IR Receiver, PTZ and DVR, then the RS-485 will just be recognized between IR Receiver and DVR)

9

## ADJUSTMENT AND SETTINGS

❖Function : How to enter the main menu

### Step 1

1. Press “CAMERA” button or “DVR” button.

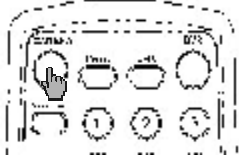

### Step 2

2. Press the ID number (0-254).

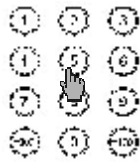

### Step 3

3. Press “Menu” button and Menu list will be on the screen.

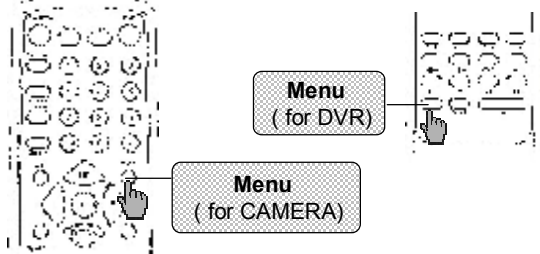

### Step 4

4. Press “ENTER” button.

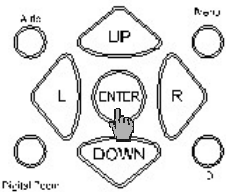

#### \*Note :

- 1.If ID number is 8, please press “0”、“0”、“8”.
- 2.If ID number is 68, please press “0”、“6”、“8”.
- 3.If ID number is 168, please press “1”、“6”、“8”.
- 4.If ID number is 100 ( or 200 ), please press “+100” button(or “+200”).

10

## ADJUSTMENT AND SETTINGS

❖Function : How to enter the main menu

### Step 1

1. Press “CAMERA” button or “DVR” button.

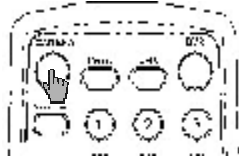

### Step 2

2. Press the ID number (0-254).



### Step 3

3. Press “Menu” button and Menu list will be on the screen.

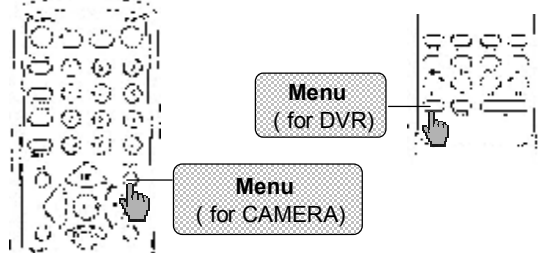

### Step 4

4. Press “ENTER” button.

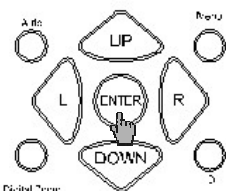

#### \*Note :

- 1.If ID number is 8, please press “0”、“0”、“8”.
- 2.If ID number is 68, please press “0”、“6”、“8”.
- 3.If ID number is 168, please press “1”、“6”、“8”.
- 4.If ID number is 100 ( or 200 ), please press “+100” button(or “+200”).

10

## ADJUSTMENT AND SETTINGS

### ❖Preset

**For example:** In PTZ mode, if you want to see the 6<sup>th</sup> preset position.

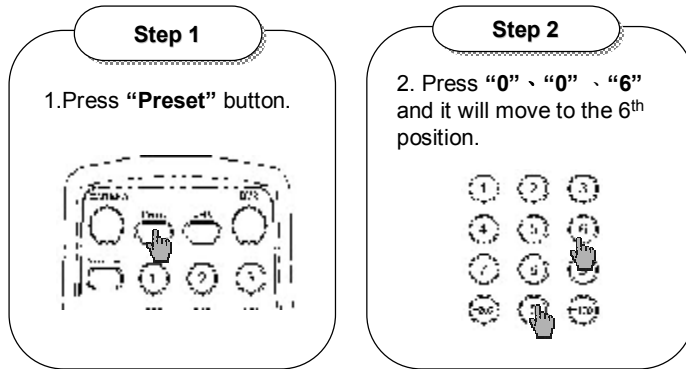

### ❖Auto

In PTZ mode, press “Auto” button and PTZ will enter the Auto Mode. Press any key can stop the Auto Mode.

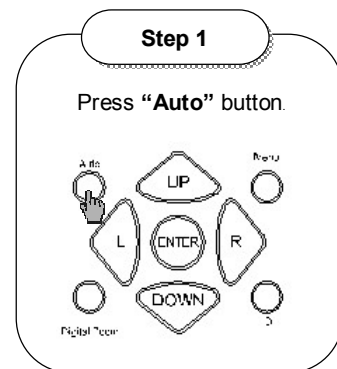

## ADJUSTMENT AND SETTINGS

### ❖Preset

**For example:** In PTZ mode, if you want to see the 6<sup>th</sup> preset position.

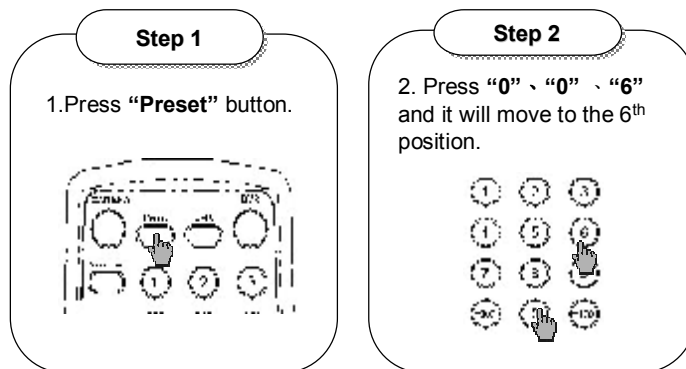

### ❖Auto

In PTZ mode, press “Auto” button and PTZ will enter the Auto Mode. Press any key can stop the Auto Mode.

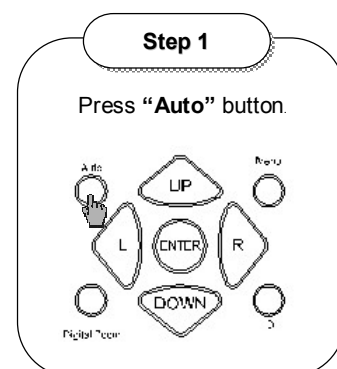

## REMOTE SWITCH

### ❖ID Setting:

The ID setting is the same as the CAMERA ID.

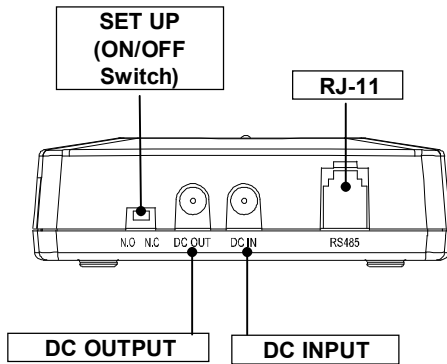

### ⚠WARNING

If the input voltage is too high, the product longevity would be affected. And it might also cause the product to break down.

### DC POWER INPUT

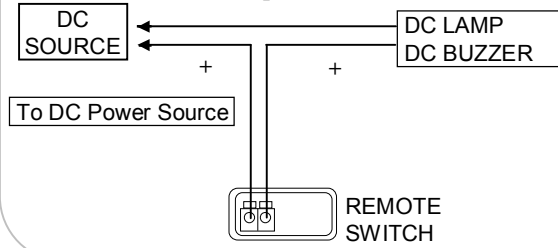

### AC POWER INPUT

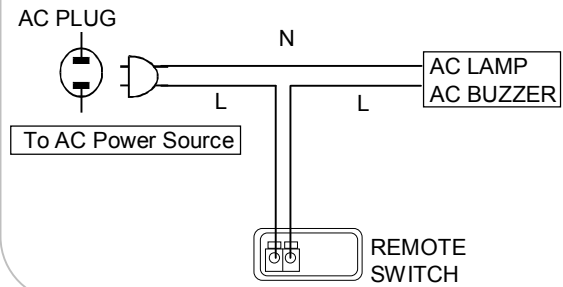

12

## REMOTE SWITCH

### ❖ID Setting:

The ID setting is the same as the CAMERA ID.

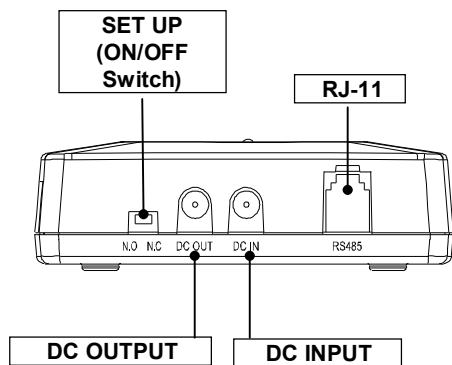

### ⚠WARNING

If the input voltage is too high, the product longevity would be affected. And it might also cause the product to break down.

### DC POWER INPUT

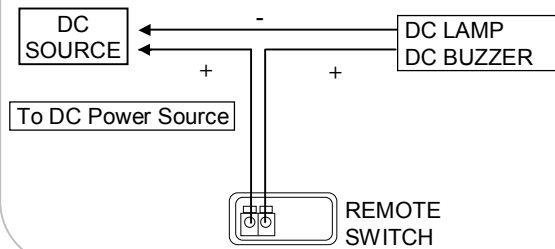

### AC POWER INPUT

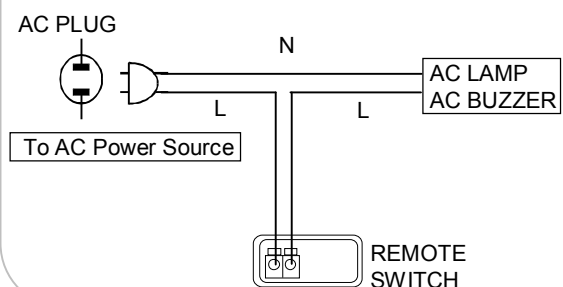

12