

### Safety

Ensure that your domestic mains supply voltage matches the voltage indicated on the identification sticker located at the back of your set. Where the mains plug or an appliance coupler is used as disconnect device, it shall remain readily operable. On certain models, the light indicator is located at the side of the TV set. The absence of a light indication at the front does not mean that the TV set is fully disconnected from the mains. To disconnect the TV set completely, the mains plug must be pulled out. The TV set's components are sensitive to heat. The **maximum ambient temperature** should not exceed **35°** Celsius. Do not cover the vents at the back or sides of the TV set. Leave sufficient space around it to allow adequate ventilation. Install the appliance away from any source of heat (fireplace, etc.) or appliances creating strong magnetic or electric fields. **Moisture** in rooms where the set is installed should not exceed **80%** humidity. Moving the set from a cold place to a warm one can cause condensation on the screen (and on some components inside the TV set). Let the condensation evaporate before switching the TV set on again.

### WARNINGS

This appliance is intended for domestic household use only and should not be used for any other application, such as for non-domestic use or in a commercial environment. If the external flexible cable or cord of this product is damaged, it shall be replaced by the manufacturer or his service agent or a similar qualified person in order to avoid a hazard. Leave more than 10cm clearance around the television to allow adequate ventilation. The ventilation should not be impeded by covering the ventilation openings with items, such as newspapers, table-cloths, curtains, etc. The apparatus shall not be exposed to dripping or splashing and no objects filled with liquids, such as vases shall be placed on the apparatus. Batteries shall not be exposed to excessive heat such as sunshine, fire or the like. An apparatus with CLASS I construction shall be connected to a MAINS socket outlet with a protective earthing connection.



To prevent the spread of fire, keep candles or other open flames away from this product at all times.



**WARNING:** To prevent injury, this apparatus must be securely attached to the floor/wall in accordance with the installation instructions.

**CAUTION:** Connect headphones with the volume set low and increase if required. Prolonged listening through headphones at high volume settings can result in hearing damage.

### Eye Fatigue

When using this product as a computer monitor, health and safety experts recommend short frequent breaks rather than occasional longer breaks. For example a 5-10 minute break after an hour of continuous screen work is considered to be better than a 15 minute break every 2 hours.

Do not use the monitor against a bright background or where sunlight or other bright light sources will shine directly onto the screen.

The  or **POWER**/ button on the TV set or the  button on the remote control can be used to switch it on and put it into standby mode. If you are **not going to be watching the TV for a lengthy period of time**, switch it off completely by removing the plug from the mains power socket.

During **thunderstorms**, we recommend that you disconnect the TV set from the mains and aerial so that it is not affected by electrical or electromagnetic surges that could damage it. For this reason, keep the **mains and aerial sockets** accessible so they can be **disconnected**, if necessary.

**Unplug** the TV set immediately if you notice it giving off a **smell of burning** or **smoke**. You must never, under any circumstances, open the TV set yourself, as you run the risk of an **electric shock** in doing so.

### TV screen

The TV screen used in this product is made of glass. Therefore, it can break when the product is dropped or impacted upon by other objects.

The TV screen is a very high technology product, giving you finely detailed pictures. Occasionally, a few nonactive pixels may appear on the screen as a fixed point of blue, green or red. This does not affect the performance of your product.

### Care

Use a glass-cleaning product to clean the screen and a soft cloth and mild detergent to clean the rest of the set.

**Important:** Using strong detergents, alcohol-based and abrasive products may damage the screen. Dust the vents at the back and sides regularly. Using solvents, abrasive or alcohol-based products could damage the TV set. If an object or liquid enters the appliance, unplug it immediately and have it checked by an authorized engineer. Never open the appliance yourself since this may put you at risk or damage the appliance.

### Hanging the TV set on the wall

**Warning: This operation requires two people.**

To ensure a safe installation, observe the following safety notes:

- Check that the wall can support the weight of the TV set and wall mount assembly.
- Follow the mounting instructions provided with the wall mount. For certain models, make sure to screw

the hexagonal VESA wall mounting screw bosses (and screws) provided with the set into the nuts for the wall mount at the back of your set before your wall mounting.

- The TV set must be installed on a vertical wall.
- Make sure to use only screws suitable for the material of the wall.
- Make sure that the TV set cables are placed so that there is no danger of tripping over them.

All other safety instructions about our TV sets are also applicable here.

### Placing the TV on a table and other surfaces

Before setting up your television set, make sure that the surface you want to put the set on can support its weight.

Do not place the set on an unstable surface (e.g. moving shelf, very edge of a unit) and make sure that the front of the television set does not overhang the surface it is standing on.

To avoid TV from falling please fasten TV to the wall by using necessary screws (in Vesa wall mount holes), clamps, anchors to be bought separately. Install TV near to the wall to avoid falling backwards.

### Multi product user manual

The features described in this manual are common to most models. Some features may not be available on your TV and/or your TV may include features that are not described in this user manual. The illustrations in this manual may differ from the actual product. Please refer to the actual product.

### Information for Users on Disposal of Old Equipment and Batteries [European Union]

These symbols indicate that the electrical and electronic equipment and the battery with this symbol should not be disposed of as general household waste at their end-of-life. Instead, the products should be handed over to the applicable collection points for the recycling of electrical and electronic equipment as well as batteries for proper treatment, recovery and recycling in accordance with your national legislation and the Directive 2012/19/EU, 2006/66/EC and 2008/12/EC.

By disposing of these products correctly, you will help to conserve natural resources and will help to prevent potential negative effects on the environment and human health which could otherwise be caused by inappropriate waste handling of these products.

For more information about collection points and recycling of these products, please contact your local municipal office, your household waste disposal service or the shop where you purchased the product. Penalties may be applicable for incorrect disposal of this waste, in accordance with national legislation.

#### [Business users]

If you wish to dispose of this product, please contact your supplier and check the terms and conditions of the purchase contract.

#### [Other Countries outside the European Union]

These symbols are only valid in the European Union. If you wish to dispose of these items, please do so in accordance with applicable national legislation or other rules in your country for the treatment of old electrical equipment and batteries.



Products



Battery

Notice:  
The sign Pb below the symbol for batteries indicates that this battery contains lead.

#### Dear Customer,

This apparatus is in conformance with the valid European directives and standards regarding electromagnetic compatibility and electrical safety.

TCL Operations Polska Sp. z o.o.  
ul. A. Mickiewicza 31/41  
96-300 Żyrardow, Poland

Email address: zyeee@tcl.com

Figures and illustrations in this User Manual are provided for reference only and may differ from actual product appearance. Product design and specifications may be changed without notice.

Important information .....	1	Viewing pictures, playing music and watching videos from a USB storage device.....	15
<b>Chapter 1 - Connections</b>		All .....	15
Connect the power and antenna .....	4	Picture .....	15
Connect DVD player, home theatre system.....	4	Video .....	15
Connect DVD recorder, cable receiver.....	5	Music .....	15
Connect Blu-ray Disc player, HD game console, HD camcorder, headphones, CI module.....	5	Using EPG (Electronic Programme Guide) .....	16
<b>Chapter 2 - Getting started</b>		PVR (Personal Video Recorder) .....	16
Remote control functions .....	6	MHL (Mobile High-Definition Link).....	17
Switch the TV on and off.....	7	Connecting MHL compatible device .....	17
		When using MHL .....	17
<b>Chapter 3 - Installing channels</b>		MHEG function .....	17
Initial setup .....	8	<b>Chapter 6 - Network</b>	
Performing an automatic channel search.....	8	Network connection .....	18
<b>Chapter 4 - Using your TV</b>		Connecting to a wired network .....	18
Accessing channels .....	10	Connecting to a wireless network .....	18
Watching connected devices .....	10	DLNA (Share & See) .....	19
Volume .....	10	Connecting to your PC .....	19
Using TV menus .....	10	Enabling DLNA function .....	19
Selecting menu language .....	10	Adding media from your PC for sharing .....	19
<b>Chapter 5 - Using more of your TV</b>		DLNA application .....	19
Setting up your favourite channels .....	11	GuideOn.....	19
Energy saving .....	11	TV Remote .....	19
Local dimming .....	11	WiFi TV link .....	20
Viewing TV using the 3D function .....	11	HbbTV .....	20
SPDIF type .....	11	HbbTV access .....	20
Audio description .....	12	HbbTV deactivation .....	20
Diagnostics on digital TV channels .....	12	<b>Chapter 7 - Smart TV</b>	
Timeshift .....	12	Access Smart TV portal .....	21
Using subtitles .....	12	<b>Chapter 8 - Other information</b>	
Turning on/off subtitles .....	12	Password in Parental Control.....	22
Enabling subtitle languages on digital TV channels .....	13	Troubleshooting .....	22
Selecting a subtitle type on digital TV channels .....	13	Television specifications .....	22
Using Teletext .....	13	OSS Notice .....	22
Selecting decoding page language .....	13		
Digital Teletext language .....	13		
E-Manual .....	13		
Time access .....	13		
Customising the input settings .....	13		
Software update .....	13		
Changing to shop or home mode .....	14		
Common interface .....	14		
Using the common interface module .....	14		
Accessing common interface services .....	14		
DivX video .....	14		
T-Link .....	14		
Enabling or disabling T-Link .....	14		
Using one-touch play .....	14		
Using system standby .....	14		
Reset shop .....	15		
LED Indicator .....	15		

# Chapter 1 - Connections

English

## Connect the power and antenna

To switch on TV after connecting power cord, press **⏻** or **POWER/⏻**.

Notes:

- Position of power socket varies according to TV model. On certain models, you have to turn on the power switch first.
- Disconnect the power cord before connecting devices.

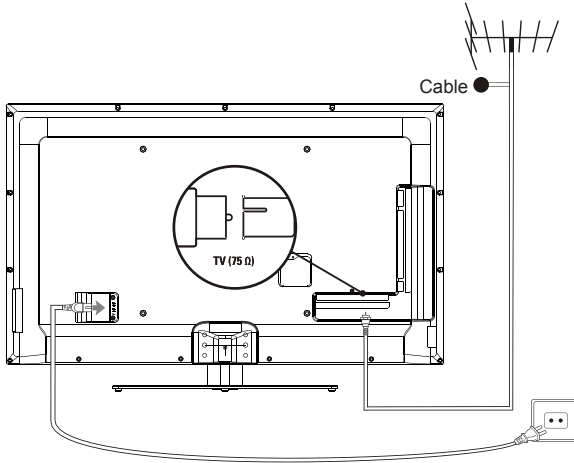

## Connect DVD player, home theatre system

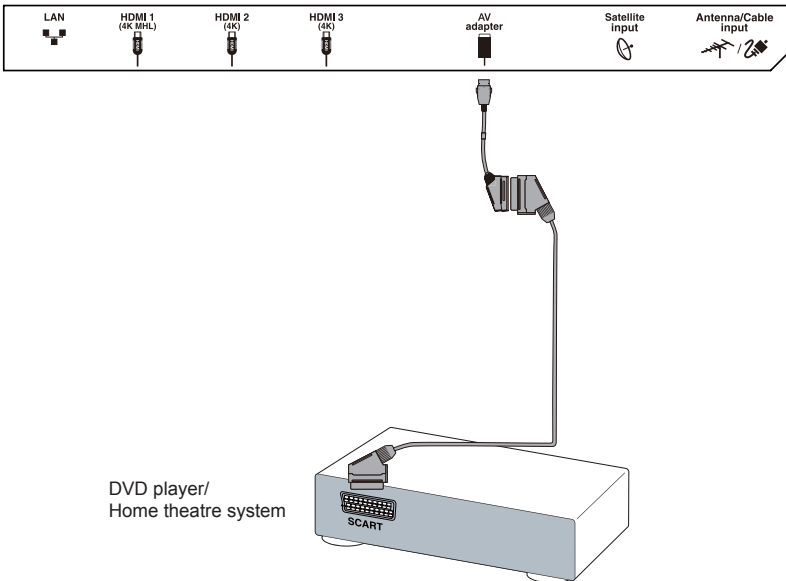

Note: AV output is not available in Norway.

## Connect DVD recorder, cable receiver

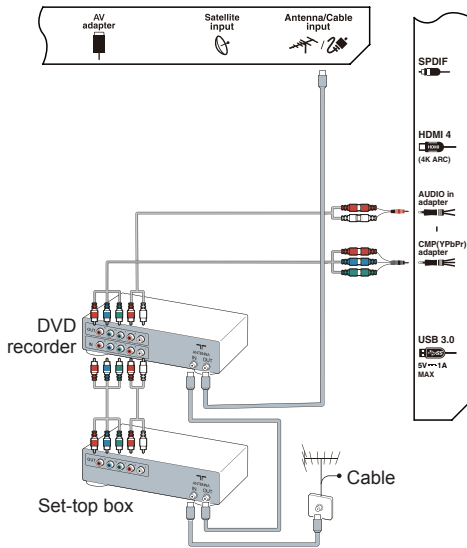

## Connect Blu-ray Disc player, HD game console, HD camcorder, headphones, CI module

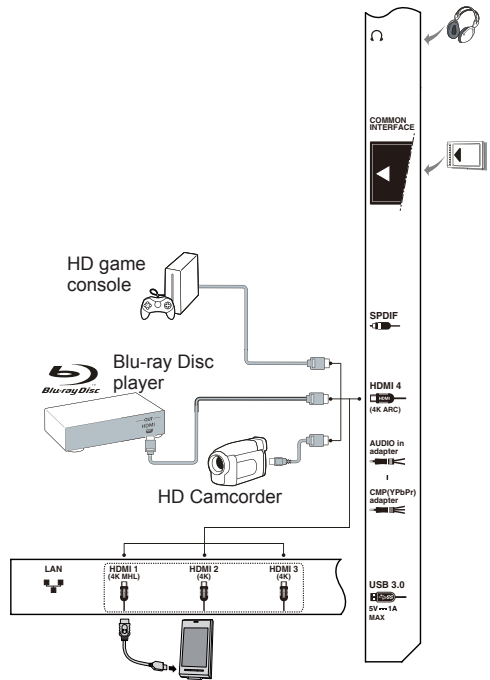

## Notes:

- Your TV might not have all connectors visible on diagram above. Number of USB and HDMI ports may vary according to TV model.
- Button and connector locations may vary according to TV model.
- USB connectors are for data input from USB drives and for connecting other relevant USB devices where applicable. External HDD drives without own power supply have to be connected to USB connector marked with 1A current output.
- All USB devices have to be directly connected to TV set without cable extenders. In case extender is required, maximum 50cm length is recommended. Longer extenders should have ferrite beads.
- ARC (Audio Return Channel) function is only supported on the HDMI port identified with ARC. To use ARC function, please turn on T-Link function first as described in the **T-Link** section.
- MHL (Mobile High-Definition Link) function allows you to link an MHL-capable mobile device to the television and is only supported on the HDMI port identified with MHL. Maximum video resolution is 1080P (60Hz).
- Please connect 4K video sources to HDMI inputs using HDMI high speed cable. Supported 4K (UHD) video formats: 3840x2160 (60Hz, 50Hz, 30Hz, 25Hz, 24Hz). Picture format is fixed to 16:9.
- It is recommended to use high quality and well shielded HDMI cables to avoid possible interferences.
- Excessive sound pressure from earphones and headphones can cause hearing loss.

### Remote control functions

Most of your television's functions are available via the menus that appear on the screen. The remote control supplied with your set can be used to navigate through the menus and to configure all the general settings.

*Note: You are recommended to use the full screen mode. Do not use the display mode with black bars on both sides of the picture (such as 4:3) for a long time; otherwise the TV screen may be damaged permanently.*

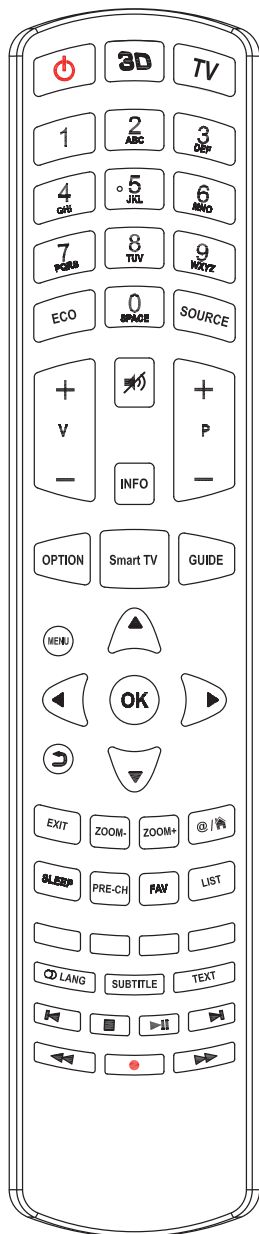

- Standby / quit standby.
- 3D** To select the 3D input format options. (*Not available for some models.*)
- TV** To access TV mode.
- Alphanumeric buttons** To enter channel numbers; to enter a letter, a digit or a symbol in some functions.
- ECO** To select a desired energy saving mode.
- SOURCE** To select connected devices.
- V+/-** To control the volume.
- To switch the sound off and back on.
- INFO** To display programme information, if available.
- P+/-** To change channels.
- OPTION** To display the function menu to perform certain operations; to display the Teletext page in different modes.
- Smart TV** To access the Smart TV portal.
- GUIDE** To toggle the Electronic Programme Guide on or off (only available for digital channels).
- MENU** To access the homepage.
- ▲/▼** To navigate through the menus; to select menu options.
- ◀/▶** To navigate through the menus; to select menu options and change values.
- OK** To confirm an entry or selection.
- To return to the previous menu.
- EXIT** To exit the menu, homepage or Teletext, etc.
- ZOOM-/+** To select the screen mode.
- @/🏠** To access the homepage.
- SLEEP** To select the sleep timer options.
- PRE-CH** To return to the previous channel in TV mode. When the homepage is displayed, press and hold this button for 3 seconds to bring up the History menu.
- FAV** To bring up your favourite channel list.
- LIST** To display the channel list.
- Colour buttons** To select tasks or Teletext pages; to be used for MHEG and HbbTV function.
- LANG** To select a sound type available for selected analogue TV programme; to select an audio language available for selected digital TV programme.
- SUBTITLE** To select a subtitle language available for selected digital TV programme.
- TEXT** To toggle Teletext on or off.
- To select the previous picture, music or video.
- To stop playback.
- To start or pause playback.
- To select the next picture, music or video.
- To start fast reverse.
- Recording button.
- To start fast forward.

**Important:**

Batteries shall not be exposed to excessive heat such as sunshine, fire or the like. Remove batteries when the remote control is not to be used for a long time. Batteries left in equipment may cause damage through deterioration and corrosive leakage, invalidating the guarantee.

To protect the environment use local recycling facilities for battery disposal. Dispose of used batteries according to the instructions.

**CAUTION:** Risk of explosion if batteries are replaced by an incorrect type. Replace only with the same or equivalent type recommended by the equipment manufacturer.

If the batteries in your remote control are run down, you can use the buttons on your TV set. They have the following functions:

For models with below buttons on the set:

For models with below buttons on the set:

	TV mode	In menus		TV mode	In menus
<b>PR+</b> or <b>PR ▲</b>	<b>P+</b>	<b>▲</b>	<b>▲</b>	<b>P+</b>	<b>▲</b>
<b>PR-</b> or <b>PR ▼</b>	<b>P-</b>	<b>▼</b>	<b>▼</b>	<b>P-</b>	<b>▼</b>
<b>VOL+</b> , <b>▲</b> or <b>VOL ►</b>	<b>V+</b>	<b>►</b>	<b>&gt;</b>	<b>V+</b>	<b>►</b>
<b>VOL-</b> , <b>▼</b> or <b>VOL ◀</b>	<b>V-</b>	<b>◀</b>	<b>&lt;</b>	<b>V-</b>	<b>◀</b>
<b>⏠</b> or <b>☰</b>	<b>MENU</b>	<b>MENU</b>	<b>⏻</b>	Features (Short press)	<b>OK</b> (Short press)
<b>OK</b> or <b>⏏</b>	<b>OK</b>	<b>OK</b>	<b>⏻</b>	Return (Long press)	Return (Long press)
<b>⏻</b>	<b>⏻</b>	<b>⏻</b>			

**Switch the TV on and off**

1. When the power cord is connected, the TV will be turned on directly or be in standby mode. If the TV is in standby mode, press the **⏻** or **POWER/⏻** button on the set or the **⏻** button on the remote control to turn it on.
2. To put the TV into standby mode, press the **⏻** or **POWER/⏻** button on the set or the **⏻** button on the remote control. The TV set remains powered up, but with low energy consumption.
3. To switch the TV off, unplug the mains plug from the mains outlet.

(\*On certain models, you have to turn on the power switch first.)

### Initial setup

Initial setup involves selecting all the settings required to be able to search for and store all the analogue and digital channels you can receive.

Make sure that the television is switched on and follow all the steps in turn specified hereafter.

*Note: If the channel search retrieved only the analogue channels it could be caused by poor broadcasting and therefore is not covered by manufacturer warranty. Manufacturers cannot be held responsible for lack of or poor broadcasting in some areas.*

The first time you switch the set on, the **Initial Setup** wizard opens, which guides you through the initial setup process. (Refer to Figure 1.)

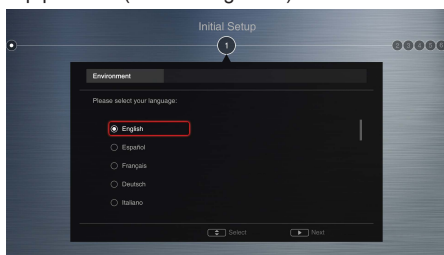

Figure 1

### Step 1: Environment setup

1. Press **▲/▼** to select your language, then press **OK/▶** to enter the next step.
2. Press **▲/▼** to select your country, then press **OK/▶** to enter the next step.

*Note: If you select France or Italy, you will have to enter the password setting menu here to set a password. Use the numeric buttons to enter a four-digit number as your password. (0000 is too simple to be set as your password.) Enter the same code again to confirm the password. After that, you will enter the next step automatically. (In this step, you can only press **◀** to return to the previous step.)*

3. Press **▲/▼** to select your location, then press **OK/▶** to enter the next step.

### Step 2: Network setup

1. Press **▲/▼** to select your network connection type (**Wired** or **Wireless**), then press **OK/▶** to enter the next step.
2. Follow the guides on the screen and press the corresponding buttons on the remote control to proceed.

*Note: You can also skip this step and step 3 by selecting "I do not have a network connection", and connect to the Internet later. For details please refer to section **Network Connection**.*

### Step 3: Software update

1. If the set has connected to the network successfully, it will search for upgrade files automatically.
2. Follow the guides on the screen and press the corresponding buttons on the remote control to proceed.

### Step 4: Channel installation

1. Press **▲/▼** to select **Continue** to install channels.
2. Follow the guides on the screen and press the corresponding buttons on the remote control to proceed.

*Note: To prevent the channel installation process from being interrupted, wait for the message indicating that the installation is complete. You can also skip this step by selecting "I don't want to install channels". In this case, to search and store your channels you may do an automatic channel search by following the instructions in the next section **Performing an automatic channel search**.*

### Step 5: Clock setup

Use the numeric buttons to enter the date and time, then select the **OK** button and press **OK** to confirm.

### Step 6: Congratulations

The **Congratulations!** message appears. Press **OK** to confirm.

### Performing an automatic channel search

This section describes how to search and store channels automatically. This may be done in any of the cases below:

- you have selected "I don't want to install channels" in the initial setup;
- you see "No program info now, please search channels first!" in TV mode;
- you want to update your channels.

1. In TV mode, press **MENU** or **OPTION** on the remote control and select **Settings > Channel > Channel scan**. Press **OK/▶** to enter.
2. The TV installs and arranges channels according to your country. Press **▲/▼** to select **Country**, and press **OK/▶** to enter. Enter the default password 1234 or your own password in case you have changed the password in the **System > Lock** menu. Press **▲/▼** to select your country and press **OK/▶** to confirm.
3. Press **▲/▼** to select **Tuner mode**, then press **OK/▶** to enter. Press **▲/▼** to select **Cable**, **Antenna** or **Satellite**, and press **OK/▶** to confirm. (*Note: Satellite option is available only in selected models.*)
4. Follow a), b) or c) below.
  - a) If you have selected **Cable**.



- Press ▲/▼ to select **Automatic search**, then press **OK/▶** to enter.
  - Press ▲/▼ to select **Channel type**.
    - If you select **Digital & Analogue**, press **OK** to enter. Press ◀/▶ to select your **Scan mode** if available (**Full** or **Advanced**).
      - If you select **Full**, press ▲/▼ to select the **Search** button and press **OK** to start the automatic search for all DVB-C digital and/or analogue channels.
      - If you select **Advanced**, use the numeric buttons to adjust the values for **Frequency**, **Symbol rate**, **Network ID**, and use ◀/▶ to select the **Modulation** mode. Then press ▲/▼ to select the **Search** button and press **OK** to start the automatic search for all DVB-C digital and/or analogue channels.
    - If you select **Digital**, follow the same process as above to start your automatic search for all DVB-C digital channels.
    - If you select **Analogue**, press **OK** to start your automatic search for all analogue channels.
  - b) If you have selected **Antenna**.
    - Press ▲/▼ to select **Automatic search**, then press **OK/▶** to enter.
    - Press ▲/▼ to select **Channel type (Digital & Analogue, Digital or Analogue)**, then press **OK** to start the automatic search for all DVB-T digital and/or analogue channels.
  - c) If you have selected **Satellite**.
    - Press ▲/▼ to select **Automatic search**, then press **OK/▶** to enter.
    - Press ▲/▼ to select **Select satellite** and press **OK** to enter the satellite list. Press ▲/▼ to select your desired satellite and press **OK** to confirm or deselect it. You can also press the red button to edit the parameters of the selected satellite. Press the ⏪ button to return. Then with your desired options of **Scan mode** and **Channels**, press ▲/▼ to select the **Search** button and press **OK** to start scanning.
5. The channel search may take a few minutes. During the process, you can press **OK** to stop the search halfway.
6. After the automatic search, channels are arranged in a preset order. If you wish to skip channels, modify the preset order, rename or delete channels, press **MENU** or **OPTION** on the remote control, select **Settings > Channel > Organiser** and press **OK/▶** to enter.

### Accessing channels

**Using the numeric buttons:** press the corresponding numeric buttons on the remote control to access the channels.

**Using the P+/- buttons:** press the **P+/-** buttons on the remote control or the corresponding buttons on the TV set to scroll through the channels.

**Using the LIST button:** press the **LIST** button on the remote control to display the channel list and press **▲/▼/◀/▶** and **OK** to select channels.

### Watching connected devices

Repeatedly press **SOURCE** on the remote control or **OK** on the TV set to toggle between TV and other input sources. Press **P+/-** to cycle through all TV channels and other input sources.

*Note: Not all models have OK button on the set.*

### Volume

**Volume control:** press the **V+/-** buttons on the remote control or the corresponding buttons on the TV set to increase or decrease the volume.

**Sound mute:** press the **🔇** button to temporarily mute the sound. Press this button again or the **V+** button to restore the sound.

### Using TV menus

1. Press **MENU** on the remote control to display the homepage.
2. Press **▲/▼/◀/▶** to select **Settings** and press **OK** to enter the main menu. (Refer to Figure 2.)

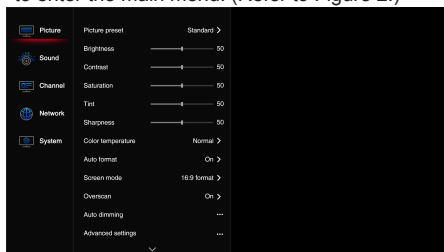

Figure 2

3. Press **▲/▼** to select the desired item, then press **OK/▶** to enter the corresponding submenu.
4. In submenus, press **▲/▼** to select menu options, then press **OK/▶** to enter the option list, the adjustment interface, or the corresponding submenu.
5. Press **↶** to return to the previous menu.
6. Press **EXIT** or **MENU** to close the menu.

*Note: You can also press **OPTION** on the remote control, select **Settings** (if available) and press **OK** to enter the main menu. Some options may not be available for certain signal sources.*

### Selecting menu language

You can choose your preferred menu language following the instructions below.

1. Press **MENU** or **OPTION** on the remote control, select **Settings > System > Menu language > Language** and press **OK/▶** to enter.
2. Press **▲/▼** to select your desired language to display the menus and press **OK** to confirm.
3. Press **EXIT** or **MENU** to close the menu.

### Setting up your favourite channels

You can create a list of your favourite TV channels.

1. Press **LIST**.
2. Press the red button to enter **Select channel list**, press **▲/▼** to select a list and press **OK** to enter.
3. Press **▲/▼/◀/▶** to scroll through the channel list and press the green button to add the selected channel to your favourite list.
4. Repeat this procedure to set up other favourite channels.
5. Press the red button to enter **Select channel list**, select **Favorites** and press **OK** to enter.
6. Press **▲/▼/◀/▶** to select a channel, press **OK** to watch it or press the green button to remove it from your favourite list.
7. Press **LIST** or **EXIT** to exit.

### Energy saving

1. Press **MENU** or **OPTION** on the remote control, select **Settings > Picture > Auto dimming > Energy saving** and press **OK/▶** to enter.
2. Press **◀/▶** to select a desired power saving mode and press **OK** to confirm.
3. Press **EXIT** or **MENU** to close the menu.

### Local dimming

(\* available only in selected models)

Your TV is equipped with local dimming technology which increases local contrast and decreases power consumption.

Follow the steps below to access the local dimming.

1. Press **MENU** or **OPTION** on the remote control, select **Settings > Picture > Auto dimming > Local dimming** and press **OK/▶** to enter.
2. Press **◀/▶** to select **On** or **Off** and press **OK** to confirm.
3. Press **EXIT** or **MENU** to close the menu.

### Viewing TV using the 3D function

(\* not available for some models)

#### WARNING:

- Some viewers may experience discomfort while viewing 3D TV such as dizziness, nausea and headaches. If you experience any such symptom, stop viewing 3D TV, remove your 3D glasses and rest.
- Watching 3D videos too closely or for a long period of time may harm your eyesight.
- A responsible adult should frequently check on children who are using the 3D function.
- Do not use the 3D glasses for any other purpose than viewing 3D videos on a 3D TV.
- Do not use the 3D function or 3D glasses while walking or moving around, otherwise this may result in injuries due to running into objects, tripping, and/or falling.

1. Press **MENU** or **OPTION** on the remote control, select **Settings > Picture > 3D navigation**, and press **OK/▶** to enter. Press **◀/▶** to select **Manual** and press **OK** to confirm.
2. Press **▲/▼** to select **3D** in the **Picture** menu and press **OK/▶** to enter.
3. Wear the 3D glasses first, then select **3D Mode** and press **OK/▶** to enter. Press **◀/▶** to select the desired 3D input format for the playing of 3D video and press **OK** to confirm.
4. Press **▲/▼** to select other menu options:
  - **3D-to-2D**: Select **On** to display 3D image in 2D mode (no 3D effect).
  - **L-R switch**: Select **On** or **Off** to adjust the 3D video between the left and right eyes for better 3D viewing.
  - **Depth of field**: This option is available only in 3D mode. You can adjust it to achieve a good 3D effect with the image.
5. Press **EXIT** or **MENU** to close the menu.

Notes:

- 3D glasses from other manufacturers may not be supported.
- All photo functions are disabled in 3D mode.
- If you change to a different signal source or access Smart TV, the 3D mode will be automatically disabled.
- Some 3D modes may not be available depending on the input format of the 3D video source.
- Supported 3D modes:  
Analogue TV, AV: **2D-to-3D**  
Digital TV, CMP, HDMI, USB, Videos from the Internet: **2D-to-3D, Side-by-Side, Top-and-Bottom, Line Interleave**.
- 3D function in USB mode: During the playback of a selected video from USB, press **OPTION** to display the video menu in the browser mode, then select **3D mode**. For more detail information, refer to the above related descriptions.

### SPDIF type

Connect the TV to an audio device through the **SPDIF** output. To select a proper sound type for your SPDIF output, press **MENU** or **OPTION** on the remote control, select **Settings > Sound > SPDIF type** and press **OK/▶** to enter. Press **▲/▼** to select an option and press **OK** to confirm.

- If you select **Auto**, the SPDIF output format is
- Dolby Digital when the programme's sound format is Dolby Digital or Dolby Digital Plus or HE-AAC.
- PCM when the programme's sound format is MPEG.
- If you select **PCM**, the SPDIF output format is PCM, regardless of the programme's sound format.
- If you select **Off**, this turns off the audio output from the audio device connected to the SPDIF output.

*Note: The options you may choose depend on the programme you are watching. If the sound is ahead of the picture, you can select **SPDIF delay** from the **Sound** menu, press **OK/▶** then press **◀/▶** to adjust the delay time to synchronize the sound with the picture.*

### Audio description

Audio description refers to an additional narration track for blind and visually impaired viewers of visual media, including television programmes and movies. The description narrator talks through the presentation describing what is happening on the screen during the natural pauses in the audio (and during dialogue if deemed necessary).

You can use this feature if the current broadcast contains audio description.

1. Press **MENU** or **OPTION** on the remote control, select **Settings > Sound > Advanced settings > Audio description** and press **OK/▶** to enter.
2. Select the **Audio description** option, press **OK/▶** to enter, press **▲/▼** to select **On** or **Off** and press **OK** to confirm.
3. To adjust the volume for audio description in case this function is turned on, press **▲/▼** to select **Volume**, press **OK/▶** then press **◀/▶** to set the volume.
4. Press **EXIT** or **MENU** to close the menu.

### Diagnostics on digital TV channels

1. Press **MENU** or **OPTION** on the remote control and select **Settings > Channel > Channel diagnostics**.
2. Press **OK/▶** to display some signal information on the current digital channel, such as signal strength, frequency, etc.
3. Press **OK** to confirm.
4. Press **EXIT** or **MENU** to close the menu.

### Timeshift

Allows you to record digital TV programmes so that you will not miss the favourite part even if you go out. Before you use the function, connect a USB drive to the TV first. For the first time, you should do the disk setup for the USB drive.

*Note: This feature is available only in selected products and, due to specific TV network limitations and country technical requirements, might not be available in product or place of installation. This feature might also be blocked by TV network due to copyright protection (HD content, recording protection). Please press **OPTION** on the remote control to check if this feature is available in your product.*

1. Press **MENU** or **OPTION** on the remote control, select **Settings > Channel > Timeshift** and press **OK/▶** to enter.
2. Press **▲/▼** to select **On** and press **OK** to switch on the timeshift function, then press **EXIT** or **MENU** to close the menu.
3. Press **OPTION** on the remote control and select **Timeshift**, then press **OK** to confirm.
4. Follow the directions on the screen to do the disk setup.
5. After the disk setup is done, press **OPTION** and select **Timeshift**.
6. Press **OK** to display the timeshift menu.
  - Press the **▶||** button to pause the picture and begin the timeshift.
  - Press the **▶||** button to play the recorded part.
  - Press the **◀◀** button to fast backward or the **▶▶** button to fast forward.
  - When the timeshift menu disappears and only the timing of the timeshift remains on the screen, you can press **▶||◀◀▶▶** to access the timeshift menu.
  - Press the **■** button to quit the timeshift function.

#### Notes:

- Before you connect the USB drive to the TV, make sure you have backed up the data in the drive to avoid the loss of your important data due to unforeseen malfunction.
- We recommend you use a USB drive with free capacity above 1GB and disk speed faster than 5.0MB/sec.
- The bigger the USB drive free memory for timeshift, the bigger the recording length.
- If you change the channel or the input source in timeshift mode, a message prompts you to select **Yes** or **No**. You can select **Yes** to stop the timeshift function and execute the channel change or the input source change.

### Using subtitles

You can enable subtitles for each TV channel. Subtitles are broadcast via Teletext or DVB-T/DVB-C digital broadcasts. With digital broadcasts, you have the additional option of selecting a preferred subtitle language.

#### Turning on/off subtitles

1. Press **MENU** or **OPTION** on the remote control, select **Settings > Channel > Subtitle** and press **OK/▶** to enter.
2. Select the **Subtitle** option, press **OK/▶** to enter, press **▲/▼** to select **On** or **Off** and press **OK** to confirm.
3. Press **EXIT** or **MENU** to close the menu.

### Enabling subtitle languages on digital TV channels

1. Press **MENU** or **OPTION** on the remote control, select **Settings > Channel > Subtitle > Digital subtitle language** and press **OK/▶** to enter.
2. Press **▲/▼** to select a subtitle language as your preferred language and press **OK** to confirm.
3. Press **▲/▼** to select **Digital subtitle language 2nd** and press **OK/▶** to enter.
4. Press **▲/▼** to select a secondary subtitle language and press **OK** to confirm.
5. Press **EXIT** or **MENU** to close the menu.

**Shortcut operation:** Press **SUBTITLE** on the remote control to directly select a subtitle language available for the selected digital TV programme.

### Selecting a subtitle type on digital TV channels

1. Press **MENU** or **OPTION** on the remote control, select **Settings > Channel > Subtitle > Subtitle type** and press **OK/▶** to enter.
2. Press **▲/▼** to select a subtitle type and press **OK** to confirm. You can select **Hearing Impaired** to display the hearing impaired subtitles with your selected language.
3. Press **EXIT** or **MENU** to close the menu.

## Using Teletext

### Selecting decoding page language

1. Press **MENU** or **OPTION** on the remote control, select **Settings > Channel > Teletext > Decoding page language** and press **OK/▶** to enter.
2. Press **▲/▼** to select a proper type of language in which Teletext will display and press **OK** to confirm.
3. Press **EXIT** or **MENU** to close the menu.

### Digital Teletext language

On digital TV channels, depending on the broadcaster, you may be able to enjoy a service with multiple initial Teletext pages in different languages. This function allows you to select an available language as primary language, which relates to different initial Teletext pages.

1. Press **MENU** or **OPTION** on the remote control, select **Settings > Channel > Teletext > Digital teletext language** and press **OK/▶** to enter.
2. Press **▲/▼** to select a language and press **OK** to confirm.
3. Press **EXIT** or **MENU** to close the menu.

## E-Manual

E-Manual is an electronic user manual for the product. You can find instructions for the features of this TV set.

1. Press **MENU** or **OPTION** on the remote control, select **Settings > System > E-Manual** and press **OK** to enter.
2. Press **◀/▶** to select the contents and press **OK** to enter, then press **◀/▶** to view the instruction pages. Press **↵** to return to the contents.
3. Press **EXIT** to exit.

## Time access

You can access the time from digital channels following the instructions below.

1. Press **MENU** or **OPTION** on the remote control, select **Settings > System > Timer > Clock > Auto synchronization** and press **OK/▶** to enter.
2. Press **▲/▼** to select **On** and press **OK** to confirm.
3. Press **EXIT** or **MENU** to close the menu.

## Customising the input settings

You can name your connected sources according to the type of device instead of the type of socket.

1. Press **MENU** or **OPTION** on the remote control, select **Settings > System > Input settings** and press **OK/▶** to enter.
2. Press **▲/▼** to select a connector your equipment is connected to and press **OK/▶** to enter.
3. Press **▲/▼** to select the type of device connected to this connector and press **OK** to confirm.
4. Press **EXIT** or **MENU** to close the menu.

After configuring, the selected source name will be displayed after the name of the related connector in the source list when pressing **SOURCE** on the remote control or **OK** on the TV set.

*Note: Not all models have OK button on the set.*

## Software update

*Note: Do not switch off or unplug the TV until the upgrade is completed.*

Press **MENU** or **OPTION** on the remote control, select **Settings > System > Software update** and press **OK/▶** to enter. You have the following options to update the software.

- **By USB:** Enables you to install a new version software from a USB stick. Insert the USB stick in which a new version software is stored into a USB socket of the set. Select **By USB** and press **OK/▶** to enter. Follow the on-screen instructions to complete the process.
- **By network:** Enables you to download and install the latest version software from the Internet. Make sure to set up a wired or wireless network connection first then select **By network** and press **OK/▶** to enter. Follow the on-screen instructions to complete the process.

*Note: Keep successful network connection during upgrade.*

- **By channel:** Enables you to install the latest version software if available from the broadcast. Select **By channel** and press **OK/▶** to enter. Follow the on-screen instructions to complete the process.

### Changing to shop or home mode

1. Press **MENU** or **OPTION** on the remote control, select **Settings > System > Location** and press **OK/▶** to enter.
2. Press **▲/▼** to select **Home, Shop** or **Shop with demo** and press **OK** to confirm.
3. Press **EXIT** or **MENU** to close the menu.

*Note: According to the regulation of European Commission 2009/125/EC, in Home mode, TV will be put into standby mode automatically if there is no operation in 4 hours. This feature can be deactivated in the **System > Timer > Auto standby** menu.*

### Common interface

Encrypted digital TV channels can be decoded with a common interface module and a card provided by a digital TV service operator.

The common interface module may enable several digital services, depending on the operator and services you choose (for example, pay TV). Contact your digital TV service operator for more information about services and terms.

#### Using the common interface module

**WARNING: Switch off your TV before inserting a common interface module. Be sure to follow the instructions described below. Wrong insertion of a common interface module may damage both the module and your TV.**

1. Following the directions printed on the common interface module, gently insert the module into the common interface slot on the TV.
2. Push the module in as far as it will go.
3. Turn on the TV and wait for the common interface function to be activated. This may take several minutes.

*Note: Do not remove the common interface module from the slot. Removing the module will deactivate the digital services.*

#### Accessing common interface services

After inserting and activating the common interface module, press **MENU** or **OPTION** on the remote control, select **Settings > System > Common Interface** and press **OK/▶** to enter.

This menu option is only available if the common interface module is correctly inserted and activated. On-screen applications and content are provided by your digital TV service operator.

### DivX video

(\* not available for some models)

This DivX Certified® device has passed rigorous testing to ensure it plays DivX® video.

To play purchased DivX movies, first register your device at vod.divx.com. Find your registration code in the DivX VOD section of your TV's **System** menu, as explained below.

#### Obtain your registration code:

- Press **MENU** or **OPTION** on the remote control.
- Select **Settings > System > Advanced settings > DivX(R) registration**.
- Press **OK/▶** and your registration code will be displayed.

Go to vod.divx.com for more information on how to complete your registration.

#### Deregister your TV:

If you wish to deregister your TV,

- Press **MENU** or **OPTION** on the remote control.
- Select **Settings > System > Advanced settings > DivX(R) deregistration**.
- Press **OK/▶** and a message will guide you.

DivX®, DivX Certified®, DivX Plus® HD and associated logos are trademarks of DivX, LLC and are used under license.

### T-Link

Use this function to search for CEC devices connected to the HDMI sockets in your TV and enable one-touch play and one-touch standby between CEC devices.

#### Enabling or disabling T-Link

1. Press **MENU** or **OPTION** on the remote control, select **Settings > System > Advanced settings > T-Link** and press **OK/▶** to enter.
2. Press **▲/▼** to select **On** or **Off** and press **OK** to confirm.
3. Press **EXIT** or **MENU** to close the menu.

#### Using one-touch play

With one-touch play, pressing the play button on (for example) your DVD remote control starts playback on your DVD device and automatically switches your TV to the correct source, displaying DVD content.

#### Using system standby

With system standby, pressing the **⏻** button on (for example) your TV remote control switches your TV and all connected HDMI devices to standby mode.

*Note: The CEC functions depend on the devices connected and it is possible that some devices may not interoperate correctly when connected to this TV. The user manual or the manufacturer of the problematic devices should be consulted for further information.*



## Reset shop

Allows you to reset the TV to factory default settings.

1. Press **MENU** or **OPTION** on the remote control, select **Settings > System > Reset shop** and press **OK/▶** to enter.
2. Use the numeric buttons to enter the password.
3. Press **◀/▶** to select **OK** and press **OK** to confirm.
4. The **Initial setup** menu appears. Follow the instructions in the section **Initial setup**.

## LED Indicator

Allows you to select the LED indicator on the TV front panel to flash or not.

1. Press **MENU** or **OPTION** on the remote control, select **Settings > System > LED Indicator** and press **OK/▶** to enter.
2. Press **▲/▼** to select **Flashing** or **Normal** and press **OK** to confirm.
3. Press **EXIT** or **MENU** to close the menu.

## Viewing pictures, playing music and watching videos from a USB storage device

Your TV is fitted with USB connectors that enable you to view pictures, listen to music or watch videos stored on USB drives.

Supported file formats:

Picture	JPG/JPEG, BMP, PNG
Music	MP3
Video	AVI, MPG, MPEG, TS, DIVX, MKV, HEVC...

### Notes:

- Some USB keys and USB products like digital cameras or mobile phones are not fully compatible with USB standard so they may not work with the TV media player. Not all USB keys or devices are compatible with the USB function. Not all above formats are recognised. The encoding formats of your files will determine whether or not they can be played.
- Please use high speed (minimum 5MB/s read transfer) USB drives. To play back 4K content it is recommended to use 2.5" or 3.5" HDDs connected to the USB 3.0 port.

When a USB device is connected, press **MENU** on the remote control to display the homepage, press **▲/▼/◀/▶** to select **Media** and press **OK** to enter. Press **◀/▶** to select a USB drive in case you have inserted two or more USB drives and press **OK** to enter.

## All

Use this function to display all supported files, if available.

1. Press **▲/▼** to select **All**, then press **OK/▶** to enter the main file content browser.

2. In the main file content browser, use **▲/▼/◀/▶** to select a file or an inner file folder.
3. Select an inner file folder, press **OK** to enter a sub file content browser.
4. Use **▲/▼/◀/▶** to select a file in either main or sub file content browser. Press **OPTION** to display the function menu in folder mode.
  - **Sort by:** Sort folders and files by **Name** or **Date**.
  - **Parser:** You can select **Recursive** to display all supported files from all sub file folders.
  - **DivX(R) Registration:** You can register or deregister this device.
5. Select a file and press **OK** to play.
6. Press **↶** to return to the previous interface.

## Picture

Use this function to display pictures, if available.

1. Press **▲/▼** to select **Picture**, then press **OK/▶** to enter the main file content browser.
2. Use **▲/▼/◀/▶** to select a picture in either main or sub file content browser, press **OK** to watch, and a slide show begins from the selected picture.
3. Press **◀/▶** to display the previous or the next picture, press **▼** to show the playlist, and press **OK** to display the console.
4. Press **↶** to return to the previous interface.

## Video

Use this function to watch videos, if available.

1. Press **▲/▼** to select **Video**, then press **OK/▶** to enter the main file content browser.
2. Use **▲/▼/◀/▶** to select a video in either main or sub file content browser, press **OK** to watch, and automatic playback begins from the selected video.
3. Press **◀/▶** to fast reverse or forward when the focus is on the progress bar, press **▼** to show the playlist, and press **OK** to pause or play the video.
4. Press **OPTION** to display the video menu in the browser mode. You can select different picture preset settings, play modes and screen modes, etc.
5. Press **↶** to return to the previous interface.

## Music

Use this function to play back music, if available.

1. Press **▲/▼** to select **Music**, then press **OK/▶** to enter the main file content browser.
2. Use **▲/▼/◀/▶** to select a song in either main or sub file content browser, press **OK** to play, and automatic playback begins from the selected song.
3. Press **◀/▶** to select different control buttons shown at the bottom of the TV screen and press **OK** to confirm. You can pause or play the song, select the previous or the next song, select different play modes, and show the playlist, etc. When you move the focus onto the progress bar, you can press **◀/▶** to fast reverse or forward.

4. Press **OPTION** to display the music menu in the browser mode. You can select different sound preset settings, and show the music info if available, etc. You can also select **Audio only** to listen to the music with the screen turned off. Any key press will turn the screen on.
5. Press **↶** to return to the previous interface.

### Using EPG (Electronic Programme Guide)

EPG is an on-screen guide that displays scheduled digital TV programmes. You can navigate, select, view and record programmes.

1. Press **GUIDE** on the remote control, the **Program Guide** menu will appear, which allows you to get information about the current or next programme playing on each channel. Navigate through the different programmes using the **▲/▼/◀/▶** buttons on the remote control.
2. Use the related buttons shown at the bottom of the screen to view EPG.
  - **Prev day:** Press **◀◀** to display EPG of the previous day.
  - **Next day:** Press **▶▶** to display EPG of the next day.
  - **Filter:** Programme guide filter for digital TV programmes.
    - Press **OPTION** to display the type list of the programme.
    - Navigate through the different types and available subtypes using the **▲/▼/◀/▶** buttons on the remote control.
    - Select one or more types, which you want to highlight from the **Type** list, press **OK** to select or deselect. A checkmark will appear to the left of the type when selected. When you select a type, all its subtypes (if available) will be selected accordingly.
    - Also, you can select some desired subtypes (if available) without selecting any type first.
    - Press **OPTION** to exit the type list.
    - After filtering, all your desired digital TV programmes will be highlighted.
  - **Schedule list:** Press the yellow button to bring up the **Schedule list** menu.
    - Press the red button to add a schedule.
    - Press the green button to delete a selected schedule.
    - Press **OK** to edit a selected schedule.
  - **Add schedule:** Press the red button to add a schedule into your schedule list.
    - **Channel number:** use **◀/▶** to select the desired channel.
    - **Start date:** use the numeric buttons to set the start date.
    - **Start time:** use the numeric buttons to set the start time.

- **End time:** use the numeric buttons to set the end time.
- **Schedule type:** use **◀/▶** to select the available schedule type.
  - Select **Reminder** to be reminded that you can switch to the scheduled programme when the time you have set comes.
  - Select **Record** (if available) if you want to start your scheduled recording when the time you have set comes. When time is out and you do not execute any operation, scheduled recording will start automatically.
- **Repeat type:** use **◀/▶** to select different repeat mode for the schedule.
- Press **▲/▼** to select **Add schedule**, and press **OK** to confirm.

3. Press **GUIDE** or **EXIT** to exit EPG.

### PVR (Personal Video Recorder)

Allows you to record your favourite TV programmes. Before you use the function, connect a USB drive to the set first.

*Note: This feature is available only in selected products and, due to specific TV network limitations and country technical requirements, might not be available in product or place of installation. This feature might also be blocked by TV network due to copyright protection (HD content, recording protection). Please press **OPTION** on the remote control to check if this feature is available in your product.*

1. Press **OPTION** on the remote control, select **PVR** and press **OK** to enter.
  - *Shortcut operation: press the **●** button on the remote control to enter PVR directly.*
2. Press the blue button to enter the **Settings** menu, and press **▲/▼/◀/▶** to adjust the recording duration.
3. During recording, PVR mini pane will be shown on the screen to indicate the recording progress.
4. Press the **■** button to stop the recording manually. In normal operation, the recording will stop automatically when the recording duration has passed.
5. The record file is put into a folder named "PVR" on your USB drive. To watch the recorded programme, exit PVR mode first and enter **Media** from the homepage. Select **PVR**, then select the related record file and press **OK** to play.

*Notes:*

- *This feature is available only for non encrypted digital channels. Even when CICAM (CI or CI+) is inserted, this feature is not available on encrypted channels.*



- Before you connect the USB drive to the set, make sure you have backed up the data in the drive to avoid the loss of your important data due to unforeseen malfunction.
  - The bigger the USB drive free memory for the PVR function, the bigger the recording length.
  - If you want to change channel or input source during recording, store the recording data before changing the channel or input source.
  - The set cannot play files normally if the parameters of the file exceed the limitations of the system, the file format is not supported, the file is damaged, or the file cannot be decoded.
  - Do not disconnect the USB drive when the system is reading a file or transmitting data, otherwise the system or the drive may be damaged.
- Some of the functions do not work by remote operation from the TV
  - If MHL does not work properly, also contact the manufacturer of the source device for advice on its use.
  - Do not disconnect the power plug of the TV when the TV is active and the MHL device is connected.
  - Do not disconnect the power plug of the TV when the TV is in standby mode and the MHL device is connected.

### MHEG function

Some digital TV broadcasters offer dedicated digital text or interactive services (for example, BBC1). These services work like normal Teletext with the addition of number, colour and navigation buttons.

*Note: MHEG and subtitles are mutually exclusive and cannot coexist on the same screen. If **Subtitle** is set to **On**, MHEG will not appear. Please follow the instructions in the section **Turning on/off subtitles** to set **Subtitle** to **Off**.*

1. Press the red button or **TEXT** on the remote control.
2. Press **▲/▼/◀/▶** to select or highlight items.
3. Press **OK** to confirm or activate.
4. Press one of the colour buttons to select an option.
5. Press **TEXT** or **EXIT** to exit.

### MHL (Mobile High-Definition Link)

(\* not available for some models)

You can use the following functions by connecting the HDMI port identified with MHL on the TV and the USB port of an MHL compatible mobile phone or similar device with an MHL cable.

- Charge your mobile phones from the TV.
- Two-way remote operation between TV and mobile phone.
- Video or audio output from your mobile phone.

*Notes:*

- These functions may not be available depending on the connected equipment.
- If there is no more battery life left in the connected device, charging will not start.
- To operate the mobile phone with the TV remote control, you need to turn on the **T-Link** function first, then press **OPTION** and select **T-Link > Setup > Guide** menu. Follow the virtual keypad to do operations.

### Connecting MHL compatible device

- Connect the MHL compatible device to the HDMI port identified with MHL on the TV using an MHL cable (not supplied), charging will start automatically.
- When connecting an MHL compatible device to the HDMI port identified with MHL on the TV, switch the TV input source to the corresponding HDMI input.

*Note: Do not connect the MHL compatible device to any ports other than the HDMI port identified with MHL.*

### When using MHL

- Interoperability with MHL devices from other manufacturers is not guaranteed.
- TCL does not provide any guarantee, therefore, against operational failure such as that described below when an MHL source is connected to the TV.
  - No picture or sound

### Network connection

You can set up your TV so that it can access the Internet through your local area network (LAN) using a wired or wireless connection.

#### Connecting to a wired network

You can connect your TV to your LAN using cable in three ways:

- You can connect your TV to your LAN by connecting the LAN port on your TV to an external modem using a Cat 5 cable.
- You can connect your TV to your LAN by connecting the LAN port on your TV to an IP sharer, which is connected to an external modem. Use Cat 5 cable for the connection.
- Depending on how your network is configured, you may be able to connect your TV to your LAN by connecting the LAN port on your TV directly to a network wall outlet using a Cat 5 cable. Note that the wall outlet is connected to a modem or router elsewhere in your house.

1. Press **MENU** or **OPTION** on the remote control, select **Settings > Network > Internet connection** and press **OK/▶** to enter.
2. Press **▲/▼** to select **On** and press **OK** to confirm.
3. Press **▲/▼** to select **Interface** and press **OK/▶** to enter.
4. Press **▲/▼** to select **Ethernet** and press **OK** to confirm.
5. Press **▲/▼** to select **IP settings** and press **OK/▶** to enter. You can set **Address type** to **Auto** or **Manual**.
  - Select **Auto** if you want the TV to acquire and enter the needed IP address automatically.
  - Select **Manual** if you want to enter your IP address manually, then:
    - Press **▼** to go to the first entry field.
    - Enter the **IP address, Subnet mask, Default gateway, Primary DNS** and **Secondary DNS** values. Use the numeric buttons to enter numbers and the **▲/▼/◀/▶** buttons to move from one entry field to another.
    - Once **IP setting** is completed, press **▲/▼/◀/▶** to select **OK** and press **OK** to confirm. The set will try to connect to the network and inform you about the result. Press **↵** to return to the **Network** menu.
6. If you want to check the information on current connection, such as **Interface, Address type, IP address**, etc., press **▲/▼** to select **Information** and press **OK/▶** to enter. Press **↵** to return to the **Network** menu.
7. If you want to check the Internet connectivity, press **▲/▼** to select **Connection test** and press **OK/▶**.

#### Connecting to a wireless network

Your TV is equipped to be connected to your home network wirelessly. To do that you need a wireless router or modem.

1. Press **MENU** or **OPTION** on the remote control, select **Settings > Network > Internet connection** and press **OK/▶** to enter.
2. Press **▲/▼** to select **On** and press **OK** to confirm.
3. Press **▲/▼** to select **Interface** and press **OK/▶** to enter.
4. Press **▲/▼** to select **Wireless** and press **OK** to confirm.
5. Press **▲/▼** to select **Wireless settings** and press **OK/▶** to enter. You can set the wireless network connection in 3 ways:

##### - a) Scan

- Press **▲/▼** to select **Scan** and press **OK/▶** to enter. The TV will search all access points within range. Access points found by the TV will be displayed.
- Press **▲/▼** to select an available access point, then press **OK/▶** to connect.
- Press **↵** to return to the **Wireless settings** menu.

*Note: If you select a protected access point, you will have to enter the corresponding password. Press **OK** on the remote control to display the virtual keyboard to enable you to enter the password.*

##### - b) Manual

Press **▲/▼** to select **Manual** and press **OK/▶** to enter. You will be prompted to enter the correct SSID of an available wireless router to set up the connection. Press **↵** to return to the **Wireless settings** menu.

##### - c) Auto

If your AP (Access Point) supports WPS (Wi-Fi Protected Setup), you can connect to the network via PIN (Personal Identification Number) or PBC (Push Button Configuration). WPS will automatically configure the SSID and WPA key in either mode.

Press **▲/▼** to select **Auto** and press **OK/▶** to enter.

- **PIN:** Select **PIN** and press **OK/▶** to enter. Choose a random PIN code. Make sure this code is installed on the AP. (For the procedures, refer to your router manual.) Select **OK** and press **OK** to set up the connection.
- **PBC:** If your router has a PBC push button, select **PBC** and press **OK/▶** to enter. Press the PBC push button on your router within 2 minutes before you select **OK** and press **OK** again. Your TV will automatically acquire all the network setting values it needs and connect to your network.

- Press **↵** to return to the **Wireless settings** menu.
  - Press **↵** to return to the **Network** menu.
6. If you want to check the information on current connection, such as **Interface, Address type, IP address**, etc., press **▲/▼** to select **Information** and press **OK/▶** to enter. Press **↵** to return to the **Network** menu.
  7. If you want to check the Internet connectivity, press **▲/▼** to select **Connection test** and press **OK/▶**.

### DLNA (Share & See)

*Note: This manual covers products with either **Share & See** or **DLNA** function. **Share & See** is DLNA-compatible.*

#### Connecting to your PC

Make sure to set up a wired or wireless connection from your TV to a router first. Then connect your PC to your router either through a network cable or wirelessly. Also make sure to select **Network > Internet connection** and select **On**, and that your computer firewall won't block the connection.

#### Enabling DLNA function

Press **MENU** or **OPTION** on the remote control, select **Settings > Network > DLNA** and press **OK/▶** to enter. Press **▲/▼** to select **On** and press **OK** to confirm. Follow the steps in turn specified hereafter, then you can enjoy recorded videos, images and music saved on your PC.

#### Adding media from your PC for sharing

Install a DLNA media server on your PC. The simple and familiar server you may install is Microsoft Windows Media Player 11 and 11 above. Follow the instructions below to allow your TV to access the designated files on your PC.

1. Open the Microsoft Windows Media Player 11.
2. Select **Library > Media sharing**.
3. Check the checkbox **Share my media to**.
4. Select the icon of the TV set connected to your PC.
5. Select **Allow** to allow the TV set to access your PC, and select **OK** to enable the access.  
*Note: Use the **Settings** button to customize your desired settings.*
6. Select **Library > Add to Library**.
7. Select your personal folders or folders of other users that you can access for sharing.
8. Select **Add** and press **OK** to enable the addition.

#### DLNA application

Select **Media** from the homepage and press **OK** to enter. Then you can view pictures, listen to music or watch videos, which are stored on your PC.

Supported file formats:

- Picture JPEG, PNG
- Music MP3, WMA, LPCM
- Video MPEG2, MPEG4, WMV

*Notes:*

- If **DLNA** is switched on, the TV will display the list of available DLNA servers which are available in local network.
- Content from third-party DLNA servers may not play correctly on your TV due to compatibility problems.
- When sharing media files from a PC, certain features may be unavailable and, due to the file and encoding formats used, playback issues may occur.
- Because of network related conditions, playback of media files may not be error-free. When this happens, play them from a USB drive.

### GuideOn

GuideOn refers to network EPG, which is an app of preview programme and helps you navigate through a vast amount of content. It provides functionality similar to a printed programme guide by informing you as to which television content is available, such as cast and related information.

1. Press **MENU** or **OPTION** on the remote control, select **Settings > Network > GuideOn** and press **OK/▶** to enter.
2. Press **▲/▼** to select **On** and press **OK** to confirm, then press **EXIT** or **MENU** to close the menu.
3. Press **GUIDE** on the remote control to display the network EPG page. It contains three tabs: **On-Going, Guide** and **Reminders**.
  - Press **◀/▶** to select a tab.
  - Press **OK** to enter.
4. To quit the EPG, press **EXIT** on the remote control.

*Note: To use network EPG, make sure the Internet is connected. In case Internet is connected and **GuideOn** is turned on, network EPG replaces local EPG as described in section **Using EPG (Electronic Programme Guide)** when you press the **GUIDE** button.*

### TV Remote

This function allows you to turn a smart device into a sophisticated remote control, providing more features than your normal TV remote control. You can then control your TV through your smart device.

1. Press **MENU** or **OPTION** on the remote control, select **Settings > Network > TV Remote** and press **OK** to enter. You will see details for downloading the TV Remote application and other related information.

*Note: The following instructions are based on the example of a laptop.*

- Download and install into the laptop the correct TV Remote application for the laptop.
- Make sure the laptop and the TV are in the same home LAN (local area network) or network segment.
- Run the TV Remote application on the laptop, it will search and communicate with the TV automatically to enable the TV Remote functionality.
- Once the TV and the laptop are linked as described in step 4, you will be able to enjoy the extra features of the TV Remote function.

To quit the TV Remote function, press EXIT on the remote control.

### WiFi TV link

*(\*not available for some models)*

WiFi TV link allows you to share screen and sound of your device such as a smartphone or a tablet to your TV, wirelessly (i.e. without cables). This makes it possible to view on your TV, at the same time, what your smartphone or tablet is showing. For example, you can launch a video on your smartphone and display it simultaneously on your TV, or use your tablet as game controller with content displayed on the big screen of your TV.

Whenever you want to use WiFi TV link, you must first activate this function in your TV. To do it follow the steps below:

- Press **MENU** or **OPTION** on the remote control, select **Settings > Network > WiFi TV link** and press **OK** to enter. You will see details for this function.
- Find the WiFi TV link function in your device. Different devices may have different names for this function.
- Then click the "connection" function on the device. If connected successfully, you will see on your TV screen what the device is showing.

*Note: TCL does not guarantee that the use of the WiFi TV link function will be smooth or error-free since not all devices are compatible with the WiFi TV link function.*

### HbbTV

HbbTV (Hybrid broadcast broadband TV) is a service offered by certain broadcasters and available only on some digital TV channels. HbbTV delivers interactive television over broadband Internet. These interactive features are added to and enrich the normal digital programmes, and include services such as digital teletext, electronic programme guide, games, voting, specific information related to the current programme, interactive advertising, information magazines, catch-up TV, etc.

To use HbbTV please ensure your TV is connected to Internet and HbbTV is switched on.

*Notes:*

- *HbbTV services are broadcast- or country-dependent and may be unavailable in your area.*
- *You cannot download files to your TV with HbbTV function.*
- *Application provider or broadcasting related conditions may cause an HbbTV application to be unavailable momentarily.*
- *To access HbbTV applications you must connect your TV to the Internet via a broadband link. HbbTV applications may not work correctly in case of network related issues.*

### HbbTV access

- Press **MENU** or **OPTION** on the remote control, select **Settings > System > HbbTV mode** and press **OK** to enter.
- Press **▲/▼** to select **On** and press **OK** to confirm.
- When you tune to a TV digital channel that offers HbbTV, this will be signalled to you by an on-screen indication (generally a red button, but other colour buttons may also be used). Press the indicated colour button to open the interactive pages.
- Use **▲/▼/◀/▶** and the colour buttons to navigate through the HbbTV pages and press **OK** to confirm.

### HbbTV deactivation

To avoid disturbances that may be caused by HbbTV broadcasting tests, you can turn off the HbbTV function:

- Press **MENU** or **OPTION** on the remote control, select **Settings > System > HbbTV mode** and press **OK** to enter.
- Press **▲/▼** to select **Off** and press **OK** to confirm.

Allows you to enjoy Internet Applications (Apps), specially adapted Internet websites for your TV. You can control the Apps with the TV remote control.

**WARNING:**

- Configure the network settings before using Smart TV applications.
- Slow responses and/or interruptions may occur, depending on your network conditions.
- If you experience a problem using an application, please contact the content provider.
- According to circumstances of the content provider, an application's updates or the application itself may be discontinued.
- Depending on your country's regulations, some applications may have limited service or not be supported.
- Changes in application content may be made without prior notice by the service provider.

**Access Smart TV portal**

1. Press **MENU** to display the homepage.
2. Press **▲/▼/◀/▶** to select **Smart TV** and press **OK** to enter the Smart TV portal.

Shortcut operation: Press **Smart TV** on the remote control to access the Smart TV portal directly.

*Note: Since the connection with Internet takes time, it's recommended that you wait a few minutes to use the Smart TV feature after activation of TV from standby.*

### Password in Parental Control

- The default password is 1234. You can change it to a new one.
- The super password is 0423. If you forget your code, enter the super password to override any existing codes.

### Troubleshooting

Please check the following list before requesting service.

#### There is no picture or sound.

- Make sure the power cord is properly inserted in the power outlet.
- Make sure the source type is set correctly.
- Make sure the antenna is properly connected.
- Make sure the volume is not set to minimum or the sound is not set to mute.
- Make sure the headphones are not connected.
- The TV may be receiving a signal other than from TV broadcasting stations.

#### Picture is not clear.

- Make sure the antenna cable is properly connected.
- Consider whether your TV signal is being properly received.
- Poor picture quality can occur due to a VHS camera, camcorder, or other peripheral being connected at the same time. Switch off one of the other peripherals.
- The 'ghost' or double image may be caused by obstruction to the antenna due to high-rise buildings or hills. Using a highly directional antenna may improve the picture quality.
- The horizontal dotted lines shown on the pictures may be caused by electrical interference, e.g., hair dryer, nearby neon lights, etc. Turn off or remove these.

#### Picture is too dark, too light or tinted.

- Check the colour adjustment.
- Check the brightness setting.
- Check the sharpness function.

#### Remote control does not work.

- Check the batteries of the remote control.
- Make sure the remote sensor window on the TV front is not under strong fluorescent lighting.
- Try to clean the remote sensor window on the TV front with a soft cloth.

If the above suggestions do not solve your technical issue, please refer to the warranty card for service information.

### Television specifications

TV Broadcasting	PAL/SECAM BG/DK/I/LL'
Receiving channels	VHF/UHF/Cable
Tuner type	Frequency synthesized

### Operating Conditions

Temperature 5°C - 35°C (41°F - 95°F)  
Humidity 20 - 80% (non-condensing)

### Storage Conditions

Temperature -15°C - 45°C (5°F - 113°F)  
Humidity 10 - 90% (non-condensing)

### OSS Notice

This product uses the GPL (Version 2) and LGPL (version 2.0 and 2.1) and MPL (version 1.1).

To send inquiries and requests for questions

regarding open source, contact nearest TCL office.

This product uses some software programs which are distributed under the Independent JPEG Group.

This product uses some software programs which are distributed under the libpng Project.

This product uses some software programs which are distributed under the Freetype Project.

This product uses some software programs which are distributed under the Freedesktop Project.

This product uses some software programs which are distributed under the ICU Project.

This product uses some software programs which are distributed under the SQLite Project.

This product uses some software programs which are distributed under the zlib Project.

This product uses some software programs (libxml2) which are distributed under the MIT.

This product uses some software programs which are distributed under the GPL/LGPL/MPL.

GPL software: Linux Kernel, gettext, gtk+, libsoup, webkit(gtk), atk, glib, pango, glib-networking, libiconv, pixman, gnutls

LGPL software: libgcrypt, enchant, libgpg-error, cairo, DFB (DirectFB)

### [Legal Statement] of TCL - manufacturer of this TV set

Due to the various capabilities of products featuring the SmartTV - Services, as well as limitations in the available content, certain features, applications, and services may not be available on all devices or in all territories. Some features on SmartTV may also require additional peripheral devices or membership fees that are sold separately. Please visit our website for more information on specific device information and content availability. The services and availability of content through SmartTV are subject to change from time to time without prior notice.

All content and services accessible through this device belong to third parties and are protected by copyright, patent, trademark and/or other intellectual property laws. Such content and services are provided solely for your personal noncommercial use. You may not use any content or services in a manner

that has not been authorized by the content owner or service provider. Without limiting the foregoing, unless expressly authorized by the applicable content owner or service provider, you may not modify, copy, republish, upload, post, transmit, translate, sell, create derivative works, exploit, or distribute in any manner or medium any content or services displayed through this device.

YOU EXPRESSLY ACKNOWLEDGE AND AGREE THAT USE OF THE DEVICE IS AT YOUR SOLE RISK AND THAT THE ENTIRE RISK AS TO SATISFACTORY QUALITY, PERFORMANCE AND ACCURACY IS WITH YOU. THE DEVICE AND ALL THIRD PARTY CONTENT AND SERVICES ARE PROVIDED "AS IS" WITHOUT WARRANTY OF ANY KIND, EITHER EXPRESS OR IMPLIED. TCL EXPRESSLY DISCLAIMS ALL WARRANTIES AND CONDITIONS WITH RESPECT TO THE DEVICE AND ANY CONTENT AND SERVICES, EITHER EXPRESS OR, IMPLIED, INCLUDING BUT NOT LIMITED TO, WARRANTIES OF MERCHANTABILITY, OF SATISFACTORY QUALITY, FITNESS FOR A PARTICULAR PURPOSE, OF ACCURACY, OF QUIET ENJOYMENT, AND NON-INFRINGEMENT OF THIRD PARTY RIGHTS. TCL DOES NOT GUARANTEE THE ACCURACY, VALIDITY, TIMELINESS, LEGALITY, OR COMPLETENESS OF ANY CONTENT OR SERVICE MADE AVAILABLE THROUGH THIS DEVICE AND DOES NOT WARRANT THAT THE DEVICE, CONTENT OR SERVICES WILL MEET YOUR REQUIREMENTS, OR THAT OPERATION OF THE DEVICE OR SERVICES WILL BE UNINTERRUPTED OR ERROR-FREE. UNDER NO CIRCUMSTANCES, INCLUDING NEGLIGENCE, SHALL TCL BE LIABLE, WHETHER IN CONTRACT OR TORT, FOR ANY DIRECT, INDIRECT, INCIDENTAL, SPECIAL OR CONSEQUENTIAL DAMAGES, ATTORNEY FEES, EXPENSES, OR ANY OTHER DAMAGES ARISING OUT OF, OR IN CONNECTION WITH, ANY INFORMATION CONTAINED IN, OR AS A RESULT OF THE USE OF THE DEVICE, OR ANY CONTENT OR SERVICE ACCESSED BY YOU OR ANY THIRD PARTY, EVEN IF ADVISED OF THE POSSIBILITY OF SUCH DAMAGES.

Third party services may be changed, suspended, removed, terminated or interrupted, or access may be disabled at any time, without notice, and TCL (manufacturer of Thomson branded TVs) makes no representation or warranty that any content or service will remain available for any period of time. Content and services are transmitted by third parties by means of networks and transmission facilities over which TCL has no control. Without limiting the generality

of this disclaimer, TCL expressly disclaims any responsibility or liability for any change, interruption, disabling, removal of or suspension of any content or service made available through this device. TCL may impose limits on the use of or access to certain services or content, in any case and without notice or liability. TCL is neither responsible nor liable for customer service related to the content and services. Any question or request for service relating to the content or services should be made directly to the respective content and service providers.



TCL declares that this TV is in compliance with the essential requirements and other relevant provisions of Directive 1999/5/EC (if delivered with WiFi access, built-in or USB dongle). The official declaration of conformity may be found at [www.thomsontv.eu](http://www.thomsontv.eu) in support area.