

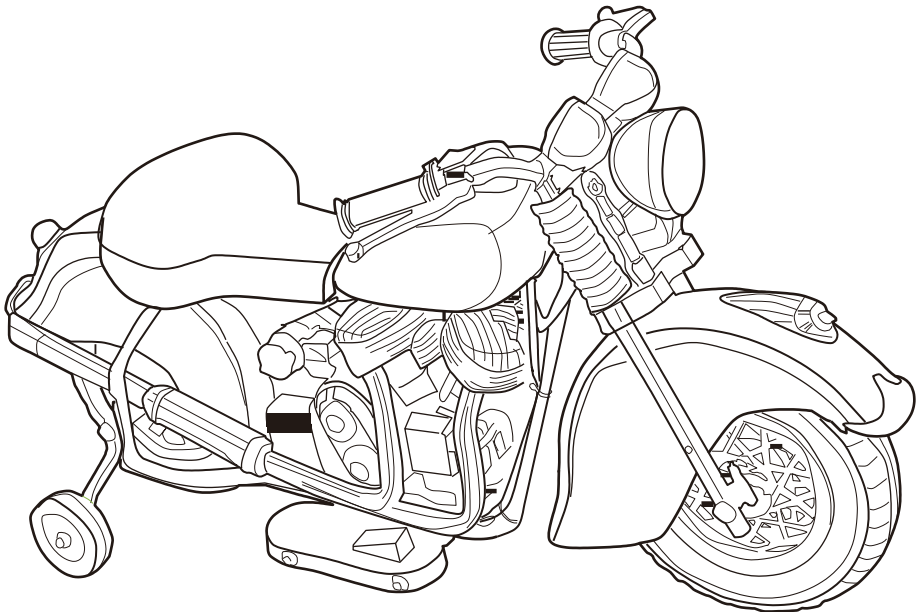

USER'S MANUAL

ITEM# GT00100

INDIAN MOTORCYCLE (6V)



Trademark of Indian Motorcycle International LLC. Used under license. ®

Illustrations are representative only. Design and style may vary.
Carefully read this manual before use and keep for future reference.



Customer Service:

1-855-GIGGOTY (1-855-444-4689)

customerservice@giggotoys.com

ASSEMBLY INSTRUCTIONS

WARNING:

Assembly must be performed by an adult. Improper assembly may result in serious operator injury or death. Do not allow children to play with the parts prior to assembly, the plastic bag or packing material covering the vehicle. Injury may occur. Small parts are a choking hazard! Plastic bags are suffocation risk– discard plastic bags immediately upon opening.

TECHNICAL DATA

Speed: 2 MPH, 2.5 km/hr

Battery: 6V4AH sealed dry cell battery

Time for charging: 8 – 12 hours

Ages: 2 – 4 years old

Load Max capacity: 55 pounds/ 25 kgs

Charger: Input 120 – 240 Volt, depending on local voltage; Output – DC 6V500mA or 7.5V500mA

Life of Battery: Approximately 200 hours, 300 charges.

Working time: About 40 to 90 minutes, depending on weight of the rider, road surface and length of time prior to last battery charging.

Functions: Forward, backward, stop, working headlight and tail light, engine sound.

PARTS LIST

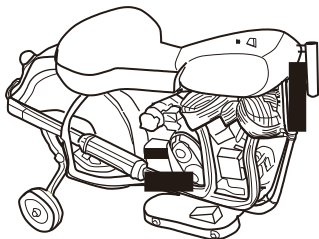

Vehicle Body

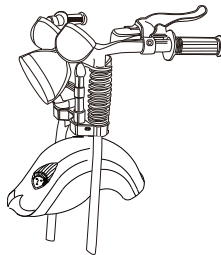

Handlebar Assembly



Front Wheel

Cap bushings



Charger

Hardware Bag

VEHICLE ASSEMBLY

Tools needed (not included): Phillips head screwdriver and two (2) adjustable wrenches. Some parts of this vehicle may come partially assembled.

1. Insert a cap bushing into each side of the axle hole at the center of the front wheel. Position front wheel between the forked legs of the handlebar assembly. Insert axle through one fork leg placing a round spacer between the fork leg and the cap bushing in the front wheel. (See illustration).
2. Push the axle through the front wheel placing another spacer on the opposite side of the wheel prior to pushing the axle through the opposite fork. Add a washer to both sides of the axle and then hand-tighten a nut on each end of axle. Now, using two (2) adjustable wrenches, hold one nut as you tighten the other. Reverse this process to tighten the nut on opposite side.

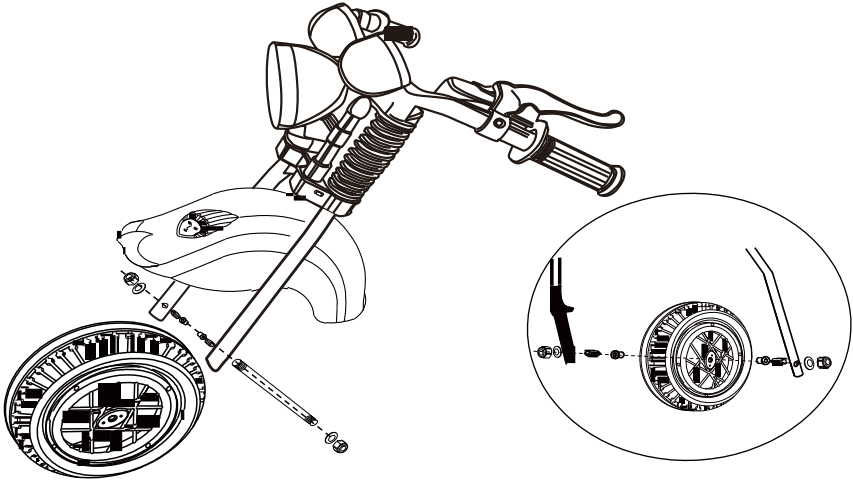

3. Remove the steering rod and nut from the handle bar assembly. (See illustration.) Line up the holes in the handle bar assembly with the holes in the vehicle body and insert the steering rod. Attach the nut at the bottom. Tighten the steering rod and nut with two (2) adjustable wrenches.
4. Connect the two plugs for the headlight. (See illustration)

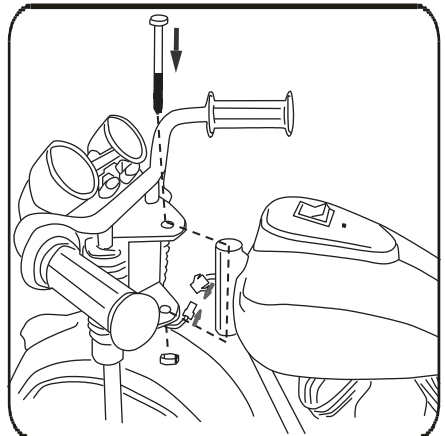

CHARGING THE BATTERY

1. Battery wires are not connected at the factory so before charging the battery for the first time you must remove the battery compartment cover and connect the wires. Connect the wires black to black and red to red. Now replace the battery cover. You are ready to begin charging the battery.

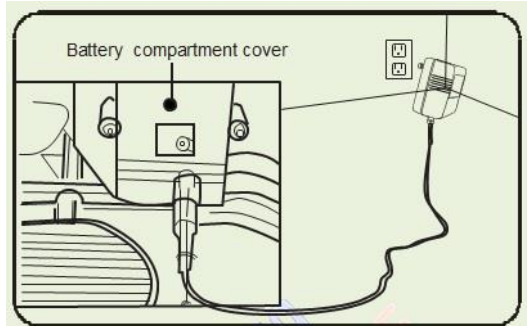

2. Plug the charger into the vehicle jack.
Next insert the charger plug into a wall outlet. After 8 - 12 hours, battery should be fully charged. Unplug the charger from the wall outlet and disconnect the charger from the jack on the vehicle.

REPLACING THE BATTERY

1. Unscrew and remove the battery compartment cover.
2. Unplug the battery connectors and remove the used battery from the battery compartment.
3. Put the new battery into the battery compartment.
4. To charge the new battery, refer to "CHARGING THE BATTERY" above
5. Dispose of the used battery in an appropriate waste collection center.

You can help protect the environment! Please remember to follow local regulations regarding the disposal of batteries in the required manner.

Turn in non-working electrical equipment at an appropriate waste disposal center.

RECHARGING PRECAUTIONS AND WARNING

1. The charger is not a toy. The battery should be charged by an adult only.
2. Do not allow children to play with the charger or to recharge the battery.
3. Before the first use, you should fully charge the battery for 8-12 hours. Do not charge the battery for more than 15 hours to avoid overheating the charger.
4. To recharge the battery, plug the charger into vehicle first and then into a household wall outlet. The battery will begin charging automatically. After the battery is fully charged, unplug the charger from the battery and then from the wall outlet. Secure battery charger and place out of the reach of children.
5. It is normal for the charger to feel warm during charging. If the charger feels hot, stop charging the vehicle and check the battery and charger for damage.
6. When the vehicle begins to run slowly, recharge the battery.

7. To lengthen the life of the battery, always recharge the battery before storing and at least every 30 days thereafter.
8. Use only battery and charger recommended by the manufacturer.
9. Charger should be examined regularly for damage to the cord, plug and other parts. If any damage is found, charger should be repaired or replaced immediately.
10. Do not use a damaged charger.

IMPORTANT: To prolong battery life, recharge the battery after each use. You should also charge the battery if the vehicle has not been used for 30 days or more.

CAUTION

1. The battery compartment is located near the front footrest. Unscrew the battery cover to check the battery terminals and wire connections.
2. Open the battery compartment cover carefully because the wires are secured to the cover. Please note, do not connect Red to Black or Black to Red as a short circuit will occur which may result in damage to the vehicle and can result in a fire.
3. Make sure the battery is connected for use before you reattached the battery compartment cover!
4. For long term storage of the vehicle, disconnect the wires from the battery terminals. Do not store battery in extreme temperatures.

OPERATION

1. To change the direction of the vehicle, set the direction switch to:
“Forward” position, step on the accelerator, the vehicle will move forward.
“Reverse” position, step on the accelerator, the vehicle will move in reverse.
Middle position “Neutral”, step on the accelerator, the vehicle will not move.
2. Headlight comes on when vehicle is moving forward.
3. Taillight comes on when the vehicle is moving in reverse.
4. Press the sound button down to hear the engine sound. Press again to turn sound off.

OVERLOAD PROTECTION

This vehicle battery is equipped with an auto-recovery device. If the vehicle's electrical system is overloaded or if it is being operated incorrectly or if power current is greater than the vehicle's electrical system is designed to accept; the device will shut power off automatically and the vehicle will stop working. After two minutes, the device will reset itself and the vehicle will resume normal operation.

WARNING:

1. **NEVER** change direction by pressing Forward/Backward switch while the vehicle is moving. You must stop before changing direction.
2. This toy is not suitable for children under 2 years of age.



WARNING:

TO REDUCE THE RISK OF INJURY, ADULT SUPERVISION IS REQUIRED. NEVER USE IN ROADWAYS, NEAR MOTOR VEHICLES, ON OR NEAR INCLINES OR STEPS, SWIMMING POOLS OR OTHER BODIES OF WATER. USE TOY ONLY ON FLAT SURFACES. ALWAYS WEAR SHOES AND NEVER ALLOW MORE THAN ONE (1) RIDER.



WARNING:

Protective equipment should be worn. Not to be used in traffic.



WARNING:

ADULT ASSEMBLY REQUIRED!

IMPORTANT!

- An adult must read this manual completely and carefully before allowing a child to operate the vehicle. Vehicle must be assembled by an adult.
- Child should always be supervised by an adult while operating the vehicle.
- Do not overload the vehicle. Product's maximum weight is 55LBS/25kgs.
- Only one (1) child should ride the vehicle at a time.
- Do not operate the vehicle on grass, sand, mud, or rugged surfaces to avoid damaging the vehicle.
- Do not use the vehicle in dangerous places such as public highways, streets, roads or any place where automobile traffic may be present.
- Do not operate the vehicle on hilly areas or slopes.
- Do not operate the vehicle near swimming pools or other bodies of water.
- Do not operate the vehicle in the dark or in dimly lit areas.
- Only use batteries recommended by the manufacturer for the vehicle.
- Only use the battery charger that comes with the vehicle or otherwise specified by the manufacturer.

- Do not clean the vehicle while the battery charger is attached.
- Clean the vehicle using only a damp cloth. Never submerge the vehicle in water or spray with water.
- We recommend wearing protective equipment when in use; such as a helmet, gloves, knee pads, elbow pads, etc.

ELECTRICAL AND ELECTRONIC EQUIPMENT THAT ARE SUPPLIED WITH BATTERIES (INCLUDING INTERNAL BATTERIES)

WEEE Directive & Product Disposal



At the end of its serviceable life, this product should not be treated as household or general waste. It should be handed over to the applicable collection center for the recycling of electrical and electronic equipment.

Internal / Supplied Batteries Notice to customers:

This symbol on the battery indicates that the battery is to be collected separately.

The following applies to users in the European Union.

This battery is designed for separate collection at an appropriate collection center. Do not dispose of as household waste. For more information, contact the retailer or local authorities in charge of waste management.

TROUBLESHOOTING

1. If the vehicle fails to move:
 - Make sure the direction switch is not set to the middle position.
 - Make sure the battery wires are connected properly.
 - Recharge battery, if necessary.
 - Check the battery. If it is damaged or exhausted, replace it.
2. If the vehicle runs slowly: Recharge the battery.
3. If the battery cannot be recharged: Battery or charger may need to be replaced.
4. If the headlight or tail light does not work, check to see if the wires are loose.



Customer Service:
1-855-GIGGOTY (1-855-444-4689)
customerservice@giggotoys.com