



## **USER MANUAL MONSOON FX GB**

**Keep this manual for future reference.**



## 1. INTRODUCTION AND UNPACKING

Thank you for purchasing the MICROH MONSOON FX GB effect fixture. For your own safety and knowledge, please read this manual before installing or operating the device. This manual covers the important information on installation and applications. Please install and operate the fixture according to instructions. Meanwhile, please keep this manual for future reference.

The MICROH MONSOON FX GB effect fixture is manufactured following CSA standards, complying with international standard DMX512 protocol. This fixture is applicable but not limited to large-scale live performances, theater, studio, nightclubs and discos.

The MICROH MONSOON FX GB 3 in 1 effect fixture features a two colour laser, strobe and a moonflower effect. Please carefully unpack it when you receive the fixture and check if it was damaged during the transportation. Please check whether the following items are included inside the box:

**Fixture – One**

**Power Cord – One**

**User Manual – One**

## 2. SAFETY INSTRUCTIONS



This device has been delivered in safe working condition. In order to maintain this condition and to ensure safe operation, it is absolutely necessary for the user to follow the safety instructions and warning notes written in this user manual.



**Important:**

*Damages caused by the disregard of this user manual are not subject to warranty. The dealer will not accept liability for any resulting defects or problems.*

If the device has been exposed to temperature changes, do not switch it on immediately. The arising condensation could damage the device. Leave the device switched off until it has reached room temperature, and is dry.



This device falls under protection-class I, therefore it is essential that the device be grounded. The electrical connection must be carried out by a qualified technician.

The device should only be used with rated voltage and frequency. Make sure that the available voltage is not higher than 120V as stated at the end of this manual.

Make sure the power cord is never crimped or damaged in any way, as this could cause shock and damage. If your power cord is damaged in any way, please purchase a new cable from your local MICROH dealer. Always disconnect power, when the device is not in use or before cleaning it. Never pull out the plug by tugging the power cord.

During initial start-up, some smoke or smell may arise. This is a normal process, and does not necessarily mean that the device is defective. It should decrease gradually. Please do not project the beam onto combustible substances.

Fixtures cannot be installed on or near combustible substances. Keep more than 50cm distance from wall for proper ventilation and air flow. If your fixture is or has become damaged in any way, it shall be exclusively replaced or repaired by the manufacturer to avoid any hazard.

	<b>CAUTION!</b> Never touch the device during operation! The housing may heat up
	<b>CAUTION!</b> Never look directly into the light source, as sensitive persons may suffer an epileptic shock.
	<b>CAUTION!</b> The electric connection must only be carried out by a qualified electrician.

### 3. MOUNTING AND INSTALLATION

**Caution:** For added protection, mount the fixtures in areas outside walking paths, seating areas, or in areas where the fixture might be reached by unauthorized personnel. Before mounting the fixture to any surface, make sure that the installation area can hold a minimum point load of 10 times the device's weight. Fixture installation must always be secured with a secondary safety attachment, such as an appropriate safety cable. Never stand directly below the device when mounting, removing, or servicing the fixture.

Whether installing inverted on a truss / ceiling or set on a flat level surface (see illustration below). Be sure this fixture is kept at least 0.5m (1.5 ft.) away from any flammable materials (decoration etc.). Always use and install the supplied safety cable as a safety measure to prevent accidental damage and/or injury in the event the clamp fails.

**Mounting Points:** Overhead mounting requires extensive experience, including calculating working load limits. A knowledge of the installation material being used and periodic safety inspection of all installation material and the fixture are all imperative and should only be performed by a qualified technician. Improper installation can result in bodily injury and damage.

Be sure to complete all rigging and installation procedures before connecting the main power cord to the appropriate wall outlet.

**Clamp Mounting:** The MICROH MONSOON FX GB provides a unique mounting bracket assembly that integrates 2 brackets to be used to mount on a truss or the floor. When mounting this fixture to truss, be sure to secure an appropriately rated clamp to the included bracket fitted through the center hole. As an added safety measure, be sure to attach at least one properly rated safety cable to the fixture.



Regardless of the rigging option you choose for your MICROH MONSOON FX GB, always be sure to secure your fixture with a safety cable. The fixture provides a built-in rigging point for a safety cable on the hanging bracket as illustrated above. Be sure to only use the designated rigging point for the safety cable and never secure a safety cable to a carrying handle.

**Proper Usage:** This product is for overhead mounting only. For safety purposes, MICROH DJ recommends mounting lighting effect products on steady elevated platforms or sturdy overhead supports using suitable hanging clamps. In all cases, use safety cables. Obtain appropriate mounting hardware from your lighting vendor.

International laser safety regulations require that laser products must be operated in the fashion illustrated below, with a minimum of 3 meters (9.8 ft) of vertical separation between the floor and the lowest laser light. Additionally, 3 meters of horizontal separation is required between laser light and audience or other public spaces.

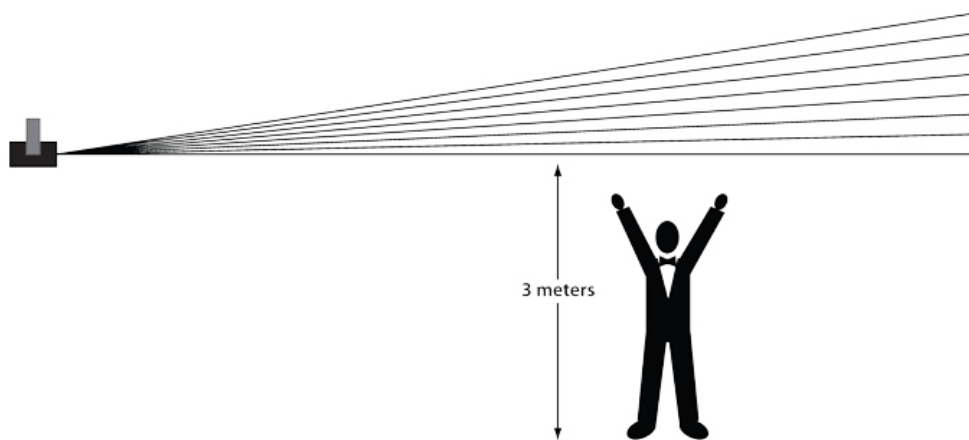

CAUTION! USE OF CONTROLS, ADJUSTMENTS, OR PROCEDURES OTHER THAN THOSE SPECIFIED IN THIS USER MANUAL MAY RESULT IN HAZARDOUS RADIATION EXPOSURE.

## 4. DMX-512 CONTROL CONNECTIONS

This fixture complies with international USITT DMX standards and can be used with either a 3 pin or 5 pin DMX connector. Plug in the provided 3 pin XLR cable to the female 3-pin XLR output of your controller and the other side to the male 3-pin XLR input of the MICROH MONSOON GB. To connect the units to DMX, you must daisy chain the fixtures together as referred in the diagram below. Always end your DMX-512 connection with a DMX terminator.

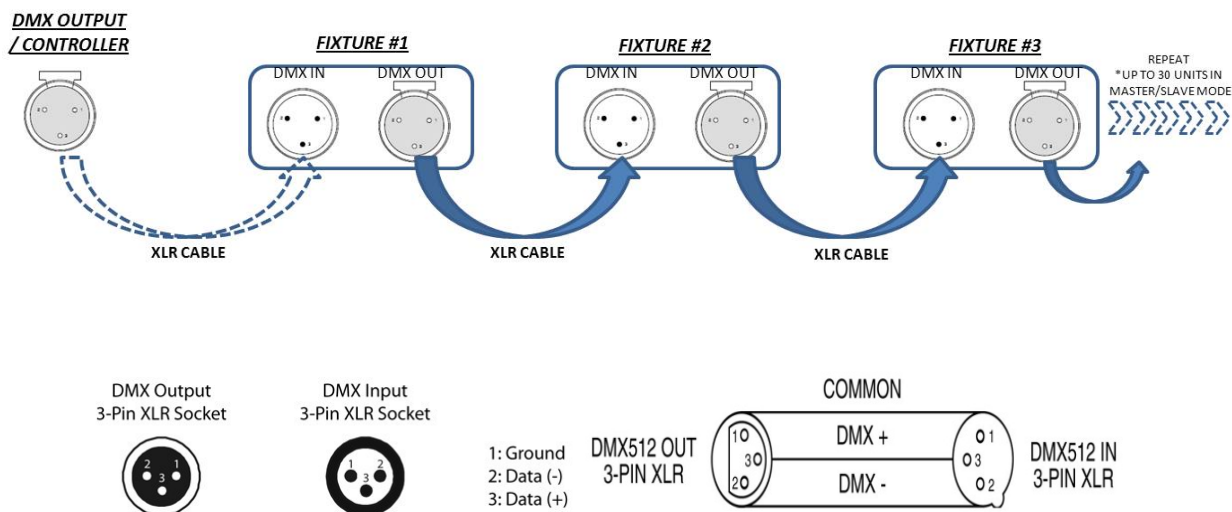

For installations where the DMX cable has to run a long distance, or is in an electrically noisy environment, it is recommended to use a DMX terminator. This helps in preventing corruption of the digital control signal by electrical noise. The DMX terminator is simply an XLR plug with a 120  $\Omega$  resistor connected between pins 2 and 3, which is then plugged into the output XLR socket of the last fixture in the chain. Please see illustrations below.

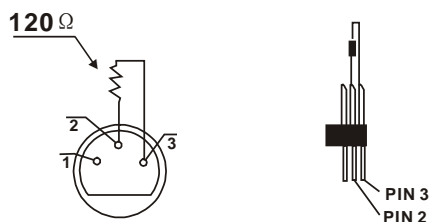

## 5. SETUP MENU

AUTO	AUT 0	LASER+RGBWA+8 WHT	SPEED S 1 - S100 SLOW/FAST S 0 DEFAULT	ENTER
	AUT 1	LASER+RGBWA		
	AUT 2	LASER+8 WHT		
	AUT 3	RGBWA+8 WHT		
	AUT 4	RGBWA		
	AUT 5	LASER		
	AUT 6	8 WHT		
SOUND	SOU 0	LASER+RGBWA+8 WHT	ADJUST SENSITIVITY WITH THE POTENTIOMETER	
	SOU 1	LASER+RGBWA		
	SOU 2	LASER+8 WHT		
	SOU 3	SOUND RGBWA+8 WHT		
	SOU 4	SOUND RGBWA		
	SOU 5	SOUND LASER		
	SOU 6	SOUND 8 WHT		
SLAVE	SLA	SLAVE MODE		
DMX	D001 - D504	DMX ADDRESS		

## 6. DMX CHANNEL MODES

9 Channel Mode Configuration

Channel	Function	Value	DESCRIPTION
1	MODE	000-009	Blackout
		010-024	AUTO
		025-039	AUTO1
		040-054	AUTO2
		055-069	AUTO3
		070-084	AUTO4
		085-099	AUTO5
		100-114	AUTO6
		115-129	SOUND
		130-144	SOUND1
		145-159	SOUND2
		160-174	SOUND3
		175-189	SOUND4
		190-204	SOUND5
		205-220	SOUND6
		221-255	DMX MODE

2	LED OPERATION	000-009	Blackout
		010-014	Red
		015-019	Green
		020-024	Blue
		025-029	Amber
		030-034	White
		035-039	White+red
		040-044	Red+green
		045-049	Green+blue
		050-054	Blue+amber
		055-059	Amber+white
		060-064	White+green
		065-069	Green+amber
		070-074	Amber+red
		075-079	Red+blue
		080-084	Blue+white
		085-089	Red+green+blue
		090-094	Red+green+amber
		095-099	Red+green+white
		100-104	Red+amber+blue
		105-109	Red+white+blue
		110-114	Red+amber+white
		115-119	Amber+green+blue
		120-124	Blue+green+white
		125-129	Amber+green+white
		130-134	Amber+white+blue
		135-139	Red+green+blue+amber
		145-149	Red+white+blue+amber
		155-159	White+green+blue+amber
		160-164	Red+green+blue+amber+white
		165-209	Automatic (single colors only)
		210-255	Automatic (two colors at a time)
3	MACRO SPEED	AUTO SPEED	Automatic Speed(when CH2 is between 160-255)
		000-255	Slow-fast(only colors)
4	LED STROBE	000-004	No Function
		005-254	Strobe(slow->fast)(max 30HZ)
		255-255	Sound-activated strobe mode
5	8PCS WHITE LED CONTROL	000-009	Blackout
		010-019	Picture1 ((slow->fast)
		020-029	Picture2((slow->fast)
		030-039	Picture3((slow->fast)
		040-049	Picture4((slow->fast)
		050-059	Picture5((slow->fast)
		060-069	Picture6((slow->fast)
		070-079	Picture7((slow->fast)
		080-089	Picture8((slow->fast)
		090-099	Picture9((slow->fast)
		100-109	Picture1 O((slow->fast)
		110-255	ON



<b>6</b>	<b>LASER</b>	000-009	Black out
		010-049	Blue on
		050-089	Green on
		090-129	Blue & Green on
		130-169	Green on & Blue strobe
<b>7</b>	<b>LASER STROBE</b>	000 - 004	NO FUNCTION
		005 - 254	Strobe(slow->fast)(max 30HZ)
		255 - 255	Sound-activated strobe mode
<b>8</b>	<b>MOTO LED</b>	000 - 004	STOP
		005 - 127	ROTATE CLOCKWISE (SLOW-FAST)
		128 - 133	STOP
		134 - 255	ROTATE COUNTER CLOCKWISE (SLOW-FAST)
<b>9</b>	<b>MOTO LASER</b>	000 - 004	STOP
		005 - 127	ROTATE CLOCKWISE (SLOW-FAST)
		128 - 133	STOP
		134 - 255	ROTATE COUNTER CLOCKWISE (SLOW-FAST)

## 7. KEY FEATURES

- 9 channel DMX-512
- 3W RGBAW LED's for moonflower effect
- 7 Built-in program with speed adjustment
- Blue and Green laser built in
- 8 x 3W WHT LED's for strobe
- Variable electronic strobe
- 7 Sound modes

## 8. LAYOUT

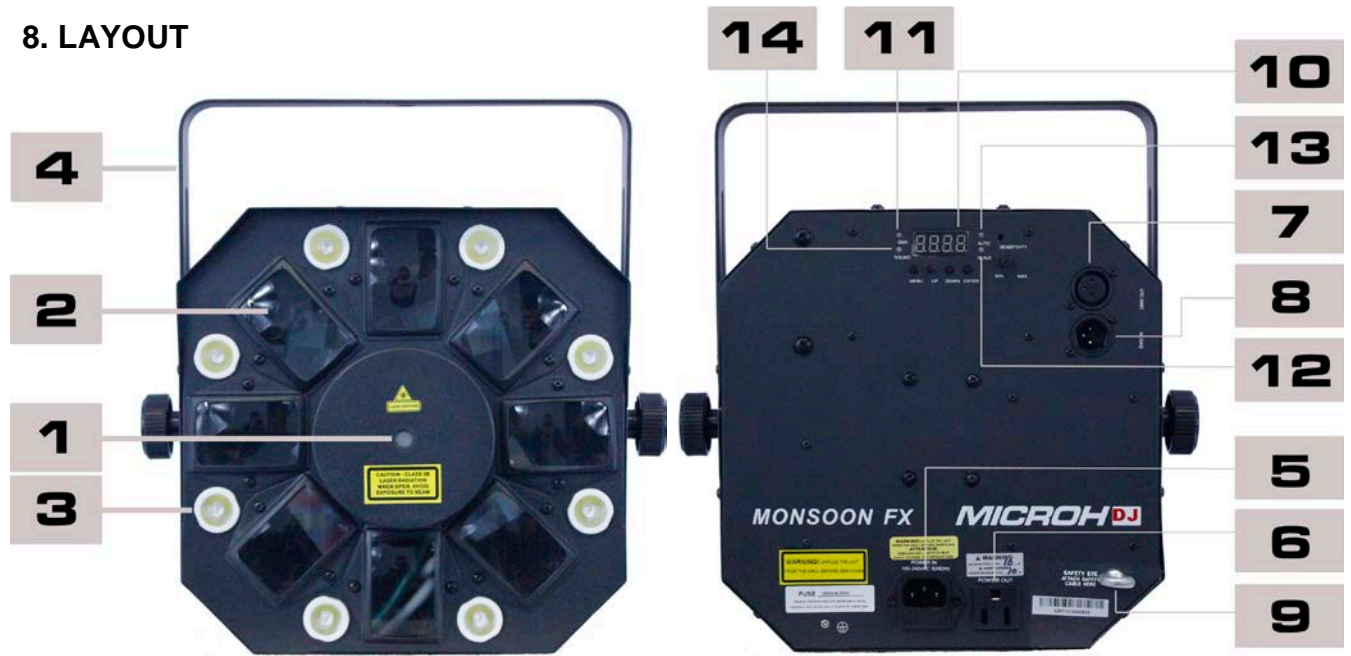

No.	NAME
1	LASER
2	MOONFLOWER LEN
3	STROBE LED
4	HANGING BRACKET
5	POWER INPUT
6	POWER OUTPUT
7	DMX INPUT
8	DMX OUTPUT
9	SAFETY RING
10	LED DISPLAY
11	DMX INDICATOR
12	SLAVE INDICATOR
13	AUTO INDICATOR
14	SOUND INDICATOR

## 9. TECHNICAL SPECIFICATIONS

DIMENSIONS and WEIGHT	
DIMENSION	9.34" x 12.25" x 12.2" / 237 x 311 x 310mm
WEIGHT	9.8Lbs / 4.5Kgs
POWER INPUT	SWITCHED
RANGE	120V 60Hz
RATE	66W
FUSE	2A
LIGHT SOURCE	
TYPE	CLASS 3B LASER DIODE / LED
DIODE QTY. / COLOUR	1 BLUE - 1 GRN
POWER RATING	130mW - 50Mw
WAVE LENGTH	457nm - 532nm
LED QTY. / COLOUR	1 RED - 1 GRN - 1 BLU - 1 AMB - 1 WHT - 8 WHT
LED POWER RATING	3W
WORK ENVIRONMENT	
MAX TEMP.	104°F (40°C)
COOLING SYSTEM	FAN
CONTROL	
AUTO	6
SOUND	6
DMX CHANNEL	9

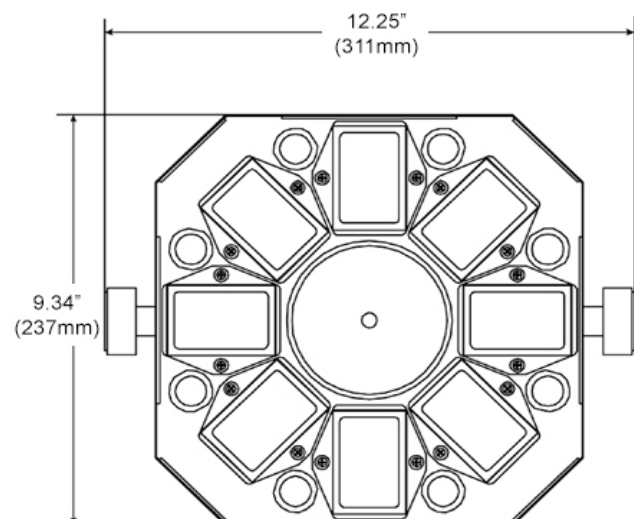
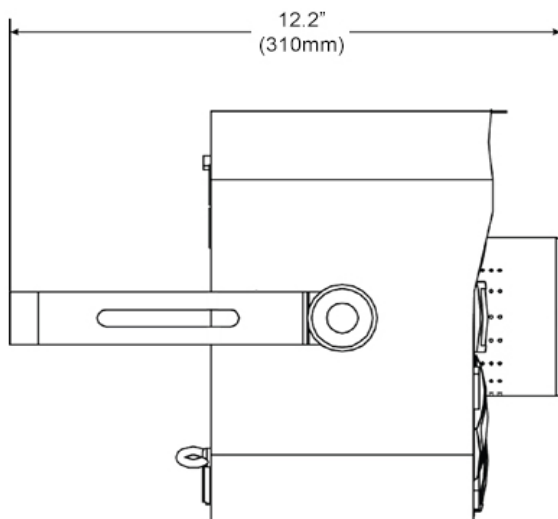

## 10. MAINTENANCE AND CLEANING

The following points have to be considered during the inspection:

- 1) All screws for installing the device or parts of the device must be tightly connected, and must not be corroded.
- 2) There must not be any deformations on the housing, colour lenses, fixations or installation spots (ceiling, suspension, trussing).
- 3) Mechanically moved parts must not show any traces of wearing and must not rotate with unbalances.
- 4) The electric power supply cables must not show any damage, material fatigue or sediments.

Further instructions depending on the installation spot and usage must be handled by a skilled installer or technician. Any safety issues must be resolved.



In order to keep the fixture in good condition and extend the life, we suggest regular cleaning to the fixture.

- 1) Clean the inside and outside lens each week to avoid the light output from darkening due to accumulation of dust, dirt, etc.
- 2) Clean the fan each week.
- 3) A detailed electrical check by approved technician every three months is advised. Ensure the circuit contacts are in good condition.

We recommend a frequent cleaning of the device. Please use a moist, lint- free cloth. Never use alcohol or solvents.

There are no serviceable parts inside the device. Please refer to the instructions under "Installation instructions".

Should you need any spare parts, please order genuine MICROH parts from your local dealer.

**IF YOU SHOULD EXPERIENCE ANY PROBLEMS OR ISSUES PLEASE CONTACT MICROH PROFESSIONAL PRODUCTS BY EMAIL AT [info@microhdj.com](mailto:info@microhdj.com)**

In the event that your unit is defective in any way, please contact your local dealer to obtain an RA number for service repair.

***DISCLAIMER – MICROH believes that the information contained within this user manual is accurate. However, Microh is not responsible for any error or addendums to this manual. If you have any comments or general suggestions on how this manual can be improved please contact [info@microhdj.com](mailto:info@microhdj.com). Thank you.***

**Notes:**

**Notes:**

***MICROH*** 

**[www.microhdj.com](http://www.microhdj.com)**