

Probler P2

Dispense Gun

For use with non-flammable foam and polyurea.
Not for use in explosive atmospheres.

90-110 psi (0.62-0.76 MPa, 6.2-7.6 bar) Air Inlet Pressure Range
3200 psi (22 MPa, 220 bar) Maximum Static Fluid Pressure



Important Safety Instructions

Read all warnings and instructions in this manual. Save these instructions.



USER MANUAL



Table Of Contents

Section 1 Installation

Warnings	3
Introduction	7
Standard Equipment	8
Equipment Assembly	9

Section 2 Operation

Start-up Instructions	11
-----------------------------	----

Section 3 General Information











Assembly Drawings	13
Maintenance	15
Options	20

Section 4 Warranty and Reference Information

Limited Time Warranty	29
Technical Assistance	30
For Your Reference	31

Warnings

The following warnings are for the setup, use, grounding, maintenance, and repair of this equipment. The exclamation point symbol alerts you to a general warning and the hazard symbol refers to procedure-specific risk. Refer back to these warnings. Additional, product-specific warnings may be found throughout the body of this manual where applicable.

 WARNING	
 	<p>TOXIC FLUID OR FUMES HAZARD</p> <p>Toxic fluids or fumes can cause serious injury or death if splashed in the eyes or on skin, inhaled, or swallowed.</p> <ul style="list-style-type: none"> • Read MSDS's to know the specific hazards of the fluids you are using. • Store hazardous fluid in approved containers, and dispose of it according to applicable guidelines. • Always wear impervious gloves when spraying or cleaning equipment.
	<p>PERSONAL PROTECTIVE EQUIPMENT</p> <p>You must wear appropriate protective equipment when operating, servicing, or when in the operating area of the equipment to help protect you from serious injury, including eye injury, inhalation of toxic fumes, burns, and hearing loss. This equipment includes but is not limited to:</p> <ul style="list-style-type: none"> • Protective eyewear • Clothing and respirator as recommended by the fluid and solvent manufacturer • Gloves • Hearing protection
  	<p>SKIN INJECTION HAZARD</p> <p>High-pressure fluid from gun, hose leaks, or ruptured components will pierce skin. This may look like just a cut, but it is a serious injury that can result in amputation. Get immediate surgical treatment.</p> <ul style="list-style-type: none"> • Do not point gun at anyone or at any part of the body. • Do not put your hand over the spray tip. • Do not stop or deflect leaks with your hand, body, glove, or rag. • Close material shutoff valves when not spraying. • Follow Pressure Relief Procedure in this manual, when you stop spraying and before cleaning, checking, or servicing equipment.
	<p>BURN HAZARD</p> <p>Equipment surfaces and fluid that's heated can become very hot during operation. To avoid severe burns, do not touch hot fluid or equipment. Wait until equipment/fluid has cooled completely.</p>
  	<p>FIRE AND EXPLOSION HAZARD</p> <p>Flammable fumes, such as solvent and paint fumes, in work area can ignite or explode. To help prevent fire and explosion:</p> <ul style="list-style-type: none"> • Use equipment only in well ventilated area. • Eliminate all ignition sources; such as pilot lights, cigarettes, portable electric lamps, and plastic drop cloths (potential static arc). • Keep work area free of debris, including solvent, rags and gasoline. • Do not plug or unplug power cords, or turn power or light switches on or off when flammable fumes are present. • Ground all equipment in the work area. • Use only grounded hoses. • Hold gun firmly to side of grounded pail when triggering into pail. • If there is static sparking or you feel a shock, stop operation immediately. Do not use equipment until you identify and correct the problem. • Keep a working fire extinguisher in the work area.

Warnings

WARNING



EQUIPMENT MISUSE HAZARD

Misuse can cause death or serious injury.

- Do not operate the unit when fatigued or under the influence of drugs or alcohol.
- Do not exceed the maximum working pressure or temperature rating of the lowest rated system component. See Technical Data in all equipment manuals.
- Use fluids and solvents that are compatible with equipment wetted parts. See Technical Data in all equipment manuals. Read fluid and solvent manufacturer's warnings. For complete information about your material, request MSDS forms from distributor or retailer.
- Check equipment daily. Repair or replace worn or damaged parts immediately with genuine manufacturer's replacement parts only.
- Do not alter or modify equipment.
- Use equipment only for its intended purpose. Call your distributor for information.
- Route hoses and cables away from traffic areas, sharp edges, moving parts, and hot surfaces.
- Do not kink or over bend hoses or use hoses to pull equipment.
- Keep children and animals away from work area.
- Comply with all applicable safety regulations.



PRESSURIZED ALUMINUM PARTS HAZARD

Do not use 1,1,1-trichloroethane, methylene chloride, other halogenated hydrocarbon solvents or fluids containing such solvents in pressurized aluminum equipment. Such use can cause serious chemical reaction and equipment rupture, and result in death, serious injury, and property damage.

Warnings

Isocyanate Hazard



Spraying materials containing isocyanates creates potentially harmful mists, vapors, and atomized particulates.

Read material manufacturer's warnings and material MSDS to know specific hazards and precautions related to isocyanates.

Prevent inhalation of isocyanate mists, vapors, and atomized particulates by providing sufficient ventilation in the work area. If sufficient ventilation is not available, a supplied-air respirator is required for everyone in the work area.

To prevent contact with isocyanates, appropriate personal protective equipment, including chemically impermeable gloves, boots, aprons, and goggles, is also required for everyone in the work area.

To prevent exposing ISO to moisture:

- Always use a sealed container with a desiccant dryer in the vent, or a nitrogen atmosphere. **Never** store ISO in an open container.
- Keep the ISO lube pump reservoir filled with Graco Throat Seal Liquid (TSL), Part 206995. The lubricant creates a barrier between the ISO and the atmosphere.
- Use moisture-proof hoses specifically designed for ISO, such as those supplied with your system.
- Never use reclaimed solvents, which may contain moisture. Always keep solvent containers closed when not in use.
- Never use solvent on one side if it has been contaminated from the other side.
- Always park pumps when you shutdown.
- Always lubricate threaded parts with Part 217374 ISO pump oil or grease when reassembling.

Moisture Sensitivity of Isocyanates

Isocyanates (ISO) are catalysts used in two component foam and polyurea coatings. ISO will react with moisture (such as humidity) to form small, hard, abrasive crystals, which become suspended in the fluid. Eventually a film will form on the surface and the ISO will begin to gel, increasing in viscosity. If used, this partially cured ISO will reduce performance and the life of all wetted parts.



The amount of film formation and rate of crystallization varies depending on the blend of ISO, the humidity, and the temperature.

Warnings

Keep Components A and B Separate

CAUTION

To prevent cross-contamination of the equipment's wetted parts, never interchange component A (isocyanate) and component B (resin) parts. The gun is shipped with the A side on the left. The fluid manifold, fluid housing, side seal assembly, check valve cartridge, and mix chamber are marked on the A side.

Foam Resins with 245 fa Blowing Agents

New foam blowing agents will froth at temperatures above 90°F (33 °C) when not under pressure, especially if agitated. To reduce frothing, minimize preheating in a circulation system.

Changing Materials

- When changing materials, flush the equipment multiple times to ensure it is thoroughly clean.
- Always clean the fluid inlet strainers after flushing.
- Check with your material manufacturer for chemical compatibility.
- Most materials use ISO on the A side, but some use ISO on the B side.
- Epoxies often have amines on the B (hardener) side. Polyureas often have amines on the B (resin) side.

Section 1 - Installation: Introduction

Introduction

Before operating, maintaining or servicing any **GlasCraft** system, read and understand all of the technical and safety literature provided with **GlasCraft** products. If you do not have the proper or related manuals and safety literature for your **GlasCraft** system, contact your **GlasCraft** distributor or **GlasCraft, Inc.**

In this **GlasCraft** technical and safety publication, the following advisories will be provided where appropriate:



Information about the procedure in progress.



WARNING

Indicates a hazardous situation that can result in death or serious injury.

The information in this document is intended only to indicate the components and their normal working relationship typical use. Each assembly should be directed by a **GlasCraft** distributor or made from the **GlasCraft** Assembly instructions provided.

This manual provides information for the assembly, operation, maintenance and service of this **GlasCraft** product as used in a typical configuration. While it lists standard specifications and procedures, some deviations may be found.

In order to provide our users with the most up-to-date technology possible, we are constantly seeking to improve products. If a technological change occurs after a product is on the market, we will implement that technology in future production and, if practical, make it available to current users as a retrofit, update or supplement. If you find a discrepancy between your unit and the available documentation, contact your **GlasCraft** distributor to resolve the difference. **GlasCraft, Inc.** reserves the right to change or modify this product as it deems necessary.

Careful study and continued use of this manual will provide a better understanding of the equipment and process, resulting in more efficient operation, longer trouble-free service and faster, easier troubleshooting.

Section 1 - Installation: Standard Equipment

Standard Equipment	
Part Number	Description
23950-XX	Probler P2 Dispense Gun
GC-1386	User Manual

Section 1 - Installation: Equipment Assembly

How The Gun Works

The trigger actuates a small valve in the gun handle that controls the flow of air into the piston assembly. When the trigger is pulled, air flows through the valve to the front of the piston. Air pressure forces the piston towards the rear of the gun, simultaneously closing off the purge air and moving the mixing chamber to a position where the mixing chamber orifices are aligned with the orifices in both the side block seal and check valve assemblies.

 The proper alignment of the orifices is determined by the setting of the Set Screw, p/n 17259-16F, located at the rear of the piston assembly. This set screw determines the length of travel of the air piston and has been preset at the factory and should not require adjustment. (SEE MAINTENANCE SECTION)

The two fluids (isocyanate and polyol) then flow through the material shut-off valves, seal, and check valve assemblies and into the mixing chamber. The two fluids impinge against one another and exit the mixing chamber in a swirling, conical spray pattern.

When the trigger is released, the mixing chamber returns to its original position and purge air flows into the mixing chamber housing, p/n 23963-00. The front tip o-ring, p/n 23974-00 keeps air purge inside the gun head, p/n 23963-00, forcing all of the air through the orifices in the mixing chamber, for a complete, total and constant purge.

This purge air continues to flow through the mixing chamber until the air switch, p/n 16832-00 is pulled up to shut-off all air to the gun; or until the trigger is pulled again.

GlasCraft Equipment

Air Hose is ¼ in. NPS

JIC and SAE Fittings **DO NOT** require the use of PTFE tape.

Once the fittings are attached and tight, refer to system manuals for start-up instructions.

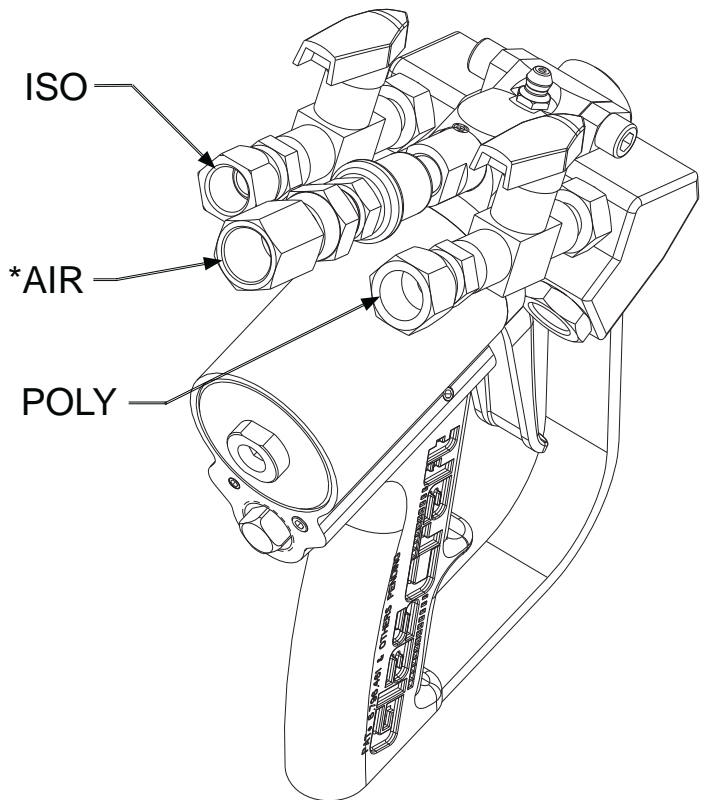

*Fitting 23825-00 is an unattached part that must be connected to the air hose first, then connected to the gun.

Section 1 - Installation: Equipment Assembly

Installing P2 on Equipment other than GlasCraft

WARNING

Do not place any part of the body in the path of the material spray.

Do not point the gun at or near other personnel.

Do not look into the mixing chamber orifice at any time.

Because of the hazardous materials used in this equipment, it is recommended that the operator use an air mask, goggles, protective clothing, and other safety equipment as prescribed by current regulations, recommendations of the chemical suppliers, and the laws in the area where the equipment is being used.

If original equipment does not require the use of an unheated whip hose or isolation hose, the P2 can be directly installed on to the material hose.

1. Remove the fittings from the original gun.
2. Remove GCI fittings, p/n's 117634, 117635 from PG-15-01 ball valves. GCI ball valves are 1/8 in. NPT female. Remove GCI fitting 23825-00 from 16832-00 air slide valve. The air slide valve is a 1/4 in. NPSM.

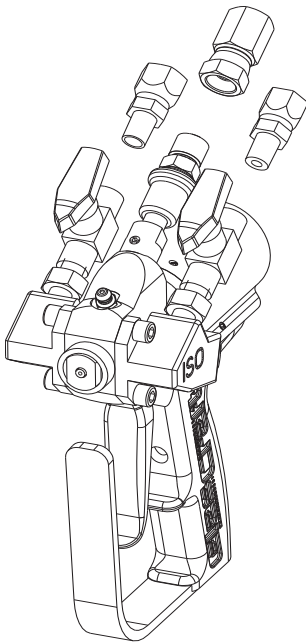

3. Install the original fittings into PG-15-01 valves.



It is recommended to use a non-permanent thread lock on the 1/8 in. NPT threads to assist as a sealant and keep the fittings from twisting with gun movement.

4. Install the gun on the original hoses.

WARNING

Relieve ALL system fluid and air pressure according to manufacturer's instructions.

Section 2 - Operation: Start-Up Instructions

 Refer to specific system user manuals for complete system installation.

Pre operation Checklist

Check that all fittings are tight and air regulators are turned to “zero pressure”.

WARNING

Do not place any part of the body in the path of the material spray.

Do not point the gun at or near other personnel.

Do not look into the mixing chamber orifice at any time.

Because of the hazardous materials used in this equipment, it is recommended that the operator use an air mask, goggles, protective clothing, and other safety equipment as prescribed by current regulations, recommendations of the chemical suppliers, and the laws in the area where the equipment is being used.

Operating Requirements

- 8-10 CFM at 90-110 psi (0.62-0.76 MPa, 6.2-7.6 bar)
- MAXIMUM Static Fluid Pressure - 3200 psi (22 MPa, 220 bar)

WARNING

The GlasCraft Probler P2 Gun is designed and manufactured to operate at a maximum static fluid pressure not to exceed 3200 psi (22 MPa, 220 bar). When attached to a GlasCraft proportioning system, this pressure will not be exceeded. However, if the GlasCraft Probler P2 Gun is installed on any other manufacturer's self-designed equipment, great care must be taken to ensure that the maximum static fluid pressure not be exceeded.

 If the gun is being used for short periods of spraying, GlasCraft recommends that the purge air be left ON. The material shut-off valves, p/n PG-15-01 can be left in the OPEN position during these periods of time.

WARNING

If purge air is to be turned OFF, BOTH MATERIAL SHUT-OFF VALVES, p/n PG-15-01, MUST BE TURNED TO THEIR “OFF” POSITION BEFORE TURNING “OFF” THE PURGE AIR !

Failure to follow this procedure will possibly result in the gun head becoming encased with mixed product.

For proper purging following use, the air switch must be left OPEN for at least 15 SECONDS after the trigger has been released.

The flow of material into the mixing chamber is controlled by the ON or OFF position of the two material shut-off valves.

 Both material shut-off valves must be FULLY OPEN during dispensing and must be FULLY CLOSED during service or extended shut-down periods.

WARNING

BOTH MATERIAL SHUT-OFF VALVES, p/n PG-15-01, MUST BE TURNED TO THEIR “OFF” POSITION BEFORE REMOVING SCREWS, P/N 9944-16C!!

Failure to follow this procedure will possibly result in the gun head becoming encased with mixed product.

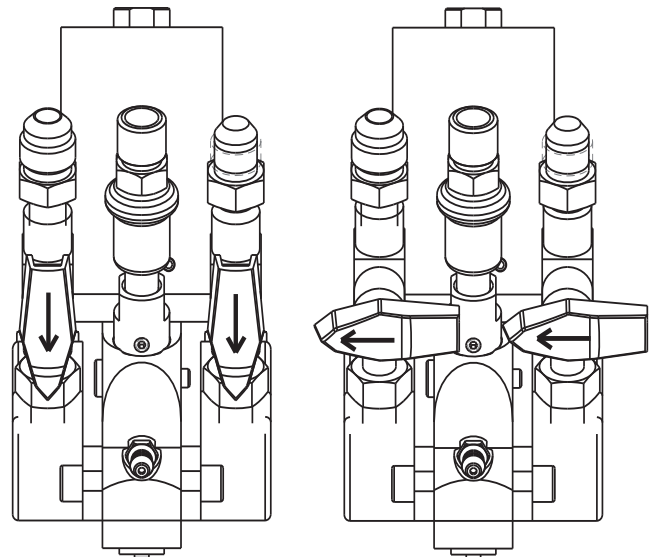

ON

OFF

Refer to system manuals for start-up and shut-down procedures.

Section 2 - Operation: Start-Up Instructions

Spray Technique

Always operate safely and follow all safety procedures outlined.

To achieve the optimum spray pattern for each application, the appropriate mixing chambers are available in six round and six flat spray sizes. Hardened mixing chambers are also available (see mixing chamber chart).

The standard mixing chamber supplied with your gun will be adequate for all but the smallest and largest applications.

Foam rise and cure times will vary according to the material and substrate temperature. Higher material or substrate temperature will increase rise and cure times; lower material or substrate temperatures will decrease rise and cure times. Consult your chemical manufacturer's data specification sheets for their recommended spray temperatures. Under most circumstances, both components will be used at identical temperatures.

Higher pressures and temperatures may be used to increase material break-up, improve mixing and speed rise times. With hose lengths over 50 ft., or when material viscosities are high, higher material pump pressures may be necessary.

The gun air switch assembly **MUST BE OPENED** (down position) prior to spraying to provide air for trigger operation and purge air when the trigger is released.

When spraying, the gun trigger may be depressed continuously, or triggered at the end of each stroke. A smooth, even layer is best achieved by moving the gun back and forth in a slow, even motion, overlapping the previous pass about 50 to 75 percent. **DO NOT SPRAY OVER RISING FOAM!** The ideal gun-to-surface distance is about 18 to 24 inches. Be sure to point the gun directly at the surface to be sprayed. Spraying at an angle to the surface will cause the foam to be rough and will generate overspray.

Section 3 - General Information: 23950-XX P2 Parts List

Part Number	Description	Qty.
PG-15-01	2-WAY BALL VALVE	2
PG-18	PROBLER TRIGGER	1
PG-19	COMPRESSION SPRING	1
117634	SWIVEL HOSE FITTING	1
117635	SWIVEL HOSE FITTING	1
13867-08	O-RING	2
13867-11	O-RING	2
16832-00	AIR SWITCH ASSEMBLY	1
17259-16F	MACHINE SCREW	1
18383-02	1/4 DIA BALL	3
19881-00	PLUG FITTING	1
2253-04	LUBE FITTING	1
23825-00	SWIVEL FITTING	1
23951-00	1-3/8" AIR PISTON	1
23952-00	1-1/2" AIR PISTON	1
23953-00	CYLINDER SPACER	1
23954-00	VALVE INSERT	1
23955-00	ISO SIDE BLOCK	1
23956-00	POLY SIDE BLOCK	1
23957-00	CHECK VALVE FILTER	2
23958-00	SEAL	2
23959-00	SEAL HOUSING	2
23961-00	FRONT TIP	1
23962-00	HANDLE	1
23963-00	PROBLER P2 HEAD	1
23964-00	GUARD	1
23965-00	TRIGGER PISTON	1
23966-00	REAR CAP	1
23967-00	TRIGGER PLUG	1
23968-00	RETAINING RING	1
23969-00	SPRING	3
23970-00	SPRING	2
23971-00	FILTER SCREEN	2
23973-00	SEAL	2
23974-07	O-RING	2
23974-12	O-RING	1
7554-05	O-RING	1
7554-06	O-RING	1
7554-07	O-RING	1
7554-10	O-RING	1

7554-07	O-RING	1
7554-09	O-RING	2
16830-00	AIR SWITCH TUBE	1
16831-00	AIR SWITCH SPOOL	1

Part Number	Description	Qty.
7554-16	O-RING	3
7554-25	O-RING	1
7554-26	O-RING	1
7554-27	O-RING	1
7554-29	O-RING	1
7554-43	O-RING	1
7704-08C	SET SCREW	1
7716-06C	SET SCREW	11
8212-12F	MACHINE SCREW	2
8301-12C	MACHINE SCREW	1
8462-08	FITTING	2
9869-19	SHOULDER SCREW	1
9936-20F	SET SCREW	1
9944-16C	MACHINE SCREW	4

Section 1 - Installation: Equipment Assembly

How The Gun Works

The trigger actuates a small valve in the gun handle that controls the flow of air into the piston assembly. When the trigger is pulled, air flows through the valve to the front of the piston. Air pressure forces the piston towards the rear of the gun, simultaneously closing off the purge air and moving the mixing chamber to a position where the mixing chamber orifices are aligned with the orifices in both the side block seal and check valve assemblies.

 The proper alignment of the orifices is determined by the setting of the adjustment nut, located on the piston lock assembly. This adjustment nut determines the length of travel of the air piston and has been preset at the factory and should not require adjustment. (SEE MAINTENANCE SECTION)

The two fluids (isocyanate and polyol) then flow through the material shut-off valves, seal, and check valve assemblies and into the mixing chamber. The two fluids impinge against one another and exit the mixing chamber in a swirling, conical spray pattern.

When the trigger is released, the mixing chamber returns to its original position and purge air flows into the mixing chamber housing. The front tip o-ring, keeps air purge inside the gun head, forcing all of the air through the orifices in the mixing chamber, for a complete, total and constant purge.

This purge air continues to flow through the mixing chamber until the air switch is pulled up to shut-off all air to the gun; or until the trigger is pulled again.

Piston Lock

Engage piston lock whenever you stop spraying, to avoid accidental triggering.

Always use piston lock in conjunction with fluid ball valves to avoid accidental triggering.



Read warnings, page 3.

To engage Piston lock: push knob in and turn clockwise. If engaged, gun will not actuate.



r_257826_313266_1_2b

To disengage piston lock: push knob in and turn counterclockwise until it pops out. There will be a gap between knob and gun body.

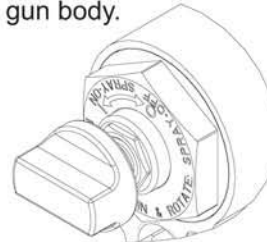

r_257826_313266_1_1b

See page 19 for piston lock adjustment or installation.

Loss of Air Pressure

In event of loss of air pressure, gun will continue to spray. To shut off gun, do one of the following:

- Push in piston lock, see **Engage piston lock**.
- Close ball valves A and B.

Section 3 - General Information: GCP2XX P2 Parts List

Ref. No.	Part No.	Description	Qty.
1	GC2337	2-WAY BALL VALVE	2
2	GC2340	PROBLER TRIGGER	1
3	GC2341	COMPRESSION SPRING	1
4	117634	SWIVEL HOSE FITTING	1
5	117635	SWIVEL HOSE FITTING	1
6	GC0043	O-RING	2
7	GC0044	O-RING	2
8	GC0128	AIR SWITCH ASSEMBLY	1
10	GC0259	1/4 DIA BALL	3
12	GC1198	LUBE FITTING	1
13*	GC2394	SWIVEL FITTING	1
14	GC1898	1-3/8" AIR PISTON	1
15	GC1899	1-1/2" AIR PISTON	1
16	GC1900	CYLINDER SPACER	1
17	GC1901	VALVE INSERT	1
18	GC1902	ISO SIDE BLOCK	1
19	GC1903	POLY SIDE BLOCK	1
20	GC1904	CHECK VALVE FILTER	2
21	GC2494	SEAL	2
22	GC2495	SEAL HOUSING	2
23	GC1914	AIR CAP	1
24	GC2499	HANDLE	1
25	GC1916	PROBLER P2 HEAD	1
27	GC1918	TRIGGER PISTON	1
29	GC1920	TRIGGER PLUG	1
30	GC1921	RETAINING RING	1
31	GC1922	SPRING	3
32	GC1923	SPRING	2
33	GC2496	FILTER SCREEN, 40 MESH	2
34	GC2498	SEAL	2
35	111450	O-RING	2
36 †	117517	O-RING	1
37	C20988	O-RING	1
38	GC2056	O-RING	1
39	110242	O-RING	1
40	GC2057	O-RING	1
41	GC2058	O-RING	3
42	108833	O-RING	1
43	107563	O-RING	1
44	GC2059	O-RING	1

Ref. No.	Part No.	Description	Qty.
8a	110242	O-RING	1
8b	106555	O-RING	2
8c	GC0126	AIR SWITCH TUBE	1
8d	GC0127	AIR SWITCH SPOOL	1

Ref. No.	Part No.	Description	Qty.
45	C20207	O-RING	1
46	GC2060	O-RING	1
47	GC2079	SET SCREW	1
48	GC2081	SET SCREW	11
49	GC2187	MACHINE SCREW	2
51	GC2196	FITTING	2
52	GC2237	SHOULDER SCREW	1
53	GC2243	SET SCREW	1
54	GC2248	MACHINE SCREW	4
55	GC2241	MACHINE SCREW	2
56	258761	PISTON LOCK ASSEMBLY	1

Ref. No.	Part No.	Description	Qty.
56a		AIR CAP	1
56b ♦		STOP SHAFT	1
56c ♦		PISTON STOP	1
56d ♦		COMPRESSION SPRING	1
56e ♦		O-RING	1
56f		ADJUSTMENT NUT	1

* Not shown.

† 100 Mesh filter GC2497 also available.

♦ Included with kit 258762.

Section 3 - General Information: Maintenance

WARNING

Before attempting to perform any maintenance on this gun, relieve All Fluid and Air Pressures!

- To relieve fluid and air pressures:
- Turn OFF all air supplies at system except gun trigger air.
- Trigger the gun until all fluid pressures have been relieved.
- Turn OFF the gun trigger air at the system.
- Trigger the gun until all trigger air pressure has been relieved.

Perform Gun maintenance as follows:

1. Check for leaking seals, p/n 23973-00:

- Turn OFF the gun incoming air by closing gun air switch.

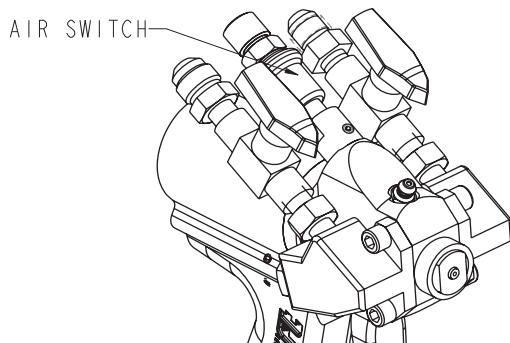

- Wait approximately 10 - 20 seconds, then turn ON the incoming air by opening gun air switch.
- Repeat two or three times.
- If any material has been purged from the gun, the seals, p/n 23973-00 are leaking, or o-ring, p/n 23974-07
- Correct leaks by replacing the seals or o-rings and re-checking.

2. Check the material valves, p/n PG-15-01 for any leaks:

- Turn OFF both material valves.

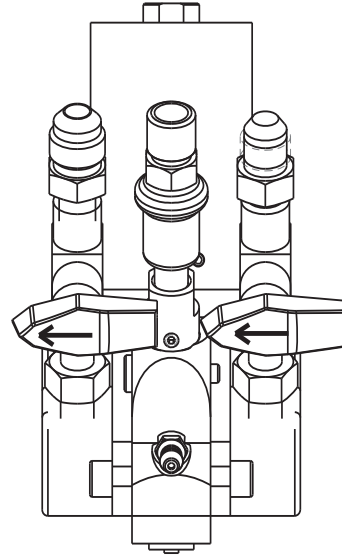

- Trigger the gun several times.
- Turn OFF the gun incoming air by closing the air switch.
- Trigger the gun several times.
- If additional material is purged, the material valves are leaking.
- Correct the leaks by taking off black knobs and turning packing 1/8 in. to 1/4 in. turns at a time until the leak has stopped. Re-check.

3. Check side blocks

- Turn OFF the air switch on the gun.

WARNING

Before removing the side blocks make certain that both material valves are in the OFF positions!

If the material valves are on when the side blocks are removed the gun will quickly become encased in urethane!

WARNING

Point gun side blocks down, away from all personnel. Existing fluid pressures could cause material to exit the side blocks with considerable force.

Section 3 - General Information: Maintenance

- Take the side blocks off by removing screws, p/n 9944-16C.

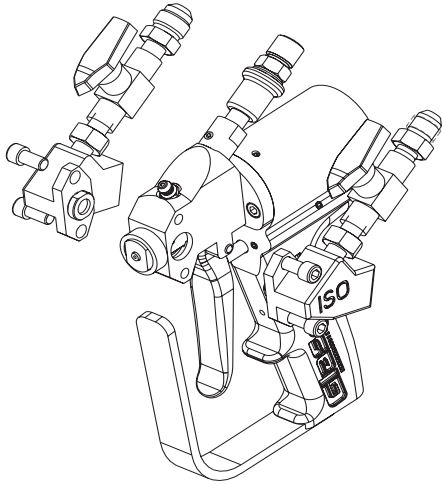

- Examine the sides of the mixing chamber, p/n 23960- for scratches and/or material build-up. Carefully, without scratching the seal surfaces (sides), remove any accumulated material. Solvent can be used to wash accumulated material off of chamber, side blocks, etc. Keep the gun chamber tilted toward the ground so that solvent does not run back into gun. Certain solvents will attack o-rings on chamber shaft causing swelling and deterioration of o-rings.

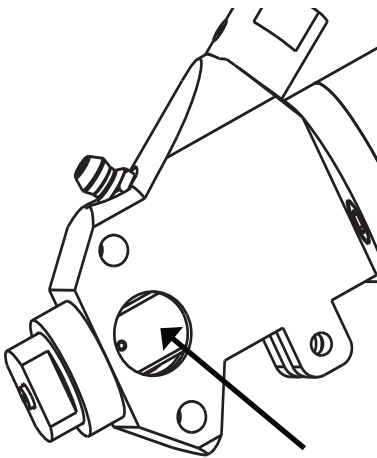

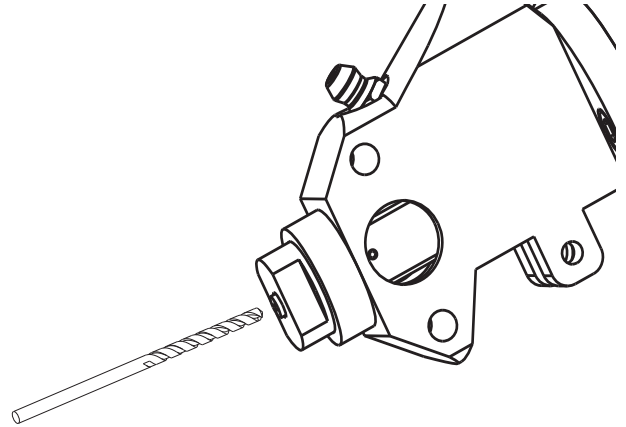

- Place generous amounts of high quality, white lithium grease in each side of the gun front housing and on the side block seals.

- Use correct size drill bit to clean out the mixing chamber exit passage. Use correct size drill bit to clean the inlet side holes of the mixing chamber taking care not to scratch the mixing chamber's polished surfaces. (refer to the chart at front of manual)

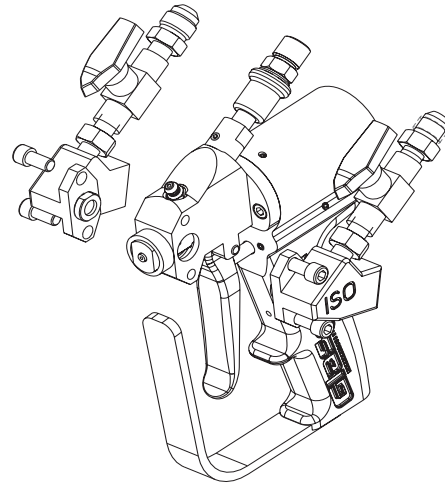

- Re-assemble the side blocks and tighten the screws. Grease should appear at the tip of the mixing chamber.



 **DO NOT** open the air switch on the gun because this will purge grease from the gun. The grease should be allowed to remain in the gun overnight.

Section 3 - General Information: Maintenance

Daily Shut-Down

For experienced users

Once you have used the gun with a product and system, and you have become comfortable with techniques on how all the variables are affecting your operations and maintenance requirements, Daily, Weekly, and Monthly maintenance requirements can be addressed specific to your operation.

1. Turn the ball valves off, p/n PG-15-01, activate and deactivate the gun 5 - 6 times to purge residual pressure.

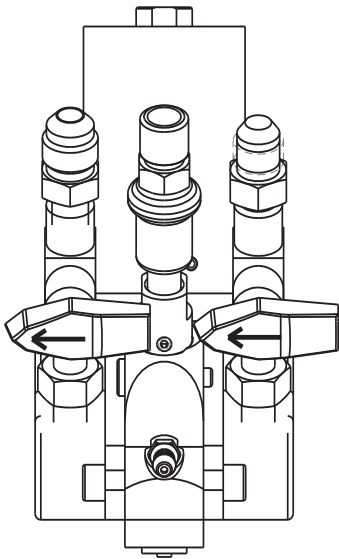

2. Drill out the chamber insert snout with correct size drill bit for insert. (see chart in front of manual)
3. Pull slide valve, p/n 16832-00 halfway back to limit the air purge.

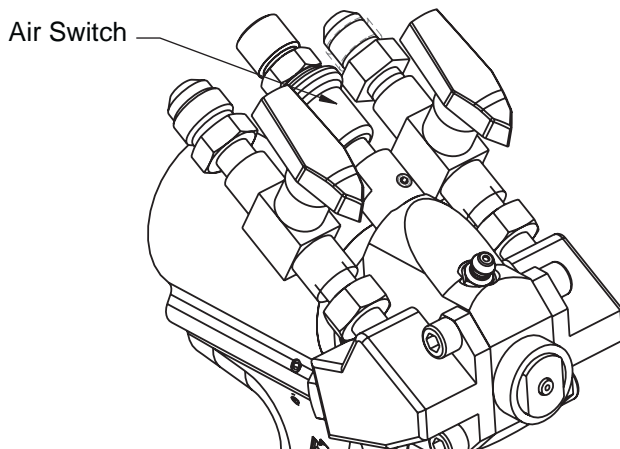

4. Inject white lithium grease into zerk fitting until a light mist of grease is purged through the snout. shut off the air purge.

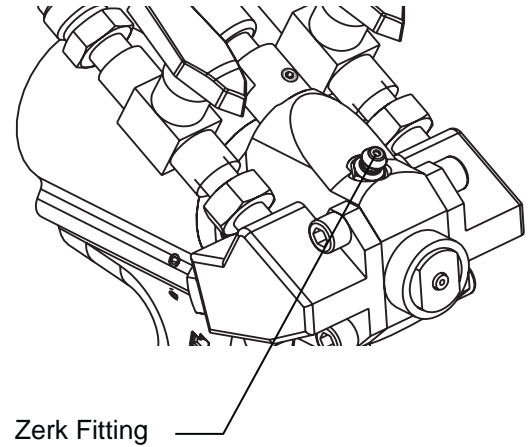

5. Remove the air cap, p/n 23961-00 and set to side. If solvent soaking is required, remove the o-ring, p/n 23974-12 before soaking.
6. Remove the insert, p/n 23977-XX and soak in solvent until next usage.

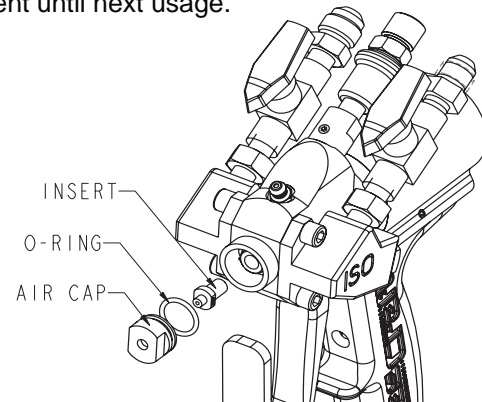

Daily Start-Up

1. Clean the snout insert, p/n 23977-XX. Be sure both, the face and bottom flat are clean. Drill the snout bore out with the correct size bit for snout. (see chart in front of manual)
2. Clean the inner bore of the chamber. Drill out the chamber snout inlet bore as required.
3. Install the snout insert.
4. Install the air cap, p/n 23961-00 on to the chamber. Tighten finger tight until the cap bottoms out. Snug down with a 1/2 in. wrench. This does not require high torque. Over tightening can result in chamber damage.

Section 3 - General Information: Maintenance

 Refer to specific system user manuals for complete system installation.

Parts Replacement Procedure

WARNING

Before attempting to perform any maintenance on this gun OR before removing the side blocks, make certain that both gun material valves are in the OFF positions!

If the material valves are on when side blocks are removed, the gun will quickly become encased in urethane!

1. Read each procedure entirely before beginning and refer to the illustrations as needed.
2. Flush and clean all chambers and passages as they become accessible.
3. Clean all parts before assembly.
4. Replace all o-rings and seals with new parts from the appropriate kit.
5. Inspect all parts for wear or damage and replace as required with new *genuine GlasCraft replacement parts from your authorized GlasCraft distributor.*
6. Inspect all threads for wear or damage and replace as required.
7. Tighten all threaded parts securely, but not excessively, upon assembly.
8. Lightly lubricate all o-rings and threads with lithium grease.
9. Check all springs for resilience. They should return quickly to their original (new) length.

Routine Care

WARNING

Before attempting to perform any maintenance on this gun OR before removing side blocks, make certain that both gun material valves are in the fully OFF positions!

If the material valves are on when side blocks are removed, the gun will quickly become encased in urethane!

It is recommended that the following service be performed on a daily basis.

1. Clean the gun using a brush and an appropriate clean solvent.
2. Inspect the side block seals, p/n 23973-00, making certain they are clean and free of scratches, nicks or foreign material. Clean and replace as required.
3. Remove, clean or replace the filter screen, p/n 23971-00.
4. Maintain a reasonable stock level of "wear" items such as seals and o-rings. (see Service & Repair Parts Kits listed in Parts & Illustrations section.)

Piston Throw Adjustment

The P2 gun piston throw is factory set and as a rule, should not require adjustment. The piston throw refers to how far back the air piston will travel when the gun is triggered. Proper throw adjustment will align the mixing chamber side ports with the side block seal thru port. There is a set screw that determines how far the piston will travel before it stops.

To determine if the throw is correct:

1. Turn the material ball valves, p/n PG-15-01 to the OFF position.

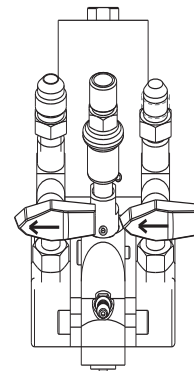

Section 3 - General Information: Maintenance

2. Trigger the gun to clear out residual pressure in side blocks.

3. Remove the side blocks, p/n 23955-00 & 23956-00.

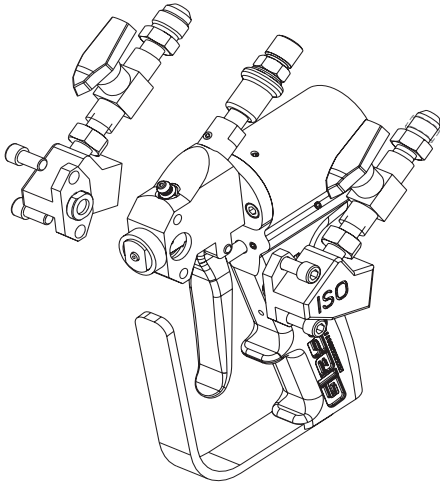

4. Remove one of the side block seal housings, p/n 23959-00 from side block. Leave the seal, p/n 23973-00 in housing and rinse with suitable solvent.

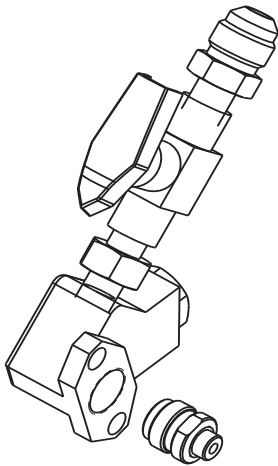

5. Turn the air ON to gun, pull the trigger to actuate the gun into spray position, when gun pulls back, keep in mind the purge air will not shut off. Turn air OFF at the slide valve, p/n 16832-00 before releasing trigger.

6. Place seal / seal housing assembly into gun head so the face of seal sets against the chamber. Look through the thru port of the seal. The side port of the chamber should be at the center, or slightly forward of the center line. If this adjustment appears to be correct, rotate the seal housing to ensure the air cap, p/n 23961-00 is not contacting the seal housing, p/n 23959-00. There should be no contact between these two parts. Contact will result in chamber damage.

7. Adjust the set screw, p/n 17259-16F until

a. the side port of the chamber is “on center” with or forward of center of the thru port of seal;

b. the seal housing can be rotated and does not make contact with the air cap.

8. Turn the air ON and re trigger the gun, then shut the air OFF before releasing trigger. Re-check the throw.

9. If the set screw feels loose, remove it from the rear cap. Clean and apply non-permanent thread lock to threads and reinstall. Set adjustment.

Section 3 - General Information: Options

Optional Equipment	
Part Number	Description
23976-00	Flat Spray Kit
23983-01	Jet Stream Nozzle
23983-02	Jet Stream Nozzle
23984-00	Pour Adapter
23986-00	Static Mixer
23941-00	* P2 Elite Conversion Kit

* The P2 Elite conversion kit is **ONLY** available for Probler P2 guns with rev B to current gun handle.

23941-00		
Part Number	Description	Qty.
11021-22	PIPE PLUG	3
18012-02	HEATED HOSE COVER	2
1880-00	FITTING	1
20735-01	ELBOW FITTING	1
20798-02	FITTING	1
21054-01	NYLON TUBING	3
21478-01	ELBOW FITTING	2
23776-00	BALL VALVE	1
23901-00	P2-ELITE HEAD	1
23902-00	POLY SIDE BLOCK	1
23903-00	ISO SIDE BLOCK	1
23904-00	PISTON SPACER	1
23906-00	MOUNTING PLATE	1
23907-00	SWIVEL ADAPTER	1
23908-01	WHIP HOSE	1
23908-02	WHIP HOSE	1
8560-23	FITTING	3
9936-32F	SET SCREW	1
PG-13	FITTING	3
PG-15-01	BALL VALVE	2
GC-1410	USER MANUAL	1

Section 3 - General Information: Options

Service & Repair Kits

23975-00 Standard Repair Kit		
Part Number	Description	Qty.
7554-05	O-Ring	1
7554-06	O-Ring	1
7554-07	O-Ring	2
7554-09	O-Ring	2
7554-10	O-Ring	1
7554-16	O-Ring	3
7554-25	O-Ring	1
7554-26	O-Ring	1
7554-27	O-Ring	1
7554-29	O-Ring	1
7554-43	O-Ring	1
13867-08	O-Ring	2
13867-11	O-Ring	2
23974-07	O-Ring	2
23974-12	O-Ring	1

23979-00 Hardware Kit 00-03		
Part Number	Description	Qty.
15845-00	3/16" Ball Driver	1
15845-01	5/32" Ball Driver	1
17672-00	Pin Vise	1
23971-00	Screen Filter	2
14693-17	Drill Bit	1
14963-13	Drill Bit	1
14963-14	Drill Bit	1
14963-15	Drill Bit	1
23974-12	O-Ring	1
23974-07	O-Ring	2

23980-00 Hardware Kit 04-05		
Part Number	Description	Qty.
15845-00	3/16" Ball Driver	1
15845-01	5/32" Ball Driver	1
17672-00	Pin Vise	1
23971-00	Screen Filter	2
14693-19	Drill Bit	1
14963-20	Drill Bit	1
23974-12	O-Ring	1
23974-07	O-Ring	2

23979-AA Hardware Kit -AA		
Part Number	Description	Qty.
14963-28	Drill Bit	1
14963-29	Drill Bit	1
15845-00	Ball Driver	1
15845-01	Ball Driver	1
17672-00	Vise Pin	1
23971-00	Filter Screen	2
23974-07	O-Ring	2
23974-12	O-Ring	1

23978-00 Side Seal Kit		
Part Number	Description	Qty.
23973-00	SST Side Seal	2
23974-07	O-Ring	2

23981-00 Premium Repair Kit		
Part Number	Description	Qty.
23974-05	O-Ring	1
23974-06	O-Ring	1
23974-07	O-Ring	4
23974-08	O-Ring	2
23974-09	O-Ring	2
23974-10	O-Ring	1
23974-11	O-Ring	2
23974-12	O-Ring	1
23974-16	O-Ring	3
23974-25	O-Ring	1
23974-26	O-Ring	1
23974-27	O-Ring	1
23974-29	O-Ring	1
23974-43	O-Ring	1

Section 3 - General Information: Options

Cleaning Drill Chart

DRILL KIT	ROUND MIXING CHAMBER	MIXING CHAMBER NOZZLE CLEANING DRILL		MIXING CHAMBER HOLE CLEANING DRILL		CHAMBER COUNTER BORE CLEANING DRILL	
		Part No.	Orifice Size	Part No.	Orifice Size	Part No.	Orifice Size
	23960-AA	14963-28	0.033	14963-29	0.022	14963-27	0.043
30059-00	23960-00	14963-30	0.049	14963-24	0.035	14963-13	0.0595
30059-01	23960-01	14963-11	0.057	14963-16	0.042	14963-14	0.067
30059-02	23960-02	14963-12	0.071	14963-17	0.052	14963-46	0.081
30059-03	23960-03	14963-15	0.086	14963-13	0.059	14963-19	0.094
	23960-04	14963-19	0.094	14963-14	0.07		
	23960-05	14963-20	0.116	14963-15	0.086		

DRILL PIN VISE 17672-00

Tungsten Carbide				
LPA2-147-1525	LPA2-147-2340	LPA2-147-3625	LPA2-147-5250	LPA2-147-7265
LPA2-147-1540	LPA2-147-2350	LPA2-147-3640	LPA2-147-5265	LPA2-147-7640
LPA2-147-1840	LPA2-147-2640	LPA2-147-3650	LPA2-147-6240	LPA2-147-7650
LPA2-147-1850	LPA2-147-2650	LPA2-147-4325	LPA2-147-6250	
LPA2-147-2125	LPA2-147-3125	LPA2-147-4340	LPA2-147-6265	
LPA2-147-2140	LPA2-147-3140	LPA2-147-4350	LPA2-147-7240	
LPA2-147-2150	LPA2-147-3150	LPA2-147-5240	LPA2-147-7250	

NOTE: The nozzle size is stated by the Orifice, Size, and Degree of Spray.
 Example: LPA2-147-1525 .015 Orifice 25 Degrees

Non Atomized Tips, For use w/23976-00	
23047-J1	. Character Designates Pattern Width . Number Designates Orifice Contact the GlasCraft Tech. Service department for help matching a tip with an application.
23047-J2	
23047-J3	
23047-M1	
23047-M2	
23047-M3	
23047-P1	
23047-P2	
23047-P3	

Section 3 - General Information: Options

Dispense Tip Reference Chart

Part Number	Orifice
23047- J1	.012
J2	.014
J3	.022
M1	.012
M2	.014
M3	.022
N1	.012
N2	.014
N3	.022
P1	.012
P2	.014
P3	.022

Section 3 - General Information: Options

Dispense Tip Reference Chart

Part Number	Orifice
LPA2-147-1525	0.015
1540	0.015
1550	0.015
1565	0.015
1825	0.018
1840	0.018
1850	0.018
1865	0.018
2125	0.021
2140	0.021
2150	0.021
2165	0.021
2325	0.023
2340	0.023
2350	0.023
2365	0.023
2625	0.026
2640	0.026
2650	0.026
2665	0.026

Part Number	Orifice
3125	0.031
3140	0.031
3150	0.031
3165	0.031
3625	0.036
3640	0.036
3650	0.036
3840	0.038
3850	0.038
4325	0.043
4340	0.043
4350	0.043
4365	0.043
5225	0.052
5240	0.052
5250	0.052
5265	0.052

Part Number	Orifice
LPA2-147-6225	0.062
6240	0.062
6250	0.062
6265	0.062
7240	0.072
7250	0.072
7840	0.078

Section 3 - General Information: Options

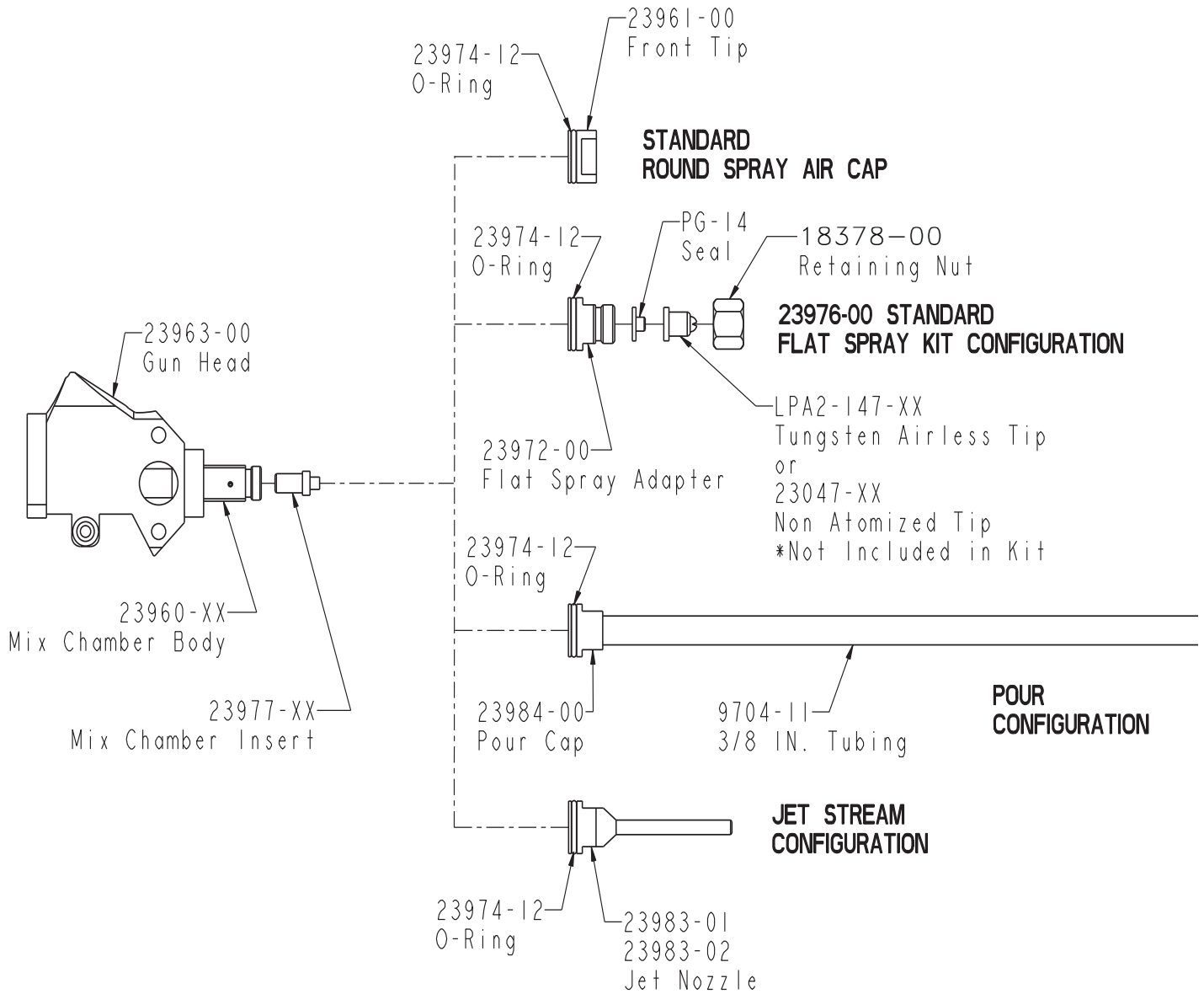

Section 3 - General Information: Options

Static Mixer Kit
23986-00

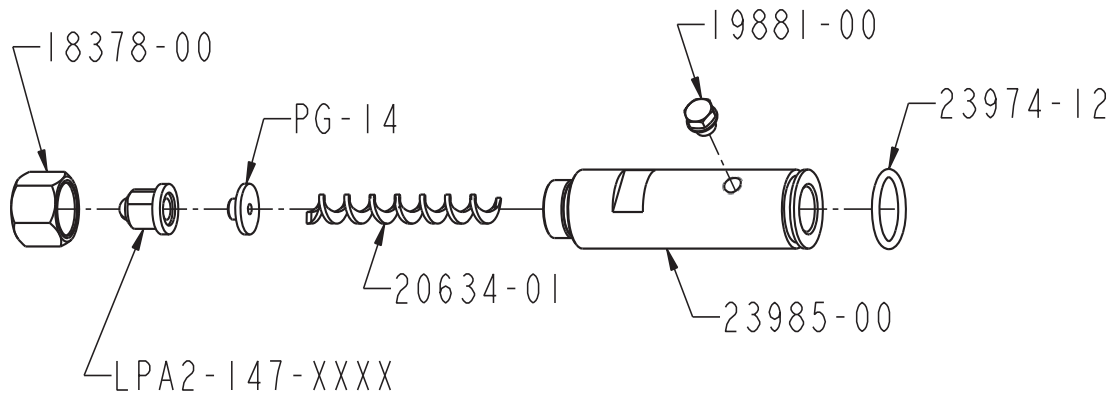

Part Number	Description	Qty.
PG-14	FLUID NOZZLE SEAL	1
18378-00	NOZZLE NUT	1
19881-00	PLUG FITTING	1
20634-01	SPIRAL MIXING ELEMENT	1
23974-12	O-RING	1
23985-00	STATIC MIXER ADAPTER	1

Section 4 - Limited Warranty Policy

GLASCRAFT, INC. ("GlasCraft") warrants to the original Purchaser of GlasCraft manufactured equipment and parts, that all GlasCraft manufactured equipment and parts will conform to their published written specifications and be free of defects in workmanship and material for a period of one (1) year from the original date of installation. GlasCraft makes no warranty to anyone other than the original Purchaser.

If any GlasCraft manufactured part or equipment is found to be defective in workmanship or material within the one-year period from the date of installation, as determined solely by GlasCraft, GlasCraft, in its sole discretion, will either repair or replace the defective part or equipment at GlasCraft's cost, including freight charges both ways, or credit or refund the purchase price for the defective equipment or part.

A warranty claim will be honored only when:

1. GlasCraft has been informed, in writing, of any such defect in workmanship or material within ten (10) days after discovery by the original Purchaser;
2. An official of GlasCraft has issued a return authorization number; and
3. The claimed defective equipment or part has been returned to GlasCraft by the original Purchaser, freight prepaid (with proper return authorization number(s) attached), to: GlasCraft, Inc., 5845 West 82nd Street, Suite 102, Indianapolis, IN 46278, U.S.A.

This warranty shall not apply to any equipment or parts that have been altered or repaired by anyone other than GlasCraft or to defects or damage resulting from improper installation, misuse, negligence, accident, or use not specified by GlasCraft. This warranty shall not apply to any equipment where any parts or components were replaced by any parts or components not manufactured or supplied by GlasCraft. The decision by GlasCraft shall be conclusive and binding on Purchaser.

GlasCraft does not warrant that any equipment or parts sold to Purchaser meet or comply with any local, state, federal, or other jurisdiction's regulations or codes. GlasCraft does not warrant that any equipment or part sold to Purchaser, when used individually or in concert with any other part, equipment, device, component or process, does not infringe on any patent rights of any third party. GlasCraft only warrants that it has no specific knowledge of any such infringement.

GlasCraft makes no warranty as to any parts or equipment manufactured by others. Purchaser shall look solely and only to the manufacturer of such parts or equipment with respect to any warranty claims. GlasCraft hereby assigns to Purchaser the original manufacturer's warranties to all such equipment and parts, to the full extent permitted.

THE AFORESAID WARRANTY IS IN LIEU OF ALL OTHER WARRANTIES, EXPRESS OR IMPLIED. SPECIFICALLY THERE ARE NO WARRANTIES OF MERCHANTABILITY OR FITNESS FOR A PARTICULAR PURPOSE, WHICH WARRANTIES ARE SPECIFICALLY DISCLAIMED.

GlasCraft shall not be liable for any loss or expense resulting from damage or accidents caused by improper use or application of materials manufactured or sold by GlasCraft or its distributors or agents.

UNDER NO CIRCUMSTANCES SHALL GLASCRAFT'S LIABILITY EXCEED THE AMOUNT PURCHASER PAID FOR THE CLAIMED DEFECTIVE EQUIPMENT OR PART. UNDER NO CIRCUMSTANCES SHALL GLASCRAFT BE LIABLE FOR INCIDENTAL OR CONSEQUENTIAL DAMAGES OR FOR LOST PROFITS.

No action arising from or relating to any goods manufactured by or purchased from GlasCraft may be brought more than one (1) year after the cause of action accrues.

Section 4 - Technical Assistance

Thank You for selecting GlasCraft spray equipment

Should you have any questions or need technical assistance, contact your factory authorized GlasCraft distributor.

Distributor: _____

Phone: _____

Contact: _____

For any issues your distributor cannot address, the GlasCraft technical service department is always available to assist you with the operation of your spray equipment. To help our technical representatives expedite your call and better address your questions, please have the following information ready and available when you phone GlasCraft.

*** If your questions are not urgent, You can e-mail all correspondence to service@glascraft.com**

For Air Powered Systems:

Model: _____

Serial number: _____

Type of spray gun: _____

Serial number: _____

Is your equipment:

Single phase: _____ Three phase _____

What is the inbound voltage
to your equipment: _____

Temperature setting ISO: _____

Temperature setting POLY: _____

Temperature setting HOSE: _____

Air compressor size: _____

CFM generated: _____

Pressure at the system:

Hydraulic _____ Pneumatic _____

Dynamic fluid pressure:

ISO _____ POLY _____

Spray gun chamber size: _____

Material being sprayed: _____

Viscosity: ISO _____ POLY _____

Approximate material temperature: _____

For Your Reference



Date Purchased _____
Distributor _____

Contact _____
Phone _____
E-mail _____

GlasCraft manufactures a complete line of polyurethane foam and polyurea coating spray systems. If your application is in-plant or a field contractor - GlasCraft has a system package to meet your requirements.

GUARDIAN - AIR POWERED / A5 & A6 SERIES EQUIPMENT

- . 6000 OR 12000 WATTS OF HEAT
- . 1600, 2200, OR 3000 PRESSURE SET-UPS AVAILABLE

MH, MH II, & MH III HYDRAULIC POWERED SYSTEMS

- . UP TO 45 LBS / MINUTE OUTPUT
- . EXCELLENT PERFORMANCE AND RELIABILITY

GUARDIAN MMH - MOBILE MODULAR HYDRAULIC SYSTEMS

- . SPECIFICALLY DESIGNED FOR ANY TYPE OF SPRAY RIG
- . GIVE COMPLETE UTILIZATION OF FLOOR SPACE IN MOBILE RIG

PROBLER P2 SPRAY GUN

- . IMPINGEMENT MIX / AIR PURGE
- . OPTIONAL NOZZLE FOR SPRAYING STUD WALLS, POURING & STREAM JET

For more information concerning any of these GlasCraft products,
contact your local authorized GlasCraft distributor or visit www.glascraft.com

Quality and Performance...

GENUINE GLASCRAFT



MCC EQUIPMENT & SERVICE CENTER

7301 Georgetown Road, Suite 210
INDIANAPOLIS, INDIANA 46268

Phone 317-209-1111

Fax 317-876-3554

www.mccind.com



www.glascraft.com

GC-1386

REVISION D

P/N 30149-00

A GRACO COMPANY

GRACO INC.
P.O. BOX 1441
MINNEAPOLIS, MN 55440-1441

Phone 612-623-6921
Toll Free 1-800-328-0211
Fax 612-378-3505