

PULSE

30W Wireless Portable PA System with MP3 Player

Model: MEGAMOUTH MP3 MKII



www.pulse-audio.co.uk

Safety Information



The lightning bolt within a triangle is intended to alert the user to the presence of a dangerous voltage levels within the product's enclosure.

To reduce the risk of electric shock, do not remove cover of this device. There are no user serviceable parts inside. Refer servicing only to qualified service personnel.

The exclamation point within a triangle is intended to alert the user to important operating and maintenance (servicing) instructions in the literature accompanying the appliance.

This voltage may be of sufficient magnitude to constitute an electric shock risk.

Safety Precautions

- Read and retain these instructions
- Follow all instructions and heed warnings
- Do not use this device near water
- If the surface becomes dirty, clean only with dry cloth, do not use solvents or thinners
- Do not block ventilation openings
- Do not install near heat sources such as radiators, heat registers, stoves, or other devices that produce heat
- Do not defeat the safety purpose of the grounded plug. The BS1363A 13A mains plug has two blades and a third ground prong. The wide blade or third prong is provided for your safety. If the provided plug does not fit into your outlet, consult an electrician for replacement of the obsolete outlet
- Protect the power cord from being stressed at the plugs, main socket outlet, and where they exit the amplifier
- Only use accessories specified by the manufacturer
- Unplug the device during lightning storms or when unused for an extended time
- Refer all servicing to qualified personnel
- This device must not be exposed to water in any way. No object filled with liquids should be placed on apparatus

Pulse 30W Wireless Portable PA System with MP3 Player

A wireless portable digital PA system that has a built-in MP3 player for digital music playback from SD/MMC card or USB flashdrive. Ideal for mobile use in schools, lectures, theaters and conferences. It has an internal rechargeable battery & VHF wireless receiver.

This unit includes a host of features, along with an impressive list of specifications, which are detailed over the next pages. Please take the time to read this document completely prior to installation of this product. Should you have questions regarding installation or operation of this unit, please contact your Pulse Retailer or Pulse Technical Support.

Features

- 30Wmax Power output
- 50m Effective range (open field)
- Internal MP3 player:
 - Play MP3 and WMA files via internal memory, SD/MMC cards or USB flash drives
 - Supports 3 folder levels
 - Remote control
 - 11 EQ modes and 3 repeat modes
- Power ON/Off/Volume, MP3, Echo & Tone controls
- Low power, Charging, Power & Wireless receiver LED indicators
- Signal level indicator LED array
- Retractable antenna
- Integrated folding handle
- Handheld VHF wireless microphone
- VHF Wireless belt pack transmitter with tie clip & headset microphones
- 6.35mm (1/4") Jack socket microphone input
- 6.35mm (1/4") Line out
- 2x Phono line input - suitable for laptop or MP3
- 3.5mm Jack socket headphone out & Aux in
- 12V DC Power socket
- Dimensions (WxHxD): 264x335x145mm
- Weight: 6kg
- Supplied with PA system, Handheld wireless mic, Headset mic, Lavalier mic, Beltpack transmitter, 2x 9V batteries, mains lead & user manual.

Specification:

Amplifier		Transmitter	
RF Frequency Range	173.8Mhz or 174.8Mhz	RF Frequency Range	173.8Mhz or 174.8Mhz
Line Output Impedance	600Ω	Dynamic Range	80dB
S/N Ratio	≥60dB	Frequency Response	100Hz-10kHz
Power Output	35Wmax / 20Wrms	Power Supply	9V PP3 Battery
Effective Distance	50m (open field)	Battery Life	10 Hours (High Quality Alkaline)
Power Supply	230Vac~50Hz or 12-15Vdc		

Connections & Controls:

NOTE: Before connecting or disconnecting any cables, microphones or instruments it is good practice to turn down all level controls and where possible switch off the system. This will prevent any pops, clicks or bangs that could damage unit. Main's cords and speaker cables should be connected and disconnected with the power switched off.

Fig.A

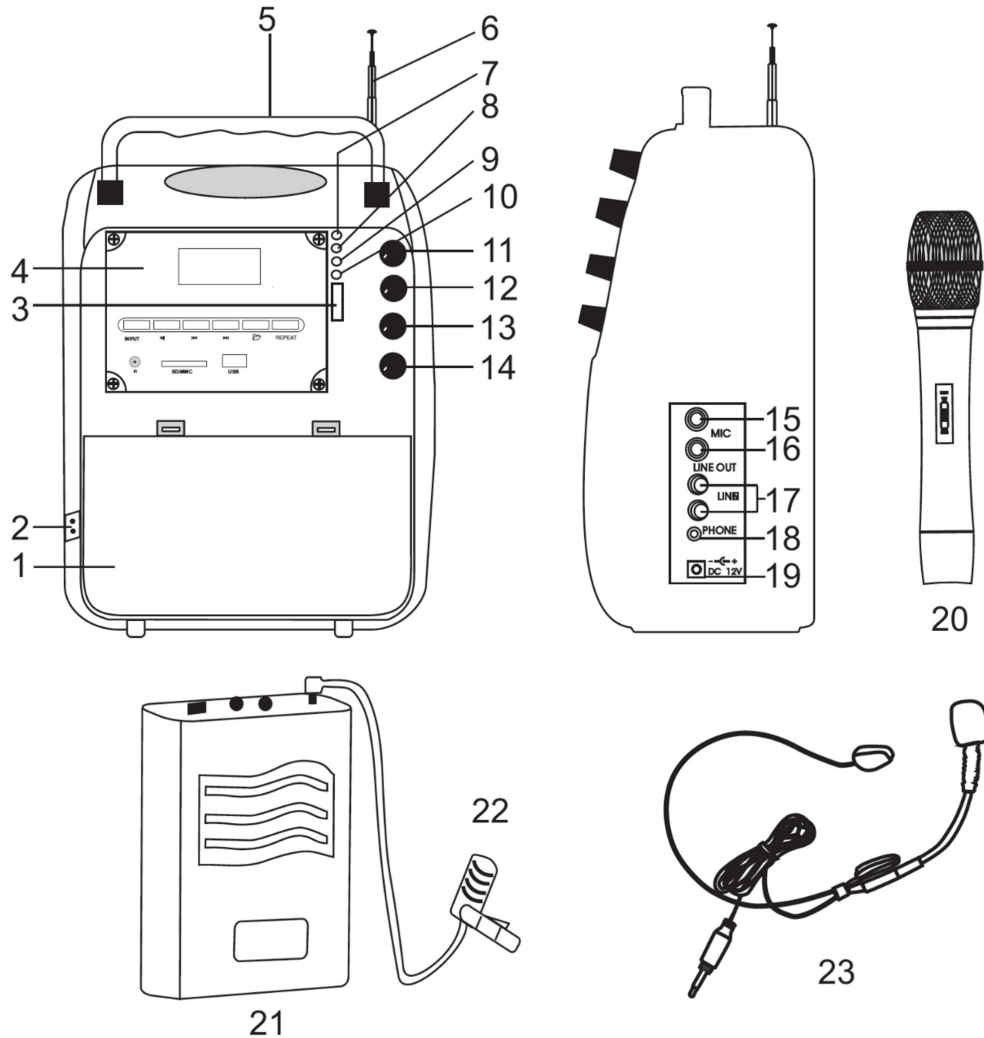

1. Battery Cover
2. AC/Mains input
3. AF level meter
4. MP3 player
5. Handle
6. Antenna
7. Low battery power indicator
8. Charging indicator
9. Power indicator
10. RF indicator
11. Master power switch & volume
12. MP3 power switch & volume

13. Echo control
14. Tone control
15. MIC input jack
16. Line output jack
17. Line input jack
18. Headphone output jack
19. DC input jack
20. Handheld wireless microphone
21. Body pack wireless transmitter
22. Lavalier (tie clip) microphone
23. Headset microphone

MP3 Player (fig.B)

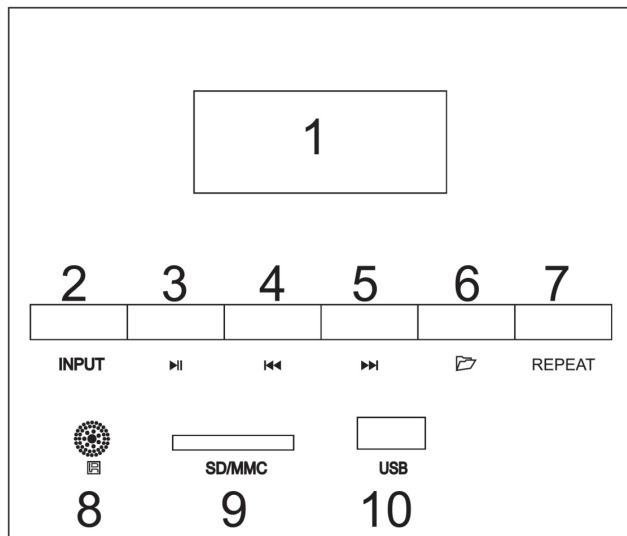

1. LCD Display
2. Input source selection
3. PLAY/PAUSE
4. PREVIOUS
5. NEXT
6. Folder
7. Repeat
8. Remote Sensor
9. SD/MMC card slot
10. USB port

Remote Control (fig.C)

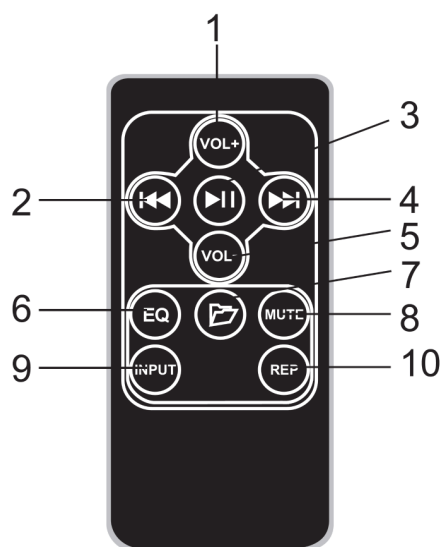

1. LCD Display
2. Input source selection
3. PLAY/PAUSE
4. PREVIOUS
5. NEXT

Operation

1) POWER

a) AC / Mains Power:

- i) This unit is designed for operation on 230Vac~50Hz only – care should be taken before connecting to any mains voltage supply to ensure the outlet conforms with this specification.
- ii) Connect the unit to the local mains voltage supply, turn the master volume control (11 – fig.A) clockwise past the click point and the main unit will power up. The power indicator (9 – fig.A) will illuminate to indicate normal operation.

b) Built-in Rechargeable 12V battery:

- i) Open the battery compartment and connect the battery terminals, take great care to ensure the leads are connected with the correct polarity (Red = Positive +ve, Black = Negative -ve).
- ii) Turn the master volume control (11 – fig.A) clockwise past the click point and the main unit will power up. The power indicator (9 – fig.A) will illuminate to indicate normal operation. If the low power indicator (7 – fig.A) the unit requires connection to AC Mains Power to recharge the battery.

c) Connection to DC Power:

- i) The MEGAMOUTH can be charged and operated from an external 12V DC power source when connected to the DC IN jack (19 – fig.A)
- ii) The DC power supply must be 12-15V DC and of the correct polarity. The DC IN jack requires a “centre positive” connection.

2) CHARGING THE BATTERY

- a) Plug the mains power cable into the AC power jack, the charging indicator (8 – fig.A) will illuminate red. Charging the unit takes on average 10 hours. The battery will charge with the power switch in either the off or the on position.
- b) When the charge indicator (8 – fig.A) turns green this indicates the unit is charged and ready for use.
- c) The battery should be discharged and recharged every two months to avoid damage to the battery.

3) MP3 PLAYER

- a) Turn the master power volume (11 – fig.A) clockwise past the click point, the power indicator will illuminate.
- b) Turn the MP3 power switch and volume clockwise past the click point, the LCD Display will illuminate and display “SEARCHING”. If no flash drive or SD card is inserted the display will show “NO DEVICE”.
- c) Insert a flash drive into the USB port (10 – fig.B) or an SD/MMC card into the SD/MMC card slots (9 – fig.B) and the unit will begin playback automatically. If both USB and SD/MMC cards are inserted the player will prioritise the USB flash drive. To change source from the USB flash drive to the SD/MMC card press the INPUT button (2 – fig.B).
- d) The MP3 player has 11 EQ modes: Normal, Rock, Pop, Classic, Jazz, Blues, Hall, Bass, Soft, Country and Opera. To select any of the modes press the EQ button (6 – fig.C) on the remote control. This function is only available via the remote control and cannot be accessed from the main control panel (fig.B)
- e) The MP3 player has three repeat modes: Repeat Track, Repeat Folder and Repeat All. To access the repeat functions press the REPEAT button (7 – fig.B or 10 – fig.B).
- f) The MP3 player can support up to levels of folders within the USB flash drive or SD/MMC card.
 - i) Press the folder button (6 – fig.B). The first level folders will display on the screen. (the LCD screen can display up to four folders at once. If there are more than 4 folders, press **VOL-** button to go to the next page of folders. Press **VOL+** button to return to the last page)
 - ii) Press **◀◀** or **▶▶** buttons to choose the song and press **▶** to play the track.

4) WIRELESS MICROPHONES

- a) Insert a 9V PP3 battery into the transmitter. The battery compartment for the handheld microphone is accessed by unscrewing the cap at the base of the unit (20 – fig.A) while the batter

compartment in the beltpack transmitter is accessed by sliding the front portion downwards away from the switches (21 – fig.A). Switch on the transmitter via the power switch, the battery light on either of the transmitters will flash and then remain off. **NOTE:** When the power indicator LED illuminates the battery power is low – replace the battery with a new one taking care to dispose of the old battery via an appropriate recycling scheme.

- b) Extend the aerial on top of the main unit (6 – fig.A).
- c) To confirm the selected wireless transmitter is working correctly the RF indicator (10 – fig.A) will illuminate. **NOTE: Only one wireless transmitter can be switched on and operated at a time – switching two transmitters on at the same time will lead to the RF signal dropping out causing an unreliable audio signal.**
- d) Adjust the amplifier main volume, tone, echo controls to suit. Take great care to avoid feedback when adjusting controls and levels. Should the transmitter become too close to the amplifier feedback can easily occur, this is a result of the microphone picking up the sound from the main speaker and the system amplifying the sound numerous times resulting in a dangerous high pitch noise. Feedback can damage audio systems and also present a danger to human hearing.

5) WIRED MICROPHONES

An additional wired microphone can be used with the MEGAMOUTH systems. The system accepts most dynamic handheld microphones. Plug the MIC into the 6.35mm (1/4") mono jack socket (15 – fig.A) on the side of the main unit.

6) EXTERNAL AUDIO SOURCES

The MEGAMOUTH will accept a standard line level input (17 – fig.A). Typical devices that can be used with the LINE IN are MP3 players, laptops and CD players.

7) AUDIO (LINE) OUTPUT

The MEGAMOUTH has a standard Line Level output for connection to a second MEGAMOUTH unit – this will allow coverage of larger venue's. The cable required to link from unit to unit is a "Mono 6.35mm (1/4") Jack to 2x Phono Plugs" your local PULSE dealer will stock these.

8) PHONE OUT

The MEGAMOUTH provides a headphone output for use with standard headphones or earphones. The jack socket (18 – fig.A) will accept most 3.5mm (1/8") stereo headphone plugs.

Compliance

When this product reaches the end of its life, do not dispose with household waste. See www.recycle-more.co.uk for details of how to dispose of PULSE products in an environmentally sound fashion, or contact PULSE directly via www.pulse-audio.co.uk



Warranty

Pulse products are warranted, by Pulse, against manufacturer defects for a period of one year from the original date of purchase. This warranty is limited to manufacturer defects, in either materials or workmanship. Consumable items such as batteries and lamps are covered for a period of 90 days from date of original purchase. PULSE, or any other worldwide divisions of Premier Farnell PLC, is not responsible for any consequential or inconsequential damage to any other component, structure or the cost of installation or removal of said items. Defective items should be returned to the retailer from whom they were originally purchased.

This warranty will not cover damage due to improper use such as (and not limited to) damaged cones, mounting frames, voice coils or items damaged by weather damaged items. Batteries are covered by a 90 day warranty from date of purchase.

For questions or specific information regarding warranty replacement or repair, contact:

PULSE
www.pulse-audio.co.uk