

Quick Start

3.5 mm
headset jack



micro-SIM/
microSD™
card slot

Power/lock key

Volume

Charging/USB port





LG G Pad 7.0^{LTE}



Dual Window

View two apps at once.

- ① From the home screen, press  and choose two apps.
- ② Drag  to adjust the size of the windows. Tap  for additional options like switching the position of the apps, accessing the Dual Window app list, or closing out an app.

Tap the icon you want

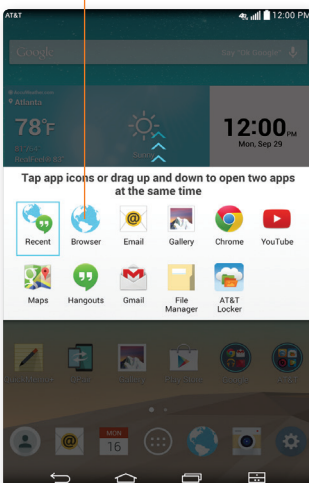

Drag to adjust
window size

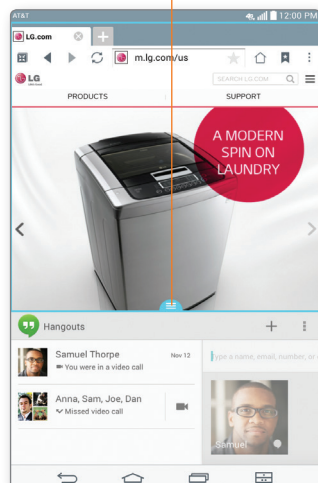

Note: Only apps found within the Dual Window panel can be opened at the same time.

AT&T Ready2Go

Ready2Go helps you configure Wi-Fi®, email, and social networks when initially setting up your device.

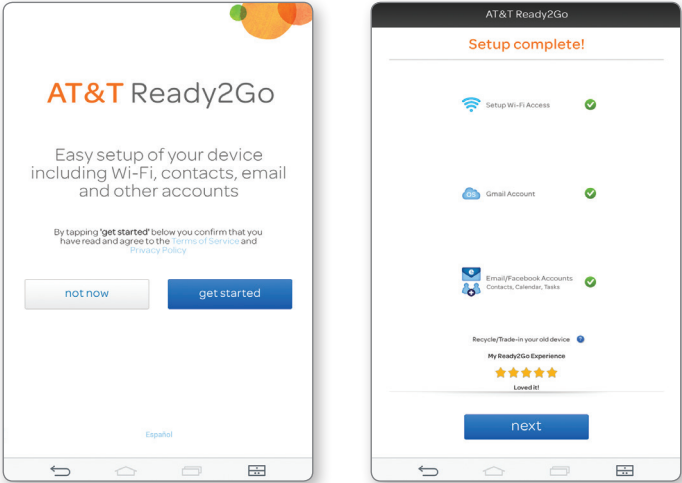

QPair™

Link your Android™ 4.1 or higher smartphone and your tablet to get notifications and text messages on your tablet.

- ① Download the QPair app (non-carrier-specific app) onto your smartphone via Google Play™. Once downloaded, access the QPair app on both devices.
- ② Tap **Get started** > **OK** > **Start** on both devices.
- ③ Tap **Pair** on both devices.

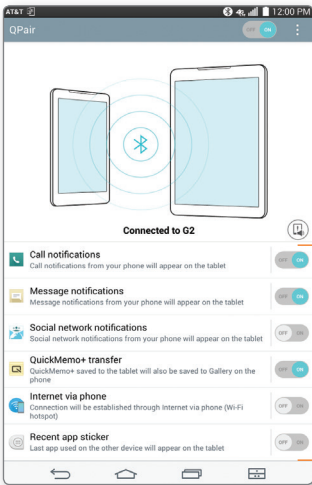

Customize

Add Apps or Widgets

- ① Press and hold an empty part of the screen.
- ② Tap **Widgets** or **Apps**.
- ③ Tap the item you'd like to add.

Change Wallpaper

- ① Press and hold an empty part of the screen.
- ② Tap **Wallpapers**.
- ③ Choose from **Gallery**, **Live wallpapers**, **Multi-photo**, or **Photos**.
- ④ Tap a wallpaper to select it.

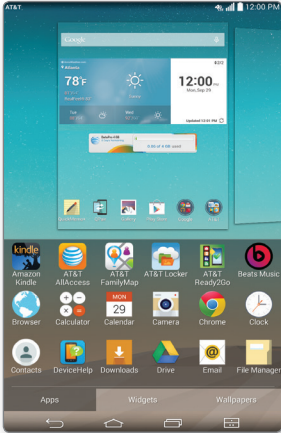

Polaris® Office

View Microsoft® Office documents.

- Open a Microsoft Excel® file
- Open a Microsoft Word® document
- View Favorites
- Share the document view
- Open a Microsoft PowerPoint® presentation
- Open a text file
- Open an Adobe® PDF
- Create a new document

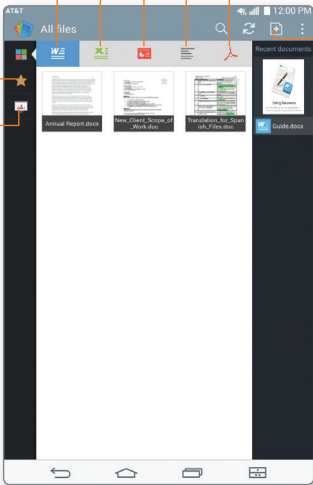

Notifications

Swipe the top of the screen downward to open the Notifications Panel.

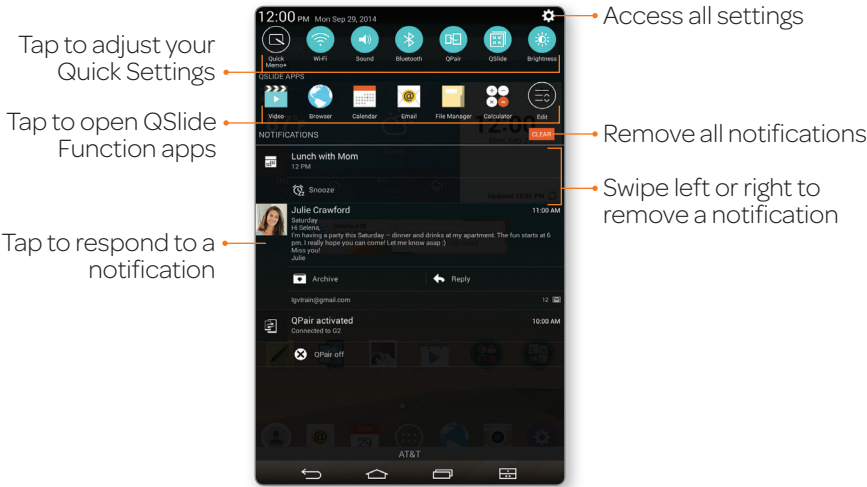

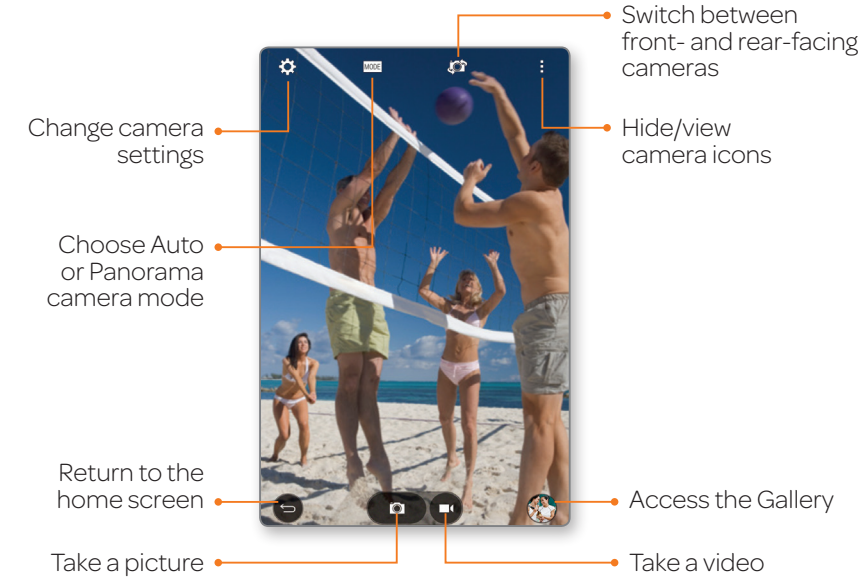

P/N: MBM64655901(1.0)

Camera and Video



Sharing Photos

- ① From the home screen, tap .
- ② Tap an album.
- ③ Tap a photo to share, tap , then choose an option and follow on-screen instructions.

Email

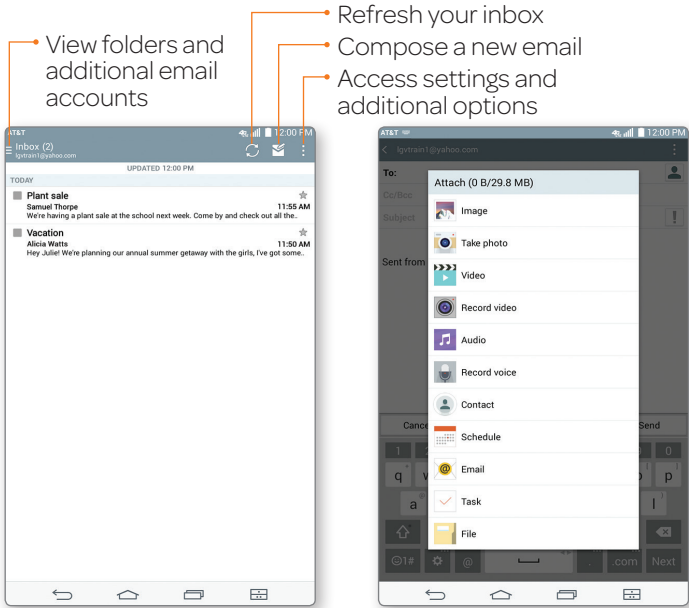

- ① From the home screen, tap .
- ② Tap an account type. Steps may vary from this point.
- ③ Enter your email address and password and tap **Next**.
- ④ Follow additional on-screen instructions to complete setup and tap **Done**.





Note: Contact your IT administrator to help set up your corporate Microsoft Exchange™ account.

Wi-Fi and Bluetooth®

Connect to Wi-Fi

- ① From the home screen, tap  > **Wi-Fi**.
- ② Tap  to turn on Wi-Fi.
- ③ Tap a network name. Enter a password if required and then tap **Connect**.

Use Bluetooth

- ① From the home screen, tap  > **Bluetooth**.
- ② Tap  to turn on Bluetooth.
- ③ Tap **Search for devices**.
- ④ Tap a device to pair. See the *Bluetooth* device's user manual for more information on pairing.

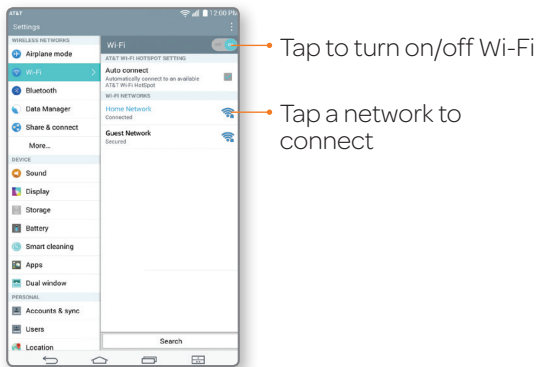

Web

From the home screen, tap .

Enter a web address or search term

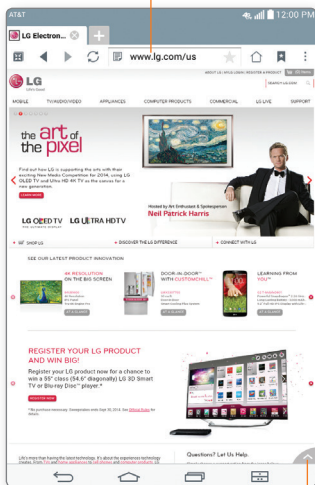

Tap to reveal the Browser Bar

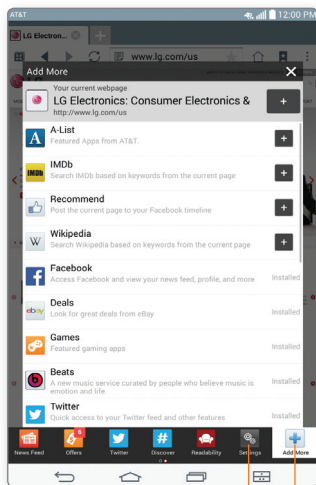

Tap to remove the Browser Bar

Select a button to add or create one of your own

Manage Your Mobile Connection

If your AT&T service was activated at the time of purchase, you'll automatically connect to the mobile network.

AT&T AllAccess

To activate service:

- ① From the home screen, tap **Activate** on the AT&T AllAccess widget.
- ② Follow the on-screen steps to activate a data plan.

Once service is activated, the AT&T AllAccess widget displays data used while you're connected to the mobile network.

To monitor data usage:

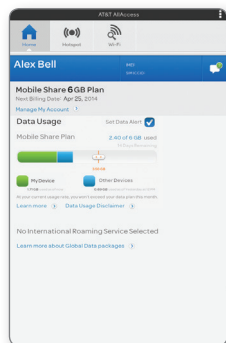

- View plan and data usage details*
- Enable mobile hotspot to share your internet connection**
- View free AT&T Wi-Fi Hot Spots in your vicinity



*Actual billed usage can be higher than estimated data usage displayed on the usage meter. For example, actual billed usage may be higher when: part of a shared data plan such as Mobile Share; multiple users with different log in credentials using the same device; traveling internationally or outside AT&T's network; using the SIM card with another device; or, using a tethered handset. Unlimited Wi-Fi usage on AT&T's entire national Wi-Fi network is included at no additional charge with a qualifying data plan. Access includes AT&T Wi-Fi Basic. Restrictions apply. See www.attwifi.com for details. The name "attwifi" will appear in the Wi-Fi network list when available.

**Req's Mobile Share Value or a min. DataPro 5GB plan. Devices connected to a Mobile Hotspot use data from your plan. Overage charges apply if exceed monthly data allowance. Number of devices you can connect depends on your device. Performance varies based on number of devices connected and other factors. If you do not use a password, others will be able to use your Mobile Hotspot. Visit a store or att.com to learn more.

LG Smart Keyboard

- ① From the home screen, tap  > **Language & input**.
- ② Tap  to the right of **LG Keyboard**.
- ③ Tap **Keyboard height and layout**.
- ④ Tap a category to access its settings:
 - Bottom row keys
 - Extended keyboard
 - Keyboard height
 - Keyboard theme
 - Split keyboard

Bottom row keys

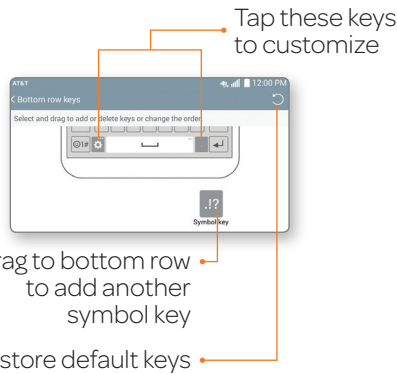
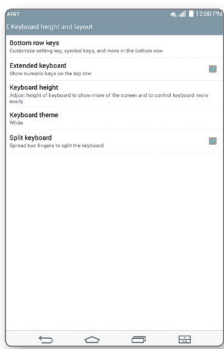

AT&T Services

These can be found in your **AT&T folder**  or in **Apps** .



myAT&T: Track your usage, review and pay your bill, and update your data plan services.



DeviceHelp: View helpful videos and tutorials.



AT&T Locker: Store, sync, and share photos, videos, and documents in one place.



Keeper: Manage and secure your passwords and other private information.



AT&T Ready2Go: Set up your device quickly and easily.

Knock Code™

Get direct access to the home screen while keeping your tablet secure.

Setup

- ① From the home screen, tap  > **Display** > **Lock screen** > **Select screen lock** > **Knock Code** > **Next**.
- ② Enter a pattern of 3 to 8 taps and tap **Continue**.
- ③ Enter the pattern again and tap **Confirm** > **Next**.
- ④ Enter a backup PIN and tap **Continue**.
- ⑤ Enter the PIN again and tap **OK**.



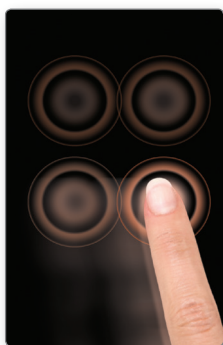

Use

- When your screen is dark, tap your Knock Code anywhere on the screen (portrait orientation).
- On the lock screen, you must tap your Knock Code in the indicated area.



For More Information

On your Tablet

- Tutorials and videos: **Apps**  > **DeviceHelp** 
- Access your account: **Apps**  > **myAT&T** 

On the Web

- Tutorials and videos: att.com/DeviceHowTo
- Manage your wireless account, including suspending service if your tablet is stolen: att.com/MyATT

Give Us a Call

- 800-331-0500
- 6-1-1 from any AT&T wireless phone

Accessories

- att.com/WirelessAccessories
- Visit your AT&T store

4G LTE not available in all areas. LTE is a trademark of ETSI. Learn more at att.com/network. Mobile broadband access requires a DataConnect Plan for Tablets or a Prepaid Session Based DataConnect Pass Plan. For information on DataConnect Plans for Tablets see (<http://www.wireless.att.com/learn/articles-resources/wireless-terms.jsp>) and for information on Prepaid Session Based DataConnect Pass Plans see att.com/buyasession.

LG, LG Life's Good, and the LG logo are registered trademarks of LG Corp. Portions © 2014 AT&T Intellectual Property. All rights reserved. AT&T, the AT&T logo and all other AT&T marks contained herein are trademarks of AT&T Intellectual Property. All other marks contained herein are the property of their respective owners.