

MANUAL FOR INSTALLATION AND USE

FAMILY CODE

121-053

KIPTRONIC EUO 2

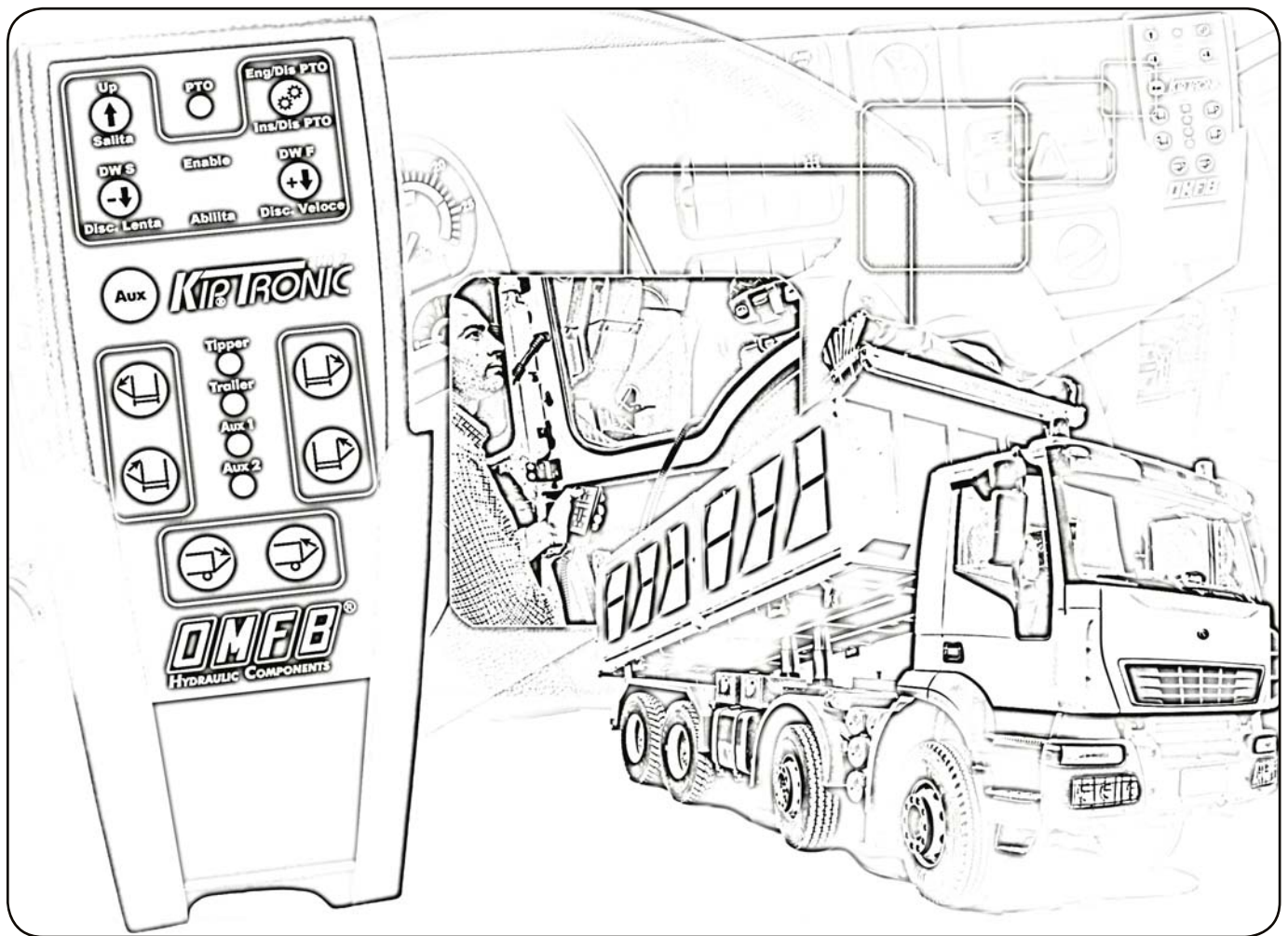

Data: Mercoledì 13 ottobre 2010

Codice foglio: 997-010-12156 Rev: AE

page 1

OMFB
HYDRAULIC COMPONENTS

O.M.F.B. S.p.A. Hydraulic Components
We reserve the right to make any changes without notice.
Edition 2006.07 No reproduction, however partial, is permitted.
Via Cave, 7/9 25050 Provaglio d'Iseo (Brescia) Italy Tel.: +39.030.9830611
Fax: +39.030.9839207-208 Internet:www.omfb.it e-mail:info@omfb.it

COMPANY
WITH QUALITY SYSTEM
CERTIFIED BY DNV
=ISO 9001/2000=

1. INFORMATION PRIOR TO INSTALLATION page 3

1.1 Information about SAFETY..... page 3
 1.2 Contents of package page 3
 1.3 Equipment for installation page 4
 1.4 Electric/Pneumatic specifications page 4
 1.5 Product marking page 5
 1.6 Versions available..... page 6

2. INSTALLATION..... page 8

2.1 Introduction..... page 8
 2.2 Mechanical installation page 8
 2.3 Pneumatic connections page 10
 2.4 Electric connections page 12

3. TESTING SYSTEM..... page 14

3.1 Test of signals page 14
 3.2 Test of controls..... page 14
 3.3 P.T.O..... page 14
 3.4 Tip control page 15
 3.5 Low control..... page 16
 3.6 Control of tractor/crane selector page 17
 3.7 Tipper’s manual control..... page 17
 3.8 Setting the speed of slow lowering (121-053-02008) page 18
 3.9 Block of rear door (121-053-02017) page 19
 3.10 Auxiliary side doors and tarpaulin system controls (121-053-02017) page 20
 3.11 Hydraulic unit remote switch (121-053-02017) page 20
 3.12 Firmware setup (121-053-02017)..... page 21

4. TECHNICAL FEATURES OF PRODUCT page 22

4.1 Pneumatic diagram.....page 22
 4.2 Wiring diagram.....page 23

Data: Mercoledì 13 ottobre 2010

Codice foglio: 997-010-12156 Rev: AE

1. INFORMATION PRIOR TO INSTALLATION

General information for the product installation.

1.1 Information about SAFETY

The installation should be made only by specialized personnel with adequate training. During installation it must be taken all the necessary measures and precautions to ensure the personal safety and that of the people around in the installation zone. In particular, if the KipTronicEVO2 is installed on a vehicle with tilting platform already installed, a safety pole must be used.

Electrical and pneumatic connections made during installation of the system must be carried out in a workmanlike manner using equipment, consumable materials and procedures that respect the necessary safety standards.

1.2 Content of the package

Before proceeding with installation, make sure the KipTronicEVO2 package contains the following materials:

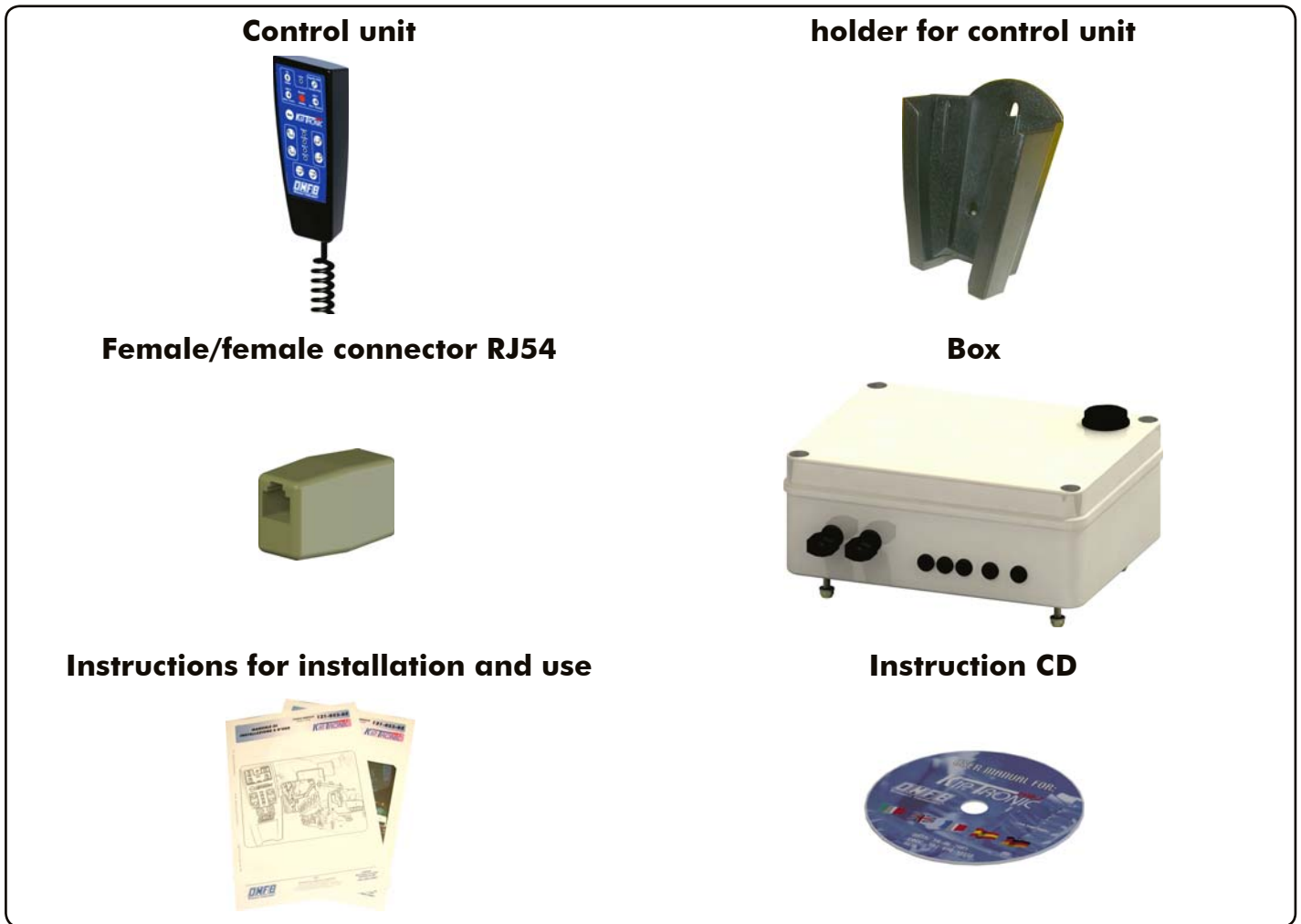

Control unit

holder for control unit

Female/female connector RJ54

Box

Instructions for installation and use

Instruction CD

Data: Mercoledì 13 ottobre 2010

Codice foglio: 997-010-12156 Rev: AE

1.3 Equipment for installation

Before proceeding with installation make sure you have the following tools and materials:

- 6 mm plastic hose
- Pipe cutter (NOTE: pipes for pneumatic uses must be cut with a special tool otherwise the pneumatic circuit may lead due to the ovalization caused by cutting the pipes with other tools)
- Fastening bracket
- Fastening screws
- Plastic clamps



1.4 Electric/Pneumatic specifications

- | | |
|--------------------------------|---|
| • Supply voltage | 24V DC |
| • Current absorbed on Stand-by | 0,5 A |
| • Current Absorbed to energize | 1 solenoid/2 solenoids |
| • Input managed: | 12 keys per control unit |
| | 5 direct inputs on logic unit |
| • Outputs controlled: | 5 solenoids in Box |
| | 3 accessory outputs with a capacity of 1 A |
| | 8 accessory outputs with a capacity of 0.5A |
| • Working pressure | MAX 12 bar treated air |
| • Temperature range | -30 +50 (°C) |
| • IP Protection (EN 60529) | IP44 |
| • Dimensions | 219x294 mm |
| • Weight | |

1.5 Product markings and certification

The electronic KipTronic EVO2 device complies with the essential requisites and other pertinent provisions of European Directive 2006/28/CE (Ministry Decree of Feb. 20, 1996) and ECE/ONU regulation no. 10 Amendment 9, regarding "Elimination of radioelectric disturbance (Electromagnetic Compatibility) caused by the controlled ignition engines of motor vehicles".

On the subject of Electromagnetic Compatibility, directive 2006/28/CE is the reference directive for electric/electronic units installed on road vehicles as it is the specific directive for the purposes of art. 2, para. 2, of directive 89/336/CE enacted as of January 1, 1996. The requisites of directive 2006/28/CE must be satisfied on the subject of Electromagnetic Compatibility by all vehicles defined in directive 70/156/CE as regards approval of motor vehicles and trailers, as last amended by directive 92/53/CE, and their components or technical parts, which are thus exempt from compliance with the provisions of directive 89/336/CE.

The conformity tests required by directive 2006/28/CE and regulation ECE/ONU no. 10 Em. 9 were carried out in the PRIMA RICERCA & SVILUPPO (via Campagna, 58 - 22020 Gaggino Faloppio (CO)).

Approval of the electronic KipTronic EVO2 device with the requisites of Dir. 2006/28/CE is certified by the NSAI (National Standards Authority of Ireland-Glasnevin, Dublin 9, Ireland (+353-1-80703910)) which has issued the approval number for marking the product, as follows:

e24*72/245*2006/28*1352

Approval is proven by marking the product:

e24 **031352**

Approval of the electronic KipTronic EVO2 device with the requisites of Regulation ECE/ONU no. 10 Em.9 is certified by the NSAI (National Standards Authority of Ireland-Glasnevin, Dublin 9, Ireland (+353-1-80703910)) which has issued the approval number for marking the product, as follows:

E24 10R-020015

Approval is proven by marking the product:

E24 **10R** **02 0015**

1.6 Versions available

KipTronic EVO2 is available in the following configurations:

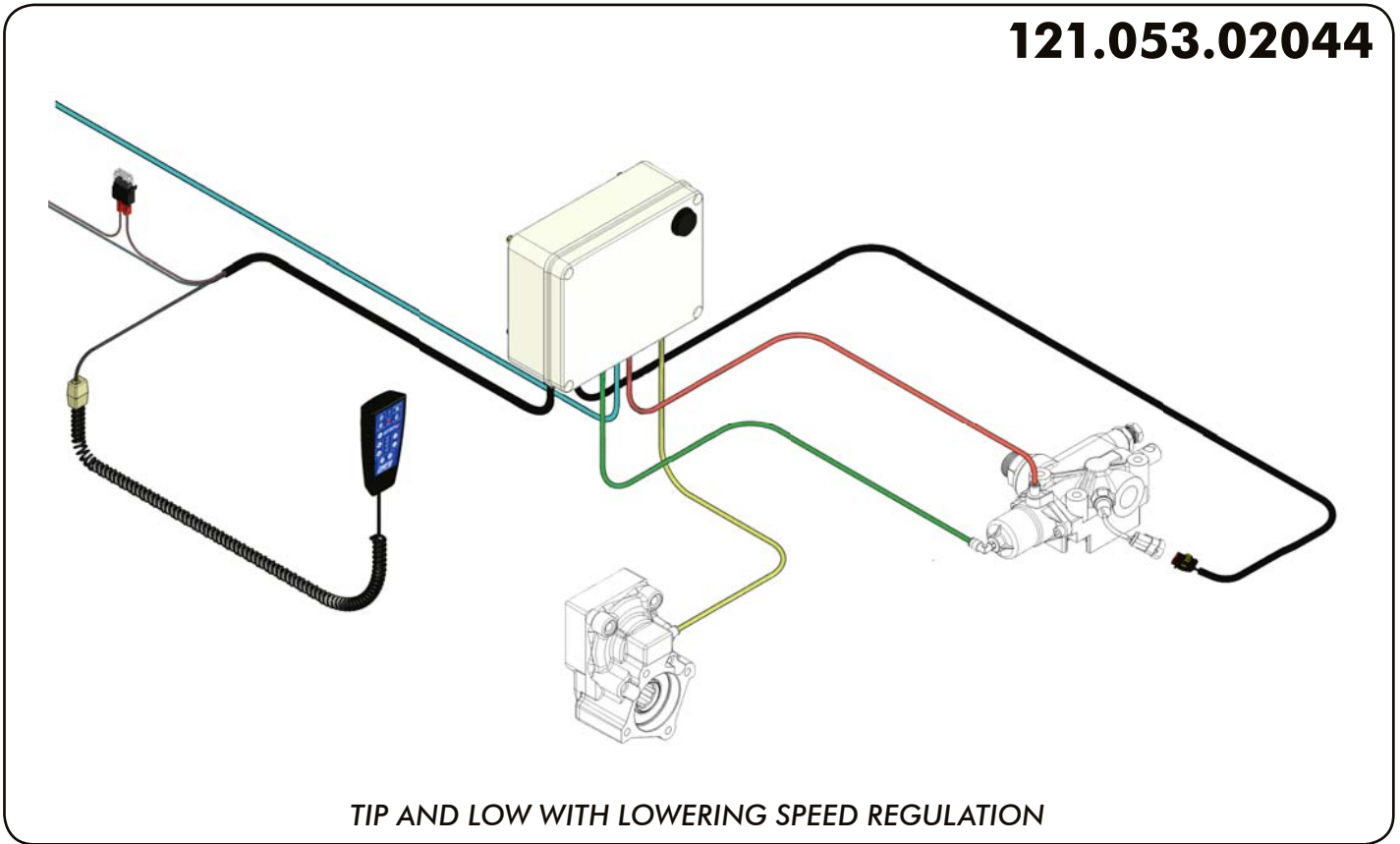
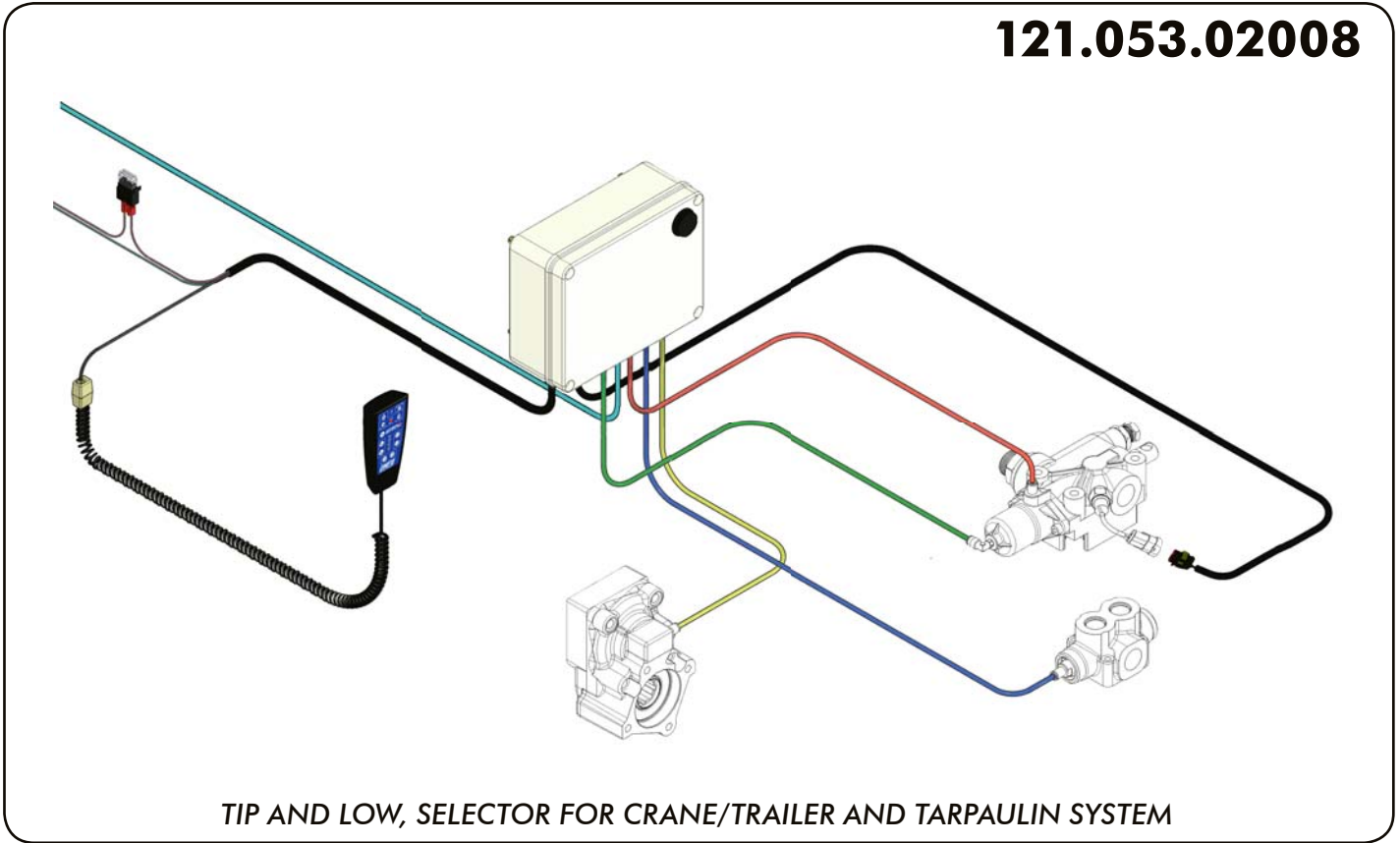

Data: Mercoledì 13 ottobre 2010

Codice foglio: 997-010-12156 Rev: AE

121.053.02017

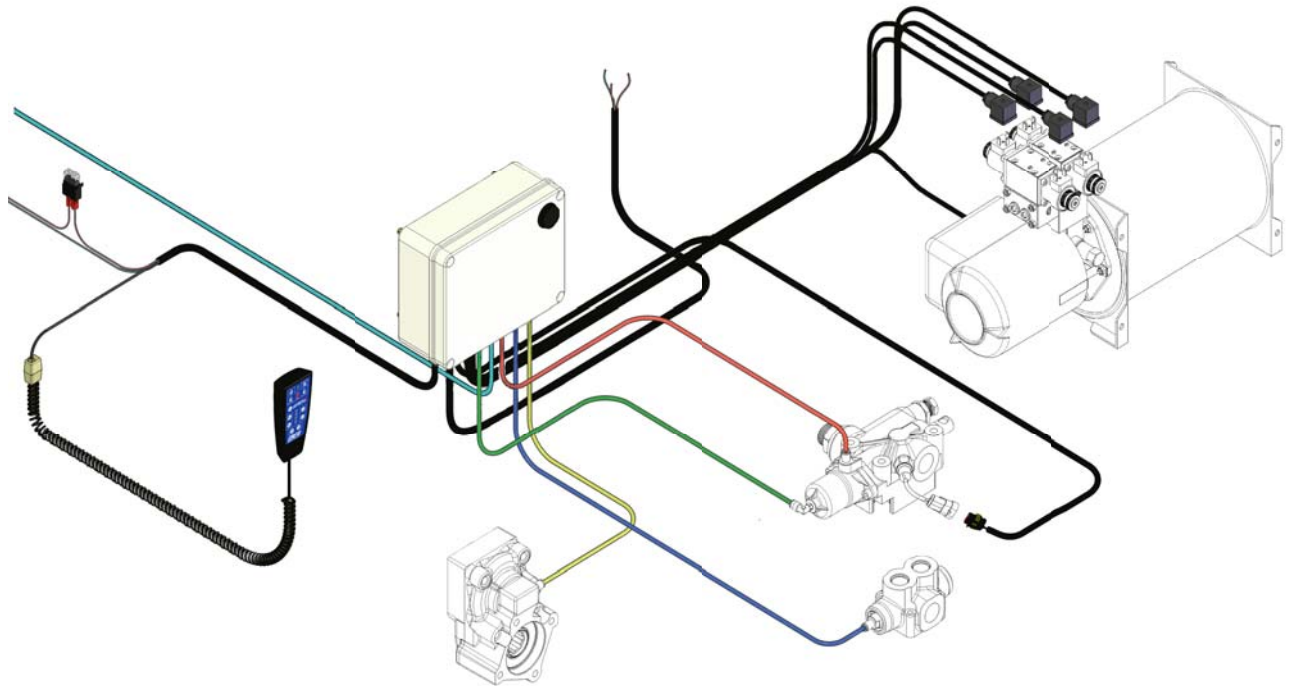

LIKE THE CODE 121.053.02008 + HYDRAULIC DOORS CONTROL THROUGH POWER PACK

121.053.02026/02035

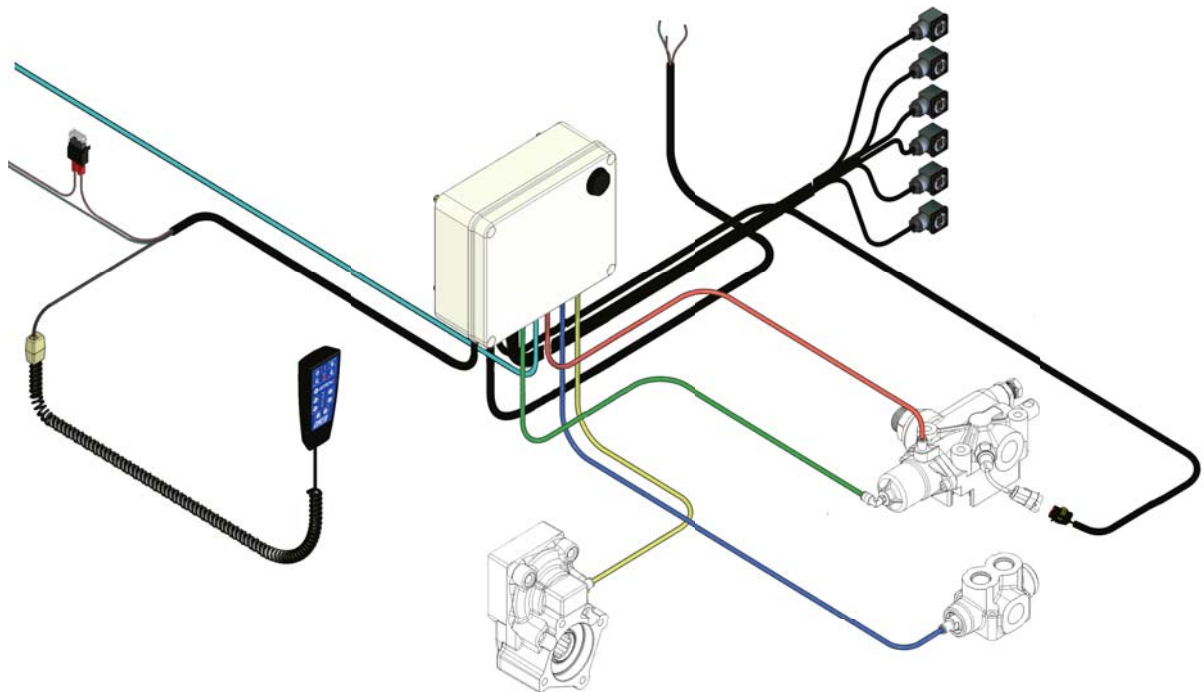

121.053.02026: LIKE THE CODE 121.053.02008+HYDRAULIC DOORS CONTROL BY MEANS OF PNEUMATIC

121.053.02035: LIKE THE CODE 121.053.02008+HYDRAULIC DOORS CONTROL BY MEANS OF ELECTRIC

Data: Mercoledì 13 ottobre 2010

Codice foglio: 997-010-12156 Rev: AE

2. INSTALLATION

This section describes the operations necessary for the installation of KipTronic EVO2 system

2.1 Introduction

The KipTronicEVO2 system was designed to simplify operations of installation. The only necessary operations are the fastening of the Box on the chassis, the connection of the pneumatic circuit and connection of the electric power cable and control unit in the cab. In this chapter we provide some indications as to how to perform each step.

IMPORTANT: In order to ensure the maximum safety of the installer during these operations and to optimize the installation time, you should proceed in the following order:

- Mechanical installation
- Pneumatic connection
- Electric connection

The procedure is described here below, step by step.

2.2 Mechanical installation

Mechanical installation consists of the following steps:

- installation of the Box on the vehicle's chassis.
- positioning of wires including the control cable, the positive power cable (with fuse) and the negative power cable.

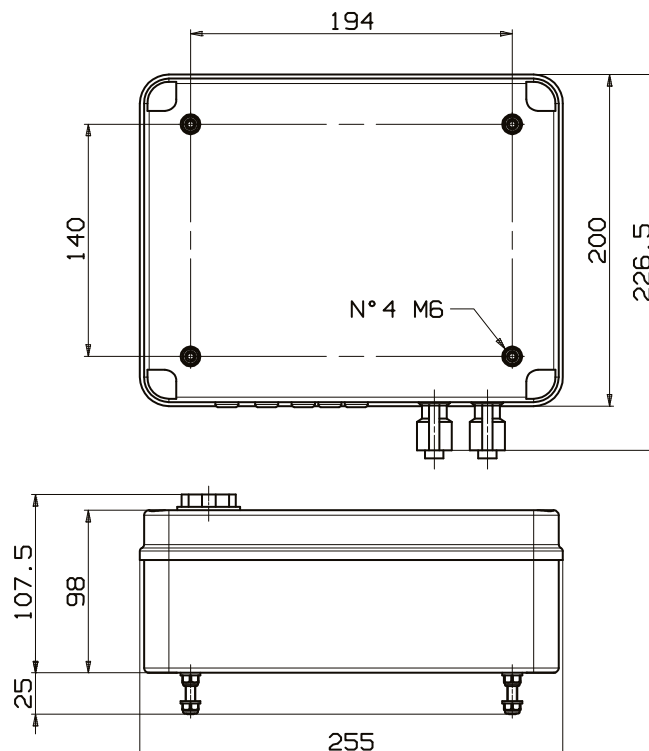

Installation of the Box on the vehicle chassis

You must secure the Box in a zone that satisfies all the following requisites:

- REQUIRED orientation for assembly
- safety during maintenance
- simple use of the tipper's manual controls
- absolute protection from impacts and mechanical stresses
- adequate air circulation around Box

Required orientation for assembly: in order to ensure to the Box the degree of protection for which it was designed, it must be installed according to the given instructions. And only as shown below. Installation in any other way could cause malfunctioning of the system that would automatically invalidate the warranty.



Safety during maintenance: The chosen zone must make it easy and safe to perform the maintenance on the internal parts of the Box. We therefore recommend a place that can be reached from outside the vehicle, without raising the tipper for maintenance and without having to remove the Box in order to open the cover and work on the parts inside.

Easy use of the manual platform raising and lowering controls: These controls are inside the Box. The Box must be mounted as to allow that, in case of breakdown of the KipTronicEVO2, the operator can easily open the Box and operate the tipper tip and low controls manually from a safe position.

Absolute protection from impacts and mechanical stresses in general: The Box contains hightech parts tested to bear the vibrations of the vehicle. However, these parts should be protected against impacts and mechanical stresses as they could get critically damaged. Moreover, direct impacts and mechanical stresses to the Box may case the loss of the level of protection with regard to water and dust and this could cause malfunctioning in the long term of the KipTronicEVO2 control system.

Adequate circulation of air around the Box: The Box contains hightech parts designed and tested to withstand the temperatures typically found in the zone of the chassis near the vehicle transmission. It is necessary, however, that enough air circulates around the Box.

Wiring installation

To install the wiring in side the cab, including the telephone cable and the positive and negative power cables, use the passages provided from the outside to the inside of the cab which the installer should know and identify.

The head of the wires (the side where the wires and cable protrude) should be handled with care in order not to damage the cable and wires and especially not to damage the telephone type plug on the end of the control cable. Once the wiring head is inside the cab the installer should check that its passage along the chassis, under the cab and inside the cab will not cause any critical situations (passage far from heat sources) and that the wires are adequately protected, and not subject to repetitive movements that could cause breakage or fatigue.

2.3 Pneumatic connection

IMPORTANT: The installer is responsible for ensuring safe working conditions in this stage. In particular, before making the pneumatic connections, make sure the safety pole has been properly installed under the platform.

IMPORTANT: The pneumatic circuit of the KipTronicEVO2 system is designed for a maximum working pressure of 12 bar. Higher working pressures can damage the system, cause malfunctioning or create risks for persons and property. Before connecting the KipTronicEVO2 to the pneumatic pressure line, check with a pressure gauge that the pressure does not exceed 12 bar: if so, the installer is responsible for installing a pressure reducer on the pneumatic circuit.

When making the pneumatic connections use only suitable piping for automotive applications and cut the pipes with the specific tool (NOTE: pipes for pneumatic uses must be cut with a special tool otherwise the pneumatic circuit may lead due to the ovalization caused by cutting the pipes with other tools)

First connect all the pipes to the outputs as shown in the picture and taking care to use different colors or mark the pipes suitably:

in this way you will reduce the risk of creating risk conditions for the installer due to improper connection to the outputs of the KipTronicEVO2 system.

The pneumatic outputs to be connected are:

- power take-off (where controlled by the KipTronicEVO2 system)
- tipping control
- lowering control
- tractor/crane diverter valve

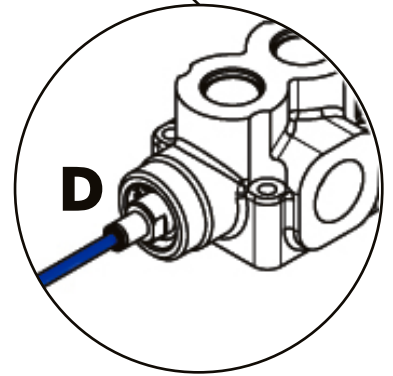
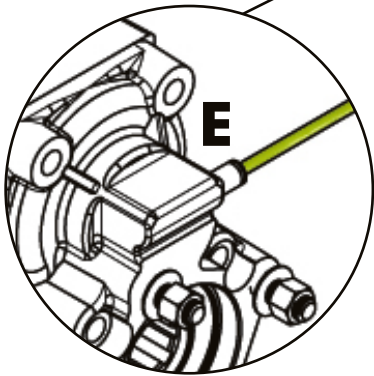
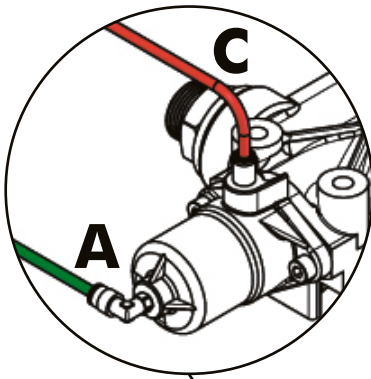
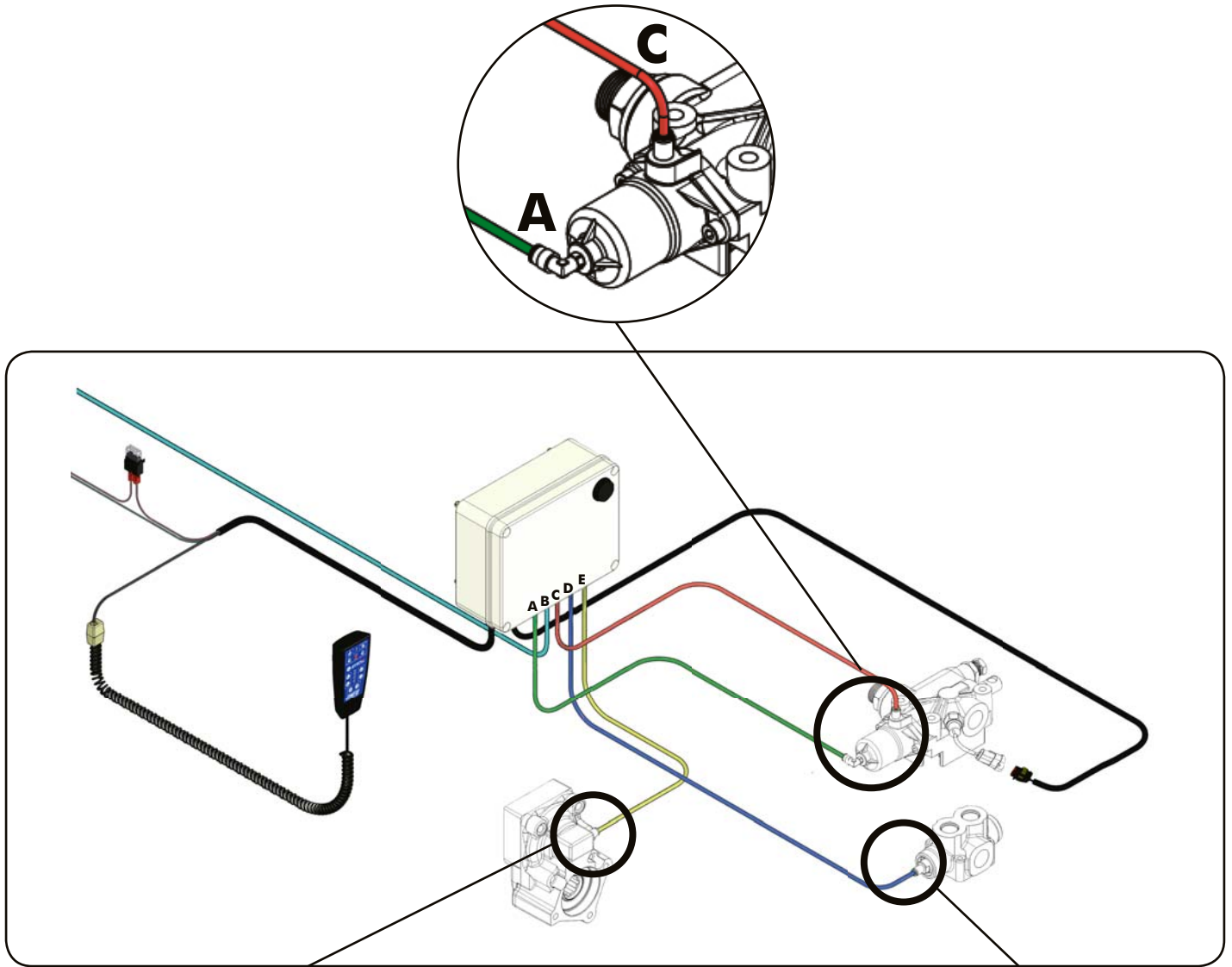

A	lowering control
C	tipping control
D	selector
E	power take-off socket

Data: Mercoledì 13 ottobre 2010

Codice foglio: 997-010-12156 Rev: AE

When all the pipes are connected to the outputs, plug them to the air fittings of the Box respecting the positions shown (see diagram and figure below).

After connecting all the outputs to the Box, connect the pipe on the pneumatic supply line to the input on the Box and then to the pickup point from the vehicle line.

NOTE: This connection must always be the last one to ensure the maximum safety of the installer.

A	lowering control
B	IN
C	tipping control
D	selector
E	power take-off socket

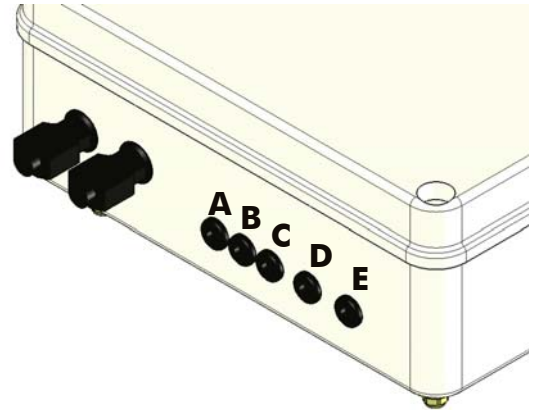

2.4 Electric connection

IMPORTANT: Electrical installations on vehicles and the connection of external devices to the original system must be made by expert personnel, under the absolute and sole responsibility of the person in charge of the job.

IMPORTANT: The installer is responsible for taking all precautions to ensure safe working conditions in this stage. In particular, before starting to make the electric connections, make sure a safety support has been properly installed under the tipper.

Once the pneumatic connection is done, it is possible to proceed with the electrical connections of the KipTronicEVO2 system. This stage consists of the following steps:

- Connection of the wire cable to the sensor that detects the “tipper raised” condition;
- Connection of the control unit to the wire cable in the cab;
- Connection of the electric power line of the locked KipTronicEVO2 system.

“Tipper raised” sensor cable

The KipTronicEVO2 system detects the “tipper raised” condition by closing to mass an input of the logic unit inside the Box. This information is taken to the input of the logic unit by the yellow/black wire in the IN “Platform raised sensor” wire.

The mass wire is supplied in the same wire, so the installer has to bring these two wires to a clean contact (Normally closed or open depending on the type of sensor used and the mode of use).

Control unit in cab

The installation of the control unit in the cab requires connection of the telephone type plug (situated at the end of the wire cable of the control unit) to the telephone jack on the control cable coming from the Box: to make this connection use the female/female adapter supplied with the system.

When making this connection take particular care because any mechanical alteration of the plugs or adapter could cause malfunctioning of the system or problems after installation.

In particular, after connecting the two plugs to the adapter it is important to prevent any mechanical action of the crimping of the wire leading to the plugs: it is a good idea to use a wire clamp to fasten together the coiled wire and the control wire coming from the Box, and a second clamp to fasten them to the vehicle dashboard.



Connection to the electric power supply

IMPORTANT: The power supply of KipTronic EVO2 system should be taken from a dedicated line with all following features:

- with a dedicated switch which should be unabled by users when the vehicle is moving on the road

- protected by a fuse

- positiv under lock and key

It's body builder's own responsibility to make sure the respect of the above mentioned conditions, in order not to lose the warranty on the product.

In case this rule is not respected, the body builder risks to cause damage to person or property and by not respecting it he assumes the whole responsibility of his choice.

IMPORTANT: Connection of the power supply must be made with the vehicle off and the battery disconnection switch must also be off, if possible.

The positive pole of the electric power supply must be connected by a fuse to a locked positive pole of the vehicle: the connection must be made in a "workmanlike manner" using suitable consumable materials for the application of the vehicle.

The negative pole must be connected to a mass point on the vehicle and not to the chassis or other points where "connection to mass is only presumed or random".

3. TESTING OF THE SYSTEM

This chapter describes the procedures for testing the system after installation.

3.1 Testing signals

After the installation is complete, it is important to test, first of all, the function of the signals: tipper raised, doors open...

To test the signals proceed as follows.

Platform raised: create the "tipper raised" condition on the sensor used (switching the limit switch or causing overpressure on the pressure switch...) and check for the yellow light on the control unit and the 95 dB acoustic signal on the Box.....

3.2 Test of controls

After testing the signals, check the operation of each control as follows.

3.3 Power take-off control



For vehicles on which the controls of the power take-off is handled by the KipTronic EVO2 (it means only where a pneumatic connection is installed between the Box and the P.T.O., so that this function will not be used, for example, on vehicles with original P.T.O.) the engagement and disengagement are activated by pressing the "PTO" key.

NOTE: Before pressing the "PTO" the operator must press and hold the clutch; this is valid for to the engagement stage, with the red LED off, and the disengagement stage with the red LED on. When the KipTronicEVO2 controls engagement of the PTO, the condition of "PTO engagement control on" is signaled to the operator by the red led which is "on" with steady light on the control unit and marked "PTO".

When the PTO button is pressed (with the clutch pressed) and the red PTO light is off, the red "PTO" light should come "on" and the control to engage the PTO is sent to the Box which reacts by energizing the PTO control solenoid, present on the solenoid panel in the Box with pressure from its output towards the PTO.

When the red PTO led is on, and the PTO key is pressed and released (with the clutch depressed) the red PTO light should be off and the Box should receive the command to disengage the PTO and react by de-energizing the PTO control solenoid on the solenoid panel in the Box and stop pressure to its output towards the power take-off.

3.4 Tip control

IMPORTANT: The operator is responsible for ascertaining that the tests do not involve any risk for persons or property in the operations area.



In compliance with the regulations in force, the tip control, like all the controls that move the tipper, is configured as a “deadman” control: movement starts when the operator presses the tip key and continues as long as the key is pressed. The instant the operator released the key the tip, or low, stops.

IMPORTANT: It is essential to verify that the ascent movement stops immediately upon releasing the key.

If not, the system should be checked to find the cause of the malfunction (for example, error in electrical or pneumatic connections): if the problem persists contact OMFB for further instructions.

When the tipper starts raising from the rest position, this is signaled by the yellow LED on the Tipper control and by the 95 dB acoustic signal on the Box.

If this does not happen, check the electric connection on the sensor that detects the raised platform conditions (“rat-tail” limit switch, pressure switch...) by shortcircuiting the brown and yellow/black wires, the yellow LED and 95 dB acoustic signal should switch on if they are not present, contact OMFB.

IMPORTANT: It is also important to test the emergency function: with the low control in use (the tipper is lowering), the turning off the ignition key of the vehicle must stop the descent. If not, make sure the power supply of the KipTronicEVO2 system is correctly taken from the locked system as required. If not, there is no emergency stop control.

Data: Mercoledì 13 ottobre 2010

Codice foglio: 997-010-12156 Rev: AE

3.5 Descent control



The KipTronicEVO2 has two separate lowering controls: fast low and slow low. The fast lowering control lowers the tipper at top speed, opening the oil passage completely from the cylinder to the drain. The slow lowering control causes descent at slower speed by opening the passage only partially for the oil from the cylinder to the drain: slow descent speed varies depending on the weight of the tipper (tipper with aluminum doors descent more slowly than platforms in steel), depending on the size of the hydraulic system (single front cylinder systems descent more rapidly than those with double cylinder..., systems with tipping valves with high capacity such as 150-200 l/min, can partialize better than valves with lower capacity,

such as 80 l/min); also, slow descent speed is affected by the air line pressure of the vehicle (because the partialization of the opening is achieved by controlling the opening times of the descent control solenoids and not the pressure in the pneumatic cylinder of the tipping valve).

IMPORTANT: The operator is responsible for ascertaining that the testing operations do not cause risks for any persons or property in the area operations. In compliance with the regulations in force, the rapid and slow lowering controls, like all the controls that move the tipper, are configured as “deadman controls”: movement starts when the operator presses the key and continues only as long as the key is pressed and only stops when it is released.

IMPORTANT: It is essential to verify that the descent movement stops immediately upon releasing the key.

If not the system should be checked to find the cause of the malfunction (for example, error in electrical or pneumatic connections): if the problem persists contact OMFB for further instructions.

IMPORTANT: It is also important to test the emergency function: with the low control in use (the tipper is lowering), the turning off the ignition key of the vehicle must stop the descent. If not, make sure the power supply of the KipTronicEVO2 system is correctly taken from the locked system as required. If not, there is no emergency stop control.

3.6 Control of tractor/crane selector

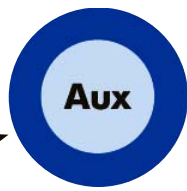

When it is prearranged in the hydraulic and pneumatic system, the tractor/crane selector is controlled by pressing and releasing the AUX key.

The confirmation of "Switch command sent" is given by the green LED marked Trailer, which lights up on the control panel. Pressing and releasing the AUX button with the green LED "off" send the switch command to the control and energizes the specific solenoid in the Box so that air pressure is sent to the selector: with the increase in the pressure of the air line the switch changes position and changes the direction of the oil from the main channel to the secondary channel. Pressing and releasing the AUX key with the green led "on" cancels the switch command, de-energizes the solenoid in the Box and stop air pressure to the switch.

3.7 Tipper's manual movement controls

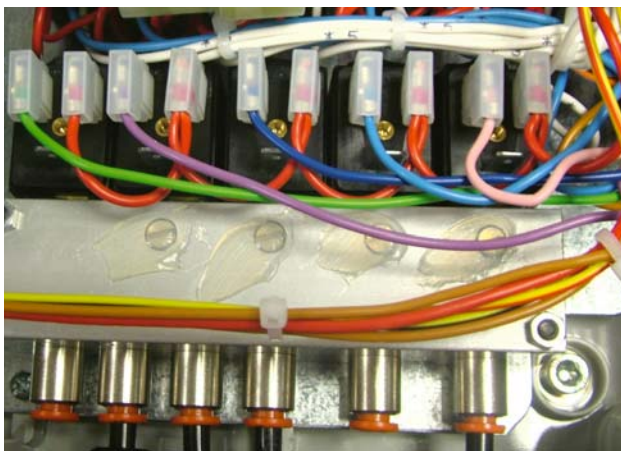

The KipTronicEVO2 system is also equipped with manual controls for the following actions: PTO engagement (if this is controlled by the KipTronic EVO2), tip control, low control and Auxiliary control (tractor/trailer selector or other).

The use of the tipper's manual movement controls is restricted to skilled operators: the installer is responsible for training the end user in their use. The operator is responsible for checking that these controls are not used accidentally by extraneous persons. The use of

the manual controls for movement of the tipper should be limited to emergency situations when the electronic control system is out of order: they enable the operator to complete maneuvers in progress (tip and empty the tipper, lower the tipper after raising it). To ensure the necessary safety, in case of any malfunction the operator should use the manual controls to restore safe conditions for travelling on the road and should then have the vehicle checked by specialized personnel.

To use these controls it is necessary to open the cover on the Box, identify the solenoid panel and turn the knobs on the panel to energize them manually.

Every solenoid can be turned to the limit to enable or disable the output connected to it.

Data: Mercoledì 13 ottobre 2010

Codice foglio: 997-010-12156 Rev: AE

IMPORTANT: All manual controls are active only when held. When enabled, they must be disabled by the operator otherwise the function remains enabled

The installer is responsible for installing the Box in a position where it can be easily and safely used by the operator. The installer is also responsible for instructing the user adequately on the use of these controls. The manual controls for moving the tipper only apply air pressure to the outputs (PTO engagement, tip/low tipping valve, tractor/trailer selector): the manual controls serve only in case of malfunctions of the KipTronicEVO2 control system and do not permit movement when the problem is relative to the outputs (for example, it will not be possible to move the tipper with the manual controls if the tipping valve stem is blocked...).

Special functions

“NOTE: The functions indicated and described here are implemented only on the codes indicated alongside each.”

3.8 Setting the speed of slow lowering (121.053.02008)

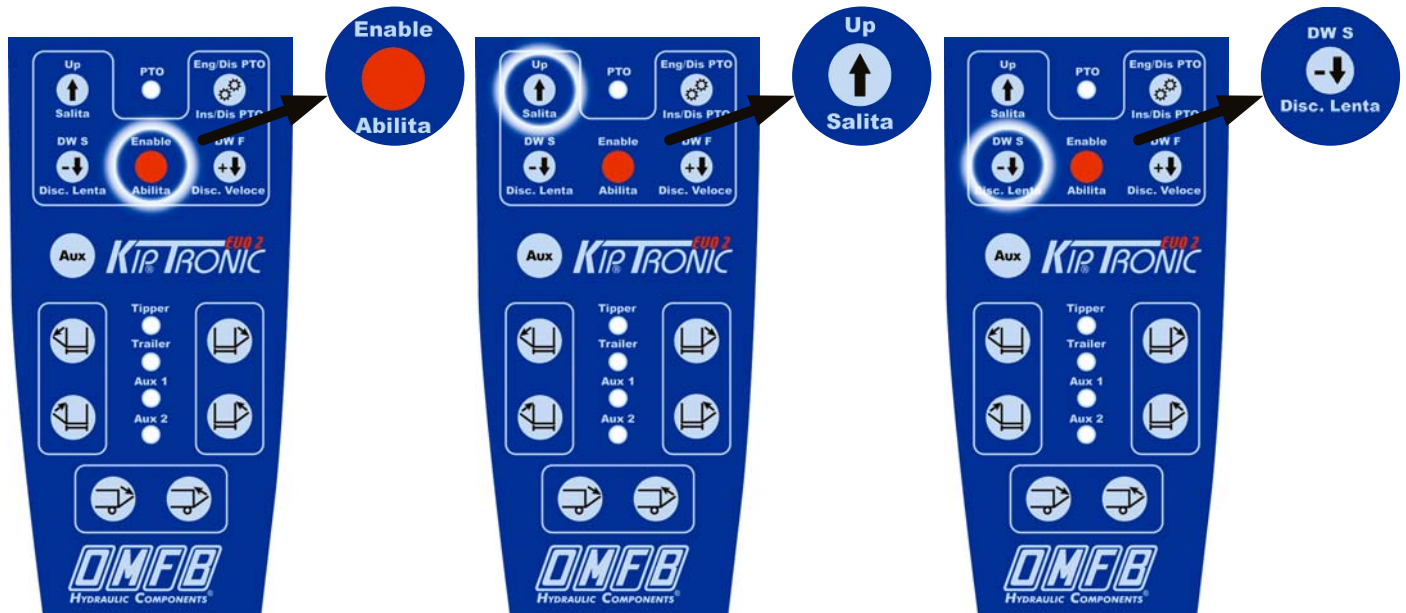

The KipTronic EVO 2 system can be configured in part by the installer.

“In particular, as the lowering speed of the tipper depends on the construction features of the truck and hydraulic system, the speed of slow lowering is generally calibrated at a moderate speed which can be set by the installer. Small tipper’s or lightweight materials, or low capacity valves may require an increase in the settings with respect to the standard, while heavy tipper’s with high capacity valves require a reduction of the settings. To make these settings, it is necessary to access the firmware settings as described below”.

To access the firmware configuration mode press the red ENABLE key with the KipTronic off, and hold it pressed while switching on.

Configuration mode is signaled by the 3 leds lighting up: the red PTO led, the yellow tipper led and the green trailer led.

To increase by 1 unit the number of impulses of slow low, press the tip key: the led AUX1 will blink twice. To decrease by 1 unit the number of impulses of slow descent, press the slow low key: the LED AUX1 will immediately blink four times. To increase or decrease further the number of impulses press the tip or low key and wait every time for the LED AUX1 to blink 2 or 4 times. NOTE: the system is supplied with a medium number of impulses: 5; for very light tipper we recommend increasing by 2-3 to a total of 7-8 impulses and for very heavy tipper we recommend reducing by 1-2 to 3-4 impulses. After making the necessary settings to exit the configuration mode press the PTO key, and the 3 leds will go out, then all 5 leds will light up for 1 sec and the system is ready to operate

3.9 Block of rear door (121.053.02017)



The Intentional block of the rear door is possible with the fixed discharge of the distributor. This can only be enabled after the two following conditions have been satisfied:

- the tipper must be in the rest position, or the end of stroke must detect that the tipper is down
- the operator must hold the red Enable key pressed for at least 1 second.

When the rear door block is enabled, this is signaled to the operator by the two red LEDs AUX 1 and AUX 2 blinking.

The installer is responsible for explaining to the user that the vehicle can travel on the roads only when these LEDs are enabled and blinking

The operator can move the tipper only after releasing the rear door, by pressing the red key again for at least 1 sec.

When the operator stops the vehicle, the system memorizes the status in which the operator left the system with regard to the rear door block, so that when the vehicle is started again the system returns automatically to the off condition, or to the on condition if the block was left on, or disabled if it was left disabled.

3.10 Auxiliary side doors and tarpaulin system controls (121.053.02017)



The auxiliary controls must be enabled by the operator by pressing the AUX key: when enabled this is signaled to the operator by the green "TRAILER" LED lighting up. As long as the green "TRAILER" LED is on, the operator can control the two side doors and the tarpaulin system of the tipper.

The installer is responsible for explaining to the user that when the green "TRAILER" led is on, pressing any key relative to control of the side doors and movement of the tarpaulin will enable these functions.

The user is solely responsible for ascertaining that there are no persons or property in the area of movement of the sidewalls.

Opening at least one of the two side doors is signaled by the red LED marked AUX1.

3.11 Hydraulic unit remote switch (121.053.02017)

This unit is in function when the red LED marked AUX2 is on: when on, it means that the hydraulic motor is working.

The red LED marked AUX2 should light up only when the operator holds one of the side doors control keys pressed.



3.12 Firmware settings(121.053.02017)

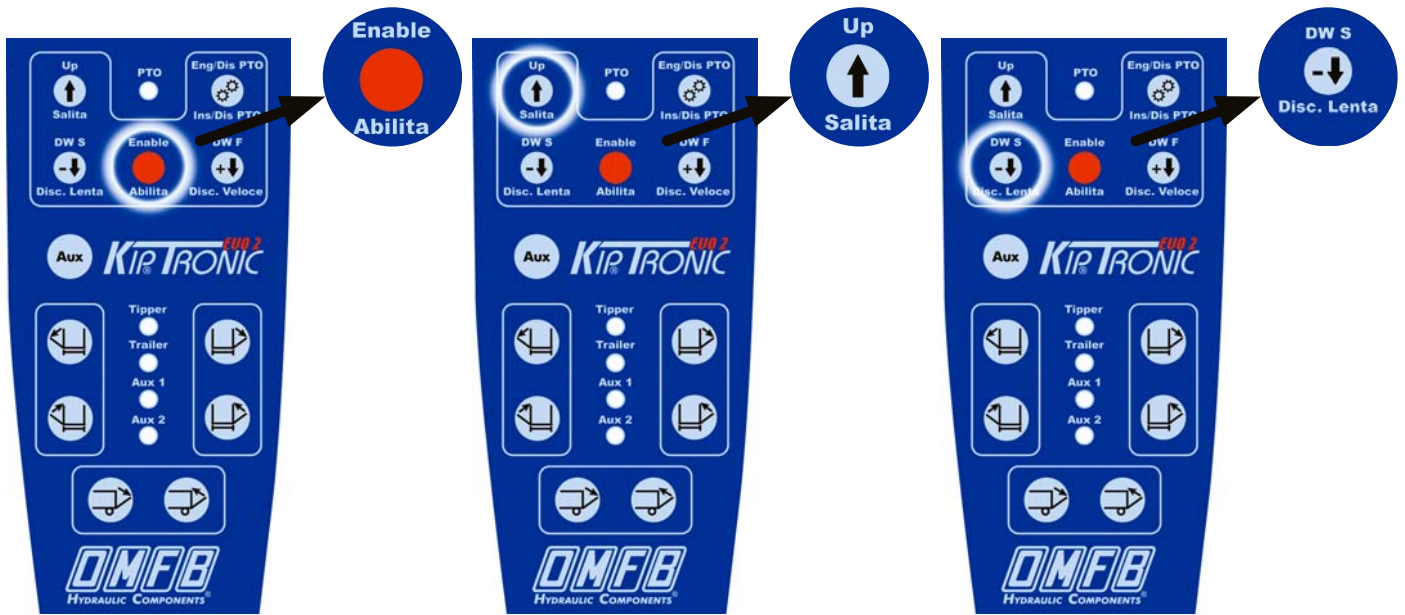

The KipTronic EVO 2 system is partly configurable by the installer.

Configuration mode is signaled by the 3 leds lighting up: the red PTO led, the yellow tipper led and the green trailer led. When in "configuration mode", press the tip control so that the LED AUX1 blinks twice to indicate that use of the keys for control of the rear door has been enabled to control the rear bike safety device while pressing the slow descent key will be followed by the red AUX1 key blinking 4 times to indicate control of the tarpaulin system. After making the necessary settings, exit the configuration mode by pressing the PTO key. At this point the 3 leds will go off, and all 5 leds will light up for 1 sec and the system is ready to operate.

In the configuration for control of the rear bike safety door, the two keys serve to raise and lower the part, controlling in ON/OFF mode (one key for "on" and the other for "off") one of the two wires of the roof control cable.

For the regulation of slow lowering speed, once entered in the programming, to increase of 1 unit the number of slow lowering impulses, press the slow lowering button: the LED AUX1 will flash twice.

Proceed in this way, to increase the number of impulses from 1 until a maximum of 10. Once reached the number of 10, a further pression of slow lowering button, will make the impulse count start again from 1 on.

4. TECHNICAL FEATURES OF PRODUCT

This section analyzes the main technical features of the product with particular reference to the pneumatic and electric diagrams.

4.1 Pneumatic diagram

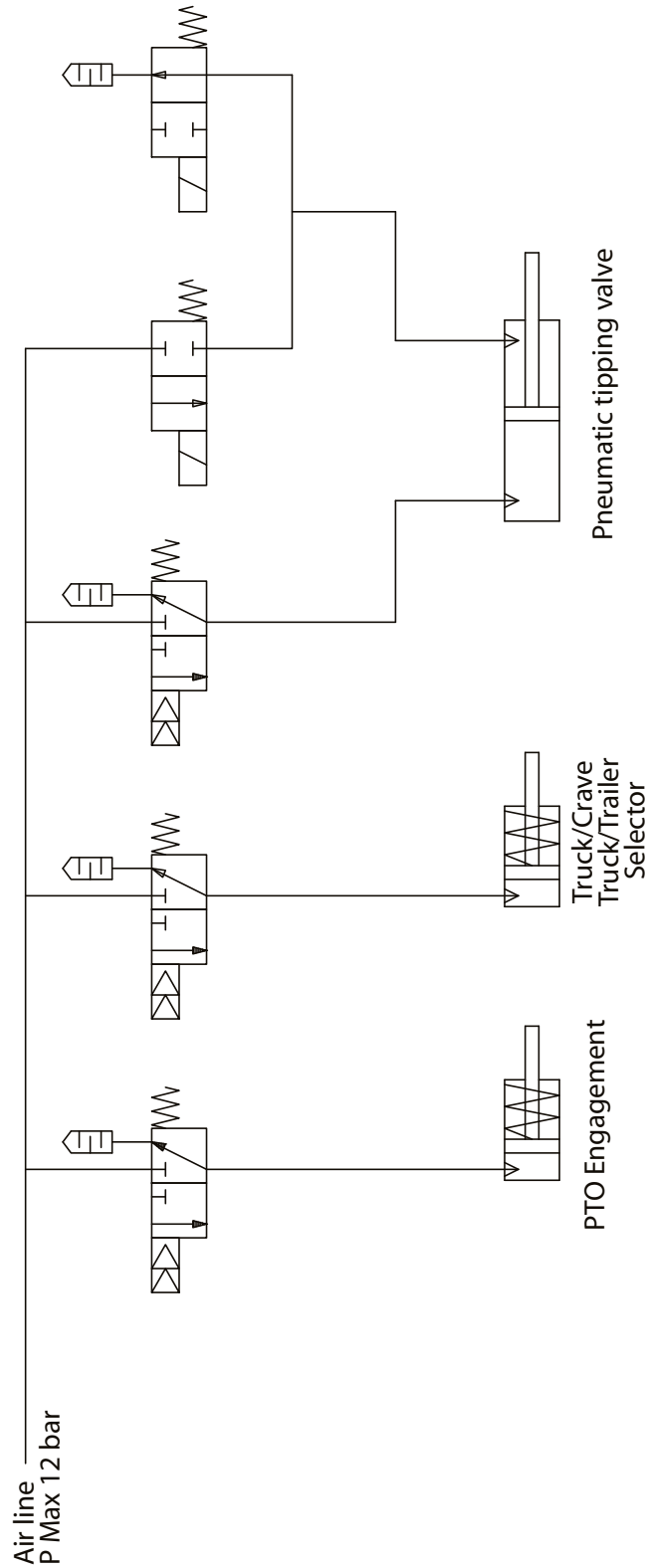

Data: Mercoledì 13 ottobre 2010

Codice foglio: 997-010-12156 Rev: AE

4.2 Wiring diagram

121-053-02008/02044

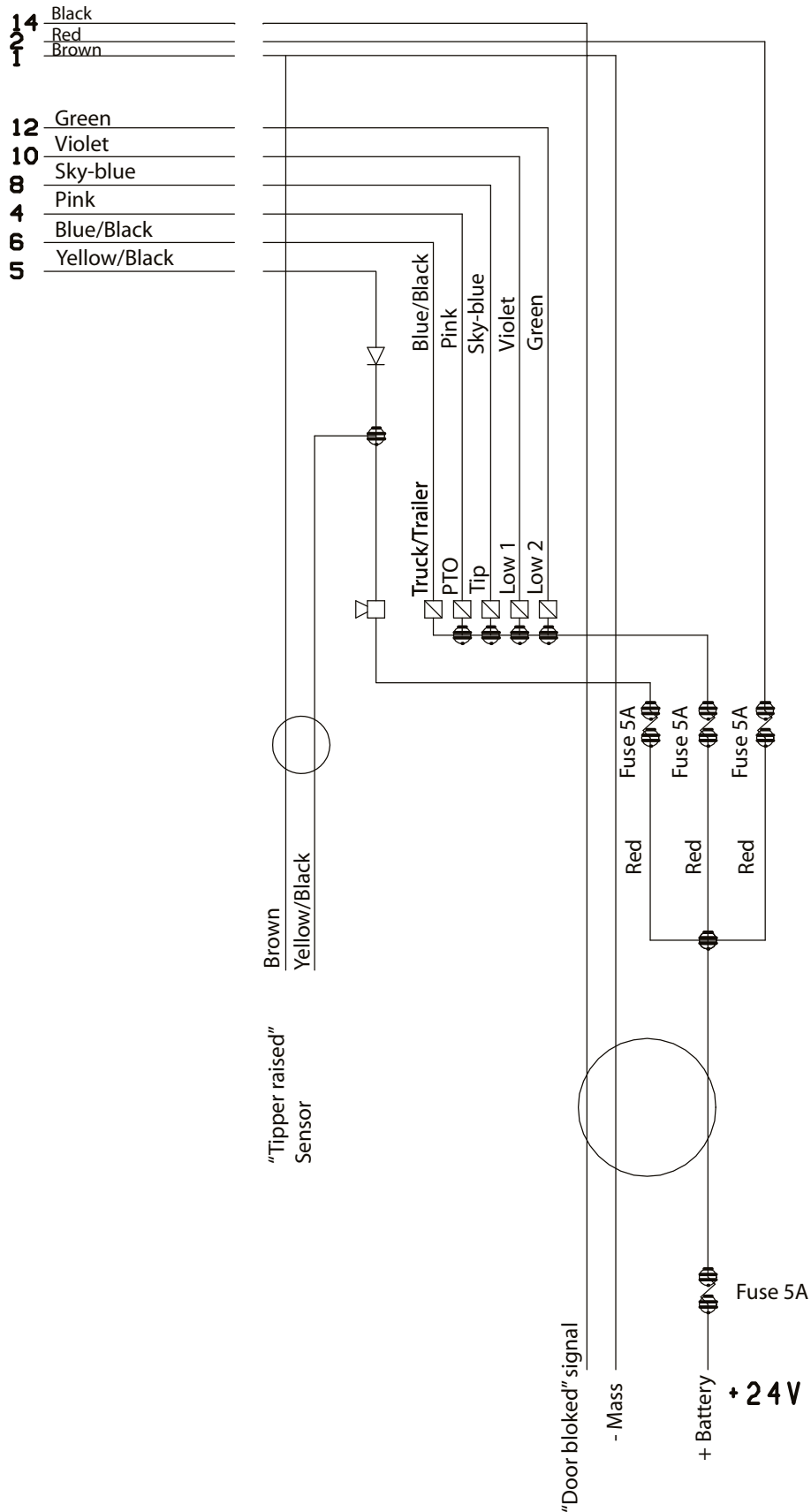

Data: Mercoledì 13 ottobre 2010

Codice foglio: 997-010-12156 Rev: AE

121-053-02017

