



Advance Units



Blue Streak Sifton "Tuneable" Ignition Advance Assembly includes stainless advance base, points plate with "Blue Streak" points and condenser with hardware and 3 pairs of color coated springs which allow full advance at 1400, 2000 and 2600 RPM depending on which spring is selected.

VT No. 32-0713



Competition Advance Unit by Rivera Competition features machined stainless steel shaft and plate, metallic coated weights and special wound springs for exact advance. Replaces 32505-78A for 1970-up, mechanical advance applications. Center screw included.

VT No.	Item
32-9037	Competition Unit
32-9223	Rebuild



32-9220



32-9261

Tuneable Advance Unit features stainless base, heat treated weights cam bolt and 3 different color coded spring sets which allows full advance at 1400, 2000, and 2600 RPM depending on which springs are selected. Can be used with all ignitions, points, single or dual fire types which utilize an advance unit. Springs also available separately.

VT No.	Type
32-9220	Stock
32-9261	Needle Bearing
13-0121	Stock Springs, Black
13-9246	Heavy
13-9247	Severe

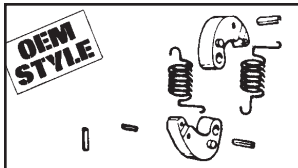

Automatic Advance Rebuild Kit includes 2 of the following: springs, weights, and 4 roll pins. For all 1970-78 Twins.

VT No. 32-0140



32-0140

Warranty

All Electrical Components sold as individual pieces or in kits are covered under our warranty "Replacement Only" Provision. All electrical related item part numbers begin with a 32 prefix. No credit will be issued for these items as they are exchange only.



32-7773

Points Conversion Kit. Both brands include everything necessary for direct replacement on 1970-78 BT, 1971-78 Sportsters or for converting late model electronic-type back to points. Accel type available with microchip points, which will require a domed shaped points cover such as VT No. 42-0299 to accommodate taller points. The V-Twin unit includes stock style points and condenser. 32-0150 available with stock needle bearing weights.

VT No.	Item	Type
32-7773	Accel with Microchip	Stock
32-0136	V-Twin with Points	Stock
32-0150	V-Twin/Points	Needle



Points Plate Screws replace 32606-82.

VT No.	Type
32-0760	Stainless
32-0049	Zinc



Stainless Advance Unit features stainless base, heat treated weights and cam center screw for 1970-up mechanical advance ignition.

VT No.	Item	Brand
32-0178	W/Bolt	Sifton
32-0168	W/O Bolt	V-Twin



32-7510

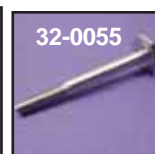

32-0055

Advance Units feature heat treated weights and steelbase. Order center bolt separately.

VT No.	Type
32-7510	Advance
32-0055	Center bolt



32-0156



32-0157

Blue Streak Premium Parts for 1970-78 Twins.

VT No.	Item
32-0156	Points
32-0157	Condenser

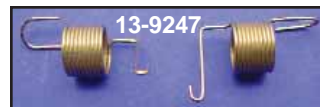

13-9247

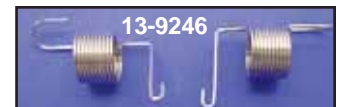

13-9246

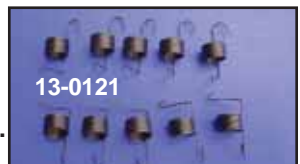

13-0121

1970-up Advance Weight Springs.

VT No.	Fits
13-9247	Severe Duty Advance Weight Springs for all Hi-compression and heavily modified engines. Also useful for applications experiencing detonation (pinging) or very erratic idle, pair
13-9246	Heavy Advance Weight Springs for slightly modified stock, low compression or mild stroker application, helps cure minor idle problems, pr
13-0121	Original type replacement. Uses premium grade spring steel, 10 pk



Daytona Twin Tech Ignitions

BIG TWIN

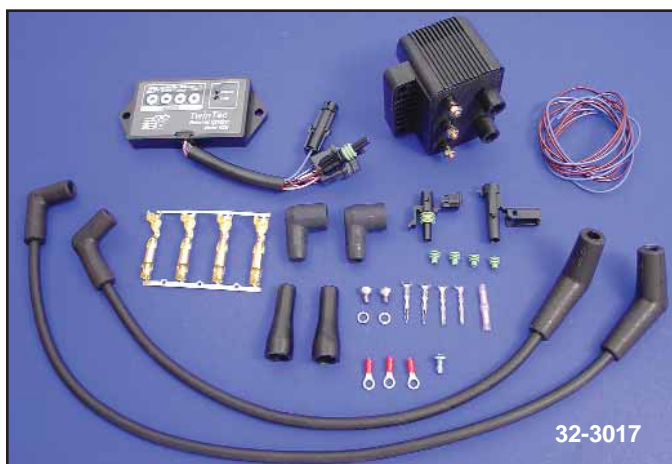

32-3017

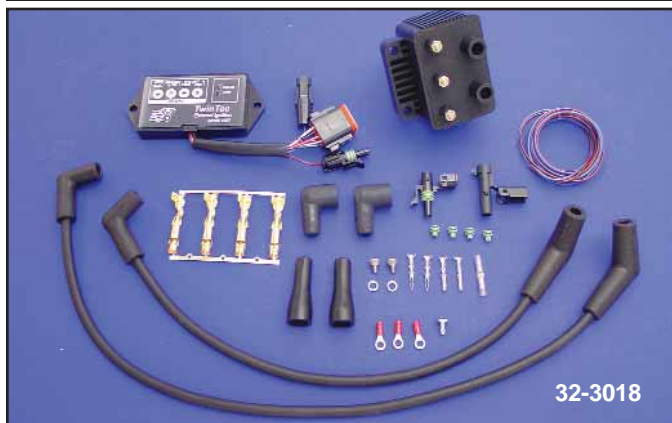

32-3018

Daytona Twin Tec External Ignition Kits for 1990-98 Evo Big Twin and 1990-97 Sportster models. Kit include module, coil and spark plug wire set.

VT No.	Fits
32-3017	1990-94 Evo
32-3018	1995-98 Evo

Twin Tec Internal Ignition for 1970-99 Models. Two advance curve families with adjustable advance slope accommodate stock to highly modified engines. Digitally set RPM Limit (100 RPM Steps). Selectable single or dual fire mode. Coil outputs protected against short circuits. Optional PC link cable and software for programming custom advance curve.



VT No.	Item
32-1005	Ignition
32-2005	3 Ohm Coil Single Fire

Compu-Fire Ignition Systems HD Models: Include the only true single and dual fire systems for dual plug operation. Built in Accu-Ray timing light simplifies initial installation. Tach output works with either single or dual fire systems. RPM Limiter eliminated. Correct dwell times, coils run cooler, maintain maximum output. Battery current reduced. No external ignition module, electronics mounts entirely inside ignition housing.



VT No.	Item
32-1040	Single fire/dual plug, uses 2 coil packs
32-7510	Mechanical advance unit

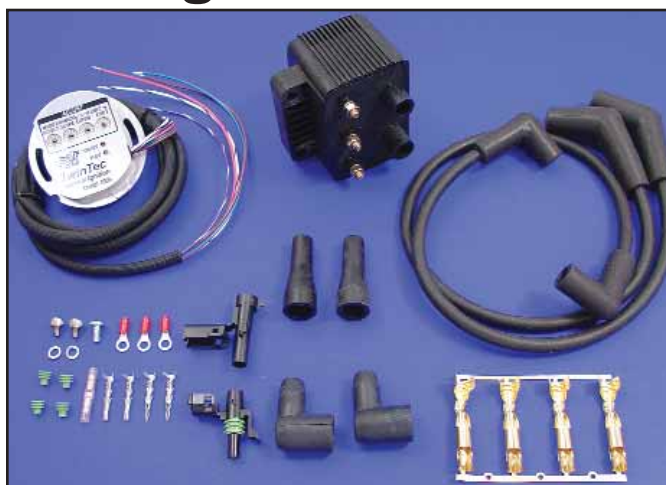

Daytona Twin Tec Internal Ignition Kit for 1984-99 Evo Big Twin, 1970-84 Shovelhead Big Twin and 1971-97 Sportster models. Kit includes ignition, coil and spark plug wire set.
VT No. 32-3015



Daytona Twin Tec TC-88 Ignition Kits for all 1999-up TC-88 Carbureted Big Twins includes module, coil and spark plug wire set.
VT No. Fits
32-3088 1999-02
32-3089 2003-up



Mallory Unilite Breakerless Ignition System for 1970-99 all Twins. Dual fire unilite module features integrated photo coupler, signal processor and power switch. Requires mechanical advance assembly and ignition coil with 3.0 to 4.0 ohms.

VT No.	Item
32-5119	Ignition System
32-7510	Mechanical Advance



45 KV Single Fire Coil Kit includes coil and cover to fit 1984-99 ST models.
VT No. 32-0749



Ignition Kits and Advance Units



32-0469



32-0468

V-Tech™ Ignition Kits are available in **dual fire** where there are 2 sparks at the same time and **single fire** where there is one spark for each cylinder when it is fired. Each kit includes a mechanical advance unit and all hardware. Order coil separately 32-0467 coil has 2 separate coils inside to fire independently.

VT No.	Item	Type	Coil
32-0468	Kit	Dual Fire	32-0511
32-0469	Kit	Single Fire	32-0467



37-9015

Ignition Wire Chrome Clamps.

VT No.	Type
37-9014	Points
37-9015	Electronic



37-9132

Ignition Sensor Wire Clamps for all 1987-up Big Twins.

VT No.	Fits	OEM
37-9132	1987-92	38713-87A
37-9349	1993-96	38711-93
37-9350	1997-99	38713-97



32-0467



32-0474

V-Tech™ Single Fire Coil gives 1 spark for each cylinder as fired and will mount to stock bracket and accept stock coil cover.

VT No.	Finish
32-0467	Black
32-0474	Chrome



32-5119



Mallory Unilite Breakerless Ignition System for 1970-99 all Twins. Dual fire unilite module features integrated photo coupler, signal processor and power switch. Requires mechanical advance assembly and ignition coil with 3.0 to 4.0 ohms.

VT No.	Item
32-5119	Ignition System
32-7510	Mechanical Advance



32-9020

Ignition Sensor Plate Assembly.

VT No.	OEM	Fits
32-9020	32400-80A	1980-93 FLT, 1980-94 FXR 1984-95 FXST
32-0518	32404-90	1991-95 Dyna
32-0519	32400-94	1994-95 FLT
32-0520	32404-96	1996-98 Dyna
32-0521	32448-95A	1996-98 FLT 1996-99 FXST

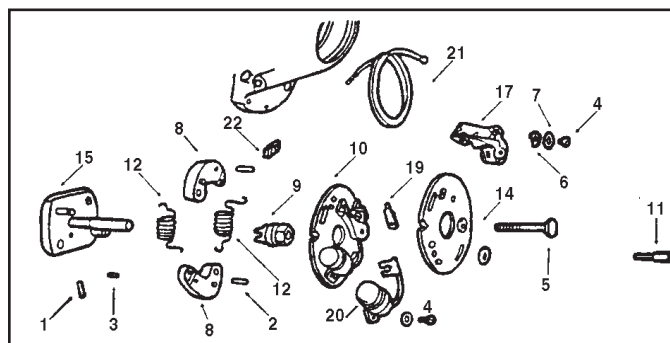

Advance Unit Rebuild Parts.

VT No.	OEM	#	Item
32-7510	32505-78A		Rotor and Weight Assembly
12-1163	615	1	Roll Pin Breaker Plate
12-1164	620	2	Roll Pin Breaker Weight
12-1162	623	3	Roll Pin, Breaker Plate
12-1152	8699		Pop Rivet for Cover
37-8809	1047,7115 6189W	4	Point Mount Plate Washer and Screw Assortment
32-0055	3570	5	Timing Screw
32-0138	32522-70	8	Weight Set
32-0053	32542-70A	9	Cam only
32-0549	32577-70	10	Breaker Base Assembly
32-0051	32601-78	11	Plate Mount Stud 1970-81
32-0049	32606-82	11	Plate Mount Stud 1982-up
32-0054	As Above	11	Oversize with 12/24 threads for Stripped out Covers
13-0121	32605-70	12	Springs
32-0042	32618-70A	14	Mount Plate only
32-0041	32629-70	15	Shaft and Plate only
32-0118	32661-70	17	Point Set
32-0411	32670-70	19	Terminal Kit
32-0121	32726-30A	20	Condenser and Bracket
32-1557	70456-73	21	Point Lead Wire
37-8971	10046	22	Point Lead Wire Clamp



Accel Single/Dual Fire Ignition Module. Fits all carbureted 1970-2000(except TC-88) and all 1971-up Sportster models, works in both single or dual fire applications and features 14 tuneable advance curves from stock to full performance, adjustable rev limiter, VOES input,

tachometer output and front cylinder static time LED. Requires sensor cup for installation.

VT No.	Item
32-0091	Accel S/D Fire Ignition Module
32-9087	Sensor Cup



32-8075



32-7510

32-9255

32-9292

32-9291

Crane Cams Hi-Intensity Ignition System converts early, points type 1970-79 BT to electronic ignition. On 1980 and later models it will replace stock electronic ignition, external module and rev limiter. Kit includes Hi module stand off screws and hardware. Order VT No. 32-7510 advance weight unit separately.

VT No.	Item
32-8075	Single module/dual fire/single coil for a dual fire ignition system that replaces the stock point and condenser type ignition. Can be used with stock coil.
32-9291	Rotor for Above
32-8076	Dual module/Single Fire/ Single or Dual Coil when being used as single fire/single plug requires VT No. 32-9224 coil. When used as dual plug applications VT No. 32-9225 coil must be used.
32-9292	Rotor for above
32-7510	Advance Unit
32-9255	Tach Adapter for Above

Ignition



CRANE Cams

Crane Hi-4 fits all 1970-98 carbureted models and requires sensor cup for 1982 and earlier applications. Order tach interface, sensor cup and screw separately if required. **Note:** Order Coils Listed Below

VT No.	Crane#	Fits
32-9217	8-1100	Dual Fire Ignition fits Evo, Shovel and Sportster through 1997. It can be set for Street or Race-Electric start or Kick Start includes 4000 to 8000 adjustable RPM limiter. Includes adjustment for rate of advance. This unit is compatible with stock dual fire coils
32-9218	8-2100	Single Fire Ignition fits Evo, Shovel and Sportster through 1997. It can be set for Street or Race-Electric or Kick Start includes rear cylinder timing adjustment for rate of advance. Compatible with single fire coils.
32-4100	8-4100	Single Fire Ignition Kit fits As Above Includes coil and 8.5mm wires.
32-0588		8.5 mm Wire Set
32-9255		Tach Adapter Interface
32-0559		Sensor Cup and Screw Set
32-9087		Sensor Cup, replaces 32402-83
32-9052		Cup Screw, replaces 2611C

Note: When using HI-4 Single Fire Ignition with "Dual Plug Cylinder Heads", two dual fire coils must be used (Crane Cams #8-3002 or 8-3006). Both the spark plug wires from one coil will go to the front cylinder, while both plug wire from the other coil will go to the rear cylinder.

Single Fire: Just the spark plug for the piston that is in its compression stroke will be fired. The other piston, being in its overlap position will not be ignited.

Dual Fire: Both spark plugs are fired simultaneously at the time only one piston is in its compression stroke.

This is the way the stock motor works.

Single Plug: One spark plug in each head. Total of 2 spark plugs in one engine.

Dual Plug: Two spark plugs in each head. Total of 4 spark plugs in one engine.

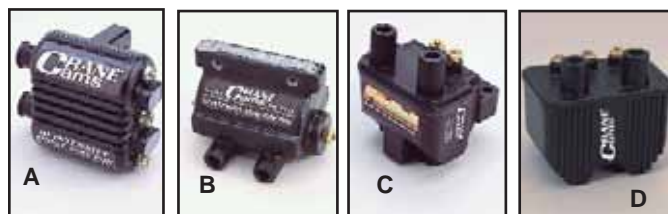

Crane Coils are available in high intensity for single or dual fire, mounts to stock brackets.

VT No.	Crane No.	#	Type
32-9224	8-3001	A	Single Fire
32-9241	8-3005	D	Single Fire
32-9225	8-3002	B	Dual Fire
32-3006	8-3006	C	Dual Fire



Ignition

CRANE Cams



32-0806



32-4102

Crane HI-4E Ignition Modules/Module-Coil Kits.

- Improved, Adjustable Spark Curve Produces Strong Torque/Power Increases!
- Multi-Spark Technology Delivers Cleaner Low-End, Idling, Crisper Throttle Response.
- Easy Plug-In Installation. No Harness Replacement required on 1991-up Bikes. (1980-94 requires VT No. 32-9014 (OEM 32408-90) Harness Kit)
- Selectable Single-Fire or Dual Fire.
- Adjustable Rev-Limit, 500 to 9,900 RPM in 100 RPM increments!
- Accurate, Easy Rear Cylinder Timing Offset.
- Billet Aluminum, External Mounted.
- Kits include module, coil and spark plug wires.

VT No.	Item	Description
32-0806	Module only	1980-94 with 7 Pin connector.
Note: 1980-90 requires harness kit VT No. 32-9014		
32-4101	Kit	As Above
32-0807	Module only	1995-up with 8 Pin Connector
32-4102	Kit	As Above



32-0733



32-0741



32-0672



32-0673



Crane HI-4TC Ignition for TC88 Carbureted Engine Models

offers multi-spark performance, variable advance curves and a digital rev limiter. It is a plug in replacement of the stock module and is compatible with the factory security system. A crankshaft position sensor is employed to establish accurate firing. Rear

cylinder timing can be offset from -5° to +4°; the same for initial timing. Both are easily adjusted by means of rotary switch on the unit. An additional rotary switch is used to select the advance curve, with choice of ten families. This enables the ignition to optimize the performance potential of the Twin-Cam 88® in any stage, from stock to wildly modified. Rotary switches also control the built-in Sequential Rev Limiter, which is adjustable from 1,500 to 9,900 RPM, and won't cause "popping and banging" like conventional rev limiters.

Benefits of multiple spark system include easier starting (hot or cold), better low-speed driveability and off-idle response. It pulses up to nine sparks per cycle at idle and three sparks up to 6,000 RPM, which also stops spark plug fouling and lean-surge.

VT No.	Year
32-3160	1999-03
32-3180	2004-up



Sensor Cup Kit includes special screws to fit all "Sensor" type ignition kits.

VT No. 32-0559



Controller by Comp Cams is a programmable performance ignition computer featuring:

- High Energy output with accurate spark timing.
- Uses stock rotor and pickup in both single and dual fire operation.
- 14 factory programmed curves
- User friendly programming with switches.
- RPM switch for nitrous 2-stage rev limiter.
- Programmable rev limit.
- Bolt-on easy installation with style connectors.

Controller by Comp Cams				
VT No.	V-Thunder	Description	Year	Model
32-0672	VTI2000A	Ignition Controller	1995-earlier 1993-earlier	Softail, Dyna, FXR, FX w/ conv. Harness XL except 1994-up FLT & XL models
32-0673	VTI2000B	Ignition Controller	1996-up 1993-up	Softail, Dyna, FXR, FX w/ conv. Harness Softail, Dyna, FLT except F.I., XL
32-0733*	VTI2001A	Power Adapter 7-pin Connector	Fits all 32-0672 applications	
32-0734	VTI2001B	Power Adapter 8-pin Connector	Fits all 32-0673 applications	
32-0741	VTE2200	RPM Switch Harness	For use with VTI2000 A or B	

*Note: For 1979 and earlier models use pickup VT No. 32-9020 OEM 32400-80A and rotor VT No. 32-9087 OEM 32402-83. For 1991 and earlier models use OE harness VT No. 32-9014 OEM 32408-90.



32-8204

TC-88 Performance Ignition Systems for Carbureted only. Available with 6200 RPM limit for engines with slight modifications and stock compression

or 7000 RPM limit for engines with raised compression, Big Bore Cylinder & Performance Cams installed.

6200 RPM

VT No.	OEM	Models	Years
32-8204	31710-01	Dyna	1999-up
		FXST	2000-up
32-8205	32721-01	FLT	1999-2001

7000 RPM

32-8206	31713-01	Dyna	1999-up
32-8207	32724-01	FLT	1999-01

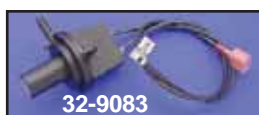

32-9083

Vacuum Switch Assembly

VT No.	OEM	Fits
32-9079	26557-83	1984-90 All FXR
32-9080	26558-84	1984-90 FXST 1986-89 All FLT
32-9082	26555-91	1991-93 All FLT
32-9083	26566-91	1991-95 All FXST-FLST, Dyna & FXR
32-9084	26555-94	1994-98 All FLT
32-9156	26566-96	1996-99 FXST-FLST
32-9157	26569-96	1996-98 Dyna



32-0085



32-0086

Ignition Module Adapters allow use of seven pin module (1991-93) going to eight-pin Deutsch (1994-99) wiring harness or an eight pin module going to a seven pin harness. Can not be used on EFI models.

VT No. Fits

32-0085	7 Pin Adapter to 8 Pin Module
32-0086	8 Pin Adapter to 7 Pin Module



Replacement Ignition Modules bolt-on replacements. Harness 32-9014 required as noted.

VT No.	OEM	Fits
32-9016	32405-91A	1984-95 Evo BT, except 94-95 FLT
32-9322	32426-94	1994-95 FLT
32-9321	32449-95A	1996-99 All BT
32-0527	32568-00A	2000-up FXST
32-0528	32478-99A	2000-up FXD, FLT
32-9014	32408-90A	Harness for installing the above modules

Performance Ignition Modules. 6000 RPM.

VT No.	OEM	Fits	Note
32-9325	32596-96	1984-95 BT	1-2
32-9326	32630-96	1996-99 Evo BT	1

Note 1: Cannot be used on EFI models.

Note 2: Use 32-9014 harness to install ignition module on all pre-90 models.

Ignition Modules



32-1014

Twin Tec External Ignition for 1999-up Carbureted Twin Cam Models. Wide timing advance adjustment range accommodates stock to highly modified engines. Digitally set RPM Limit (100 RPM Steps). Selectable multi-spark mode for quick starting & smooth cruise. Coil outputs

protected against short circuits. Billet aluminum housing with black anodized finish. Easy plug-in installation supports all sensors including theft/security module.

VT No. Years

32-1008	1999-02
32-1014	2003-up

Twin Tec External Plug In Ignition for 1990-99 Evolution Big Twins

features 4 rotary switches used to set the operating modes such as single or dual fire, adjust the timing, advance and select RPM limit. Two diagnostic LED's indicate status and start of the VOES switch. The status led is also used for static timing as it will flash when the engine reaches top dead center.

VT No. Item

32-1006	1990-94 with 7 pin Connector
32-1007	1995-99 with 8 pin Connector



S&S Spark Technology Ignition System features an ECU module that will automatically adjust ignition timing. When detonation is detected by knock sensor, the ECU retards the ignition timing to prevent engine damage. When detonation is not present, ignition timing is advanced for maximum power and economy. Additional features include: Simple installation--plugs into stock harness, No timing adjustments, 7000 RPM rev limiter, single fire operation, automatic dwell adjust, short circuit and reverse polarity protected.

VT No. Fits

32-1013	Module
---------	--------

Installation Kit

32-7805	2004-2006 carbureted TC-88 models
32-1012	1999-2003 carbureted TC-88 models
32-1049	1995-99 carbureted Big Twins



Chrome Accel Rev Master is pre-set by the rider to a specific R.P.M. Limit. When engine speed reaches limit, the Rev Master interrupts coil triggering, preventing engine damage due to over-revving. Measures 4 3/4 x 2 1/2.

Includes instructions. Fits all 1948-99 Big Twin.

VT No. 32-0152



Ignition



32-9500



32-9501

V-Tech Ignition Systems fit all 1970-98 carbureted models and requires sensor cup for 1982 and earlier applications. Order tach interface, sensor cup and screw separately if required. **Note: Order Coils As Required.**

VT No. Fits

- 32-9501** Dual Fire Ignition fits Evo, Shovel and Sportster through 1997. It can be set for Street or Race-Electric start or Kick Start includes 4000 to 8000 adjustable RPM limiter. Includes adjustment for rate of advance. This unit is compatible with stock dual fire coils.
- 32-9500** Single Fire Ignition fits Evo, Shovel & Sportster through 1997. It can be set for Street or Race-Electric or Kick Start includes rear cylinder timing adjustment for rate of advance. Compatible with single fire coils.
- 32-9503** Single Fire Ignition Kit fits As Above Includes coil and 8.5mm wires.
- 32-0588** 8.5mm Wire Set
- 32-9255** Tach Adapter Interface
- 32-0559** Sensor Cup and Screw Set



Sensor Cup and Screw Kit fits 1982-up models with stock or performance electronic ignition systems.

VT No. 32-0559



32-9285

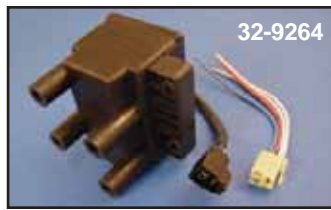

32-9264

Dyna	Application
DC6-5	All FXR-FXST and Dyna models
DC6-4	Dual Spark Plug Head Application



Dyna Twin Fire Ignition Coils are designed to work with Dyna 2000 HD-I ignition modules. Twin fire coils are slightly larger than stock coils, fit the stock mounting bracket. Twin fire coils can be used with any electric advance ignition system that incorporates dwell control except Dyna DS6-2 or similar type ignitions.

VT No. Dyna Ohms/Type

- 32-9285** DC6-5 3 (A) Twin Fire II Miniature Dual Output Towers, Replaces DC6-3
- 32-9264** DC6-4 3 (B) Four output towers Fits Dual Spark Plug



Dyna 2000 Digital Ignition Systems. Systems include Dyna 2000 HD-1 Ignition Module and a matched Dyna Twin Fire Coil for each application.

VT No.	#	Fits
32-0802	SFK-3	1995-up FXR, FLT, FXST, FXD
32-0804	SFK-1	Pre1995 FXR-FLT, FXST, FXD
32-9118		Programming Software for 32-0802
32-9117		Programming Software for 32-0804



32-9308

A



32-9050

B



32-9085

C

Dyna 2000 Ignition Modules Replacement can used with stock electronic ignition.

Note: The stock ignition consist of a sensor plate and rotating cup. The 2000 will work on all 1970-up models but requires the 1983-up type ignition cup and sensor plate. The 2000 Advance curves will not work properly if installed with the pre1983 ignition cup and sensor.

Dyna 2000 HD-1 can be used with both single fire (separate coils) or Dual fire (Single Coil) the Dyna 2000 HD-2 can be used as dual fire only. **Both units** feature programmable advance curves, rev limiter and L.E.D. diagnostic lamp for easy static timing, plugs into stock harness and bolts to stock module location. Also available with USB port that will allow mechanics or tuners move advanced programming but requires separate purchase of Dyna Programming kit.

Note: Can only be used with suppression spark plug wires. On 1984-90 models Dyna extension harness must also be used.

VT No.	#	Item/Plug	Years
32-9112	A	Dyna 2000 HD-1E 7 Pin With USB Port	1984-95
32-9049	A	Dyna 2000 HD-2E 7 Pin	1984-95
32-9113		As Above with USB Port	
32-9318	A	Dyna 2000 HD-1E8 8 Pin	1996-99
32-9114		As Above with USB Port	
32-9317	A	Dyna 2000 HD-2E8 8 Pin	1996-99
32-9115		As Above with USB Port	
32-9116	A	Dyna 2000 TC-88-1, 1999-2000 TC88 & Carb As Above with USB Port	
32-9308	A	Dyna 2000 TC-88-3, 2004-06 TC88 Carbureted Only with USB Port	
32-9050	B	Extension Cable	
32-9085	C	7-8 Pin Conversion Harness	
32-0559		Ignition Cup Kit	
32-9087		Ignition Cup Only	
32-9020		Sensor Assembly	
32-9052		Cup Screw, 10 pk	
32-9117		Programming Software for 32-9112, 32-9113	
32-9118		Programming Software for 32-9114, 32-9115	
32-9119		Programming Software for 32-9116	



Dyna 'S' Hi-Performance Ignition System is self contained, fits behind ignition cover, uses magnetic rotor with the original spark advancer, so factory advance curve is maintained. Improves performance, extends spark plug

life, eliminates points and condensers.

Note: For dual plugged heads, on 1980-up use advance mechanism, VT No. 32-7510

VT No. 32-7778 (DS6-1)



Dyna 'S' Single Fire Ignition has the features of the Dyna 'S', but fires front and rear cylinders independently of each

other which allows accurate timing of each cylinder. Stock ignition systems fire both cylinders at the same time which has the wasted sparks on the exhaust stroke. This eliminates this inherent problem. For use with either dual or single plug heads. On 1980-up models, use VT No. 32-7510 Advance assembly.

VT No. 32-7777 (DS6-2)



Dyna 2000i Digital Ignition available as a module only or complete kits that include correct coil. Features include single or dual fire operation, 8 advance curves, built in tach driver, adjustable RPM limit from 6000 to 7500 and easy static timing with built in timing indicator. Fits all 1970-98 carbureted models and requires 1983-up sensor cup for 1982 and earlier applications. Advanced Programming Software allows the mechanic or tuner the ability to fine tune 2000i Ignition but requires adapter.

VT No.	Item	Plug	Fire	Coil
32-9151	Kit	Single	Single	DC3-1
32-9152	Kit	Dual	Single	DC1-1
32-9153	Kit	Dual	Dual	DC2-1
32-9155	Kit	Single	Single	DC6-5

Miniature coil

32-9159 Module Only

32-9087 Sensor Cup

32-9052 Cup Screw, 10 pk

32-9120 Advanced Programming Software for Above Ignitions

32-9121 Software Adapter Harness

DYNA Ignition



Dyna S Performance Ignition Systems. Available in dual or single fire for street applications only. Each kit includes sensor plate assembly and correct coil for each application. Single plug only. 1980-up applications require 32-7510 advance mechanism.

VT No. # Type

32-0800 DSK-6-2 Single Fire

32-0801 SDK-6-1 Dual Fire



Replacement Rotor for Dyna Ignitions.

VT No.	Fits
32-9300	DS-6-1
32-9301	DS-6-2



Dyna Coils. 35,000 volt! Works with all points ignitions, after-market or factory electronic ignitions. Note: 32-7792 is electronic, 32-7793 is for points ignition.

VT No.	#	Volt	Ohm	Dyna	Type	U/M
32-7789	A	12V	3	DC-1	Angle, Dual	Pair
32-7790	A	6V	1 1/2	DC-2	Angle, Dual	Pair
Use 2 for dual plug heads						
32-7792	C	12V	3	DC-6	Stock, Dual	Each
32-7793*	C	12V	5	DC-7	Stock, Dual	Each
32-8055	B	12V	3	DC-3	Angle, Single	Pair
32-8086	A	12V	5	DC-8	Angle, Dual	Pair
32-9035	B	12V	5	DC-10-1	Angle, Single	Pair

*Note: Use 2 for single fire ignition.



Dyna Ignition Booster for single points systems only transforms inconsistent electrical surges into controlled bursts of energy to the coil power is not wasted.

VT No. 32-7787



Dyna Electric Tach Adapter Kit must be used with Dyna 'S' single fire ignition is installed on any twins with dual plugs when electric tach is used.

VT No. 32-7799

K.V. Recommends the following coils for Dyna Ignitions:
DS6-1 Ignition VT No. 32-7778
 Street, Single plugs use DC-7 or DC-8
 Race, Single plugs use DC-1 or DC-6
 Street/Race Dual plugs use 2 DC-2 or DC-5, wired in series
DS6-2 Ignition VT No. 32-7777
 Race, Single plugs use 2 DC-3
 Street, Dual plugs use 2 DC-7 or DC-8
 Race, Dual plugs use 2 DC-1 or 2 DC-6
 Street, Single plug uses 2 DC10-1



Fuel Injected Systems



Twin Tec TCFI Fuel Injection Kit for 2001-up TC-88 with Delphi Fuel Injection System. Includes plug in fuel injection controller, PC link, interface cable, Wego wide band exhaust gas oxygen sensor and weld nut for exhaust pipe. The TCFI solves tuning problems with highly modified engines. Fully programmable plug in replacement for Delphi Controller. Allows programming of advance curves, idle air control including idle RPM and cold start characteristics. The TCFI communicates diagnostic information by blinking codes on the check engine LED. The unit also has a built in data logging that stores data for the last 15 minutes of operation. Fits all 2001-up.

***Note** Oxygen sensor must be installed in rear exhaust pipe.

VT No.	Item
32-1004	TCFI2D-Kit
32-1016	TCFI3D-Kit
32-1017*	TCFI3D-Kit

***Note:** Same features as 32-1016 with the addition of extended data logging and diagnostics.



Pro EFI Race Tuner. This software package will make tuning the EFI models a professional endeavor. It is divided into two mode:

- Data (Real Time)
- Tuning Changes

The kit includes

- CD Software
- User's Manual

Requirements for use are Windows 98, a CD-ROM, serial port, 32MB RAM, 10MB hard drive and a highly skilled technician. Replaces 32107-01H. Order cable to connect tuner to PC separately.

VT No.	Item
32-0380	Tuner
32-0382	Cable



Twin Tuner Fuel Injection Controller for 2008-up FLT models. Features include increased horsepower, improved throttle response, easy plug-in installation and setup, can be used with Dyno Jet Power Commander Maps and is compatible with Twin Scan II service tool VT No. 16-0378. The Twin Tuner allows you to easily adjust your fuel injection to match the requirements of performance parts. You can add or subtract fuel by using the mode and up/down push button switches.

VT No. 32-3038

272



32-3003

Power Commander III USB Engine Management Systems for Fuel Injected Models. Allows for both fuel and ignition adjustments. Each unit includes a specific map, designed to improve performance over stock. The Power Commander includes an IBM compatible link cable and software package which allows you to fully map the fuel ignition curves on an IBM compatible computers. If a computer is not available, the fuel curves can be adjusted by using three touch buttons on the face plate.



32-3011



32-3037

VT No.	Year	Model
32-3001	1997-98	Evo Big Twins
32-3007	1999-01	TC-88 Touring
32-3004	2002-06	TC-88 Touring
32-3003	2001-06	TC-88 Softail
32-3005	2002-06	V-Rod
32-3008	2004-05	TC-88 Dyna
32-3011*	2006	TC-88 Dyna
32-3012*	2007	FLT
32-3013*	2007-up	FXST
32-3014*	2007-up	Dyna
32-3037	2008-up	FLT

***Note:** Includes O₂ eliminators.



32-0294

Vance & Hines Fuel Pak. A throttle position sensor based system that simplifies the process of fuel injection tuning. Enables you to fine tune the fuel mixture

throughout the entire RPM range. No computer or software is required. Simply punch in the values supplied with the fuel pak. Requires use of high performance air cleaner.

VT No.	Fits
32-0293	2007-08 FXST/B/C SSE, 2007-08 FLSTF
32-0291	2004-up FXD, 2002-up V-Rod
32-0292	2002-07 FLHT, FLHR
32-0294	2008-up FLHT, FLHR
32-0290	2001-08 ST except 2007-08 FXST/B/C SSE, 2007-08 FLSTF



Controller Mount Bracket, zinc plated for 2000-up ST.

VT No. 31-0963



Fuel Injected Products



Fuel Injection Replacement Parts for 1995-up EFI systems.

VT No.	OEM	Item
32-0503	27218-95	Fuel Injector
32-0504	27219-95	Fuel Pressure Regulator 300 K PA
32-0495	As Above	350 K PA
32-0499	27609-01	Fuel Injector
32-0498	As Above	High Flow
32-0497	32424-95	Barometric Pressure Sensor 100 K PA
32-0496	As Above	250 K PA
32-0494	27628-01	Idle Air Control Motor
32-0567	27658-06	Idle Air Control
32-0505	27270-95	Air Temperature Sensor
32-0506	32446-99	Engine Temperature Sensor
32-0534	27629-01	Throttle Position Sensor
32-0568	27659-06	Throttle Position Sensor
32-0535	27135-97	Fuel Injector
32-0536	31511-01A	Relay w/Diode
32-0537	32316-99	Map Sensor
32-0569	32315-01	Coolant Temp. Sensor
14-0688	—	Gasket and Seal Kit
30-0424	27683-06	Ox Sensor
30-0423	66054-06	Ox Sensor Plug



Chrome Crank Sensor Cover Includes mount screw. 1999-up FXD-FLT.
VT No. 42-0953



Dyna Tek FI Controller is a plug module that offer 3 user selectable base fuel curves that are designed to improve engine operation and can be modified to suit a wide variety of modifications. Fuel mixture can be enriched or leaned as required. The Dyna FI controller uses the factory connectors for easy installation and there is no PC required for tuning or adjusting the fuel curves. There are no modifications required to the stock ECU and removing the Dyna FI controller returns the vehicle to the factory configuration.

VT No.	Fits
32-3021	1997-98 FLT Evo
32-3022	1999-01 FLT TC-88
32-3023	2002-05 FLT TC-88
32-3024	2001-05 FXST and FXD TC-88
32-3025	2006 FLT
32-3026	2006-FXST
32-3027	2006 FXD
32-3032	2007-up FLT
32-3033	2007-up FXST
32-3034	2007-up FXD



EFI Components Kits.

VT No.	Item
35-0874	Fuel Rail Kit
35-0875	Module Service Kit

V-Thunder Products for Evo EFI models



VT No. 32-0732 Complete Kit



VT No.	V-Thunder #	Description	Year
32-0718	VTE2600P	Injection Overdrive™ (A)	1995-96
32-0719	VTE2700P	Injection Overdrive™ (A)	1997-98
32-0730	VTE3001-KIT	Includes VTE 2700P and V-Thunder F.I Cam	1997-98
32-0732	VT-3003-KIT	Includes Air Cleaner element & backplate , F.I. Cam & FastTimes™ Adjustable Pushrods	1997-98
10-1147	EVL-2015	Fuel Injection Cam	1995-98