

---

# HCP653

---

## Gasoline-Powered Trash Pump

---

### User Manual

---

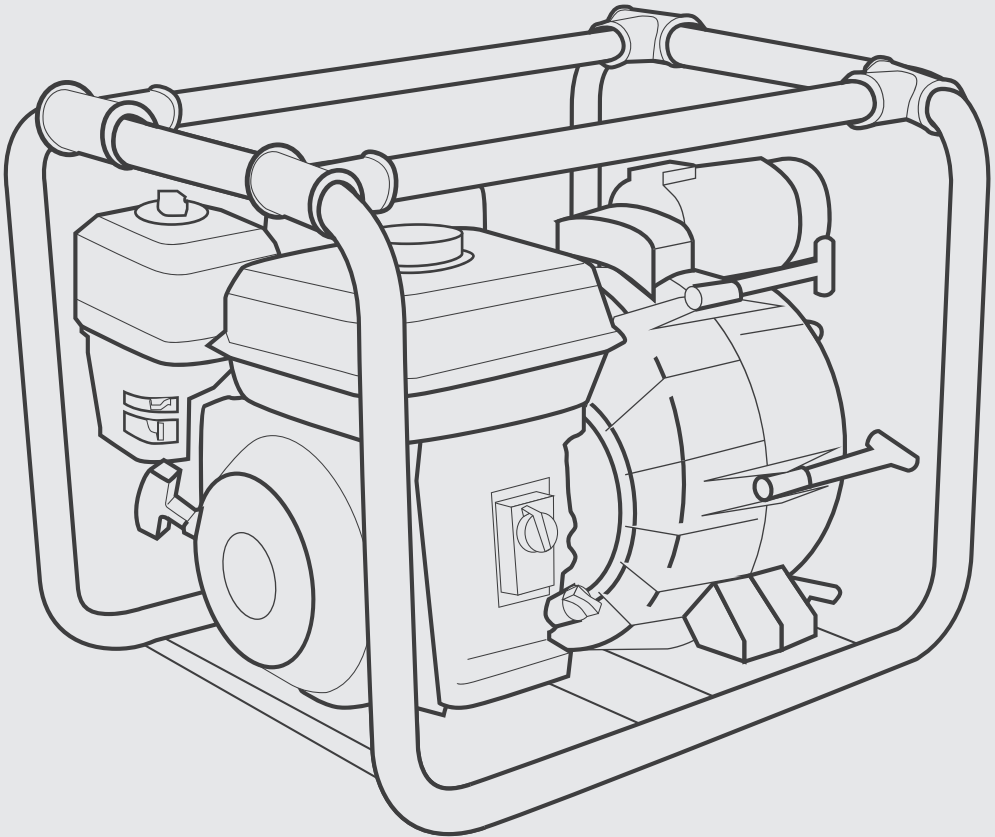

# **HYUNDAI**

POWER EQUIPMENT

©2011 Hyundai Power Equipment. All Rights Reserved.

Licensed by Hyundai Corporation, Korea.

HCP653-0711-02

**COMMERCIAL**  
series®





Thank you for purchasing this Hyundai Power Equipment  
Trash Pump.

Please register this product in order to ensure warranty  
service in the future.

This manual covers the safety, operation and maintenance  
procedures for the HCP653.

All information in this publication is based on the latest  
product information available at the time of print.  
Visit [www.powerbyhyundai.com](http://www.powerbyhyundai.com) for manual updates and  
operation notices.

No part of this publication may be reproduced without  
written permission. Please keep this manual together with  
the Owners Card. Contact Hyundai Power Equipment at  
the numbers listed on the Owners Card if warranty service  
is required.

It is important that anyone operating this product read and  
understand the manual prior to use.



## **Warranty Information**

Warranty service, operation assistance and product support is provided by Midland International Inc., a licensed manufacturer of Hyundai Power Equipment.

[www.powerbyhyundai.com](http://www.powerbyhyundai.com)

### **TECHNICAL ASSISTANCE**

1-855-706-8475

### **CUSTOMER SERVICE**

1-877-528-3772 (toll-free)

### **SALES**

1-503-534-3684

## **Component Certifications**

This product contains components certified by the following agency:



## TABLE OF CONTENTS

<b>1.0 - OPERATION SAFETY</b>	
1.1 - Operation Safety	8
<b>2.0 - COMPONENTS</b>	
2.1 - Identification	9
<b>3.0 - PRE-OPERATION INSPECTION</b>	
3.1 - Engine Oil Check	11
3.2 - Fuel Level Check	12
3.3 - Air Filter Check	13
3.4 - Hose Connections	14
<b>4.0 - OPERATION</b>	
4.1 - Pump Placement	15
4.2 - Priming Water	16
4.3 - Starting Trash Pump	16
4.4 - Stopping the Engine	17
<b>5.0 - MAINTENANCE</b>	
5.1 - Importance of Maintenance	18
5.2 - Maintenance Schedule	18
5.3 - Oil Maintenance	19
5.4 - Air Filter Service	20
5.5 - Spark Plug Service	21
5.6 - Fuel Sediment Cup	22
5.7 - Fuel Drainage	23
5.8 - Impeller Cleaning	23
5.9 - Transportation	24
5.10 - Storage	24
5.11 - External Parts Cleaning	25
<b>6.0 - TROUBLESHOOTING</b>	26
<b>7.0 - SPECIFICATIONS</b>	27
<b>WARRANTY</b>	28



---

## 1.0 - SAFETY PRECAUTIONS

---

### 1.1 - Operation Safety

- Always perform a pre-operation check before starting the engine.
- Properly clean and maintain the equipment.
- Operate the Trash Pump according to instructions for safe and dependable service.
- Read user manual carefully before operating this product! Failure to do so may result in serious harm to the user and to the equipment.
- This product emits poisonous carbon monoxide gas. Do not operate in an enclosed area.
- Be careful not to touch the exhaust system during operation due to risk of burns.
- Pay attention to the warning labels. The engine exhaust system will become heated during operation and remains hot immediately after the engine is stopped.
- Gasoline is a highly flammable and explosive liquid. Refuel in a well ventilated area with the engine stopped.
- When refueling the Trash Pump, keep it away from cigarettes, open flames, smoke and/or sparks.
- Place at least 5ft away from buildings or other equipment during operation.
- Run on a level surface to avoid fuel spills
- Know how to stop the engine quickly and understand operation of all the controls. Never permit anyone to operate this equipment without proper training.
- Keep children, pets and machinery with rotating parts away during operation.
- Do not touch the spark plug while the engine is operating or shortly after the engine has been shut down.
- Do not use this product to work with caustic liquids.



## 2.0 IDENTIFICATION OF COMPONENTS

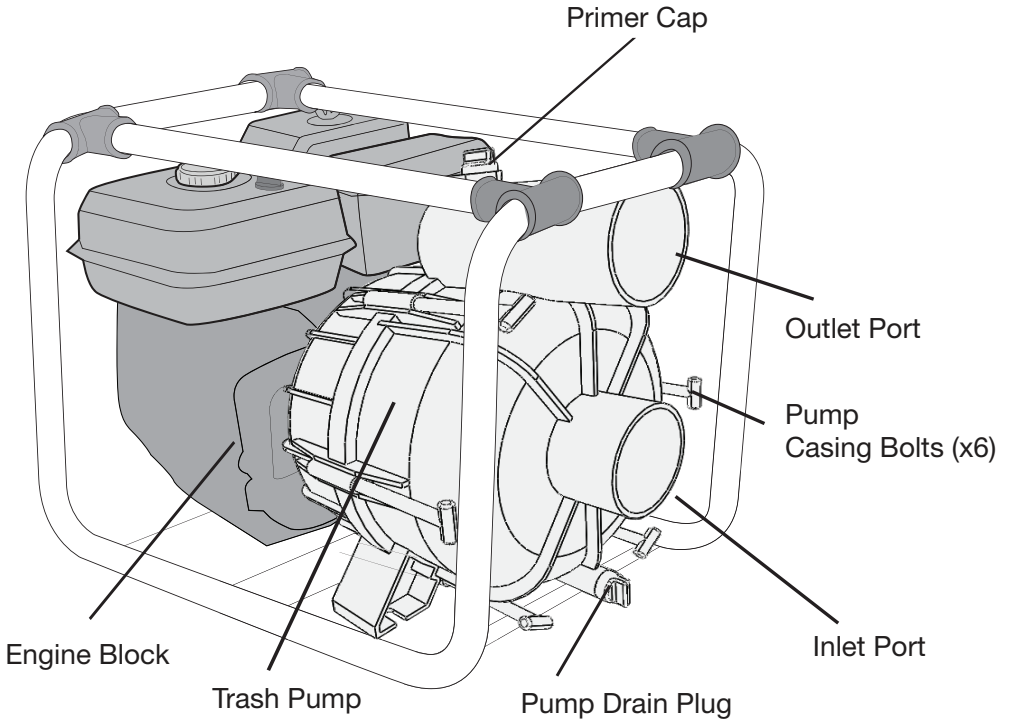
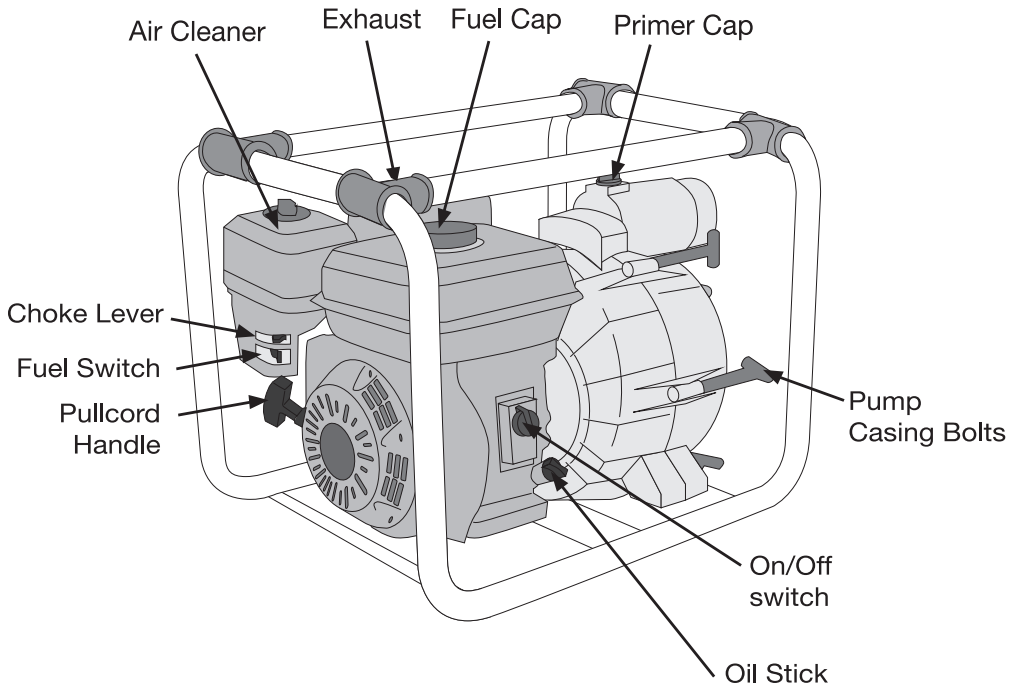

**HCP 653**  
**UNLEADED GASOLINE ONLY**  
 97+ OCTANE / 100+ ETHANOL MAX  
**SOLO GASOLINA SIN PLOMO**  
**3.6L / 1 GAL**

**AIR CLEANER MAINTENANCE**  
 Rinse with cleaning solvent and dry. Wash filter with solvent every 45 to 90 hours and operation. Wash filter once every 10 hours depending under heavy conditions. Immerse the filter into engine oil when clean and dry, then squeeze out excessive oil and reinstall.

**MANTENIMIENTO DEL FILTRO DE AIRE**  
 Enjuague con el solvente recomendado de limpieza, y seque. Lave el filtro con el solvente cada 45 a 90 horas de utilización. Lave el filtro cada 10 horas si la operación es en malas condiciones de mucho polvo. Una vez que está limpio y seco, sumerja el filtro en aceite de motor, exprima el exceso de aceite e reinstal.

**ATTENTION! / ATENCION!**

- Never add fuel when the engine is running
- Never add fuel when engine is hot
- Always add fuel in a well-ventilated area
- Always clean up fuel spills

- Nunca añadir combustible cuando el motor está funcionando.
- combustible cuando el motor está caliente.
- Siempre añadir combustible en un área ventilada.
- siempre limpiar cualquier derrame de combustible.

**HOT SURFACE / SUPERFICIE CALIENTE!**  
 KEEP CLEAR OF EXHAUST / MANTENGA LEJOS DE LOS GASES DE ESCAPE

**INCREASE POWER / AUMENTE EL PODER** ↔ **DECREASE POWER / DISMINUYA EL PODER**

**CLOSE / CERRAR** ↔ **OPEN / ABRIR**

**ON** →  
**OFF** ←

**WARNING!**  
 Starting the engine with the pump unprimed will burn the seal. Always prime before usage.

**ADVERTENCIA!**  
 Encender el motor sin antes cebar la bomba puede quemar el filtro. Asegúrese siempre de cebar la bomba primero.

**ADD OIL BEFORE USE!**  
**DO NOT OVER-FILL!**

**10W30**

**AGREGUE EL PETRÓLEO ANTES DEL USO**  
**NO SATURE**

**HYUNDAI**  
**7.0HP**  
**HX208**

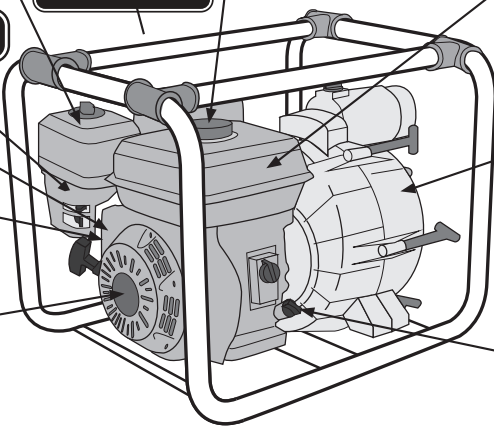

## 3.0 - PRE-OPERATING PROCEDURE

*Inspect all components for damage and to ensure that none are missing. If you require a replacement, do not operate this tool until all parts are present and in proper working order.*

*Do not modify or create accessories for this equipment. Using modified components may result in damage and may void the warranty. Contact customer service if you suspect that this equipment has been tampered with.*

### 3.1 - Engine Oil Check

1. Ensure the Trash Pump is on a level surface.
2. Inspect engine oil:
  - Take out the dipstick and clean it with a dry towel.
  - Check the oil level by reinserting the oil filler cap without rotating it.

Remove the oil filler cap and examine the oil level. If the oil level is at or below the lower level, refill the oil to the upper limit mark. (10W30)

Reinsert the oil filler cap and tighten securely.

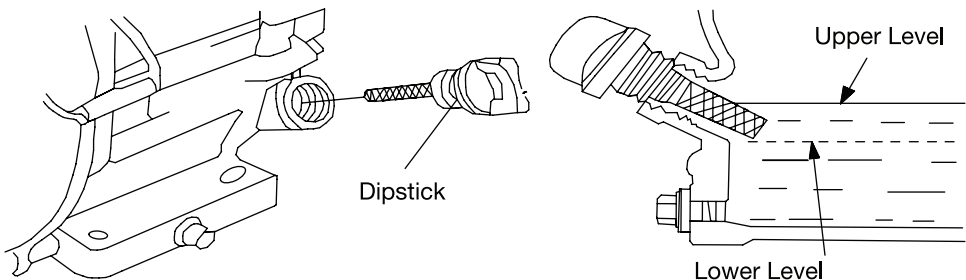

3. If necessary, add engine oil - Open oil inlet located opposite the recoil starter handle. Remove the dipstick and pour in the supplied oil with a funnel. Do not operate without oil.

*Reservoir can hold maximum 20 fl.oz of 10W30 oil - do not over fill.*

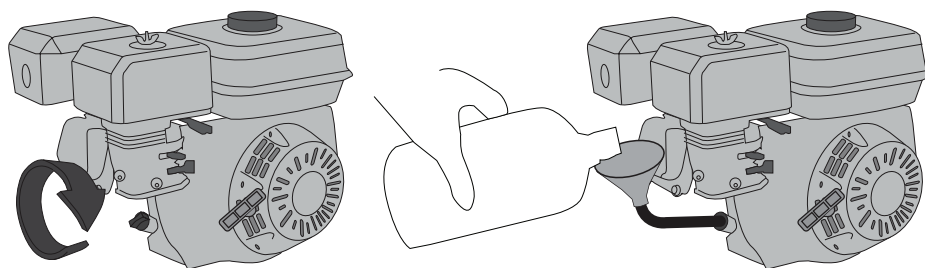

*Engine oil is a major factor affecting engine performance and service life. Non-detergent or vegetable oils are not recommended.*

### **3.2 - Fuel Level Check**

1. Check the fuel level by opening the tank and visually inspecting
2. Refuel if level is too low. Tighten the fuel tank cap securely after refilling

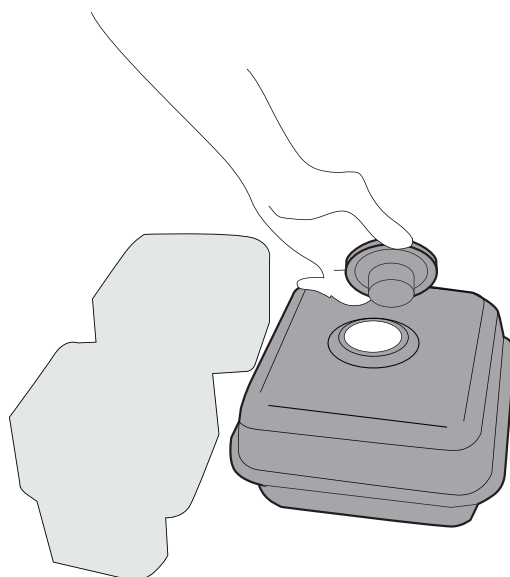

*Gasoline is highly flammable and explosive under certain conditions. Refuel in a well-ventilated area with the engine stopped. Do not smoke or allow open flames or sparks in the area where the Trash Pump is being refueled or where gasoline is stored. Do not overfill the tank. Be careful not to spill fuel when refueling. Wipe up any spilled gasoline and let the area dry before starting the engine. Gasoline substitutes such as gasohol are not recommended. They may be harmful to the fuel system components*

### **3.3 - Check the Air Filter**

1. Loosen the knob and remove the air filter cover. Remove the air filter element and inspect for cleanliness.
2. Clean the air filter element with soap and water or solvent. Squeeze dry and then soak in clean engine oil.
3. Squeeze out all excess oil and reinstall. Replace the element if it is damaged.

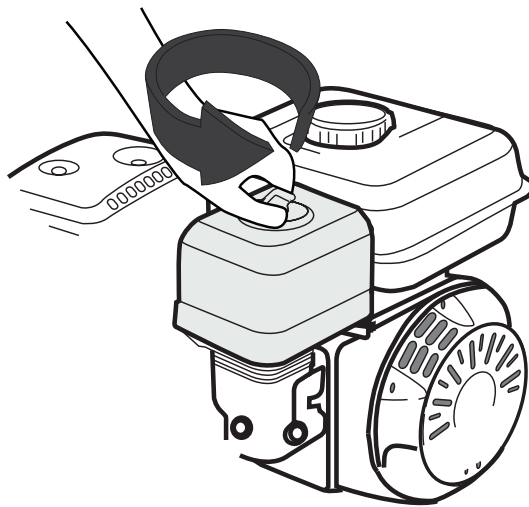

*Check the air filter according to the maintenance schedule. Always inspect the air filter before using the Trash Pump. Clean Air Filter every 3 months or after 50hrs of operation according Section 5.4: Air Filter Service procedure.*

### 3.4 - Hose Connections

1. Insert adapters into each end of the suction and discharge hoses.
2. Attach O-Rings to the adaptors.
3. Tighten the hose clamp around the discharge hose.
4. Insert strainer into the suction hose and tighten the hose clamp around the hose.
5. Insert adapters into the appropriate pump fittings. Avoid sharp bends in the hoses and do not place heavy objects on top.

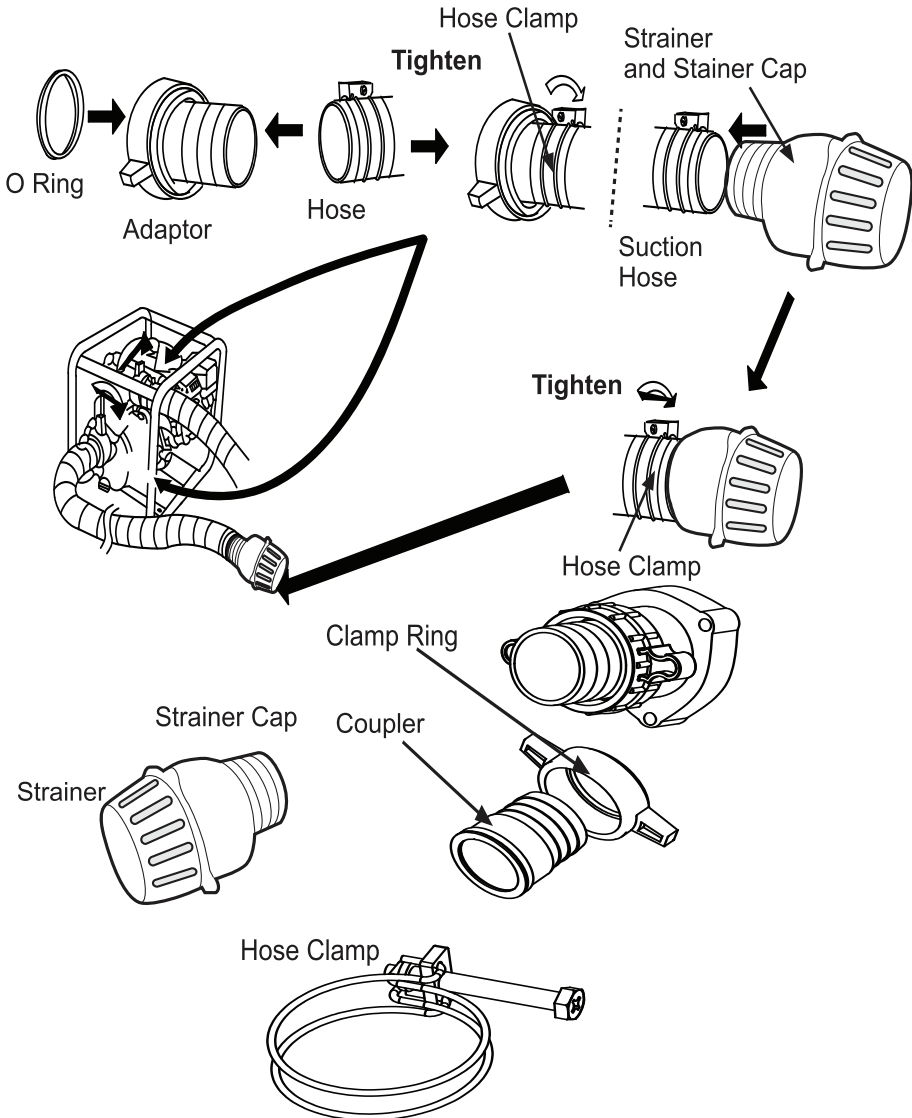

## 4.0 - OPERATION

### 4.1 - Pump Placement

Placement is an important step in safely operating this product.

1. Refer to diagram for proper placement instructions.
2. Ensure that the suction head is less than the discharge head.
3. Increasing the discharge head will decrease output.
4. Ensure pump is primed to minimize the suction head.

*Suction head is the height to which a pump can raise water on the suction side, measured from the water level in the sump. Discharge head is the vertical distance between the intake level of the water pump and the level at which it discharges water freely. Total head is the sum of the suction and discharge head.*

#### Bad Placement

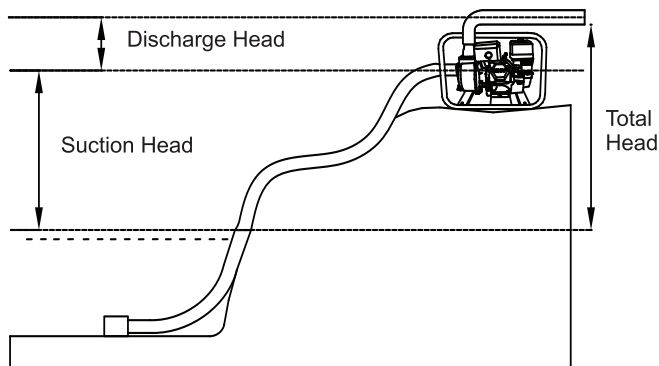

#### Good Placement

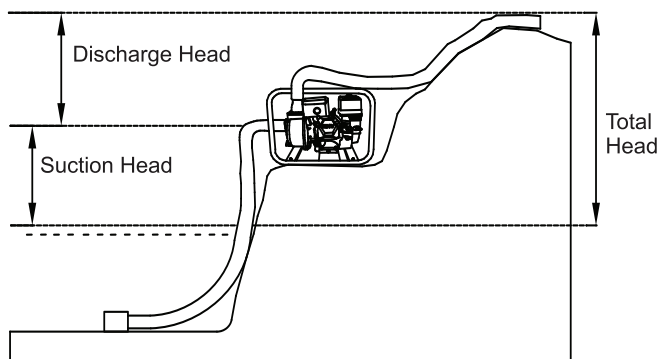

## 4.2 - Priming Water

*Make sure to prime the pump with water prior to operating it. Priming creates a vacuum that helps to start the flow of water.*

1. Unscrew the primer cap and insert the neck of the water container into the opening. Gradually tilt until the reservoir is full.
2. Tighten the cap back on.
3. In case of dry operation (running the pump without priming), stop the engine immediately and allow it to cool before following the priming procedure.

*Do not operate without priming. Doing so will overheat the engine and result in damage to the system. Ensure that the priming water does not contain debris.*

## 4.3 - Starting the Trash Pump

### RECOIL START METHOD

1. Rotate the fuel valve lever to ON position.
2. If the engine is cold: Push the choke lever to the CLOSE position out to close the choke.

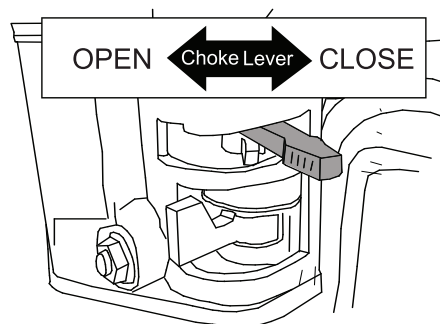
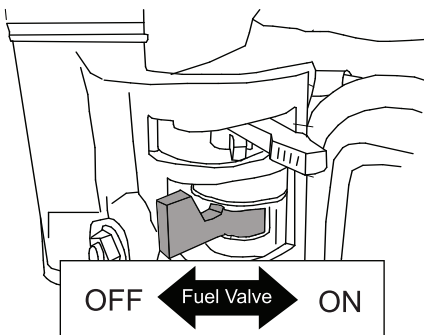



3. Grasp the recoil starter handle and pull it until the engine starts.

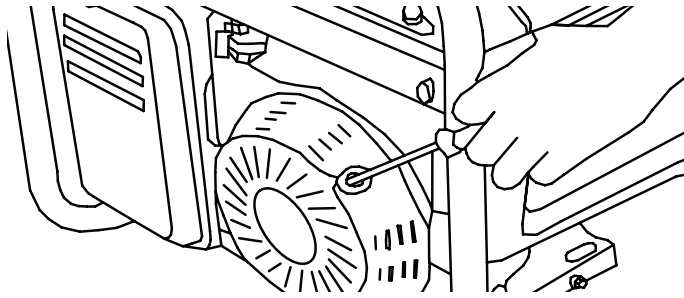

*Do not allow the recoil starter to snap back. Return it slowly by hand*

4. Push the choke lever to the OPEN position as the engine warms up. The choke is used to provide the proper mixture when the engine is cold. It can be open and closed manually by moving the choke lever to the closed position to enrich the mixture for cold starting.
5. After 5 minutes, slowly push the throttle lever to the OPEN position. Engine RPMs will increase until engine reaches its stable running speed.

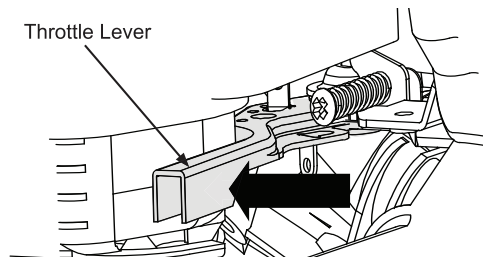

*If the engine backfires or does not start repeated attempts, contact customer support and do not attempt to use the Trash Pump.*

#### **4.4 - Stopping the Engine**

1. Return the throttle lever to the IDLE position (towards the right)
2. Turn the engine switch to the OFF position
3. Turn the fuel valve to the OFF position

*In an emergency, the engine can be quickly stopped by turning the engine switch to the OFF position.*

## 5.0 - MAINTENANCE

### 5.1 - Importance of Maintenance

Proper maintenance ensures safe, economical and trouble-free operation. Improper maintenance may cause the Trash Pump to malfunction and can lead to serious injuries. Contact Hyundai Power Customer Support if you have any maintenance questions.

### 5.2 - Maintenance Schedule

ITEM	TASK	DAILY	EVERY 20 HOURS	EVERY 50 HOURS	EVERY 100 HOURS	EVERY 300 HOURS
Spark Plug	Check condition, adjust gap and clean. Replace if necessary.			•		
Engine Oil	Check oil level	•				
	Replace		•		•	
Air Filter	Clean, replace if necessary			•		
Fuel Filter	Clean fuel valve and tank filter. Replace if necessary.				•	
Valve Clearance	Check and adjust when engine is cold.					•
Fuel Line	Check fuel hose for cracks and other damage. Replace if necessary.	•				
Exhaust System	Check for leakage. Tighten or replace gasket if necessary.	•				
	Check muffler screen. Clean or replace if necessary.				•	
Carburetor	Check choke operation	•			•	
Cooling System	Check for water damage.					•
Starting System	Check recoil starter assembly.	•				

### 5.3 - Oil Change and Oil Drainage

*Used motor oil can cause skin irritations if left in long-term contact with skin. Wash hands thoroughly with soap and water after handling oil.*

*Do not dispose of used oil in drains or on soil. Local service shops provide environmentally-friendly disposal methods.*

1. Stop the engine and remove oil filler cap.
2. Place a pan under the engine.
3. Remove the oil drain screw and allow the oil to completely drain into the pan.
4. Reinstall drain screw before filling the engine with fresh oil. Do not overfill oil reservoir. Use a funnel to prevent spillage.
5. Reinstall the filler cap and tightly fasten it.

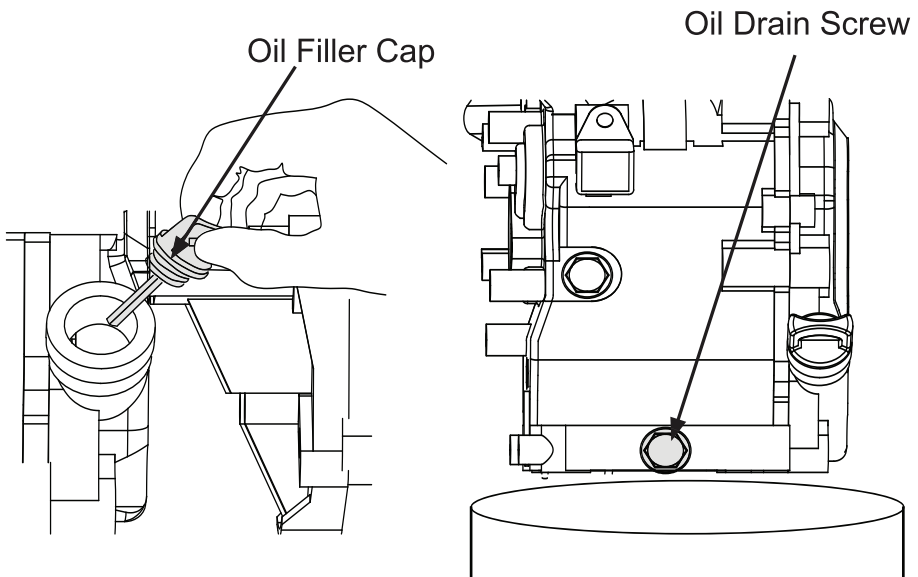

## 5.4 - Air Filter Service

*Using gasoline or other flammable solvents can cause a fire or explosion. Do not use these to clean the air filter.*

*Do not operate this product without an air filter.*

1. Unscrew the air filter cover.
2. Remove the filter element and wash with soap and water.
3. Pour a small amount of oil on filter element and squeeze out any excess. Do not wring the filter element or apply excessive pressure. Smoke may appear if too much oil is left in the air filter.
4. Reinstall the filter element and cover, ensuring a complete seal around the filter.

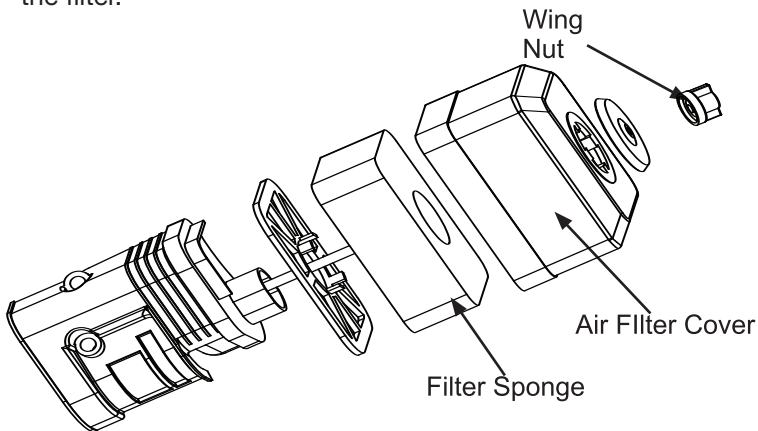

## 5.5 - Spark Plug Service

*Do not rinse spark plug in water. Follow guidelines and be careful not to overtighten the spark plug.*

*Tighten  $\frac{1}{2}$  turn when installing a new spark plug.*

*Tighten  $\frac{1}{4}$  turn when re-installing an old spark plug.*

1. Disconnect and remove the spark plug using a wrench.
2. Inspect the spark plug and clean any dirt from the electrodes with a wire brush. If electrodes are worn or show signs of wear, replace spark plug.
3. Measure the electrode gap with a spark plug gauge and adjust as necessary by bending the side electrodes. Ensure that the gap is between 0.7 and 0.9mm
4. Reinsert the plug carefully. Tighten with a spark plug wrench.

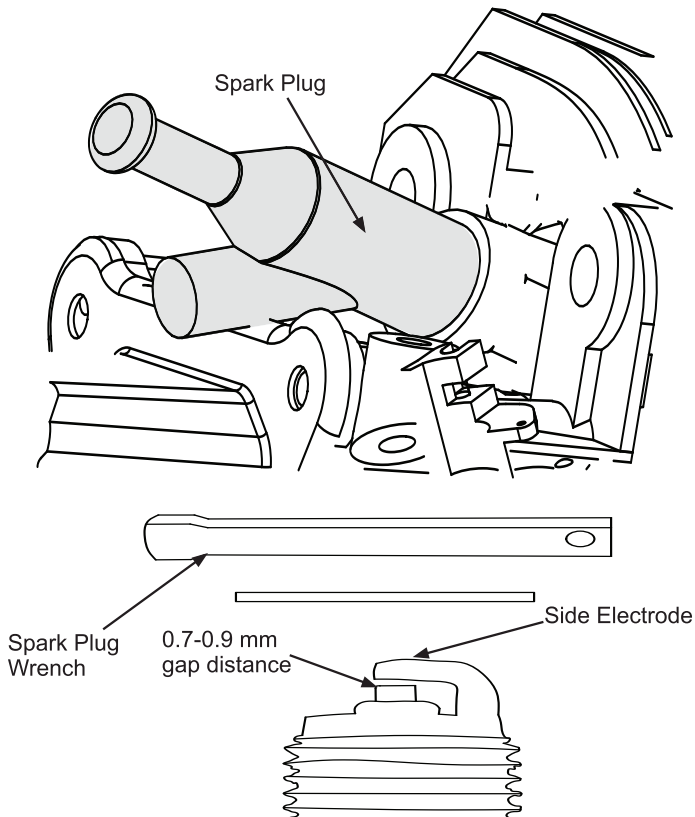

## 5.6 - Fuel Sediment Cup Service

1. Switch fuel valve to the OFF position.
2. Unscrew the sediment cup using a wrench and remove the O-ring.
3. Wash the cup and O-ring in a non-flammable solvent and dry thoroughly.
4. Place the O-ring in the fuel valve, then attach sediment cup. Tighten securely.
5. Switch the fuel valve to the ON position and check for leaks. Replace O-ring if leakage occurs.

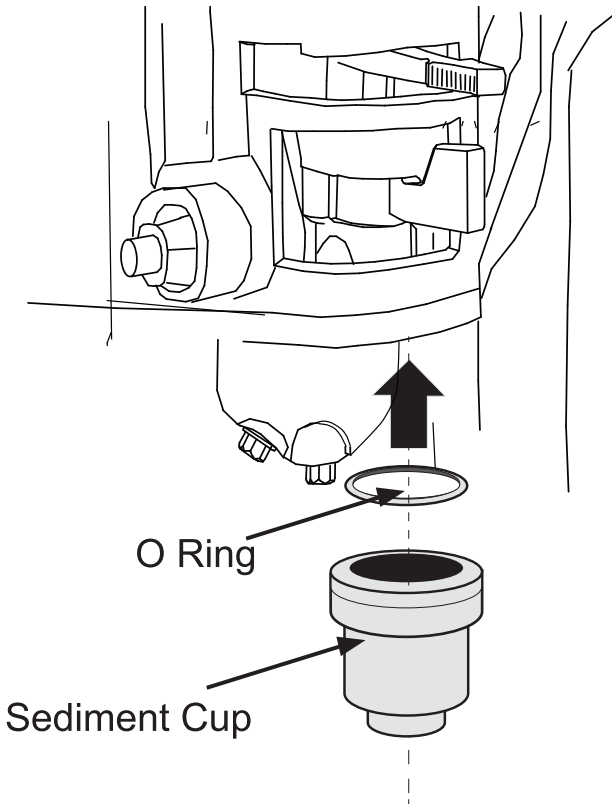

## 5.7 - Fuel Drainage

*Gasoline should not be stored in containers that are not safe for fuel transport.*

1. Place container underneath the while removing the drain screw from the carburetor.
2. Turn the fuel valve to ON and slowly remove the fuel drain screw.
3. Allow fuel to drain fully and reinsert the screw.

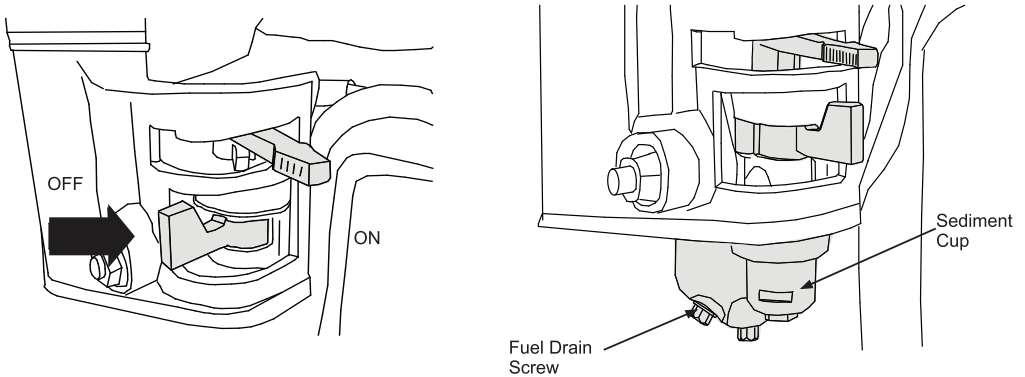

## 5.8 - Impeller Cleaning

Impeller cleaning is important when storing pump for long periods of time. It is also advisable as part of regular maintenance checks.

### QUICK METHOD

1. Fill pump with fresh water through primer opening.
2. Start pump and allow it to run for up to 8 minutes or until water evaporates upon contact with engine block.
3. Drain water through pump drain outlet.
4. Flush pump with clean water (puring it through primer opening).
5. Reinsert drain screw.

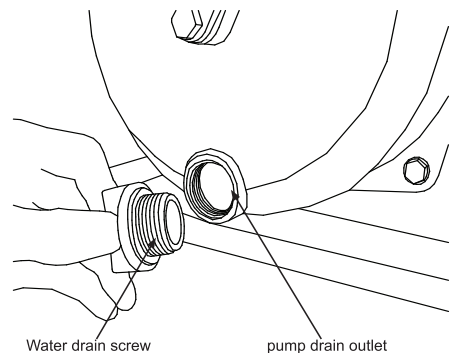

## INTENSIVE CLEANING

1. Remove / unscrew all 6 pump casing bolts from the pump.
2. Carefully remove the outside casing, exposing the impeller.
3. Clean impeller using regular soap and water, if necessary use a light scrubbing tool to remove debris.
4. Reinstall casing on trash pump and fasten all bolts.

*When reinstalling the casing, ensure that the rubber seal is properly secure all around the perimeter of the opening.*

## 5.9 - Transportation

*Engine and exhaust can become hot. Avoid contact due to risk of burns and fires. Allow engine to cool before transporting unit.*

*Do not drop or strike the pump during transport. Avoid placing heavy objects on the frame or gas tank.*

- Make sure engine and fuel valve are in the OFF positions
- Keep the unit level to prevent spillage.
- Place pump on a solid, level surface and secure it to prevent movement during transport

## 5.10 - Storage

*Do not store close to sources of heat, flames or sparks*

*Do not store in extremely humid or dusty areas*

*Do not store with gasoline still inside carburetor or gas tank*

1. Clean the impeller and drain water out
2. Drain gasoline from tank and carburetor
3. Change engine oil



4. Slide fuel valve to OFF position
5. Place pump in an appropriate storage area at temperatures above 32°F
6. Cover inlet and outlet ports
7. Cover unit to protect it from dust

## 5.11 - External Parts Cleaning

Keeping the external parts clean can prevent debris build-up and ensure easy access during maintenance.

*Do not use a pressure washer to clean this product. Delicate electrical components may be damaged.*

1. Place unit in a well-lit area
2. Use a grease-removing solvent (non-flammable) and a cloth to clean areas around the gas tank and oil ports.
3. Use a soft, damp cloth to clean off remaining residue and debris.
4. Allow unit to dry before using it.



## 6.0 - TROUBLESHOOTING

Common issues can be fixed by following the instructions in this guide. If the unit will not function after following these instructions, contact technical support before attempting to use or repair the product.

ISSUE	CAUSE	ACTION
Engine will not start	Faulty spark plug	Use a wrench to remove the spark plug and follow procedure for cleaning or replacing
	Clogged fuel line	Check fuel line for leaks. Unclog if necessary
	Wrong fuel type	Drain fuel and clean fuel line. Refill with appropriate fuel
	Carburetor not getting air or fuel	Take to service dealer
	Dirty air filter	Clean air filter
	Starter not functioning	Take to service dealer
Power is low	Dirty air filter	Clean air filter
	Throttle lever unadjusted	Slide throttle lever to increase power output
Water output is low	Clogged strainer	Remove debris and rinse with water
	Suction hose blocked with debris	Remove obstruction
	Damaged hoses	Replace hoses
	Clogged impeller	Remove obstruction
	Lose hose clamps	Tighten or replace hose clamps
	Leaking seals	Take to service dealer
No water output	Incorrect pump placement	Reposition pump (see placement section of manual)
	Pump is not primed	Prime pump
	Pump mechanism is damaged	Take to service dealer

## 7.0 - SPECIFICATIONS

### HCP9100

<b>TRASH PUMP</b>	Discharge Port Diameter	3"
	Suction Port Diameter	3"
	Maximum Discharge	15,850 gal/hr
	Maximum Lift	98'
	Maximum Suction	26'
	Operating Temperature Range	32° - 104°F (0° - 40°C)
<b>ENGINE</b>	Type	7 HP, Single Cylinder, forced air cooling, 4-stroke, OHV 25 deg tilt
	Displacement (cm <sup>3</sup> )	208cc
	Ignition mode	Non-contact transistor
	Starting mode	Recoil Start
	Fuel tank capacity (Gal)	1
	Oil capacity	20 fl.oz. (10W30)
	Fuel Type	Unleaded gasoline, propane
	Running Volume	67dB (at 7m)
	Running Time Per Tank (hours)	6
<b>BOX</b>	L x W x H	23x18x18.5"
	Dry Weight	90lbs



# Warranty

Midland International Inc.  
26 Huddersfield Rd. Unit #2  
Etobicoke, Ontario Canada  
M9W 5Z6

This warranty is limited to the listed Hyundai Power Equipment products when distributed by Cobalt Power Inc.

These products are warranted to be free of defects in materials and workmanship from the original date of purchase according to the schedules defined in this warranty document. This limited warranty guarantees that any defective parts will be repaired or replaced, at the warrantor's discretion, at no cost, including diagnosis and replacement parts.

### **3 YEAR LIMITED WARRANTY:**

The limited warranty coverage is continual from the initial date of purchase and does not restart at any time under any circumstances. This limited warranty is valid only when the equipment receives all necessary preventative maintenance, as described in the Hyundai User Manual. The repair or replacement will take place within a reasonable period of time during normal business hours.

### **LABOR WARRANTY CLAIM PROCEDURE:**

The product must be purchased in the United States or Canada from Cobalt Power Inc., via an authorized channel of distribution. This limited warranty applies to the first purchaser and each subsequent registered owner during the applicable warranty time period.

### **What MIDLAND INTERNATIONAL INC. will Repair or Replace Under Limited Warranty:**

MIDLAND INTERNATIONAL INC. will repair or replace, at its opinion, any part that is proven to be defective in material or workmanship under the normal use during the applicable warranty time period. Warranty repairs and replacements will be made without charge for parts, accessories, or labor during the first 12 months after original purchase. The remaining 24 months of warranty are parts only. Anything replaced under warranty becomes the property of MIDLAND INTERNATIONAL INC. All parts replaced under warranty will be considered as part of the original product, and any warranty on those parts will expire coincident with the original product warranty.

Warranty service must be performed by a Hyundai-authorized service dealer. If you feel your equipment is malfunctioning due to a defect, simply contact our customer support center for technical advice, to file a warranty claim or for general information.

## **BEFORE WARRANTY WORK CAN BEGIN**

To obtain warranty service, contact our customer support center:

Toll Free: 1-877-528-3772

Email: support@hyundaipower.ca

Online: www.powerbyhyundai.com or www.hyundaipower.ca

## **LIMITATIONS OF REMEDIES AND DISCLAIMERS**

THE FOREGOING LIMITED WARRANTY IS EXCLUSIVE OF AND IN LIEU OF ALL OTHER WARRANTIES OF MERCHANTABILITY, FITNESS FOR A PARTICULAR PURPOSE, AND OF ANY OTHER WARRANTY, WHETHER EXPRESSED OR IMPLIED.

Midland International Inc. disclaims any responsibility for any indirect, incidental or consequential loss or damage caused by any defects in material or workmanship.

All expenses incurred in maintaining parts shall be incurred by the purchaser. This warranty coverage does not include parts affected by accident and/or collision, corrosion or rust, normal wear, use in an application for which the product was not intended, service from an unauthorized service dealer, or any other misuse, neglect, incorporation or use of unsuitable attachments and/or parts. Under this warranty, the warrantor is not obligated to bear any transportation fees of any product to/from an authorized service dealer. Unauthorized alteration, installation, or any cause other than defects in material or workmanship of the product will not be covered under this warranty.

Some states do not allow limitations on how long an implied warranty lasts and/or do not allow the exclusion or limitation of incidental or consequential damages, so the above exclusions and limitations may not apply to you. This warranty gives you specific legal rights, and you may also have other rights which vary from state to state.

## **NOT COVERED BY THIS LIMITED WARRANTY:**

1. Normal wear and tear, such as but not limited to fading of painted or plated surfaces, sheet peeling and other natural deterioration.
2. Damage caused by a lack of maintenance as described in the Hyundai User Manual.
3. Consumable parts: Hyundai does not warrant deterioration of the following unless needed as a part for another warranted repair: Spark plugs, fuel filters, air cleaner elements, clutch discs, tires, wheel bearings, starter ropes, cables, belts, oil and grease.
4. Damage caused by accidental or improper installation or storage.
5. Exposure of the product to chemical agents, bird droppings, sea water, sea breeze or salt.
6. Improper repair or maintenance.
7. Damage caused by water ingestion, submersion, or external water damage except for HCP653 (Trash Pump) and HCP3000 (Pressure Washer).
8. Damage or non-performance caused by operation of the generators set in a marine application.
9. Operating methods other than those indicated in the owners manual.
10. Damage caused by operation with improper pressure, conditions, or modifications contrary to published specifications.



11. Items not supplied by Hyundai, such as, but not limited to, external wiring, filters, etc.
12. The use of non-genuine Hyundai parts and accessories.
13. Repairs made during the warranty period without first obtaining a case number form Hyundai.

**PRODUCT REGISTRATIONS**

Product registration is required for all product support and warranty coverage. The purchaser must also provide the original proof of purchase. The owner’s registration, found with the user manual, must be completed and mailed. You can also register online at [www.powerbyhyundai.com](http://www.powerbyhyundai.com) or [www.hyundaipower.ca](http://www.hyundaipower.ca). You should keep your receipt or invoice as proof of purchase.

Product covered by warranty	Length of warranty from date of original purchase	
	LABOR	PARTS
Pro Power Series Generators: Model No: HCP6500D, Diesel Power Generator	12 Months	36 Months
Model No: HCP9000, Dual-Fuel Generator	12 Months	36 Months
Model No: HCP9100, Gas-Powered Air Compressor	12 Months	36 Months
Model No: HCP3000, Gas-Powered Pressure Washer	12 Months	36 Months
Model No: HCP653, Gas-Powered Water Trash	12 Months	36 Months

**ACCESSORIES AND REPLACEMENT PARTS**

**3 YEAR LIMITED PARTS AND ACCESSORIES WARRANTY**

This limited warranty defines the accessories and replacement parts warranty and is limited to Hyundai Power Equipment products when distributed by Cobalt Power Inc.

The accessories and replacement parts must be purchased from COBALT POWER INC. in the United States or Canada. Parts and Accessories must be purchased for installation on original Hyundai equipment or engines to be eligible for warranty coverage. Installing parts and accessories on non-Hyundai products or engines voids the warranty.

Midland International Inc. will repair or replace, at its option, any Hyundai Power Equipment accessories or replacement parts that are proven to be defective in material or workmanship under normal use during the applicable warranty time period. Anything replaced under warranty becomes the property of Midland International Inc. All parts replaced under warranty will be considered as part of the original product, and any warranty on those parts will expire coincident with the original product warranty.

**PARTS AND ACCESSORIES WARRANTY CLAIM PROCEDURE**

Original accessories and replacement parts that are proven to be defective in material or workmanship under the normal use will be repaired or replaced under warranty without charge if determined to be defective within the first thirty-six months form the original date of purchase. After one year from the original date of purchase, labor costs will be the responsibility of the purchaser. If installed by anyone else, acces-

sories and replacement parts will be repaired or replaced under warranty without charge for parts, but any labor charges will be the responsibility of the purchaser.

### **EXCLUSIONS**

The same exclusions listed above for labor apply to this warranty. This warranty does not extend to accessories, or parts, affected or damaged by collision, normal wear, use in an application for which the product was not designed or any other misuse, neglect, incorporation or use of unsuitable attachments or parts, unauthorized alteration, improper installation, or any causes other than defects in material or workmanship of the product. Installing non-Hyundai Parts and Accessories voids this warranty.

### **DISCLAIMER OF CONSEQUENTIAL DAMAGE AND LIMITATION OF IMPLIED WARRANTIES:**

MIDLAND INTERNATIONAL INC. disclaims any responsibility for loss of time or use of the product, or the power equipment on which the product is installed, transportation, commercial loss, or any other incidental or consequential damage. Any implied warranties are limited to the duration of this written warranty. Some states do not allow limitations on how long an implied warranty lasts and/or do not allow the exclusion or limitation of incidental or consequential damages, so the above exclusions and limitations may not apply to you. This warranty gives you specific legal rights, and you may also have other rights, which vary from state to state.

### **TO OBTAIN WARRANTY SERVICE FOR PARTS OR ACCESSORIES:**

You must, at your expense, take the Hyundai Power Equipment accessory, or replacement part, or the Hyundai Power Equipment product on which the accessory or replacement part is installed, and proof of purchase to any authorized Hyundai Power Equipment dealer, distributor or distributor's dealer in the United States or Canada during the dealer's or distributor's normal business hours. If you are unable to obtain warranty service or are dissatisfied with the warranty service you receive, take the following steps:

First, contact the owner of the service location involved; normally this will resolve the problem. Second, if the issue is not resolved, contact:

Hyundai Power Equipment Customer Support Center

Toll Free: 1-877-528-3772

E-mail: [support@hyundaipower.ca](mailto:support@hyundaipower.ca)

Online: [www.powerbyhyundai.com](http://www.powerbyhyundai.com) or [www.hyundaipower.ca](http://www.hyundaipower.ca)

