



You can be sure...
if it's Westinghouse 

WESTINGHOUSE™,  and "YOU CAN BE SURE. IF IT'S WESTINGHOUSE™" are trademarks of WESTINGHOUSE ELECTRIC CORPORATION and used under license to W-Lifestyle Limited.
WKTB316 • 06 2011



Blender

Instructions
For household use only

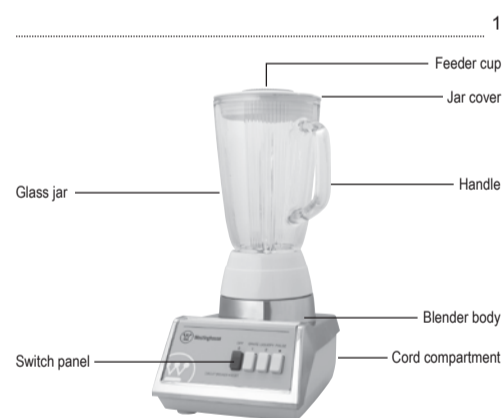

INSTRUCTIONS

Read the instructions and keep them safe. If you pass the appliance on, pass on the instructions too. Remove all packaging, but keep it till you know the appliance works.

IMPORTANT SAFEGUARDS

Follow basic safety precautions, including:

1. Read all instructions.
2. To protect against risk of electrical shock, do not immerse blender body, cord, or plug in water or other liquids.
3. This appliance should be used only by or under the supervision of a responsible adult. Do not leave the appliance unattended, especially when children are present.
4. Unplug from outlet when not in use, before cleaning and before attaching and detaching accessories.
5. Do not operate the appliance with a damaged cord or plug, or after the appliance malfunctions or has been dropped or damaged in any manner.
6. Do not place the appliance near a hot gas or electric burner, or in a heated oven.
7. Do not attach or remove accessories or other attachments while the appliance is in use.
8. Before using this appliance, make sure that accessories are firmly attached to the blender body.
9. Do not use accessories or attachments other than those we supply.
10. Do not use outdoors or while standing in a damp area.
11. Do not let cord hang over edge of table or counter, or touch hot surfaces, including the stove.
12. Blades are sharp, handle with care.
13. The blade of this appliance is very sharp, please handle it carefully when cleaning and assembling.
14. Do not use the appliance for any purpose other than those described in these instructions.

CAUTION

1. Before using, make sure voltage and frequency indicated on the bottom plate are the same as you local supply.
2. The machine should be laid on flat platform when it is working and operated according to the user manual.
3. Do not crush ice cubes only.
4. Do not operate blender longer than 4 min. at one time. Rest for 2 min., then resume.
5. Dice solid foods first. Blend with water.
6. Unplug after use

Maximum ingredient volume: 1400 ml

ASSEMBLY

Assemble the appliance as shown below.

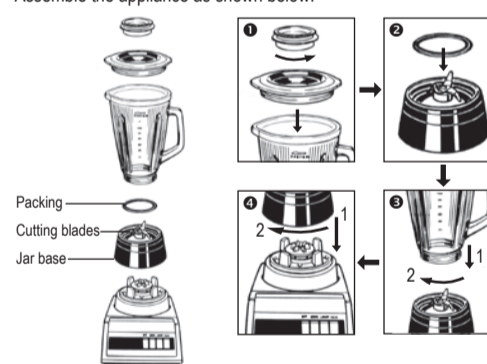

USING THE BLENDER

1. Make sure switch is OFF.
2. Place ingredients in the glass jar. Cover.
3. Place the glass jar on the blender body.
4. Plug in.
5. Select one of two speed buttons as required.
6. Use PULSE switch for precision blending.
7. Ingredient cap can be used to add ingredients. Remove cap and add ingredients during operation.
8. When finish, switch the appliance OFF.

CARE AND MAINTENANCE

Caution: Never immerse the blender body in water or any other liquid.

1. Put into the jar proper amount of warm water and a little food detergent, cover the jar and press the pulse button for about 10 seconds; or soak the jar into the water to wash with a brush.
2. Wipe the main body with a piece of wet cloth. Do not wash it in water to prevent damage.
3. Put cord in the cord compartment for easy storage.
4. Store the appliance in its original box in a cool and dry place.

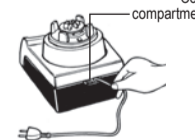

INFORMATION AND SERVICE

If you have question or concerns about your product, please visit our website: www.westinghouse-lifestyle.com, or contact our oversea offices/agents.

In line with our policy of continuous product development, we reserve the right to change product, packaging and documentation specifications without notice.