

MPA-101

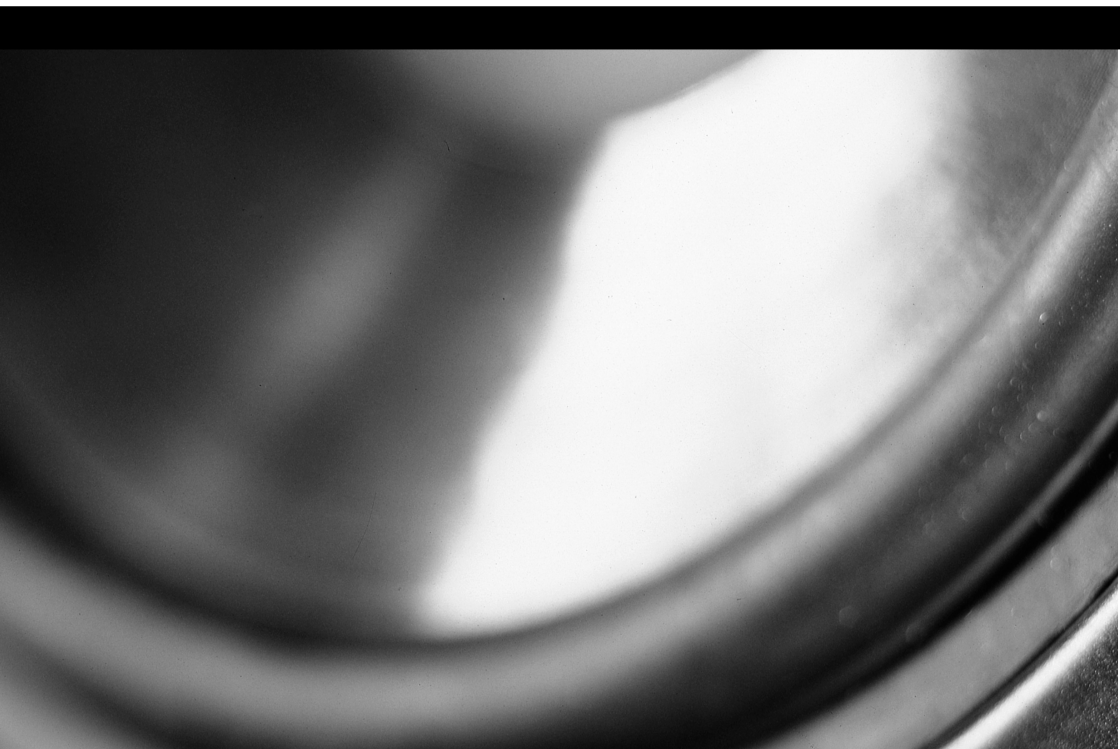

WARNING: Improper installation could result in damage to the amplifier and/or speakers. Read all instructions before installation.

Jamo[®]
Let's get personal



The lightning flash with arrowhead, within an equilateral triangle, is intended to alert the user to the presence of uninsulated "dangerous voltage" within the product's enclosure that may be of sufficient magnitude to constitute a risk of electric shock to persons.



Warning:
To prevent electric shock, never open this product.
No user-serviceable parts inside.
Leave all service to qualified service personnel.



The exclamation point within an equilateral triangle is intended to alert the user to the presence of important operating and maintenance (servicing) instructions in the literature accompanying the appliance

Safety Precautions

1. **Heed warnings :** All warnings on the product and in the User's Guide must be adhered to.
2. Read all instructions before using this product, and keep the instructions safe for later reference.
3. **WARNING:** To reduce the risk of fire or electric shock, do not expose this product to rain or moisture - Never use the product immediately after moving it from a cold environment, which may cause condensation.
4. The product must be positioned in such a way that there is sufficient ventilation at all times.
5. Do not place the product near heat sources, such as radiators, heaters or any other heat-emitting appliances.
6. Avoid placing in direct sunlight.
7. The product may only be attached to a mains supply that corresponds to the marking on the product.
Do not defeat the safety purpose of a polarized or grounding type plug. A polarized plug has two blades with one wider than the other. A grounding type plug has two blades and a third grounding prong. The wide blade or the third prong are provided for safety reasons. If the provided mains plug does not fit into your outlet, consult an electrician for replacement of the obsolete outlet.
8. If the product is not used for a longer period of time, or for added protection during a lightning storm, disconnect the mains lead from the wall outlet.
9. Pull on the mains plug - never the mains lead itself - when disconnecting the plug from the wall outlet.
Ensure that the mains lead does not become stretched or trapped/clamped, especially around the mains plug and the point at which the lead is connected to the product.
10. Always follow the user instructions when making connections to other appliances.
11. Take care not to drop objects or spill liquid through the openings in the product.
12. The product should be serviced by qualified personnel if:
 - The mains lead or plug is damaged.
 - Objects are dropped or liquid is spilled into the product.
 - The product has been exposed to rain.
 - The product is not operating normally.
 - The product has been dropped and/or the cabinet is damaged.
13. Please note that this product - either alone or combined with an amplifier, loudspeakers or headphones - can cause damage to hearing.
Never play at high volume for longer periods and never play so loud that it feels uncomfortable.
Warning! It can be particularly difficult to estimate sound pressure in the deep bass area, which is why extra attention must be paid in order to avoid harmful sound pressures.
Always contact your doctor if you experience loss of hearing and/or ringing in the ears.
14. **Warning :** Power-supply cords should be routed so that they are not likely to be walked on or pinched by items placed upon or against them, paying particular attention to cords at plugs, and the point at which they exit from the product.

Contents:

Introduction	Page 4
Features:	Page 4
Jamo MPA-101 front panel	Page 5
Jamo MPA-101 rear panel	Page 6
Connection	Page 7
Connecting examples	Page 8
Passive subwoofer	Page 8
Fullrange stereo	Page 9
2 x 100W bridged	Page 10
Daisy chain	Page 11
Specifications	Page 12
Warranty	Page 13

Introduction

Congratulations on your purchase of your new Jamo Multi-Purpose Amplifier (MPA-101). It is backed by state-of-the-art engineering and manufacturing techniques to bring you the best quality craftsmanship and reliable performance.

The MPA-101 is specifically designed for home theatre applications. Because of its ample power and two-channel capacity (stereo), it can fit into virtually any surround application. Narrow width chassis is designed for convenient shelf or system rack mounting in the space of the one stereo component.

It allows you to use one amplifier as left and right stereo front speakers, second amplifier use as left and right rear (surround) speakers and third amplifier use for centre channel.

Bridge mode capability allows the use of the two channels connected together to form one high power amplifier channel, providing 100 watts into 8 Ohm.

The MPA-101 is also a subwoofer amplifier with adjustable electronic crossover. With switch in OFF position it becomes full range amplifier.

The power rating for the Jamo MPA-101 power amplifier are obtained using fixed value test load impedances and high intensity sine wave test tones. However, the actual impedance of the loudspeaker will vary with frequency, deviating somewhat from the loudspeaker manufacturer's nominal impedance rating.

This Jamo amplifier has been specially designed to drive any modern loudspeaker system with a rated impedance of 4 Ohms or higher.

Features

1. Power output, rated at 2x50 Watts (stereo) into 4 Ohm
2. High power output (bridged mode), rated at 100 Watts into 8 Ohm
3. Subwoofer amplifier, adjustable crossover frequency 50 Hz – 150 Hz
4. Full range amplifier
5. Extensive heat sinks for reliable operation and long life of the amplifier
6. High current discrete power transistors in the output stage for the best possible performance
7. Automatic power turn "ON"
8. Level control
9. Gold plated RCA input and output jacks
10. Heavy duty push button binding posts
11. Overload protection

Jamo MPA-101 front panel

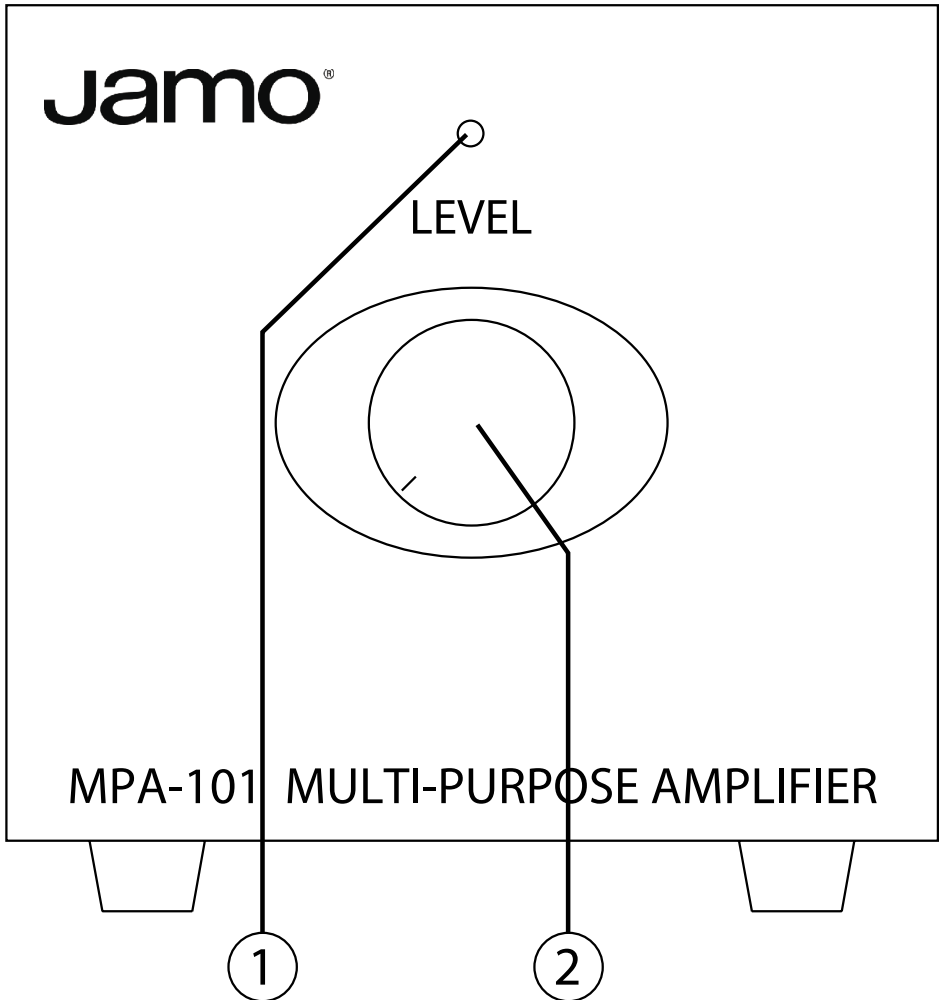

① **Power LED**

Flashing blue - Standby mode

Blue - Amplifier On

Flashing red - Thermal protection

Red - Overload protection

② **Level adjustment**

Jamo MPA-101 rear panel

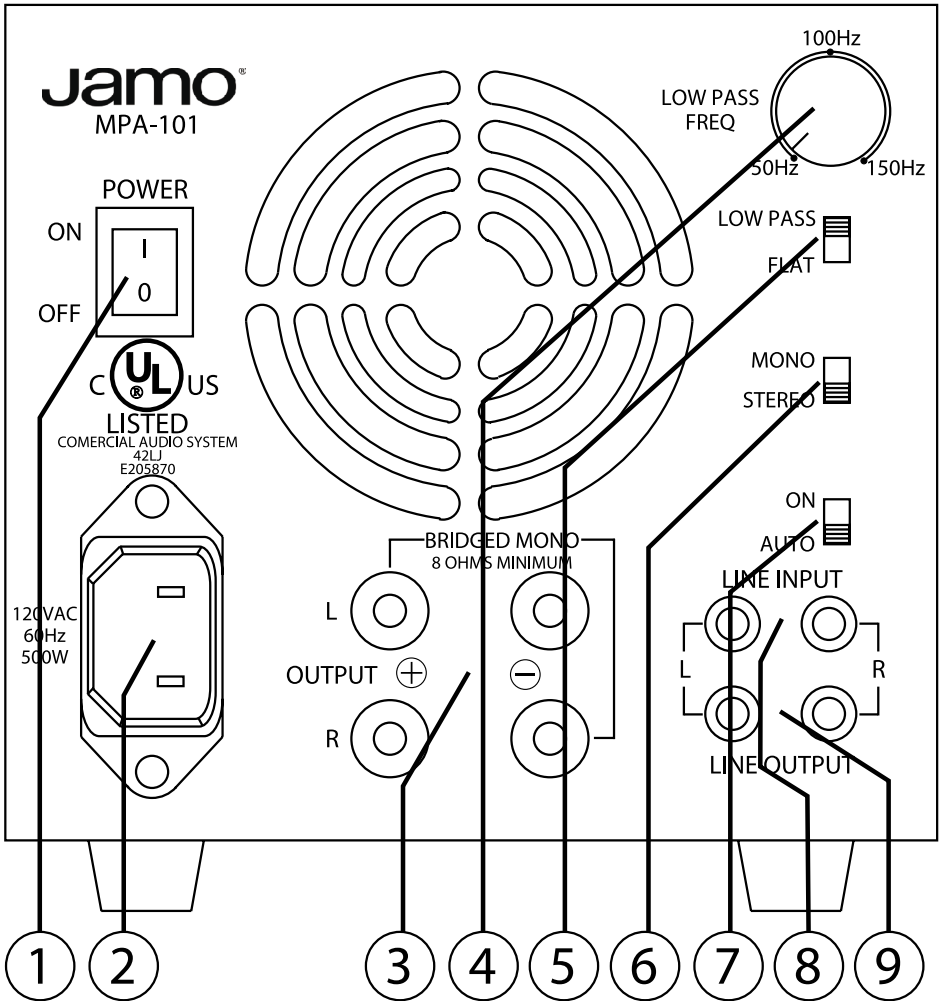

- ① **Power switch**
- ② **Socket for mains cable**
- ③ **Speaker output:** Speakers terminals
- ④ **Low pass adjustment:** Output frequency is adjustable between 50 - 150 Hz. Only adjustable when „low pass“ is selected
- ⑤ **Low pass:** ④
Flat: Fullrange
- ⑥ **Stereo/mono:** Stereo mode - 2 x 50 watt stereo output (4Ω)
Mono mode - 100 watt mono output (8Ω)
- ⑦ **On - Amplifier ON**
AUTO - auto turn on mode
- ⑧ **Line in:** Line level input from source
- ⑨ **Line out:** Line level output

Connection

The Jamo MPA-101 is equipped with gold-plated push button binding posts which will accept very heavy stripped wire.

Ask your local Jamo dealer for advice on the choice of cable.

Connect the loudspeakers to your Jamo MPA-101 as follows:

1. Turn off the MPA-101
2. Carefully remove approx. 3/8" (10 mm) of the insulating material - beware not to damage the conductors!
3. Twist the conductor ends
4. Push the binding posts so the conductors can easily fit into the holes

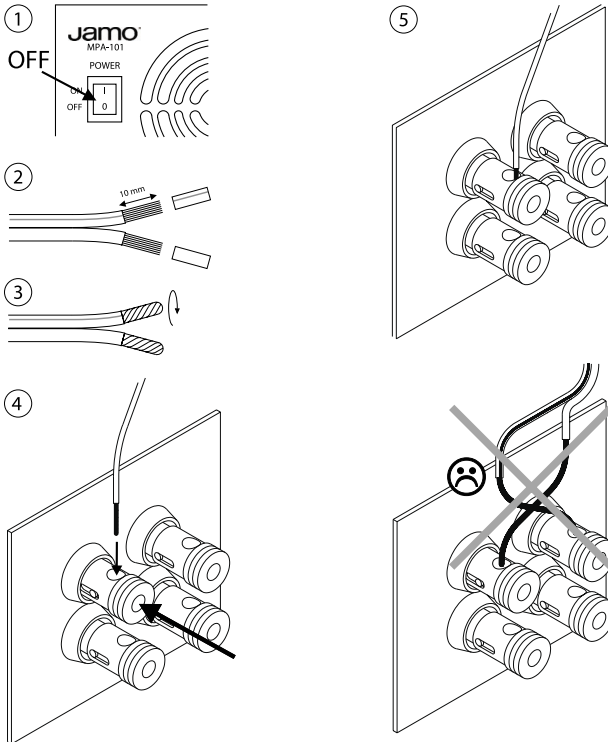

Note: Make sure that the stripped + and - wires do not touch each other, as a short-circuit could damage the Jamo MPA-101's output section.

Always make sure that:

Your loudspeakers are in correct phase;

The loudspeaker's + terminal is connected to the Jamo MPA-101's + terminal.

The loudspeaker's - terminal is connected to the Jamo MPA-101's - terminal.

Usually, the loudspeaker cable is marked on one wire which is normally used to connect the + terminals to ensure correct phase.

Connecting examples

Passive subwoofer

Switch to LOW PASS

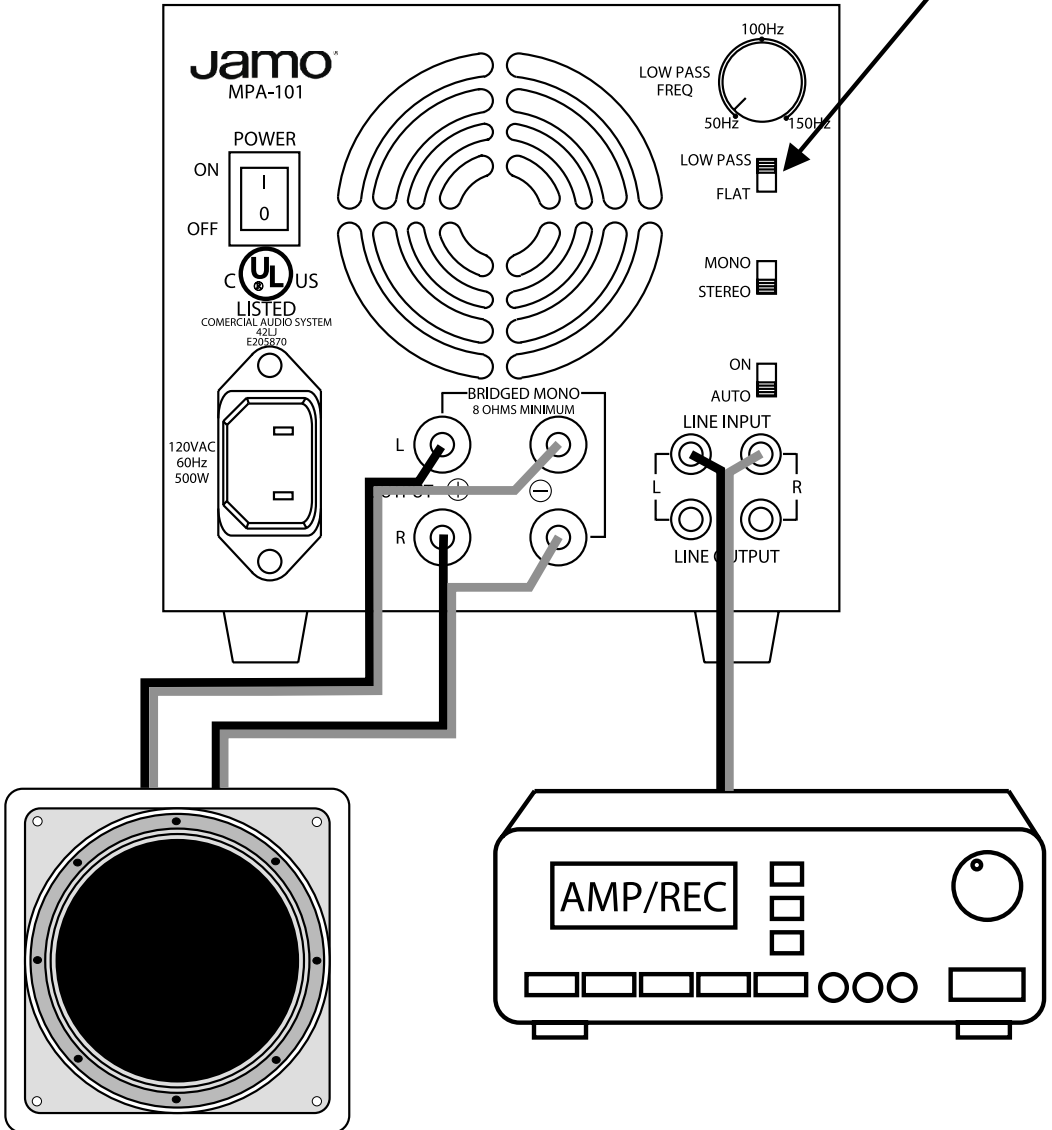

When „Low pass“ is selected, you can adjust the low pass frequency between 50 - 150 Hz. This makes it possible to make the subwoofer match your front speakers.

Fullrange stereo

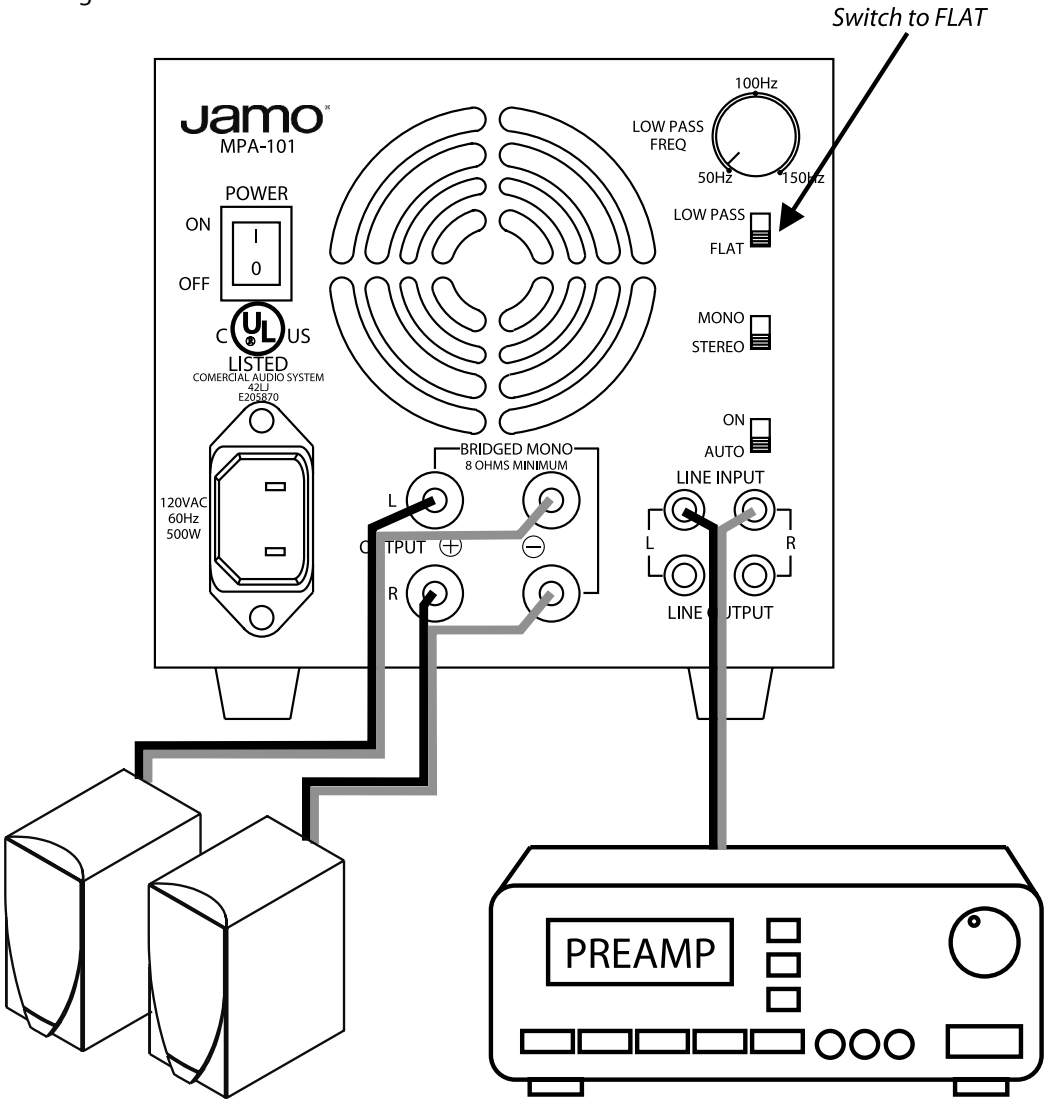

2 x 100W bridged

Switch to MONO

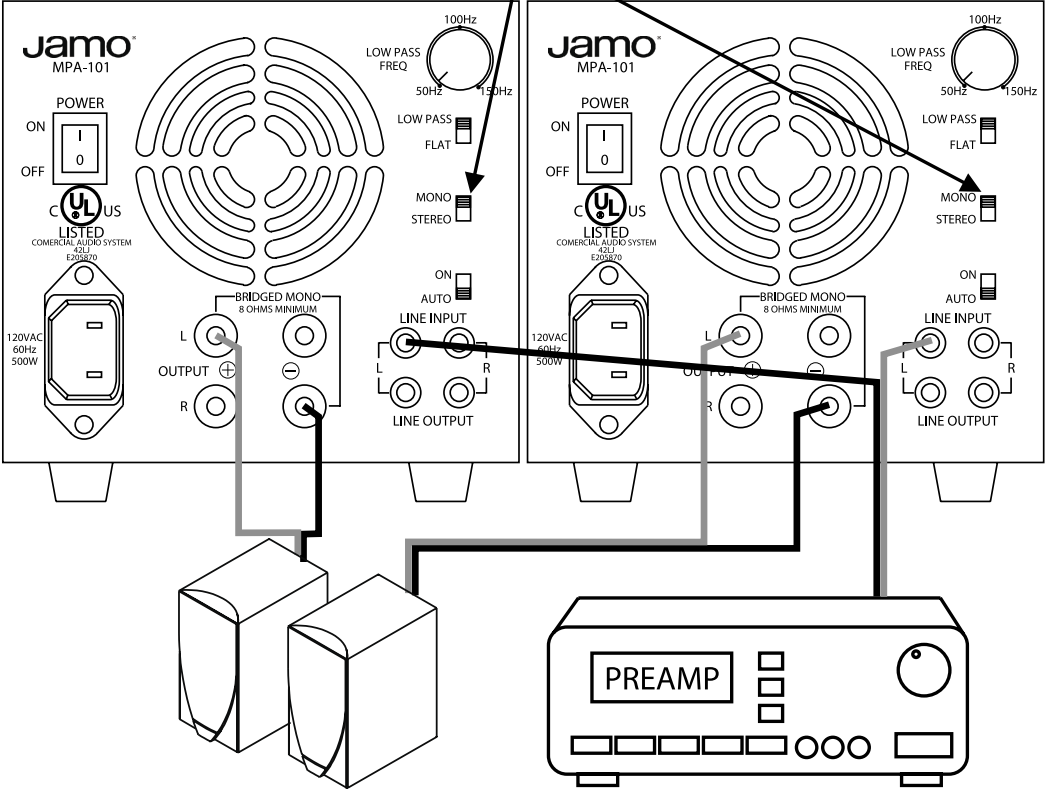

Daisy chain

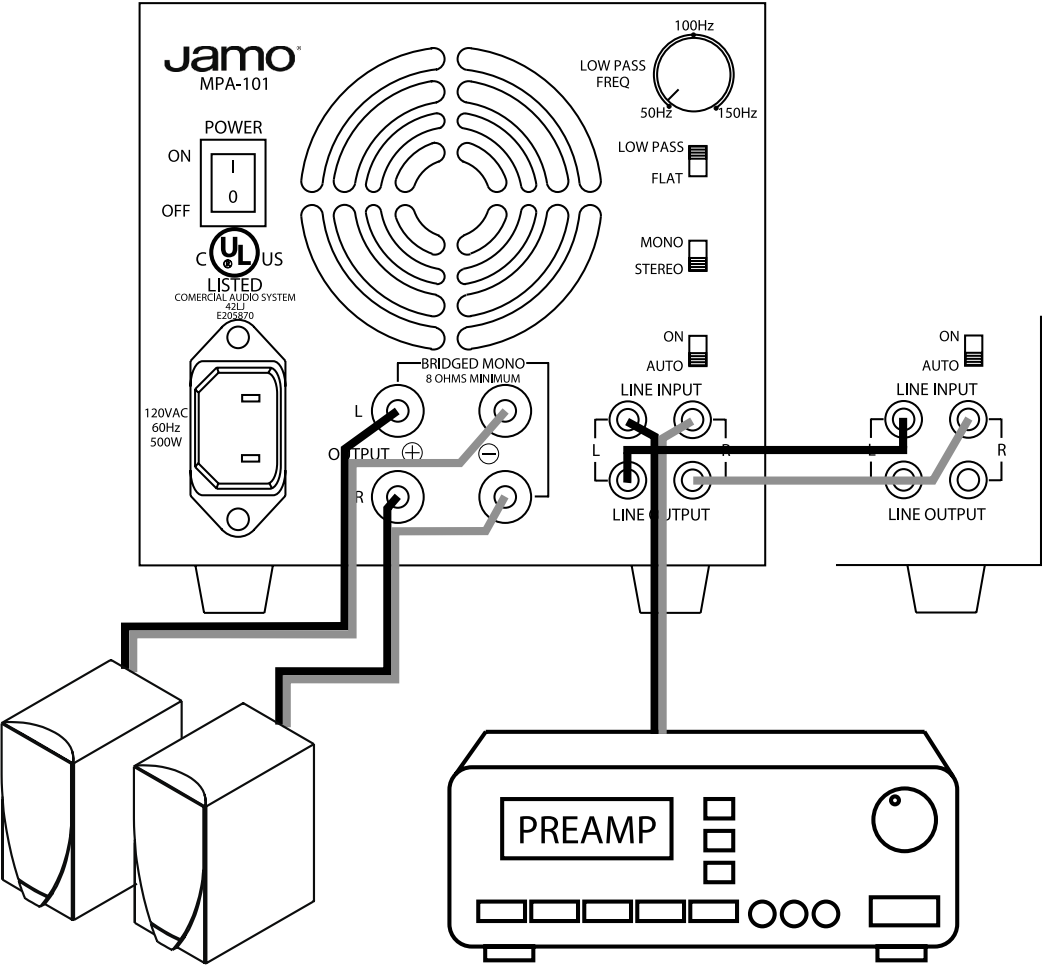

When using this feature you can connect all the MPA-101 in parallel you need.

Specifications

Rated Power Output	50 Watts (Stereo) into 4Ω Load
Total Harmonic Distortion (THD)	100 Watts (BTL) into 8Ω Load
Signal-to-Noise Ratio	<0.1%
Crossover Freq. Response (-3dB):	@ Min position 28-45Hz 40Hz/0dB ref @ Max position 32-60Hz 40Hz/0dB ref
Auto Turn On Sensitivity	11.0V +/-3 Full Range 1KHz 7.0V +/-2 Sub Input 50 Hz
Delay „OFF“ Time	15 - 20 minutes
Input Sensitivity Line In	Output 1 W/4Ω with: Full Range 44mV +/-10 1KHz Sub In 7mV +/-2 50Hz
Line Out Freq. Response (-3dB)	20Hz +/-5K - 20 KHz +/-5K 1KHz/0dB ref
Input Impedance Line In	47KΩ +/-5
Max. noise+hum Vol Max	<3.0mV, Input Shorted
Clearance for ventilation - Back	Minimum 2" (50mm)
Power Requirement	115V 60Hz
Weight	7.8lbs (3.6 kgs)
Shipping Weight	8.6lbs (3.9kgs)
Dimensions:	
Width	6.000" (152.00mm)
Height	3.125" (79.00mm)
Depth	11.4375" (290.00mm)
Clearance for ventilation	
Top	Minimum 3/8" (10 mm)
Back	Minimum 2" (50 mm)

The scope of the warranty

The warranty period will come into force as from the purchase date stated on the invoice. The warranty will apply for the following period of time:

- 2 years for electronics (power supply, amplifier, etc.)
- 7 years for other parts (cabinet, speaker units, etc.)

In case of warranty inquiries, please contact your dealer.

In case of request for service under warranty, please enclose your original receipt.

Defects covered by the warranty:

Except for the defects stated below, the warranty covers any production and material defects of the product.

Defects not covered by the warranty:

- Defects arising from accidents, misuse, normal wear and tear, mis-maintenance, voltage variation, overloading, stroke of lightning, and other force majeure events
- Defects arising from incorrect installation or operation
- Defects arising from modification/repair/attempt of repair by a non-authorised service centre
- Defects arising from the use of non-original spare parts
- Defects on products with altered or lacking series number
- Other defects due to conditions or circumstances beyond the supplier's control

Transportation costs for servicing are not covered by the warranty.

The supplier is liable only to repair or replace defective parts or products. A replacement cannot exceed the value of the product under warranty.

