



# User Manual

Original User Manual

**SD 18**  
**GVD 10**  
**DV 10**



Company information:  
[www.vipercleaning.eu](http://www.vipercleaning.eu)  
[info-eu@vipercleaning.com](mailto:info-eu@vipercleaning.com)

VA61415 (1) – 2010-09-01





## TABLE OF CONTENTS

<b>INTRODUCTION</b> .....	<b>4</b>
MANUAL PURPOSE AND CONTENTS .....	4
TARGET .....	4
HOW TO KEEP THIS MANUAL .....	4
DECLARATION OF CONFORMITY .....	4
IDENTIFICATION DATA .....	4
OTHER REFERENCE MANUALS .....	4
SPARE PARTS AND MAINTENANCE .....	4
CHANGES AND IMPROVEMENTS .....	4
PURPOSE AND INTENDED USE .....	4
CONVENTIONS .....	5
<b>UNPACKING/DELIVERY</b> .....	<b>5</b>
<b>SAFETY</b> .....	<b>5</b>
SYMBOLS USED TO MARK INSTRUCTIONS .....	5
GENERAL INSTRUCTIONS .....	5
TRANSPORT .....	5
OPERATION .....	5
MAINTENANCE .....	6
EXTENSION LEAD .....	6
GUARANTEE .....	6
TESTS AND APPROVALS .....	6
ELECTRICAL COMPONENTS .....	6
MATERIALS HAZARDOUS TO HEALTH .....	7
EMPTYING DIRT TANK .....	7
RISK OF EXPLOSION .....	7
SPARE PARTS AND ACCESSORIES .....	7
<b>MACHINE DESCRIPTION</b> .....	<b>8</b>
MACHINE STRUCTURE .....	8
STANDARD ACCESSORY SET .....	9
TECHNICAL DATA .....	9
<b>WIRING DIAGRAM FOR GV702-EU</b> .....	<b>10</b>
<b>OPERATION</b> .....	<b>10</b>
BASIC OPERATION .....	10
<b>MAINTENANCE</b> .....	<b>10</b>
EMPTYING THE DIRT TANK .....	11
REPLACING THE FILTER BAG .....	11
REPLACING THE AIR FILTER .....	11
<b>STORAGE</b> .....	<b>11</b>
<b>RECYCLING THE CLEANER</b> .....	<b>11</b>

## INTRODUCTION



### NOTE

The numbers in brackets refer to the components shown in Machine Description chapter.

## MANUAL PURPOSE AND CONTENTS

The purpose of this Manual is to provide the operator with all necessary information to use the machine properly, in a safe and autonomous way. It contains information about technical data, safety, operation, storage, maintenance, spare parts and disposal. Before performing any procedure on the machine, the operators and qualified technicians must read this manual carefully. Contact Viper in case of doubts concerning the interpretation of the instructions and for any further information.

## TARGET

This manual is intended for operators and technicians qualified to perform the machine maintenance.

The operators must not perform procedures reserved for qualified technicians. Viper will not be answerable for damages coming from the non-observance of this prohibition.

## HOW TO KEEP THIS MANUAL

The User Manual must be kept near the machine, inside an adequate case, away from liquids and other substances that can cause damage to it.

## DECLARATION OF CONFORMITY

The declaration of conformity, supplied with the machine, certifies the machine conformity with the law in force.



### NOTE

Two copies of the original declaration of conformity are provided together with the machine documentation. The CE-declaration is printed in the Quick Start Guide.

## IDENTIFICATION DATA

The machine model and serial number are marked on the plate.

This information is useful when requiring machine spare parts. Use the following table to write down the machine identification data.

MACHINE model .....
MACHINE serial number .....

## OTHER REFERENCE MANUALS

- Service Manual (can be consulted at Viper Service Centers)
- Spare Parts List (see [www.vipercleaning.eu](http://www.vipercleaning.eu))

## SPARE PARTS AND MAINTENANCE

All necessary operating, maintenance and repair procedures must be performed out by qualified personnel or by Viper Service Centers. Only original spare parts and accessories must be used. Contact Viper for service or to order spare parts and accessories, specifying the machine model and serial number.

## CHANGES AND IMPROVEMENTS

Viper constantly improves its products and reserves the right to make changes and improvements at its discretion without being obliged to apply such benefits to the machines that were previously sold.

Any change and/or addition of accessories must be approved and performed by Viper.

## PURPOSE AND INTENDED USE

The appliance is suitable for picking up dry, non-flammable dust.

This appliance is suitable for commercial use, for example in hotels, schools, hospitals, factories, shops, offices and rental businesses.

Any other use is considered as improper use. The manufacturer accepts no liability for any damage resulting from such use. The risk for such use is borne solely by the user.

Proper use also includes proper operation, servicing and repairs as specified by the manufacturer.

## CONVENTIONS

Forward, backward, front, rear, left or right and up are intended with reference to the operator's position, that is to say in working position with the handle.

## UNPACKING/DELIVERY

To unpack the machine, carefully follow the instructions on the packing.





When the machine is delivered, check that the packing and the machine were not damaged during transportation. In case of visible damages, keep the packing and have it checked by the carrier that delivered it. Call the carrier immediately to fill in a damage claim.

## SAFETY

The following symbols indicate potentially dangerous situations. Always read this information carefully and take all necessary precautions to safeguard people and property.

The operator's cooperation is essential in order to prevent injury. No accident prevention program is effective without the total cooperation of the person responsible for the machine operation. Most of the accidents that may occur in a factory, while working or moving around, are caused by failure to comply with the simplest rules for exercising prudence. A careful and prudent operator is the best guarantee against accidents and is essential for successful completion of any prevention program.

## SYMBOLS USED TO MARK INSTRUCTIONS

	<p><b>DANGER!</b> Danger that leads directly to serious or irreversible injuries, or even death.</p>
	<p><b>WARNING!</b> Danger that can lead to serious injuries or even death.</p>
	<p><b>CAUTION!</b> Danger that can lead to minor injuries and damage.</p>
	<p><b>NOTE</b> Indicates a remark related to important or useful functions.</p>

## GENERAL INSTRUCTIONS

Specific warnings and cautions to inform about potential damages to people and machine are shown below.

The appliance must

- only be used by persons, who have been instructed in its correct usage and explicitly commissioned with the task of operating it
- only be operated under supervision
- not be used by children

Do not use any unsafe work techniques.

Never use the vacuum cleaner without a filter.

Switch off the appliance and disconnect the mains plug in the following situations:

- Prior to cleaning and servicing
- Prior to replacing components
- Prior to changing over the appliance

Use of the cleaner is subject to current national regulations. Besides the operating instructions and binding accident prevention regulations valid in the country of use, observe recognized regulations for safe and proper work.

## TRANSPORT

Before transporting the dirt tank, close all the locks.

Do not use a crane hook to lift the cleaner.

## OPERATION

Take all necessary precautions to prevent hair, jewels and loose clothes from being caught by the machine moving parts.

The machine working temperature must be between 0°C and +40°C.

The humidity must be between 30% and 95%.

Do not use the machine as a means of transport.

In case of fire, use a powder fire extinguisher, not a water one.

Do not tamper with the machine safety guards and follow the ordinary maintenance instructions scrupulously.

Do not allow any object to enter into the openings. Do not use the machine if the openings are clogged. Always keep the openings free from dust, hairs and any other foreign material which could reduce the air flow.

Do not remove or modify the plates affixed to the machine.

If the machine is used according to the instructions, the vibrations are not dangerous. The machine vibration level is less than 2.5 m/s<sup>2</sup> (98/37/EEC-EN 1033/1995).

This machine must not be used on roads or public streets.

## MAINTENANCE

To ensure machine proper and safe operation, the scheduled maintenance shown in the relevant chapter of this manual, must be performed by the authorised personnel or by Viper Service Center.

Carefully read all the instructions before performing any maintenance/repair procedure.

Do not wash the machine with direct or pressurised water jets, or with corrosive substances.

## EXTENSION LEAD

- ▶ As an extension lead, only use the version specified by the manufacturer or one of a higher quality.
- ▶ When using an extension lead, check the minimum cross-sections of the cable:

Cable length	Cross section	
	< 16 A	< 25 A
up to 20 m	1.5 mm <sup>2</sup>	2.5 mm <sup>2</sup>
20 to 50 m	2.5 mm <sup>2</sup>	4.0 mm <sup>2</sup>

## GUARANTEE

Our general conditions of business are applicable with regard to the guarantee.

Unauthorised modifications to the appliance, the use of incorrect brushes and detergents in addition to using the appliance in a way other than for the intended purpose exempt the manufacturer from any liability for the resulting damage.

## TESTS AND APPROVALS

Electrical tests must be performed in accordance with the provisions of safety regulations (BGV A3) and to DIN VDE 0701 Part 1 and Part 3. In accordance with DIN VDE 0702 these tests must be performed at regular intervals and after repairs or modifications.

## ELECTRICAL COMPONENTS



### DANGER

Electric shock due to faulty mains connecting lead.  
Touching a faulty mains connecting lead can result in serious or even fatal injuries.

- ▶ Do not damage the mains power lead (e.g. by driving over it, pulling or crushing it).
- ▶ Regularly check whether the power cord is damaged or shows signs of ageing.
- ▶ Have the faulty mains connecting lead replaced by your Viper service representative or a qualified electrician prior to using the appliance again.



### DANGER

The upper section of the vacuum cleaner contains live components.  
Contact with live components leads to serious or even fatal injuries.

- ▶ Never spray water on to the upper section of the vacuum cleaner.



### CAUTION

Electrical components.  
Damage due to unsuitable mains voltage.  
The appliance can be damaged as a result of being connected to an unsuitable mains voltage.

- ▶ Ensure that the voltage shown on the rating plate corresponds to the voltage of the local mains power supply.



### CAUTION

Electrical connection.

- ▶ Connect the appliance via a residual current circuit breaker.
- ▶ Arrange the electrical parts (sockets, plugs and couplings) and lay down the extension lead so that the protection class is maintained.
- ▶ Connectors and couplings of power supply cords and extension leads must be watertight.

**MATERIALS HAZARDOUS TO HEALTH****WARNING**

Hazardous materials.

Vacuuming up hazardous materials can lead to serious or even fatal injuries

- ▶ The following materials must not be picked up by the vacuum cleaner:
  - liquids
  - hazardous dust
  - hot materials (burning cigarettes, hot ash, etc.)
  - flammable, explosive, aggressive liquids (e.g. petrol, solvents, acids, alkalis, etc.)
  - flammable, explosive dust (e.g. magnesium or aluminium dust, etc.)

**EMPTYING DIRT TANK****CAUTION**

Picking up environmentally hazardous materials.

Materials picked up can present a hazard to the environment.

- ▶ Dispose of the dirt in accordance with legal regulations.

**RISK OF EXPLOSION****WARNING**

Flammable and explosive materials.

Risk of explosion in explosive atmosphere or areas where flammable and explosive materials are stored.

- ▶ Do not operate the machine near dangerous, flammable and/or explosive powders, liquids or vapours.

**SPARE PARTS AND ACCESSORIES****CAUTION**

Non-genuine components and unsuitable detergents.

The use of non-genuine parts and unsuitable detergents can impair the safety of the appliance and lead to damage.

- ▶ Only use spare parts and accessories from Viper.
- ▶ Only use the accessories and detergents supplied with the appliance or those specified in the operating instructions.

## MACHINE DESCRIPTION

### MACHINE STRUCTURE

- |                     |                               |
|---------------------|-------------------------------|
| (1) Carrying handle | (6) Wheel                     |
| (2) On/off switch   | (7) Dirt tank                 |
| (3) Snap handle     | (8) Motor cover               |
| (4) Hose intake     | (9) Mains cord                |
| (5) Casters         | (10) Holder, Combination tool |



SD18-EU



GVD10-EU DV-10



**STANDARD ACCESSORY SET**

- (1) Combination tool
- (2) Upholstery tool
- (3) Dusting tool
- (4) Crevice tool
- (5) Tube
- (6) Filter bag
- (7) Filter basket with cloth filter
- (8) Hose
- (9) Filter

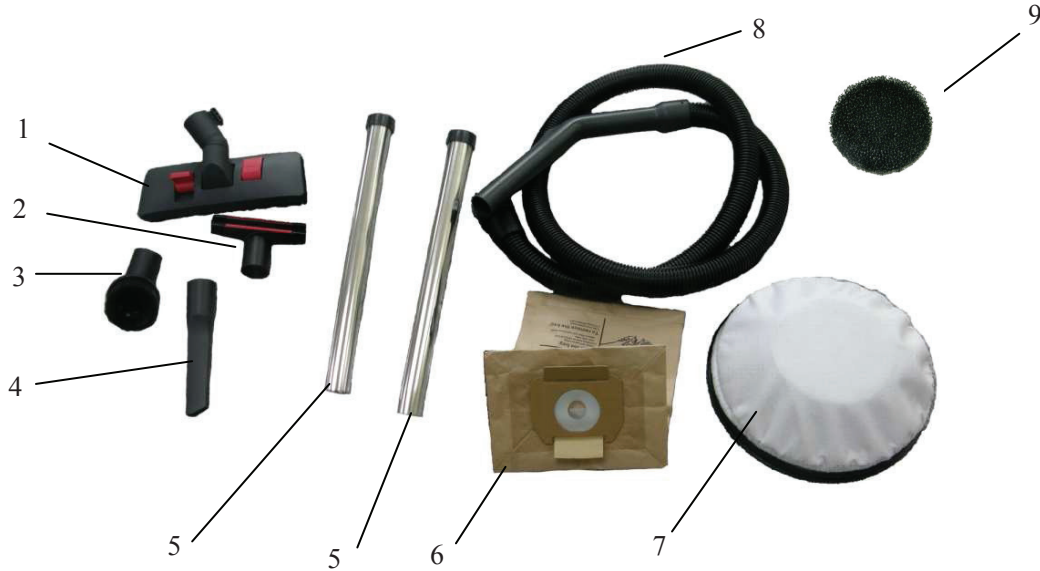

**TECHNICAL DATA**

Model		SD18-EU	GVD10-EU	DV-10 / DV-10-UK
Voltage	V	220-240	220-240	220-240
Power	W	1000	1000	1000
Current	A	4.5	4.5	4.8
Frequency	Hz	50-60	50-60	50-60
Dirt tank volume	L	20	10	10
Vacuum	mm	2032	2032	2159
Flow rate	l/min	3398	3398	3036
Sound pressure level at workstation	dB(A)	59	61	65
Weight	kg	10	8.6	8.5
Length of Power cord	m	10	10	10

**WIRING DIAGRAM FOR SD18-EU / GVD10-EU**

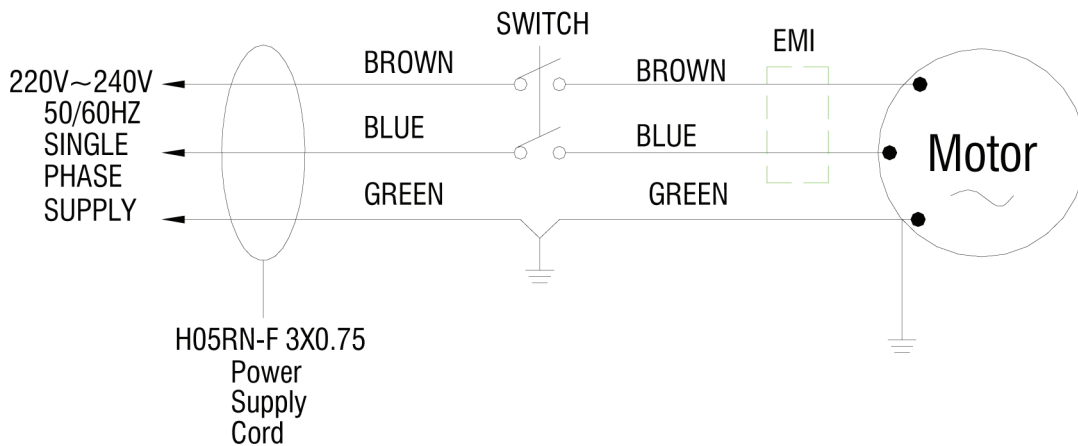

## OPERATION

### BASIC OPERATION

- ▶ Never use the vacuum cleaner without the cloth filter.
- ▶ Before picking up dry substances, the bag-type filter should always be installed in the tank.



- ▶ Check that the vacuum cleaner is switched off.
- ▶ Check that there is either a cloth filter or a paper filter inserted in the dirt tank.
- ▶ Connect the suction hose.

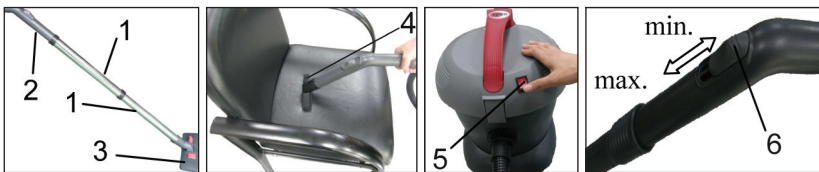

- ▶ Connect the tubes (1) with the hose handle (2), twist the tubes in order to ensure that they are properly fitted.
- ▶ Attach a suitable nozzle (3) to the tube. Choose the nozzle depending on the type of material that is to be picked-up. Upholstery and difficult to reach areas can be vacuumed with an upholstery tool (4), a dusting tool or a crevice tool.
- ▶ Insert the power cord into a properly installed and fused socket with earthing contact. Do not use an extension cord in conjunction with the standard power cord.
- ▶ Put the on/off switch (5) into position "I" in order to start the motor.
- ▶ With the mechanical suction control (6) on the upper part of the suction tube, the suction power can be adjusted to the type of surface to be vacuumed.
- ▶ Immediately switch off the appliance, if an obstruction is noticed (generally indicated by reduced suction power).
- ▶ Check the filling level of the paper filter bag.
- ▶ Check nozzle, suction tubes and suction hose for blockage.

## MAINTENANCE

- ▶ To keep the machine performing well for many years, please follow the following maintenance procedures.



### CAUTION!

Always confirm that the machine is unplugged prior to performing any maintenance or repairs.

- ▶ Unplug machine as soon as you are not using it.
- ▶ Lubricate wheels with a water resistant lubricant once a month.
- ▶ Check machine for loose or missing nuts and bolts, and replace as necessary.
- ▶ Check the filter and clean it after each use.
- ▶ Remove the vacuum hose and check it for any holes and clogs.
- ▶ Clean the outside of the machine, accessories and power cord with a damp cloth after use.

### EMPTYING THE DIRT TANK

Empty the dirt tank when you notice that the performance is reducing.



- ▶ Switch off the appliance.
- ▶ Pull the mains plug out of the socket.
- ▶ Press the snap handle (1) upward and remove the upper section of the vacuum cleaner (2).
- ▶ Remove the filter basket with the cloth filter (3). Clean the cloth filter or wash it at 30°C.

### REPLACING THE FILTER BAG

Check the filter bag periodically for filling level. For optimal performance, replace the filter bag when it is 2/3 full.



- ▶ Switch off the appliance.
- ▶ Pull the mains plug out of the socket.
- ▶ Press the snap handle (1) upward and remove the upper section of the vacuum cleaner (2).
- ▶ Unfold the new filter bag (1) and pull the rubber flange over the hose socket.
- ▶ Reinsert filter basket with cloth filter.
- ▶ Attach the upper section of the vacuum cleaner.
- ▶ Press the carrying handle down until the snap handle audibly clicks into position.

## REPLACING THE AIR FILTER

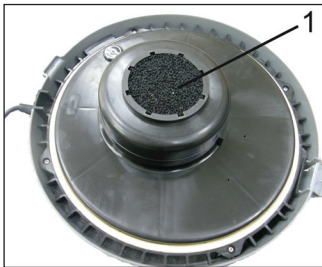

- ▶ Periodically clean the air filter (1), never reinsert if wet. After 10 paper filter bags have been used, replace the air filter.

## STORAGE

- ▶ Switch off the appliance.
- ▶ Pull the mains plug out of the socket.

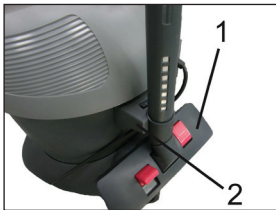

- ▶ SD 18 only: Attach the combination tool (1) to the holder (2).
- ▶ Store the appliance in a dry place, protected from frost.
- ▶ The machine storage temperature must be between 0°C and +40°C.

## RECYCLING THE CLEANER

- ▶ Make the old cleaner unusable immediately:
  - ▶ Unplug the cleaner.
  - ▶ Cut the power cord.
- ▶ Do not discard of electrical appliances with household waste.



As specified in European Directive 2002/96/EC on old electrical and electronic appliances, used electrical goods must be collected separately and recycled ecologically. Contact your local authorities or your nearest dealer for further information.



Company information:  
[www.vipercleaning.eu](http://www.vipercleaning.eu)  
[info-eu@vipercleaning.com](mailto:info-eu@vipercleaning.com)

