



Aquaglide



Owner's Manual



Stop! Read this manual carefully before using this product!

Product	Maximum Capacity	Maximum Suggested Weight Load
MALIBU Island™	Ten (10)	1650 lbs. (748 kg)

Contents:

MALIBU Island™ – (1) MALIBU Island™ tube, (1) Repair Kit

Watersports Safety Code

Watersports are fun and challenging but involve inherent risks of injury or death. To increase your enjoyment of the sport and to reduce your risks, use common sense and follow these rules:

Before you start:

- Familiarize yourself with all applicable federal, state, and local laws, the risks inherent in the sport, and the proper use of the equipment.
- Know the waterways.
- Use caution and common sense.
- Do not use within 3,0m (10ft.) of boats, docks, pool edge or other hard obstructions.
- Do not attempt or allow somersaults. Landing on the head or neck can cause serious injury, paralysis or death.
- Never use at night, or in low-light conditions.
- Never use in poor weather conditions, excessive wind, waves or lightning.
- Do not use on dry land.
- Do not use without proper anchoring.
- Never swim under the product.
- Take extreme care when swimming between the shore and the product. Be cautious of any boat traffic or other obstructions. Ensure all users are capable swimmers and are not excessively fatigued. Do not allow anyone to attempt to swim to or from the product that are not physically able to do so.
- Always ensure that the swimming area around the product is free of submerged logs, rocks and sandbars. Ask about the local water conditions before use.
- Only allow use of the product with proper supervision. Secure the product when not in use to prevent access by any other users.
- Do not jump or dive from this item.
- Do not jump onto this item from any other item.
- Do not use in water where there are sharks or other animals that could pose a threat to humans.
- If product is used indoors, always ensure adequate ceiling height overhead.
- Always remove personal items such as rings, watches or other sharp objects before use.

Your equipment :

- Check all equipment prior to use. Inspect your product for missing, defective or worn parts. Never use the product if excessive wear or damage are detected.
- Always check for proper inflation before each use. Temperature and environmental changes can cause changes in tube pressure. Using the product over or under inflated is dangerous and can cause damage to the product, voiding the warranty.
- Always check security of the anchor(s) and all attachments before each use.

It is the owner's responsibility to read the owner's manual and instruct all users in the safe operation of these products. By inflating these products you hereby agree to the Release of Liability, Claim Waiver, and Assumption of Risk Agreement in this manual. Please read this manual prior to inflating and using these products and keep for future reference. As with any action sport, recklessness, inexperience, misuse, or neglect of the equipment may result in serious injury or death.

WARNING

USE OF THIS PRODUCT AND PARTICIPATION IN WATERSPORTS INVOLVES INHERENT RISKS OF INJURY OR DEATH.

- This product should never be used by children except under adult supervision.
- Not intended for use by children under 5 years of age.
- This product is not a personal flotation device.
- Always wear a floatation vest (PFD) as required by the authorities in area of use.
- Never place wrists or feet through handles, straps or rings.
- Do not use in water less than 48in (1,21m) deep.
- Do not use within 10ft (3,0 m) of docks, pilings, boats or other hard objects.
- Never swim under the product.
- Do not jump or dive from this product.
- Do not exceed the manufacturer's recommended number of users for your particular product.
- Do not use while under the influence of alcohol or drugs.
- Read Operator's Manual before use.

Made in China

CAUTION

Watersports can be safe and fun for all levels of enthusiasts. The Operator's Manual is presented to enhance your enjoyment of the sport. It is intended to alert you to some of the potentially dangerous conditions that can arise in all watersports. It is the owner's responsibility to read the owner's manual and instruct all users in the safe operation of these products. By inflating these products you hereby agree to the Release of Liability, Claim Waiver, and Assumption of Risk Agreement in the Owner's Manual.

To reduce the risk of injury or death, follow these guidelines:

- Carefully read the product Owner's Manual and follow the instructions.
- Take all reasonable precautions in the use and operation of your trampoline and/or aquapark.
- Teach anyone using your trampoline and/or aquapark about safe guidelines prior to use.
- Know your own limits. Stop when you are tired. Act responsibly. Be in good physical condition and be cautious in your use of this or any other water sports product.
- Periodically check mooring bridle and/or lines to ensure safety. Replace any portion of mooring and/or connection system that shows signs of wear.
- Do not add any hardware or attachments not otherwise supplied by the manufacturer.

THE WARNINGS AND PRACTICES SET FORTH ABOVE REPRESENT SOME COMMON RISKS ENCOUNTERED BY USERS AND DOES NOT PURPORT TO COVER ALL INSTANCES OF RISK OR DANGER. PLEASE USE COMMON SENSE AND GOOD JUDGMENT.

Please contact the dealer or manufacturer of this product if you have any questions about proper selection, function, or safe use of this product.

Made in China

- Always wear a life vest (PFD) as required by the authorities in area of use.

THE WARNINGS AND PRACTICES SET FORTH ABOVE IN THE WATERSPORTS SAFETY CODE REPRESENT SOME COMMON RISKS ENCOUNTERED BY USERS. THE CODE DOES NOT PURPORT TO COVER ALL INSTANCES OF RISK OR DANGER. PLEASE USE COMMON SENSE AND GOOD JUDGMENT.

Please contact us if you have any questions on the proper selection, function, or safe use of this product.

Assembly

1) Locate a flat, dry area with access to electrical outlet or extension cord. The best setup position will also make launching easy, so ideally the MALIBU Island™ should be carefully carried into position at the water's edge. NOTE: Dragging or sliding the MALIBU Island™ over ground, either before or after inflation, can cause damage.

2) Once in the setup/ launch position, unfold the MALIBU Island™ completely and locate the Main Valve. The Main Valve is a Rapid Inflate type and is located near the product warnings, and opposite the boarding area. If necessary, unscrew the valve cap to ready the valve. If open, close the Valve Flap by pushing it to the inside of the valve. See Valve Diagram for details.

3) Using a high output inflator/deflator, place the inflation hose with Rapid Inflate adaptor into the valve. Inflation times can vary by inflator, but the tube should be moderately firm when completely inflated. **DO NOT OVER-FILL. Inflate to 0.8 psi (0,07 bar)** or until tube is just firm enough to walk on. NOTE: In hot weather, be sure to leave room for air expansion. Check for proper air pressure using a manometer, if necessary. The valve's one-way flap will stop the outflow of air. Press the Valve Flap inward briefly to release some air. Close the valve by securing the valve cap.

WARNING: Do not use an air compressor to inflate tube. Air compressors are designed for high pressure inflation and can cause tube to burst if over-inflated.

4) MALIBU Island™ can be used as a stand-alone item, or joined with MALIBU Aquapark™ to add terrain. If you have purchased MALIBU Aquapark™, connect it now using the instructions provided with that item. NOTE: DO NOT attach any items not otherwise supplied by the manufacturer specifically for this purpose.

5) To launch the product, make sure to have at least 2 people evenly spaced around the product to help carry it.

NEVER DRAG THE PRODUCT! YOU MUST LIFT AND SET THE MALIBU Island™ IN THE WATER TO AVOID ANY ACCIDENTAL TEARING AND/OR ABRASION.

Anchoring

IMPORTANT: Proper anchoring is essential to the safety and performance of your product. If improperly anchored, the product can move and/or float away. Aquaglide, Inc. is not responsible for any damage, injuries or losses due to improper anchoring.

The MALIBU Island™ is designed for short-term anchoring and day-use. Leaving the product in the water for extended periods of time may create a safety hazard and/or reduce the expected lifespan of the product.

There are several rope holder fittings permanently welded below the water-line of the MALIBU Island™. These fittings are used to connect the MALIBU Aquapark™, and are also for anchoring. We recommend connecting the anchor line to at least 2 of these fittings. DO NOT connect the anchor line to boarding handles, as these are not designed for anchoring.

Here are some general guidelines for anchoring your product. These guidelines are not intended to replace the need for professional installation.

1) Choose a location for your MALIBU Island™. Place the product in **at least 4 ft. (1,2m)** of water depth, in an area protected from the wind, current and boat

Owner's Manual

Valve Diagram

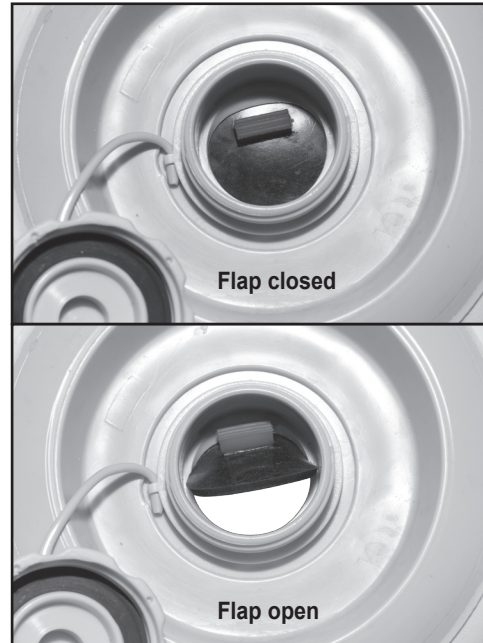

Boarding Area

traffic. Review rules and restrictions with your local authorities.

2) Carefully check the water and seabed below the selected area for sharp or dangerous objects (i.e. rocks or stumps).

3) Keep a safe distance of at least 10ft. (3,0m) away from docks, boats, boat lifts, pool edges or any other structures.

IMPORTANT: DO NOT tie the product to a dock. Users could be injured by contact with hard structures, and/or the product could be damaged by abrasion.

4) Anchors and anchor line are sold separately. We recommend a MINIMUM of 30 lbs. for short-term anchoring of the MALIBU Island™ in settled conditions. Heavier moorings should be used in the presence of breeze, current, and/or multiple users.

5) If strong winds or storms are expected, remove the product from the water, secure and/or deflate it.



Operation

- 1) This item is intended for use as a soaking lounge in shallow, protected waters.
 - 2) When connecting MALIBU Aquapark™, use only specifically designed Aquaglide straps and connecting rings according to the instructions provided. Make sure that the connection is tight and that there is NO GAP between items. **IMPORTANT:** Failure to connect these items properly may result in injury or death.
 - 3) Do not exceed the product's maximum number of users or capacity. Be reasonable in the use of this product. Do not allow more than 2 users to stand on the mesh floor at once (maximum standing weight 400 lbs. [181kg]).
- IMPORTANT:** The product is NOT designed to support the maximum number of users or the maximum capacity solely on the mesh floor. Excessive jumping, roughhousing on and/or overloading of the mesh floor may cause failure that is not covered by warranty.
- 4) **USE COMMON SENSE.** Never dive from the product. Do not jump from the product while in shallow water. Do not stand on the top deck of the product because motion could cause a loss of balance and injury.
 - 5) Ensure that all swimmers have cleared the area before entering the water. Never swim underneath the product.
 - 6) If the product shows any signs of instability or appears to have lost air pressure, immediately discontinue use. Check and monitor moorings, air pressure and air-holding ability. Do not continue use until these are confirmed.

Care and Maintenance

- 1) While your product has been initially treated with UV protectant, long-term exposure to sunlight will damage the product. Regularly apply a UV protectant to the exposed surface of the tube to ensure the life of your product. We recommend using 303 UV Protectant intended for use on vinyl for this purpose. Monthly application while the product is in use is recommended. 303 UV Protectant is available at most watersports dealers, or online at www.303-products.com.
- 2) **WARNING:** Certain products, especially petroleum-based solvents, cleaners and protectants such as ArmorAll can damage the product and use of these products will void the warranty.
- 3) **WARNING:** Use of a high-pressure washer will damage the product and void the warranty. To clean, use a soft sponge with mild soap and fresh water. 303 UV Protectant contains a 'safe for vinyl' cleaner, and can be used to clean and protect the product at the same time.
- 4) Check the inflation of your tube often. Check for proper air pressure using a manometer, if necessary. It may appear to have lost air early in the morning, but will expand once the sun warms it. Maximum expansion will occur in the heat of the day. Proper inflation is critical to the safe operation of your product and will prolong damage from wear.

Storage

- 1) Before storing, place the product on a clean, level area and remove all attachments. Clean with mild soap and water and allow to dry completely. This is a good time to apply 303 Protectant to the surface of the product before deflating.
- 2) To deflate, unscrew the Main Valve Cap to access the Valve Flap. For complete deflation, open the Valve Flap using a forefinger to reach inside the valve and pull the flap toward the outside. See Valve Diagram for details. This allows the air to flow out freely. Remove all air from the tube using the deflation end of the high output inflator/deflator.
- 3) Fold the deflated tube in fourths then roll or fold toward the valve. This pushes any remaining air out toward the valve.
- 4) Store the product out of direct sunlight and protected from the environment in a clean, dry location. It is best to store inside a container to prevent damage from rodents. NEVER store uncovered, in a damp location, or on a concrete surface! NEVER store at temperatures below 40 degrees F.



NOTICE! - Release of Liability, Claim Waiver, and Assumption of Risk Agreement

By opening and assembling this product, you are agreeing (1) to be bound to the terms set forth below and (2) to require anyone using this product to be bound by such terms. If you are unwilling to be bound by these terms, return this product (before use) for a full refund.

ASSUMPTION OF RISK: Use of this product and any of its components involves certain inherent risks, dangers, and hazards which can result in serious personal injury and death. In using the product, you freely agree to assume and accept any and all known and unknown risks of injury while using this equipment. The risks inherent in the sport can be greatly reduced by abiding by the Warning Guidelines listed in this Owner's Manual and by using common sense.

RELEASE AND WAIVER OF CLAIMS AGREEMENT: In consideration of the sale of the product to you, you hereby agree to the fullest extent permitted by law as follows:

TO WAIVE ANY AND ALL CLAIMS that you have or may in the future have against North Sports Inc., and Aquaglide Inc., its distributors and dealers, resulting from use of this product and any of its components.

TO RELEASE North Sports, Inc. and Aquaglide, Inc. from any and all liability for any loss, damage, injury, or expense that you or any users of this product may suffer, or that your next of kin may suffer, as a result of the use of this product, due to any cause whatsoever, including negligence or breach of contract on the part of North Sports Inc. and Aquaglide Inc. in the design or manufacture of this product and any of its components.

ARBITRATION: In further consideration of the sale to you of this product and any of its components, you hereby agree to submit to binding arbitration any and all claims which you believe you may have against North Sports Inc. and Aquaglide Inc. arising from the use of any North Sports Inc. and Aquaglide Inc. equipment or products. The arbitration shall be pursuant to the rules of the American Arbitration Association. Arbitration shall be commenced within (1) year from the date on which any alleged claim first arose. Further, the arbitration shall be held in White Salmon, Washington unless otherwise mutually agreed to by all parties. The submission to the American Arbitration Association shall be unlimited and the arbitration award may be enforced by any Court of competent jurisdiction.

BINDING EFFECT OF AGREEMENT: In the event of your death or incapacity, this Agreement shall be effective and binding upon your heirs, next of kin, executors, administrators, assigns, and representatives.

ENTIRE AGREEMENT: In entering into this Agreement, you are not relying upon any oral or written representations other than what is set forth in this agreement and the North Sports Inc. and Aquaglide Inc. Owner's Manual.

Warranty

Aquaglide, Inc. warrants products to be free of defects in material or workmanship to the original purchaser for a period of One (1) year from date of purchase. This warranty is subject to the following limitations:

1. Warranty is valid only with dated proof of purchase in the form of the original invoice.

2. Warranty is valid only when the product is used for normal recreational activities, and does not cover use in schools, rental operations or any type of commercial use.

3. Aquaglide will make the final warranty determination which may require inspection and/or photos of the product which clearly show defect(s). We require the above be sent to another location of our choice, freight prepaid, or by email to support@aquaglide.com.

4. If a product is deemed to be defective by Aquaglide, the warranty covers the repair or replacement of the defective product only. Aquaglide will not be responsible for any costs, losses, or damages incurred as a result of loss of use of product.

5. This warranty does not cover damage caused

by misuse, abuse, neglect, or normal wear and tear, including, but not limited to, punctures, dragging the product over the ground, damage due to excessive sun exposure or seam failure due to overinflation in the sun, damage caused by improper handling and storage, damage caused by use in waves or shore break, and damage caused by anything other than defects in materials and workmanship.

6. This warranty is voided if any unauthorized repair, change, or modification has been made to any part of the equipment. Authorization for such must come in writing from Aquaglide.

7. The warranty for any repaired or replacement equipment is good from the date of the original purchase only.

8. Any warranty claims must be accompanied by the original purchase receipt. The name of the retailer and date of purchase must be clear and legible.

9. There are no warranties which extend beyond the warranty specified here.

Returns and Service Policy

Product can be returned only if a return autho-

rization number (RA) is given by Aquaglide in advance. The RA number must be on the outside of the package or it will not be accepted at our warehouse. Freight on the returned product must be prepaid or it will not be accepted. Upon receipt, Aquaglide will make a determination within (30) days. If the product is covered under warranty it will be returned to the customer at the expense of Aquaglide, Inc. after repairs can be made. If not, the customer will receive a quote for repair and/or replacement as well as any necessary cleaning and shipping charges. The customer will have 30 days to accept the quotation. At the end of 30 days, or upon refusal of the quote, Aquaglide will return the product in the condition in which it was received at the customer's expense. The customer agrees to authorize Aquaglide, Inc. to charge the customer's credit card for any costs not covered under the terms and conditions of the Aquaglide Warranty.

Serial Number

All Aquaglide Platinum products are marked with a serial number near the main inflation valve (#1). The serial number may be stamped into the PVC directly around the valve, or it may be visible on a welded plate near the valve. Please include this number when you contact Aquaglide, or your dealer, with any warranty claim.