

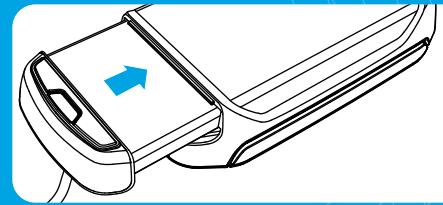

Check contents

1. Vscan with probe
2. Docking station
3. USB 2.0 cable
4. Storage microSD card (Already installed in Vscan)
5. Battery
6. AC/DC converter & Adapter plugs
7. Quick card
8. Ultrasound gel
9. Soft case
10. CD-ROM Vscan gateway software
11. CD-ROM user manual
12. microSD card with factory SW (In a sealed envelope)
13. Global ultrasound support center phone number list

2 Insert battery



3 Charge battery

1. Select plug
2. Mount

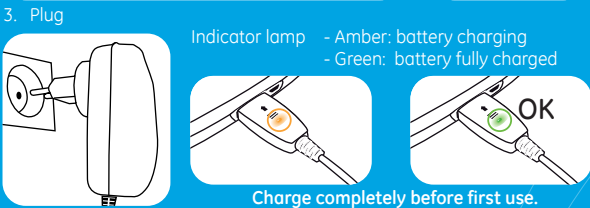
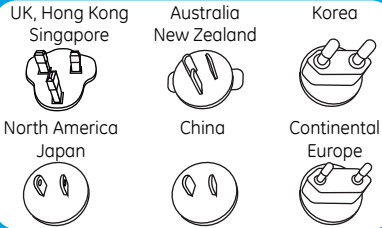

4 Connect

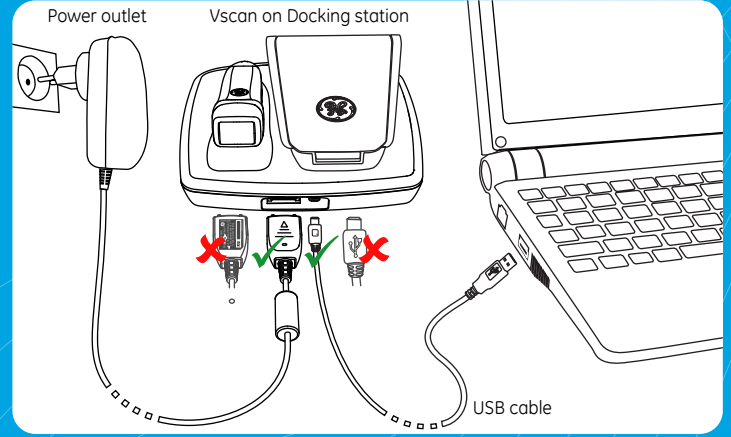

5 Activate Vscan & Vscan gateway software

Follow one of the three scenarios below.

Scenario 1

You have a computer with Internet access and you can install the software on the computer.

- 1) Install Vscan gateway software.
- 2) Dock Vscan and open the display.
- 3) Start Vscan gateway software (icon on desktop)
- 4) Follow instructions on screen to activate Vscan and Vscan gateway software.
- 5) Perform Vscan configuration (see below).

See "Online activation" in the user manual for more details.

Scenario 2

You have a computer without Internet access but you can install the software on the computer.

- 1) Install Vscan gateway software.
- 2) Dock Vscan and open the display.
- 3) Start Vscan gateway software (icon on desktop)
- 4) Call your local GE Service contact (see "Global ultrasound support center phone numbers" included with your Vscan or in the user manual).
- 5) Follow instructions provided by GE Service to activate Vscan and Vscan gateway.
- 6) Perform Vscan configuration (see below).

See "Offline activation" in the user manual for more details.

Scenario 3

Vscan activation only when NOT installing the software.

If no Internet access:

- 1) Call your local GE Service contact to get the activation key (see "Global ultrasound support center phone numbers" included with your Vscan or in the user manual).
- 2) Perform Vscan configuration and insert the activation key (see below).

If you have Internet access:

- 1) Go to <http://vscan.gehealthcare.com>.
- 2) Click on "Owners" then "Activation form".
- 3) Fill in the form to retrieve the Vscan activation key.
- 4) Perform Vscan configuration and insert the activation key (see below).

See "Activation of the Vscan without Vscan gateway software" in the user manual for more details.

Vscan configuration

1. Select language.
2. Adjust time.
3. Adjust date.

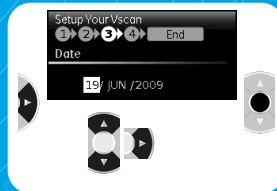
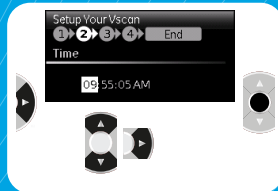

Vscan Activation key

1. Insert Activation key.

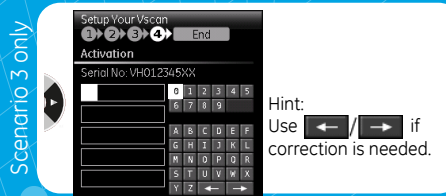

Battery

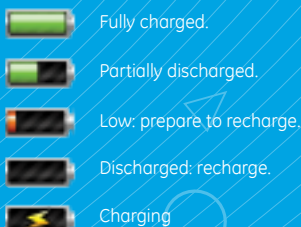

MicroSD card



Menu

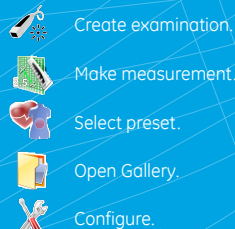

United States law restricts this device to sale or use by or on the order of a physician.

Read and understand the user manual before using the Vscan.

Contraindication: The Vscan ultrasound unit is not intended for ophthalmic use or any use causing the acoustic beam to pass through the eye.





Scanning

Start Apply gel Scan Depth Auto-optimize Freeze / Unfreeze

Start Color Color Gain Stop Color

Presets Press Menu Select Presets menu Select preset

Voice notation Start recording Record Stop recording Press any key

Review & Store

Scan Freeze Select frame Play (Pause) Store Still frame Video Direct Store Video

Measure

Press Menu Select Distance Place first point Place second point Store Return to scanning

Gallery

Press Menu Select Gallery Select exam Select file Review other files in exam Return to scanning