



# Pure Fun Race Car Jumper Trampoline



## USER MANUAL

Model No.  
9020CT

### Age Recommendation: **4 - 10**

Do not allow more than one person on this product at any time.  
Adult supervision is required.  
ADULT ASSEMBLY REQUIRED.

Please visit [www.pureglobalbrands.com](http://www.pureglobalbrands.com) to register your product to ensure warranty coverage.

Please read all the instructions before using this product. Consult a physician before beginning any exercise program or strenuous activity.



#### WARNING

The contents of this package are not suitable for children under 3 years of age. Contains small parts which may cause choking.

**75 LBS MAXIMUM WEIGHT RATING**



Pure Fun is a Trademark  
of Pure Global Brands, Inc.

Customer Service



1 866 498 5269



[customerservice@puregbi.com](mailto:customerservice@puregbi.com)



# **IMPORTANT MESSAGE**

PLEASE READ

## **WARNING**

**CHOKING HAZARD** - Small Parts  
**NOT** for children under 3 year of age.  
**ADULT ASSEMBLY REQUIRED**

## **WARNING**

While every attempt is made to ensure the highest degree of protection in all equipment, we cannot guarantee freedom from injury. The user assumes all risks of injury due to use. All merchandise is sold on this condition, which no representative of the company can waive or change.



# USER MANUAL

## CUSTOMER SERVICE INFORMATION

Thank you for purchasing our **Pure Fun™ Race Car Jumper Trampoline**

At Pure Global Brands, we want all of our customers to be completely satisfied with their purchase. Please take time to review the contents of the product you have just received to make sure that all of the parts are included. If you find that any parts are missing or damaged, we will happily provide replacement parts at no charge within 30 days of purchase. Please keep in mind that for select damaged part replacement requests, we will require a photo for submission to our quality control office.

To order these parts, or if you have any other questions or concerns about this Pure Global product, please e-mail the Pure Global Brands, Inc. customer service department at: [customerservice@puregbi.com](mailto:customerservice@puregbi.com) or contact us at 1-866-498-5269. You can also visit our website at: [www.pureglobalbrands.com](http://www.pureglobalbrands.com)

*If you request replacement parts, please be sure to include the following information in your correspondence:*

**YOUR NAME**

**YOUR MAILING ADDRESS**

**YOUR EMAIL ADDRESS**

**RETAILER WHERE YOU PURCHASED PRODUCT**

**DATE OF PURCHASE**

**ORDER # (IF AVAILABLE)**

**PRODUCT MODEL #: 9020CT**

**SERIAL #**

**PRODUCT NAME: Race Car Jumper Trampoline**

**PART # (located in manual)**

**QUANTITY NEEDED**

**PICTURE OF DAMAGED PART(s) – SUBMIT VIA Email , Fax, or Mail**

Again, thank you for purchasing a Pure Global Brands product.

Sincerely,

Customer Service

Pure Global Brands, Inc.

Phone: 1-866-498-5269

Email: [customerservice@puregbi.com](mailto:customerservice@puregbi.com)

8040 Belvedere Rd.

West Palm Beach, FL 33411



# LIMITED WARRANTY

Pure Global Brands, Inc. warrants this product to be free from defects in workmanship and materials under normal use and conditions for the duration of the period outlined below FROM THE DATE OF ORIGINAL PURCHASE. This Limited Warranty is not transferable and is available only for the original purchaser of the Product.

The various components of the trampoline/enclosure are warranted against defects and workmanship for the following time period(s):

- **Steel Frame: 2 Years**
- **All Other Parts: 90 Days**

All warranty coverage extends only to the original retail purchaser from the date of purchase. Pure Fun's obligation under this Warranty is limited to replacing or repairing, at Pure Fun's option, the product at one of its authorized service centers. All products for which a warranty claim is made must be received by Pure Fun at one of its authorized service centers and accompanied by sufficient proof of purchase (photocopy of the original store receipt, indicating the date of purchase). All freight and handling fees are the responsibility of the consumer to pay, both to and from Pure Fun. All warranty claims must be pre-authorized by Pure Fun. Pre-authorization can be obtained by calling 866-498-5269. This warranty does not extend to any product or damage to a product caused by or attributable to freight damage, abuse, misuse, improper or abnormal usage, or repairs not provided by a Pure Fun authorized service center or for products used for commercial or rental purposes. This warranty does not cover ordinary wear and tear, weathering, failure to follow directions, improper installation, improper maintenance or acts of Nature (such as damage caused by wind, lightning, snow, water or ice). Weather damage, damage caused by unauthorized repair work or damage caused by improper use of the products are not covered by the product warranty. No other warranty beyond that specifically set forth above is authorized by Pure Fun.

**PURE FUN IS NOT RESPONSIBLE OR LIABLE FOR INDIRECT, SPECIAL OR CONSEQUENTIAL DAMAGES ARISING OUT OF OR IN CONNECTION WITH THE USE OR PERFORMANCE OF THE PRODUCT OR OTHER DAMAGES WITH RESPECT TO ANY ECONOMIC LOSS, LOSS OF PROPERTY, LOSS OF REVENUE OR PROFITS, LOSS OF ENJOYMENT OR USE, COST OF REMOVAL, INSTALLATION OR OTHER CONSEQUENTIAL DAMAGES. SOME STATES DO NOT ALLOW THE EXCLUSION OR LIMITATION OF INCIDENTAL OR CONSEQUENTIAL DAMAGES. ACCORDINGLY, THE ABOVE LIMITATION MAY NOT APPLY TO YOU. THE WARRANTY EXTENDED HEREUNDER IS IN LIEU OF ALL OTHER WARRANTIES AND PURE FUN SPECIFICALLY DISCLAIMS ANY IMPLIED WARRANTY OF MERCHANTABILITY OR FITNESS FOR A PARTICULAR PURPOSE IS LIMITED IN ITS SCOPE AND DURATION TO THE TERMS SET FORTH HEREIN. SOME STATES DO NOT ALLOW LIMITATION ON HOW LONG AN IMPLIED WARRANTY LASTS. ACCORDINGLY, THE ABOVE LIMITATION MAY NOT APPLY TO YOU.**

This warranty gives you specific legal rights. You may also have other rights, which vary from state to state.





# WARNINGS

## IMPORTANT PLEASE READ!

Please read these warnings and the information in this manual in its entirety. Failure to comply with the following instructions may increase the risk of serious injury and/or death:

- This unit must be assembled and disassembled by **ADULTS ONLY**.
- This Trampoline is suitable for use by most children 4 to 10 YEARS OF AGE.
- **DO NOT** exceed the **MAXIMUM WEIGHT** limit of 75lbs (35kgs) regardless of age.
- **FOR INDOOR HOME USE ONLY:** This Trampoline is designed for indoor family residential use. It is **NOT** intended for use outdoors, or in commercial applications and/or use in public areas such as schools, parks, nurseries, day schools, day cares, etc.
- **ALWAYS** locate this equipment on a stable, level surface **AT LEAST 7 feet** away from any structure, obstruction, or possible hazard(s) such as walls, pools, power lines, overhangs, other playground equipment, driveways, hard surfaces and/or roadways.
- Children must be supervised at all times when using this equipment. **DO NOT** leave children unattended at any time.
- **DO NOT** attach items to the trampoline not specifically designed for this purpose. Especially in the case of jump ropes, chains, clotheslines, pet leashes and cables. These may cause a strangulation or physical hazard.
- This Trampoline is **NOT** for adult or adolescent use.
- **DO NOT** allow more than one child on the Trampoline at any time.
- **DO NOT** allow children to wear glasses or helmets when using the Trampoline.
- **DO NOT** allow the padding cover of this trampoline to become wet. If accidental spillage occurs, immediately blot this with a moist paper towel and allow to dry.
- **DO NOT** allow children to wear loose fitting clothing, clothing with straps/loops, backpacks or wear and/or hold accessories with straps or loops, or any article of clothing or accessory with sharp edges which may present a hazard or become snagged or caught on the Trampoline during use. Serious injury and/or accidental strangulation may occur.
- **DO NOT** place objects on or under the trampoline, or allow people and pets to stand or sit on, near or under the unit.
- **DO NOT** allow children to sit or stand on the frame pad edge or attempt to hang or swing from the hand rail – this presents a tipping hazard and can cause serious injury.
- Never allow a child to jump from or onto this trampoline from any other object or surface area.
- Children must **ALWAYS** jump while securely centered on the Trampoline mat. It is recommended that children always keep a firm grip on the handrail during exercise.
- **DO NOT** store this item outside, or in extreme humidity or temperatures.
- **ALWAYS** secure the Trampoline against unauthorized and unsupervised use.
- It is not recommended that this trampoline is used while wearing shoes. Additionally, children should always wear socks when jumping to prevent injury to feet.
- Before each use of this product, inspect this unit for any worn, defective or missing parts. Although this Trampoline is made to take a lot of wear, over time parts may need to be replaced. It is important to check the unit to ensure the Springs, Frame, Padding and Safety Skirt are undamaged and secure and all parts are in good condition. If any loose, cracked, missing, or otherwise damaged components are found, cease use of this item immediately and secure it from unauthorized use until the issue has been corrected and/or replacement parts obtained. Failure to do so may result in injury and/or void your warranty.
- Please read and refer to other warnings and use information in the Trampoline instructions before use.

**Dispose of all packaging materials safely and per local ordinance.**



Please visit: [www.pureglobalbrands.com](http://www.pureglobalbrands.com) for any important product information updates and/or additional safety warnings before assembling or using this product.

Use search word: **9020CT**

## PRIOR TO ASSEMBLING

When you are ready to start, make sure that you have the correct tools at hand, and adequate space for assembly. Please refer to the following pages for part descriptions and numbers. The assembly instruction uses these descriptions and numbers as reference. Make sure you have all parts listed. If you are missing any parts, contact customer service at: [customerservice@puregbi.com](mailto:customerservice@puregbi.com) or by calling 1-866-498-5269 (9am-5pm, M-F).

**IMPORTANT: USE GLOVES TO PROTECT AGAINST PINCH POINTS DURING ASSEMBLY.**

**Enclosed are the current specifications and product features available at time of printing, however, changes may be made in equipment, availability, specifications and features without notice.**

**Tools Required (Included): Spanner Wrench, Allen Wrench, Spring Tool.**

## PARTS LIST (Trampoline)

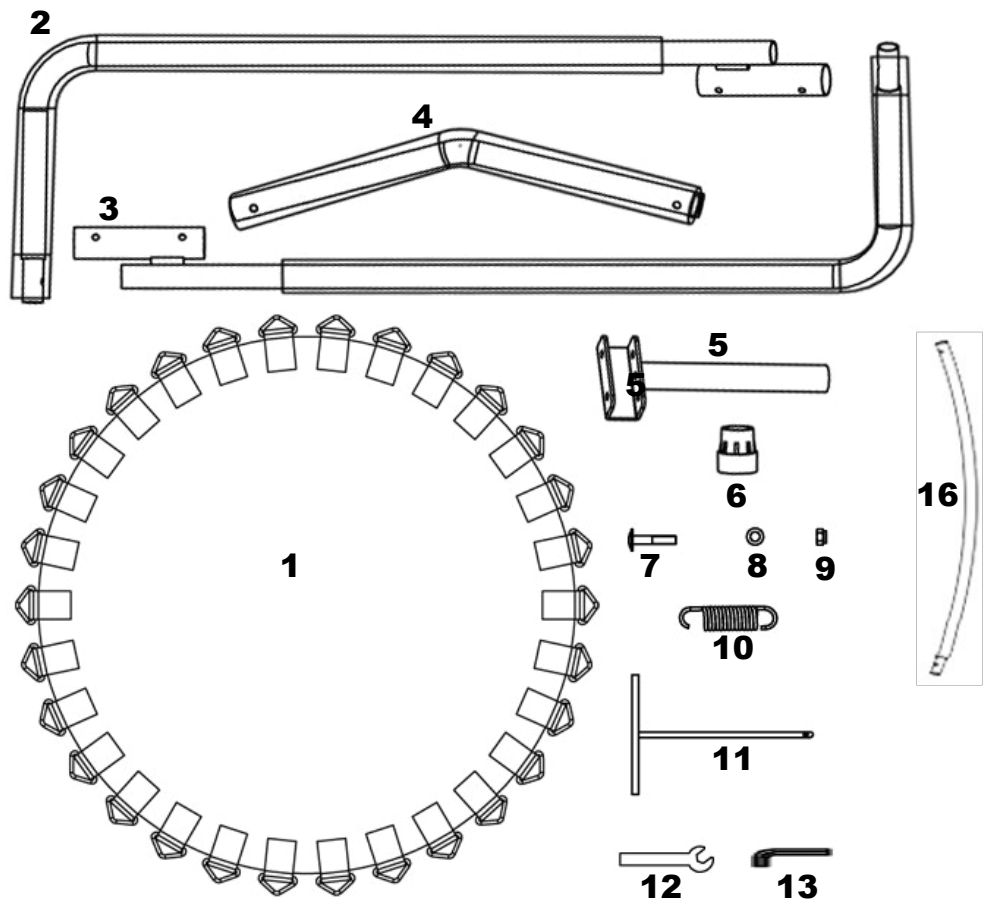

# TRAMPOLINE EXPLODED VIEW

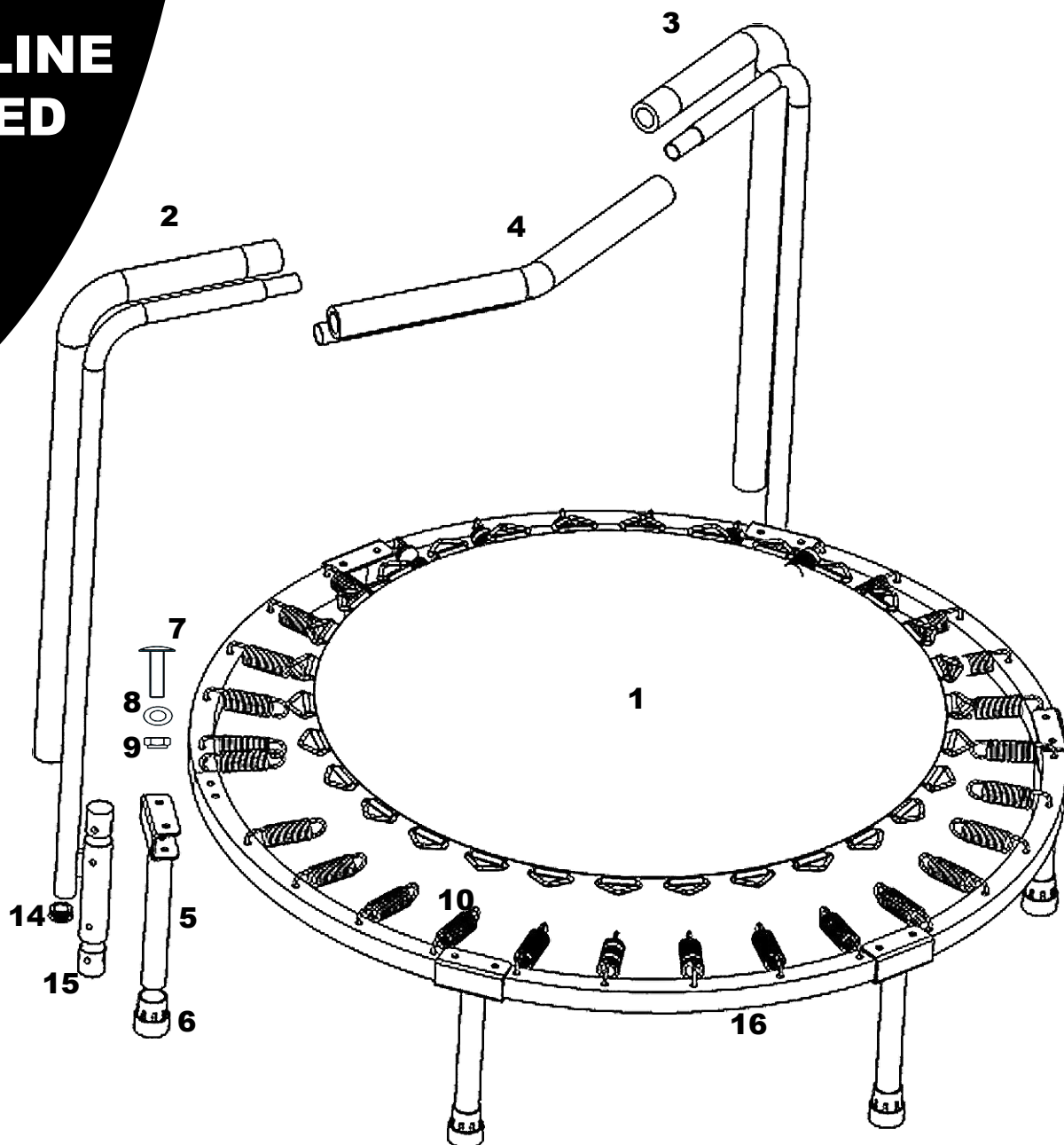

Part No.	Description	Qty		Part No.	Description	Qty
1	Trampoline Mat	1		9	Hex Nut	12
2	Left Handle w/ Foam	1		10	Spring	30
3	Right Handle w/ Foam	1		11	Spring Tool	1
4	Center Handle w/ Foam	1		12	Wrench	1
5	Frame Leg	6		13	Allen Key	1
6	Leg Cap	6		14	End Cap	2
7	Bolt	12		15	Handle Base Insert	4
8	Washer	12		16	Frame Section	6



# STEP 1

## ASSEMBLE FRAME

### PARTS NEEDED:

Frame Legs (6 PC)  
Frame Pieces (6 PC)  
Bolt (12 PC)  
Nut (12 PC)  
Washer (12 PC)  
Mat (1 PC)  
Springs (30 PC)

1. Place a Frame Leg (5) against a Frame Section (16). Ensure that the grooved side of the frame section is facing *inwards*, parallel with the open end of the Frame Leg (see below for clarification). Line up one of the Bolt holes in the Frame Leg to the corresponding hole in the Frame Piece.

Thread 1x Bolt (7) through the Frame Leg and Frame Section so that the threaded end points down towards the plastic Leg Cap. Place a Washer (8) on the Bolt End and loosely secure with a Hex Nut (9). Take another Frame Section and secure it to the remaining hole in the Frame Leg using the above instructions. Continue assembling the frame as described above. **DO NOT FULLY TIGHTEN NUT/BOLT COMBINATIONS UNTIL THE ENTIRE FRAME IS ASSEMBLED. ALSO NOTE THAT BEFORE THE SPRINGS AND MAT ARE ATTACHED, THE FRAME MAY NOT BE COMPLETELY CIRCULAR. ONCE THE SPRINGS ARE ATTACHED TO THE MAT, THIS WILL CAUSE THE FRAME TO CONFORM TO ITS PROPER CIRCLE SHAPE.**



2. Once the Trampoline frame is complete and you have tightened all the bolts securely, flip the trampoline over and install the mat. Center the Logo on the mat so it is perpendicular to any one of the legs, and begin to attach the springs using the Spring Tool.

**Using the Spring Tool:** Place the end of the spring which is more “closed” onto the V-Ring sewn into the Trampoline Mat. Next, Hook the end of the spring which is more “open” with the spring tool, and pull the tool towards you until the spring extends to the corresponding hole. Push the spring down into the hole with your palm, making sure you do not pinch your other fingers in the spring or against the frame.

**Installing the Springs:** Using compass points as a general reference, install two springs at N and S, and then an additional two at E and W. Once installed, count the holes in the top rail and ensure these match up to the available V-Rings sewn into the mat. Note: You may have to move a spring over a space or two to ensure that it is properly matched to its V-Ring. Continue installing the springs by placing 2 on either side of the N spring, and then 2 on either side of the S spring, followed by two on either side of the E and W springs. Installing the springs in this fashion will ensure that the mat is kept evenly centered, and will greatly assist in ease of attaching the springs.

Once complete, fold the mesh safety skirt down so it is covering the springs. You may need to place a few weights (such as several books) on this skirt for a few minutes while it flattens against the frame.

INSTRUCTIONAL “HOW-TO” QUICK VIDEOS ALSO AVAILABLE  
ON LINE AT: [pureglobalbrands.com](http://pureglobalbrands.com)





# STEP 2

## ATTACH COVER AND PADDING

### PARTS NEEDED:

Race Car Cover (1)

Inner Padding (1)

3. Begin to attach the Race Car cover to the trampoline by locating the large seam in the center of the black fabric (see diagram on right). Line this seam up to the leg that is located directly above the Trampoline logo. This will be where the "nose" on the head is located. It is important to keep this seam as close to the chosen leg as possible during assembly of the trampoline cover.

For ease of assembly, it is recommended that another adult assist during this step.

While attaching this cover, ensure that the mesh safety skirt stays flat against the springs.

Once attached, place the foam ring on top of the black cover fabric.



Next fold the red top fabric of the Race Car cover in the same fashion which you attached the black fabric base, keeping the foam ring centered on the trampoline.



INSTRUCTIONAL "HOW-TO" QUICK VIDEOS ALSO AVAILABLE ON LINE AT: [pureglobalbrands.com](http://pureglobalbrands.com)



# STEP 3

## ASSEMBLE SIDE SKIRT AND HANDLES

### PARTS NEEDED:

- Side Skirt Foam Padding (1)
- Hand Rail Bases (2)
- Center Handle (1)

4. Fold the Side Skirt (sewn to the top cover) down so it covers the frame of the trampoline. Begin to tuck the white side skirt padding on the inside of the Side Skirt fabric between it and the trampoline legs. Carefully tuck the top of the padding up into the sewn seam of the top skirt fabric and the top padding. **Do not tie the Skirt ends yet.** Leaving these ties free, tie the inner strings on the padding to the strings on the inside of the cover skirt fabric. Finally, attach the foam loops sewn into the bottom of the Side Skirt to the legs of the trampoline.

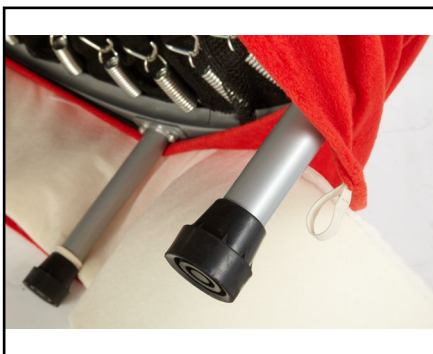

5. Attach the Handrail Bases to the Trampoline by first removing the plastic Leg Cap from the Legs they are to be placed on. Next, slide the Handrail Bases up onto the unit, and secure by replacing the Leg Cap. Join the Handrail Bases together by snapping the Center Handle piece into place. Lastly, tie the strings at the ends of the padding and side cover around the leg using the fabric loops sewn into the padding. NOTE: If you are unable to attach the center handle piece, switch the sides the Handrail Bases are attached to.

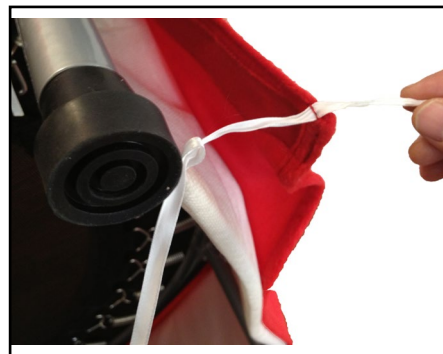

INSTRUCTIONAL "HOW-TO" QUICK  
VIDEOS ALSO AVAILABLE ON LINE AT:  
[pureglobalbrands.com](http://pureglobalbrands.com)



# STEP 4

## ASSEMBLE HEAD and ACCESSORIES

### PARTS NEEDED:

Race Car Head (1)  
Race Car Wheels (4)  
License Plate Insert (1)

6. To attach the head of the Race Car to the trampoline, first slide the remaining leg through the loop sewn into the center of the back of the head. Next, tie the bottom side panel of the head to the Handrail Bases. Next, attach the sides of the head using the velcro straps. Lastly, secure this assembly using the ties at the top of the side panels.



6. To attach the wheels to the side panel of the Race Car, first peel the backing off of the hook and loop straps on the rear side of the wheels (if present). Affix to the side panel of the skirt using these straps. Next, remove the license plate from the sleeve and insert into the clear plastic pocket on the rear of the unit.

Note: Visit [pureglobalbrands.com](http://pureglobalbrands.com) for information on how to obtain a personalized license plate!



# CARE AND MAINTENANCE

Your kids' trampoline is designed to be very low maintenance.

- If any part of the trampoline frame requires cleaning, simply wipe with a damp cloth. (Do not jump on the trampoline after cleaning until completely dry)
- If the paint is chipped, we recommend you lightly rub the damaged area and cover using a non-toxic enamel paint.
- If the cover becomes dirty or needs washing, remove the foam insert (top foam and side skirt foam). If possible, spot wash the cover. If necessary, you may hand wash the trampoline cover, but please be aware that this will affect the efficiency of the flame retardant applied to it. DO NOT Machine Wash or Tumble Dry. Always allow to air dry.

**IMPORTANT:** While no regular maintenance is required, you must inspect the trampoline before each use and replace any worn, defective, or missing parts. The following conditions could represent potential hazards: Missing, improperly positioned, or insecurely attached frame padding; Punctures, frays, tears, or holes worn in the bed or frame padding; Deterioration in the stitching or fabric of the bed or frame padding; Broken or missing springs; A bent or broken frame; A sagging jump mat; or sharp protrusions on the frame or suspension system. Cease using trampoline immediately and secure it against unauthorized use if any of these conditions are present.

# FREQUENTLY ASKED QUESTIONS

**Question: "The Handrail ends do not point in the right direction, I cannot assemble the center handrail piece, are the holes drilled wrong?"**

Answer: IF THE HANDLE PIECES DO NOT SEEM TO BE ORIENTED IN THE CORRECT DIRECTION, YOU MAY HAVE ASSEMBLED THE HANDLE PIECES ON THE WRONG LEGS. REMOVE THE HANDLE BASES AND SWAP THE SIDES THEY ARE ATTACHED TO.

**Question: "The foam padding or mat is damaged, what should I do?"**

Answer: IF YOU ARE STILL WITHIN YOUR WARRANTY PERIOD (90-DAYS FROM INITIAL PURCHASE) YOU SHOULD CONTACT CUSTOMER SERVICE (info below). YOU CAN ALSO PURCHASE REPLACEMENT PADDING AND MATS AT:  
<http://www.pureglobalbrands.com>

**Question: "I had a part missing from my box" or "something was damaged in shipping, can you send it to me?"**

Answer: IF IT HAS BEEN 30 DAYS OR LESS FROM THE DATE OF YOUR INITIAL PURCHASE, YOU CAN CONTACT CUSTOMER SERVICE (info below) FOR A REPLACEMENT PART TO BE ISSUED.

Telephone: 866-498-5269 (9am-5pm, M-F)  
Fax: 561-833-1996

Customer Service



1 866 498 5269



[customerservice@puregbi.com](mailto:customerservice@puregbi.com)

MODEL NO. 9020CT