

USER MANUAL

TDR-i SERIES EN (Original Instruction)



KEEP THIS USER MANUAL FOR FUTURE USE

© 2013 Fri-Jado BV, Etten-Leur, The Netherlands.

We advise you to contact your supplier for the guarantee period and conditions. Further we refer to our General Terms and Conditions for Sales and Delivery that are available upon request.

The manufacturer does not accept any liability for damage or injury caused by failing to adhere to these regulations or by not observing the usual caution or care in actions, operation, maintenance or repair activities, even if not explicitly described in this manual. As a result of constant commitment to improvement, it may happen that your unit deviates in detail from what is described in this manual. For this reason, the given instructions are only a guideline for the installation, use, maintenance and repair of the unit referred to in this manual. This manual has been composed with the utmost care. The manufacturer shall, however, not be held responsible for any mistakes in this manual nor for any consequences thereof. The user is allowed to copy this manual for own use. Further all rights are reserved and nothing in this manual may be reproduced and/or made public in any way.

Modifications:

In case of unauthorised modifications in or on the unit, every liability on the part of the manufacturer becomes null and void.

CONTENTS

1.	INTRODUCTION	6
1.1.	General	6
1.2.	Identification of the unit	6
1.3.	Pictograms and symbols.....	6
1.4.	Safety instructions	7
1.4.1.	General	7
1.4.2.	Moving.....	8
1.4.3.	Outdoor use restrictions	8
1.4.4.	Hygiene.....	9
1.5.	Service and technical support	9
1.6.	Storage	9
1.7.	Disposal	9
2.	DESCRIPTION OF THE UNIT.....	10
2.1.	Technical description.....	10
2.2.	Intended use.....	10
2.3.	Accessories	10
3.	INSTALLATION AND FIRST USE	11
3.1.	Unpacking the unit	11
3.2.	Dismantling the pallet	12
3.3.	Installation and positioning.....	13
3.4.	First use	13
4.	OPERATION AND USE	16
4.1.	Control panel.....	16
4.2.	Switching-on the unit	17
4.3.	Loading the unit.....	17
4.3.1.	Loading the unit with meat forks	17
4.3.2.	Loading the rotisserie using meat baskets (accessory)	18
4.3.3.	Loading the rotisserie using chicken racks (accessory)	19
4.3.4.	Loading the rotisserie using two different accessories.....	20
4.4.	Grilling time	20
4.5.	Taking out the products	20
4.5.1.	Taking out the meat forks	20
4.5.2.	Taking out the chicken racks (accessory)	21
4.5.3.	Taking out the meat baskets (accessories)	21
4.6.	Switching-off the unit.....	21
5.	OPERATE.....	22
5.1.	Starting a program.....	22

5.2.	Pre-heating	23
5.3.	While cooking	23
5.4.	Adding extra time to the active program	24
5.5.	Interrupt a program.....	24
5.6.	Set the timer (optional)	25
5.7.	Reset alarm signal.....	25
5.8.	Power down	25
6.	SETTINGS	26
6.1.	General	26
6.2.	Information.....	26
6.2.1.	Access	26
6.2.2.	Overview.....	26
6.3.	Manager	27
6.3.1.	Access	27
6.3.2.	Overview parameters	27
6.4.	Service Menu	27
7.	PROGRAM.....	28
7.1.	General	28
7.2.	Adding programs	28
7.2.1.	Enter the program name.....	28
7.2.2.	Programming cooking step.....	29
7.2.3.	Keeping warm (HOLD)	30
7.2.4.	Saving the program	30
7.3.	Edit programs	30
7.4.	Deleting programs	30
7.5.	Testing the programs	31
7.6.	Sorting programs	31
8.	CLEANING AND MAINTENANCE	32
8.1.	Maintenance schedule	32
8.2.	Daily Cleaning	32
8.3.	Weekly Cleaning	33
8.4.	Monthly Cleaning	34
9.	MALFUNCTIONS AND SERVICE; WHAT TO DO	35
9.1.	Replacing the mains cord	35
9.2.	Replacing a lamp	36
10.	TECHNICAL SPECIFICATIONS.....	37
11.	ACCESSORIES	37

1. INTRODUCTION

1.1. General

This manual is intended for the user of the TDR (Turbo Deli Rotisserie). The features and controls are being described, along with directions for the safest and most efficient use, in order to guarantee a long life of the unit.

All pictograms, symbols and drawings in this manual apply to the TDR.

1.2. Identification of the unit

The identification plate can be found on the outside of the machine, and contains the following data:

- Name of the supplier or the manufacturer
- Model
- Serial number
- Year of construction
- Voltage
- Frequency
- Power consumption

1.3. Pictograms and symbols

In this manual, the following pictograms and symbols are used:



WARNING

Possible physical injury or serious damage to the unit, if the instructions are not carefully followed.



WARNING

Hazardous electrical voltage.



WARNING

Danger of getting injured by hot surfaces.



Suggestions and recommendations to simplify indicated actions.



Recycling symbol.



Direction of view symbol.

1.4. Safety instructions

**WARNING**

The outside of the unit can be very hot.

**WARNING**

The maximum load on top of the unit may never exceed 50 kg.

**WARNING**

Always use the brakes on both front wheels:

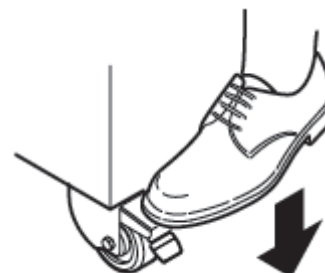

1.4.1. General

The user of the unit will be fully responsible for abiding the locally prevailing safety- rules and regulations.

The unit may be operated by qualified and authorised persons only. Anyone working on or with this unit must be familiar with the contents of this manual and carefully follow all guidelines and instructions. Never change the order of the steps to be performed. The management must instruct the personnel on the basis of this manual and follow all instructions and regulations.

The pictograms, labels, instructions and warning signs attached to the unit, are part of the safety measures. They may never be covered or removed, and have to be clearly visible during the entire lifetime of the unit.

Immediately repair or replace damaged or illegible pictograms, warnings and instructions.

- To avoid short-circuiting, never clean the unit using a water hose. For cleaning instructions, see section 8.
- During the grilling process, the unit can get very hot.
- When the door is opened the rotor stops and the heater is de-energised.
- The unit must be cleaned regularly to ensure proper functioning and prevent fire hazard (over heating). Especially the back of the fan plate.
- The fat collecting drawer must be emptied regularly, to prevent overflow.
- This appliance is not intended for the use by persons (including children) with reduced physical, sensory or mental capabilities, or lack of experience and knowledge, unless they have been given supervision or instruction concerning use of the appliance by a person responsible for their safety.
- Children should be supervised to ensure that they do not play with the appliance.

1.4.2. Moving

When moving the unit:

- Before moving the unit, first switch off the mains voltage by pulling the plug from the wall socket and empty the fat collecting drawer. After that, cool-down the unit for at least ten minutes.
- The units equipped with wheels are not suited to pass ledges or obstacles higher than 10 mm.
- When moving the unit, always push at the centre of the unit. Never on top. Never at the bottom.
- Make sure that the wheels can move freely, so they never touch the power lead (see Figure 1).

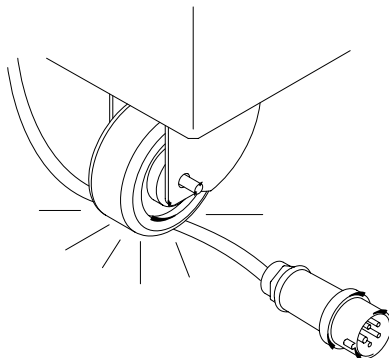

Figure 1

1.4.3. Outdoor use restrictions

To avoid short-circuiting, the units may not be used outdoors unprotected. Placing under a screen is allowed.

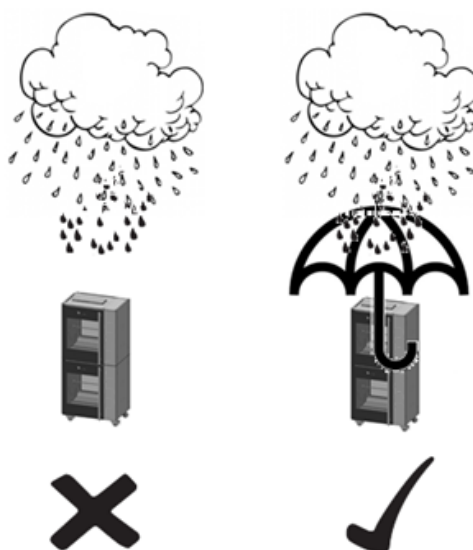

Figure 2

1.4.4. Hygiene

The quality of a fresh product always depends on hygiene. Especially grilling products. With the risk of salmonella contamination – especially for chicken products – you must make sure that grilled products can never be mixed with uncooked products. Also contact between grilled products and hands or tools that have been in contact with raw chicken meat, must be avoided at all times.

Hands or tools that have been in contact with raw chicken meat, must be cleaned thoroughly.

1.5. Service and technical support

The electrical schematics of your unit is included. In case of malfunctions you can contact your dealer/service agent. Make sure you have the following data available:

- Model.
- Serial number.

This data can be found on the identification plate.

1.6. Storage

If the unit will not be used temporarily, and will be stored, follow these instructions:

- Clean the unit thoroughly.
- Wrap the unit from getting dusty.
- Store the unit in a dry, non condensing environment.

1.7. Disposal

Dispose of the machine, any components or lubricants removed from it safely in accordance with all local and national safety and environment requirements.

2. DESCRIPTION OF THE UNIT

2.1. Technical description

The unit uses a combination of direct infra red radiation and convection heat.

The rotor is being wheeled by a maintenance-free motor with a gear box.

The fan provides an equally divided heat. The glass panes are equipped with a heat reflecting layer to keep the heat inside the grill.

The intelligent control keeps the temperature inside the unit fixed to level set by the operator. During the entire process, the interior of the unit will be illuminated by halogen lamps.

The intelligent control has a capability to store 250 different programs.

Each program can consist of a pre-heat step, with additional (maximum 9) steps, in which the cooking time and temperature can be set.

Communication through RS232 enables easy read-out, re-work and creating of programs via a PC. For this, special software is available at Fri-Jado.

The plating of the unit is made of stainless steel. The product contact parts are made of stainless steel AISI 304 (eventual with PTFE coating).

The mains cable has a CEE-form plug.

2.2. Intended use

The TDR has been designed for grilling meat products. Any other use will not be regarded as intended use.

The manufacturer accepts no liability whatsoever for loss or injury caused by failing to strictly adhere to the safety guidelines and instructions in this manual or due to carelessness during installation, use, maintenance and repair of the unit referred to in this manual and any of its accessories.

Use the unit in perfect technical condition only.

2.3. Accessories

Your unit contains the following standard accessories:

- Meat forks.
- User manual.

For optional accessories refer to section 0.

3. INSTALLATION AND FIRST USE

3.1. Unpacking the unit

Your unit is packed in a plastic cover with protective corners, and a carton box around it. All units are placed on a wooden pallet. Around the box there are two tightening straps.

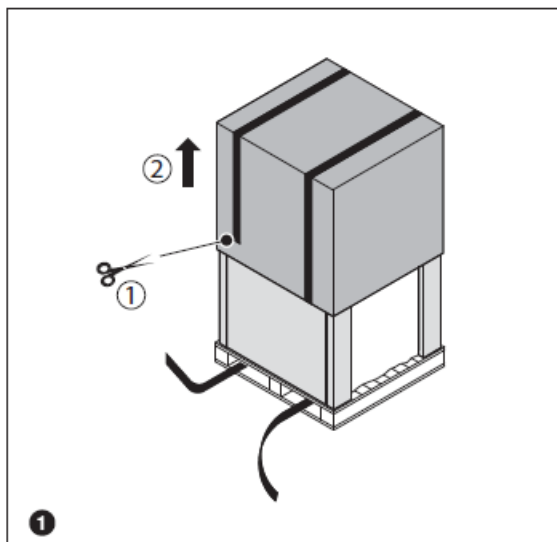

Figure 3

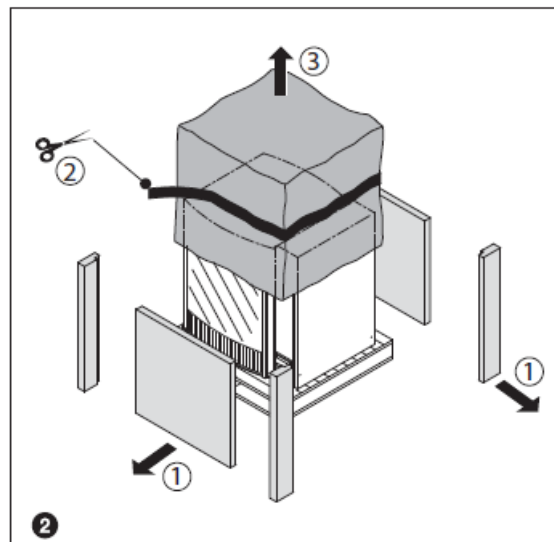

Figure 4

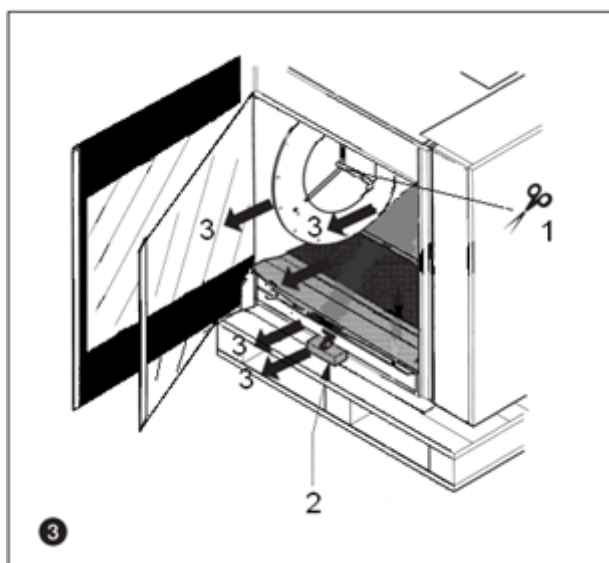

Figure 5

Remarks Figure 5:

1. Cut the two transportation seals from both sides of the rotor
2. Remove the transportation block of the fat collecting drawer
3. Remove all remaining packing materials from the unit
4. Take off the standard accessories.

3.2. Dismantling the pallet

For proper unpacking the unit, the pallet must be taken apart. Use the instructions shown in Figure 6.

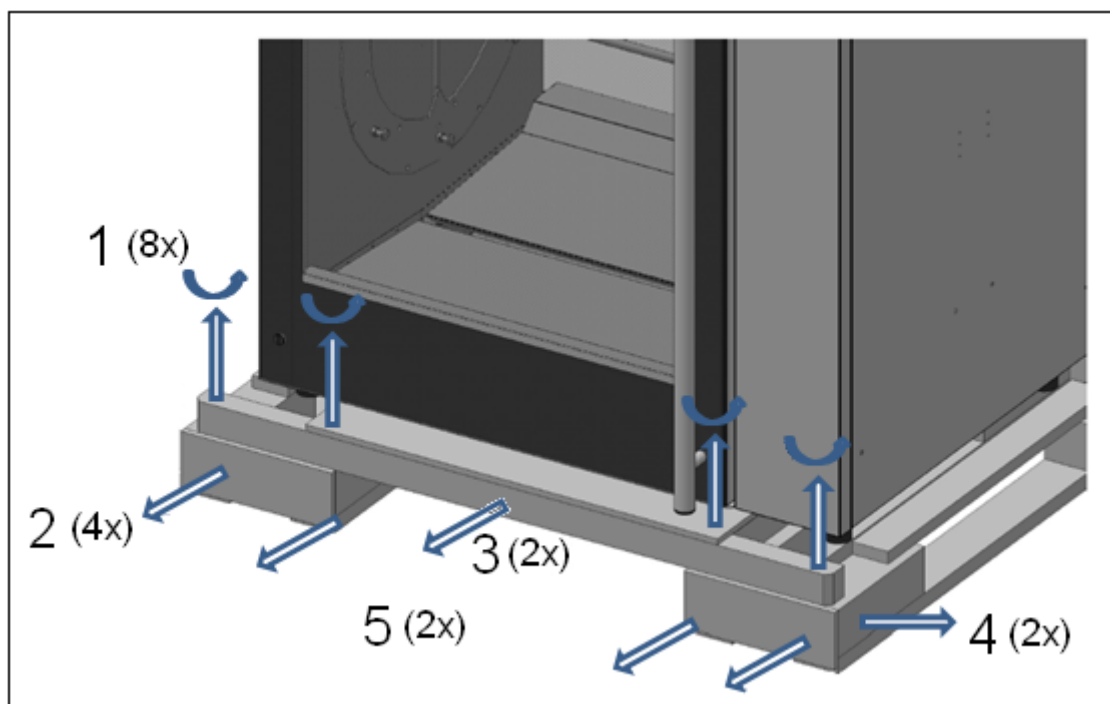

Figure 6



All packing materials used for this unit are suited for recycling.

After unpacking, check the state of the unit. In case of damage, store the packing material, and contact the transporter within fifteen working days after receiving the goods.

3.3. Installation and positioning

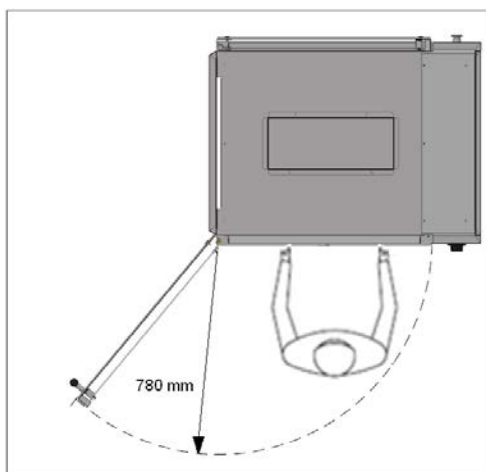
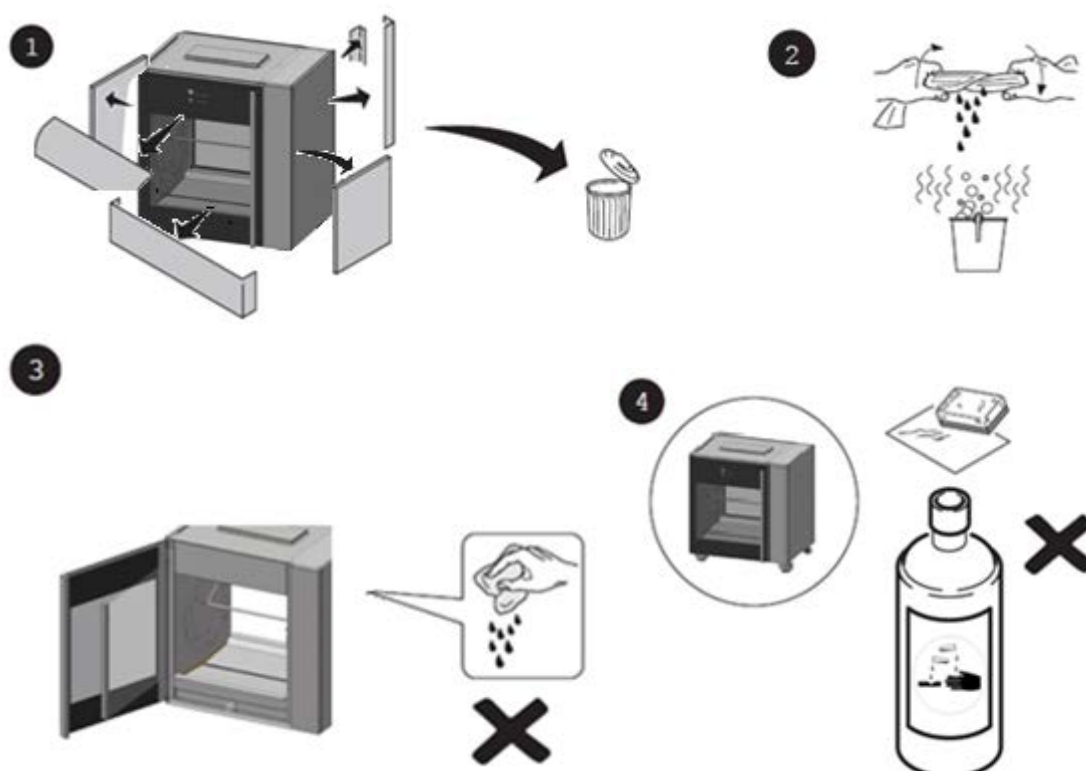

Figure 7

- The user must have sufficient freedom of movement to properly operate the unit (see Figure 7).
- The minimum free distance must be at least 25 cm.
- During grilling, the glass panes will get very hot. While positioning, keep the unit out of children's reach.
- In case of a wheeled unit, the floor must be flat and levelled.
- The unit has a mains plug, and must be connected to a wall socket with the proper mains voltage. The wall socket must be mounted by a certified electrician.

3.4. First use

When using the unit for the first time, clean the interior thoroughly with soap suds and heat up the unit. After commissioning discolouration of the cooking/grilling area can occur.



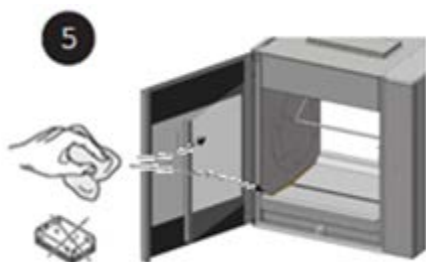

The cleaning remains will find its way to the fat collection drawer, so this drawer must be cleaned and emptied after cleaning the unit.

- Place the bottom plates in the grilling compartment (see Figure 8).

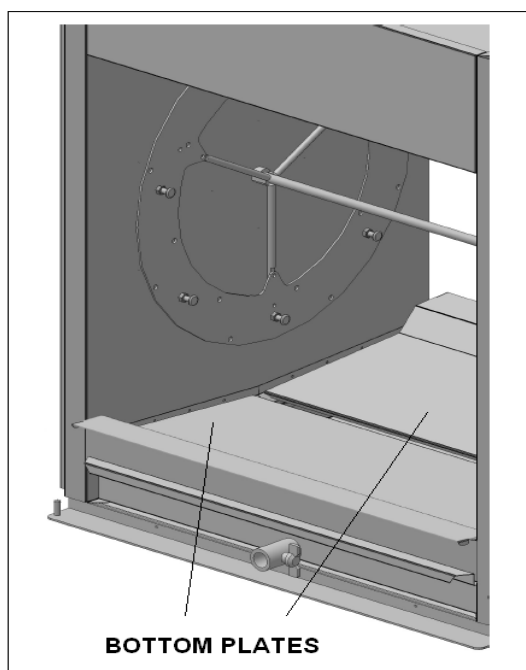

Figure 8

- Place the meat forks in the rotor discs (see Figure 9).

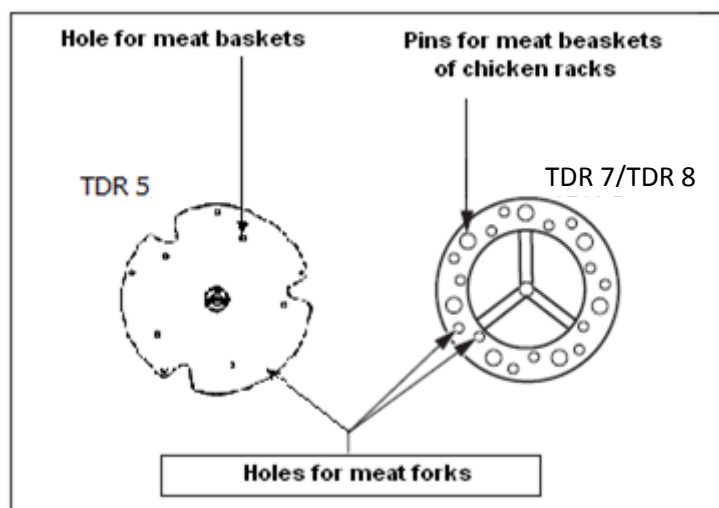
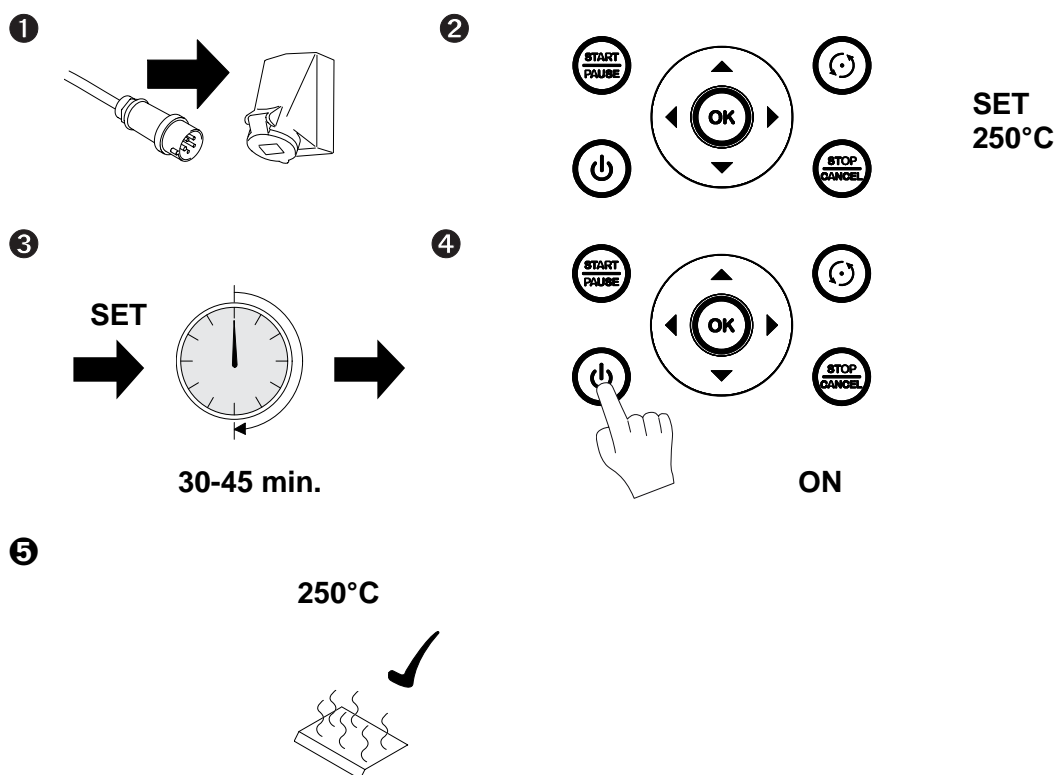

Figure 9

Metal odour

To remove both the oil- and metal odour that will appear at first use, the unit must be heated at the maximum temperature for at least half an hour.



4. OPERATION AND USE

4.1. Control panel

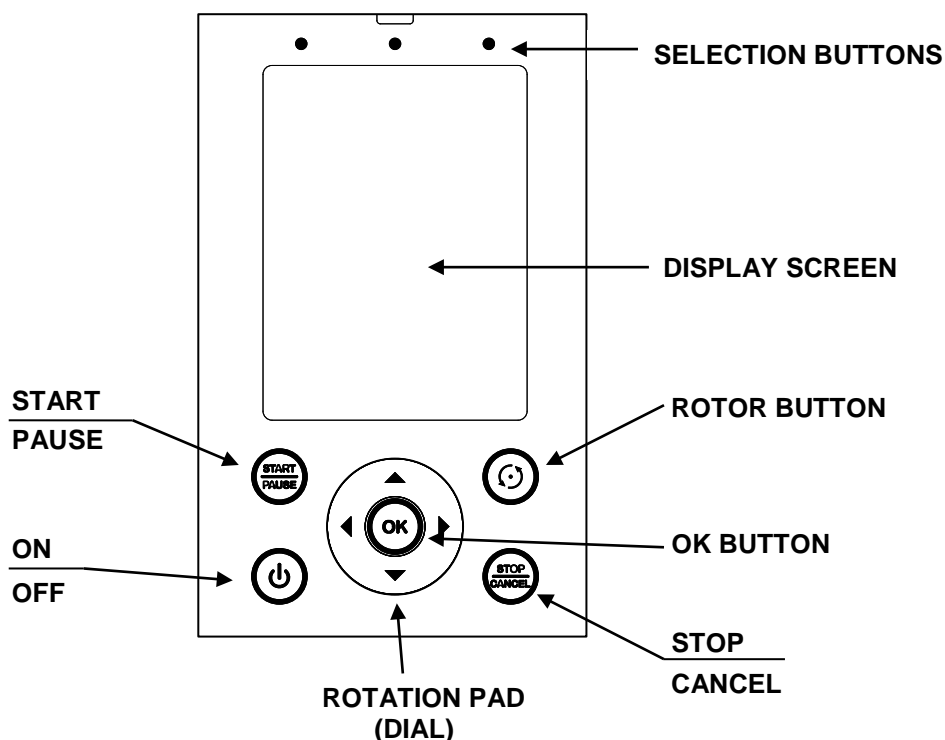

Button	Function
SELECTION BUTTONS	Selecting tabs in display screen.
ON / OFF	Switching the unit on and off.
START / PAUSE	Starting and ending a program.
STOP / CANCEL	Interrupting a program (one step back in the menu)
OK BUTTON	Acknowledge a choice
ROTOR BUTTON	Rotate the rotor
ROTATION PAD	See "Rotation pad"

Rotation pad

This pad is used for:

- Navigating through the menu-items in the screen.
- Changing the settings.

Changing the settings quickly

- Increase value: rub the pad clock-wise with one finger.
- Decrease value: rub the pad counter-clock-wise with one finger.

Screen

The following tabs are present:

- Operate "Choose between programs" (See section 5).
- Program "Creating programs" (See section 7).
- Settings "Change settings of programs" (See section 6).

4.2. Switching-on the unit

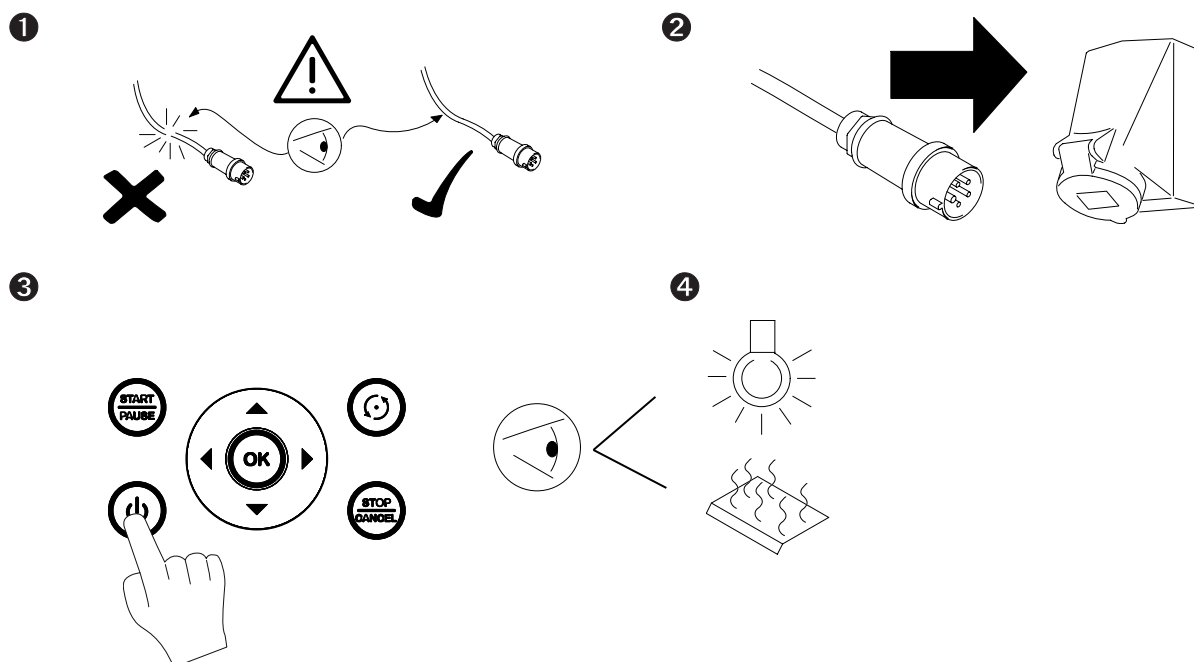

4.3. Loading the unit

When the door is open press the rotor button to activate the rotor. This allows easy loading or unloading of the products.

Whilst loading the unit, make sure that the rotor gets evenly loaded, so that the mass of the products is evenly spread over the rotor, causing an equal balance. Do not allow empty meat forks, meat baskets and chicken racks etc. in the grilling process.

4.3.1. Loading the unit with meat forks

The unit will be equipped with a set of meat forks.

For preparing chicken or any other poultry, you can work as follows (see Figure 10).

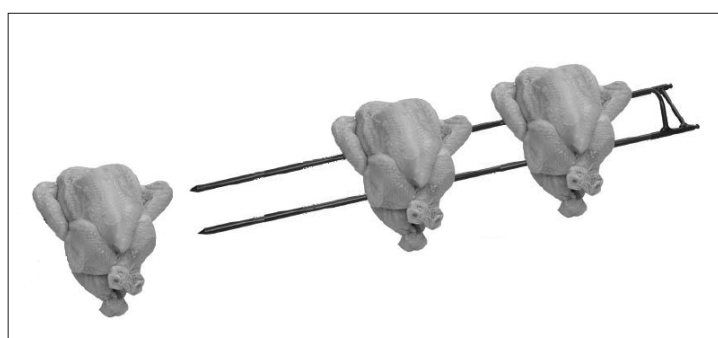

Figure 10

1. Insert one point of the meat fork through the chest at the position of the wings. Insert the other point through the drum sticks. Don't forget to include the wings.
2. Leave some space between the products, for an even exposure and browning.
3. Put the meat forks onto the rotor disks in such a way that during grilling the chicken breasts face the operator.
4. Put the points of the meat forks through the appropriate holes in the rotor disks (see Figure 11).

5. The other end of the meat forks must be put through the corresponding holes in the opposite rotor disk.

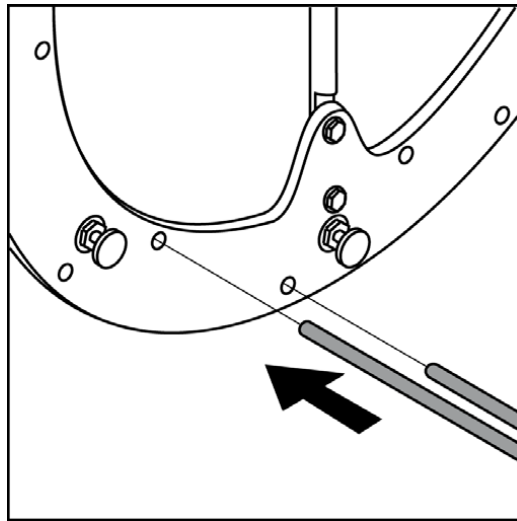

Figure 11

6. To insert the remaining meat forks in the unit, act as follows:
 - Switch-on the unit using the on/off button.
 - With the door opened, use the rotor button to move the rotor to easily insert the next meat fork. Keep the rotor button pressed until the rotor reaches the desired position. Repeat these steps, until all products are loaded.



Whole uncut chickens should always be grilled using the meat forks. This way their natural fat will baste each other, giving a perfectly slender cooking result. Refer to the You-Tube movie: "Fri-Jado instruction for binding and loading chicken".

4.3.2. Loading the rotisserie using meat baskets (accessory)

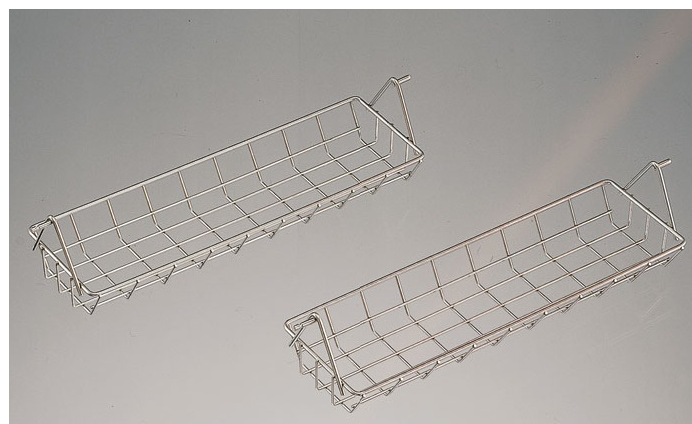

Figure 12 (type for TDR 5 is shown)

If you are using meat baskets, act as follows:

- With the TDR 5 you must stick the ends of the meat baskets through the appropriate holes of the rotor disks (see Figure 12).
- With the TDR 7 and TDR 8 you must attach the meat baskets to the appropriate pins (see

- Figure 9 and Figure 13).

Whilst loading the unit with meat baskets, you must see to it, that the rotor gets evenly loaded, so that the mass of the products is evenly spread over de rotor, causing an equal balance.

Also see to it that no meat parts are sticking out of the baskets.

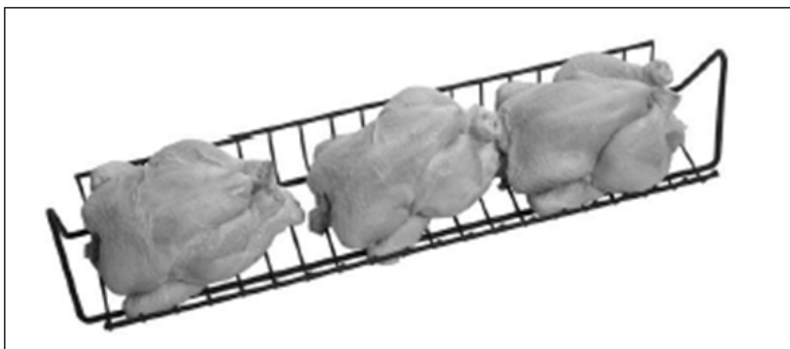

Figure 13 (type for TDR 7 / TDR 8 is shown)

4.3.3. Loading the rotisserie using chicken racks (accessory)

When using chicken racks, (see Figure 14), you can use the principle as described in section 4.3.2.

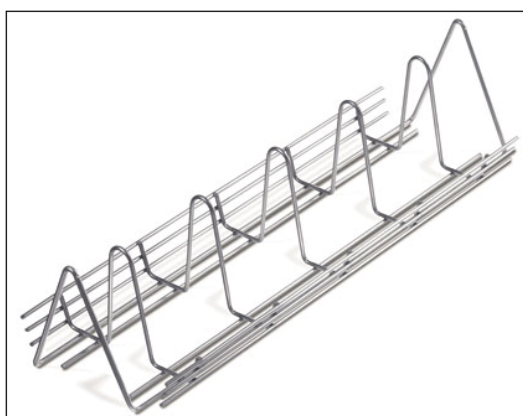

Figure 14

For preparing chicken or any other poultry in the racks, you can use Picture 1 as an example.



Picture 1

4.3.4. Loading the rotisserie using two different accessories.



WARNING

After loading the rotor, at least make ONE full rotation, and check whether the rotor can spin without obstructions.

If you want to load the unit using two different accessories at the same time, always fill the rotor with ONE accessory fewer than the maximum allowed quantity. See to it that accessories of the same type are placed consecutively.

Example

For both TDR 5 and TDR 5 + 5: 1 meat fork + 2 meat baskets consecutively

4.4. Grilling time

Grilling time depends on a number of factors:

- The ambient temperature and draft in the direct vicinity of the unit.
- Grilling temperature.
- The initial product temperature.
- The sort of meat (fat or lean) and with or without additives.
- The mass and shape of the product.
- The total amount of meat to be grilled in one grilling cycle.
- The end result.

4.5. Taking out the products



WARNING

After the grilling, the interior of the unit and the glass panes are very hot. Always use oven gloves when taking out the meat forks or other accessories

4.5.1. Taking out the meat forks

When taking out the meat forks, it is best to act as follows (see Figure 15):

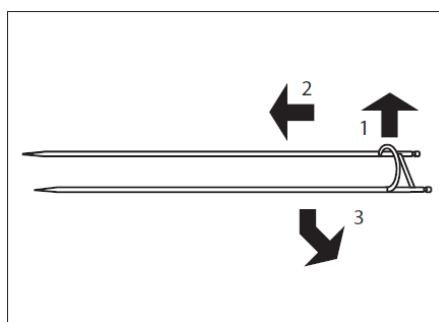

Figure 15

1. Hold the meat fork firmly.
2. Slightly lift the end with the grips and shift the meat fork into the direction of its points. This releases the meat fork.
3. Take the meat fork at its other end and take it out of the unit.
4. Remove the products from the meat fork.

4.5.2. Taking out the chicken racks (accessory).

When taking out the chicken racks from the TDR it is best to act as follows:

1. Slightly lift both ends of the chicken rack.
2. Move the rack towards either the left or right hand side of the unit. This action unlocks one end of the rack.
3. Move the unlocked end towards you, and take out the rack from the unit.

Depending on the number of prepared products, you may have to empty the racks before they can be removed.

4.5.3. Taking out the meat baskets (accessories)

For the TDR 5 you can use the same principal as described in section 4.5.2.
For both the TDR 7 and TDR 8 it is preferred to act as follows:

1. Slightly lift both ends of the meat basket.
2. Move either one side towards you, and take out the basket from the unit.

Depending on the number of prepared products, you may have to empty the baskets before they can be removed.

4.6. Switching-off the unit

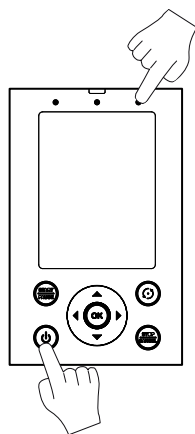

1. Press buttons together and hold for approx. 3 seconds.

5. OPERATE

5.1. Starting a program

1. Press the left-hand selection button
2. Select the required program. The total duration of the program is shown in minutes next to the name of the program.
3. Press START/PAUSE.

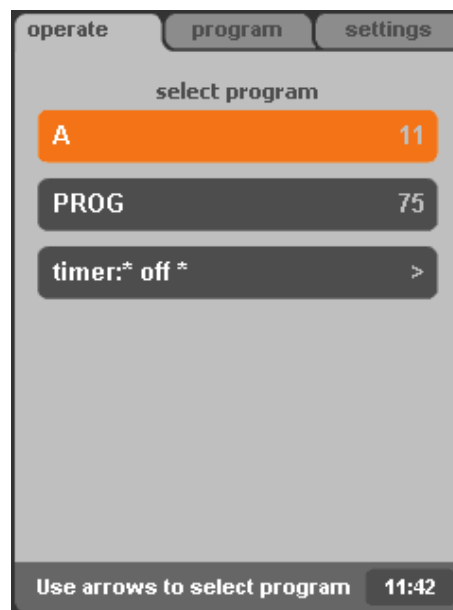

Use the rotation pad or arrow buttons to toggle between the programs.

- **timer:* off *** Is the timer program (see section 5.6).

5.2. Pre-heating

When the pre-heat function is activated, the unit will start this function after selecting this program. The screen will display the current temperature (on the right) and the set pre-heat temperature (on the left). When the set temperature is reached, the screen will show: "Load products" and a sound is activated.



5.3. While cooking

During the cooking process, the display shows a graph with the planned temperature trajectory (orange line) and the current temperature (light orange field). Under the graph, the program name and the total time is shown.

In the bottom of the screen, the current temperature inside the unit and the remaining time are given. When 'process correction' is switched-on, the total time and remaining time will be adjusted.

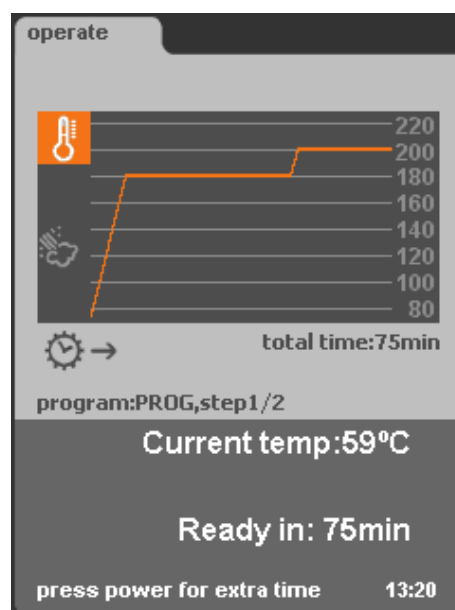

5.4. Adding extra time to the active program

During the process extra time can be added, by following the next steps:

1. Press the power button. 
2. Set extra time by rubbing the rotation pad.
3. Select the arrow point right to save setting.
4. Press OK.

The display now shows the extra time, which will be added to the last baking step. The screen always shows the total amount of extra time.



5.5. Interrupt a program

Interrupt temporarily:

1. Press START/PAUSE.
2. Press START/PAUSE again to resume the program.

Interrupt definitely:

1. Press STOP/CANCEL.
2. Select "yes".
3. Press OK.

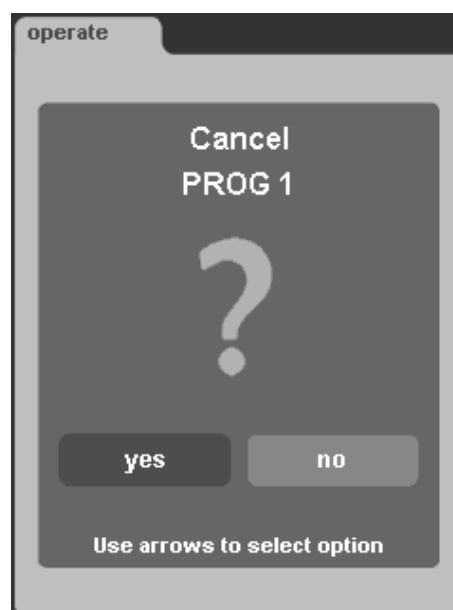

5.6. Set the timer (optional)

This function allows the user to automatically start a program on a pre-determined date and time.

To enable this function, the “timer function” in the Manager menu must be set to “YES”.

1. Select the recipe “timer:*off*”.
2. Press OK.
3. Use the arrows to change the setting “timer function” from “OFF” to “ON”. This setting switches the timer off or on.
4. Press OK twice.
5. Use the arrows to select the desired program, and press OK.
6. Select “Set time” and press OK.
7. Set the desired time using the rotation pad. By pressing OK you switch from hours to minutes, and consequently to “save”. Press OK to save the time setting.
8. Select “Set date”.
9. Select the desired date using the right and left arrow.
10. Select “store” to save the timer settings, and to quit the menu.
11. Once the timer has been set, the top-left of the display will show a flashing clock-sign.

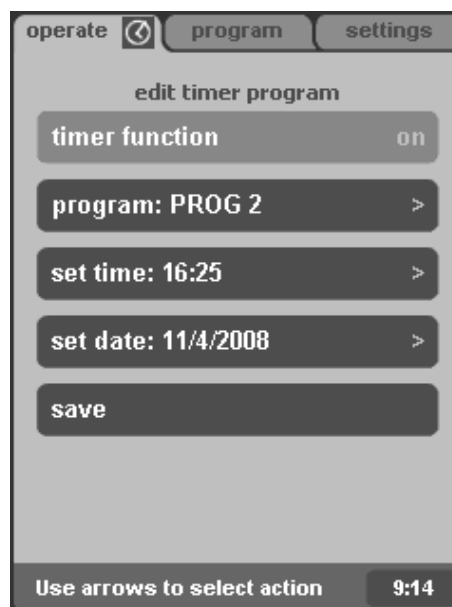

5.7. Reset alarm signal

When an alarm signal has been set, it will sound. To stop this signal, press OK.

5.8. Power down

If no program is active and no key is touched within the next 60 minutes the unit will switch-off automatically.

Press ON/OFF for some seconds to re-start the unit.

This option can be both switched-off or adjusted by a service engineer.

6. SETTINGS

6.1. General

The settings of the unit can be changed by using the control panel.

There are three kinds of settings:

- Information
- Manager
- Service

6.2. Information

6.2.1. Access

1. Activate the settings menu (right selection button).
2. Select "information".
3. Press OK.

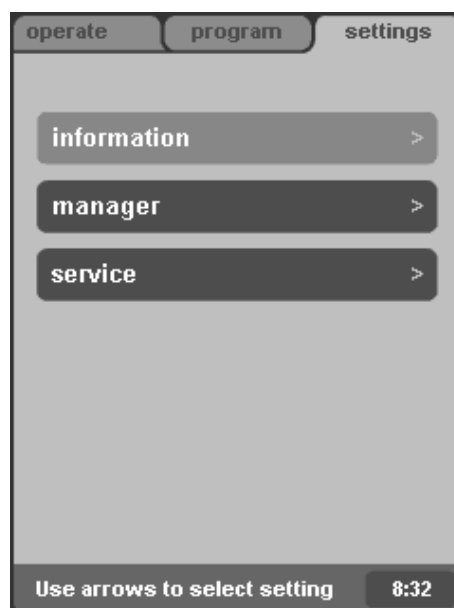

6.2.2. Overview

The screen shows, for a predefined time, an overview with some pre-programmed settings. Pressing any knob to return to the setting menu instantaneously.



6.3. Manager

The Manager menu is used to set the parameters.

6.3.1. Access

1. Activate the settings menu (right selection button).
2. Select “manager”.
3. Press OK.

When a pin code has been set:

1. Use the rotation pad to enter the pin code.
2. Press OK or the right arrow to enter the next number.
3. Press OK twice.

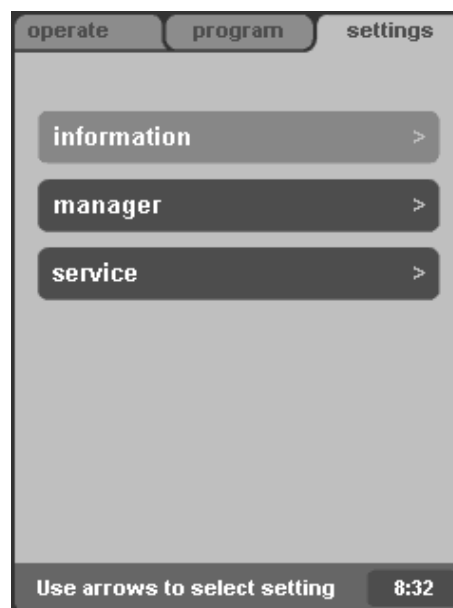

6.3.2. Overview parameters

Setting	Function and values
Change pin code	Setting the pin code for access to the Manager Menu. This pin code can also be used for access to the Program Menu. <ul style="list-style-type: none"> • 0000 – 9999
Light	<ul style="list-style-type: none"> • ON – OFF
Temperature	<ul style="list-style-type: none"> • °C – °F
Set time	Setting the current time
Set date	Setting the current date
Set contrast	Setting the contrast of the screen
Time format	<ul style="list-style-type: none"> • 24h – AM/PM
Date format	<ul style="list-style-type: none"> • D/M/Y – M/D/Y
Alarm signal	<ul style="list-style-type: none"> • YES – NO
Pre heat mode	<ul style="list-style-type: none"> • NO: never a pre heating • 1X: pre heating ONCE, after switching on the unit. • YES: always pre heating
Pre heat delta	Correction on the pre-heat temperature based upon the operation temperature.. <ul style="list-style-type: none"> • -50°C(-90°F) – +50°C(+90°F)
Auto recipe start	<ul style="list-style-type: none"> • NO – YES
Buzzer set	<ul style="list-style-type: none"> • Beep 1 – 5
Key beep	<ul style="list-style-type: none"> • ON – OFF
Clear errors	Clear errors

6.4. Service Menu

The service menu contains settings for the language and security of the unit. This can only be accessed by the supplier or a service technician.

7. PROGRAM

7.1. General

Your dealer has programs that are loaded into the unit by means of a computer. These programs vary with the composition of the product and the customer's desire, and are customer dependent.

You can protect the cooking programs and the 'secured settings' by changing pin code "0000" in the menu, into any other pin code. By changing the pin code back into "0000", the protection is removed.

The program menu is used to store programs yourself. A program can have not more than 9 steps. In each step both the temperature and time can be set. The memory can handle 250 programs.

Access:

Activate the program menu (middle selection button).

If a pin code has been set:

1. Use the rotation pad to enter the pin code.
2. Press OK or the right arrow to enter the next number.
3. Press OK twice.
4. Select the desired action.

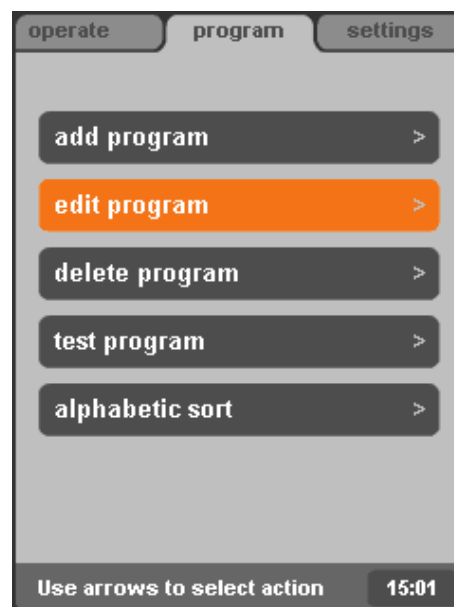

7.2. Adding programs

1. Select "add program".
2. Press OK.

7.2.1. Enter the program name

1. Enter the first character by using the rotation pad. The name can consist of:

- letters: "A – Z"
- numbers "0 – 9"
- and character "-" or "blank"

The combination is free to choose. A name cannot have more than 11 characters, including blanks. You can create a blank by skipping a position. This can be done by pressing the right arrow.

2. Press OK or the right arrow to go to the next position.
3. Repeat steps 1 and 2 for the letter/number of the name, if needed.
4. Select the next position with the right arrow.
5. Press OK twice to store the name and to proceed.
6. Select "next".
7. Press OK



7.2.2. Programming cooking step

The table on the screen contains the following columns:

- Time duration
- Temperature

Row 1 shows step 1, row 2 shows step 2, etc.

There can be no more than 9 steps.

A selected cell shows an orange frame. To alter a cell, it needs to be 'opened' by selecting it and pressing OK.

I. Setting the time duration

1. Select the time duration of the first cooking step. This is the value in the top-left of the table.
2. Press OK to open the cell. The cell background turns orange.
3. Set the time duration of the step to (1-240 minutes) using the rotation pad.
4. Choose “-” to skip the step.
5. Press OK to close the cell.

The first cooking step can be set as the pre-heat step. Skip the time setting or enter “-”.

II. Setting the temperature

1. Use the right arrow to select the cell in the second column.
2. Press OK to open the cell.
3. Set the temperature using the rotation pad.
4. Press OK to close the cell.

III. Next cooking steps

Select the first cell of the next cooking step, and repeat steps I - II to add another cooking step.

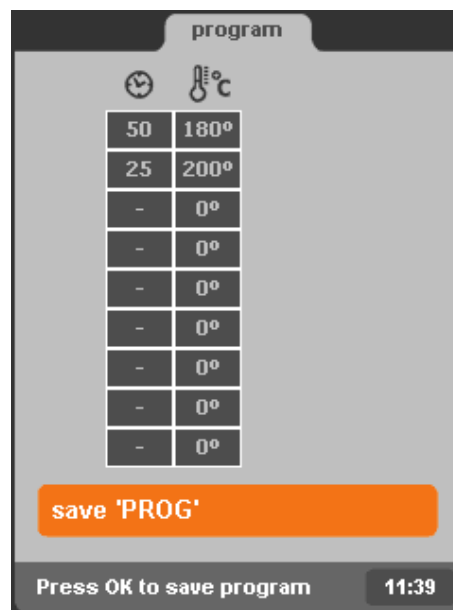

7.2.3. Keeping warm (HOLD)

Steps 2 - 9 can be set to keep the products warm. Skip setting the time duration, or enter “-“. If setting the temperature, the time duration will automatically be set to HOLD.

A “keeping warm” step will only be executed if this is the last program step. A “keeping warm” step lasts infinitely and it keeps the unit at the desired temperature.

7.2.4. Saving the program

1. Select “saving program”.
2. Press OK.

7.3. Edit programs

1. Select “Edit program”.
2. Press OK.
3. Select the required program.
4. Press OK.

Edit the program name

1. Select the position of the character.
2. Change the character using the rotation pad.
3. Use a ‘blank’ to erase a character.
4. Repeat steps 1 and 2 if needed.
5. Select next.
6. Press OK.

Edit the cooking steps

1. Select the cell.
2. Press OK. The cell background turns orange.
3. Set the value using the rotation pad.
4. Press OK to close the cell.
5. Repeat steps 1 - 4 if needed.
6. Select “save program”.
7. Press OK.

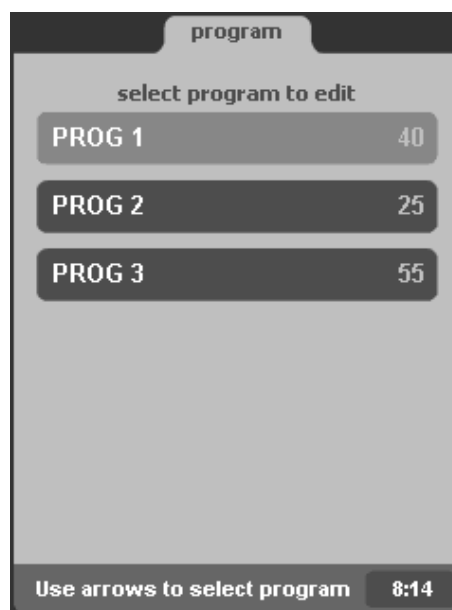

7.4. Deleting programs



Deleting of a program cannot be undone.

1. Select “delete program”.
2. Press OK.
3. Select the program.
4. Press OK.
5. Check whether the program name matches the program you wish to delete.
6. Select “yes” if this is the case. Select “no” if not.
7. Press OK.

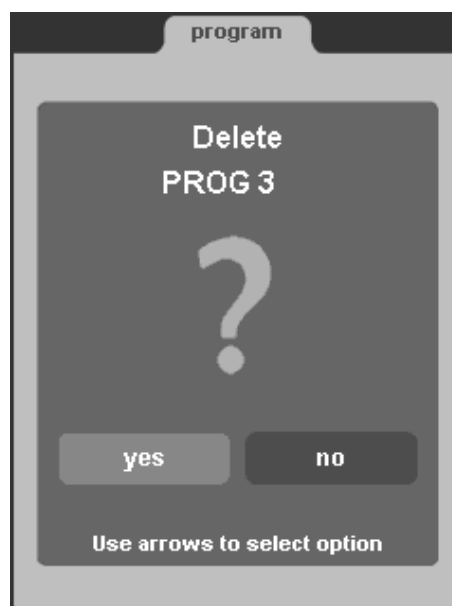

7.5. Testing the programs

In the test-mode the program will run normally, but the settings can be changed during the process.



Changes that are made (during testing) in the steps that already are passed, will not affect the products in the unit. However, the changes will be stored and will be active the next time the program is executed.

The changes that are made, will be stored during the test-mode.

1. Select "test program".
2. Press OK.
3. Select the program.
4. Press START/PAUSE or OK.

The process will be running identically to the normal execution of a cooking program. During the process the program can be changed.

1. Press OK.
2. Apply the changes.
3. Select "save program".
4. Press OK.

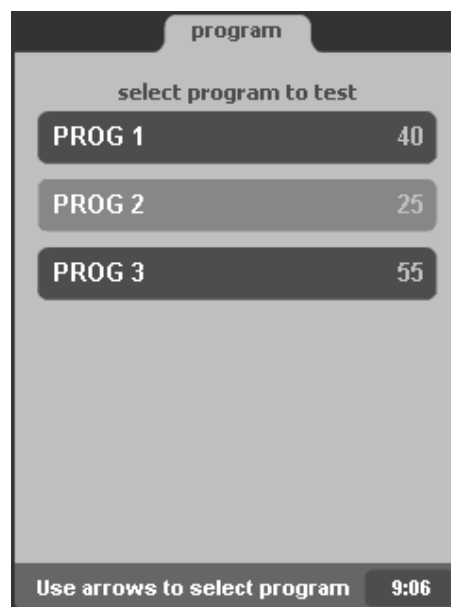

7.6. Sorting programs

This function allows you to sort programs alphabetically.

1. Select "sorting alphabetically".
2. Press OK.
3. Use arrows to select "yes".
4. Press OK.



8. CLEANING AND MAINTENANCE



WARNING

Never use a water hose for cleaning. Water can seep into the unit through the ventilation holes of the unit.



WARNING

Do not touch the halogen lamps with bare hands. Protect hot lamps from cold water.



Because of hygiene aspects and optimum condition of the unit it is of utmost importance to keep a daily cleaning pattern from first use onwards.

8.1. Maintenance schedule

Item	Action	Frequency
Interior	• Clean, see section 8.2.	Daily
Fat collection drawer	• Empty, see section 8.2.	Daily
Rotor and bottom plates	• Clean, see section 8.2.	Daily
Glass panes	• Clean, see section 8.3	Weekly
Exterior	• Clean, see section 8.3 • Use Stainless Steel cleaning spray to remove stains, and restoring the gloss.	Weekly
Fan blade	• Clean, see section 8.4	Monthly

8.2. Daily Cleaning



The unit can be cleaned best shortly after use, when it is still lukewarm. Grilling residue and fat can be removed easily in this state.

The best cleaning can be achieved by using special oven- or grill cleaner.

Covering the bottom plates with aluminium foil before use, saves cleaning time

The door has a magnetic lock. Regularly check the surfaces between the door and grill, and clean if necessary, to avoid air leaks.

Rotor and bottom plates

- Remove the rotor and bottom plates from the unit (no tools required).
- Place the detachable parts in a wide rinsing container filled with hot water and an appropriate cleaning agent.
- Soak these parts for one night and clean them the next day.

Fat collecting drawer

- Carefully take out the fat collection drawer partly.
- Open the tap until the drawer is empty.
- Clean the drawer with cleaning agent or hot water combined with an appropriate cleaning agent.

The interior

- Clean the interior with cleaning agent or hot water combined with an appropriate cleaning agent.
- Dry the interior thoroughly by using a dry cloth. Make sure no water or detergent stays behind in the unit.

8.3. Weekly Cleaning**WARNING**

The control panel may only be cleaned using a damp cloth.

**WARNING**

Do not use aggressive or abrasive materials. These will damage the surface which will make it more difficult to remove dirt.

Treat the outer surface of the interior window with a soft cleaning agent to protect the reflection layer.

Glass doors:

- Open the outer glass doors
- Unlock the inner glass doors (they are magnetically locked to the outer doors).
- Clean the panes with cleaning agent or hot water combined with an appropriate cleaning agent.
- Dry the doors thoroughly by using a dry cloth.
- If possible, leave the glass doors open at night.

The exterior:

- Clean the exterior with cleaning agent or hot water combined with an appropriate cleaning agent.
- Dry the exterior thoroughly by using a dry cloth.

8.4. Monthly Cleaning



WARNING

Take the power plug from the socket prior applying maintenance.

Clean the fan plate and the fan blade thoroughly as described below.

Fan plate:

- Remove the fan plate by loosening two winged nuts (see Figure 16). This plate hinges at two points at the sides. After pivoting, the plate can be removed from the unit.
- Clean the fan plate with cleaning agent or hot water combined with an appropriate cleaning agent.
- Dry the fan plate thoroughly by using a dry cloth.

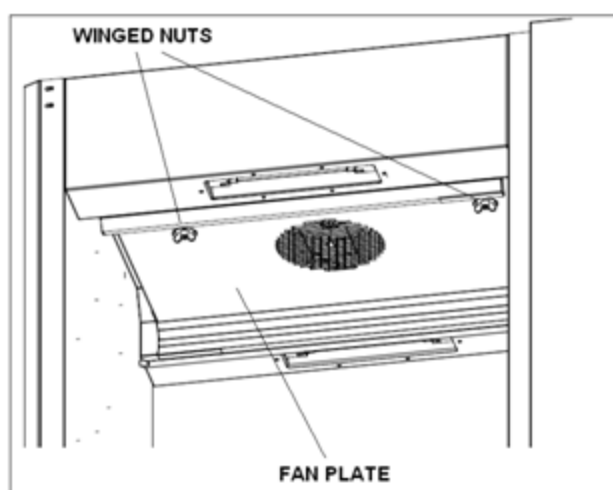

Figure 16

Fan blade:

- Clean the fan blade with a cloth and grill cleaning agent (see Figure 17).
- Dry the fan plate thoroughly by using a dry cloth.

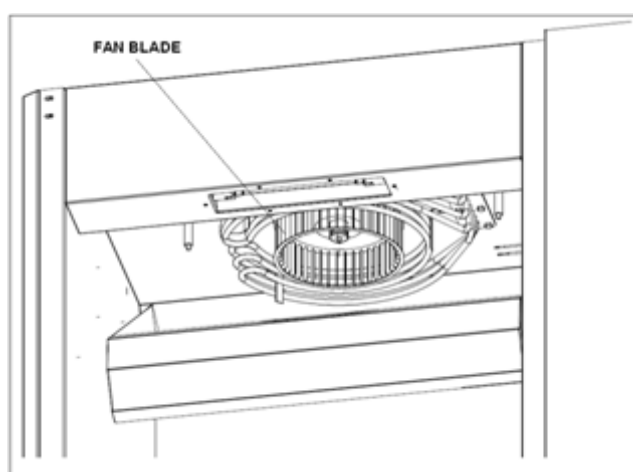

Figure 17

9. MALFUNCTIONS AND SERVICE; WHAT TO DO

Before you contact your supplier/dealer in case of a malfunction, there are some items you can check yourself:

- Is the power supply working properly? Check fuses and differential switch.
- Has the timer clock been properly set?

Item	Malfunction	Possible action
Control	Program do not start	<ul style="list-style-type: none"> • Check if both doors are closed correctly.
Fan	Fan not spinning	<ul style="list-style-type: none"> • Remove the plug from the socket. • Open the door. • Remove fan plate (see section 8.2) and check what's blocking the fan blade.
Fan	Noisy fan	<ul style="list-style-type: none"> • Fan polluted, clean (see section 8.2).
Lamp	Does not light up	<ul style="list-style-type: none"> • Set OFF in manager menu. • Defect, refer to section 9.2.
Oven	Product is not getting done equally	<ul style="list-style-type: none"> • Try a lower cooking temperature. • Check fuses and/or the differential switch.
Oven	The oven does not heat up	<ul style="list-style-type: none"> • Open and close door. • Check fuses and/or the differential switch.
Mains cord	Damaged	<ul style="list-style-type: none"> • Replace, see section 9.1

9.1. Replacing the mains cord



WARNING

Hazardous electrical voltage.

If the mains cord is damaged, it must be replaced by the manufacturer, his service agent or a similarly qualified person in order to avoid hazards.

9.2. Replacing a lamp



WARNING

Remove the power plug from the wall socket.



WARNING

Do not touch the lamps with bare hands. **Use a clean cloth or paper tissues when replacing the lamp**

Remove any moisture with alcohol or methyl spirits after the lamp has cooled down

1

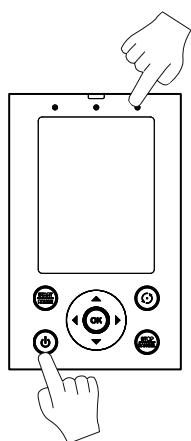

2

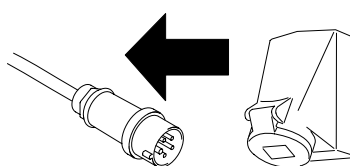

- Press buttons together and hold for approx. 3 seconds.

3. Remove the broken lamp by moving it in the length-direction of the lamp holder
4. Install the new lamp (230 V – 500 W). First press one side of the lamp into the lamp holder (A). Press lamp in its correct position (B) and use its spring pressure to make contact with the other terminal (see Figure 18).
5. Make sure the lamp is correctly clamped between the two terminals (C). If this is not the case, the lamp can move freely along its length-direction, until it is fixed into its terminals.

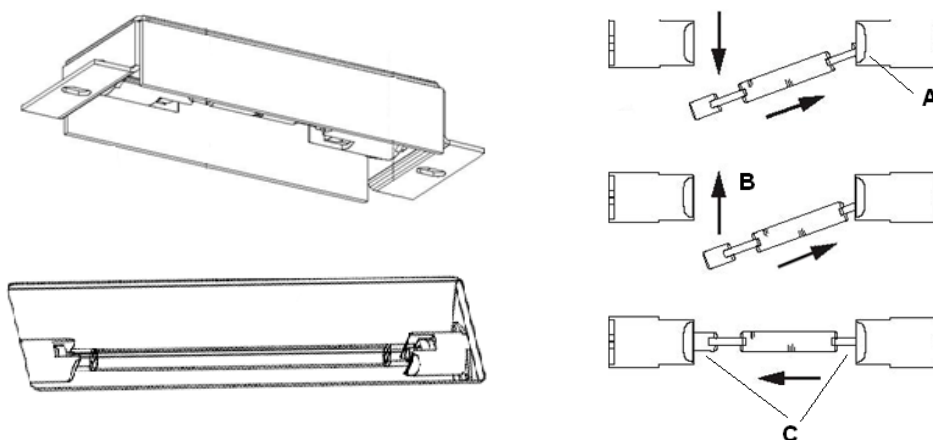

Figure 18

10. TECHNICAL SPECIFICATIONS



WARNING

Consult the identification plate to get the proper specifications of the unit. The electrical data may vary from country to country.

The technical specifications of the different models in the TDR-series, are shown in the next tables. For the TDR-TRC combination refer to the TRC manual.

European Models

Model	TDR 5	TDR 8	TDR 5+5	TDR 8+8
Dimensions				
- Width	835 mm	995 mm	835 mm	995 mm
- Depth	710 mm	830 mm	710 mm	830 mm
- Height	895 mm	1050 mm	1775 mm	2080 mm
Weight				
- Gross	160 kg	216 kg	300 kg	435 kg
- Nett	130 kg	185 kg	266 kg	375 kg
Maximum ambient temperature	35 °C	35 °C	35 °C	35 °C
Sound pressure	< 70 dB(A)	< 70 dB(A)	< 70 dB(A)	< 70 dB(A)
Electrical installation				
- Voltage	3N~ 400/230 V	3N~ 400/230 V	3N~ 400/230 V	3N~ 400/230 V
- Frequency	50...60 Hz	50...60 Hz	50...60 Hz	50...60 Hz
- Required power	6.6 kW	10,5 kW	13.2 kW	21 kW
- Max. nom. current	10.0 A	15.5 A	20 A	31 A
Plug ¹	CEE-form 16 A	CEE-form 16 A	CEE-form 32 A	CEE-form 32 A
Length of power cable	approx. 2,20 m	approx. 2,20 m	approx. 2,20 m	approx. 2,20 m

American Models

Model	TDR 5	TDR 7	TDR 5+5	TDR 7+7
Dimensions				
- Width	32 ⁷ / ₈ "	39 ³ / ₁₆ "	32 ⁷ / ₈ "	39 ³ / ₁₆ "
- Depth	28 "	32 ⁵ / ₈ "	28 "	32 ⁵ / ₈ "
- Height	35 ¹ / ₄ "	41 ⁵ / ₁₆ "	69 ⁷ / ₈ "	81 ⁷ / ₈ "
Weight				
- Gross	353 lb	476 lb	661 lb	959 lb
- Nett	287 lb	408 lb	586 lb	827 lb
Maximum ambient temperature	95 °F	95 °F	95 °F	95 °F
Sound pressure	< 70 dB(A)	< 70 dB(A)	< 70 dB(A)	< 70 dB(A)
Electrical installation				
- Voltage	3~ 208 V	3~ 208 V	3~ 208 V	3~ 208 V
- Frequency	50/60 Hz	50/60 Hz	50/60 Hz	50/60 Hz
- Required power	6.6 kW	10.5 kW	2x 6.6 kW	2x 10.5 kW
- Max. nom. current	18.9 A	30.8 A	2x 18.9 A	2x 30.8 A
Plug	NEMA15-30P	NEMA 15-50P	2x NEMA 15-30P	2x NEMA 15-50P
Length of power cable approx.	75 "	75 "	2 x 75 "	2 x 75 "

¹ Depending on Country

11. ACCESSORIES

For all rotisserie models in the TDR -series mentioned in this manual, the following accessories are available:



meat fork

V-spit

Figure 19

For the TDR 5 and TDR 5 + 5 specifically:



multi purpose basket

chicken rack

Figure 20

For the TDR 8 and TDR 8 + 8 specifically:

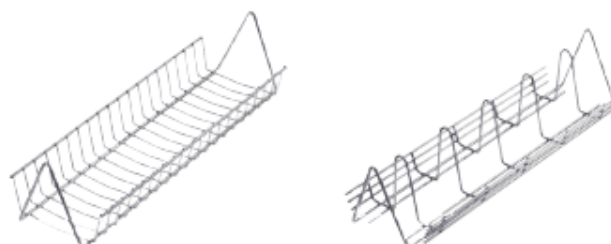

meat basket

chicken rack

Figure 21

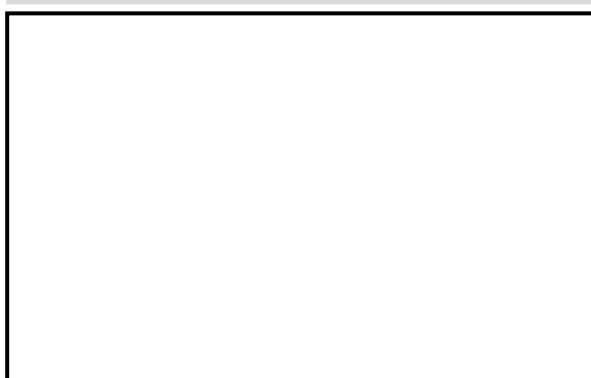
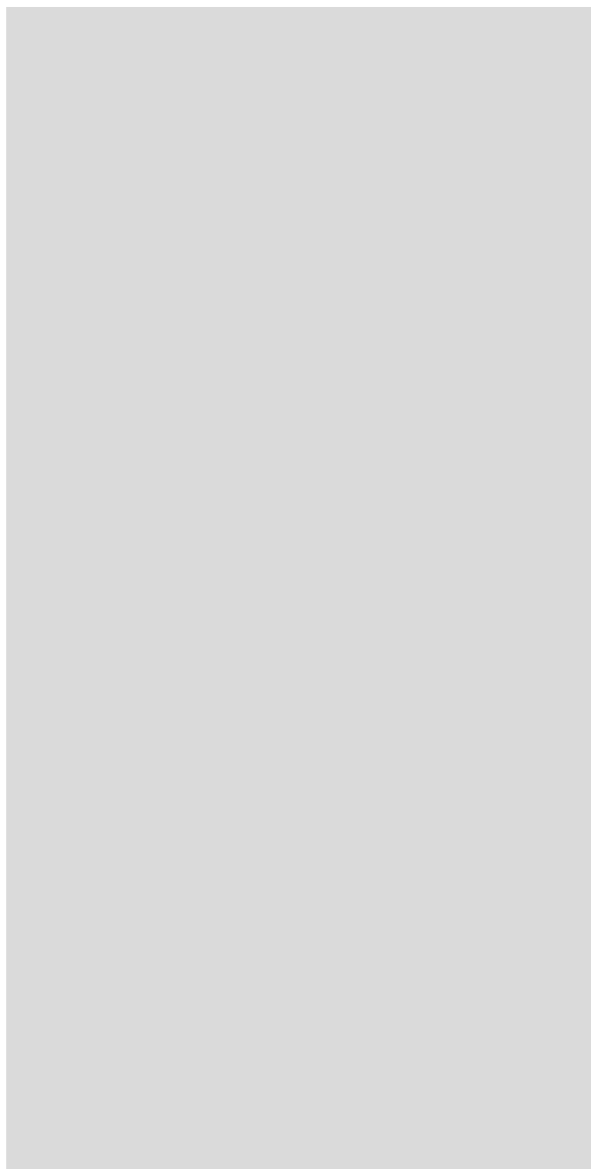

Fri-Jado BV
Oude Kerkstraat 2
4878 AA Etten-Leur
The Netherlands

Tel: +31 (0) 76 50 85 400
Fax: +31 (0) 76 50 85 444