

MODEL: ECMR-250

Dimmer module receiver

FEATURE:

- Self program, 67 million codes.
- ON/OFF/DIMMER function.
- Suitable only for lights, 230V incandescent or halogen lamp.
- Connect with (non-dimmable) electronic transformer for 12V halogen lamp.
- Not suitable for traditional transformer.
- 6 memories for scene setting.
- Green LED indication.
- Compatible to all KAPPA transmitters.
- Standby power consumption: 1 W.

INSTALLATION: (Fig. 1)

- Disconnect main power line.
- Connect LIVE AC 230V wire to ECMR-250 port L↓
- Connect LIVE lamp wire to ECMR-~~250~~ 250 port
- Connect Neutral AC 230V wire to lamp.
- Turn on main power line.
- LED indicator light on and load light on.

HOW TO SET / DELETE CODE WITH KAPPA

TRANSMITTER:

SET (LEARN) CODE: (Fig. 2)

- After correct installation, switch on the main power.
- Bring the transmitter near the receiver, push the self program button on receiver once.
- Receiver LED will blink slowly, press transmitter selected "ON" button.
- Receiver connected lamp will blink twice, code is confirmed and LED stops blinking.
(Remember the transmitter button you selected for the programmed receiver.)
- Transmitter and receiver code is auto programmed.
- Same procedure to link with KAPPA code switch transmitter.



Fig.1

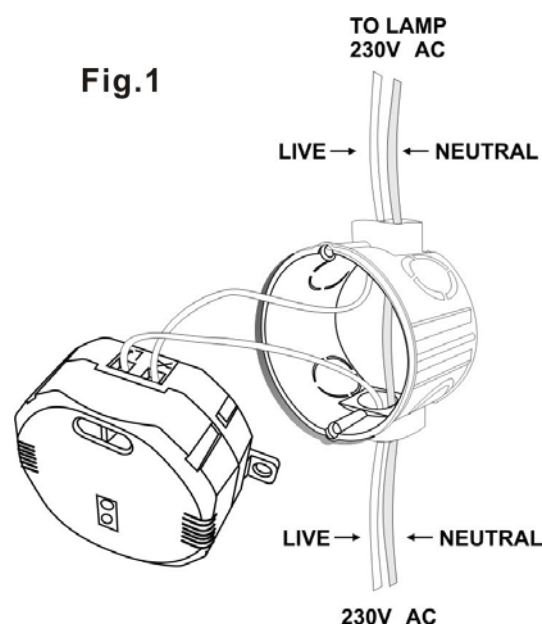
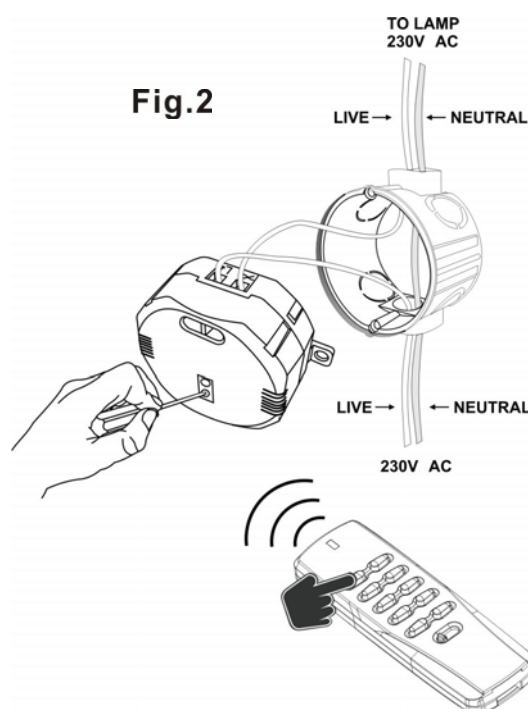

Fig.2



DELETE CODE: (Fig. 3)

Delete individually –

- Push the self program button once, LED will blink slowly.
- Press selected “OFF” button on transmitter, selected programmed memory is deleted.
- Receiver connected lamp will blink twice for confirmation. LED stops blinking.
- Repeat step for re-setting.

Delete ALL memories – (Fig. 4)

- Push the self program button till LED blinks continuously.
- Release and push again once.
- Receiver connected lamp will blink twice for confirmation.
- All programmed memories will be deleted from receiver.

Fig.3

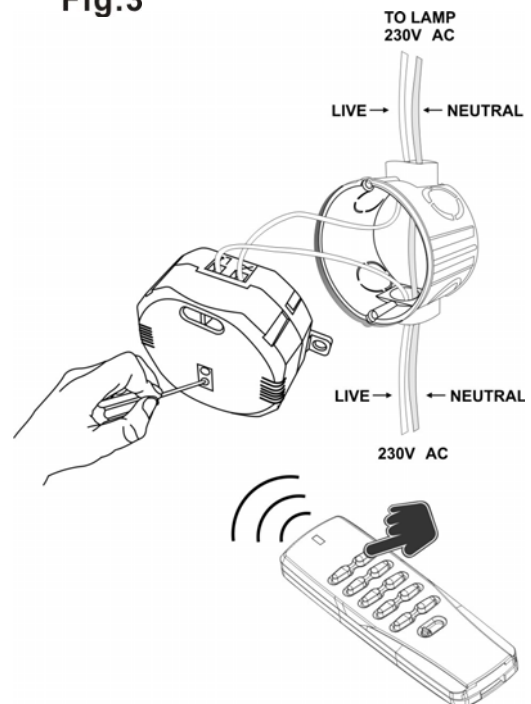
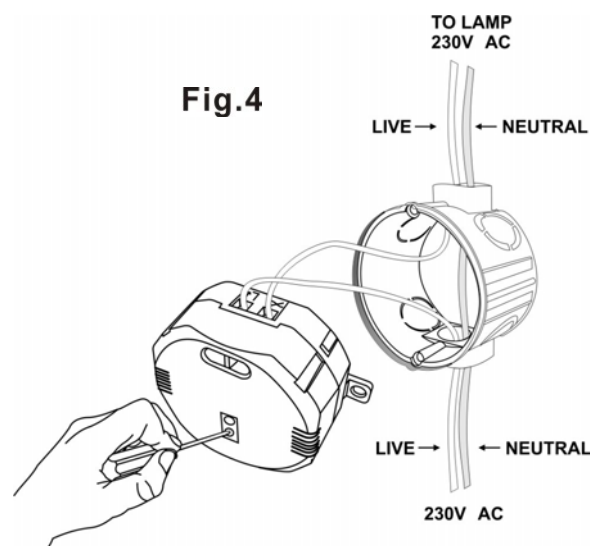

Fig.4



OPERATION:

On transmitter:

- Switch “ON” function – press “ON” button once.
- Switch “OFF” function – press “OFF” button once.
- “DIMMING” function – press “ON” button first time to switch on, then press a second time “ON” button start to dim. When light reaches wanted brightness level, press “ON” button again to stop dimming.

** If not manual to stop dimming, after light running up/down 4 cycles, ECMR-250 will automatically stops dimming at last selected brightness level.

** Next time lamp switched on will stay at last brightness level before switching off.

SCENE SETTING:

RECEIVER HAS 6 MEMORY SETTINGS:

* It can be programmed to switch ON at one time individually or programmed with different combinations switching.

* This means one receiver can be programmed into max. 6 different combinations.

Example: if there are 3 receivers

[receiver 1= lamp shade, receiver 2= night light, receiver 3= ceiling light]

Receiver 1,2,3 can be control individually with transmitter button 1,2,3

Receiver 1,3 can be programmed with transmitter button 4, (lamp shade and ceiling light ON/OFF at same time)

Receiver 1,2,3 can also be programmed into group function ALL ON or OFF at same time into group button (lamp shade, night light and ceiling light ON/OFF at same time)

(Above settings 'Receiver 1' and '3' takes up 3 programmed memory and 'Receiver 2' only 2 program memory.

Different combinations and settings can be teamed up and controlled from transmitter)

SPECIFICATION:

Frequency: 433.92 MHz

Power: 230V~+/-10%, 50Hz

Output: 40 W / VA – 250 W / 210 VA

Transmission distance: 50 meter (open field)

Load type:

- Incandescent lamp (high voltage 230V) and halogen lamp (high voltage 230V);
- Electronic transformer (non-dimmable) for halogen lamp low voltage 12V. (eg. Fig. 5)

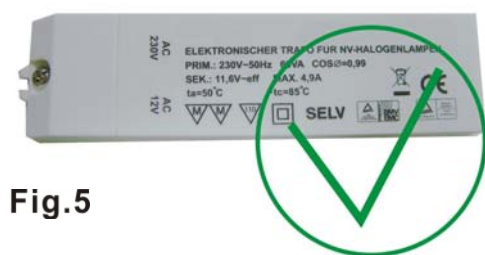

Fig.5

Note:

1. When connecting with (non-dimmable) electronic transformer for low voltage 12V halogen lamp, to calculate load, add the VA ratings of the transformers (not the wattage of the lamps). At this moment, the load for ECMR-250 means this electronic transformer (VA) not the lamp. (Fig. 6)



Fig.6

WARNING!

- Do not overload.
- Do not place two receivers near each other, the distance should be above 3 meters.
- Do not use in damp places like patios, cellar, flammable liquid, solvents, paints etc.
- Do not use with fluorescent or compact fluorescent lamps (CFL);
- Do not use with traditional transformers (conventional, wire-wound or toroidal transformers);
- Do not use with electric motors.
- Wrong application of traditional transformers (conventional, wire-wound or toroidal transformers) will cause ECMR-250 out of function. (eg. Fig. 7)

Fig.7