

Epson Revolutionises Projector Market with the 3LCD Technology and Retains World No.1 Leadership* for 8 Consecutive Years!

* (Based on independent research by FutureSource Consulting)

Advantages of 3LCD Projection System

Bright Images and Faithful Colour Reproduction

3LCD projectors offer all-time colour (Red, Green and Blue) projection thereby ensuring faithful full colour reproduction. This is suitable for projection of colour intensive images such as videos, photographs and colour charts.

Incredible Details

3LCD projectors are able to produce an unparalleled range of grayscale images thus delivering incredible colour images that is smooth and seamless.

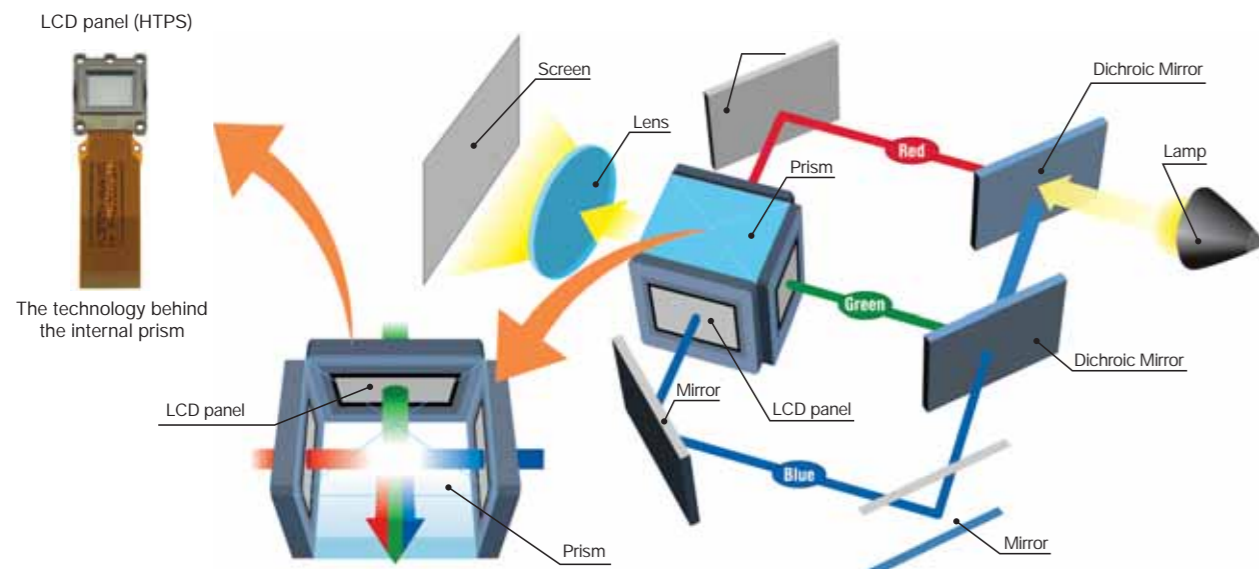

3LCD projector : RGB are projected at the same time so that it is easy on the eyes.



*HTPS (High Temperature Poly-Silicon) is an active matrix transmissive LCD. It is extremely small and produces high quality images.

Gentle on the Eyes

3LCD projectors' images do not suffer from colour break-up (commonly known as rainbow effect). The projections are easy on the eyes as you will not be affected by any distorted pattern.

3LCD projectors use 3 separate LCD panels to form a continuous image containing all colours (red, blue and green) ensuring smooth video playback; even for rapid-motion images.

Reliable Technology

With more than 60 million 3LCD chips shipped to date, the powerful and road-tested 3LCD projection technology is extremely reliable and is trusted by many throughout to deliver sharp and true-to-life images.

Cited from 3LCD Business Centre Press Release: 3LCD Achieves Projection Industry Milestone: 60 Million Chips Shipped, 12 October 2009

Weight - approx. 3.5kg / 7.82lbs



SUPPLIED ACCESSORIES	
Power Cable	3.0m
Remote Control	With AA type alkaline batteries 2pcs
Computer Cable	1.8m ϕ 4.5 - AHD-15 pin type slim-cable
USB Cable	3.0m
Soft Carrying Case	Except EB-1900
Password Protect Sticker	
User's Manual	
Epson Projector Software for Meeting & Presentation (EB1915)	
Epson Projector Software for Meeting & Monitoring (EB1910)	
Wireless LAN Unit	ELPAP03 (EB-1915)

OPTIONAL ACCESSORIES	
ELPLP53	Spare Lamp
ELPAF24	Air Filter Set
ELPAP06	Quick Wireless Connection USB Key
ELPAP03	Wireless LAN Unit
ELPDC06	USB Document Camera

PROJECTION DISTANCE (EB-1900/1910/1915)

A:2 Screen Size	Screen Distance	Projection Plane	Offset
60" / 1524mm	197 / 78	321 / 126	8 / 3.3
80" / 2032mm	258 / 101	430 / 169	11 / 4.4
100" / 2540mm	332 / 131	538 / 212	14 / 5.5
120" / 3048mm	418 / 164	646 / 255	18 / 7.1
140" / 3546mm	515 / 202	754 / 297	23 / 9.1

EPSON is the registered trademark of Seiko Epson Corporation.

All other product names and other company names used herein are for identification purposes only and are the trademarks or registered trademarks of their respective owners.

EPSON disclaims any and all rights in those marks. Scan/Print samples shown herein are simulations. Specifications are subject to change without notice.

EPSON
EXCEED YOUR VISION

www.epson.com.sg

SPECIFICATIONS

Multimedia Projector EB-1900/1910/1915

MODEL NUMBER	EB-1900	EB-1910	EB-1915
SPECIFICATION OF MAIN PARTS	LCD	SIZE PIXEL NUMBER NATIVE RESOLUTION	0.7-inch x 3 786,432 dots (1024 x 768) x 3 N/A Manual Focus & 1.6 x Optical zoom F-number = 1.75 - 2.42 / Focal Length = 24.0 - 38.2mm 230W / 13W 2500 hours (Power Consumption: Normal) / 3500 hours (Power Consumption: ECO)
PROJECTION LENS			Power Focus & 1.6 x Optical zoom
LAMP			TYPE LIFE
SCREEN SIZE			30" to 300" (816 to 16.24m)
OFFSET			10:1
LIGHT OUTPUT*			BRIGHTNESS CONTROL: NORMAL / ECO 4000 lm / 2700 lm
COLOUR LIGHT OUTPUT*			4000 lm
CONTRAST			2000:1
SOUND OUTPUT			N/A 10W / Manual
KEYSTONE CORRECTION			VERTICAL HORIZONTAL
			Yes (Manual) Yes (Auto / Manual) Yes (Auto / Manual)
SCREEN FIT			N/A Yes
ANALOG RGB	INPUT TERMINAL OUTPUT TERMINAL	VIDEO AUDIO VIDEO	D-sub 15 pin x 1 N/A N/A D-sub 15 pin x 2 Stereo Mini x 2 D-sub 15 pin x 1 Stereo Mini x 1
VIDEO	INPUT TERMINAL	VIDEO	Composite Video: RCA x 1 (Yellow) S-Video: Mini DIN x 1 Component Video: D-sub 15 pin x 1 (corresponds with Analog RGB connector) RGB Video: D-sub 15 pin x 1 (corresponds with Analog RGB connector)
DIGITAL INPUT TERMINAL		AUDIO	N/A RCA x 1 (White/Red)
CONTROL	USB I/O SERIAL	TERMINAL SPEED TERMINAL SIGNAL	USB Type B x 1 USB Type B Ver. 2.0 D-sub 9 pin x 1 RS232C
MEMORY		TERMINAL SPEED	N/A N/A USB Type A x 1 (for USB Memory / for Document Camera) USB Type A x 2 (for USB Memory / for Document Camera)
NETWORK FOR PROJECTION	WIRED LAN WIRELESS	TERMINAL SUPPORT SPEEDS FOR EACH MODE	N/A N/A RJ45 x 1 100Mbps USB Type A x 1 IEEE 802.11b: 11Mbps** IEEE 802.11g: 54Mbps** IEEE 802.11n: 54Mbps**
PC APPLICATION			N/A N/A USB Display (for Windows) No audio N/A EasyMP Monitor (for Windows)** EasyMP Network Projection (for Windows and Mac) No audio** USB Display (for Windows) with audio Quick Wireless Connection (for Windows) By way of wired LAN / No audio** EasyMP Network Projection (for Windows and Mac) with audio** USB Display (for Windows) with audio** Quick Wireless Connection (for Windows) By way of wired LAN / No audio** EasyMP Slide Converter (for Windows)**
OPERATING TEMPERATURE			5°C to 35°C / 41°F to 95°F*
OPERATING ALTITUDE			Up to 7,500 feet <math><2283m</math>- (over 4,921 feet <math><1500m</math>- area - use with High Altitude mode)
START-UP PERIOD			About 10 sec.
DIRECT POWER ON			Yes
DIRECT POWER OFF			Yes
COOL DOWN PERIOD			Instant off
POWER SUPPLY VOLTAGE			100 - 240 V AC \pm 10%, 50/60 Hz
POWER CONSUMPTION	100 - 120V 220 - 240V	LAMP ON STAND BY LAMP ON STAND BY	317W 0.2W (Network Off) 290W 0.3W (Network Off) 341W 319W
DIMENSIONS EXCLUDE FEET (D x W x H)			257 x 357 x 86mm
WEIGHT			Approx. 7.25lbs. / 3.2kg Approx. 7.54lbs. / 3.4kg Approx. 7.82lbs. / 3.5kg
FAN NOISE	BRIGHTNESS CONTROL: NORMAL / ECO		37dB / 29dB

*Light Output / Colour Light Output / Contrast --- Colour mode: Dynamic, Zoom: Wide
**Maximum speed and range is achievable when used with same enhanced mode technology. Actual data rates, features and performance may vary depending on your computer system, and environment.
***Supplied on included CD-ROM
****Supplied as an option

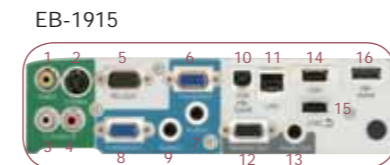

CONNECTOR PANEL	
1	Video Input
2	S-Video
3	Video-L Input
4	Video-R Input
5	RS-232C
6	Computer Input 1
7	Audio Input 1
8	Computer Input 2
9	Audio Input 2
10	USB (Type B)
11	LAN
12	Monitor Out
13	Audio Out
14	USB (Type A) 1
15	USB (Type A) 2
16	HDMI

Dealer's Stamp

Printed in October 2009

Multimedia Projector EB-1900/1910/1915

EPSON
EXCEED YOUR VISION

The Perfect Mobile Projector for Every Business and Classroom Environment



- 4000lm Brightness
- Compact in design without compromising on features
- Hassle-free set up with easy-to-use features

High-performing projector ideal for all successful meetings and classes

Multimedia Projector
EB-1900/1910/1915

Enjoy perfect mobility, easy set-up and user-friendly features!



The ideal tool offers you the best performance in both business meetings and the classroom!

The Epson EB-1900 series is the compact, portable projector series that delivers high-quality projection without the fuss. Packed with all the functions and features you need for impressive presentations in meetings or in the classroom, the Epson EB-1900 series comes in a clean, easy-to-use, easy-to-maintain design, yet packs a punch.

4000lm Brightness

With a brightness of 4000lm projected images are visible and clear even under fluorescent lights or without curtains.



Front heat exhaust vents

The heat exhaust vents is intelligently positioned in the front so that it will not affect the audience seated at the side of the projector.



Lightweight at up to 3.5kg[^]

At a modest leading lightweight of up to 3.5kg[^], the EB-1900 series projector is extremely mobile and easy to carry around.

[^] EB-1900 is at 3.2kg and EB-1910 is at 3.4kg



Hassle-free to set up

Wireless Connection (For EB-1915 only)

With the wireless connectivity feature, the EB-1900 series projector allows you to make a connection between the PC and the projector directly using an access point within a wireless LAN, thus eliminating messy complicated cables and clutter.

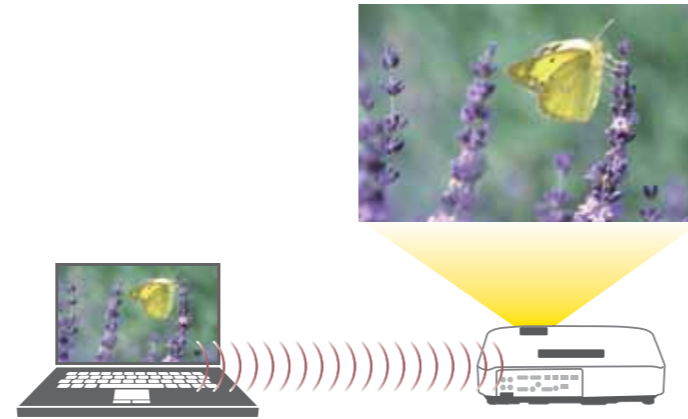

USB Display

With the EB-1900 series projector, you no longer have to deal with complicated set ups. Images can be projected by simply connecting the PC and projector via the included USB cable. In addition, a built-in 10W speaker* allows you to enjoy powerful sound without the need for external speakers.

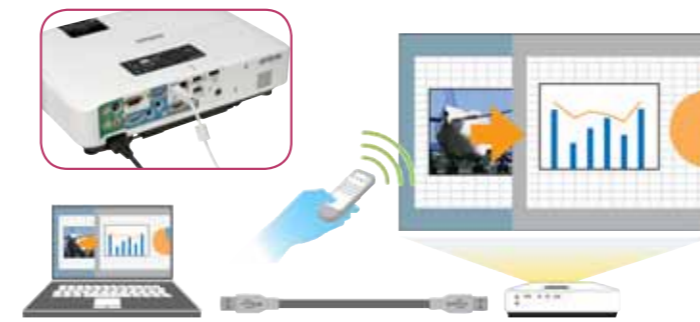

* Excluding EB-1900

User-friendly features for everyone

"Slide Converter" function (For EB-1915 only)

The EB-1900 series projector comes with "Slide Converter" software, allowing presentations to be made directly via a USB memory device, without the need for any PC/laptop.



Easy to share pictures (Excluding EB-1900)

You can view pictures in JPEG format and save them on a USB memory device directly with the EB-1900 series projector. This feature allows pictures to be converted into "scenario files" as a slide show with the use of a remote control or the operation panel.



Instant On/Off

When you finish your presentation, you can pack up and go. There is no need to wait for the projector to cool down.



Direct Power On/Off

With this feature, you can connect the projector directly to the room's power source and switch the projector on and off without having to press the "power" button on the projector.

Easy-to-use features that allow images to be adjusted automatically

Auto H/V Keystone Correction (Excluding EB-1900)

During set-up, the projector automatically adjusts the focus and keystone correction, resulting in perfect images without the need for manual adjustment.



Automatic



"Screen Fit" (For EB-1915 only)

This one touch "Screen Fit" feature adjusts the image vertically and horizontally to fit to the size of the screen or whiteboard.

Note:
EB-1915 is able to adjust images both vertically and horizontally.
EB-1910 is able to adjust images vertically only.

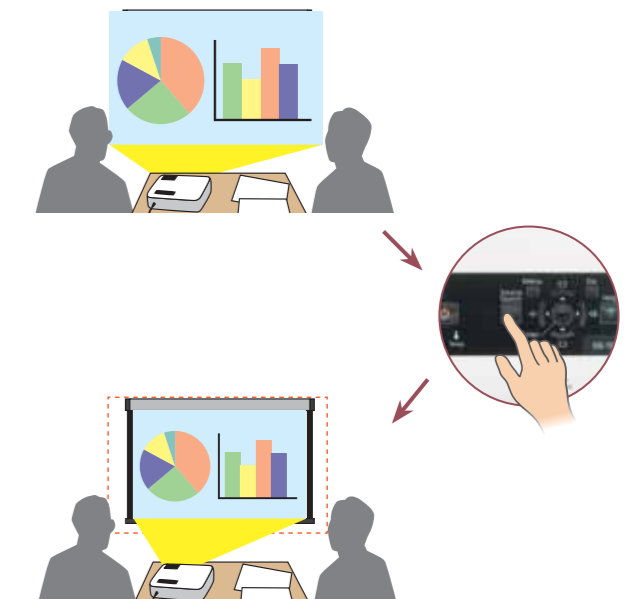

A whole host of connectivity features to choose from

Wide-ranging Connectivity

Choose from a variety of connections including USB*, LAN*, wireless connection** and HDMI**. It is also possible to connect Epson's ELP-DC06*** document camera with a USB cable*

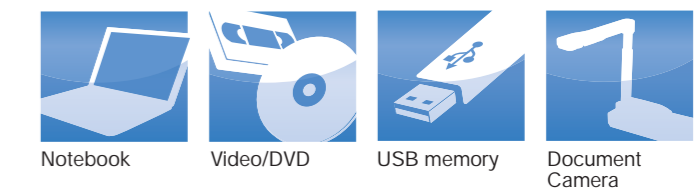

* Excluding EB-1900
** For EB-1915 only
*** Available from end December 2009

