



## Product Specifications

**NAME: LED Single Color Dimmer**

**MODEL: GN-DIM002**



### Summarization

### User Manual

RF dimmer is a controller that can adjust brightness infinitely and change to flash, its control mode is wireless control, you could adjust light to the appropriate lighting brightness in accordance with your actual need.

### Technical parameters

- working temperature: -20-60 ℃
- supply voltage: 12-24V
- output: 1 channel
- net weight: 100g
- gross weight: 130g
- external dimension: L110 X W56 X H34 mm
- packing size: L122X W85 X H42 mm
- rated load current: <8A
- output power: 12V<96W,24V<192W

# Product Specifications

## Dimension

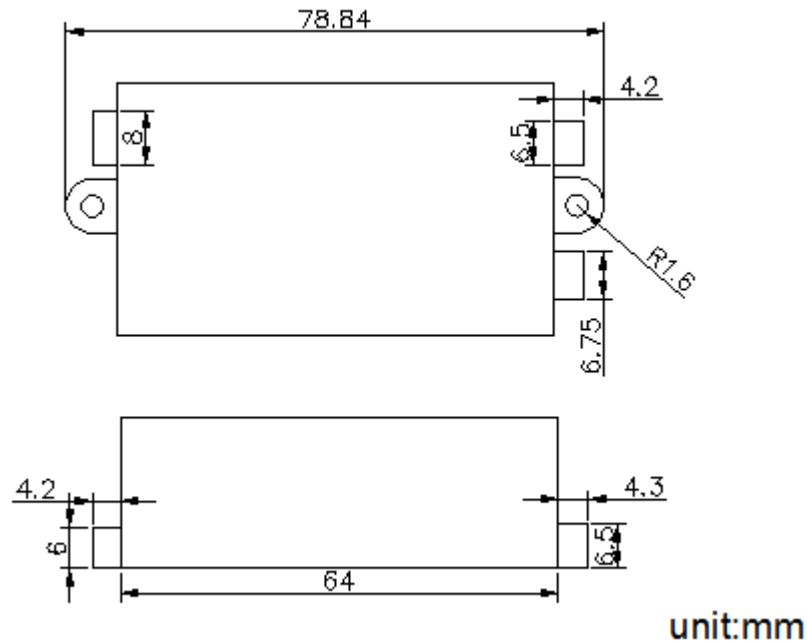

## Interface specifications

### Input interface :



### Output interface :



### Direction for use

1. Connect the load wire at first, following by the power wire; Please ensure short circuit can not occur between connecting wire before you turn on the power;

2. Adopt wireless control. its function as follows:

△ key is for increasing brightness,

▽ key is for reducing brightness,

Remark: when pressing △ key and the ▽ key meanwhile, that will cut the change pattern. Pressing the both buttons, the lights will be shifted to flash! And then pressing both buttons again, the buttons are again used to adjust brightness of lights!

# Product Specifications

## Typical Applications

