

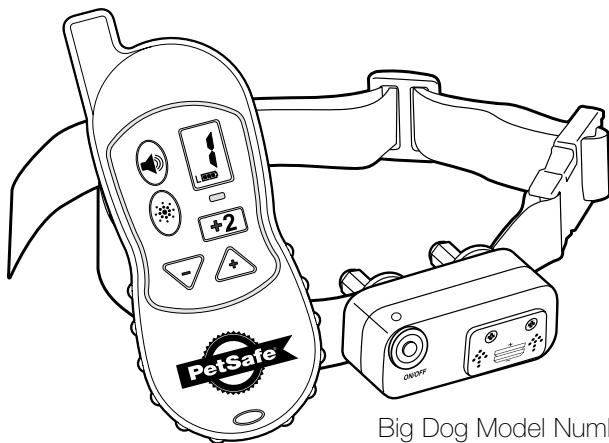

protect. teach. **love.**

Remote Trainer

operating and training guide



Big Dog Model Number
PDT00-13411

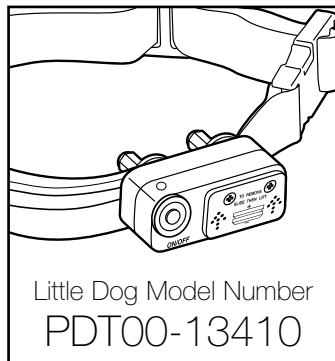

Little Dog Model Number
PDT00-13410

PLEASE READ THIS ENTIRE GUIDE BEFORE BEGINNING

Important Safety Information

Explanation of Attention Words and Symbols used in this guide



This is the safety alert symbol. It is used to alert you to potential personal injury hazards. Obey all safety messages that follow this symbol to avoid possible injury or death.

! WARNING

WARNING indicates a hazardous situation which, if not avoided, could result in death or serious injury.

! CAUTION

CAUTION, used with the safety alert symbol, indicates a hazardous situation which, if not avoided, could result in minor or moderate injury.

CAUTION

CAUTION, used without the safety alert symbol, indicates a hazardous situation which, if not avoided, could result in harm to your pet.

! WARNING

Not for use with aggressive dogs. Do not use this Product if your dog is aggressive, or if your dog is prone to aggressive behavior. Aggressive dogs can cause severe injury and even death to their owner and others. If you are unsure whether this product is appropriate for your dog, please consult your veterinarian or certified trainer.

! WARNING

Risk of explosion if battery is replaced by an incorrect type. Do not short circuit, mix old and new batteries, dispose of in fire, or expose to water. When batteries are stored or disposed, they must be protected from shorting. Dispose of used batteries properly.

! CAUTION

Safety during on-leash training. It is vitally important that you and your dog remain safe while learning during on-leash training. Your dog should be on a strong leash, long enough for him to attempt to chase an object, but short enough for him not to reach a road or other unsafe area. You must also be physically strong enough to restrain your dog when he tries to chase.

CAUTION

Risk of skin damage. Please read and follow the instructions in this manual. Proper fit of the collar is important. A collar worn for too long or made too tight on the pet's neck may cause skin damage. Ranging from redness to pressure ulcers; this condition is commonly known as bed sores.

- Avoid leaving the collar on the dog for more than 12 hours per day.
- When possible reposition the collar on the pet's neck every 1 to 2 hours.
- Check the fit to prevent excessive pressure; follow the instructions in this manual.
- Never connect a lead to the electronic collar; it will cause excessive pressure on the contacts.
- When using a separate collar for a lead, don't put pressure on the electronic collar.
- Wash the dog's neck area and the contacts of the collar weekly with a damp cloth.
- Examine the contact area daily for signs of a rash or a sore.

- If a rash or sore is found, discontinue use of the collar until the skin has healed.
- If the condition persists beyond 48 hours, see your veterinarian.
- For additional information on bed sores and pressure necrosis, please visit our website.

These steps will help keep your pet safe and comfortable. Millions of pets are comfortable while they wear stainless steel contacts. Some pets are sensitive to contact pressure. You may find after some time that your pet is very tolerant of the collar. If so, you may relax some of these precautions. It is important to continue daily checks of the contact area. If redness or sores are found, discontinue use until the skin has fully healed.

The PetSafe® Remote Trainer must be used only on healthy dogs. We recommend that you take your dog to a veterinarian before using the collar if he is not in good health.

Thank you for choosing PetSafe®, the best selling brand of electronic training solutions in the world. Our mission is to be the most trusted brand in the pet ownership experience. We want to ensure your pet's safety by providing you with the tools and techniques to successfully train your pet. If you have any questions, please contact the Customer Care Center at 1-800-732-2677 or visit our website at www.petsafe.net.

To get the most protection out of your warranty, please register your product within 30 days at www.petsafe.net. By registering and keeping your receipt, you will enjoy the product's full warranty and should you ever need to call the Customer Care Center, we will be able to help you faster. Most importantly, PetSafe® will never give or sell your valuable information to anyone. Complete warranty information is available online at www.petsafe.net.

Table of Contents

Components.....	5
Other Items You May Need	5
How the System Works	6
Features.....	6
Key Definitions	7
Operating Guide	9
Prepare the Remote Transmitter	9
Prepare the Receiver Collar	11
Fit the Receiver Collar.....	12
To Pair the Remote Transmitter and Receiver Collar	14
Training Guide	15
General Tips.....	15
Teaching Your Pet the Positive Tone.....	15
Find the Best Stimulation Level for Your Pet	16
+2 Boost	16
Teaching Basic Obedience	17
The “Sit” Command	17
The “Come” Command.....	17
The “Stay” Command	18
Eliminating Unwanted Behavior.....	19
Jumping Up.....	19
Digging	20
Chasing	21
Trash Raiding	22

Frequently Asked Questions	23
Troubleshooting	24
Test Light Instructions	24
Customer Care International	25
Terms of Use and Limitation of Liability	25
Compliance	26
Perchlorate Battery	26

Components



Remote
Transmitter

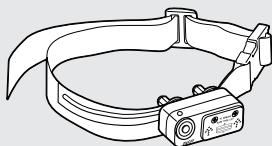

PDT00-13410 Little Dog
Receiver Collar

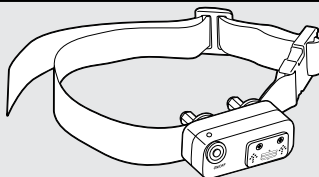

PDT00-13411 Big Dog
Receiver Collar



Wrist Strap



Test Light
Tool



3-volt
Lithium
Batteries
(CR2032)



Operating and
Training Guide

Other Items You May Need

- Small Phillips screwdriver
- Pliers
- Scissors
- Lighter
- Non-metallic collar and 10-foot leash

How the System Works

Now you can experience the difference a Remote Trainer can make. Spend less time training and more time enjoying your dog. The PetSafe® Remote Trainer is easy to use with an advanced digital display that tells you exactly what level of stimulation you are using.

The Remote Trainer assists you in controlling your pet without a leash in a range of up to 100 yards. At the push of a button, your remote sends a signal activating your dog's Receiver Collar. He receives a safe but annoying stimulation. He'll quickly learn the association between his behavior and your correction; in no time, you'll have a better-behaved pet. The PetSafe® Remote Trainers have been proven safe, comfortable, and effective for both small and large dog breeds.

Using the Remote Trainer consistently and correctly, any basic obedience commands can be taught and many misbehaviors that your pet exhibits can be corrected.

Important: The Remote Trainer has a range up to 100 yards. Hold the Remote Transmitter in a horizontal position away from your body to achieve optimum range. Terrain, weather, vegetation, transmission from other radio devices, and other factors will affect the maximum range.



Features

- Range up to 100 yards
- 16 levels of stimulation (8 low levels and 8 high levels) and a “+2 Boost” button that instantly increases the current Stimulation Level by 2 when pressed (will not exceed the 8 High Stimulation Level)
- Tone only button
- Easy to read Digital Display on Transmitter displays current Stimulation Level and battery status
- Waterproof Receiver Collar

Key Definitions

Remote Transmitter: Transmits the signal to the Receiver Collar.

Tone Only Button (Green): Sends an audible tone to the collar. No stimulation is delivered.

Stimulation Only Button (Yellow): Delivers stimulation through the Contact Points on the Receiver Collar at the level shown on the Digital Display. When held down for 12 consecutive seconds, the Transmitter will “time-out”, and you must release and press the button again before additional stimulation can be delivered.

+2 Boost Button (Red): When pressed, instantly adds a boost of 2 levels above current Stimulation Level. Can not exceed the 8 High Stimulation Level.

Stimulation Down Button (-): Decreases Stimulation Level by 1.

Stimulation Up Button (+): Increases Stimulation Level by 1.

Digital Display: Indicates Stimulation Level, pairing mode and battery status. See Prepare the Remote Transmitter section for more details.

Transmitter LED Indicator Light: 3 colors indicate which function the Transmitter is currently performing.

Green LED: Indicates tone is being transmitted.

Red LED: Indicates stimulation is being transmitted. Also indicates low battery.

Orange LED: Indicates pairing command is being transmitted.

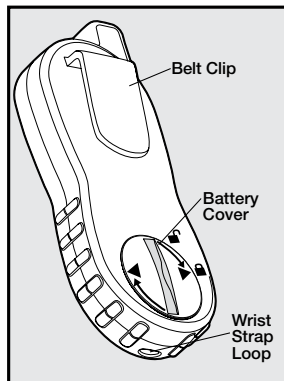
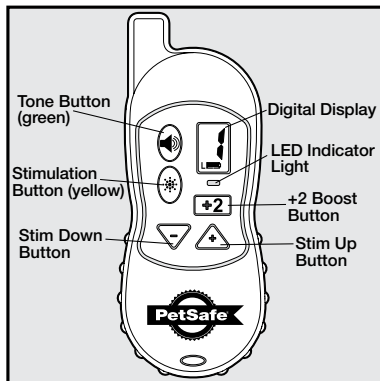

Receiver Collar: Delivers stimulation or tone on a signal from the Remote Transmitter. It is waterproof.

Antenna: Receives the signal that is emitted from the transmitter. The antenna on the Little Dog Receiver Collar is inside the nylon collar. The antenna is internal for the Big Dog Receiver Collar.

On/Off Button: Momentarily pressing and holding this button turns the Receiver Collar on and off.

Contact Points: Deliver stimulation to your pet from the Remote Transmitter.

Receiver Indicator Light: Indicates that a button is pressed and also serves as a low-battery indicator.

Red LED: Indicates low battery and when static stimulation button is pressed.

Green LED: Indicates good battery and when tone button is pressed. Also indicates when pairing mode is complete.

Little Dog Receiver Collar PDT00-13410

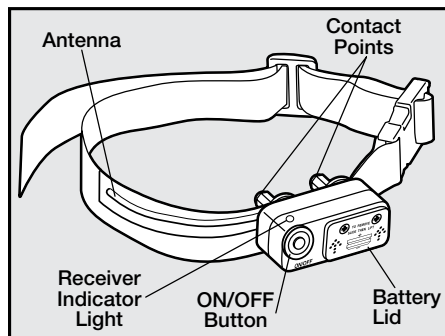

Big Dog Receiver Collar PDT00-13411

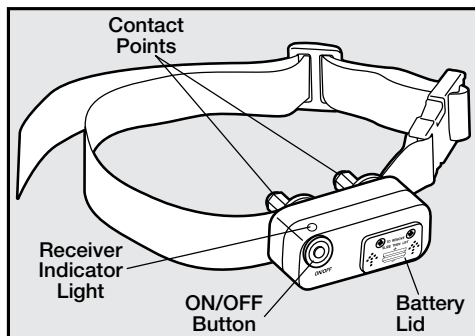

Operating Guide

Step 1 Prepare the Remote Transmitter

To Insert and Remove the Battery

1. To remove, use the Test Light Tool or a coin and turn the battery cover counter-clockwise until the right triangle aligns with the unlock symbol on the Transmitter housing (1A).
2. Install two (2), 3-volt (CR2032) batteries positive (+) side up (1B).
3. To replace the battery cover, align the right triangle with the unlock symbol, press down and turn clockwise (1C) so that the right triangle aligns with the lock symbol on the Transmitter housing.

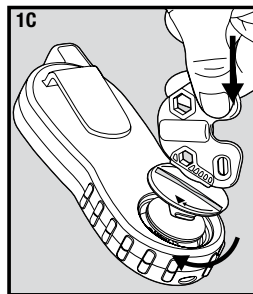
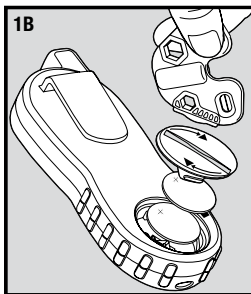
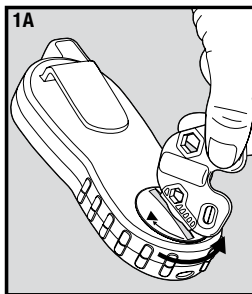

To verify the batteries are inserted correctly





1. Press any button on the Remote Transmitter.
2. The Digital Display should activate showing the current correction level.
3. If the Digital Display doesn't activate, you may have inserted the batteries backwards. Try taking them out and turning them over, ensuring that the (+) side is up.
4. If the Digital Display still does not activate, contact the Customer Care Center.

⚠ WARNING

Risk of explosion if battery is replaced by an incorrect type. Do not short circuit, mix old and new batteries, dispose of in fire, or expose to water. When batteries are stored or disposed, they must be protected from shorting. Dispose of used batteries properly.

Transmitter Digital Display

The display stays on for approximately 30 seconds after a button press. After 30 seconds with no button press, the display shuts off and the Transmitter goes into battery conservation mode. Pressing any button will turn the display back on. The symbols on the display are explained below.

	L indicates low stimulation levels ranging from 1-8, and appears in the lower left corner before the battery indicator.
	H indicates high stimulation levels ranging from 1-8, and appears in the lower right corner after the battery indicator.
	The battery indicator provides constant awareness of your battery's power level. Divided into segments, 3 indicates high battery power, 2 indicates medium, 1 indicates low (replace soon) and no bars indicate critically low (replace immediately). <i>Note: Red LED will flash 3 times every 5 seconds to indicate low battery.</i>
	Indicates Transmitter is ready to pair with Receiver Collar. Press Down (-) button through the stimulation levels to display and begin pairing.

Transmitter LED Indicator Light – Function and Response

Button	Button Function	Transmitter Indicator Light Response
Tone (green)	Delivers audible tone to collar	Green LED on for length of button press
Stimulation (yellow)	Delivers stimulation to collar based on current level shown on Digital Display (stimulation will time-out if pressed continuously for 12 seconds or longer and will reset after release)	Red LED on for length of button press <i>Note: Red LED will also flash 3 times every 5 seconds to indicate low battery.</i>
+2 Boost (red)	Delivers stimulation at 2 levels higher than the current setting (can not exceed level 8 High and will also time-out after button is held for 12 continuous seconds)	Red LED on for length of button press
Tone and Stimulation Buttons held simultaneously	Transmits Pairing command to Receiver Collar when P is visible on Digital Display	Orange LED on for length of button press

Step 2 Prepare the Receiver Collar

To Insert and Remove the Batteries

1. Remove the screws with a small Phillips screwdriver, applying adequate pressure for the screwdriver head to fit snugly into the screw (2A).
2. Push the Battery Lid up according to the arrows stamped on the Battery Lid (2A).
3. Slide the Battery Lid out.
4. Install two (2), 3-volt batteries positive (+) side up (2B). Slide the Battery Lid into the Receiver Collar.
5. Reinstall the screws (2B). Do not over-tighten the screws.

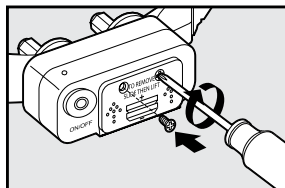
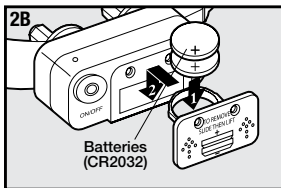
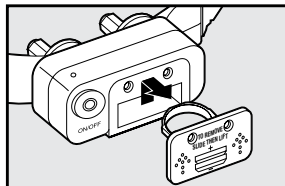
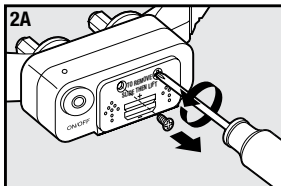

Replacement batteries (3-volt, CR2032) can be found at many retailers. Contact the Customer Care Center or visit our website at www.petsafe.net for a list of common retailers.

⚠ WARNING Risk of explosion if battery is replaced by an incorrect type. Do not short circuit, mix old and new batteries, dispose of in fire, or expose to water. When batteries are stored or disposed, they must be protected from shorting. Dispose of used batteries properly.

To turn Receiver Collar On

1. Press and hold the On/Off Button until the unit beeps and the Green LED light comes on. (This takes approximately one second.)
2. Release the On/Off Button.

In normal mode, the Green LED will flash once every 5 seconds, indicating the Receiver Collar is on and ready to receive a signal from the Handheld Transmitter.

To turn Receiver Collar Off

1. Press and hold the On/Off Button until the unit beeps and the LED light shuts off. (This takes approximately 3 seconds.)
2. Release the On/Off Button. *Note: To extend the life of the batteries, turn the Receiver Collar off when it is not in use.*

Important: If the Receiver Collar is left on continuously, the maximum battery life will be two weeks.

Receiver Indicator Light – Function and Response

Receiver Collar Function	Green LED Response
Power on	Flashes once
Normal operation - Good battery	1 flash every 5 seconds
Training tone	On length of button press
Pairing Complete	Flashes 5 times

Receiver Collar Function	Red LED Response
Power off	On for 3 seconds
Normal operation - Low battery	3 flashes every 5 seconds
Static stimulation	On length of button press

Step 3 Fit the Receiver Collar

Important: The proper fit and placement of your Receiver Collar is important for effective training. The Contact Points must have direct contact with your pet's skin on the underside of his neck.

To assure a proper fit, please follow these steps:

1. Make sure that the Receiver Collar is turned off.
2. Have your pet standing comfortably (3A).
3. Place the Receiver Collar on your dog's neck close to the ears. Center the Contact Points underneath your dog's neck, touching the skin. *Note: It is sometimes necessary to trim the hair around the Contact Points to make sure that contact is consistent. Longer Contact Points are available from the Customer Care Center.*

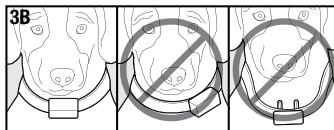
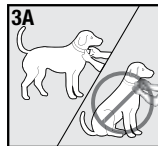

CAUTION

Do not shave the pet's neck as this may increase the risk of skin irritation.

4. The Receiver Collar should fit snugly, yet loose enough to allow one finger to fit between the strap and your pet's neck (3C).
5. Allow your pet to wear the collar for several minutes then recheck the fit. Check the fit again as your pet becomes more comfortable with the Receiver Collar.

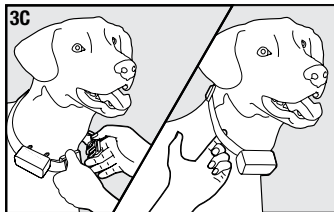

6. Trim the collar as follows (3D):

- Mark the desired length of the collar with a pen. Allow for growth if your pet is young or grows a thick winter coat.
- Remove the Receiver Collar from your pet and cut off the excess. **Important: Do not cut the part of the collar containing the Antenna on the PDT00-13410 Little Dog Remote Trainer.**
- Before placing the Receiver Collar back onto your pet, seal the edge of the cut collar by applying a flame along the frayed edge.

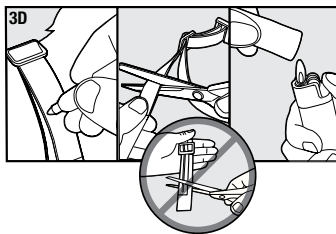

CAUTION

Risk of skin damage. For comfort, safety and effectiveness of this product, please ensure that you check the fit of your pet's collar frequently. If any skin irritation is observed, discontinue the use of the collar for a few days. If the condition persists beyond 48 hours, see your veterinarian.

Do not attach a leash to the Remote Trainer. This can result in pulling the Contact Points too tightly against your pet's neck. You may put a separate non-metallic collar on your dog's neck and attach a leash. Do use a harness for attaching a leash and/or tags while using the Remote Trainer.

Please refer to page 2 for additional information.

To Re-Thread the Collar

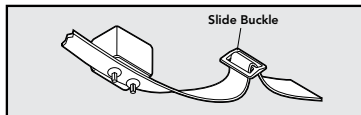

The slide buckle prevents the collar from becoming loose around your pet's neck.

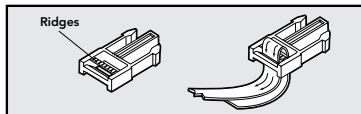

The ridges must be facing up; the collar will slip if it is not properly threaded.

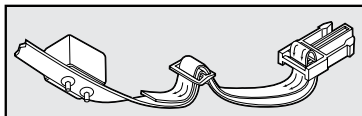

Step 4 To Pair the Remote Transmitter and Receiver Collar

If your Receiver Collar does not beep when the Tone Button of the Remote Transmitter is pressed, or if you feel the Receiver Collar is not responding to the Remote Transmitter, follow these steps to pair:

1. Start with the Receiver Collar off your pet and powered off.
2. Press and hold the On/Off Button until the Green LED light shuts off. When the Green LED shuts off, release the On/Off Button and the Receiver LED will flash green.
3. Place the Transmitter into pairing mode by pressing the down (-) button until the Digital Display shows P.
4. Press the Tone and Stimulation Buttons simultaneously (the Orange LED should be lit) until the collar flashes the Green LED 5 times, indicating it has learned the Transmitter ID.
5. Change the level to 1 Low by pressing the up (+) button on the transmitter and then press the Tone Button. The Receiver Collar should emit a tone, verifying that it is paired with the transmitter.
6. If the Receiver Collar does not respond, please contact the Customer Care Center.

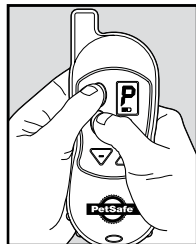

Training Guide

General Tips

- Eliminate one misbehavior or teach one obedience command at a time. If you move too fast with training, your pet may become confused.
- Be consistent. Correct your pet every time he misbehaves.
- Unless you can supervise him, it is recommended that you restrict your pet from situations in which he has a history of misbehaving. However, setting up a situation as a training session can dramatically improve your chances of success.
- If your pet reacts to the tones by hiding or acting fearful, redirect his attention to a simple and appropriate behavior, such as the “sit” command.
- Pets should be at least 6 months old before using the Trainer.
- Only let responsible family members use the Trainer. It is not a toy!
- Other pets in hearing range will be affected by the training tones. Therefore, training sessions should be conducted out of hearing range of other pets.

⚠ WARNING	Never use the Remote Trainer to correct or eliminate any form of aggressive behavior. We recommend you contact your local veterinarian or professional trainer to determine if your pet might be aggressive. See page 2 for more information.
------------------	---

Teaching Your Pet the Positive Tone

Before using the Trainer to correct your pet, spend 10 to 15 minutes per day for 2 or 3 days helping him create the association of the tone with reward and praise. To accomplish this:

1. Push the Tone Button (green) for 2 consecutive seconds.
2. Release the button and immediately reward your pet with verbal praise, petting, or a small food reward. Spend 3 to 5 seconds on your rewarding.
3. Wait a few minutes and repeat holding the Tone Button for 2 seconds following with praise.

Vary the reward to prevent your pet from anticipating a specific type. This stage of training is complete when your pet obviously anticipates a reward when he hears the positive tone.

Find the Best Stimulation Level for Your Pet

Important: Always start at the lowest level and work your way up.

The Remote Trainer has 8 Low and 8 High Stimulation Levels. This allows you to choose the Stimulation that is best for your pet.

Once you have placed the Receiver Collar on your pet, it is time to find the Stimulation Level that is best for him. This is called the Recognition Level.

A slight change in your pet's behavior, such as looking around in curiosity, scratching at his collar, or flicking his ears, indicates the Recognition Level that is best for him.

Follow the steps below to find your pet's Recognition Level:

1. Starting at Level 1 Low on the Digital Display, press the Stimulation Button (yellow) continuously for 1 to 2 seconds. *Note: When the Stimulation Button is held down for 12 consecutive seconds, the Transmitter will "time-out", and you must release and press the button again before additional stimulation can be delivered.*
2. If your pet shows no reaction, repeat the Stimulation Level several times before moving up to the next level.
3. YOUR PET SHOULD NOT VOCALIZE OR PANIC WHEN RECEIVING STIMULATION. IF THIS HAPPENS, THE STIMULATION LEVEL IS TOO HIGH AND YOU NEED TO GO BACK TO THE PREVIOUS LEVEL AND REPEAT THE PROCESS.
4. Move up through the Stimulation Levels until your pet reliably responds to the stimulation.
5. If your pet continues to show no response at Level 8 High, check the fit of the Receiver Collar. If your pet has long or thick hair, contact our Customer Care Center to obtain a longer set of Contact Points. Then go back to #1 and repeat the process. If this still does not yield any results, your pet's hair will need to be trimmed around the Contact Points.

CAUTION Do not shave the pet's neck as this may increase the risk of skin irritation.
--

If, after completing all of these steps, your dog still does not indicate he is feeling the stimulation, please contact Customer Care Center or visit our website at www.petsafe.net.

+2 Boost

A press of this button (red) sends a signal to the collar to issue a stimulation that is 2 levels higher than the currently selected level. For example, if the Stimulation Level is set at Level 2 Low, a touch of the +2 Boost button will stimulate at Level 4 Low. *Note: The system can not exceed the 8 High Stimulation Level.*

Teaching Basic Obedience

The “Sit” Command

1. Put a separate, non-metallic collar on your pet's neck ABOVE the Receiver Collar, and attach a 10-foot leash. *Note: Be sure the extra collar does not put pressure on the Contact Points.*
2. Hold the leash and the Remote Transmitter in one hand. Keep your other hand free to guide your pet into a “Sit” position.
3. Press and hold the Stimulation Button, starting at your pet's Recognition Level.
4. Immediately give the “Sit” command while continuing to hold the Stimulation Button.
5. Release the Stimulation Button as soon as your pet is in position, and praise him.
6. Release your pet from the “Sit” command and play.
7. Repeat Steps 2 through 6.

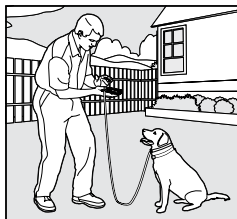
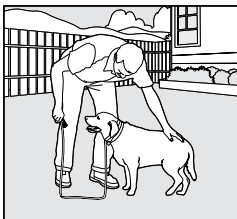

Note: If your pet breaks the “Sit” command, repeat steps 3 through 6. Keep your pet close to you while teaching the “Sit” command.

The “Come” Command

1. Put a separate, non-metallic collar on your pet's neck ABOVE the Receiver Collar, and attach a 10-foot leash. *Note: Be sure the extra collar does not put pressure on the Contact Points.*
2. Hold your leash in one hand and the Remote Transmitter in the other.

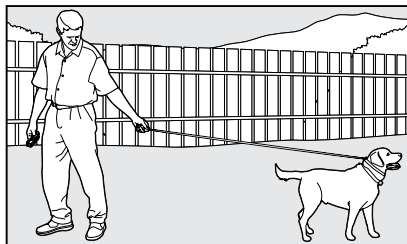

3. Wait for your pet to walk away from you. Using the Recognition Level for your pet, press and hold the Stimulation Button on your Remote Transmitter.
4. Immediately give the command “Come” while continuing to hold the Stimulation Button.
5. Using the leash, gently guide your pet toward you until he begins to come in your direction.
6. Immediately release the Stimulation Button as soon as your pet steps towards you, and praise him enthusiastically.
7. Quickly move backwards as your pet begins to come back to you, praising him the entire time.
8. Praise your pet when he returns to you.
9. Repeat Steps 3 through 8.
10. Once your pet responds readily to the “Come” command several times, back away from him without giving a command. When your pet turns toward you, give the command “Come” (WITHOUT STIMULATION) and praise him while you continue to back up. Praise your pet when he returns to you.
11. Use your leash to prevent your pet from running past you. If your pet manages to run past you, repeat Steps 3 through 8.

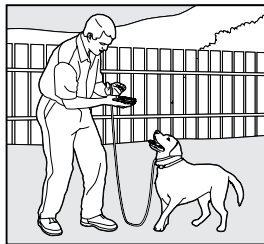
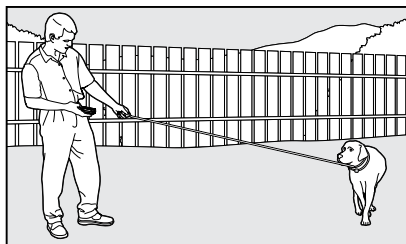

The “Stay” Command

1. Put a separate, non-metallic collar on your pet’s neck ABOVE the Receiver Collar, and attach a 10-foot leash. *Note: Be sure the extra collar does not put pressure on the Contact Points.*
2. Put your pet on his bed. Hold your leash in one hand and the Remote Transmitter in the other.
3. Staying within 3 feet, walk the perimeter of the bed. Do not say anything to your pet.
4. If your pet tries to leave the bed, press and hold the Stimulation Button and give the “Stay” command. Continue to hold the button until your pet is back on his bed. If necessary, use the leash to guide your pet onto his place.
5. Praise your pet when he is back on his bed.
6. Once your pet has settled for a few seconds, release him and play calmly.
7. Repeat steps 1 through 5.

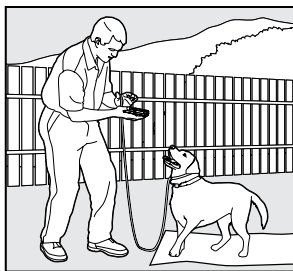
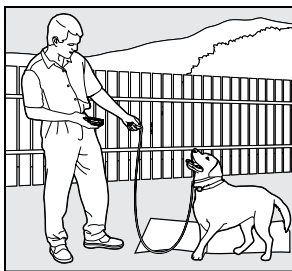

Eliminating Unwanted Behavior

Jumping Up

Pets typically jump up to get attention. If you do not want your pet to jump on you, then friends or members of the family should not encourage this behavior. That means every time your pet jumps on someone, he should be reprimanded or redirected to an alternate and acceptable behavior, for which he can receive praise.

Note: It is best if your pet first understands the “Sit” command.

1. Choose your pet's Recognition Level.
2. As soon as your pet lifts his paws off the ground to jump on you, press the Stimulation Button and give the command “Sit.”
3. Release the Stimulation Button immediately once your pet is sitting, and verbally praise him.
4. If your pet ignores the stimulation, increase the Intensity Level by 1.
5. Practice this exercise in several different areas and use different people for distractions.



Digging

It is important to first understand why your pet is digging. Many dogs, such as terriers, were bred to flush out prey, and digging is very innate to them. Other dogs may be digging to find a cool spot to lie down, or simply out of boredom. Your pet may no longer have the desire to dig if he is provided with the following:

- A cool, shaded area in which to lie down, and plenty of water.
- An alternate activity, such as a favorite toy.
- Plenty of play, exercise, and attention.
- A yard free from rodents or prey that he may be trying to flush out.

1. Choose the Intensity Level 1 higher than your pet's Recognition Level.
2. Place the Receiver Collar on your pet and wait at least 10 minutes before placing him in the yard. No other people or pets should be in the yard, as you do not want your pet to associate the stimulation with anything other than his digging. Your pet must be securely fenced in or contained during training.
3. From a window or area where your pet cannot see you, wait until your pet begins to dig.
4. While your pet digs, press the Stimulation Button and release it when he stops digging. Only press the button while your pet is in the act of digging, and do not say anything to him.
5. If your pet ignores the stimulation, increase the Intensity Level by 1.
6. Continue to watch your pet, as he may choose another area to dig.
7. Do not allow your pet in the yard unsupervised until he has completely stopped digging.

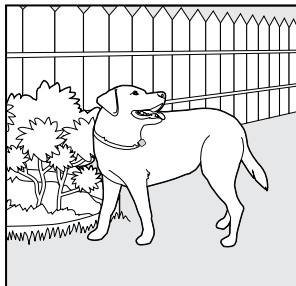
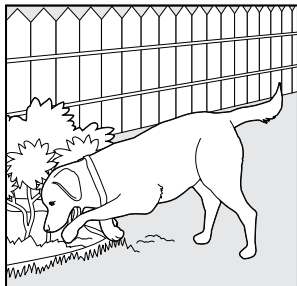
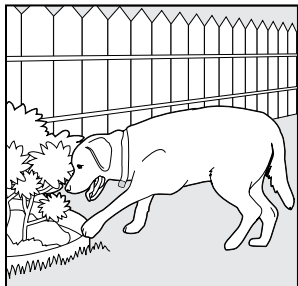

Chasing

Chasing is an instinctive behavior stimulated by moving objects. Some dogs have a particularly strong desire to chase that can put them in harm's way and leave you helpless. Never allow your dog off the leash or out of a contained area until he has learned the "Come" command, regardless of the distraction. Be consistent and correct your dog every time he chases something.

CAUTION

It is vitally important that you and your dog remain safe while learning during on-leash training. Your dog should be on a strong leash, long enough for him to attempt to chase an object, but short enough for him not to reach a road or other unsafe area. You must also be physically strong enough to restrain your dog when he tries to chase.

1. If your dog has not learned the "Come" command, keep a leash on him so you can physically stop him before he reaches the object he is chasing.
2. Choose the Intensity Level 1 higher than your dog's Recognition Level.
3. Set up a scenario where your dog is enticed to chase an object. Common items could be cars, motorcycles, bicycles, etc. (do not use toys).
4. When the object passes in front of your dog, make sure to hold the leash with a firm grip. As soon as your dog begins to chase the object, press and hold the Stimulation Button until he stops.
5. When your dog stops chasing the object, immediately release the button, walk backwards and give the command "Come." Praise your dog as he comes to you.
6. Repeat the process until your dog stops chasing the object.

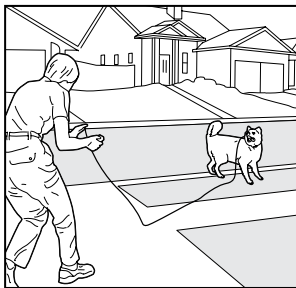
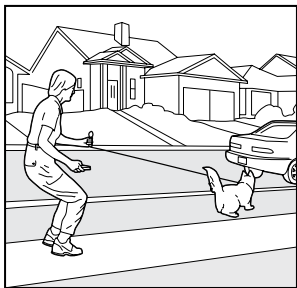
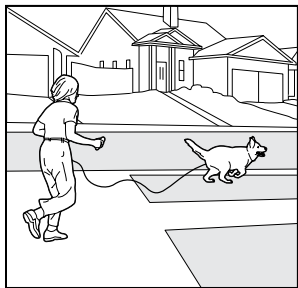

Trash Raiding

The easiest way to prevent trash raiding is to remove garbage and tempting food from your pet's environment. You can use the Remote Trainer to teach your pet to stay away from these items; however, you must be prepared to correct your pet every time he approaches them.

1. Choose the Intensity Level 1 higher than your pet's Recognition Level.
2. Pick a temptation for your pet and position yourself where he cannot see you.
3. While your pet's mouth is touching the temptation, press and hold the Stimulation Button. Immediately release the button when your pet leaves the temptation.
4. Do not say anything, as you want your pet to associate the stimulation with his behavior, not you.
5. If your pet does not respond to the stimulation, increase the Intensity Level by 1 and repeat the process.
6. Repeat this process in several different locations with different temptations.

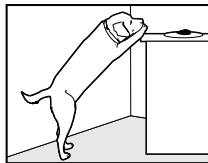
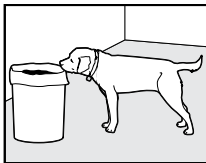

Frequently Asked Questions

Is the Stimulation safe for my pet?	<ul style="list-style-type: none"> • While the Stimulation is unpleasant, it is harmless to your pet. Electronic training devices require interaction and training from the owner to achieve desired results.
How old does my pet have to be before using the PetSafe® Remote Trainer?	<ul style="list-style-type: none"> • Your pet should be able to recognize basic obedience commands such as “Sit” or “Stay”. Pets should be at least 6 months old before using the Trainer.
Once my pet is trained and has been obeying my commands, will he have to continue to wear the Receiver Collar?	<ul style="list-style-type: none"> • Probably not. You may need to reinforce training with the Receiver Collar from time to time.
Is the Receiver Collar waterproof?	<ul style="list-style-type: none"> • Yes. When changing the batteries, be sure to keep the area free of dirt and debris. Also, make sure the screws are flush with the Battery Lid.
Will I get exactly 100 yards of range with the Remote Trainer?	<ul style="list-style-type: none"> • The range of the Remote Trainer will vary according to terrain, weather, vegetation, as well as transmission from other radio devices. See “How the System Works” for tips on maximizing your range.
How long can I continuously deliver stimulation to my pet?	<ul style="list-style-type: none"> • The maximum amount of time you can press the Stimulation Button and deliver stimulation to your pet continuously is 12 seconds. After this, the Remote Transmitter will time-out, and the Stimulation Button must be released and pressed again.

Troubleshooting

My pet does not respond when I press a button.

- Make sure the Receiver Collar has been turned on.
- If your range has reduced from the first time you used the Remote Trainer, the battery(s) may be low in either the Remote Transmitter or Receiver Collar.
- Many factors can impact the amount of range you have with the Remote Trainer. For a list of these factors, see “How the System Works”.
- Test the Receiver Collar. See “Test Light Instructions” for details.
- Increase the Stimulation Level. Refer to “Find the Best Stimulation Level For Your Pet” for more information.
- Make sure the Receiver Collar’s Contact Points are placed snugly against your pet’s skin. Refer to “Fit the Receiver Collar” for more information.

The Receiver Collar will not turn on.

- Check that two (2) CR2032 batteries have been installed properly. See “To Insert and Remove the Batteries.”

The Receiver Collar is not responding to the Remote Transmitter.

- Verify the Receiver Collar is on.
- If the Indicator Light does not come on when a button is pressed on the Transmitter, ensure that the batteries are inserted properly.
- If the first two solutions did not resolve your problem, see “To Pair the Remote Transmitter and the Receiver Collar.”

Test Light Instructions

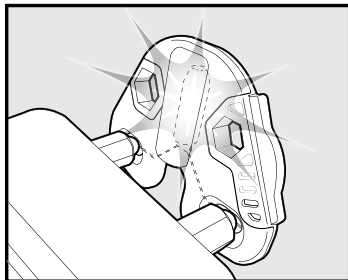

1. Turn the Receiver Collar on.
2. Hold the Test Light Contacts to the Contact Points.
3. Press the Stimulation Button on the Remote Transmitter.
4. The Test Light will flash. *Note: At higher Stimulation Levels, the Test Light will flash brighter.*
5. Turn the Receiver Collar off.

Save the Test Light for future testing. *Note: If the Test Light does not flash, replace the batteries and re-test. If Test Light still does not flash, contact the Customer Care Center or visit our website at www.petsafe.net.*

Customer Care International

USA & Canada - Tel: 800-732-2677

Monday - Friday 8 AM - 8 PM / Saturday 9 AM - 5 PM

Australia - Tel: 1800 786 608

Monday - Friday 7:30 AM - 5 PM

New Zealand - Tel: 0800 543 054

Monday - Friday 10:30 AM - 7 PM

This product has the benefit of a limited manufacturer's warranty. Details of the warranty applicable to this product and its terms can be found at www.petsafe.net and/or are available by sending a stamped addressed envelope to PetSafe® Ltd. Redthorn House, Unit 9, Chorley West Business Park, Ackhurst Road, Chorley, Lancashire PR7 1NL, United Kingdom.

Terms of Use and Limitation of Liability

1. Terms of Use

This Product is offered to you conditioned upon your acceptance without modification of the terms, conditions and notices contained herein. Usage of this product implies acceptance of all such terms, conditions, and notices.

2. Proper Use

This Product is designed for use with pets where training is desired. The specific temperament of your pet may not work with this product. We recommend that you not use this product if your pet is less than 8 lb or under 6 months old, or if your pet is aggressive. If you are unsure whether this is appropriate for your pet, please consult your veterinarian, certified trainer or contact our Customer Care Center or visit our website at www.petsafe.net.

Proper use includes reviewing the entire Operating and Training Guide provided with your product and any specific Caution statements.

3. No Unlawful or Prohibited Use

This Product is designed for use with pets only. This pet training device is not intended to harm, injure, or provoke. Using this product in a way that is not intended could result in violation of Federal, State or local laws.

4. Limitation of Liability

In no event shall Radio Systems® Corporation be liable for any direct, indirect, punitive, incidental, special or consequential damages, or any damages whatsoever arising out of or connected with the use or misuse of this Product. Buyer assumes all risks and liability from the use of this Product.

5. Modification of Terms and Conditions

Radio Systems Corporation reserves the right to change the terms, conditions and notices under which this Product is offered.

Compliance

FCC - USA

This device complies with part 15 of the FCC Rules. Operation is subject to the following two conditions: (1) This device may not cause harmful interference, and (2) this device must accept any interference received, including interference that may cause undesired operation.

CAUTION: Modification or changes to this equipment not expressly approved by Radio Systems® Corporation may void the user's authority to operate the equipment.

NOTE: This equipment has been tested and found to comply with the limits for a Class B digital device, pursuant to part 15 of the FCC Rules. These limits are designed to provide reasonable protection against harmful interference in a residential installation. This equipment generates, uses, and can radiate radio frequency energy and, if not installed and used in accordance with the instructions, may cause harmful interference to radio communications. However, there is no guarantee that interference will not occur in a specific installation. If interference does occur to radio or television reception, which can be determined by turning the equipment off and on, the user is encouraged to try to correct the interference by one or more of the following measures:

- Reorient or relocate the receiving antenna.
- Increase the separation between the equipment and the receiver.
- Connect the equipment to an outlet on a circuit different from that to which the receiver is connected.
- Consult customer care, the dealer, or an experienced radio/TV technician for help.

IC - Canada

This device complies with Industry Canada licence-exempt RSS standard(s). Operation is subject to the following two conditions: (1) this device may not cause interference, and (2) this device must accept any interference, including interference that may cause undesired operation of the device.

Le présent appareil est conforme aux CNR d'Industrie Canada applicables aux appareils radio exempts de licence. L'exploitation est autorisée aux deux conditions suivantes : (1) l'appareil ne doit pas produire de brouillage, et (2) l'utilisateur de l'appareil doit accepter tout brouillage radioélectrique subi, même si le brouillage est susceptible d'en compromettre le fonctionnement.

Perchlorate Battery

Perchlorate Material – special handling may apply.
See www.dtsc.ca.gov/hazardouswaste/perchlorate.

Radio Systems® Corporation
10427 PetSafe Way
Knoxville, TN 37932
1-800-732-2677
www.petsafe.net
400-1362/2

©2011 Radio Systems Corporation