

Using the Power override battery box:

If the internal batteries of the safe die, you can always give power to the lock from the outside by using the included battery override box.

1. Slide the battery box cover and install 4 AA batteries
 2. Plug in the jack in the power override hole in the scanner
 3. Now open the safe as you would by using your fingerprint
- NEVER LOCK THE POWER OVERRIDE BOX INSIDE THE SAFE.

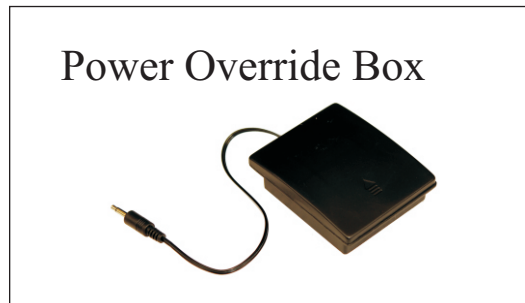

Installation:

We recommend hiring a contractor or a handyman to install the safe in your home or office.

Installation Steps:

1. Locate an interior wall that you would know for sure that there are no pipes running inside. Make sure there is no bathroom or a shower on the other side of that wall.
2. Using a Stud Finder, locate a good location between two wall studs at approx. the height of your eyes.
3. Using a level and a measuring tape, draw a rectangular of 18" high x 14" wide. (to make sure, measure the size of the back of the safe and make the rectangular about a ¼" larger to have some play).
4. Using a hand held drywall saw, cut the dry wall according to the marking. **DO NOT USE AN ELECTRIC SAW.**
5. Remove the drywall cutout and make sure there are no interference inside the wall to install the safe
6. Insert the safe into the wall and install to the wall studs from the inside of the safe using the lag bolts provided. It is recommended to drill pilot holes for bolts.



USER MANUAL



**PROTEX FINGERPRINT
WALL SAFE**
Model: FW-1814Z

Step 1. – Opening the safe.

Make sure safe is in an upright position. (not laying down).

1. Install the 4 AA batteries in the power override box and plug it in below the fingerprint reader in the left hole. This will give the lock power to open the safe so you can install the batteries inside the safe.
2. Press the wake-up button and place your finger on the glass scanner until the LED turns green followed by a long beep.
3. The safe door will slowly spring open

NOTE: The safe will open with any finger if no fingerprint is enrolled. Install 4 AA batteries in the black battery box located in the back of the door, inside the safe.

Step 2. – Closing the safe.

1. To close the safe, push and hold the door shut, press the wake-up button and wait until the safe is locked.

Note: You will hear the bolts extending and locking the safe

Step 3. – Enrolling fingerprints.

1. Open the safe by following step 1.
2. Press the red setup button located inside the safe on back of door (see diagram). The scanner will flash red.
3. While the scanner flashes red immediately place your finger (preferably your index) flat on the fingerprint scanner wait until the scanning process is done and the green LED goes on twice with two beeps.
4. Remove your finger from the scanner, your fingerprint is now enrolled.

NOTE: To add additional fingerprints, repeat step 3. You can enroll up to 30 different fingerprints.

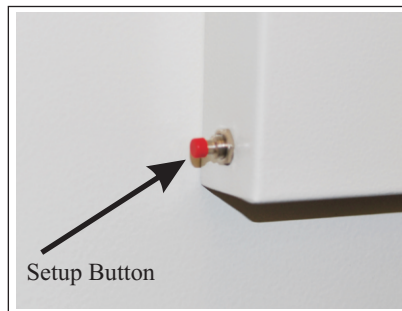

Deleting:

To delete fingerprints (users), go to: Initialization Process
You cannot delete individual users. You must delete all users.

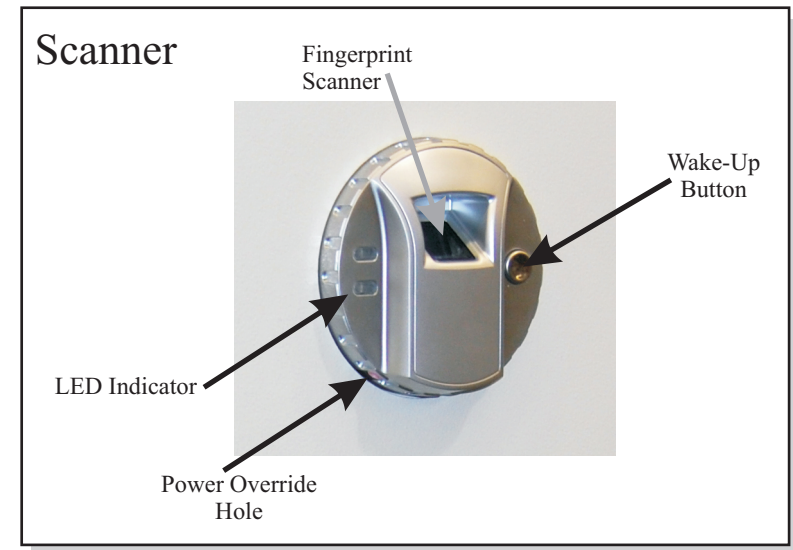

Initializing: Restoring Factory Setting

1. Open the safe and leave the door open
2. Remove one of the batteries from the battery box inside the safe
3. Press and hold the wake-up button for 3 seconds and release.
4. Press and hold the red setup (programming) button, while holding the button insert the battery back into the battery box.
5. Keep holding the red setup button until the LED indicator flashes green twice with 2 beeps.
7. Release the setup button and the safe is now initialized back to factory settings. Now any fingerprint can open the safe

Using the Emergency override key:

Please use this key only if the scanner is not reading your fingerprint for some reason.

DO NOT use this key to open the safe on a regular bases.

To use the key, gently unscrew the chrome keyhole cap located below and left of the scanner. Insert the key with the notch pointing upwards and turn counter-clockwise to open the safe.

NEVER LOCK THE KEYS INSIDE THE SAFE. ALWAYS KEEP THE KEYS OUTSIDE OF THE SAFE IN A HIDDEN PLACE.

(continue next page)