

# RYOBI®

## RBCGM25SS

### TRIMMER / BRUSHCUTTER

#### OPERATOR'S MANUAL (Original Instructions)

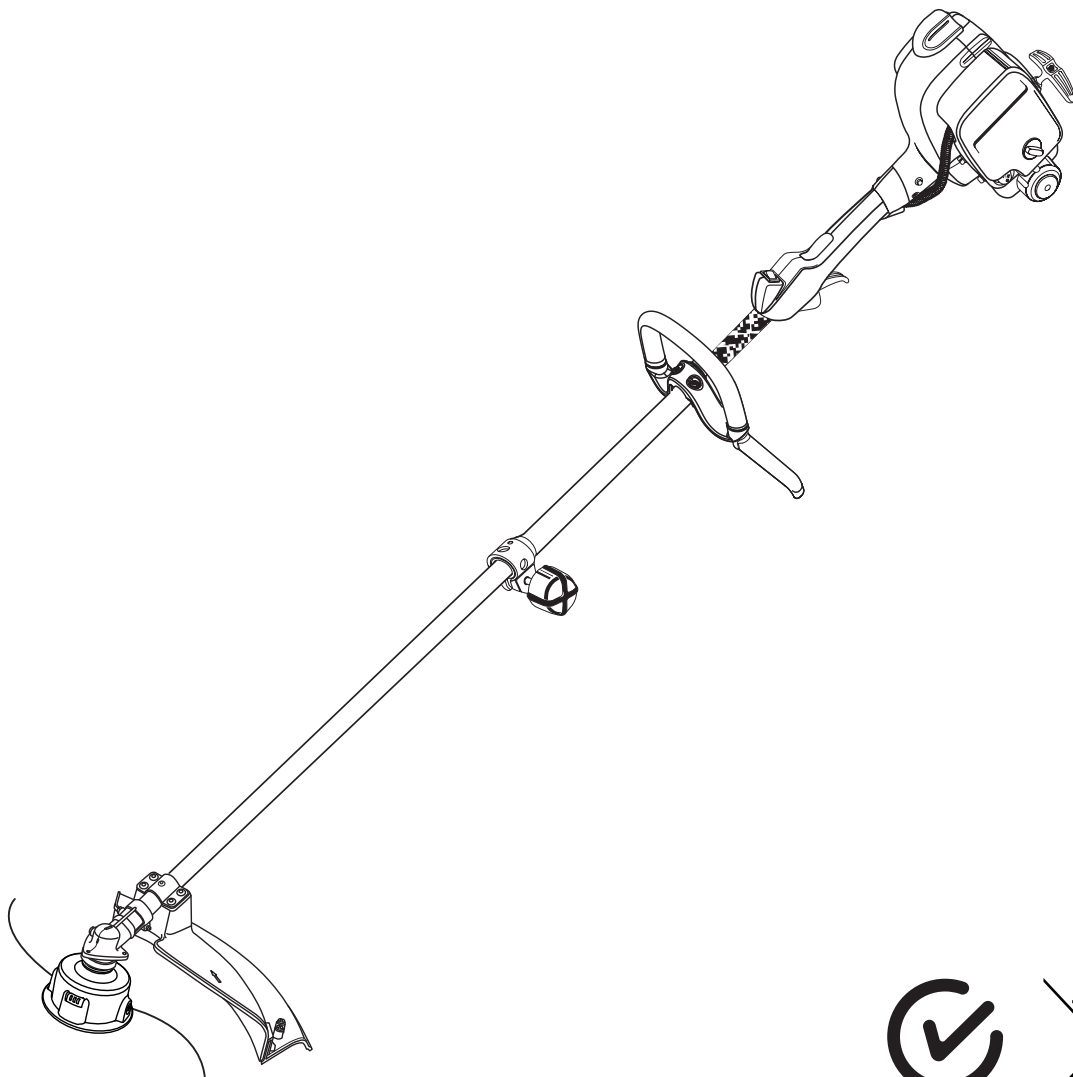

N197



***Important!***

It is essential you read the instructions in this manual before starting and operating this machine.

Subject to technical modifications.

**RYOBI** RBCGM25SS

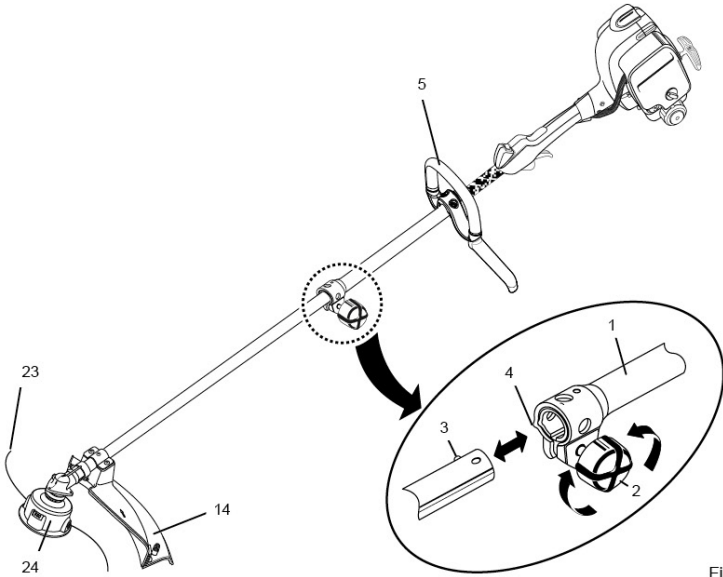

Fig. 1

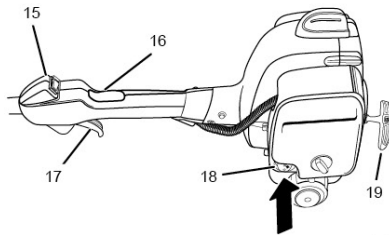

Fig. 4

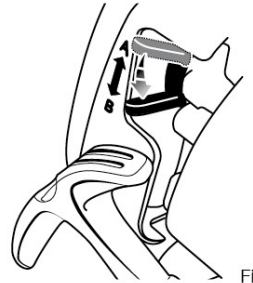

Fig. 5



Fig. 6

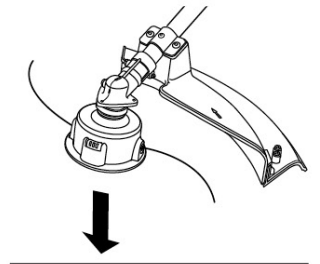

Fig. 7

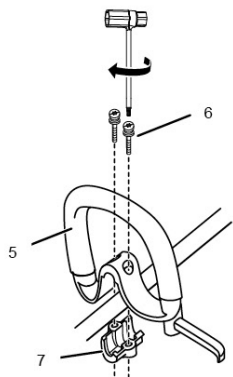

Fig. 2

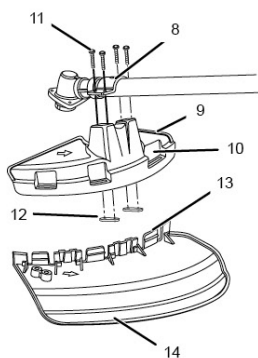

Fig. 3



Fig. 8

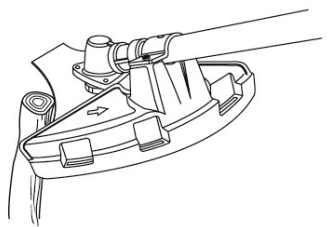

Fig. 9

**RYOBI**

**RBCGM25SS**

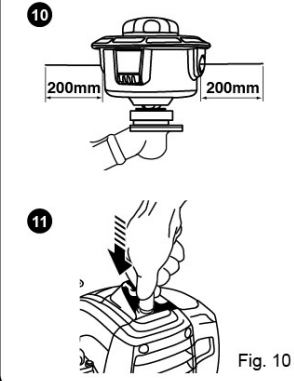
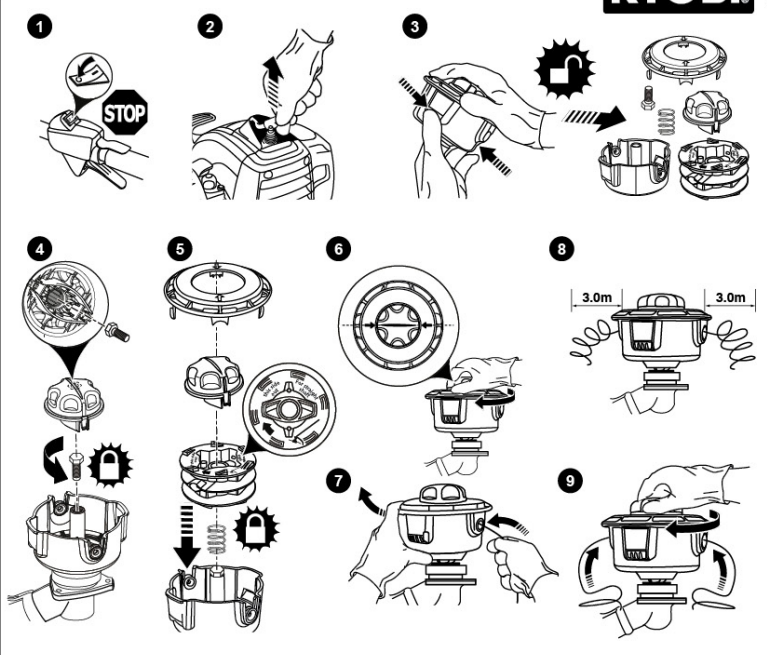

Fig. 10

Fig. 11

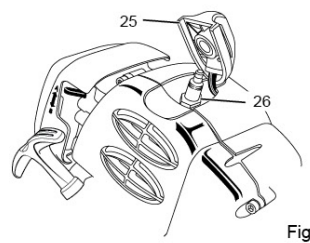

Fig. 12

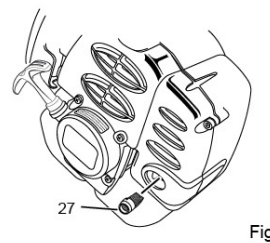

Fig. 13

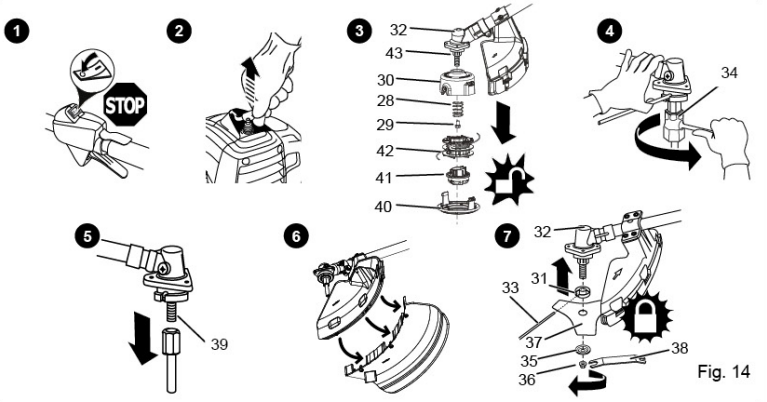

Fig. 14

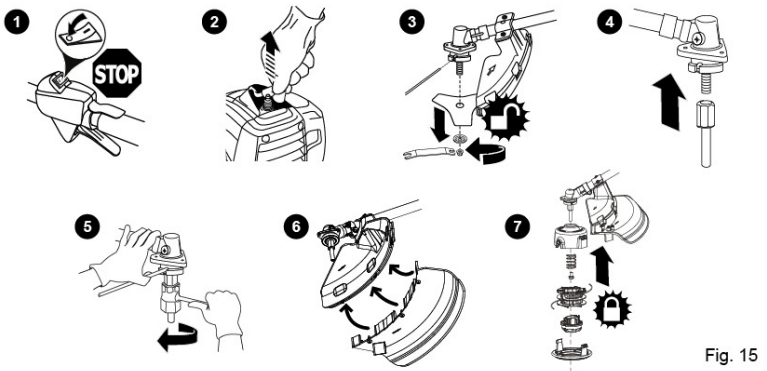

Fig. 15

## English (Original Instructions)

### GENERAL SAFETY WARNINGS

#### WARNING

**Read and understand all instructions.** Failure to follow all instructions may result in serious personal injury as well as damage to the product.

- **Physical Condition of the Operator.** Do not operate this product when tired, ill or under the influence of alcohol, drugs or medication.
- **Clothing Requirements.** Always wear long heavy pants, boots and gloves. Do not wear loose clothing, jewelry, short pants, sandals or go barefoot. Secure hair so that it is above shoulder level to avoid entanglement in moving parts.
- **Protective Accessories Requirements.** Wear eye and hearing protection when operating this product. Before use, inspect the condition of the trimmer. Replace damaged parts. Check for fuel leaks. Make sure all fasteners are in place and secure. Replace cutting attachment parts that are cracked, chipped or damaged in any way. Make sure the cutting attachment is properly installed and securely fastened. Be sure the cutting attachment shield is properly attached and in the position recommended by the manufacturer. Use only flexible, non-metallic line recommended by the manufacturer. For example, never use wire or wire rope, which can break off and become a dangerous projectile.
- **Proper Stance. Keep firm footing and balance.** Do not overreach. Keep the cutting attachment below waist level. Keep all parts of your body away from the rotating cutting attachment and hot surfaces.
- **Exhaust Gases.** Never start or run the product inside a closed room or building; breathing exhaust fumes can cause illness or death.
- **Fueling.** Mix and pour fuel outdoors where there are no sparks and flames. Slowly remove the fuel cap only after stopping the engine. Do not smoke while fueling or mixing fuel. Wipe spilled fuel from the product. Move at least 30ft. (9m) away from the fueling source and site before starting the engine.
- **Work Area.** Clear the area to be cut before each use. Remove all objects, such as rocks, broken glass, nails, wire or string, that can be thrown or become entangled in the cutting attachment. Clear the area of children, bystanders and pets. At a minimum, keep all children, bystanders and pets outside a 50 ft. (15 m) radius. Because there still may be a risk of injury to bystanders from thrown objects. Bystanders should be encouraged to wear eye protection. If you are approached while operating the product, stop the engine and the cutting attachment.

- **Dangerous Environments.** To avoid falling, do not use the product in damp or wet locations.
- **Controlling the Product.** During carburetor adjustments the cutting attachment may spin. Therefore, you should wear protective equipment and observe all safety instructions when adjusting the carburetor. For products equipped with a clutch, be sure the cutting attachment stops turning when the engine idles. When the product is turned off, make sure the cutting attachment has stopped before setting down the product.
- **Use the Right Product.** Use the product for the intended purpose only.
- **Save these instructions.** Refer to them frequently and use them to instruct others who may use this power tool. If you loan someone this power tool, loan them these instructions also.

### SPECIFIC SAFETY RULES FOR BRUSHCUTTER AND BLADE

#### WARNING





Extreme care must be taken when using blades to ensure safe operation. Read the safety information for safe operation using the blade, refer to "Specific Safety Rules for Brushcutter and Blade Use" earlier in this manual.

- Always hold brushcutter with both hands when operating. Use a firm grip on both handles.
- Maintain your grip and balance on both feet. Position yourself so that you will not be drawn off balance by the kick-back reaction of the cutting blade.
- Inspect and clear the area of any hidden objects such as glass, stones, concrete, fencing, wire, wood, metal, etc.
- Never use blades near footpaths, fencing, posts, buildings or other immovable objects.
- Never use a blade after hitting a hard object without first inspecting it for damage. Do not use if any damage is detected.
- The unit is used as a scythe, cutting from the right to the left in a broad sweeping action from side to side.



## English (Original Instructions)

### SYMBOLS

The following symbols are located on labels on the attachment shaft. Please study them and learn their meaning. Proper interpretation of these symbols will allow you to operate the tool better and safer.

SYMBOL	NAME	DESIGNATION/EXPLANATION
	Safety Alert	Precautions that involve your safety.
	Read The Operator's Manual	Read the operator's manual before starting or operating this product. Failure to follow operating instructions and safety precautions in the operator's manual can result in serious injury.
	Eye and Ear Protection	Thrown objects can cause severe eye injury. Wear eye protection when operating this product. Wear hearing protection during extended periods of operation.
	Thrown Objects	Thrown objects can cause severe injury. Wear protective clothing and boots.
	Keep Bystanders Away	Keep all bystanders, especially children and pets, at least 50 feet (15m) from the operating area.

The following signal words and meanings are intended to explain the levels of risk associated with this product.

SYMBOL	SIGNAL	MEANING
	<b>DANGER:</b>	Indicates an imminently hazardous situation, which, if not avoided, will result in death or serious injury.
	<b>WARNING:</b>	Indicates a potentially hazardous situation, which, if not avoided, could result in death or serious injury.
	<b>CAUTION:</b>	Indicates a potentially hazardous situation, which, if not avoided, may result in minor or moderate injury.
	<b>CAUTION:</b>	(Without Safety Alert Symbol) Indicates a situation that may result in property damage.

# English (Original Instructions)

## SPECIFICATIONS

Weight without fuel and trimmer head	5.31 Kg
Weight without fuel with trimmer head	5.61 Kg
Fuel tank volume	620 cm <sup>3</sup>
Cutting swath	457 mm
Diameter of cutting line	2.4 mm
Engine displacement	25.4 cc
Maximum engine performance (in accordance with ISO 8893)	0.9 kW
Maximum rotational frequency of the spindle	10000 min <sup>-1</sup>
Engine speed (rotational frequency) at recommended max. spindle rotational frequency	12000 min <sup>-1</sup>
Engine speed (rotational frequency) at idle	2600-3200 min <sup>-1</sup>
Fuel consumption (in accordance with ISO 8893) at max. engine performance	0.54 kg/h
Specific fuel consumption (in accordance with ISO 8893) at max. engine performance	0.50 kg/h
Vibration level idling	
Left handle	6.4 m/s <sup>2</sup>
Right handle	14.9 m/s <sup>2</sup>
Vibration level racing	
Left handle	5.8 m/s <sup>2</sup>
Right handle	3.7 m/s <sup>2</sup>
Sound pressure level (in accordance with EN ISO1806:1997. ISO 7917:1987)	98 L <sub>PA</sub> (dBA)
Sound power level (in accordance with ISO 10884)	113 L <sub>WA</sub> (dBpA)

## DESCRIPTION

### FIGURE 1

1. Upper shaft
2. Knob
3. Button

4. Guide recess
5. Front handle
14. Grass deflector
23. Trimmer line
24. Trimmer head

### FIGURE 2

5. Front handle
6. Securing bolts
7. Bracket

### FIGURE 3

8. Guard mounting bracket
9. Blade guard
10. Slot
11. Guard screws
12. Threaded mounting plates
13. Locking tabs
14. Grass deflector

### FIGURE 4

15. On/Off switch
16. Throttle lock out button
17. Throttle trigger
18. Primer bulb
19. Starter grip

### FIGURE 11

20. Foam air filter
21. Air filter cover
22. Cover securing knob

### FIGURE 12

25. Spark plug boot
26. Spark plug

### FIGURE 13

27. Spark arrester

### FIGURE 14

28. Bump head spring
29. Bump head securing bolt
30. Cutting head housing
31. Blade flange washer
32. Gearbox
33. Shaft locking pin
34. Socket wrench
35. Cupped washer
36. Blade nut
37. Blade
38. Spanner
39. Gear shaft
40. Bump head cover
41. Bump knob
42. Line spool
43. Drive shaft adaptor

## English (Original Instructions)

### ASSEMBLY

#### ATTACHING THE POWER HEAD TO THE TRIMMER ATTACHMENT (FIG. 1)

- Follow these steps to connect the attachment to the upper shaft (item 1).
- Loosen the knob (item 2) by turning it counter clockwise.
- Align the button (item 3) on the attachment shaft with the guide recess (item 4) on the upper shaft.
- Slide the attachment shaft into the upper shaft until the attachment shaft clicks into place.
- Tighten the knob securely by turning it clockwise.

**Removing the Attachment from the Upper Shaft.**  
Follow these steps to remove the attachment from the upper shaft.

- Loosen the knob by turning it counterclockwise.
- Push the button while pulling out the attachment.

#### ATTACHING THE FRONT HANDLE (FIG. 2)

- Remove the securing bolts (item 6) and bracket (item 7) from the front handle (item 5).
- Install the front handle (item 5) onto the upper shaft (item 1).  
**Note:** The front handle should tilt slightly towards the operator when correctly fitted.
- Place the bolt through the front handle and securely tighten them into the captive nuts on the bracket (item 7).  
**Note:** Do no attempt to remove or modify the spacer, this spacer limits the upper position of the handle grip.

#### ASSEMBLY OF THE GUARD (FIG. 3)

- Attach the blade guard (item 9) to the guard mounting bracket (item 8); install the four screws (10-24 x 3/4in) from the top of the mounting clamp through the blade guard and into the threaded mounting plates (item 12).
- Using the Torx wrench supplied, tighten all four screws securely.

#### ATTACHING THE GRASS DEFLECTOR TO THE GUARD (FIG. 3)

**Note:** When using the line trimming head, the grass deflector (item 14) must be attached to the blade guard (item 9).

- Carefully align the locking tabs on the grass deflector (item 13) with the the slots on the blade guard (item 10).
- Push the grass deflector towards the blade guard until the locking tabs click firmly into place.

### ⚠ CAUTION

The grass deflector is fitted with a line cut off blade. Take extra care when fitting the grass deflector to avoid contact with the sharp blade.

#### INSTALLING THE REEL EASY LINE TRIMMER HEAD (FIG. 10)

- Stop the engine and disconnect the spark plug wire.
- Remove currently installed line trimmer head or cutting blade.
- Open the Reel Easy Line Trimmer Head by depressing the latches on each side. The contents of the line trimmer head are spring loaded, so keep your other hand over the line trimmer head cover while depressing the latches. (image 3)
- Remove the line trimmer head cover, bump knob, and line spool and set aside.
- Place the cutting head housing on the drive shaft. Make sure the housing is fully seated.
- Install the hex bolt to secure the line trimmer head to the drive shaft. Tighten by using the hex-shaped opening on the inside of the bump knob.  
**Note:** Only use the bump knob to tighten the bolt. The use of other tools may allow over tightening of the bolt, which could damage the line trimmer head. (image 4)
- Reinstall the bump head spring into the line trimmer head and push down to seat. (image 5)
- Reinstall the line spool.  
**Note:** For the straight shaft attachment with the Reel Easy cutting head, the spool should be placed so "This side out for straight shaft" is visible on the line spool.
- Replace the bump knob by inserting it into the centre of the line spool.
- Replace the line trimmer head cover, aligning latches with openings in the line trimmer head. Press cover and line trimmer head together until both latches snap into openings securely.
- Install line as described in the next section of this manual.

#### INSTALLING LINE IN REEL EASY LINE TRIMMER HEAD (FIG. 10)

Use 2.4mm diameter monofilament line.

- Stop the engine and disconnect the spark plug wire.
- Cut one piece of line approximately 6.0 meters in length.
- Rotate the bump knob on line trimmer head until line on the centre of the bump knob aligns with arrows on top of line trimmer head. (image 6)
- Insert one end of line into eyelet located on the side of the line trimmer head and push until line comes out through the eyelet on the other side. Continue to push line through the line trimmer head until the middle section of the line is inside the line trimmer head and line outside the line trimmer head is evenly divided on each side. (images 7-8)
- Rotate the knob on the line trimmer head to wind the line. If using a straight shaft attachment, the knob should be rotated clockwise.

## English (Original Instructions)

- Wind the line until approximately 20cm remains protruding from the line trimmer head.
- Replace the spark plug boot.

### CONVERTING FROM LINE TRIMMER TO BRUSH CUTTER (FIG. 14)

Stop the engine and disconnect the spark plug wire.

#### REMOVING THE LINE TRIMMING HEAD

- Open the Reel Easy Line Trimmer Head by depressing the latches on each side. The contents of the line trimmer head are spring loaded, so keep your other hand over the line trimmer head cover while depressing the latches.
- Remove the bump head cover (item 40), bump knob (item 41), line spool (item 42) and spring (item 28) and set them aside.
- Use the hex-shaped opening on the inside of the bump knob (item 41) to remove the hex bolt (item 29) on the drive shaft (item 43) in a clockwise direction and set aside.
- Remove the cutting head housing (item 30).
- Align the slot in the upper flange washer (item 31) with the hole in the gear head (item 32). Insert the holding pin (item 33) through the slot in the upper flange washer and the hole in the gear head. Using the 16mm socket wrench (item 34) supplied, turn the drive shaft adaptor (item 43) clockwise to remove it from the gear shaft (item 39). Remove the upper flange washer from the gear shaft and retain for blade installation.
- Remove the grass deflector by pushing in on the three locking tabs while pulling on the grass deflector to separate from the blade guard. (image 6)  
**NOTE:** Store the line trimmer head parts and grass deflector together for later use.

#### INSTALLING THE BLADE

- Place the upper flange washer over the gear shaft with the hollow side towards the blade guard.
- Centre blade (item 37) on the upper flange washer, making sure the blade sits flat. Install the cupped washer (item 35) with the raised centre away from the blade. Install and hand tighten the blade nut in a counterclockwise direction (item 36). The blade (item 37) turns counterclockwise from the operator's position during operation.
- Insert the holding pin through the slot in the upper flange washer and the hole in the gear head (item 32). Using the wrench (item 38) supplied, turn the blade nut (item 36) counterclockwise.
- Tighten nut securely.

### CONVERTING FROM BRUSH CUTTER TO LINE TRIMMER (FIG. 15)

#### REMOVING THE BLADE

- Insert the holding pin through the slot in the upper flange washer and the gear head. Turn the blade nut clockwise to remove.
- Remove the cupped washer and the blade.
- Remove the upper flange washer from the gear shaft and retain for the line trimmer head installation.
- Attach the grass deflector to the blade guard. Refer to "ATTACHING THE GRASS DEFLECTOR TO THE GUARD" earlier in this manual.  
**NOTE:** Store the brush cutter parts together for later use.

#### INSTALLING THE REEL EASY LINE TRIMMER HEAD

Refer back to instructions listed earlier in this manual.

## OPERATION

### FUEL AND REFUELING

#### Handling the fuel safely

Always handle fuel with care, it is highly flammable.

- Always refuel outdoors where there are no sparks and flames. Do not inhale fuel vapors.
- Do not let petrol or oil come in contact with your skin.
- Keep petrol and oil away from the eyes. If petrol or oil comes in contact with the eyes, wash them immediately with clean water. If irritation is still present, see a doctor immediately.
- Clean up spilled petrol immediately.

#### MIXING THE FUEL

- This product is powered by a 2-stroke engine and requires pre-mixing petrol and 2-stroke oil. Pre-mix unleaded petrol and 2-stroke engine oil in a clean container approved for petrol.
- This engine is certified to operate on unleaded petrol intended for automotive use with an octane rating of 87 ([R + M] / 2) or higher.
- Do not use any type of pre-mixed petrol / oil from fuel service stations, this includes the pre-mixed petrol / oil intended for use in mopeds, motorcycles, etc.
- Use synthetic 2-stroke oil only. Do not use automotive oil or 2-stroke outboard oil.
- Mix 2% synthetic 2-stroke oil into the petrol. This is a 50:1 ratio.
- Mix the fuel thoroughly and also each time before fueling.
- Mix in small quantities. Do not mix quantities larger than usable in a 30 day period. Synthetic 2-stroke oil containing a fuel stabilizer is recommended.



## English (Original Instructions)

### FILLING THE TANK

- Clean surface around fuel cap to prevent contamination.
- Loosen fuel cap slowly to release pressure and to keep fuel from escaping around the cap.
- Carefully pour fuel mixture into the tank. Avoid spillage.
- Prior to replacing the fuel cap, clean and inspect the gasket.
- Immediately replace fuel cap and hand tighten. Wipe up any fuel spillage. Move 9 m away from refueling site before starting engine.

**Note:** It is normal for smoke to be emitted from a new engine during and after first use.

### ⚠ WARNING

Always shut off engine before fueling. Never add fuel to a machine with a running or hot engine. Move at least 9m from refueling site before starting engine. Do not smoke!



### 50:1 Petrol to Oil Mixing Chart

1 litre	+	20 ml	=	} 50: 1 (2%)
2 litres	+	40 ml	=	
3 litres	+	60 ml	=	
4 litres	+	80 ml	=	
5 litres	+	100 ml	=	

### ⚠ WARNING

The product may throw objects during operation, causing injury to the operator or to bystanders. Always wear suitable eye protection, long heavy pants and boots while operating the product.

### STARTING THE PRODUCT (FIG. 4-5)

Starting the product differs depending on whether the engine is cold or warm. Refer to the label on the air filter cover.

#### TO START A COLD ENGINE

Follow these steps to start a cold engine.

1. Lay the product on a flat, bare surface.
2. Ensure the engine switch is in the I (ON) position (item 15).
3. Push the primer bulb (item 18) approximately 10 times.
4. Set the choke lever to position A (Choke Closed).
5. Hold down the throttle lock-off button (item 16) and squeeze the throttle trigger (item 17).

6. Pull the starter grip (item 19) with a quick firm and consistent upward motion (No more than 4x).
7. Set the choke lever to position B (Choke Open).
8. Hold down the throttle the lock-off button and squeeze the throttle trigger.
9. Pull the starter grip with a quick firm and consistent upward motion until the engine starts (No more than 6x).

**Note:** If engine does not start, return to step 4 and repeat the steps.

**Note:** When the engine starts, let it run for 30 seconds prior to operation.

#### TO START A WARM ENGINE

Follow these steps to start a warm engine.

1. Lay the product on a flat, bare surface.
2. Ensure the engine switch is in the I (ON) position (item 15).
3. Ensure the choke lever is set to position B (Choke Open).
4. Hold down the throttle lock-off button (item 16) and squeeze the throttle trigger (item 17).
5. Pull the starter grip with a quick firm and consistent upward motion until the engine starts (No more than 6x).

**Note:** If engine does not start, return to step 4 on the "TO START A COLD ENGINE" and repeat the steps.

#### STOPPING THE PRODUCT

- Release the throttle trigger.
- Hold down the engine switch to the O (OFF) position until the engine comes to a complete stop.

#### OPERATING AS A LINE TRIMMER (FIG.6)

Follow these steps to operate the straight shaft trimmer.

- Start the trimmer.
- Hold the trimmer at waist level with your right hand on the trigger handle and your left hand on the front handle.
- Place the product on the right side of your body with the engine behind and away from your body.
- Trim grass and weeds in a left-to-right motion with the line parallel to the ground.

#### TO ADVANCE THE CUTTING LINE (FIG.7)

Follow these steps to advance the cutting line.

- Start the trimmer.
- Tap the bump knob lightly on the ground while the motor is running. The line will only advance with the engine at full throttle. Do not hold the bump knob on the ground.

**Note:** The line cutting blade on the safety guard will cut the line to the proper length.

**Note:** To help prevent line tangle, tap only once to lengthen the line. If additional line is required, wait a

## English (Original Instructions)

few seconds before retapping the bump knob. Do not allow the line to wear too short. Keep the cutting line at full length.

### OPERATING AS A BRUSHCUTTER (FIG. 8-9)

#### WARNING

Extreme care must be taken when using blades to ensure safe operation. Read the safety information for safe operation using the blade, refer to "Specific Safety Rules for Brushcutter and Blade Use" earlier in this manual.

### TRI-ARC BLADE

The TRI-ARC blade is suited only for pulpy weeds and vines. When the blade becomes dull, it can be turned over to extend the life of the blade. Do not sharpen the TRI-ARC blade.

Hold the brushcutter with the right hand on the trigger handle and the left hand on the front handle. Keep a firm grip with both hands while in operation. Brushcutter should be held at a comfortable position with the trigger handle about hip height. Maintain your grip and balance on both feet. Position yourself so that you will not be drawn off balance by the kick-back reaction of the cutting blade. If using a shoulder strap adjust to position the brushcutter at a comfortable operating position. Shoulder straps are available as an accessory and may help to reduce operator fatigue.

Exercise extreme caution when using the blade with this unit. Blade thrust is the reaction which may occur when the spinning blade contacts anything it cannot cut. This contact may cause the blade to stop for an instant, and suddenly "thrust" the unit away from the object that was hit. This reaction can be violent enough to cause the operator to lose control of the unit. Blade thrust may occur without warning if the blade snags, stalls or binds. This is more likely to occur in areas where it is difficult to see the material being cut. For cutting ease and safety, approach the weeds being cut from the right to the left. In the event that an unexpected object or woody stock is encountered, this could cause the blade thrust reaction.

### MAINTENANCE

#### WARNING

When servicing, use only identical replacement parts. Use of any other parts may create a hazard or cause product damage.

#### WARNING

Always wear safety goggles or safety glasses with side shields during tool operation. If operation is dusty, also wear a dust mask.

#### WARNING

Before inspecting, cleaning, or servicing the machine, shut off engine, wait for all moving parts to stop, and disconnect spark plug lead and move it away from spark plug. Failure to follow these instructions can result in serious personal injury or property damage.

#### WARNING

Neglected or poorly conducted maintenance may create additional hazards. Do not attempt to repair or maintain this product if you are not qualified to do so. If in doubt, return to a service centre for professional assistance.

### GENERAL MAINTENANCE

Avoid using solvents when cleaning plastic parts. Most plastics are susceptible to damage from various types of commercial solvents and may be damaged by their use. Use clean cloths to remove dirt, dust, lubricant, grease.

#### WARNING

Do not at any time let brake fluids, petrol, petroleum-based products, penetrating lubricants, etc., come in contact with plastic parts. Chemicals can damage, weaken or destroy plastic which may result in serious personal injury.

You can often make adjustments and repairs described in this manual. For other repairs, have the trimmer serviced by an authorised service dealer.

### CLEANING THE AIR FILTER (FIG. 11)

A dirty air filter will cause starting difficulty, loss of performance, and shorten the life span of the engine. Check the air filter monthly. For best performance, replace the air filter at least once a year.

- Loosen the air filter cover by turning the cover securing knob (item 22) counterclockwise.
- Remove the air filter (item 20).
- Clean the foam filter element with warm soapy water. Rinse and let dry.

**NOTE:** If the foam filter element is damaged, it should be replaced.

- Apply a light coat of engine oil to the foam filter element, then squeeze it out.
- Reinstall the air filter.

## English (Original Instructions)

**NOTE:** Make sure the filter is seated properly inside the cover. Installing the filter incorrectly will allow dirt to enter the engine, causing rapid engine wear.

- Reinstall the cover and tighten knob to secure.

### CHECKING THE FUEL CAP

#### WARNING

A leaking fuel cap is a fire hazard and must be replaced immediately.

The fuel cap contains a non-serviceable filter and check valve. A clogged fuel filter causes poor engine performance. If performance improves when the fuel cap is loosened, the check valve may be faulty or the filter may be clogged. Replace the fuel cap if necessary.

### REPLACING THE SPARK PLUG (FIG. 12)

This engine uses a Champion RCJ6Y or NGK BPMR7A spark plug. Use an exact replacement and replace annually.

Follow these steps to replace the spark plug.

- Remove the spark plug boot (item 25).
- Loosen the spark plug (item 26) by turning it counterclockwise with a 16mm socket.
- Remove the spark plug.
- Hand thread the new spark plug, turning it clockwise.
- Tighten with a socket. Do not overtighten.

#### CAUTION

Be careful not to cross-thread the spark plug. Cross-threading will seriously damage the engine.

### CLEANING THE SPARK ARRESTER (FIG. 13)

Follow these steps to clean the spark arrester.

- Locate the spark arrester (item 27) through the hole on the muffler exit hole.
- Remove the spark arrester using needle-nosed pliers.
- Clean the spark arrester with a small wire brush.
- Replace the spark arrester.

### STORING THE PRODUCT

Storing the product differs depending on the amount of time it will be in storage.

Follow these steps for short term product storage.

- Clean all foreign material from the product.
- Store the product in a well-ventilated place that is inaccessible to children.

If you do not intend to use the product for more than one month, follow the storage procedures below.

- Drain all fuel from the tank into a container approved for petrol.

- Run the engine until it stops.
- Clean all foreign material from the product.
- Store the product in a well-ventilated place that is inaccessible to children.

**Note:** Keep the product away from corrosive agents such as garden chemicals.

**Important:** Abide by all local and government regulations for the safe storage and handling of petrol.

## English (Original Instructions)

### TROUBLE SHOOTING

PROBLEM	POSSIBLE CAUSE	SOLUTION
Engine will not start	<ol style="list-style-type: none"> <li>1. Switch set to the O (OFF) position.</li> <li>2. No spark</li> <li>3. No fuel</li> <li>4. Flooded engine</li> <li>5. Starter cord is hard to pull</li> </ol>	<ol style="list-style-type: none"> <li>1. Set switch to the I (ON) position.</li> <li>2. Remove the spark plug. Reattach the spark plug cap and lay the spark plug on the metal cylinder. Pull the starter cord and watch for a spark at the spark plug tip. If there is no spark, repeat the test with a new spark plug.</li> <li>3. Push primer bulb until the bulb is full of fuel. If the bulb does not fill, the primary fuel delivery system is blocked. If the primer bulb fills, the engine may be flooded. (See next item.)</li> <li>4. Remove the spark plug. Turn the product so that the spark plug hole is aimed at the ground. Make sure the choke lever is set to position B and pull the starter cord 10 to 14 times. This clears excess fuel from the engine. Clean and reinstall the spark plug. With the throttle trigger fully depressed, pull the starter cord 3 times. If the engine does not start, set the choke lever to A and follow normal starting instructions. If the engine still fails to start, repeat the procedure with a new spark plug.</li> <li>5. Contact an authorized service dealer.</li> </ol>
Engine does not reach full speed and emits excessive smoke	<ol style="list-style-type: none"> <li>1. Check oil fuel mixture</li> <li>2. Air filter is dirty</li> <li>3. Spark arrestor screen is dirty</li> </ol>	<ol style="list-style-type: none"> <li>1. Use fresh fuel and the correct 2-stroke oil mix.</li> <li>2. Clean the air filter according to the instructions in the Maintenance section.</li> <li>3. Contact an authorized service dealer.</li> </ol>
Cutting line will not advance when using bump feed action	<ol style="list-style-type: none"> <li>1. Line welded to itself</li> <li>2. Not enough line on the spool</li> <li>3. Line worn too short</li> <li>4. Line tangled on spool</li> <li>5. Engine speed too slow</li> <li>6. Line spool installed back to front</li> </ol>	<ol style="list-style-type: none"> <li>1. Lubricate with silicone spray.</li> <li>2. Install more line.</li> <li>3. Pull line while alternately pressing down on and releasing the bump knob.</li> <li>4. Remove line from spool and rewind.</li> <li>5. Advance line at full throttle.</li> <li>6. Ensure the writing on the line spool is facing the correct way; THIS SIDE OUT FOR STRAIGHT SHAFT.</li> </ol>
Grass wraps around the trimmer head assembly and the attachment shaft	<ol style="list-style-type: none"> <li>1. Cutting tall grass at ground level</li> <li>2. Operating the product at part throttle</li> </ol>	<ol style="list-style-type: none"> <li>1. Cut tall grass from the top down.</li> <li>2. Operate the product at full throttle.</li> </ol>
Oil drips from muffler	<ol style="list-style-type: none"> <li>1. Operating the product at part throttle</li> <li>2. Check oil/fuel mixture</li> <li>3. Air filter is dirty</li> </ol>	<ol style="list-style-type: none"> <li>1. Operate the product at full throttle.</li> <li>2. Use fresh fuel and the correct 2-stroke oil mix.</li> <li>3. Clean the air filter according to the instructions in the Maintenance section.</li> </ol>

## LIMITED WARRANTY (Original Instructions)

TTI warrants this outdoor product to be free of defects in material and workmanship for 24 months from the date of purchase by the original purchaser, subject to the limitations below. Please keep your invoice as proof of date of purchase.

**This warranty is only applicable where the product is used for personal and non-commercial purposes.** This warranty does not cover damage or liability caused by / due to misuse, abuse, accidental or intentional acts by user, improper handling, unreasonable use, negligence, failure by end user to follow operating procedures outlined in the user's manual, attempted repair by non-qualified professional, unauthorised repair, modification, or use of accessories and/or attachments not specifically recommended by authorised party. Please see your local dealer for list of authorised service centres in your area.

This warranty does not cover belts, brushes, bags, bulbs or any part which ordinary wear and tear results in required replacement during warranty period. This warranty does not cover transportation cost or consumable items such as fuses and batteries.

This limited warranty is void if the product's original identification (trade mark, serial number, etc.) markings have been defaced, altered or removed or if product is not purchased from an authorised reseller or if product is sold AS IS and / or WITH ALL FAULTS.

Where permitted, the provisions of this limited warranty are in lieu of any other written warranty, whether express or implied, written or oral, including any warranty of MERCHANTABILITY OR FITNESS FOR A PARTICULAR PURPOSE. IN NO EVENT SHALL WE BE LIABLE FOR SPECIAL, INCIDENTAL, CONSEQUENTIAL OR INCIDENTAL DAMAGES. OUR MAXIMUM LIABILITY SHALL NOT EXCEED THE ACTUAL PURCHASE PRICE PAID BY YOU FOR THE PRODUCT.

**This warranty is applicable only in the European Union, Australia, and New Zealand. Outside these areas, please contact your authorised Ryobi dealer to determine if another warranty applies.**

**TECHTRONIC INDUSTRIES EMEA**

Medina House, Fieldhouse Lane,  
Marlow, Bucks  
SL7 1TB - United Kingdom

**RYOBI TECHNOLOGIES (UK) LIMITED**

Medina House, Fieldhouse Lane,  
Marlow, Bucks  
SL7 1TB - United Kingdom  
Tel: + 44 (0) 1628 894400  
Fax: + 44 (0) 1628 894401  
Technical Helpline : + 44 (0) 800 389 0305

**TECHTRONIC INDUSTRIES FRANCE SAS**

Immeuble Le Grand Roissy  
Z.A. du Gué - 35 rue de Guivry  
77990 Le Mesnil Amelot France  
Phone: + 33(0)1 60 94 69 70  
Fax: + 33(0)1 60 94 69 79

**RYOBI BELGIUM**

Avenue des Pâquerettes, 55  
Zoning artisanal - bâtiment 5  
B - 1410 Waterloo  
Belgique  
Tel : + 32(0) 2357 8140  
Fax : + 32(0) 2357 8149

**TTI ITALIA SRL**

Via Fratelli Gracchi, 39  
20092 Cinisello Balsamo (MI)  
Italia  
Tel : + 39 02 37050440  
Fax : + 39 02 37050444

**TECHTRONIC INDUSTRIES IBERIA S.L**

Av. De la Industria, 52  
Coslada – Madrid – España  
Tel: 91 485 12 10

**TECHTRONIC INDUSTRIES SOUTH AFRICA CO. (PTY) LTD**

P.O Box 83888, South Hills,  
Johannesburg, 2136  
South Africa

**TECHTRONIC OUTDOOR PRODUCTS TECHNOLOGY LIMITED**

24/F, CDW Building,  
388 Castle Peak Road,  
Tsuen Wan, Hong Kong  
Tel : + 852 2402 6888

**TECHTRONIC INDUSTRIES CENTRAL EUROPE GMBH**

Itterpark 2  
D-40724 Hilden  
Deutschland  
Tel: + 49 (0) 2103 960-0  
Fax: + 49 (0) 2103 960-238

**TECHTRONIC INDUSTRIES AUSTRALIA PTY LIMITED**

Building B, Rosehill Industrial Estate,  
3 Shirley Street,  
Rosehill NSW 2142  
Australia  
Tel: (02) 8892 1800 or 1300 361 505  
Fax: 1800 807 993

**TECHTRONIC INDUSTRIES (NZ) LIMITED**

27 Clemow Drive, Mt Wellington  
PO Box 12-806, Penrose, Auckland  
New Zealand  
Tel: + 64 (0) 9 573 0230  
Free Call: +64 0800 279 624  
Fax: + 64 (0) 9 573 0231

**A&M MIDDLE EAST FZCO**

P.O.Box 61254  
Jedel Ali, Dubai  
United Arab Emirates  
Tel.: + 9714 8861399  
Fax: + 9714 8861400

**TECHTRONIC INDUSTRIES DENMARK APS**

Stamholmen 147, 4  
DK-2650 Hvidovre  
Denmark  
Tlf 43 56 55 55  
Fax 43 56 55 56  
E-mail: kundeservice@tti-emea.com

**TECHTRONIC INDUSTRIES NORWAY AS**

Stamholmen 147, 4  
DK-2650 Hvidovre  
Denmark  
Tlf.: (+47) 800 12 493  
Faks: (+47) 800 12 492  
E-mail: kundetjeneste@tti-emea.com

**TECHTRONIC INDUSTRIES SWEDEN AB**

Stamholmen 147, 4  
DK-2650 Hvidovre  
Denmark  
Tel (+46) 08 24 60 30  
Fax (+46) 08 24 60 31  
E-mail: kundtjanst@tti-emea.com

**TECHTRONIC INDUSTRIES FINLAND OY**

Stamholmen 147, 4  
DK-2650 Hvidovre  
Denmark  
Tel. 0800 1 09000  
Fax 0800 1 09001  
E-mail: asiakaspalvelu@tti-emea.com

Machine: **TRIMMER / BRUSHCUTTER**

Name of company: AC (Macao Commercial Offshore)  
Limited

Address: Unit D, 26/F, Centro Commercial  
da Praia Grande, No.429 Avenida  
da Praia Grande, Macau

Type: **RBCGM25SS**

Name / title: Andrew John Eyre (BEng, CEng, MIET)  
Vice President of Engineering

Signature:

