

L.L.Bean

L.L. Bean 0DCX6 Nightfinder II Travel Alarm Clock Model: AS689

USER MANUAL

INTRODUCTION

Thank you for selecting this travel alarm clock.

NOTE Please keep this manual handy as you use your new product. It contains practical step-by-step instructions, as well as technical specifications and warnings you should know about.

CLOCK OVERVIEW

FRONT VIEW

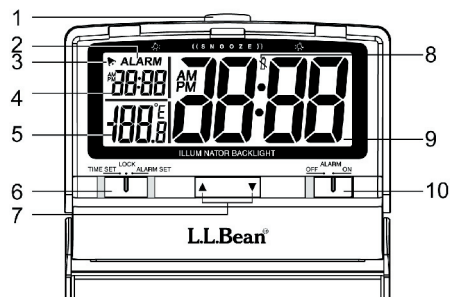

1. **PUSH BUTTON:** open case
2. **Alarm icon**
3. **Alarm set icon**
4. **Alarm time**
5. **Temperature**
6. **TIME SET / LOCK / ALARM SET:** set clock / alarm time; lock unit
7. **▲ / ▼:** increase / decrease a setting
8. **Battery icon.** indicates batteries are low.
9. **Time**
10. **ALARM ON / OFF:** toggle alarm ON / OFF

BACK VIEW / BATTERY COMPARTMENT

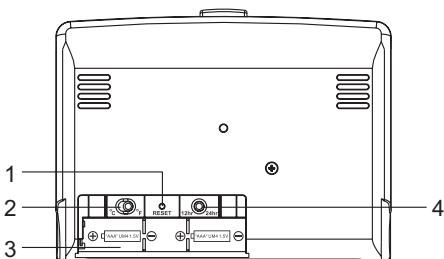

1. **RESET:** return to default settings
2. **°C / °F:** toggle temperature display unit
3. **Battery compartment**
4. **12hr / 24hr:** toggle time display format

GETTING STARTED

INSERT BATTERIES

NOTE Do not use rechargeable batteries. It is recommended that you use alkaline batteries with this product for longer usage

To insert/replace the batteries:

Insert 2 (AAA) Alkaline batteries before first use, matching the polarity (+ / -).

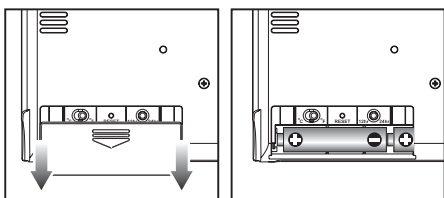

To use the cover as a table stand:

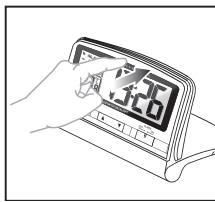

SET CLOCK

1. Slide **TIME SET / LOCK / ALARM SET** to the **TIME SET** position.
2. Press **▲** or **▼** to set the time. (Press and hold for faster setting).
3. Press Slide **TIME SET / LOCK / ALARM SET** to the **LOCK** position to confirm.

NOTE To select 12 / 24 hour format press 12hr / 24hr (in the battery compartment on back of alarm).

ALARM

To set the alarm:

1. Slide **TIME SET / LOCK / ALARM SET** to the **ALARM SET** position.
2. Press **▲** or **▼** to set the time. (Press and hold for faster setting.)
3. Slide **TIME SET / LOCK / ALARM SET** to the **LOCK** position to confirm.

To toggle alarms ON / OFF:

Slide **ALARM ON / OFF** to the desired position. indicates the alarm is ON.

To silence the alarm:

- Gently tap/touch the clock face backwards on its stand as shown to **SNOOZE** (silence the alarm for 8 minutes.)

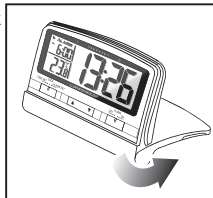

OR

- Press any button or slide **ALARM ON / OFF** to the **OFF** position turn the alarm off.

TEMPERATURE

To select the indoor temperature display unit press °C / °F.

BACKLIGHT

Gently tap/touch the clock face backwards on its stand to illuminate the LCD display for 8 seconds.

RESET

To return to the default settings use a thin blunt object to press **RESET** (in the battery compartment on back of alarm).

PRECAUTIONS

This product is engineered to give you years of satisfactory service if you handle it carefully. Here are a few precautions:

- Do not subject the unit to excessive force, shock, dust, temperature or humidity, which may result in malfunction, shorter electronic life span, damaged battery and distorted parts.
- Do not immerse the unit in water. If you spill liquid over it, dry it immediately with a soft, lint-free cloth.
- Do not clean the unit with abrasive or corrosive materials.
- Do not tamper with the unit's internal components. Doing so will invalidate the warranty on the unit and may cause unnecessary damage. The unit contains no user-serviceable parts.
- Only use fresh batteries as specified in the user's instructions. Do not mix new and old batteries.
- Due to printing limitations, the displays shown in this manual may differ from the actual display.
- The contents of this manual may not be reproduced without the permission of the manufacturer.

NOTE The technical specifications for this product and the contents of the user manual are subject to change without notice.

SPECIFICATIONS

TYPE	DESCRIPTION
L x W x H	108 x 81 x 16 mm (4.4 x 3.3 x 0.7 in)
Weight	81 g (2.86 oz) without battery
Temperature unit	°C / °F
Operating temperature range	-5°C to 50°C (23°F to 122°F)
Resolution	0.1°C (0.2°F)
Alarm duration	2 minutes
Snooze	8 minutes
Hour format	12 / 24 hour format
Power	2 x UM-4 (AAA) 1.5 V

L.L.BEAN GUARANTEE

Our products are guaranteed to give 100% satisfaction in every way. Return anything purchased from us at anytime if it proves otherwise. We do not want you to have anything from L.L. Bean that is not completely satisfactory.

The L.L. Bean 24hr customer service number is:
1-800-341-4341.



086L004308-036