

FunTab XL

Parent's Guide



Section 1: Tablet Overview

Tablet Overview	2
Kid Mode Overview	3
Parent Mode Overview	3
Touch Screen Basics	4
Lock Screen	5
Icon Glossary	5

Section 2: Initial Setup

Charging	6
Connecting to Wi-Fi	6
User Setup	7
Editing Available Apps	7
Turning on Child Lock	8
Parent Dashboard	9

Section 3: Common Functions

Downloading and Installing Apps	10
Uninstalling Apps	11
Removing Apps from Home Screen	11
Connecting to a Computer	11
Kid Safe Browser Overview	14
Adding Safe Sites	15
Deleting Sites	15
Recording a Storybook	16
Adding Music and Movies	16
Camera	17
Widgets	17
Settings	18
Included Apps	19
Tips and Tricks/FAQs	23
Care	24
Specifications	24
Customer Support	25
Limitations of Liability	25

1. Tablet Overview

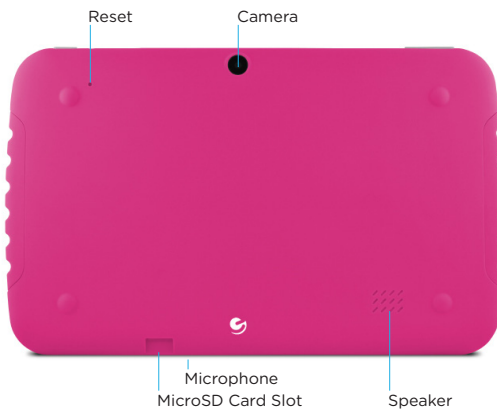
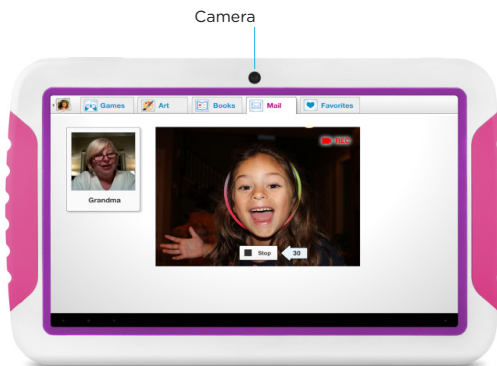
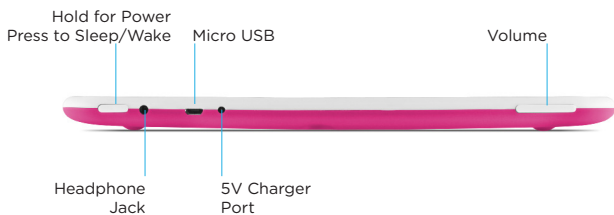

Kid Mode Overview

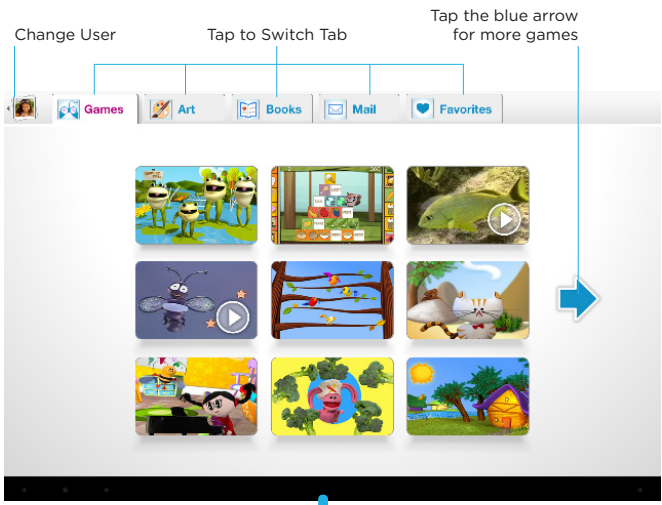

Parent Mode Overview

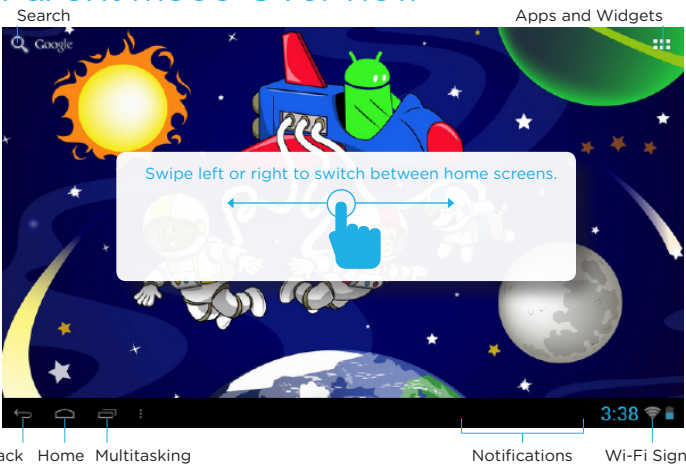

Touch Screen Basics

Tap the screen once to activate or open something.



Touch and hold to move an item by dragging.

*In many apps touch and hold can offer more options.



Zooming: Double tap quickly to zoom into a webpage, picture, or map. Some apps allow you to zoom in and out by touching the screen with two fingers, and pinching them together.



TIP: You can flick the screen with your finger to quickly scroll through a long list, such as a library of music.

Tap a specific location on the screen where you would like to enter text. The on-screen keyboard will pop up, allowing you to type out your desired text.

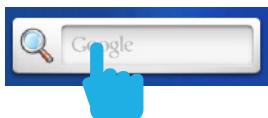

Hide Keyboard

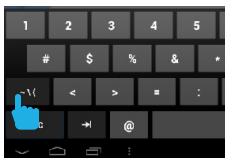
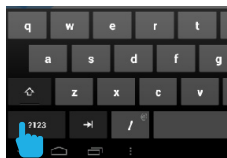
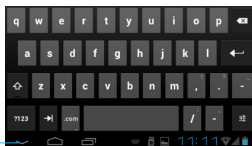

Tap **?123** for numbers and more punctuation. Then tap **~\{** for more symbols.

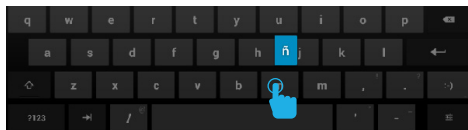

Touch and hold a letter for special characters.

The G-Sensor allows the tablet to detect screen rotation. You can view the home screen in either a landscape or portrait format as you use the apps. **Kid mode only functions in landscape format.**



Lock Screen

Slide the padlock icon circle to the unlocked padlock to unlock the screen.

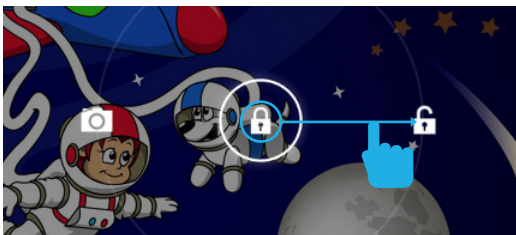

Icon Glossary



Battery Level: The blue battery level indicator will decrease and change to red as the battery is drained.



Wi-Fi Signal: As the Wi-Fi signal strength decreases, the blue bands will change to grey.



Settings: Adjust your settings for Wi-Fi, screen brightness, security settings, language options, and more.



Menu: Tap to reveal settings and options.

2. Initial Setup

Charging

Fully charge your FunTab XL for 6 hours before the first use.



Use the included 5V wall charger.



The battery indicator will show that your device is charging.



Connecting to Wi-Fi

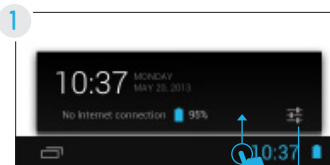

Slide up from the clock and tap the settings icon.

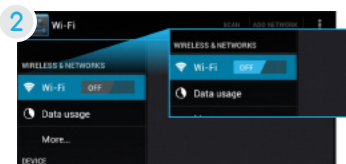

Select Wi-Fi.

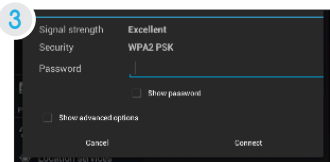

Choose your network and enter your password.

When connected, tap back.



If you accidentally exit Kid Mode during set-up, tap the Kid Mode icon on the desktop to resume initial setup.



User Setup

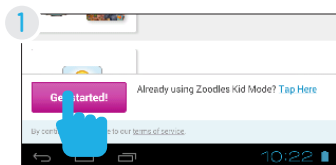

Tap "Get Started!"

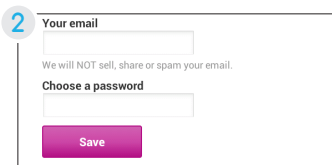

Enter the e-mail and password you would like to use and tap save.

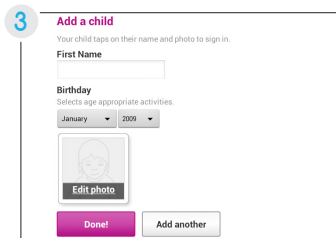

Add your child. You can add another child now, or later at any time by using the parent dashboard app.



Editing Available Apps

All apps will be available the first time you turn on the tablet.

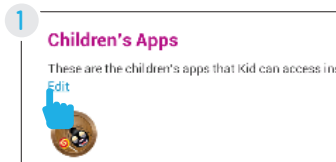

To modify apps, tap Edit, or you can tap Save to skip and move on to the next step.

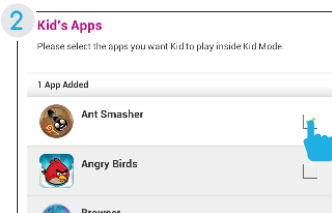

Uncheck the apps you want to remove by tapping in the check box, then tap save.

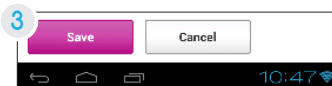

You can edit the available apps later by using the Parent Dashboard app and selecting Apps.

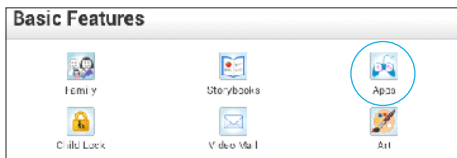

Turning on Child Lock

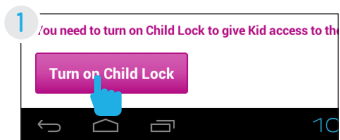

Tap "Turn on Child Lock."

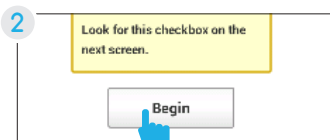

Tap "Begin."

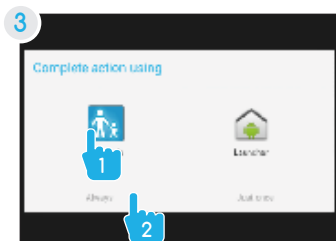

First, tap Kid Mode. Then, tap Always.

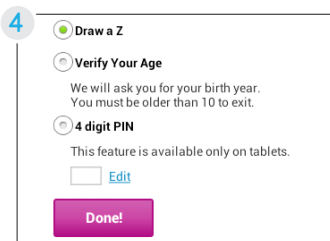

Choose which action is required to exit Kid Mode. Entering a 4 digit pin is the most secure option.

Use the Parent Dashboard to control the child lock features and to change the required action for exiting out of Kid Mode.

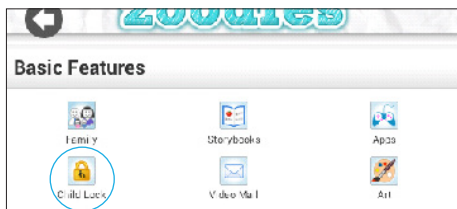

You can choose 3 levels of security:

Least Secure

Most Secure

Draw a Z

Enter Birthdate

Enter PIN

Parent Dashboard



Family: Add additional children.



Storybooks: Record yourself reading a story, or buy more books.



Apps: Select the Android Apps available to use from inside Kid Mode.



Child Lock: Turn Child Lock on/off or choose which action is required to exit Kid Mode.



Video Mail: Turn Video Mail on/off.
Go to www.zoodles.com/parent to send your child a video message, add family members to your account, and review all the message your child has sent and received.



Art: Save your favorite drawings by giving them a gold star.



Settings: Sign out, refresh content, or set maximum volume.



Help: Need help? Get answers to help you address common problems with Zoodles. Scroll through a list of popular topics, or send questions and feedback.

Visit www.zoodles.com/parent to promote subjects, record video mail, invite family members, and more.

Upgrade to premium to promote subjects, set time limits, adjust violence filter, block characters, block sites, and more.

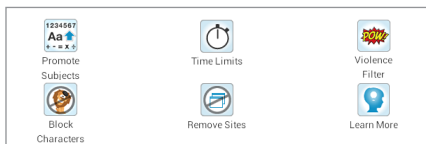

3. Common Functions

Downloading and Installing Apps

Apps can be downloaded in Kid Mode, but you must exit Kid Mode to install the app.



Tap the App Mall icon.



Tap the app you want to download.



Tap Accept Permissions.

3 Exit Kid Mode.



Tap the App Mall icon

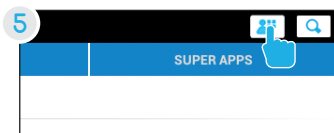

Tap the My Account icon in the top right corner.



Tap downloads to see the apps that have been downloaded but not installed.

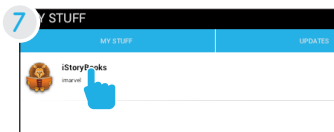

Tap an app.



Tap Install.

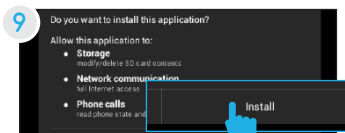

Tap Install.

10 Use the Parent Dashboard app to make the app available in Kid Mode. See the [Editing Available Apps](#) Section.



Tip: If you install too many apps, you may run out of memory. You can uninstall an app and download it again later.

Uninstalling Apps

In parent mode, touch and hold an app in the app menu and drag to the trash can Uninstall icon.

You can also uninstall apps by tapping apps in the settings app.

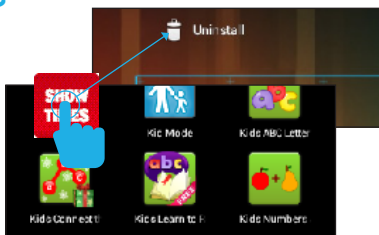

Removing Apps from Home Screen

In parent mode, touch and hold an app on the home screen and drag to the X Remove icon.

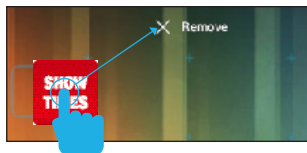

Connecting to a Computer

You must be in parent mode to connect to a computer.



Connect to your computer by USB.

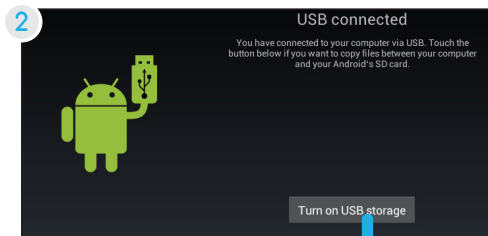

Tap turn on USB storage.

3

USB Mass Storage

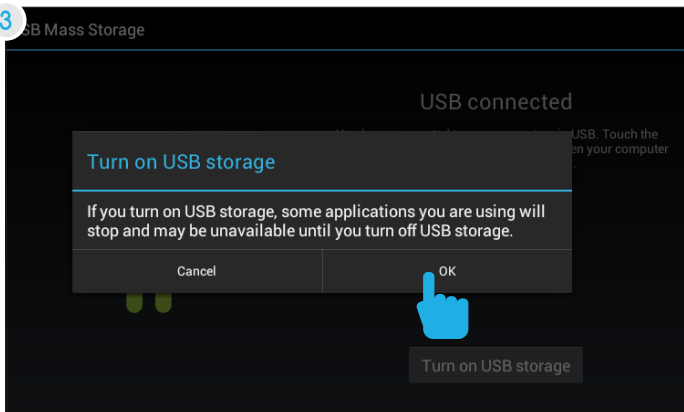

Tap OK to allow USB Storage.

PC

Skip to the next page if you have a Mac®.

4



Choose open folder to view files or select the removable disk.

5

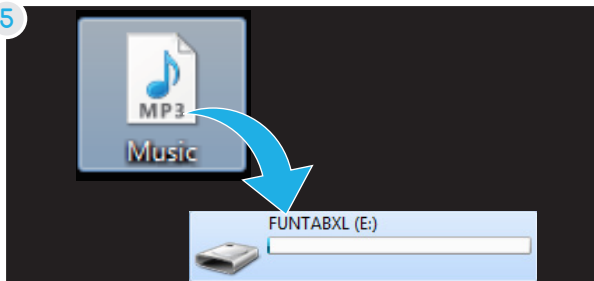

You will now be able to drag and drop files from your computer to your tablet just as you would with a USB flash drive.

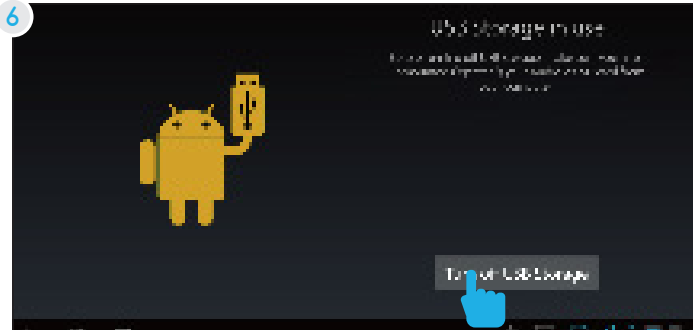

Before turning off USB storage, make sure you have unmounted (“ejected”) the FunTabXL and SD card from your computer. Tap Turn off USB Storage.

Mac®

Go to the previous page if you have a PC.

- 4 Use **Finder®** to go to **Devices** and choose FTABXL.
- 5 You will now be able to drag and drop files from your computer on to your tablet just as you would with a USB flash drive.

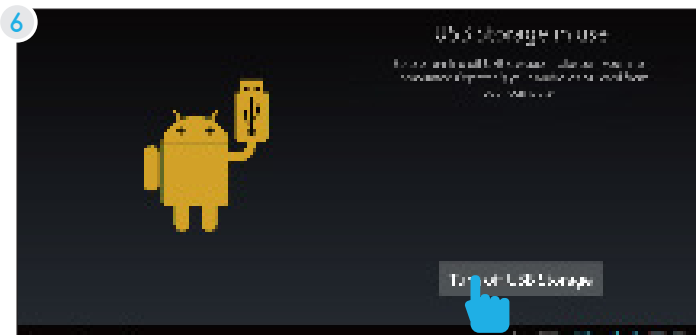

Before turning off USB storage, make sure you have unmounted (“ejected”) the FunTab and SD card from your computer. Tap Turn off USB Storage.

Kid Safe Browser Overview



Maxthon's kid safe browser allows your child to safely browse the internet by only granting access to sites you have approved.



Settings:

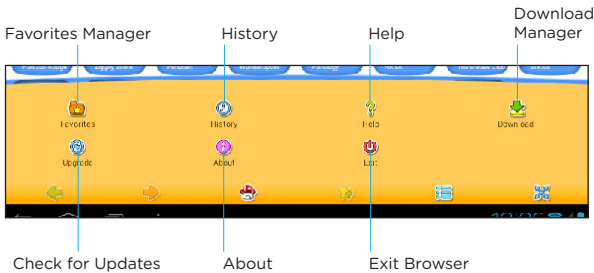

Adding Safe Sites



Tap the + icon.

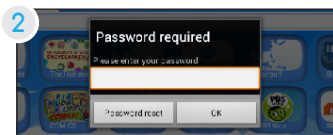

The first time you add a site you will be prompted to solve a math problem and create a password.

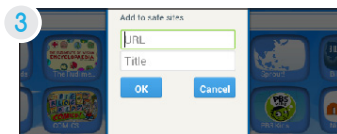

You can choose from recommended sites or enter your own URL.

Deleting Sites

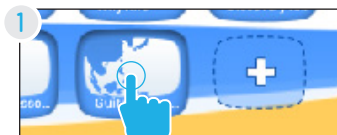

Touch and hold an icon.

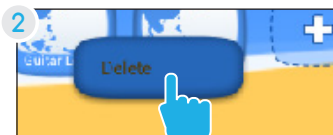

Tap the pop-up delete button.

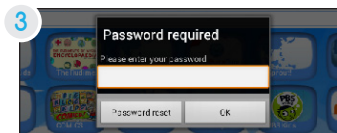

Enter your password.

Recording a Storybook



Use the Parent Dashboard app to make a recording of you reading a storybook to your child.

1

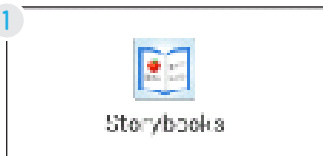

Tap Storybooks.

2



Select a child to receive your story.

3



Choose a book. You can upgrade to premium for more books.

4

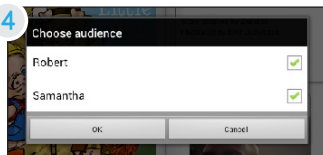

Choose your audience.

5



Tap start recording to begin. Turn each page by tapping the green arrow.

6

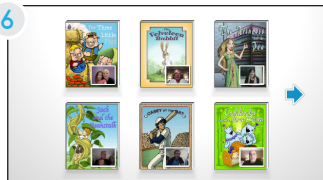

The story will be available to your child after processing.

You can delete a recording by logging into your parent dashboard on zoodles.com.

Adding Music and Movies

To view videos and listen to music that have already been loaded, the My Music app and My Video app must be made available in Kid Mode. Use the Parent Dashboard to add them if they aren't already. See the [Editing Available Apps](#) Section.



Camera



Tap the Camera app to access the camera.

Camera Overview:

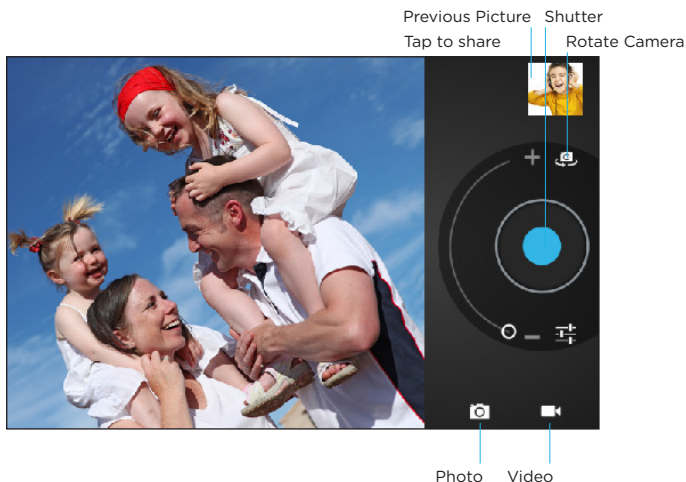

View your photos and videos in the HD Player.

Widgets

Widgets allow you to personalize your home screen with useful information and tools. Some widgets can be resized. Touch and hold, then release. Next, drag the blue diamonds to resize the widget.

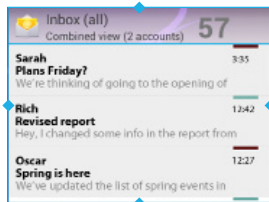

Settings

Wi-Fi: Turn Wi-Fi on to see available networks and connect.

Data usage: View user data for your FunTabXL.

Sound: Adjust the volume, notifications, and alarm sounds.

Display: Adjust brightness, change your wallpaper, turn on/off screen rotation, sleep settings, and font size.

Storage: Provides storage use data.

Battery: Provides battery usage data.

Apps: Tap an app to force stop, uninstall, clear data, move to SD card, or clear data.

Location services: Allow google to use data to determine your location for improved search results.

Security: adjust settings to make your tablet more secure. Allow installation of non-Market apps.

Language & input: Set language, spelling correction, keyboard and voice settings.

Backup & reset: Backup data and factory reset your tablet.

Accounts: Add or remove accounts.

Date & time: Set the date, time, and time zone.

Accessibility: Adjust settings for users with poor vision.

Developer options: Advanced settings for developers.

About tablet: Model number and general tablet information.

Included Apps



Adobe Reader: View PDF documents



Angry Birds: Use the unique power of the Angry Birds to destroy the greedy pigs' fortresses!



Ant Smasher for Kids: Smash ants with your finger.



App Mall: Download kid friendly apps and games.



Bumbee: Bumbee is here & now it's up to you to fly her in this never ending adventure!



Browser: Internet browser.



Calendar: Keep track of your schedule and set reminders.



Calculator: Basic calculator functions.



Camera: Still and video camera.



Caveman 2: Go back to the Stone Age and survive from the dangerous dinosaurs.



Clock: Keep time and set alarms.



Clouds & Sheep: Care for a flock of sheep to become the best shepherd of all time!



Cut the Rope: Cut the rope to feed Om Nom the candy he wants and catch stars along the way.



Devil Ninja 2: Fight monsters on the devil's land.



Downloads: Manage your current downloads.



Email: Sync your Email accounts.



eMusic: Listen, discover, and buy new music.



Evernote: Keeps notes and to do lists.



File Manager: Browse for files to open, delete, etc.



Flash Player: Provides Flash compatibility.



Fruit Ninja: Slice fruit like a true warrior.



Geo Quiz: Match the correct flag and capital with the country.



Gravittire 3D: 3D tire racing!



Happy Vikings: Hoard gold and perform great stacking feats to earn your place in Valhalla!



iStory Books: Illustrated storybooks that read themselves.



Kid Mode: The primary interface for the FunTab XL with educational content, stories, and more.



Kids ABC Letters: Learn the letters of the alphabet.



Kids ABC Phonics: Learn the sounds of letters.



Kids Animals: Contains questions and descriptions of over 70 animals.



Kids Animal Piano: 9 tone piano for kids with animal sounds.



Kids Connect the Dots: Improve letter and number recognition skills with this classic game.



Kids Connect the Dots Xmas: Festive-themed, musical version of Kids Connect the Dots



Kids Learn to Read: Practice blending sounds together to read and spell simple words.



Kids Numbers and Math: A fun way for kids to learn numbers and build basic math skills.



Kids Preschool Puzzle: Educational fun with colorful puzzles.



Kids Shapes: A hands-on, real-life way for kids to learn shapes.



Kingsoft Office: Type documents, make spreadsheets and presentations



Maxthon Kid Safe Browser: Safe and clean web browser for kids.



Music: Music Player



High-Q MP3 Recorder: Voice Recorder



HD Player: Video and Picture Player



Lightracer 3D: Futuristic light-emitting motorcycles race in a 3D arena.



Noogra Nuts: Control a cute little squirrel with a unique ability; he can crack nuts using his head!



Parent Dashboard: Adjust settings for Zoodles Kid Mode.



Pig Rush: Help Jumpy the Pig in his quest to run away from the farm.



Pogoplug: Connect to the internet to access and share your files. Includes 5GB of cloud storage.



Radio Ball 3D: A fun, radioactive, fast-paced, accelerometer driven 3D game.



Return Zero: Ultra fast 3D tunnel racer.



School Assistant: School Assistant is your personal school aide, keep your routine organized.



Settings: Adjust settings on the FunTab XL.



Sketch: Annotate an image with arrows, shapes and text.



Tiki Kart 3D: Extreme racing with Tiki Bobby and friends.



Toon Goggles: Unlimited amount of child and parent friendly cartoons.



Where's My Water: Help Swampy by guiding water to his shower!



WiFi Connection Manager: Wi-Fi manager and scanner.

Tips and Tricks/FAQs

Screen Brightness

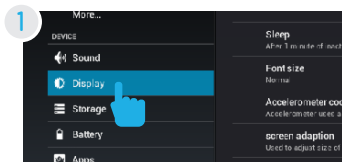

In the settings tap Display.

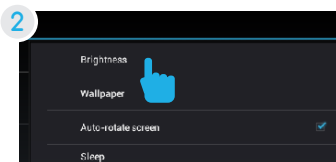

Tap Brightness.

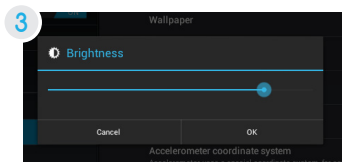

Use the slider to adjust the brightness. Then tap OK.

Tip: Lower the brightness at night to extend your battery life.

Volume Limiter

Kid Mode features a built-in volume limiter to prevent your child from listening to audio at excessive volume. Go to the Parent Dashboard app and tap Settings, then tap Maximum Volume to adjust the setting.

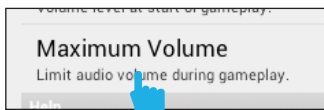

Apps won't install

In the settings app tap security. Be sure "Allow installation of non-Market apps" is checked.

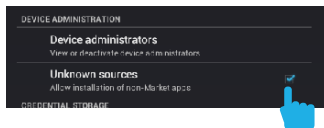

You must allow installed apps to be accessed in Kid Mode. See the [Editing Available Apps](#) section.

Won't Connect to Computer

Try a different USB port on your computer and/or restarting your FunTab XL.

The battery may be too low and the computer is not providing enough power by USB. Use the wall charger to charge your FunTab XL for 30 minutes then re-connect to the computer.

Tablet Freezes

Sometimes your FunTab XL may freeze.



The reset button is located on the back of the unit. Reset the device by pressing the button with a small object such as a paper clip.

Factory Restore

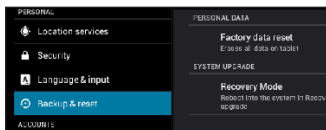

Select Backup & reset in the settings app to restore factory settings. This will erase all data on the tablet.

Care

The FunTab XL is an electronic device and can be damaged if used improperly.

- Don't expose your device to liquids, water or extreme humidity.
- Don't try to dry the FunTab XL using a heat source such as a dryer, microwave, or oven.
- Don't charge your tablet or use it in environments above 95°F and below 32°F.
- Don't expose the FunTab XL to dirt or sand.
- Use a clean, dry cloth to clean your tablet. Do not use chemicals or water.
- The FunTab XL can be damaged by shock from dropping.

Specifications

CPU: 1.0GHz

GPU: 400MHz

RAM: 512MB

Memory: 4GB

MicroSD Card Supported: up to 32GB

Resolution: 800x480

Battery: Rechargeable Li-Polymer

Record: Built-in Microphone

Operating System: Android 4.1, Jelly Bean

Video Formats: WMV, MKV, MO, AVI, RM/RMVB, MPEG-2/4

Music Formats: MP3, WMA, APE, FLAC, AAC, AC3, WAV

Customer Support

Visit ematic.us/support for customer support regarding your device.

To submit a request, fill out the required information online. You will be provided a ticket number regarding your issue, which you can refer to when contacting us further.

Caution - Electric Device

Not recommended for children under 5 years of age. As with all electric products, precautions should be observed during handling and use to prevent electric shock.

Attention: Important Safety Information

All charging functions and mechanisms (AC adapter, car charger) are intended for adult usage. Children should not use this device while charging.

Limitations of Liability Statement Links to Third Party Sites

The Ematic User Manual may contain or reference links to third-party sites, however, please be aware that Ematic is not responsible for and cannot control these other sites. Ematic makes no representations or warranties whatsoever about any other website which you may access as a result of reading this user manual, or otherwise. When you access a website that is not owned or operated by Ematic (a "non-Ematic website"), even one that may contain an Ematic logo, please understand that it is independent from Ematic, and that Ematic has no direct control over the content on such website(s). In addition, a link to any such non-Ematic website does not mean Ematic endorses or accepts any responsibility for the content, or of any functionalities or services, of such website(s). Furthermore, Ematic makes no promise, representation or warranty that any non-Ematic website you navigate to will be free of viruses, worms, Trojan horses and other items of a destructive nature. The Ematic User Manual is for your exclusive benefit and you assume all risks, losses and/or damages of whatever nature that may result arising out of your use of the Ematic User Manual.

Limitation of Liability and Indemnity

To the maximum extent permitted by applicable law, Ematic shall not be liable for any damages suffered as a result of using, modifying, contributing, copying, distributing, or downloading the materials, use of the Ematic User Manual or use of any Ematic product and/or software. In no event shall Ematic be liable for any indirect, extraordinary, exemplary, punitive, special, incidental, or consequential damages (including, without limitation, loss of data, revenue, profits, use or other economic advantage) however arising, whether for breach of contract or in tort, even if Ematic has been previously advised of the possibility of such damage. You agree that you have sole responsibility for adequate protection and backup of data and/or equipment used in connection with the product and software and will not make a claim of any nature against Ematic for lost data, inaccurate output, work delays or lost profits resulting from the use of the materials. You agree to indemnify, hold harmless and defend Ematic, together with its affiliates, parent and subsidiary entities, successors, assigns, partners, managers, members, employees, officers, directors and shareholders, from and against any and all damages, liens, liabilities, losses, demands, actions, causes of action, claims, costs and expenses (including, without limitation, reasonable attorneys' fees, charges and disbursements, as well as the cost of in-house counsel and appeals) arising from or related to Ematic, the use of The Ematic User Manual or any Ematic product and/or software. Some jurisdictions do not allow the exclusion or limitation of incidental or consequential damages, so the above limitation or exclusion may not apply to you.

Windows™ is a registered trademark of Microsoft Corp. in the United States and other countries; Mac® and Finder® are registered trademarks of Apple Inc.; Linux™ is a registered trademark of Linus Torvalds. Android is a trademark of Google Inc. The Android Robot logo is a trademark of Google Inc and used under a Creative Commons Attribution license. Ematic is not affiliated with Google Inc. Angry Birds is a trademark of Rovio Entertainment Ltd. and used by Ematic under a license. Ant Smasher for Kids is a trademark of Nuriara Games and used by Ematic under a license. Caveman 2 is a trademark of KidsFun and used by Ematic under a license. Clouds & Sheep is a trademark of Handygames and used by Ematic under a license. ZeptoLab, Cut the Rope, Cut the Rope Experiments, Om Nom, and Feed with Candy are the trademarks or registered trademarks of ZeptoLab UK Ltd. © 2012 and used by Ematic under a license. Devil Ninja 2 is a trademark of Droid Studio and used by Ematic under a license. EVERNOTE, the Evernote Elephant logo and REMEMBER EVERYTHING are trademarks of Evernote Corporation and used by Ematic under a license. Fruit Ninja is a trademark of Halfbrick Studios and used by Ematic under a license. Geo Quiz is a trademark of Paweł Janeczek and used by Ematic under a license. Gravitire 3D is a trademark of Anuloid and used by Ematic under a license. iStorybooks is a trademark of iMarvel and used by Ematic under a license. Intellijoy is a trademark of Intellijoy and used by Ematic under a license. Kids Animal Piano is a trademark of rad lemur a division of Byte Cave Software Inc. and used by Ematic under a license. Maxthon Kid-Safe Browser is a trademark of Maxthon International Ltd and used by Ematic under a license. Lightracer 3D is a trademark of Battery Powered Games LLC and used by Ematic under a license. Noogra Nuts is a trademark of Bengigi Studio and used by Ematic under a license. Radio Ball 3D is a trademark of Gamesoul Studio and used by Ematic under a license. School Assistant is a trademark of Gil Castro and used by Ematic under a license. Return Zero is a trademark of We Came From Mars and used by Ematic under a license. School Assistant is a trademark of Gil Castro and used by Ematic under a license. Sketch is a trademark of Evernote Corporation and used by Ematic under a license. Squibble is a trademark of MassHabit Games and used by Ematic under a license. Tiki Kart 3D is a trademark of Arb Studios LLC and used by Ematic under a license. Where's my Water? and Disney logo are trademarks of Disney and used by Ematic under a license. Zoodles is a trademark of Inquisitive Minds, Inc and used by Ematic under a license. HDMI is a trademark of HDMI licensing, LLC and used by Ematic under a permissions process granted to Ematic (Shaghal Ltd) as an Adopter.

The Bluetooth® word mark, figure mark (stylized "B Design"), and combination mark (Bluetooth word mark and "B Design") are registered trademarks and are wholly owned by the Bluetooth SIG.

Adobe and Flash are either registered trademarks or trademarks of Adobe Systems Incorporated in the United States and/or other countries.

Wi-Fi®, the Wi-Fi CERTIFIED logo, and the Wi-Fi logo are registered trademarks of the Wi-Fi Alliance.

Ematic is not affiliated with Microsoft, Apple, Inc., Linux, or Google, Inc., (including Android). Borders, or Bluetooth SIG Inc.

The Ematic brand and products are owned by Shaghal, Ltd.

